



SIMPLE MANUAL

Wireless Sound Bar

To view the instructions of advanced features,
visit <http://www.lg.com> and then download Owner's Manual.
Some of the content in this manual may differ from your unit.

MODEL
SH3B



www.lg.com



Front Panel

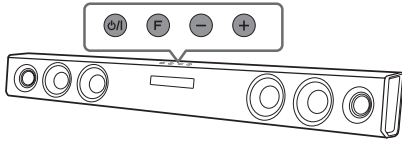

- Standby/ON
- Selects Function
- Adjusts Volume

Rear Panel

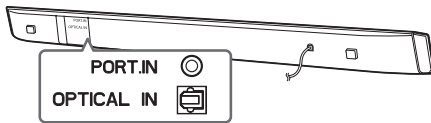

- PORT.IN Connect to a Portable device
- OPTICAL IN Connect to an Optical device

1 Subwoofer Connection

Place the wireless subwoofer near the sound bar and follow steps below.

- 1 Connect the power cord of wireless subwoofer to the outlet.
- 2 Turn on the sound bar :
The sound bar and wireless subwoofer will be **automatically** connected. The subwoofer's yellow - green LED turns on.

Subwoofer Connection Manually

- 1 Reset the subwoofer
If the yellow - green LED on the subwoofer blinks quickly, skip this step and go to 2
 - Press and hold **PAIRING** button for 5 seconds.
 - The LED lights up alternately in red and yellow - green.
 - Plug out the power cord. After the LED turns off completely, plug in the power cord again.

When the reset is completed, the subwoofer's yellow - green LED blinks quickly.

- 2 Reset the sound bar
 - Adjust volume to minimum until the red LED on the sound bar lights up for a while.
 - Press and hold (Mute) button on the remote control for 3 seconds.
 - The red LED on the sound bar blinks quickly.
 - Turn the sound bar's power off and on while the subwoofer's yellow - green LED blinks.

When the connection is completed, you can see the yellow - green LED on the subwoofer.

Keep the sound bar and the subwoofer away from the device (ex. wireless router, microwave oven, etc.) over 1m to prevent wireless interference.

2

TV Connection

- 1 Connect the sound bar to the TV using Optical cable.
- 2 Set up [External Speaker (Optical)] on your TV setting menu.

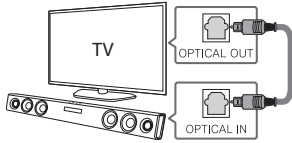

Additional Device Connection

- 1 Connect to the external device as follows.

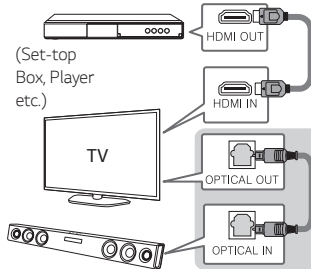

- 2 Set the input source by pressing F on the remote control or unit repeatedly.

Remote control

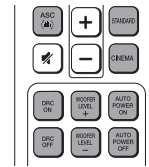

ASC/STANDARD/CINEMA : Selects sound effect.

DRC ON/OFF : Makes comfortable sound at Dolby Digital.

WOOFER LEVEL+/- : Adjusts the volume level of subwoofer.

AUTO POWER ON/OFF : Automatically turns on by an input source.

Replacement of battery

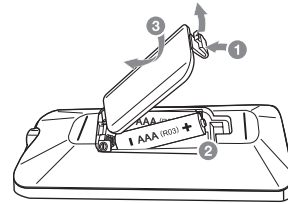

Additional Information

Specification

Power requirements	Refer to the main label.
	Refer to the main label.
Power consumption	Networked standby : 0.5 W (If all network ports are activated.)
Dimensions (W x H x D)	Approx. 950 mm x 71 mm x 47 mm (37.4 inch x 2.8 inch x 1.9 inch)
Net Weight	Approx. 2.47 kg (5.4 lb)
Amplifier (Total RMS Output power)	300 W

Design and specifications are subject to change without notice.

How to disconnect the wireless network connection or the wireless device

Set up the AUTO POWER ON/OFF function to off and turn off the unit.

Industry Canada Statement

This device complies with Industry Canada's licence-exempt RSSs. Operation is subject to the following two conditions:

- (1) This device may not cause interference; and
- (2) This device must accept any interference, including interference that may cause undesired operation of the device.

CAN ICES-3 (B)/NMB-3 (B)

IC Radiation Exposure Statement

This equipment complies with IC radiation exposure limits set forth for an uncontrolled environment.

This equipment should be installed and operated with minimum distance 20 cm (7.8 inches) between the antenna & your body.

NOTE: THE MANUFACTURER IS NOT RESPONSIBLE FOR ANY RADIO OR TV INTERFERENCE CAUSED BY UNAUTHORIZED MODIFICATIONS TO THIS EQUIPMENT. SUCH MODIFICATIONS COULD VOID THE USER'S AUTHORITY TO OPERATE THE EQUIPMENT.

WARNING

[For product having the wireless function using 5 GHz frequency bands]

- (i) the device for operation in the band 5150–5250 MHz is only for indoor use to reduce the potential for harmful interference to co-channel mobile satellite systems;
- (ii) for devices with detachable antenna(s), the maximum antenna gain permitted for devices in the bands 5250–5350 MHz and 5470–5725 MHz shall be such that the equipment still complies with the e.i.r.p. limit;
- (iii) for devices with detachable antenna(s), the maximum antenna gain permitted for devices in the band 5725–5850 MHz shall be such that the equipment still complies with the e.i.r.p. limits specified for point-to-point and non-point-to-point operation as appropriate; and
- (iv) the worst-case tilt angle(s) necessary to remain compliant with the e.i.r.p. elevation mask requirement set forth in Section 6.2.2(3) shall be clearly indicated. (devices operating in the band 5250–5350 MHz with a maximum e.i.r.p. greater than 200 mW)
- (v) High-power radars are allocated as primary users (i.e. priority users) of the bands 5250–5350 MHz and 5650–5850 MHz and that these radars could cause interference and/or damage to LE-LAN devices.

LG Customer Information Center
Centre d'information à la clientèle de LG

1-888-542-2623

CANADA

Register your product Online!
Enregistrez votre produit en ligne!

www.lg.com