

Quick Start Guide

LED TV
LH452A
LH454A
LH458A

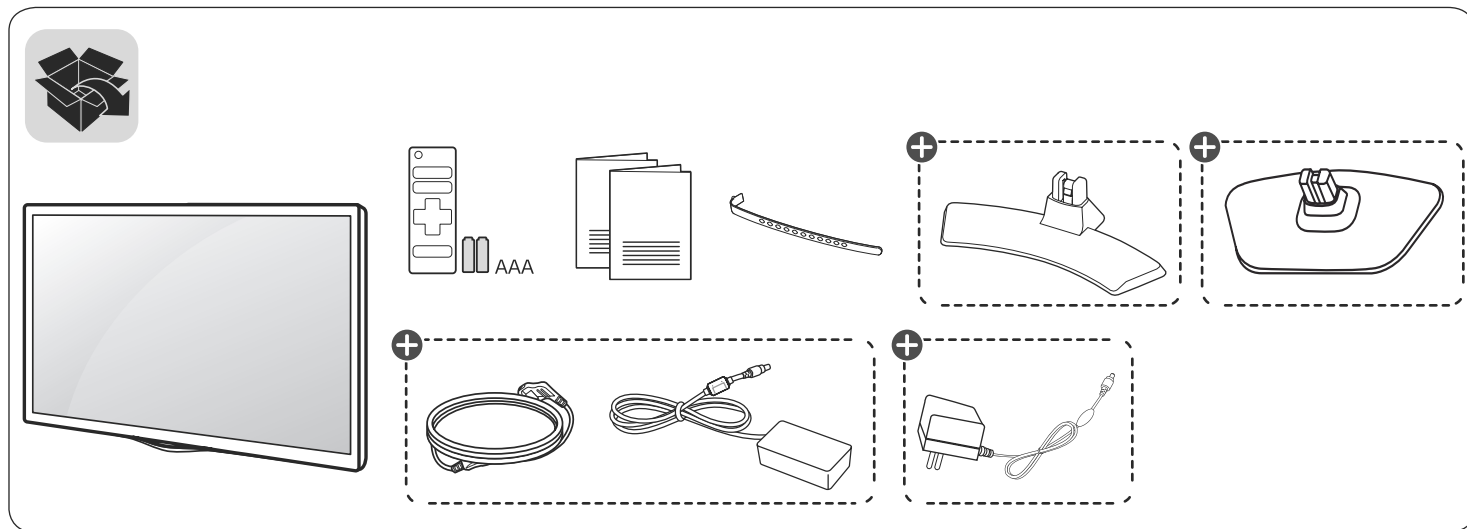

Image may vary depending on model.

⊕: Depending on models.

Unpacking

Check your product box for the following items. If there are any missing accessories, contact the local dealer where you purchased your product. The illustrations in this manual may differ from the actual product and item.



www.lg.com

P/No: MFL69446104 (1602-REV00)



English

- Read **Safety and Reference**.
- For the power supply and power consumption, refer to the label attached to the product.



LH452A

1

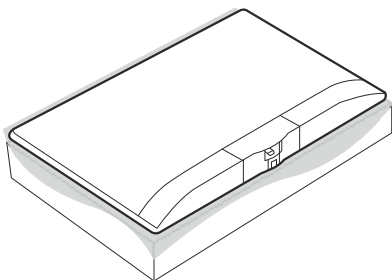

2

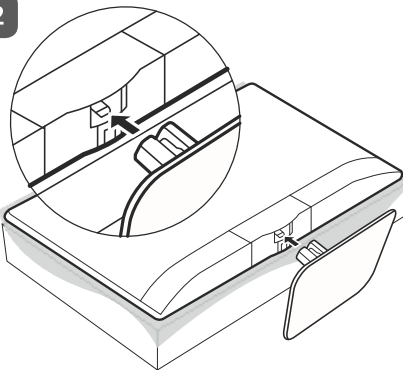

3

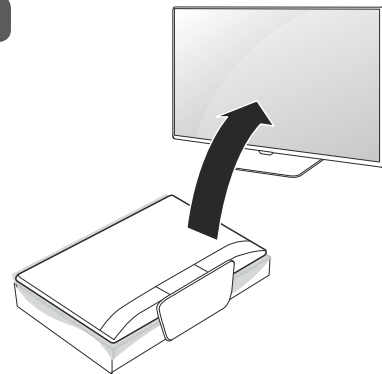

CAUTION

Image shown may differ from your TV.

When attaching the stand to the TV set, place the screen facing down on a cushioned table or flat surface to protect the screen from scratches.



LH454A /
LH458A

1

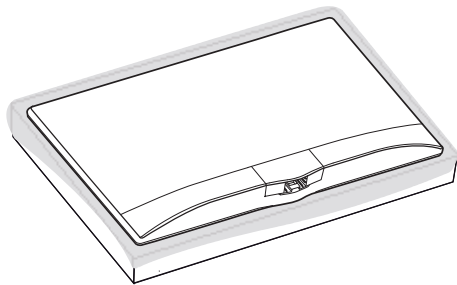

2

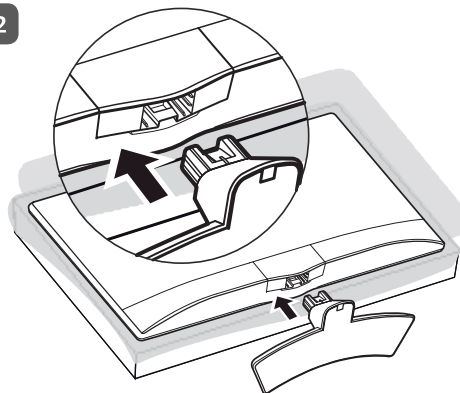

3

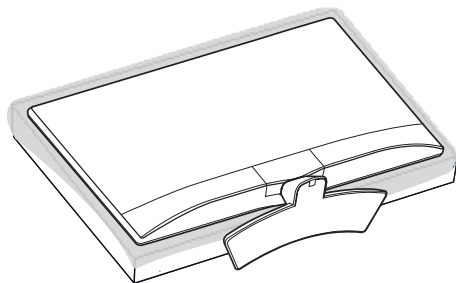

4

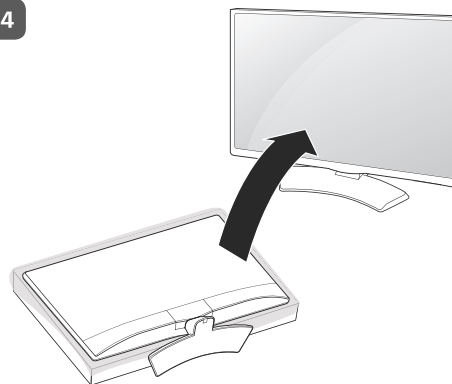

CAUTION

Image shown may differ from your TV.

When attaching the stand to the TV set, place the screen facing down on a cushioned table or flat surface to protect the screen from scratches.



ANTENNA/
CABLE IN

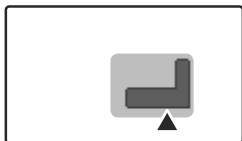
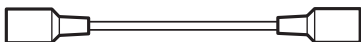

HDMI IN

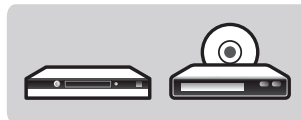
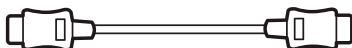

USB Connection

Connect a USB storage device such as a USB flash memory, external hard drive, or a USB memory card reader to the TV and access the entertainment menu to use Various multimedia files

USB IN



Note: All connection cables shown in the picture are not included along with the TV set

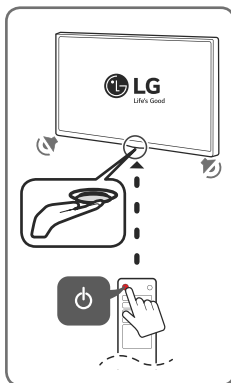

NOTE

*Image may vary depending on model.



LH452A

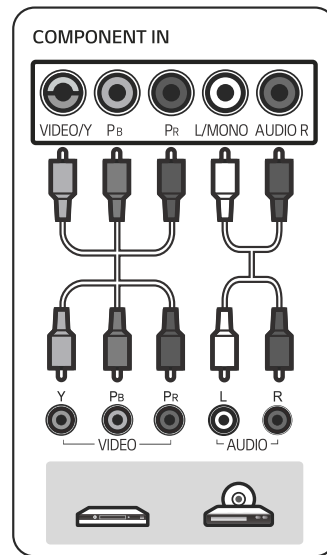
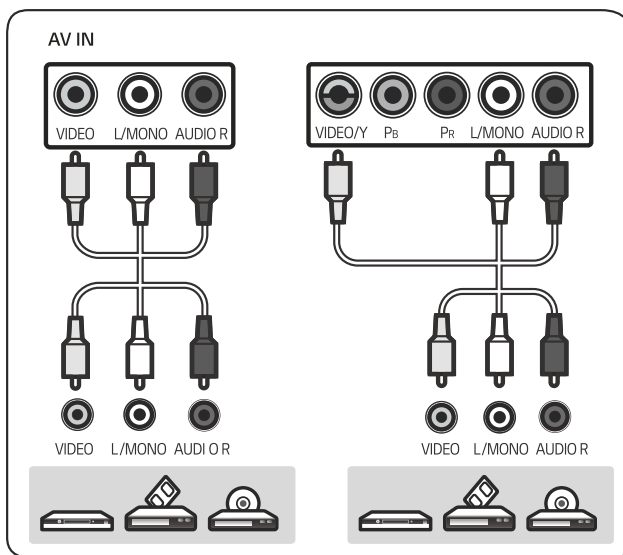
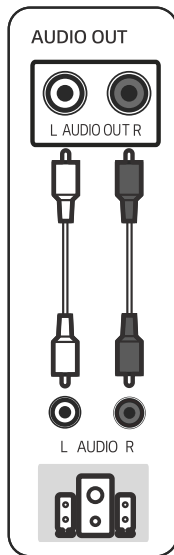
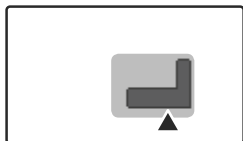

NOTE

- Image shown may vary depending on model.
- All connection cables & devices shown in the picture are not included along with the TV set.



LH454A/LH458A

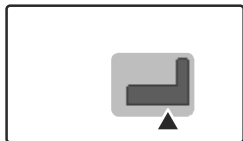

AUDIO OUT

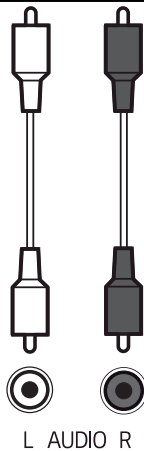

AV IN

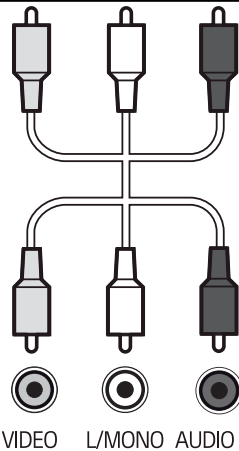

RGB IN

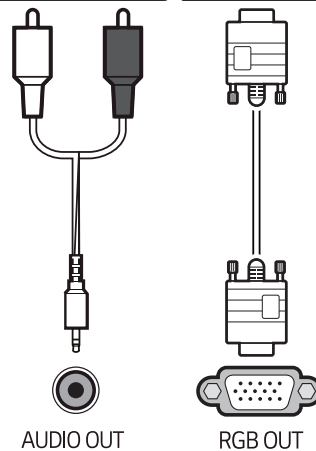

NOTE

- Image shown may vary depending on model.
- All connection cables & devices shown in the picture are not included along with the TV set.

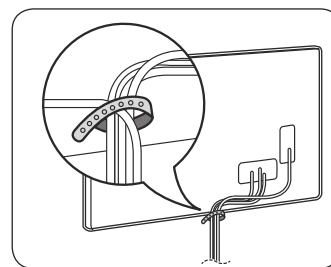
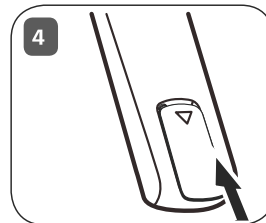
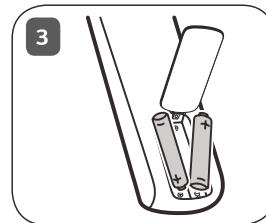
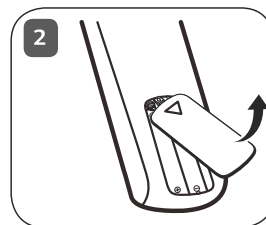
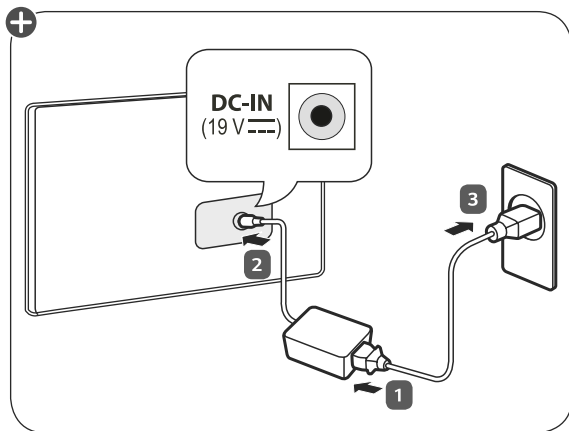
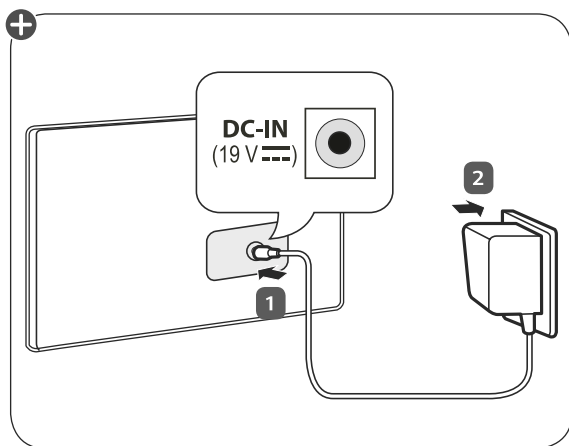

NOTE

Do not use sub standard batteries in monitor remote which may lead to leakage & damage the remote control unit permanently. For long unused applications of remote controller it is advisable to remove batteries from remote control unit.

MFL69446104

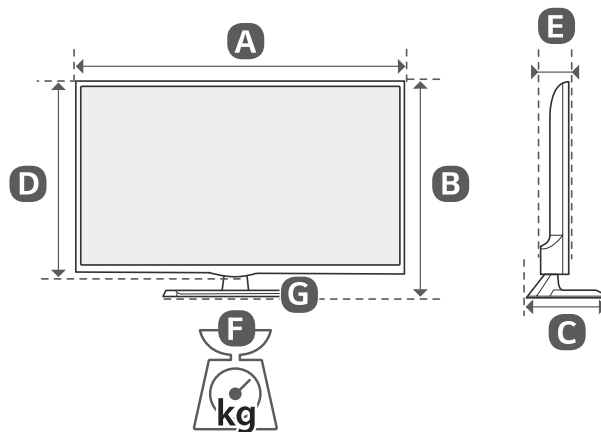
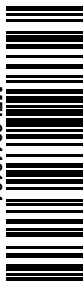

	A (mm)	B (mm)	C (mm)	D (mm)	E (mm)	F (kg)	F - G (kg)	Power requirement
24LH458A-TC 24LH454A-TA	556	387.3	146.3	343.1	53.1	3.4	3.2	19 V $\overline{\text{---}}$ 1.6 A
24LH452A-TB	556	384.3	140.6	343.1	53.1	3.4	3.2	19 V $\overline{\text{---}}$ 1.6 A
28LH454A-TA	641.5	435.5	186.1	395.8	57.6	4.5	4.2	19 V $\overline{\text{---}}$ 2.0 A

*Image may vary depending on model.