

## Charging the Unit

Before using it, charge the battery by connecting the AC Adapter.  
(Secondary unit only)

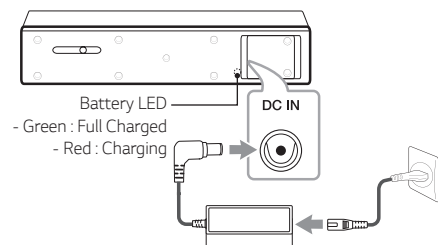

## Remote control



: Turns down the volume at night.

**REAR LEVEL +/-:** Adjusts rear level of Secondary unit on the REAR usage mode.

**SURROUND:** Turns on/off Surround function.

**AV SYNC:** Synchronizes the audio and video.

**AUTO VOL:** Automatically adjusts too loud or low output volume level appropriately.

**AUTO POWER:** Automatically turns on by an input source.

## Replacement of battery

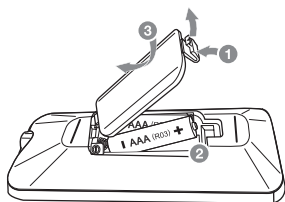

## Additional Information

### Specification

Power consumption	Refer to the main label.
AC adapter	<ul style="list-style-type: none"><li>Model : DA-38A25</li><li>Manufacturer : Asian Power Devices Inc.</li><li>Input : 100 - 240 V ~ 50 - 60 Hz 1.2 A</li><li>Output : 25 V  1.52 A</li></ul>
Dimensions (W x H x D)	Approx. 340 mm x 74 mm x 110 mm With foot (In each of Primary unit and Secondary unit)
Amplifier (Total RMS Output power)	320 W RMS (In state of connecting AC Adapter).
Operating time (Battery)	Approx. 4 hours (Varies by volume level and audio content.)

Design and specifications are subject to change without notice.

### OPEN SOURCE SOFTWARE NOTICE INFORMATION

To obtain the source code under GPL, LGPL, MPL, and other open source licenses, that is contained in this product, please visit <http://opensource.lge.com>.

In addition to the source code, all referred license terms, warranty disclaimers and copyright notices are available for download.

LG Electronics will also provide open source code to you on CD-ROM for a charge covering the cost of performing such distribution (such as the cost of media, shipping and handling) upon email request to [opensource@lge.com](mailto:opensource@lge.com). This offer is valid for three (3) years from the date on which you purchased the product.



## SIMPLE MANUAL

# Wireless Sound Bar

Please read this manual carefully before operating your set and retain it for future reference.

To view the instructions of advanced features, visit <http://www.lg.com> and then download Owner's Manual. Some of the content in this manual may differ from your unit.

### MODELS

SJ7

SJ7-C



\* M F L 6 9 7 8 3 4 1 3 \*



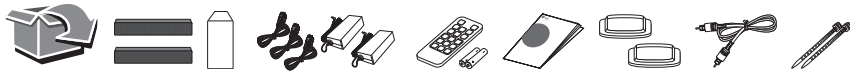

## Front/Side Panel

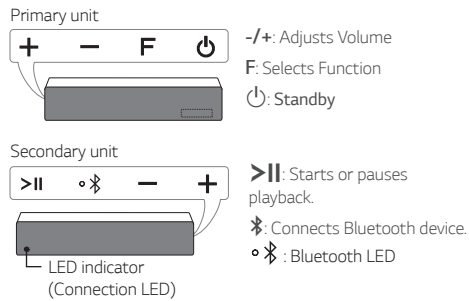

## TV Connection

Connect with the Sound Bar and TV using Optical or HDMI ARC.

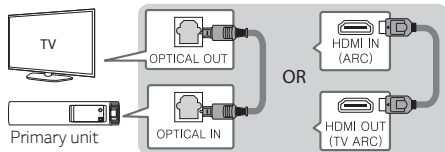

- 1 Connect the sound bar to the TV using Optical or HDMI cable.
- 2 Set up [External Speaker (Optical)] or [External Speaker (HDMI ARC)] on your TV setting menu.



- HDMI connection is unavailable if your TV does not support HDMI ARC.
- If this unit is connected by OPTICAL and ARC at the same time, the ARC signal is a high priority.

## Additional Device Connection

- 1 Connect to the external device. It is recommended to connect as follows.

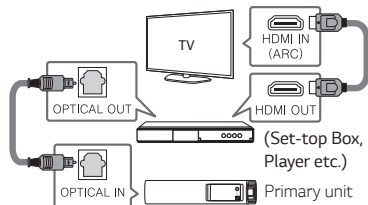

- 2 Set the input source by pressing F on the remote control or unit repeatedly.

## Speaker Connection

You can use speaker connection in the SOUND BAR or REAR usage mode only.

### Secondary unit connection

Place the Secondary unit near the Primary unit and follow steps below.

- 1 Connect the power cord of Secondary unit and Primary unit to the outlet.
- 2 Turn on the Primary unit by pressing ⏻. Turn on the Secondary unit by switching the Usage Mode Switch to REAR or SOUND BAR.

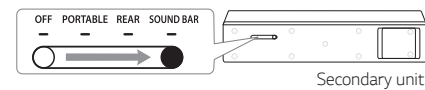

The Primary unit and Secondary unit will be **automatically** connected. The Secondary unit's white LED turns on.

### Secondary unit Connection Manually

If the Secondary unit does not make sound, try to connect manually.

- 1 Turn off the Primary unit.
- 2 Press **PAIRING** button on the rear of the Secondary unit. The white LED on the front of Secondary unit blinks.
- 3 Turn on the Primary unit.
- 4 Pairing is completed. The white LED on the front of Secondary unit turns on.

### Subwoofer connection

Place the wireless subwoofer near the speaker and follow steps below.

- 1 Connect the power cord of wireless subwoofer and sound bar to the outlet.
- 2 Turn on the Primary unit. : The sound bar and wireless subwoofer will be **automatically** connected. The subwoofer's green LED turns on.

### Subwoofer Connection Manually

If the subwoofer does not make sound, try to connect manually.

- 1 Press **Pairing** button on the rear of the wireless subwoofer. The green LED blinks quickly.
- 2 Turn on the Primary unit.
- 3 Pairing is completed. The green LED turns on.

## Positioning the Unit

### SOUND BAR usage mode

Primary unit and Secondary unit play as FRONT L/ R(Left/Right) speaker like a sound bar.

Turn on the Primary unit by pressing ⏻.

Turn on the Secondary unit by switching the Usage Mode Switch to SOUND BAR.

When disconnecting AC Adapter of Secondary unit, the audio output may be reduced.

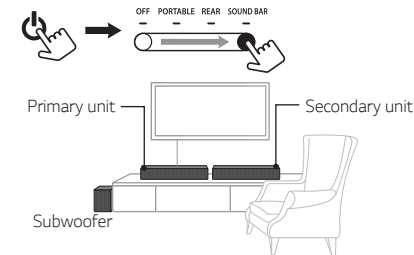

### REAR usage mode

Primary unit plays as front speaker and Secondary unit plays as rear surround speaker.

Turn on the Primary unit by pressing ⏻.

Turn on the Secondary unit by switching the Usage Mode Switch to REAR.

When disconnecting AC Adapter of Secondary unit, the audio output may be reduced.

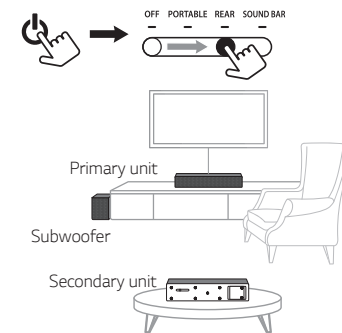

### PORTABLE usage mode

You can play Secondary unit without Primary unit.

**Primary unit and Secondary unit play separately with each connected device.**

Turn on the Secondary unit by switching the Usage Mode Switch to PORTABLE.

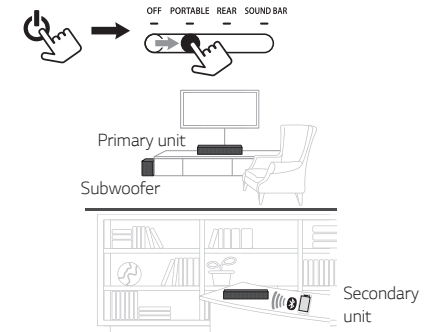

### BLUETOOTH Connection (Secondary unit)

Select LG SJ7-2ND (xx) from device list to pair your mobile device.

When successfully Paired, Bluetooth LED turns on white with beep sound.

### BLUETOOTH Connection (Primary unit)

- 1 Press F button to select the BT (Bluetooth) Function.
- 2 Select LG SJ7 (xx) from device list to pair your mobile device. When successfully Paired, "PAIRED" Your device's name "BT" appears in the display window in this order.

### OFF usage mode

Primary unit plays alone without Secondary unit

Turn on the Primary unit by pressing ⏻.

Turn on the Secondary unit by switching the Usage Mode Switch to OFF.

