

USER GUIDE

LM-W315

Copyright ©2018 LG Electronics Inc. All rights reserved.

MFL71160701 (1.1)



www.lg.com

About this user guide

Thank you for choosing this LG product. Please carefully read this user guide before using the device for the first time to ensure safe and proper use.

- Always use genuine LG accessories. The supplied items are designed only for this device and may not be compatible with other devices.
- This device is not suitable for people who have a visual impairment due to the touchscreen keyboard.
- Descriptions are based on the device default settings.
- Default apps on the device are subject to updates, and support for these apps may be withdrawn without prior notice. If you have any questions about an app provided with the device, please contact a LG Service Center. For user-installed apps, please contact the relevant service provider.
- Modifying the device's operating system or installing software from unofficial sources may damage the device and lead to data corruption or data loss. Such actions will violate your LG licence agreement and void your warranty.
- Some content and illustrations may differ from your device, depending on the area, service provider, software version, or OS version, and are subject to change without prior notice.
- Software, audio, wallpaper, images, and other media supplied with your device are licenced for limited use. If you extract and use these materials for commercial or other purposes, you may be infringing copyright laws. As a user, you are fully responsible for the illegal use of media.
- Additional charges may incur for data services, such as messaging, uploading, downloading, auto-syncing and location services. To avoid additional charges, select a data plan suitable to your needs. Contact your service provider to obtain additional details.

Instructional notices



WARNING: Situations that could cause injury to the user and third parties.



CAUTION: Situations that may cause minor injury or damage to the device.



NOTE: Notices or additional information.

Table of contents

01

Basic Functions

- 6 Accessories
- 7 Watch Overview
- 10 Get ready for snap-and-swap
- 12 Charging Your Watch
- 15 Using the battery efficiently
- 16 If the Screen Freezes
- 16 Turning the Watch On and Off
- 17 Waking Your Watch Up
- 17 Dimming the Screen
- 17 Using the Touch Screen

02

Connecting the Watch to Your Companion Device

- 21 Setting Up Your Companion Device
- 22 Pairing Your Watch with Your Companion Device
- 23 Connecting to Another Companion Device

03

How to Use Your Watch

- 25 Watch Face Home Screen
- 25 Changing the Watch Face
- 27 Notification Cards
- 28 Managing the Quick Settings
- 29 JustWatch
- 30 Sending a Text
- 30 Apps Screen
- 31 Master Tools
- 35 Google Fit
- 38 Opening the Apps Installed On Your Watch
- 39 Downloading Other Apps

04

Tasks Using Voice Command

- 41 Getting help from your Google Assistant on Your Watch
- 41 Setting a Reminder
- 42 Checking Your Step Count
- 42 Sending a Text
- 43 Setting a Timer
- 44 Using the Stopwatch
- 44 Setting an Alarm
- 44 Managing Your Alarms

05

Settings

- 46 Opening the Settings Menu
- 46 Display
- 47 Apps & notifications
- 47 Gestures
- 48 Connectivity
- 50 Accessibility
- 50 Personalization
- 50 Storage
- 51 System

06

More Information

- 53 Open Source Software Notice Information
- 53 Trademarks
- 54 Regulatory information (Regulation ID number, E-labeling, etc.)
- 54 How to Update Your Device

07

Safety Information

- 56 Safety tips
- 57 General safety & handling



01

Basic Functions

Accessories

The following accessories are provided with your device.





- Device
- Quick Start Guide
- Charging cradle
- Charger
- USB cable



- The items supplied with the device and any available accessories may vary depending on the region or service provider.
- Always use genuine LG Electronics accessories. Using accessories made by other manufacturers may affect your device's call performance or cause malfunctions. Any issues resulting from usage of accessories made by other manufacturers may not be covered by LG's repair service.
- The accessories are not water-resistant. Do not expose these items to water.



- If any of these basic items are missing, contact the dealer from which you purchased your device.
- To purchase additional basic items, contact the LG Customer Support Center.
- To purchase optional items, contact the LG Customer Support Center for available dealers, and then purchase online.
- Some items in the product box are subject to change without notice.
- The appearance and specifications of your device are subject to change without notice.

	For indoor use only
	Direct current
	Class II equipment
	Energy Efficiency Level Mark

Watch Overview

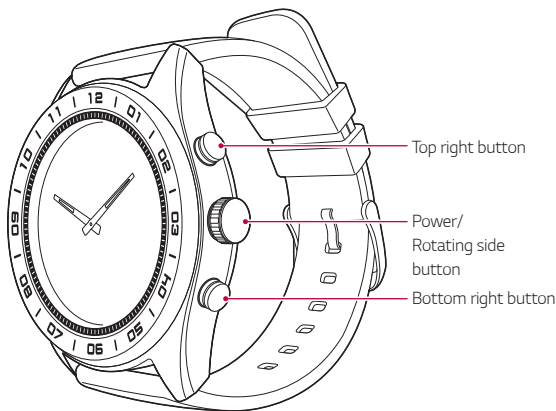

Power/Rotating side button

To turn the watch on:

- Press and hold for one second to turn the screen on. If it doesn't turn on, press and hold for a few seconds until the LG logo appears.

When the screen is dimmed:

- Press once to wake the screen.

When the screen is on:

- Press to open the Apps screen when you are on the watch face home screen.
- Press to return to the home screen when you are on any other screen.
- Press and hold for one second to get help from your Google Assistant.

When the screen is off:

- Press once to wake the screen.

Power/Rotating side button	<p>Rotating the Power/Rotating side button:</p> <ul style="list-style-type: none"> • Rotate to browse the apps list on the Apps screen. • Rotate to show or hide notifications in the watch face home screen. <p>If the screen freezes:</p> <ul style="list-style-type: none"> • Press and hold until the LG logo appears to restart the watch.
Top right button	<p>Press and hold to start Snap View when the screen is on.</p>
Bottom right button	<p>When the screen is on:</p> <ul style="list-style-type: none"> • Press once to open Master Tools. • Press and hold to use JustWatch. <p>When the screen is off:</p> <ul style="list-style-type: none"> • Press once to wake the screen.



- See *Master Tools* for details.
- See *JustWatch* for details.

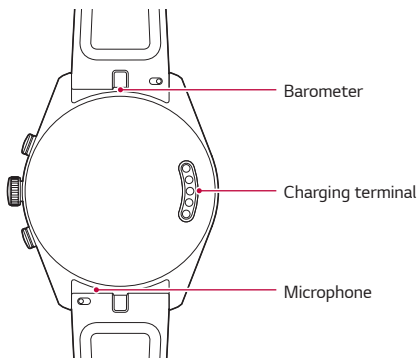

- Any damage to the barometer or microphone resulting from accidents, unreasonable use, tampering or other causes not arising from defects in material or workmanship may void the Limited Warranty.



- If water enters any hole on the device, some features may not work properly. In this case, dry the device thoroughly before using it again.
- Keep the holes clear.
- If your device receives impact or moves severely, the hour and minute hands may move slightly. Note that this is a designed performance.
- The hour and minute hands may move if you drop the device or subject it to severe impact. In this case, calibrate the hour and minute hands.

Get ready for snap-and-swap

Switch styles anytime with MODE™ snap-and-swap watch bands.

1

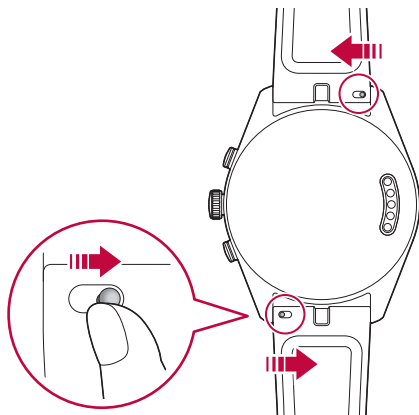

2

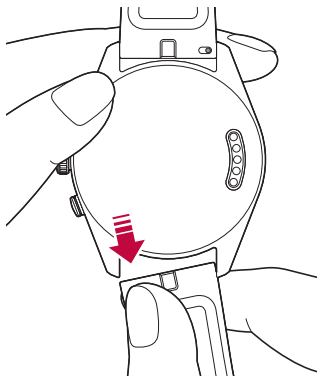



- The LG limited warranty does not cover the use of third party bands.

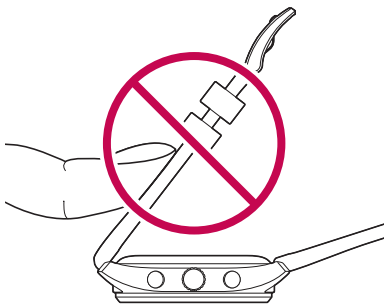

- Excessive force may cause breakage of the watch band.

Charging Your Watch

Before using your watch for the first time, you should charge the battery. Use the charging cradle provided with your watch to charge its battery.

The supplied charging cable will allow you to charge from a power outlet or from a computer.



- When the battery power is low, the battery icon may show as empty. If the battery is completely discharged, the watch cannot be turned on immediately after connecting the charger. Allow the empty battery to charge for a few minutes before turning the device on. Some features are not available while the battery is charging.



- To charge your device, always use the power adapter and charging cradle that come with your device. Using third-party charging accessories can cause fire, electric shock, injury, or damage to your device or other property.

Do NOT attempt to remove the back cover.

- This device has a non-removable battery. Do not attempt to remove the back cover. Doing so may severely damage the battery and device, which could cause overheating, fire, and injury.

- 1 Connect the USB plug on the charging cradle to the charger adapter.
- 2 Plug the charger adapter into a power outlet.

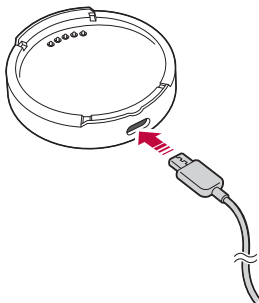

- 3 Place your device on the charging cradle as shown below.

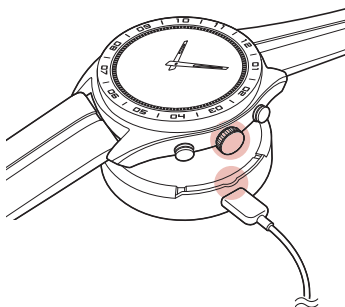

- 4 Press down the device on the charging cradle until you hear the "click" sound.

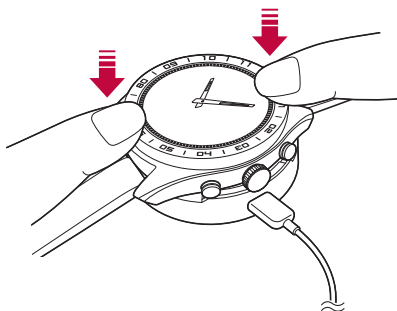



- The charging cradle is designed to only be used with the watch and is not compatible with other devices.
- To maximize battery life, make sure that the battery is fully charged before you use the device for the first time.
- Exposure to liquids or other foreign materials while using your device may affect the charging cradle, causing it to disconnect from the watch while charging.
- If the charging screen does not appear after connecting to a power source, adjust your device's position on the charging cradle.
- Do not charge while the device, charging cradle or charging cable is wet or contains moisture. This can cause fire, electric shock, injury or damage to device.

5 While your watch is charging, the screen will show the time, battery percentage and charging progress (indicated by the ring around the edge).

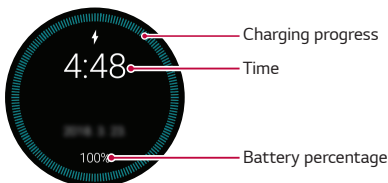

6 Once the battery is fully charged, remove it from the charging cradle.



- The watch may become warm while charging. If the device becomes hotter than usual, discontinue charging until it cools.

Using the battery efficiently

To minimize battery consumption, follow these tips.

- Turn off the Always-on screen option when not using your watch for a long time.
- Minimize the screen brightness.
- Turn off the Wi-Fi network function when not using Wi-Fi.
- Turn off the Gestures feature.
- If you get notifications on your companion device that you don't want to see on your watch, go to the notification settings of the Wear OS by Google™ app on your companion device and add those apps to **Filter watch notifications**.
- If you feel the battery life is shortened after installing a specific app, try to uninstall it.



- Battery Saver is automatically enabled at the 15% battery capacity on your watch. In the Battery Saver mode, the ambient display and Wi-Fi are set to off.

If the Screen Freezes

If the device freezes up and stops working, press and hold **Power/Rotating side button** until the device reboots and the LG logo appears.

Turning the Watch On and Off

Turning the Watch On

Press and hold **Power/Rotating side button** for a few seconds.

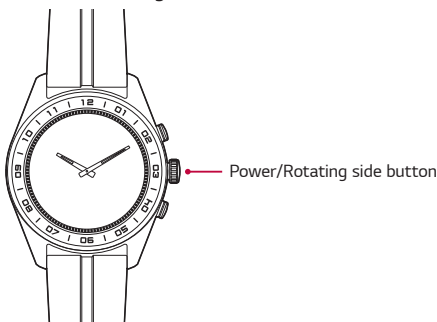

Turning the Watch Off

- 1 Press **Power/Rotating side button** to open the Apps screen.
- 2 Tap **Settings > System > Power off**.
- 3 When prompted with the message **Power off: Are you sure?**, tap .

Waking Your Watch Up

If the screen is dimmed or off, you can wake up the watch by doing one of the followings:

- Touch the screen.
- Raise your wrist such that the display of the watch is pointing towards your eyes.
- Press **Power/Rotating side button** on the watch.

Dimming the Screen

Cover the screen with your palm until it vibrates.

Using the Touch Screen

You can familiarize yourself with how to control your device by using touch screen gestures.

Tapping

Lightly tap with your fingertip to select or run an app or option.

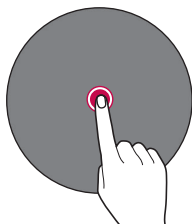

Touching and holding

Touch and hold for several seconds to display the available options.

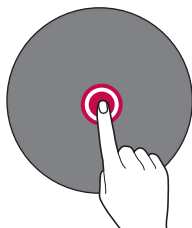

Swiping

Quickly move your finger across the surface of the screen, without pausing when you first touch it.

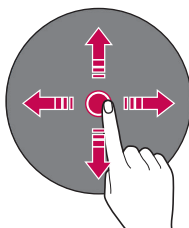

- Do not expose the touch screen to excessive physical shock. It might damage the touch sensor.



- A touch screen failure may occur if you use the device near a magnetic, metallic or conductive material.
- If you use the device under bright lights, such as direct sunlight, the screen may not be visible, depending on your position. Use the device in a shady location or a location with an ambient light that is not too bright and bright enough to read books.
- Do not press the screen with excessive force.
- Touch control may not work properly if you tap while wearing a glove on or by using the tip of your fingernail.
- The touch screen may not function properly if a screen-protective film or accessory is attached to the device.
- Do not display non-moving images for an extended period. This may cause image burn-in on the screen.
- Applications that show the same screen for more than 10 minutes are not recommended because they may cause screen damage that is not covered by the warranty.



02

Connecting the Watch to Your Companion Device

Setting Up Your Companion Device

Before pairing, follow these steps to set up your companion device that you want to pair with your watch.

- 1 Make sure the companion device is running Android™ 4.4+ or iOS 9.3+ and supports **Bluetooth®**.
 - If your companion device is not Android 4.4+ or iOS 9.3+, please check with your manufacturer for a possible software update.
- 2 Make sure your companion device supports Wear OS by Google.
 - To find out, visit <http://g.co/WearCheck> from your companion device.
- 3 Turn on Bluetooth on your companion device if it isn't already on.
- 4 Make sure your companion device is next to your watch.
- 5 On your companion device, download the Wear OS by Google app from **Play Store** or **App Store** and install it. If Wear OS by Google is already on your companion device, make sure you have the most recent version.
- 6 Make sure your companion device is connected to mobile data or a Wi-Fi network. You need a data connection to set up your watch for the first time.



- Depending on the network connection, the setup process might take over 20 minutes.

Pairing Your Watch with Your Companion Device

Step 1. Follow these steps on your watch.

- 1 Turn on the watch and tap the screen to begin.
- 2 Tap a language.
- 3 Swipe up and follow the onscreen instructions until the watch name is displayed.

Step 2. Follow these steps on your companion device.

- 1 Open the Wear OS by Google app on your companion device.
- 2 On your companion device, you'll see a list of nearby devices. Tap your watch's name.
- 3 You'll see a passkey on your companion device and watch. Check that the codes match.
- 4 Tap **PAIR** on your companion device to start pairing.

Step 3. Follow these steps to pair your watch with your companion device.

- 1 You'll see a confirmation message on your watch once it is paired. This may take a few minutes.
- 2 Follow the onscreen instructions to complete the initial setup.
- 3 When your watch completes the connection with your companion device, you'll be asked to copy your Google accounts on your companion device to your watch.



- Copying a Google account to your watch allows you to download new apps using Play Store.
- Once initial setup is complete, you will see a tutorial notification . Follow the tutorial notices before using your watch.

Connecting to Another Companion Device

Your watch connects to one mobile device at a time. If you want to connect your watch to a different device, you must reset your watch using the **Disconnect & reset** setting on your watch.

Unpairing and Resetting Your Watch

This setting unpairs the watch from your companion device and resets your watch's settings to their factory default values and deletes all of your data.

- 1 Press **Power/Rotating side button** to open the Apps screen.
- 2 Tap **Settings > System > Disconnect & reset**.
- 3 When prompted, tap  to confirm.
- 4 Connect your watch to another device.



- Performing a factory reset erases all data from your watch's memory and all watch data from your companion device. After resetting, your watch is ready to connect to another companion device.



03

How to Use Your Watch

Watch Face Home Screen

The watch face home screen is the starting point for the default screen. You see the current time and date. You can also check the battery level, and more.



- The displayed content may vary depending on the watch face design you select.

Changing the Watch Face

You can add more watch faces and personalize your watch.

- Touch and hold the watch face home screen, swipe left to go to the last screen, then tap **See more watch faces** .
- Tap the desired watch face to add it to your favorites.
- After adding your favorites, swipe the screen right or left to browse available designs, then tap the one you want to use.

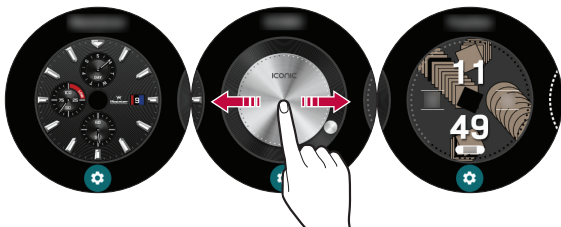



- You can also change and download watch faces through the Wear OS by Google app on your companion device.

Customizing the Watch Face Home Screen Menu

- 1 Touch and hold the watch face home screen for one second, then tap  at the bottom of the screen.



Customize

- 2 You can customize the watch face layout.

Notification Cards

Most notifications you see on your companion device will also show up on your watch. These include notifications for texts, event reminders, and more.

Notifications are displayed in the form of cards. Card previews appear at the bottom of the watch face home screen.

- To see a notification card, swipe the watch face upwards.
- To see more cards, keep swiping up from the bottom of the screen.
- To get more details, tap the notification card.



Notification cards

Swipe up to view more notifications.

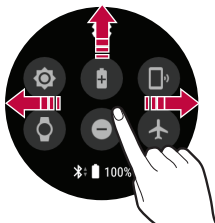

To remove a notification, swipe left or right.

Blocking Notifications





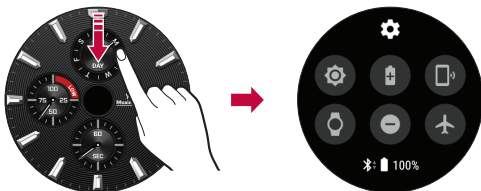

If you get notifications on your companion device that you don't want to see on your watch, you can stop specific apps from showing their notifications on your watch.

- 1 On your companion device, open the Wear OS by Google app.
- 2 Tap **Notifications** > **Filter watch notifications** > **Add more**.
- 3 Select the app you want to block.

Managing the Quick Settings

To open the Quick settings, swipe down on the watch face home screen. The Quick settings allow you to quickly and easily change commonly used settings.



-  : Open the Settings app.
-  : Set the brightness level.
-  : Turn on Battery saver.
-  : Find the connected device.
-  : Turn off your watch's screen. When the theater mode is turned on, your watch's display does not light up and notifications do not appear.
-  : Your watch will not show any notifications and alerts while this setting is turned on.
-  : Disconnect all networks and turn off your device's connectivity on your watch.



- Some content may differ from your companion device depending on the OS version.

JustWatch

You can use the device as a watch only. In the device, you can turn off all features including Wear OS by Google, watch face home screen, call, messaging, and mobile network to reduce battery consumption.

Activating the JustWatch mode

- 1 Press and hold **Bottom right button** on the watch face home screen.
Or
On the settings screen, tap **System > JustWatch > JustWatch**.
 - The duration for which you can use the device in the JustWatch mode appears on the top of the screen.
- 2 Tap  on the bottom of the screen.
 - It turns off Wear OS by Google, and you can use the device as a watch.

Deactivating the JustWatch mode

To turn on all the features including Wear OS by Google, press and hold **Power/Rotating side button**.

The device turns on and automatically pairs with the mobile device.

Sending a Text

You can ask your Google Assistant to send text messages using your watch.

You can also reply to any text message cards that you receive on your watch.

Apps Screen

The Apps screen displays icons for all apps.

- From the watch face home screen, press **Power/Rotating side button** to open the Apps screen.
- To open an app on the Apps screen, tap the app icon.



- To set the favorite app, touch and hold an app. Then, the selected app will appear at the top of the apps list.

Master Tools

You can use various functions.

From the home screen, press **Bottom right button** to open **Master Tools**, then tap a desired option.

Compass

Use the compass function to measure the direction.

- Follow the on-screen instructions to calibrate the compass.



- Calibrate the compass in a place where the magnetic field cannot affect the device, or outdoor. If there are objects to affect the magnetic field including metals or rebar, or if you are inside the building, you may not calibrate the compass properly.
- In case that the compass is not calibrated properly, make sure that there are no objects or materials to affect the magnetic field, and then swipe the compass upwards to calibrate again.

Stopwatch

You can use the stopwatch to record a lap time.

- Press **Top right button** to initiate or suspend the stopwatch.
- Press **Bottom right button** to record a lap time or reset.



Timer

You can set the timer to trigger an alarm after a specified period of time.

- Tap the desired time to start.
- To suspend or resume the timer, press **Top right button**. To cancel the timer, press **Bottom right button**.



Calibration

To synchronize the time perfectly between your device and the mobile device, calibrate the hour hand and the minute hand. Align each hand to the red dot on the top of the screen, then tap ✓.

- To move the hour hand, tap **Top right button**, then tap - or + to align the hour hand to the red dot on the top of the screen.
- To move the minute hand, tap **Bottom right button**, then tap - or + to align the minute hand to the red dot on the top of the screen.



Barometer

You can check the atmospheric pressure in the current location.



- The screen displays the current atmospheric pressure and temperature.
- You can set the unit of the atmospheric pressure and temperature by swiping the screen upwards.
- This feature is available only when the GPS feature is activated on your mobile device.

Altimeter

You can check altitude in the current location.



- The screen displays the current altitude and temperature.
- You can set the unit of the altitude and temperature by swiping the screen upwards.
- This feature is available when the Location feature is activated on your mobile device.
- This feature is provided for your convenience only.

Google Fit

Google Fit helps to work out when you're walking, jogging or cycling. Set fitness goals, and regularly record and check your progress.

To Open the Google Fit App

Open the Apps screen and tap **Fit**.



- If you feel discomfort while using the device, stop using it and remove it from your wrist.
- If your device becomes hot to the touch, please remove it until it cools.

Using the Google Fit App

Setting up your goal

- 1 Open the **Fit** app to personalize your goal.
- 2 Swipe up and tap **Settings > Activity goals**  to set one of the preset goals.

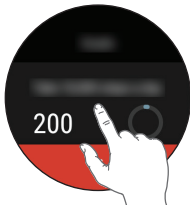

Viewing your workout report



Your workout log displays your active time, steps, distance, and active calories.

- 1 Open the **Fit** app and swipe down until the workout report appears.
- 2 Tap each goal option to view workout information and a graph depicting weekly data.



Using the Fit Workout App

Open the Fit Workout app

- 1 Open the Apps screen and tap **Fit Workout**.
OR
Open the Fit app, swipe up and tap **Workouts**.
- 2 Tap the desired workout mode.
- 3 Tap **START** to start monitoring your workout.
 - Tap  to pause or  to resume the workout.
 - Tap  to save and exit your workout and view your workout report.



- The control icons may vary depending on the workout mode selected.

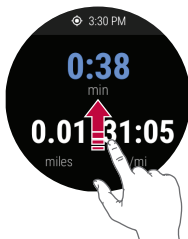

Opening the Apps Installed On Your Watch

The apps list shows you all of the applications installed on the watch.

Swipe up and down to scroll through the list, then tap the one you want to use. The most recently used app is displayed at the top of the circle.



- Default apps on the device are subject to updates. Support for these apps may be withdrawn without prior notice. If you have any questions about an app provided with the device, please contact an LG Service Center. For user-installed apps, please contact the relevant service provider.
- Modifying the device's operating system or installing software from unofficial sources may damage the device and lead to data corruption or loss. Such actions will violate your LG license agreement and void your warranty.

Viewing the Apps List

- 1 If your screen is dimmed, tap the screen to wake up the watch.
- 2 Press **Power/Rotating side button** to open the Apps screen.

Downloading Other Apps

After adding a Google account on your companion device to your watch, you can download more apps on Google Play™ Store.

To use the same apps which are already installed on your companion device, download them again on your watch. You can download them easily via the 'Apps on your phone' category on Google Play™ Store.



- The apps on your device, and their functions, may vary according to country, region or hardware specifications. LG will not be responsible for any performance issues which arise from using applications developed by providers other than LG.
- LG will not be responsible for performance or incompatibility issues which arise from edited registry settings or modified operating system software.
- Any attempt to customize your operating system may lead to the device or its apps not working correctly.
- Software, audio, wallpaper, images, and other media supplied with your device are licensed for limited use. If you extract and use these materials for commercial or other purposes, you may be infringing copyright laws. As a user, you are entirely responsible for the illegal use of media.
- Additional charges may apply for data services, such as messaging, uploading, downloading, auto-syncing and location services. To avoid additional charges, select a data plan suitable to your needs. Contact your service provider for details.
- This content is not supported in iOS version.



04

Tasks Using Voice Command

Getting help from your Google Assistant on Your Watch

Your watch has Google Assistant built in. Ask it questions. Tell it to do things. It's your own personal Google. Just say **"OK Google"** or press and hold **Power/Rotating side button**, then say a command when prompted.



- To get help from your Google Assistant, a data or Wi-Fi connection is required on your companion device, and the devices must be within Bluetooth range.
- This feature may vary or may not be supported, depending on the area, languages, or paired devices.
- To use this function, tap **Settings > Personalization** and enable **"Ok Google" detection**.

Setting a Reminder

You can ask your Google Assistant to set a reminder. When a reminder is set, a card will appear at the reminder time.

- 1 If your screen is dimmed, tap the screen to wake up the watch.
- 2 From the watch face home screen, say **"OK Google"** or press and hold **Power/Rotating side button**.
- 3 Say **"Remind me"**.
- 4 Complete your reminder when prompted. Your reminder will automatically be saved after a few seconds (tap  before it finishes saving to cancel it.)

Checking Your Step Count



You can view your step count goal, the number of steps you have taken today and each day over the last week, as measured by the Fit app.

- 1 If your screen is dimmed, tap the screen to wake up the watch.
- 2 From the watch face home screen, say **"OK Google"** or press and hold **Power/Rotating side button**.
- 3 Say **"Show me my steps"**. You will see your daily step count information.

Sending a Text

You can ask your Google Voice to send text messages using your watch. You can also reply to any text message cards that you receive on your watch.

Sending a Message

- 1 If your screen is dimmed, tap the screen to wake up the watch.
- 2 From the watch face home screen, say **"OK Google"** or press and hold **Power/Rotating side button**.
- 3 Say **"Send a text"**.
- 4 **To whom?** will appear. Say the name of the contact you want to send a text message to. You can also say a mobile phone number for numbers not saved in your companion device's Contacts list.
- 5 You will be prompted to say the message you want to send. Say your message.
- 6 Tap  to send the text message (tap  to cancel it).

Replying to a Message

When you get message notifications on your companion device, cards will appear on your watch. Tap the notification and swipe up until **Reply** appears. Tap **Reply**, then say your message or insert emoticons or input message using the keyboard. To insert an emoticon, like a smiley, into the message, tap 😊.



• This content is not supported in iOS version.

Setting a Timer

You can ask your Google Assistant to set a timer. Once a timer is set, a card is displayed with the countdown.

- 1 If your screen is dimmed, tap the screen to wake up the watch.
- 2 From the watch face home screen, say "**OK Google**" or press and hold **Power/Rotating side button**.
- 3 Say "**Set a timer**".

Using the Stopwatch

Measure how much time has passed by starting a stopwatch.

- 1 If your screen is dimmed, tap the screen to wake up the watch.
- 2 From the watch face home screen, say **"OK Google"** or press and hold **Power/Rotating side button**.
- 3 Say **"Start stopwatch"**.
- 4 Press **Top right button** to start.

Setting an Alarm

Multiple alarms can be set on your watch separately from alarms set on your companion device. Alarms set on your watch will not be transferred to your companion device, but alarms activated on your companion device will display an alarm card (with vibration and sound, if set) on your watch.

- 1 If your screen is dimmed, tap the screen to wake up the watch.
- 2 From the watch face home screen, say **"OK Google"** or press and hold **Power/Rotating side button**.
- 3 Say **"Set an alarm"**.

Managing Your Alarms

You can view, edit, and delete the alarms that you set on your watch.

- 1 If your screen is dimmed, tap the screen to wake up the watch.
- 2 From the watch face home screen, say **"OK Google"** or press and hold the **Power/Rotating side button**.
- 3 Say **"Show alarms"**.



- Tap next to an alarm to edit, or tap to delete.
- Tap to manually set an alarm.



05

Settings

Opening the Settings Menu

If your screen is dimmed, tap the screen to wake up the watch.

- Press **Power/Rotating side button** to open the Apps screen, then tap **Settings** ⚙️.

OR

Swipe down on the watch face home screen, then tap **Settings** ⚙️.



- Tap a setting option to turn it on or off, open a list of choices, or view information.

Display

From **Settings** ⚙️, tap **Display**.

- **Change watch face:** You can set the watch's face. See *Watch Face Home Screen* for details.
- **Adjust brightness:** You can set the level of brightness for your watch's display.
- **Font size:** You can set the size of the font displayed on your watch's screen.
- **Always-on screen:** When you're not using the watch, the screen can either turn off or on, depending on your settings.
- **Touch lock:** You can set the lock of the touch screen. To unlock the touch screen, press **Power/Rotating side button**.

Apps & notifications

From **Settings** , tap **Apps & notifications**.

- **App info:** You can see information about installed apps.
- **App notifications:** You can set how app alerts are sent.
- **App permissions:** You can check permission settings of installed apps.
- **Notification previews:** You can enable, disable or customize notification previews.
- **Override Do Not Disturb for...:** Select apps to receive notifications in the Do Not Disturb mode.
- **Vibration pattern:** Select the vibration pattern.

Gestures

From **Settings** , tap **Gestures**.

- **Tilt-to-wake:** You can set to tilt your watch to turn on the screen.
- **Touch-to-wake:** You can set to touch your watch to turn on the screen.
- **Wrist gestures:** You can set to flick your wrist to browse the screen.
- **Launch tutorial:** View a tutorial about using gestures on your watch.
- **More tips:** Opens a webpage on your companion device to help you with more tips for gestures.

Connectivity

From **Settings** , tap **Connectivity**.

Bluetooth

- **Bluetooth:** Tap the switch to toggle it On or Off. On allows you to pair and connect with other Bluetooth devices.
- **Available devices:** Displays all of the Bluetooth devices that are within your companion device's range. Tap one to pair and connect.



- When using Bluetooth to connect to other mobile devices, the devices must be positioned close to each other. If not, it may cause abnormal operation or noise, depending on the surrounding conditions.
- In an open space, the Bluetooth communication range usually spans approximately 10m. This range may vary depending on the surrounding conditions.
- Do not place obstacles between your product and connected devices. Outgoing/incoming signals can be weakened due to user's body, walls, corners or obstacles. Use where there is no obstacle.
- Only Bluetooth devices that support the A2DP and HFP profile are supported.

Wi-Fi

- **Wi-Fi:** Tap the switch to toggle it On or Off. On connects to a Wi-Fi network (from your list of available, detected networks).
- **Add network:** Allows you to manually add a Wi-Fi network by entering its name (SSID), security, and password.
- **Saved networks:** Displays your saved Wi-Fi networks allowing you to manage them.
- **About Wi-Fi:** Help appears when the product is using a Wi-Fi network.



- When using a Wi-Fi connection, your watch can get notifications from your device even if Bluetooth is unavailable.
- Your watch will search and connect to the nearest Wi-Fi network based on the Wi-Fi list registered on your device.

Airplane mode

Tap the switch to toggle it On or Off. When Airplane mode is on, you can still use many of the features on your watch on an airplane or anywhere else where sending or receiving data is prohibited.



- Turning on Airplane mode on your watch does not activate it on your companion device. If you want to activate Airplane mode on your companion device, you'll need to turn it on separately.

Location

Tap the switch to toggle it On or Off. You can manage your location services for determining your approximate location. Some apps like Weather and Maps need your location to work.



- When paired with a companion device, the watch will use the location of the companion device. To improve location accuracy when paired with a device, turn on High accuracy in your companion device's location settings.

Accessibility

From **Settings** , tap **Accessibility**.

- **Magnification gestures:** You can set to enable magnification to zoom in and out with triple tap.

Personalization

From **Settings** , tap **Personalization**.

- **Screen lock:** You can customize screen lock settings for your device.
 - **Pattern:** Draw a pattern to unlock the screen.
 - **PIN:** Enter a numeric password to unlock the screen.
 - **Password:** Enter an alphanumeric password to unlock the screen.
 - **None:** Deactivate the screen lock function.
- **Input methods:** You can customize keyboard settings for your device.
- **Accounts:** You can add or remove a Google account to your watch.
- **Customize hardware buttons:** You can customize the settings of **Bottom right button**.
- **Smart Reply:** You can use one of the suggestion sentences to reply to a message.
- **"Ok Google" detection:** Allows you to use "Ok Google."
- **Device administration:** Allows you to view and disable your device administrators.
- **Enable alternate launcher:** Allows you to use alternate launcher.

Storage

From the **Settings** , tap **Storage**. You can view and manage internal storage on the device.

System

From **Settings** , tap **System**.

- **Battery Saver:** Reduce battery consumption by cutting down some device settings.
- **JustWatch:** You can only use as a watch. All other features will be turned off to save battery life.
- **Date & time:** You can set the date, time and related settings for your watch.
- **Restart:** You can restart your device.
- **Power off:** You can turn off your device.
- **Disconnect & reset:** You can unpair the watch from your companion device and reset your watch's settings to their factory default values. Please note that this deletes all of your data on your watch.
- **About:** Displays the Model, Device name, Versions (for Google and Android software), Serial number, Build number, Connection, and Battery information. The following options are also available:
 - **System updates, Legal notices and Terms of Use for LG apps**
- **Regulatory information:** Displays the regulatory information.



06

More Information

Open Source Software Notice Information

To obtain the source code under GPL, LGPL, MPL, and other open source licenses, that is contained in this product, please visit <http://opensource.lge.com>.

In addition to the source code, all referred license terms, warranty disclaimers and copyright notices are available for download.

LG Electronics will also provide open source code to you on CD-ROM for a charge covering the cost of performing such distribution (such as the cost of media, shipping, and handling) upon email request to opensource@lge.com.

This offer is valid for a period of three years after our last shipment of this product. This offer is valid to anyone in receipt of this information.

Trademarks

- Copyright ©2018 LG Electronics Inc. All rights reserved. LG and the LG logo are registered trademarks of LG Group and its related entities.
- Bluetooth® is a registered trademark of Bluetooth SIG, Inc. worldwide.
- Wi-Fi® and the Wi-Fi logo are registered trademarks of the Wi-Fi Alliance.
- App Store is a registered trademark of Apple Inc.
- Google and Wear OS by Google are registered trademark of Google LLC.



Wear OS by Google

- All other trademarks and copyrights are the property of their respective owners.

Regulatory information (Regulation ID number, E-labeling, etc.)

For regulatory details, go to **Settings > System > Regulatory information**.

How to Update Your Device

Access to latest firmware releases, new software functions and improvements.

- Press the **Power/Rotating side button** and tap **Settings > System > About > System updates**.



07

Safety Information

Before turning on your product, review the basic safety information provided here.

Safety tips

To avoid damaging your product and reduce the risk of fire or electric shock, explosion, or other hazards, observe the following safety precautions:

- To charge your device, always use the included power adapter, USB cable, and charging cradle that come with your device. Using third-party charging solutions can cause fire, electric shock, injury, or damage to your device or other property.
- Available accessories may vary depending on your region, country or service provider.
- Some contents and illustrations may differ from your device depending on the region, service provider, software version, or OS version, and are subject to change without prior notice.
- Do not damage the power cord by bending, twisting, pulling, heating, or placing heavy items on it.
- This product is equipped with a charging cradle for connecting to a desktop or notebook computer or to the charger. Be sure your computer is properly grounded before connecting your product to the computer. The power supply cord of a desktop or notebook computer has an equipment-grounding conductor and a grounding plug. The plug must be plugged into an appropriate outlet that is properly installed and grounded in accordance with all local codes and ordinances.
- Do not open, disassemble, crush, bend or deform, puncture, or shred the product.
- Do not insert foreign objects into the product.
- Do not place the product in a microwave oven.
- Do not expose the product to fire, explosion, or other hazards.
- Like many electronic devices, your product generates heat during normal operation. Extremely prolonged, direct skin contact in the absence of adequate ventilation may result in discomfort or minor burns. Therefore, use care when handling your product during or immediately after operation.
- If you have a problem with using the product, please stop using it and consult with the authorized LG Electronics customer service center.

General safety & handling

While using your product, be aware of the following common-sense guidelines.

Your environment

- **Safe operating temperatures.** Use and store your product in temperatures between 0°C/32°F and 35°C/95°F. Exposing your product to extremely low or high temperatures may result in damage, malfunction, or even explosion.
- **While driving.** When driving a car, driving is your first responsibility. Using a mobile device or accessory for a call or other application while driving may cause distraction. Keep your eyes on the road.
- **Around explosives.** Do not use in areas where sparks from the product might cause a fire or explosion.
- **On airplanes.** Observe all rules and instructions for use of electronic devices. Most airlines allow electronic use only between and not during takeoffs and landings. There are three main types of airport security devices: X-ray machines (used on items placed on conveyor belts), magnetic detectors (used on people walking through security checks), and magnetic wands (hand-held devices used on people or individual items). You can pass your product through airport X-ray machines. But do not send it through airport magnetic detectors or expose it to magnetic wands.
- Always follow any special regulations in a given area. Turn your device off in areas where use is forbidden or when it may cause interference or danger.

Battery warnings

- Do not disassemble, open, crush, bend or deform, puncture or shred the device.
- Do not modify or re-manufacture the device, attempt to insert foreign objects into the battery, immerse or expose to water or other liquids, or expose to fire, explosion or other hazard.
- Make sure that no sharp-edged items such as animal's teeth or claws, come into contact with the battery. This could cause a fire.
- Only use the battery for the system for which it is specified.

- Use of an unqualified battery or charger may present a risk of fire, explosion, leakage, or other hazard.
- Do not short circuit a battery or allow metallic conductive objects to contact battery terminals.
- Battery usage by children should be supervised.
- Avoid dropping the device. If the device is dropped, especially on a hard surface, and the user suspects damage, take it to a service centre for inspection.
- Improper battery use may result in a fire, explosion or other hazard.
- Always unplug the charger from the wall socket after the product is fully charged to save unnecessary power consumption of the charger.
- Risk of explosion if battery is replaced by an incorrect type. Dispose of used batteries according to the instructions.

Embedded battery



Warning Notice for Battery replacement

- Do not remove the back cover.
- Your device has an internal battery. For your safety, do not remove the battery incorporated in the product. If you need to replace the battery, take it to the nearest authorized LG Electronics service point or dealer for assistance.
- The Li-Ion Battery is a hazardous component which can cause injury.
- Battery replacement by non-qualified professional can cause damage to your device.

Notes on Water Resistant Properties

This product is water and dust resistant in compliance with the Ingress Protection rating IP68.

Your product has undergone testing in a controlled environment and is proven to be water and dust resistant in certain circumstances (meets the requirements of classification IP68 as described by the international standard IEC 60529 - Degrees of Protection provided by Enclosures [IP Code]; test conditions: 15-35 °C, 86-106kPa, 1.5 meter, for 30 minutes). Do not expose the device in conditions that are different from the test conditions. Results may vary in actual use.



WARNING

Despite a rating of IP68, your device is not impervious to conditions not tested in LG's controlled environment. Please note that any damages that occur due to such causes changes the colour of the LDI (Liquid Damage Indicator). If the colour of LDI located inside the product changes, the product is to be considered ineligible for any free-of-charge repair services provided under the product's limited warranty. Avoid exposing the product to environments with excessive dust or moisture. Do not use the product in the following environments.



Do not immerse the product in any liquid chemicals (soap, etc.) other than water.



Do not immerse the product in salt water, including seawater.



Do not immerse the product in a hot spring.



Do not swim with this product.



Do not place the product directly on sand (such as at a beach) or mud.



Do not immerse your product in water deeper than approximately 1.5 meters.

Do not immerse your product in water for longer than 30 minutes.

- If your product becomes wet be sure to wipe the microphone and device with a dry cloth before use.
- Should your product or your hands become wet, dry them before handling the product.
- Do not use the product in places where it may be sprayed with high pressure water (e.g. near a faucet or shower head) or submerge it in water for extended periods of time, as the product is not designed to withstand high water pressure.
- This product is not resistant to shock. Do not drop the product or subject it to shock. Doing so might damage or deform the main unit, causing water leakage.
- The product's water and dust resistant features may be damaged by dropping or receiving an impact.
- If the product gets wet, use a clean, soft cloth to dry it thoroughly.
- The touch screen and other features may not work properly if the device is used while wet.



- Failure to follow the provided instructions may invalidate your device's limited warranty.

Pacemakers and other medical devices

Persons with pacemakers should:

- Keep the product more than six (6) inches from their pacemaker when the product is turned ON.
- Not carry the product in a breast pocket.
- Use the wrist opposite the pacemaker to minimize the potential for RF interference.
- Turn the product OFF immediately if there is any indication that interference is taking place.

If you use any other personal medical device, consult your physician or the manufacturer of your device to determine if it is adequately shielded from external RF energy.

Tips for using Bluetooth and Wi-Fi on your watch

- When connecting your product to other mobile devices, the devices must be positioned close to each other. If not, it may cause abnormal operation or noise, depending on the use environment.
- In an open space, the Bluetooth communication range usually spans approximately 10m. This range may vary depending on the use environment.
- Do not place obstacles between your product and connected devices. Outgoing/incoming signal can weaken due to user's body, walls, corners or obstacles. Use where there is no obstacle.
- When using a Wi-Fi connection, your watch can get notifications from your device even if Bluetooth is unavailable.
- Your watch will search and connect to the nearest Wi-Fi network based on the Wi-Fi list registered on your phone.

Tips for the display screen

- Do not display non-moving images for an extended period. This may cause image burn-in or stains on the screen.
- Applications that display the same screen for more than 10 minutes are not recommended because the potential screen damage is not covered by the warranty.

Specific Absorption Rate (SAR) Values

This product transmits and receives radio signals. It is designed and manufactured not to exceed the emission limits for exposure to Radio Frequency (RF) energy set by the Federal Communications Commission of the U.S. Government. These standards include a substantial safety margin designed to assure the safety of all persons, regardless of age and health. The exposure standard for wireless products employs a unit of measurement known as the Specific Absorption Rate, or SAR. In the United States and Canada, the SAR limit for wrist watch used by the public is 1.6 watts/kg (W/kg) averaged over one gram of tissue, or 4.0 watts/kg (W/kg) averaged over ten grams of tissue.

SAR tests are conducted using standard operating positions specified by the FCC, with the product transmitting at its highest certified power level in all tested frequency bands.

Although SAR is determined at the highest certified power level, the actual SAR level of the product during operation can be well below the maximum value.

Because the product is designed to operate at multiple power levels and to use only the power required to reach the network, in general, the closer you are to a wireless base station antenna, the lower the power output. The highest SAR value for device is

0.22 W/kg (1 g) when tested for use at next-to-mouth (face) level and 0.17 W/kg (10 g) for bodyworn (wrist) use.

While there may be differences between SAR levels of various devices and at various positions, they all meet the government requirement for safe exposure. The FCC has granted an Equipment Authorization for this product with all reported SAR levels evaluated, in compliance with the FCC RF emission guidelines. SAR information on this model product is on file with the FCC and can be found under the Display Grant section of <http://transition.fcc.gov/oet/ea/fccid/> after searching on FCC ID ZNFW315.

Additional information on Specific Absorption Rates (SAR) can be found on the Cellular Telecommunications Industry Association (CTIA) website at <http://www.ctia.org/>.

* Product meets current FCC Radio Frequency Exposure Guidelines.

FCC ID : ZNFW315

Part 15.19 Statement

This device complies with part 15 of the FCC Rules. Operation is subject to the following two conditions:

- (1) This device may not cause harmful interference.
- (2) This device must accept any interference received, including interference that may cause undesired operation.

Part 15.21 Statement

Changes or modifications that are not expressly approved by the manufacturer (or party responsible) for compliance could void the user's authority to operate the equipment.

Part 15.105 Statement

This equipment has been tested and found to comply with the limits for a class B digital device, pursuant to Part 15 of the FCC rules. These limits are designed to provide reasonable protection against harmful interference in a residential installation. This equipment generates, uses, and can radiate radio frequency energy and, if not installed and used in accordance with the instructions, may cause harmful interference to radio communications. However, there is no guarantee that interference will not occur in a particular installation. If this equipment does cause harmful interference to radio or television reception, which can be determined by turning the equipment off and on, the user is encouraged to try to correct the interference by one or more of the following measures:

- Reorient or relocate the receiving antenna.
- Increase the separation between the equipment and receiver.
- Connect the equipment into an outlet on a circuit different from that to which the receiver is connected.
- Consult the dealer or an experienced radio/TV technician for help.

Body-Worn(Wrist) and Next-to-Mouth Operation

This device was tested for typical body-worn (wrist) operations with 0 inches (0cm) between the user's body (wrist) and the back of the device.

This device was also tested for typical next-to-mouth (face) operations with 0.39 inches (1 cm) between the user's mouth (face) and the front of the device.

To comply with FCC RF exposure requirements, a minimum separation distance of 0.39 inches (1 cm) must be maintained between the user's mouth(face) and the front of the device.

Any accessories containing metallic components may not be used.

Laser safety statement

CDRH Compliance

THIS PRODUCT COMPLIES WITH APPLICABLE
REQUIREMENT OF THE DHHS PERFORMANCE STANDARD
FOR LASER PRODUCT, 21 CFR SUBCHAPTER J.

Caution!

This product employs a Laser system. To ensure proper use of this product, please read this owner's manual carefully and retain for future reference. Should the unit require maintenance, contact an authorized service center.

Use of controls, adjustments, or the performance of procedures other than those specified herein may result in hazardous radiation exposure.

To prevent direct exposure to laser beam, do not try to open the enclosure or make direct contact with the laser.

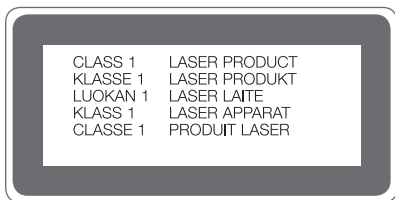

Limited Warranty – USA

ARBITRATION NOTICE: THIS LIMITED WARRANTY CONTAINS AN ARBITRATION PROVISION THAT REQUIRES YOU AND LG (as defined hereinafter in the Definitions) TO RESOLVE DISPUTES BY BINDING ARBITRATION INSTEAD OF IN COURT, UNLESS YOU CHOOSE TO OPT OUT. IN ARBITRATION, CLASS ACTIONS AND JURY TRIALS ARE NOT PERMITTED. PLEASE SEE THE SECTION TITLED "PROCEDURE FOR RESOLVING DISPUTES" BELOW.

Should your LG Mobile Phone ("Product") fail due to a defect in materials or workmanship under normal and proper use, during the warranty period set forth below, LG will, at its option, repair or replace the Product. This limited warranty is valid only to the original retail purchaser of the Product and applies only when purchased and used within the United States including U.S. Territories.

Warranty Period	Scope of Warranty
Twelve (12) months from date of original retail purchase (or absent valid proof of purchase, fifteen (15) months from manufacture date)	Parts and Labor (internal/ functional parts only)

- Replacement products and parts are warranted for the remaining portion of the original warranty period or ninety (90) days, whichever is greater.
- Replacement products and parts may be new, reconditioned, refurbished, or otherwise factory remanufactured.
- Replaced Products and parts will become the property of LG.

EXCEPT TO THE EXTENT PROHIBITED BY APPLICABLE LAW, ANY IMPLIED WARRANTY OF MERCHANTABILITY OR FITNESS FOR A PARTICULAR PURPOSE ON THE PRODUCT IS LIMITED IN DURATION TO THE DURATION OF THE ABOVE LIMITED WARRANTY. UNDER NO CIRCUMSTANCES SHALL LG OR ITS U.S. DISTRIBUTORS/DEALERS BE LIABLE FOR ANY INDIRECT, INCIDENTAL, CONSEQUENTIAL, SPECIAL, OR PUNITIVE DAMAGES, INCLUDING, WITHOUT LIMITATION, LOST GOODWILL, LOST REVENUES OR PROFITS, WORK STOPPAGE, IMPAIRMENT OF OTHER GOODS, COST OF REMOVAL AND REINSTALLATION OF THE PRODUCT, LOSS OF USE, OR ANY OTHER DAMAGES WHETHER BASED IN CONTRACT, TORT, OR OTHERWISE. LG'S TOTAL LIABILITY, IF ANY, SHALL NOT EXCEED THE PURCHASE PRICE PAID BY YOU FOR THE PRODUCT. Some states do not allow the exclusion or limitation of incidental or consequential damages or limitations on how long an implied warranty lasts, so the above exclusions or limitations may not apply to you. This limited warranty gives you specific legal rights and you may also have other rights that vary from state to state.

HOW SERVICE IS HANDLED:

The original sales receipt specifying the Product and date of purchase is required to obtain warranty service.

LG will not re-install or back-up any data, applications, or software that you have added to your Product. It is therefore recommended that you back-up any such data or information prior to sending the Product to LG to avoid permanent loss of such information

You shall bear the cost of shipping the Product to LG Customer Service. LG shall bear the cost of shipping the Product back to you after completion of service under this limited warranty.

THIS LIMITED WARRANTY DOES NOT COVER:

- (1) Damage or defects of the Product resulting from use of the Product in other than its normal and customary manner.
- (2) Damage or defects of the Product resulting from abnormal use, abnormal conditions, improper storage, exposure to moisture or dampness, unauthorized modifications/connection/repair, misuse, neglect, abuse, accident, alteration, improper installation, or other acts which are not the fault of LG, including damage or defects of the Product caused by shipping, blown fuses, spills of food or liquid.

- (3) Damage or defects of the Product caused by transportation and/or handling, including scratches, dents, chips, and/or other damage to the finish of your Product including the external housing and cosmetic parts, unless such damage results from defects in materials or workmanship and is reported within one (1) week of delivery (Call: 1-800-793-8896).
- (4) Damage or defects to antennas unless caused directly by defects in material or workmanship.
- (5) Damage or defects of the Product resulting from operating the Product contrary to the instructions outlined in the Product owner's manual.
- (6) That LG Customer Service was not notified by you of the alleged defect or malfunction of the Product during the applicable limited warranty period.
- (7) Products with original serial numbers that have been removed, altered, or cannot be readily determined.
- (8) Damage or defects of the Product or missing items to any Product sold "As Is," "With all Faults" or similar disclaimer.
- (9) Damage or defect of the Product caused by the use of accessories, parts, consumable cleaning products, or service not provided or approved by LG.
- (10) All plastic surfaces and all other externally exposed parts that are scratched or damaged.
- (11) Products operated outside published maximum ratings.
- (12) Replacement of any consumable parts (such as fuses).

The cost of repair or replacement under the above excluded circumstances shall be borne by you.

TO OBTAIN WARRANTY SERVICE AND ADDITIONAL INFORMATION:

Call 1-800-793-8896 and select the appropriate option from the menu.

Or visit our website at <http://www.lg.com>.

Or by mail: LG Electronics Customer Service P.O. Box 240007 Huntsville, AL 35813
ATTN: CIC – Mobile Handsets

DO NOT RETURN YOUR PRODUCT TO THE ABOVE ADDRESS. Please call or write for procedures for obtaining warranty service.

PROCEDURE FOR RESOLVING DISPUTES:

ALL DISPUTES BETWEEN YOU AND LG ARISING OUT OF OR RELATING IN ANY WAY TO THIS LIMITED WARRANTY OR THE PRODUCT SHALL BE RESOLVED EXCLUSIVELY THROUGH BINDING ARBITRATION, AND NOT IN A COURT OF GENERAL JURISDICTION. BINDING ARBITRATION MEANS THAT YOU AND LG ARE EACH WAIVING THE RIGHT TO A JURY TRIAL AND TO BRING OR PARTICIPATE IN A CLASS ACTION.

Definitions. For the purposes of this section, references to “LG” mean LG Electronics MobileComm U.S.A., Inc., its parents, subsidiaries and affiliates, and each of their officers, directors, employees, agents, beneficiaries, predecessors in interest, successors, assigns and suppliers; references to “dispute” or “claim” shall include any dispute, claim or controversy of any kind whatsoever (whether based in contract, tort, statute, regulation, ordinance, fraud, misrepresentation or any other legal or equitable theory) arising out of or relating in any way to the sale, condition or performance of the product or this Limited Warranty.

Notice of Dispute. In the event you intend to commence an arbitration proceeding, you must first notify LG in writing at least 30 days in advance of initiating the arbitration by sending a letter to LG at LG Electronics U.S.A., Inc. Attn: Legal Department- Arbitration 1000 Sylvan Ave, Englewood Cliffs 07632. You and LG agree to engage in good faith discussions in an attempt to amicably resolve your claim. The notice must provide your name, address, and telephone number; identify the product that is the subject of the claim; and describe the nature of the claim and the relief being sought. If you and LG are unable to resolve the dispute within 30 days, either party may proceed to file a claim for arbitration.

Agreement to Binding Arbitration and Class Action Waiver. Upon failure to resolve the dispute during the 30 day period after sending written notice to LG, you and LG agree to resolve any claims between us only by binding arbitration on an individual basis, unless you opt out as provided below. Any dispute between you and LG shall not be combined or consolidated with a dispute involving any other person's or entity's product or claim. More specifically, without limitation of the foregoing, any dispute between you and LG shall not under any circumstances proceed as part of a class or representative action. Instead of arbitration, either party may bring an individual action in small claims court, but that small claims court action may not be brought on a class or representative basis.

Arbitration Rules and Procedures. To begin arbitration of a claim, either you or LG must make a written demand for arbitration. The arbitration will be administered by the American Arbitration Association (“AAA”) and will be conducted before a single arbitrator under the AAA’s Consumer Arbitration Rules that are in effect at the time the arbitration is initiated (referred to as the “AAA Rules”) and under the procedures set forth in this section. The AAA Rules are available online at www.adr.org/consumer. Send a copy of your written demand for arbitration, as well as a copy of this provision, to the AAA in the manner described in the AAA Rules. You must also send a copy of your written demand to LG at LG Electronics, U.S.A., Inc. Attn: Legal Department- Arbitration 1000 Sylvan Avenue Englewood Cliffs, NJ 07632. If there is a conflict between the AAA Rules and the rules set forth in this section, the rules set forth in this section will govern. This arbitration provision is governed by the Federal Arbitration Act. Judgment may be entered on the arbitrator’s award in any court of competent jurisdiction. All issues are for the arbitrator to decide, except that issues relating to the scope and enforceability of the arbitration provision and to the arbitrability of the dispute are for the court to decide. The arbitrator is bound by the terms of this provision.

Governing Law. The law of the state of your residence shall govern this Limited Warranty and any disputes between us except to the extent that such law is preempted by or inconsistent with applicable federal law.

Fees/Costs. You do not need to pay any fee to begin an arbitration. Upon receipt of your written demand for arbitration, LG will promptly pay all arbitration filing fees to the AAA unless you seek more than \$25,000 in damages, in which case the payment of these fees will be governed by the AAA Rules. Except as otherwise provided for herein, LG will pay all AAA filing, administration and arbitrator fees for any arbitration initiated in accordance with the AAA Rules and this arbitration provision. If you prevail in the arbitration, LG will pay your attorneys’ fees and expenses as long as they are reasonable, by considering factors including, but not limited to, the purchase amount and claim amount. Notwithstanding the foregoing, if applicable law allows for an award of reasonable attorneys’ fees and expenses, an arbitrator can award them to the same extent that a court would. If the arbitrator finds either the substance of your claim or the relief sought in the demand is frivolous or brought for an improper purpose (as measured by the standards set forth in Federal Rule of Civil Procedure 11(b)), then the payment of all arbitration fees will be governed by the AAA Rules. In such a situation, you agree to reimburse LG for all monies previously disbursed by it that are otherwise your obligation to pay under the AAA Rules. Except as otherwise provided for, LG waives any rights it may have to seek attorneys’ fees and expenses from you if LG prevails in the arbitration.

Hearings and Location. If your claim is for \$25,000 or less, you may choose to have the arbitration conducted solely on the basis of (1) documents submitted to the arbitrator, (2) through a telephonic hearing, or (3) by an in-person hearing as established by the AAA Rules. If your claim exceeds \$25,000, the right to a hearing will be determined by the AAA Rules. Any in-person arbitration hearings will be held at a location within the federal judicial district in which you reside unless we both agree to another location or we agree to a telephonic arbitration.

Opt Out. You may opt out of this dispute resolution procedure. If you opt out, neither you nor LG can require the other to participate in an arbitration proceeding. To opt out, you must send notice to LG no later than 30 calendar days from the date of the first consumer purchaser's purchase of the product by either: (i) sending an e-mail to optout@lge.com, with the subject line: "Arbitration Opt Out" or (ii) calling 1-800-980-2973. You must include in the opt out e-mail or provide by telephone: (a) your name and address; (b) the date on which the product was purchased; (c) the product model name or model number; and (d) the IMEI or MEID or Serial Number, as applicable (the IMEI or MEID or Serial Number can be found (i) on the product box; (ii) on a label on the back of the product beneath the battery, if the battery is removable; or (iii) from the settings menu via the following path:

Settings > General > About phone > Status).

You may only opt out of the dispute resolution procedure in the manner described above (that is, by e-mail or telephone); no other form of notice will be effective to opt out of this dispute resolution procedure. Opting out of this dispute resolution procedure will not affect the coverage of the Limited Warranty in any way, and you will continue to enjoy the full benefits of the Limited Warranty. If you keep this product and do not opt out, then you accept all terms and conditions of the arbitration provision described above.

