



**MICRO  
COMPONENT SYSTEM**

**Owner's Manual**

**MODELS: FR-X1A/FK-X1/  
FH-X1/FE-X1E**

Please read this manual carefully  
before operating your set.  
Retain it for future reference.

Designs and specifications are subject to  
change without notice for improvement.

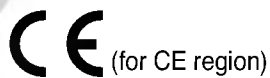

P/NO. : 3828SND035B



**Explanation Graphical Symbols:**



The lightning flash with arrowhead symbol, within an equilateral triangle is intended to alert the user to the presence of uninsulated dangerous voltage within the product's enclosure that may be of sufficient magnitude to constitute a risk of electric shock to persons.



The exclamation point within an equilateral triangle is intended to alert the user to the presence of important operating and maintenance (servicing) instructions in the literature accompanying the appliance.

**WARNING:**

TO REDUCE THE RISK OF FIRE OF ELECTRIC SHOCK, DO NOT EXPOSE THIS APPLIANCE TO RAIN OR MOISTURE. To avoid electrical shock, do not open the cabinet, Refer servicing to qualified personnel only.

**CAUTION**

Use of controls or adjustments or performance of procedures other than those specified herein may result in hazardous radiation exposure.

**(FOR THE CUSTOMERS IN EUROPE)**

If this product is marked with the CE-symbol, it means which is conformed to EMC regulation 89/336/EEC.

Laser component in this product is capable of emitting radiation exceeding the limit for Class 1.

**CAUTION: INVISIBLE LASER RADIATION WHEN OPEN AND INTERLOCKS DEFEATED. AVOID EXPOSURE TO BEAM.**

**WARNING: OSYNLIG LASERSTRÅLNING NÄR DENNA DEL ÄR ÖPPNAD STRÅLEN ÄR FARLIG.**

**Attention: Quand l'appareil est ouvert, ne pas s'exposer aux radiations invisibles du faisceau laser.**

This label is located on the interior.

CLASS 1	LASER PRODUCT
KLASSE 1	LASER PRODUKT
LUOKAN 1	LASER LAITE
CLASS 1	LASER APPARAT
CLASSE 1	PRODUIT LASER

This Compact Disc player is classified as a CLASS 1 LASER product. The CLASS 1 LASER PRODUCT label is located on the exterior.

**(FOR CUSTOMERS IN CANADA)**

**CAUTION:**

TO PREVENT ELECTRIC SHOCK, DO NOT USE THIS (POLARIZED) PLUG WITH AN EXTENSION CORD, RECEPTACLE, OR OTHER OUTLET UNLESS THE BLADES CAN BE PULLY INSERTED TO PREVENT BLADE EXPOSURE.

This class B digital apparatus meets all requirements of the canadian Interference-Causing Equipment Regulations.

**WARNING:**

SHOCK HAZARD - DO NOT OPEN

**MISE EN GARDE:**

Pour éviter les chocs électriques, n'utilisez pas cette fiche (polarisée) avec une rallonge, un réceptacle ou une autre prise si vous ne pouvez pas y insérer les bouches à fond.

**MISE EN GARDE**

Cet appareil numérique de la classe B respecte toutes les exigences de Règlement sur le matériel brouilleur de Canada.

**AVERTISSEMENT**

RISQUE DE CHOC ELECTRIQUE NE PAS OUVRIR (FOR CUSTOMERS IN THE UNITED STATES OF AMERICA)

**Note to CATV system Installer:**

This reminder is provided to call the CATV system installer's attention to Article 820-40 of the NEC that provides guidelines for proper grounding and, in particular, specifies that the cable ground shall be connected to the grounding system of the building, as close to the point of cable entry as practical.

**NOTE:**

**The interference potential to the device.**

This equipment generates and uses radio frequency energy and if not installed and used properly, that is in strict accordance with the manufacturer's instructions, may cause interference to radio and television reception. It has been type tested and found to comply with the limits for a Class B computing device in accordance with the specifications in subparts J of Part 15 of FCC Rules, which are designed to provide reasonable protection against such interference in a residential installation. However, there is no guarantee that interference will not occur in a particular installation. If this equipment does cause interference to radio or television reception, which can be determined by turning the equipment off and on, the user is encouraged to try to correct the interference by one of more or the following measures:

- Reorient or relocate the receiving antenna.
- Increase the separation between the equipment and receiver.
- Connect the equipment into an outlet on a circuit different from that to which the receiver is connected.
- Consult the dealer or an experienced radio/TV technician for help.

**(FOR CUSTOMERS IN THE UNITED KINGDOM)**

**WIRING INSTRUCTIONS**

This appliance is supplied with a BS1363 approved 3 amp fused mains plug. When replacing the fuse always use a 3 amp BS1362 approved type. Never use this plug with the fuse cover omitted. To obtain a replacement fuse cover contact your supplying dealer or "LG ELECTRONICS U.K.LTD"

If the mains sockets in your home differ, or are not suitable for the type of plug supplied, then the plug should be removed and a suitable type fitted. Please refer to the wiring instructions below:

**Warning:** The mains plug severed from the mains lead of this appliance must be destroyed. A mains plug with bared wires is hazardous if engaged in a mains output line socket.

**IMPORTANT**

The wires in this mains lead are coloured in accordance with the following codes:

Blue:	Neutral
Brown:	Live

As the colour of the wires in the mains lead of this appliance may not correspond with the coloured markings identifying the terminals in your plug, proceed as follows:

The wire which is coloured blue must be connected to the terminal which is marked with the letter N or coloured black.

The wire which is coloured brown must be connected to the terminal which is marked with the letter L or coloured red.

If a 13 amp BS1363 plug or any other type of plug is used, 3 amp BS1362 approved fuse must be fitted either in the plug or at the distribution board.

**Warning:** Do not connect either wire to the earth pin, marked with the letter E or with the earth symbol  $\perp$  or coloured green or green and yellow.

## ■ Front View

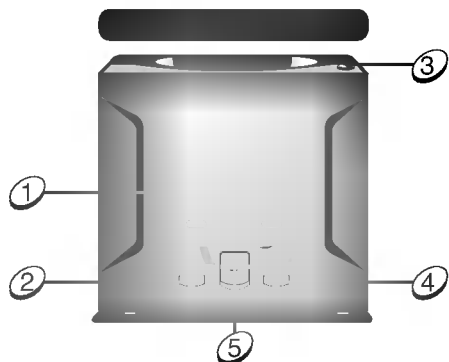

## CD PLAYER

1. SKIP/SEARCH(◀◀◀/▶▶▶) buttons
2. REPEAT button
3. CD DOOR OPEN(▲) button
4. STOP/CLEAR(■) button
5. PLAY/PAUSE(▶/||) button

## STEREO RECEIVER

6. REMOTE SENSOR
7. POWER button
8. PRESET ▲/▼ buttons
9. HEADPHONE(🎧) socket
10. FUNCTION DISPLAY

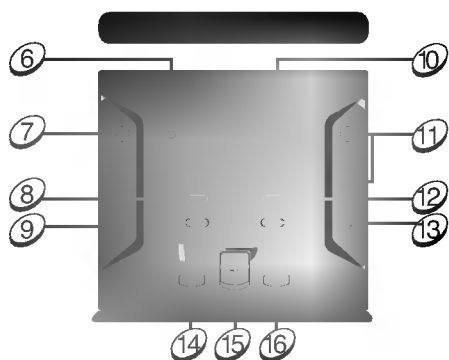
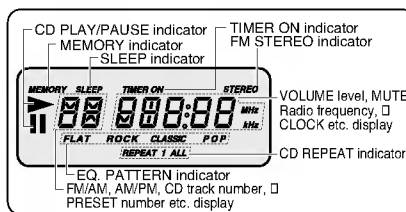

11. VOLUME + - buttons
12. TUNING ▲/▼ buttons
13. CLOCK button
14. TIMER button
15. FUNCTION button
16. MEMORY button

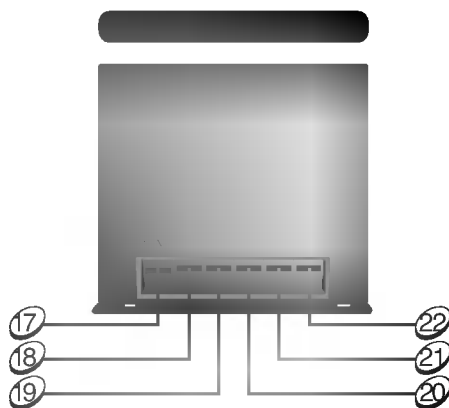

## CASSETTE DECK

17. RECORD(●) button
18. PLAY(▶) button
19. REWIND(◀) button
20. FAST FORWARD (▶▶) button
21. STOP/EJECT(■/▲) button
22. PAUSE(||) button

## ■ Back View

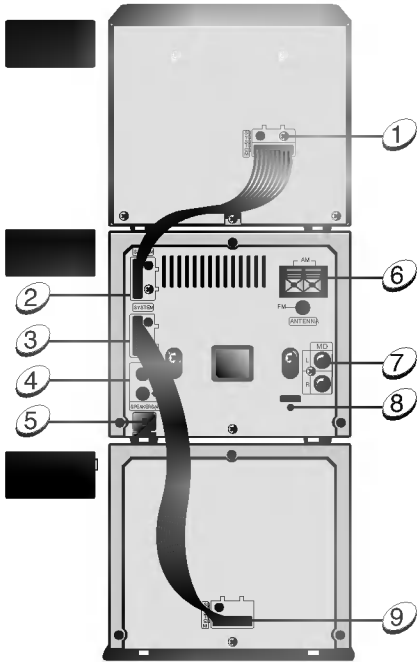

### CD PLAYER

1. SYSTEM ① jack

### STEREO RECEIVER

2. SYSTEM ① jack
3. SYSTEM ② jack
4. SPEAKER jacks
5. POWER CORD
6. ANTENNA terminals
7. MD IN jacks
8. RESET button

### CASSETTE DECK

9. SYSTEM ② jack

## ■ Remote Control

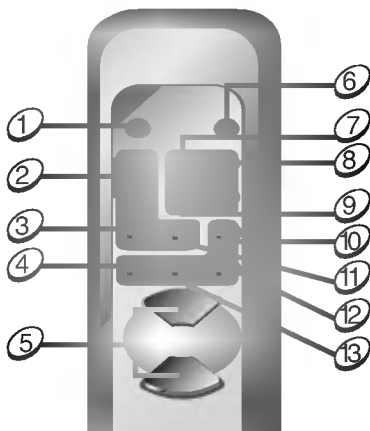

1. POWER button
2. PRESET ^/∨ buttons
3. FM STEREO button
4. EQ PATTERN button
5. VOLUME +, - buttons
6. FUNCTION button
7. CD PLAY/PAUSE (▶/||) button
8. CD STOP (■) button
9. CD SKIP/SEARCH (◀◀/▶▶) buttons
10. SLEEP button
11. FM/AM button
12. CLOCK button
13. MUTE button

## ■ System Connection

### Preparation

- Unplug the system power cord.

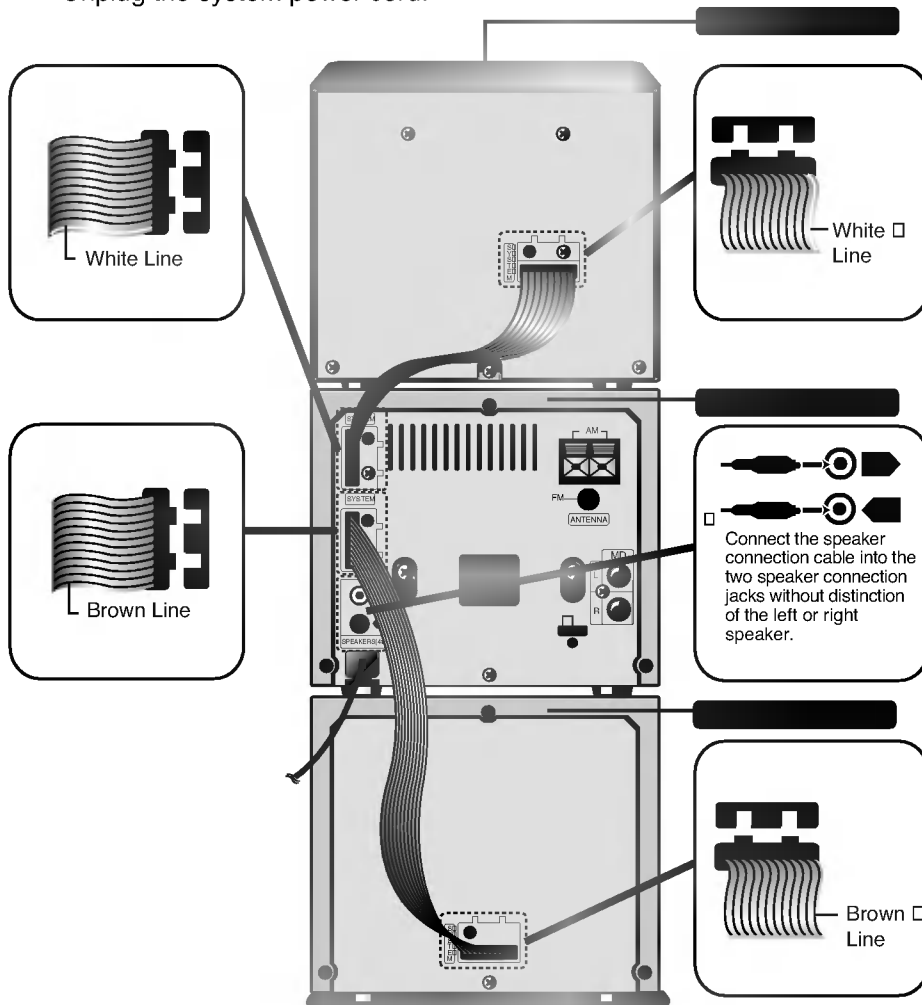

### • NOTE

- ① Insert the system connection cables into the sockets.
- ② Make sure the direction of the colour of the system connection cables.

## ■ Auxiliary device connection

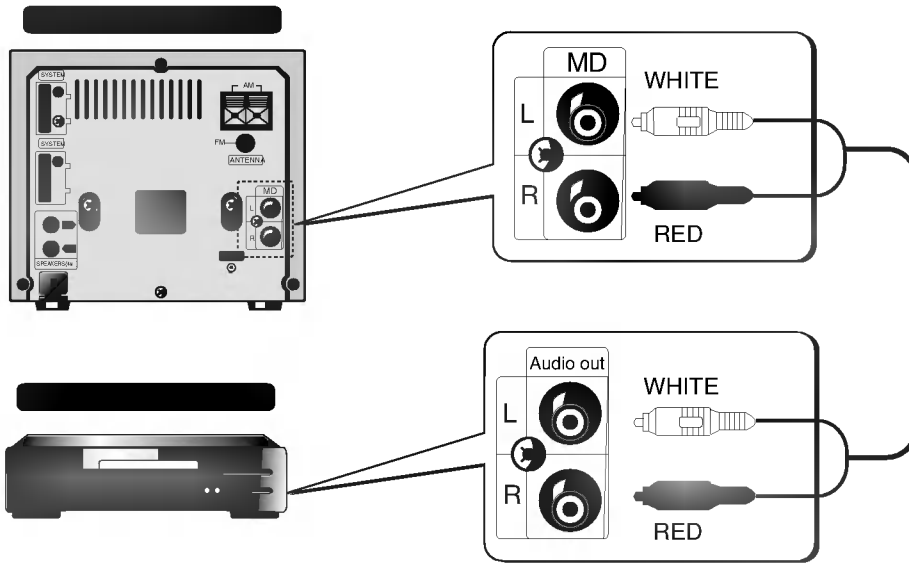

## ■ Antenna Connection

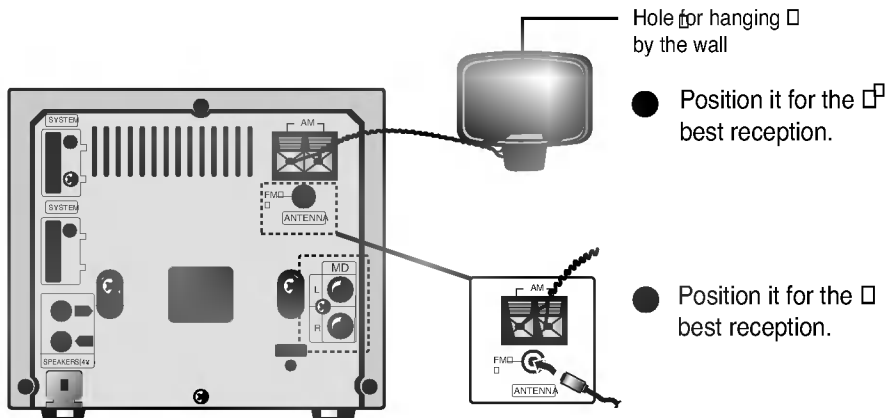

## ■ How to connect the AM antenna wire

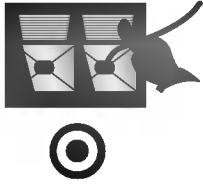

Push the fixing button and insert the antenna wire into the hole and release the fixing button. Pull it slightly and check lead is fitted securely.

## ■ How to join the AM loop antenna

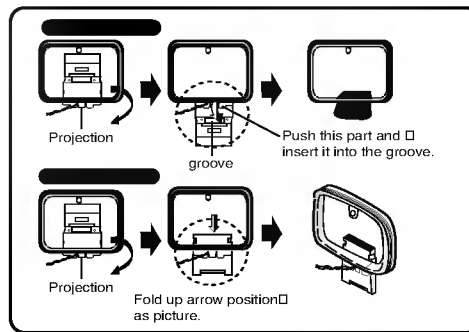

## ■ Notes on Batteries of the remote control

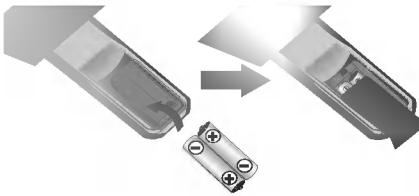

- Your remote control comes with batteries. Use two “AAA(UM-4, IEC R03)” type high quality batteries.
- When the remote control fails to operate accurately at maximum distance from the unit. Replace the worn out batteries with new ones.
- Install two “AAA” type batteries, observing correct battery polarity (⊕ and ⊖). Reversed battery polarity might damage the unit.
- Do not use different types of batteries together, or the old ones with new ones.
- When you are not going to use the unit for a long time, remove the batteries to prevent possible electrolyte leakage.

## ■ Remote Control Range

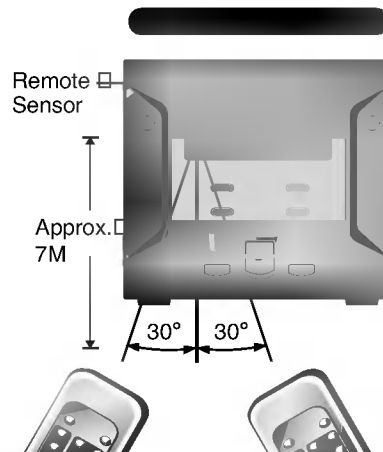

The remote control device is designed for the range shown in the illustration.

### NOTE

Strong light or obstacles between the remote control device and the stereo system may interfere with the functioning of the remote control.

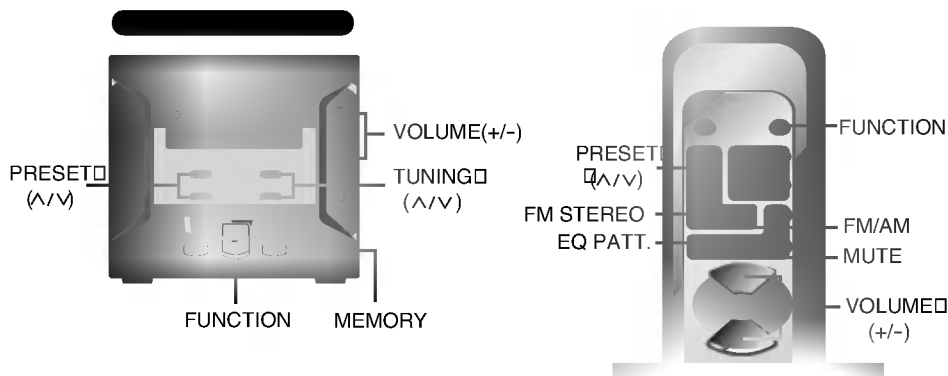

### ■ Tuning Automatically and Manually

1. Press the FUNCTION button so that FM or AM appears on the display.
2. Press the TUNING  $\wedge/\vee$  button to search a desired station.
  - Pressing briefly and repeatedly you can search a desired station manually.
  - Pressing for more than 1 second: The unit tunes in a station automatically.
3. To receive the FM stereo: Press the FM STEREO button on the remote control so that STEREO appears in the display. If stereo reception is distorted by noise, press this button to switch to mono reception so that 'STEREO' goes out in the display.



### ■ Volume Adjustment

1. To increase the volume : Press VOLUME + .
2. To decrease the volume: Press VOLUME - .



3. To mute your unit: Press MUTE.



- To cancel it press the MUTE button again or adjust the volume with VOLUME + / - button.



## ■ To select a desired EQ. pattern

Press EQ PATT. repeatedly.



- ① FLAT: linear frequency response
- ② ROCK: more bass more treble
- ③ CLASSIC: for orchestral music
- ④ POP: less bass, less treble

## ■ Storing Stations

1. Select a desired station in FM or AM mode.
2. Press the MEMORY button and it is stored in the preset number 1.

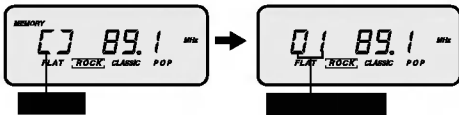

3. Repeat step 1~2 to memorise up to 30 stations. If full in memory up to 30 stations, 'FULL' appears in the display.

## ■ To recall presets and to clear a selected preset station

1. Press the FUNCTION button to select FM or AM.
2. Press the PRESET ^/v button.
3. To clear a selected preset station, press the MEMORY button for more than 3 seconds.

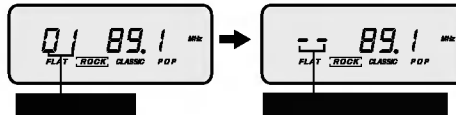

## ■ To replace or add a memorised station

1. Select a desired station.
2. Press the MEMORY button.
  - If the memory has less than 30 stations stored, new station will be stored.
  - If the memory is full 'FULL' will appear for 3 seconds in the display.
    - ① At this time press the PRESET ^/v button while 'FULL' is appearing, to select a desired preset number.
    - ② Press the MEMORY button. It is stored in the current selected preset number.

## ■ To clear all the preset stations

### (Operating with only remote control)

In FM or AM mode press the FM STEREO button on the remote control for more than 3 seconds. ('EMPTY' appears in the display and all the preset stations are erased)

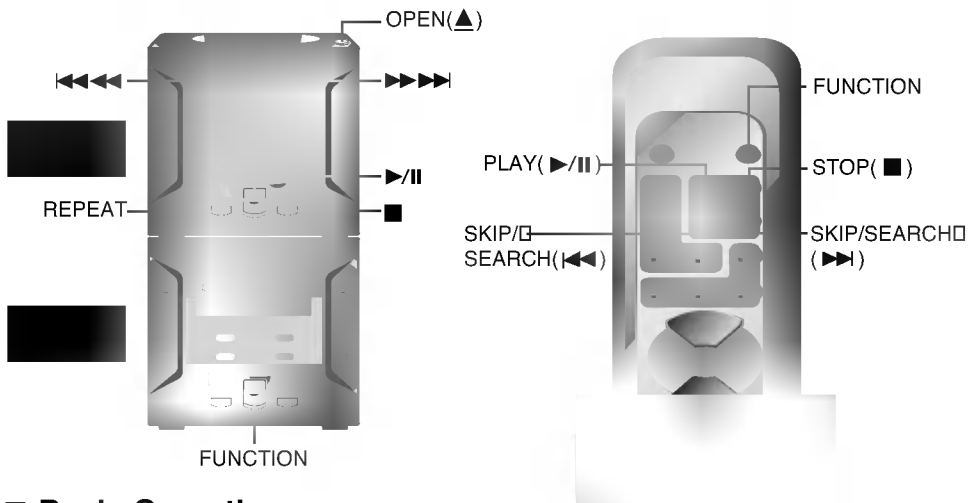

## ■ Basic Operation

1. Press the **FUNCTION** button repeatedly to enter the CD mode. (If no disc is in the CD drawer, '15C' appears in the display)

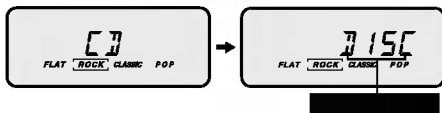

2. Press the **OPEN(▲)** button to open the CD drawer.
3. Load disc with the label side up.

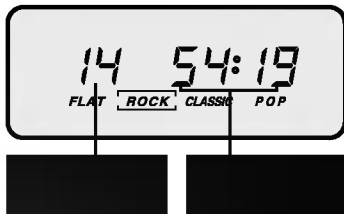

4. To skip to a desired track
  - To skip to a previous track: Press ◀◀◀ or SKIP/SEARCH (◀◀) repeatedly.
  - To skip to a forward track: Press ▶▶▶ or SKIP/SEARCH (▶▶).
  - It works also during play.

5. To play disc press the (▶/||) button.



6. To pause press the ▶/|| button. To resume play press it again.



**7. Searching for a particular point in a track.**

- **To search back:**  
Press ◀◀◀◀ [or SKIP/SEARCH ◀◀] and release it at the desired point.
- **To search forward:**  
Press ▶▶▶▶ [or SKIP/SEARCH (▶▶)] and release it at the desired point.

**8. To stop play.**

Press (■).

**■ Repeat play**

**To play one track repeatedly**

Press the REPEAT button to display 'REPEAT 1' and press the ▶/|| button to start play.

**To play all tracks repeatedly**

Press the REPEAT button to display 'REPEAT ALL' and press the ▶/|| button to start play.

**To cancel repeat play**

Press the REPEAT button so that 'REPEAT' in the display goes out.

**NOTE:**

The track skip/search function works

**■ Playback**

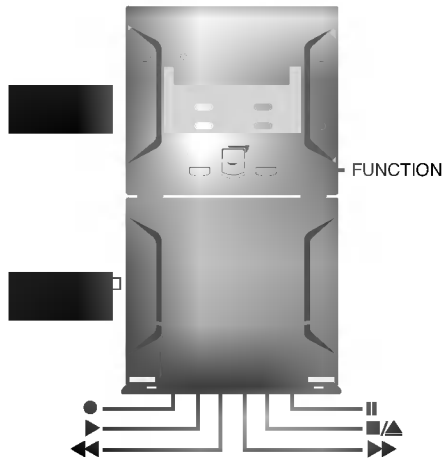

1. Press the FUNCTION button repeatedly to enter the TAPE mode.
2. Press the ■/▲ button to open the cassette door.
3. Insert a pre-recorded with the exposed section of tape down.
4. How to use each button.

Button	Function
▶	PLAY
▶▶	FAST FORWARD
◀◀	REWIND
	PAUSE
■/▲	STOP

1. Switch on the auxiliary device i.e. TV/VCR or MD, connected to the rear mounted phono sockets.
2. Press the FUNCTION button so that 'MD' appears in the display.

**NOTE:**

- While functioning of the play, rewind or fast forward, at the end of the tape it will be stopped automatically by the automatic stop mechanism.

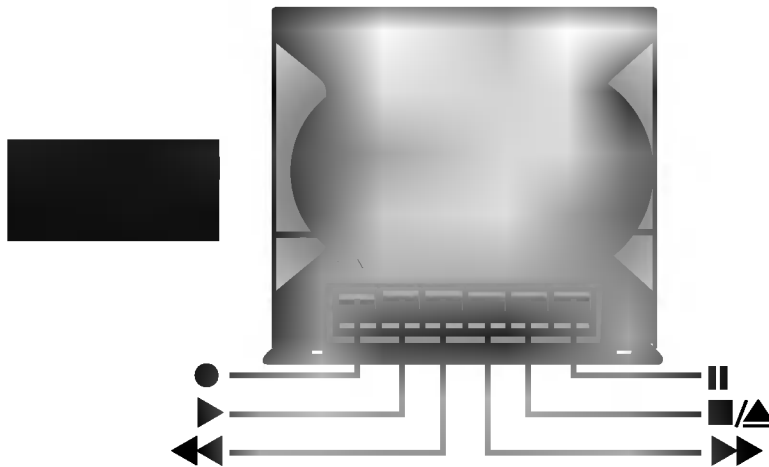

### ■ Recording From Each Source

1. Insert a blank cassette tape into deck.
2. Select and play a desired source; RADIO, CD or Auxiliary(MD) device.
3. Press the ● button to start recording.
4. To pause recording. Press the || button and to resume recording press it again.
5. To stop recording. Press the ■/▲ button.

### ■ Notes while recording

1. It can record only the front side of the cassette.
2. At the end of the tape, it stops automatically.
3. While recording, the output volume and tone of the speakers or headphone may be freely varied without affecting the level of the recording.
4. While CD recording, the repeat play, track skip and search functions work.
5. If the FUNCT., FM/AM; ►|| or PRESET ^/▼ button is pressed while recording, 'COPY' appears in the display and another function works not. Stop recording and work another function.

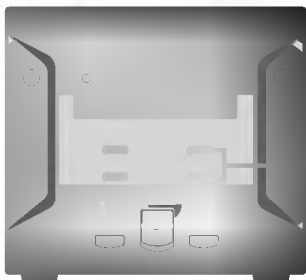

TUNING(^/v)  
CLOCK  
MEMORY

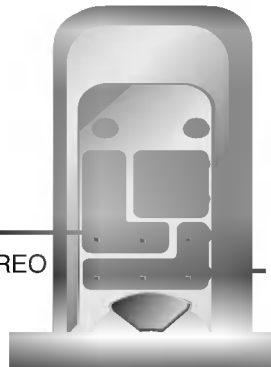

FM STEREO  
CLOCK

■ **Example: Set to 5:30 in the afternoon**

1. Press the CLOCK button. (If the CLOCK is already set, press it for more than 2 seconds)
4. Set the minute with the TUNING ^/v button.



2. Set the hour with TUNING ^/v button.



5. Press the MEMORY button. The clock starts operating.



- At this time if you press the FM STEREO button '5' changes to '17'.
  - Each time the FM STEREO button is pressed, the 12 hour cycle or 24 hour cycle appears in turn.
3. Press the MEMORY button.



■ **To confirm the current time**

Press the CLOCK button and the hours appear for about 5 seconds in the display.

With the TIMER function you can have the radio and CD automatically turned on and off at the time desired. The TAPE or MD function is not worked with the TIMER function.

**1. To check the time:**

Press the CLOCK button and check the time is correctly set.

**2. To activate the timer:**

Press the TIMER button so that the TIMER ON indicator appears in the display. (If the timer is already set, press the TIMER button for about 1.5 seconds in TIMER OFF status) FM(or AM) and CD indicator flashes on the display in turn.

**3. To select a desired function:**

Press the MEMORY button while the desired function indicator flashes.

At this time if you have selected FM or AM, select a desired preset station number with the TUNING ^ or v button and press the MEMORY button again to confirm the selected preset station number.

**4. To programme the time to switch on:**

You can see TIMER ON on the display and the hour display flashes.

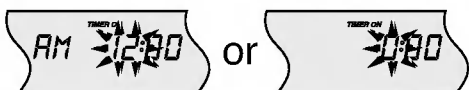

Select the time to turn on(hours) with the TUNING ^ or v button and confirm with the MEMORY button.

The minutes flash in the display. Select the time to turn on(minutes) with the TUNING ^ or v and confirm with the MEMORY button.

**5. To programme the time to turn off:**

TIMER OFF now appears on the display. And then the hour display flashes.

Programme the time to switch off in the same way as the time to turn on.

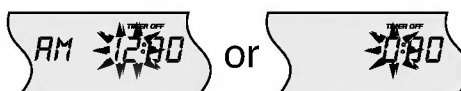

**6. To set the volume level:**

Volume level now flashes on the display. Set the volume level with the TUNING ^ or v button and confirm with the MEMORY button.

**7. To activate the timer:**

Press the TIMER button. You can see the TIMER ON on the display. At this time, if you press the TIMER button once again, the timer setting is cancelled.

Each time the TIMER button is pressed you can select the timer setting or cancel. You can also confirm the timer setting.

**8. Turn the unit off:**

The unit will be automatically turned on and off at the time set.

## ■ Sleep Timer Setting (Operating with only the remote control)

When the sleep timer is used, the power is automatically turned off after the specified time has elapsed.

### 1. To specify the time until the power is turned off.

Press the SLEEP button. In the display you can see SLEEP and 90 for about 5 seconds. This means that the unit turns off automatically after 90 minutes.

Each time the button is pressed the time interval before it turns off is reduced by 10 minutes. i.e. 80....70....etc.

Select the desired time to turn off.

### 2. To check the remaining time until the power is turned off.

While the sleep function is active press the SLEEP button briefly. The time remaining until it turns off is displayed for about 3 seconds.

#### NOTE:

If you press the SLEEP button while the sleep time is displayed, the SLEEP time is set again.

### 3. To cancel the sleep timer mode

If you wish to stop the function press the SLEEP button repeatedly until 10 appears, and then press the SLEEP button once again while 10 is displayed.

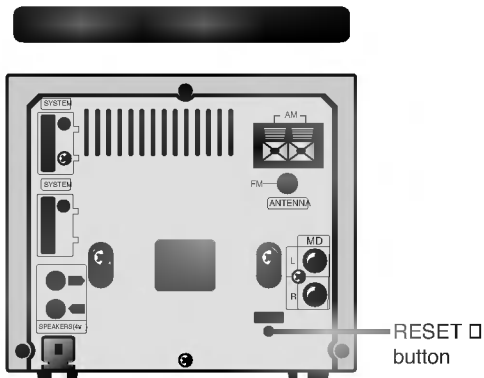

## RESET BUTTON

Don't press this button if possible except when using this unit for the first time or if there is a malfunction.

If pressed, it is necessary to unplug the power cord and press the button for more than 5 secs. Plug in the power cord. If the RESET button is pressed by mistake, all previously memorized information will be erased.

# SPECIFICATIONS

## PLAYER

- Frequency Response..... 40~20,000Hz
- S/N Ratio..... 73dB
- Net Dimensions ..... 150x135x193.5mm  
(WxHxD)
- Net Weight..... 1.1kg

## STEREO RECEIVER

- Output Power .....5W+5W

	AM	FM
Frequency Range (Option)	522~1,611kHz 530~1,720kHz or 530~1,610kHz	87.5~108MHz
Frequency Response	100~1800Hz	60~12500Hz
S/N Ratio	—	60/55dB (Mono/Stereo)

- Power Requirements  
Refer to the back panel of the unit.
- Net Dimensions .....150x135x193.5mm  
(WxHxD)
- Net Weight..... 1.8kg

## CASSETTE DECK

- Frequency Response..... 125~8200Hz
- S/N Ratio.....46dB
- Channel Separation .....40dB
- Net Dimensions ..... 150x135x193.5mm  
(WxHxD)
- Net Weight..... 1.1kg

## SPEAKER SYSTEM

- Type.....1way 1Speaker System
- Impedance .....4Ω
- Rated Input Power .....5W
- Max Input Power .....10W
- Frequency Response.....80~18,000Hz
- Net Dimensions ..... 165x270x168mm  
(WxHxD)
- Net Weight..... 2kg