

Vacuum Cleaner

OWNER'S MANUAL

MODEL : V-5060CT (Hose-Button Control, Booster, Telescopic Pipe)
V-5000CT (Hose-Button Control, Telescopic Pipe)
V-5000CD (Hose-Button Control, 2-Steel Pipes)
V-5000HT/V-5004HT (Hose-Slide Control, Telescopic Pipe)
V-5000HD (Hose-Slide Control, 2-Steel pipes)
V-5000T (Body Slide Control, Telescopic Pipe)
V-5000D (Body Slide Control, 2-Steel pipes)
V-5010T (Body-On/Off, Telescopic Pipe)
V-5010D (Body-On/Off, 2-Steel Pipes)

Please read carefully and thoroughly the operating instructions and safety precautions before installing and operating your vacuum cleaner.

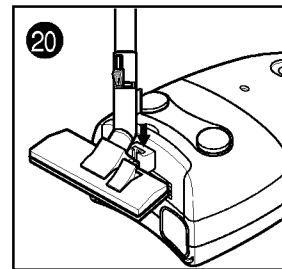
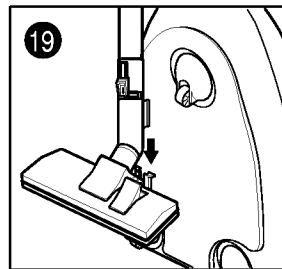
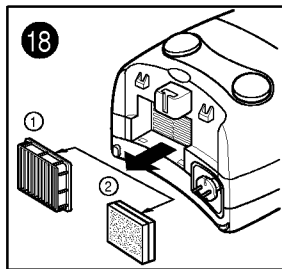
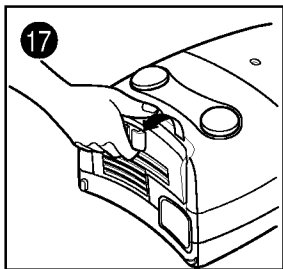
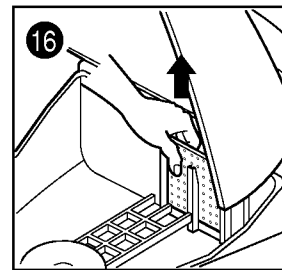
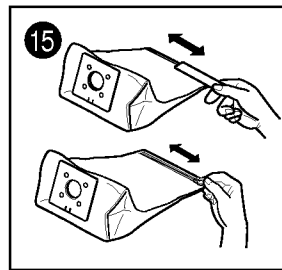
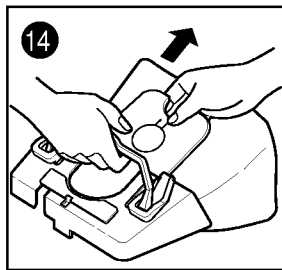
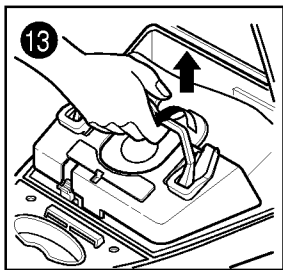
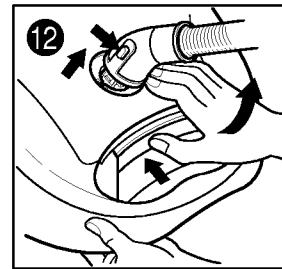
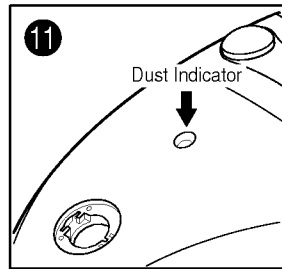
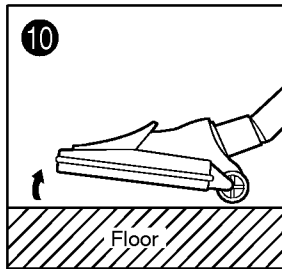
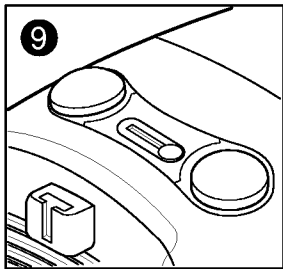
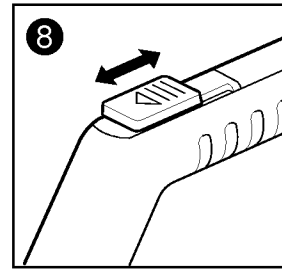
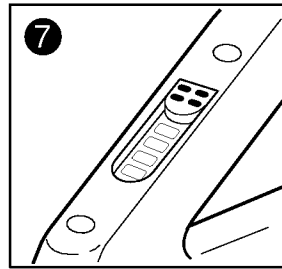
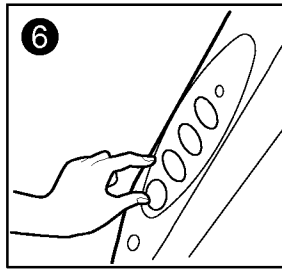
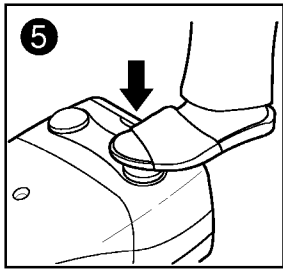
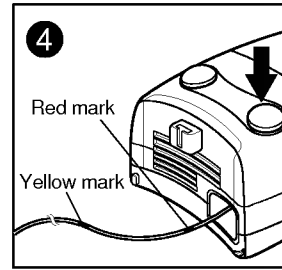
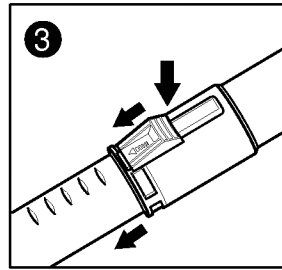
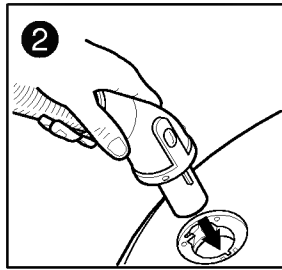
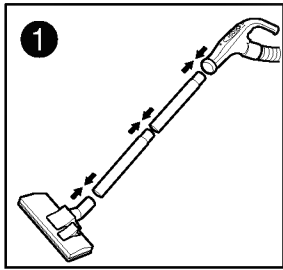

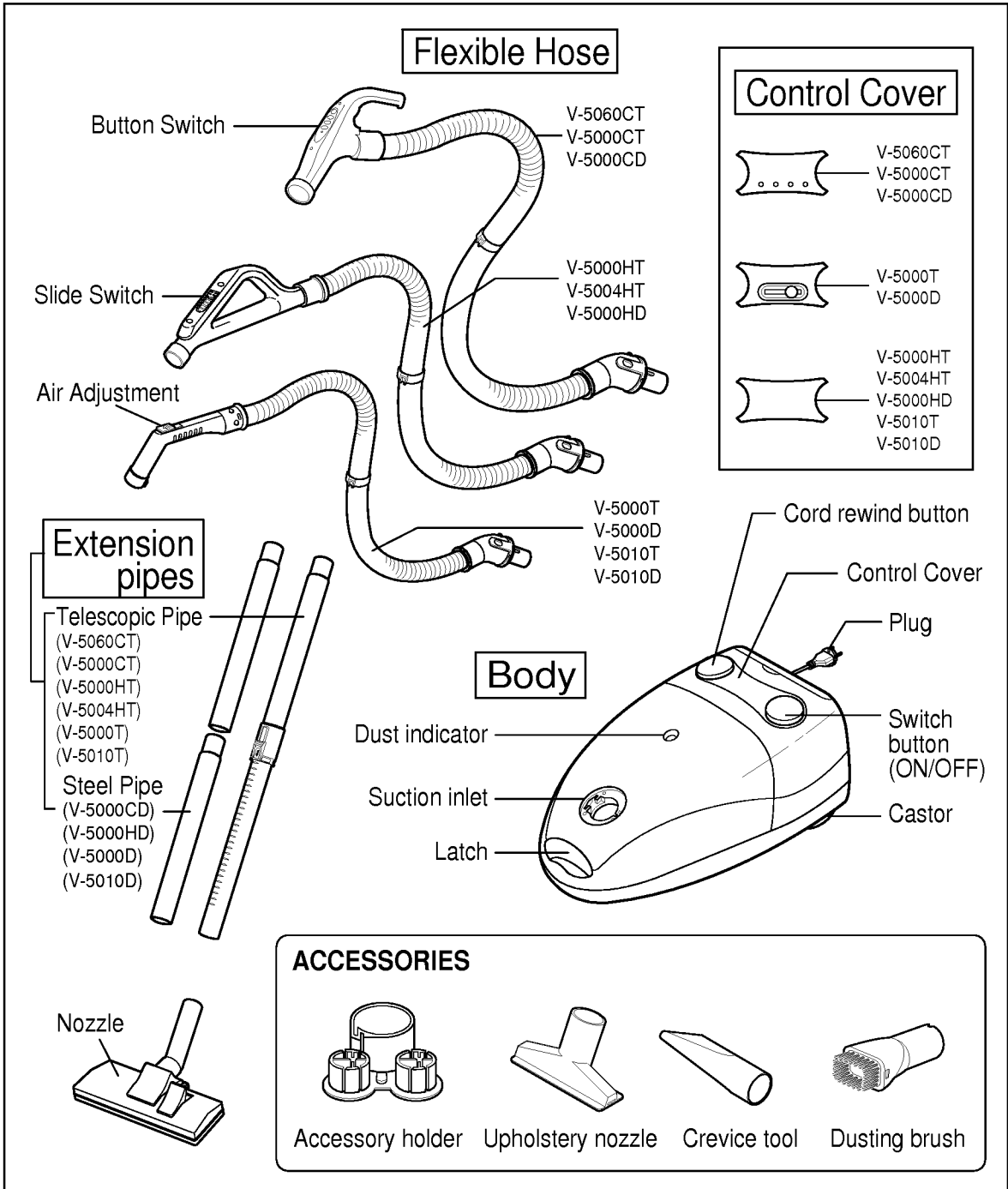
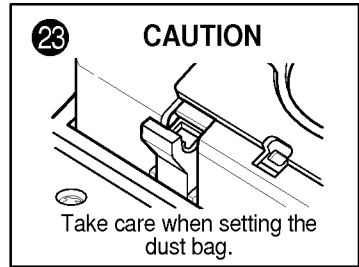
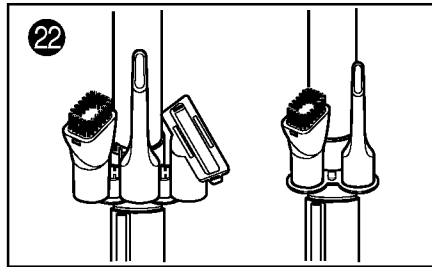
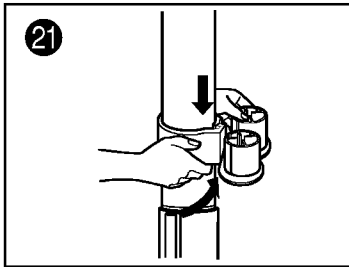

IMPORTANT SAFEGUARDS

When using an electrical appliance, basic safety precautions should always be followed, to reduce the risk of fire, electric shock and injury to persons, including the following:

READ ALL INSTRUCTIONS BEFORE ASSEMBLING or USING THIS APPLIANCE

WARNING

Disconnect power supply before servicing and/or cleaning the unit. If not, electric shock could occur and/or cleaner could suddenly start.

- 1 Do not leave appliance plugged in. Unplug it from the outlet when not in use or before servicing .
- 2 Do not use outdoors or on wet surfaces. Do not pick up the water or wet material.
- 3 Do not handle plug or appliance with wet hands.
- 4 Do not allow it to be used as a toy. Close attention is necessary when used by children
- 5 Use only manufacturer's recommended attachments.
- 6 If the supply cord is damaged, it must be replaced by the manufacturer or its service agent or a similarly qualified person in order to avoid a hazard.
- 7 Do not pull or carry by the power cord as a handle, close a door on cord, or pull the cord around sharp edges or corners. Do not run appliance over the cord. Keep the cord away from heated surfaces.
- 8 Do not unplug by pulling the cord. To unplug, grasp the plug, not the cord.
- 9 Do not put any object into openings. Do not use with any openings blocked; keep free of dust, lint, hair, and anything that may reduce air flow.
- 10 Keep hair, loose clothing, fingers, and all parts of body away from the openings. Do not use vacuum cleaner(v/cleaner) to pick up sharp hard objects, small toys, pins, etc.
- 11 Do not pick up anything that is burning or smoking, such as cigarettes, matches, or fireplace ashes.
- 12 Do not use to pick up flammable or combustible liquid or vapors such as gasoline or use in areas where they may exist.
- 13 Do not use vacuum cleaner without dust bag and filters in the right place.
- 14 Always turn off all controls before unplugging.
- 15 Do not keep v/cleaner on the chairs, tables, etc. Extra care must be taken when cleaning stairs.
- 16 The cord moves rapidly when rewinding. Provide

a clear path and hold the plug when rewinding onto cord reel. Do not allow the plug to whip when rewinding.

- 17 Take electrical inspection when hose is cracked and its coat is peeled off.
- 18 Use this v/cleaner only for those jobs expected for a home vacuum cleaner.
- 19 Do not pull out the cord beyond the red mark. Pulling the cord out past the red mark may cause problems with the cord reel.
- 20 Do not use dry cleaning solvent in toxic or flammable. It may result in the surface damage. Wipe off the dirty place with a clean cloth.
- 21 Do not allow sharp or heavy objects to rest on the power cord. If the power cord is damaged or frayed, it may cause a fire or electric shock.
- 22 The use of radio transmitting devices close to the appliance may interfere the function of the appliance, input power may vary.

USING THE VACUUM CLEANER

- 1 Connecting the nozzle, the extension pipes and the handle : insert the narrow section into the wide section. (fig.1)
- 2 HOSE Connection. (fig. 2)
 - Insert the HOSE into body of the v/cleaner until a clicking sound is heard.
 - To remove the HOSE. depress the hose clamp button and pull out.
- 3 EXTENSION PIPES Adjustment.
 - 1) TELESCOPIC EXTENSION PIPES (V-5000CT, V-5000HT, V-5004HT, V-5010T, V-5000T,V-5060CT) (fig. 3)

Push the slider control downwards to extend or/ retract extension pipes
 - 2) 2 Pieces STEEL PIPES (V-5000D,V-5010D, V-5000CD,V-5000HD,) Insert the STEEL PIPES firmly each other. (fig.1)
- 4 Pull the main plug out of the vacuum cleaner and insert into the socket outlet. (fig.4)
 - Do not pull the cord beyond the red mark.
 - Pulling the cord out past the red mark may cause problems with the cord rewinding system.
 - When cleaning is completed, unplug cord from socket outlet and press the cord reel button. The cord will be automatically rewound.
- 5 Press the ON/OFF switch (ⓘ). (fig.5)

Power indicator will extinguish slowly when press switch button in off position. (V-5060CT, V-5000CT/CD)

6 Adjusting the power

1) V-5060CT, V-5000CT, V-5000CD (fig. 6)

- Adjust power with the power control switch in the handle.
- Automatic : The normal cleaning mode, this mode is used when optimal cleaning is required by the appliance sensing the floor condition and amount of dust present.
- BOOSTER : This mode is suitable for removing dirt which is deep-embedded in a carpet or on the floor, and also recommended when the hose, the pipes, of the nozzle is clogged with any bulky obstacles, Power in this mode is much higher than MAX mode power. BOOSTER operates for 10seconds and is restored to the last mode automatically. (V-5060CT)
- MIN : This mode is used for cleaning at night, or when silent cleaning is required. (V-5000CT/CD)
- MAX : This mode is used for cleaning carpets or similar items which require strong suction force.
- OFF : Used to stop appliance operation.

2) V-5000HT,V-5000HD,V-5004HT (fig.7)

- Adjust power with the sliding switch in the handle.

3) V-5000T,V-5000D (fig.8,9)

- Adjust power with the sliding switch in the body. (fig.9)
- Open the hole in the handle, then suction power will be reduced.(fig 8)

4) V-5010T, V-5010D

- Press the on/off switch to ON. (fig.5)
- Open the air hole in the handle, then suction power will be reduced.(fig 8)

7 HOW TO USE NOZZLE

Pass the nozzle lightly over the floor. Do not exert excessive pressure, as this may damage the flooring, particularly parquet floors. Best results will be obtained by applying only light pressure. If the suction power weakened, raise the front end slightly. (fig.10)

8 HOW TO USE THE ATTACHMENTS

- Accessory Holder can be attached on the Extension wands using clamping hook. (fig. 21)
- Accessories can be stored in the holder with two types, like fig 22.

The crevice tool can be stored at the tool box in the appliance

CREVICE TOOL : For the dust between the ribs of the radiator, between the shelves, or in the narrow gap.

DUSTING BRUSH: For gentle vacuuming of a delicate fabrics on the furniture, curtain etc.

UPHOLSTERY NOZZLE: For vacuuming of the dust on the upholstery.

9 DUST INDICATOR (fig. 11)

- GREEN : Continue to use.
- RED : Empty the filter bag. Filter bag is full
- Watch the dust indicator after detaching the nozzle more than 10cm from the floor.

10 Replacing the dust filter bag

Switch the vacuum cleaner off (fig. 5), remove the hose by pressing the knob and open the cover by pressing the latch. (fig. 12)

1) Paper filter bag

Dispose of the bag and set the new one.

2) Cloth filter bag

After sliding the clip off or unzipping the cloth filter bag, empty the cloth filter bag. (fig. 15)

CAUTION: Always use genuine LG dust bag. If you can't get it, use only 'HR6938-OSH' of paper bag made by PHILIPS.

11 THE MOTOR SAFETY FILTER CLEANING

1. Pull out the MOTOR SAFETY FILTER (fig. 16)
2. Shake the dust off and wash filter in a warm soapy water. Do not clean in a dish-washer or in a washing machine.
3. Remove the moisture. Dry the filter sufficiently in shade for about a day.

12 THE EXHAUST FILTER REPLACEMENT

1. Open the exhaust cover. (fig 17)
2. Replace the old EXHAUST FILTER with the new one or clean EXHAUST FILTER.
3. Insert the EXHAUST FILTER keeping arrow mark on it.

(fig 18- L : High Efficiency pleated Micro Filter V-5060CT, V-5000CT, V-5000CD, V-5000HT, V-5004HT, V-5000HD, fig 18- M : Micro and Carbon Filter.)

13 HOW TO STORE THE VACUUM CLEANER

- Store vacuum cleaner in a cool, clean, and dry place.
- Upright Position : Push the nozzle holder into the holder slot on the bottom of the v/cleaner. (fig.19)
- Horizontal Position: Push the nozzle holder into the holder slot on the rear of the v/cleaner.(fig.20)

BEFORE REQUESTING SERVICE

Proper assembly and safe use of your vacuum cleaner are your personal responsibilities. Read this "Owner's Manual" carefully for important use and safety information.

Repairs, when necessary, must be performed at an authorized service facilities. This appliance is intended for HOUSEHOLD USE ONLY and not for commercial or industrial use.

SAVE THESE INSTRUCTIONS

The serial number is found on the bottom of this unit. This number is unique to this unit and not available to others. You should record requested information here and retain this guide as a permanent record of your purchase.

Date of purchase _____
 Dealer purchased from _____
 Dealer address _____
 Dealer phone No. _____
 Model No. _____
 Serial No. _____

TROUBLE SHOOTING CHART

Review this chart to find do-it-yourself solutions for minor performance problems.

WARNING : Disconnect power supply before servicing and/or cleaning the unit as electrical shock could occur and/or the cleaner could suddenly start.

Problem	Possible Cause	Possible solution
Cleaner won't run.	1. Unplugged at wall outlet. 2. Power control S/W is in "OFF" position.	1. Plug in firmly. 2. Push switch button. 3. Regulate power control switch.
Poor suction.	1. Full or clogged filter bag. 2. Clogged clean filter. 3. Hole in hose. 4. Clogged nozzle. 5. Filter cover open.	1. Change the filter bag. 2. Change the clean filter. 3. Replace hose. 5. Clean the air passage of nozzle. 5. Close filter cover.
Cleaner picks movable rugs or nozzle pushes too hard.	1. Suction too strong.	1. Regulate power control lever.

POSSIBLE SVC PARTS LIST

DESCRIPTION	PART NO.	REMARK
PACKING, SEAL	3920Fi4653A	
PACKING, ABSORBING	4i23008B	
MOTOR ASS'Y	4681Fi2373J	127V~60Hz
	4681Fi2373B	220V~50/60Hz
PACKING, MOTOR MOUNTING	3920Fi3675B	
FILTER ASS'Y, CLOTH	5231Fi2444C	
CARRIER, BAG	4840Fi1407B	
PACKING, DUST SEAL	3920Fi4718B	
LEVER, LEGULATION	4510Fi4665B	
BASE, BODY	3040Fi1403B	
BUMPER, BODY	4820Fi1401B	
FILTER(MECH), MOTOR SAFETY	5231Fi4518C	
CORD REEL ASS'Y	4687Fi1415C	127V~60Hz
	4687Fi1415D	220V~50/60Hz
FRAME, CASTER	3210Fi3670B	
ROLLER, CASTER	4i22024M	
INLET, HOSE	5236Fi2385A	
RING, GUIDE	4350Fi3664A	
LATCH	4026Fi3661B	
COVER, ACCESSORY	3550Fi2390A	
INDICATOR ASSY	3520Fi3475B	
BUTTON, CORD REEL	5020Fi3659C	
BUTTON, POWER SWITCH	5020Fi3658D	
SWITCH ASSY, PUSH	6601Fi3149B	
PWB(PCB) ASSY, MAIN	6871FX2102C	127V~60Hz
	6871FX2081B	220V~50/60Hz
COVER, EXHAUST FILTER	3550Fi1402B	
FILTER ASS'Y, EXHAUST	5231Fi4504F	
NOZZLE ASSY, FLOOR	2549Fi2393A	
PIPE ASSY, TELESCOPIC	5201Fi2181C	
NOZZLE, UPHOLSTERY	5248Fi2259A	
TOOL, CREVICE	5058Fi3462A	
BRUSH ASSY, DUST	5202Fi3474A	
HOLDER, ACCESSORY	4930Fi2378A	
HOSE ASSY, FLEXIBLE	5215Fi1305A	

PRINTED CIRCUIT BOARD

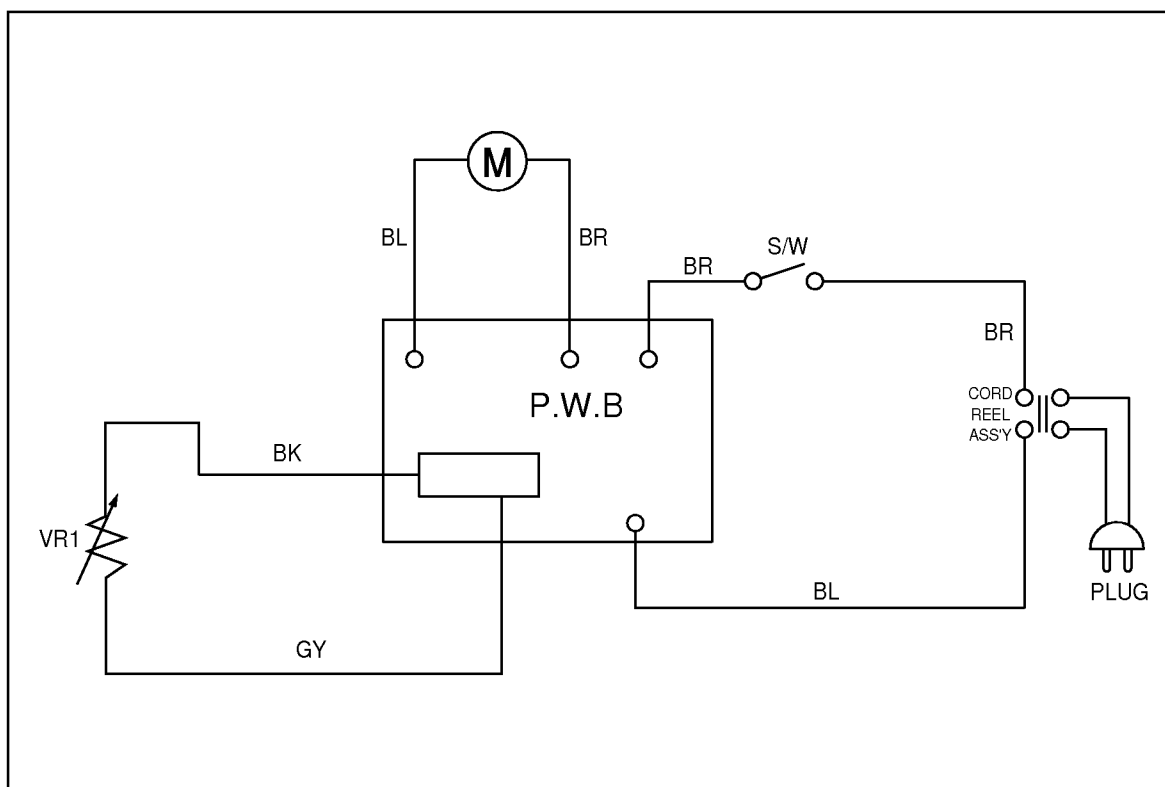

SERVICE CENTER

For service, please contact our authorized service center listed below.

Area	Telephone Number	Fax. Number
Jeddah	(02) 629 2929 ext. 310	(02) 629 1121
Jeddah	(02) 663 2325 ext. 343	(02) 665 2837
Riyadh	(01) 461 5559	(01) 463 3126
Al-Khobar	(03) 857 2929	(03) 857 7643

SPECIFICATIONS

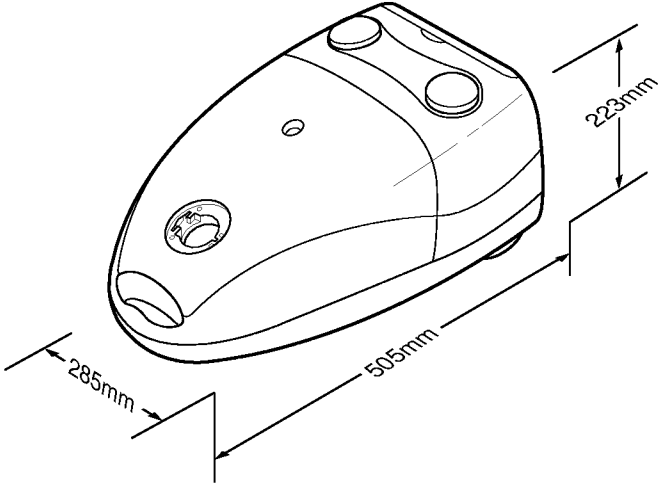

- POWER : IEC-1200W
MAX-1400W
- CURRENT : 6A / 9.5A
- FREQUENCY : 50 / 60Hz
- VOLTAGE : 127V / 220V
- NET DIMENSIONS : 285 x 505 x 223 (W x D x H)
- PACKING DIMENSIONS : 330 x 579 x 328 (W x D x H)
- ATTACHMENTS

HOSE1EA	DUSTING BRUSH1EA
TELESCOPIC PIPE	CREVICE TOOL1EA
(STEEL PIPE).....1(2)EA	UPHOLSTERY NOZZLE.....1EA
NOZZLE1EA	ACCESSORY HOLDER.....1EA
- CAPACITY A : 3.5 ℓ
- POWER CONTROL : BODY SLIDE CONTROL
- CORD LENGTH : 5/6m
- NET WEIGHT : 4.8kg

* These specifications are subject to change according to the agent/buyer's request.

● **Serial Number**

How to read Serial Number.

: There is attached a Serial Number label on back side of this product.

