



Vacuum Cleaner

OWNER'S MANUAL

MODEL : V-3742ND
V-3743ST
V-3744HT

Please read carefully and thoroughly the operation instructions and safety precautions before installing and operating your vacuum cleaner.



BZ03

P/No.: 3828Fi3692V

Made by LG ELECTRONICS INC.

IMPORTANT SAFEGUARDS

When using an electrical appliance, basic precautions should always be followed, including the following:

READ ALL INSTRUCTIONS BEFORE USING THIS APPLIANCE

WARNING— To reduce the risk of fire, electric shock, or injury:

1. Do not leave appliance when plugged in. Unplug from outlet when not in use and before servicing.
2. Do not use outdoors or on wet surfaces.
3. Do not allow to be used as a toy. Close attention is necessary when used by or near children.
4. Use only as described in this manual. Use only manufacturer's recommended attachments.
5. If the supply cord is damaged, it must be replaced by the manufacturer or its service agent or a similarly qualified person in order to avoid a hazard.
6. Do not pull or carry by cord, use cord as a handle, close a door on cord, or pull cord around sharp edges or corners. Do not run appliance over cord. Keep cord away from heated surfaces.
7. Do not unplug by pulling on cord. To unplug, grasp the plug, not the cord.
8. Do not handle plug or appliance with wet hands.
9. Do not put any object into openings. Do not use with any opening blocked; keep free of dust, lint, hair, and anything that may reduce air flow.
10. Keep hair, loose clothing, fingers, and all parts of body away from openings and moving parts.
11. Do not pick up anything that is burning or smoking, such as cigarettes, matches, or hot ashes.
12. Do not use without dustbag and/or filters in place.
13. Turn off all controls before unplugging.
14. Carry over your shoulder when cleaning on stairs.
15. Do not use to pick up flammable or combustible liquids such as gasoline or use in areas where they may be present.

(continued)

SAVE THESE INSTRUCTIONS

THE SERIAL NUMBER IS FOUND ON THE BOTTOM OF THIS UNIT. THIS NUMBER IS UNIQUE TO THIS UNIT AND NOT AVAILABLE TO OTHERS. YOU SHOULD RECORD REQUESTED INFORMATION HERE AND RETAIN THIS GUIDE AS A PERMANENT RECORD OF YOUR PURCHASE.

DATE OF PURCHASE _____
DEALER PURCHASED FROM _____

DEALER ADDRESS _____

DEALER PHONE NO. _____
MODEL NO. _____
SERIAL NO. _____

TABLE OF CONTENTS

FEATURES	4
INSTALLATIONS	5
OPERATING	6
BEFORE REQUESTING SERVICE.....	10
SPECIFICATIONS	11

FEATURES

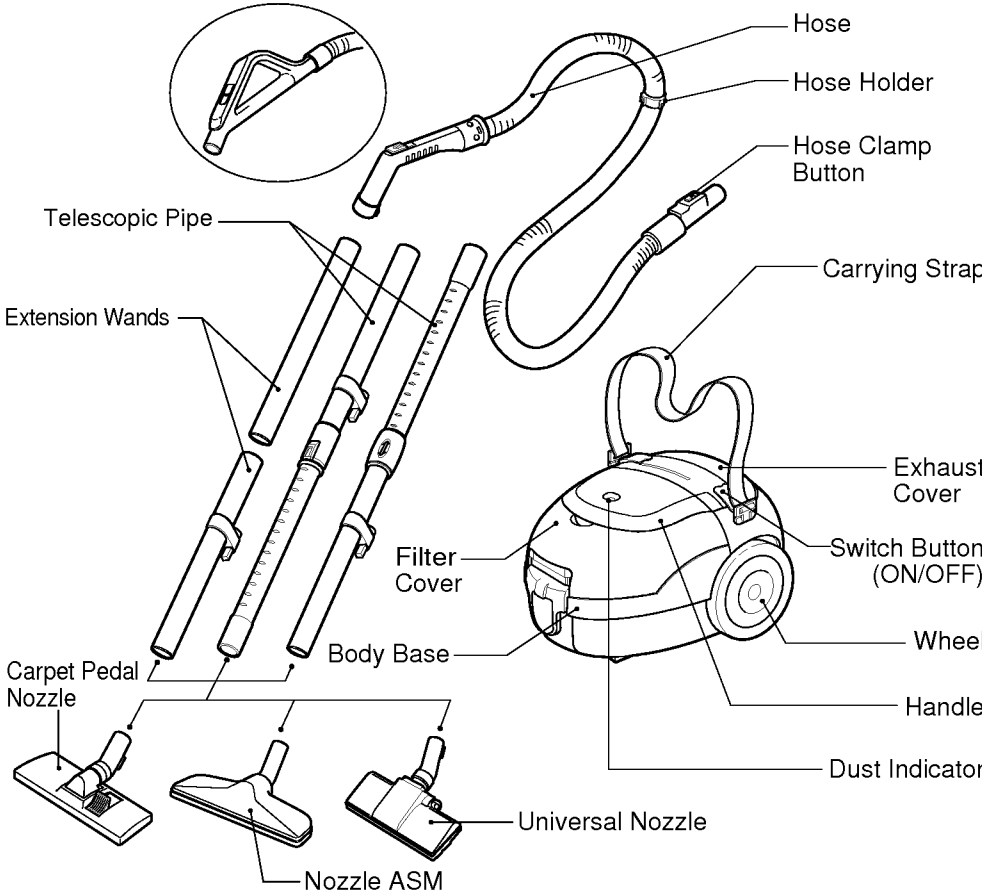

■ ATTACHMENTS

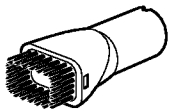

DUSTING BRUSH
(OPTION)

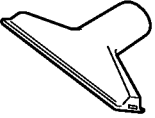

UPHOLSTERY NOZZLE
(OPTION)

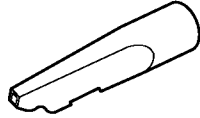

CREVICE TOOL

INSTALLATIONS

WARNING – Disconnect electrical supply before servicing and/or cleaning the unit, otherwise electric shock could occur and/or cleaner could suddenly start.

1. Electric shock could occur if used outdoors or on wet surfaces.
2. Keep children away from the vacuum cleaner at all times. Injury could result from inhalation.
3. Never leave a vacuum cleaner plugged in and unattended near children.
4. Always unplug the power cord by pulling the plug; not the cord.
5. Always turn off the vacuum cleaner before unplugging.
6. Always unplug your vacuum cleaner whenever you leave it for more than a moment or when not in use.
7. Always check the dust bag after vacuuming carpet. Fine soot and dust can clog the airfilter or bag, reduce the airflow and cause the bag to burst. Failure to change could cause permanent damage to the vacuum cleaner.

8. Keep cleaner on floor-not on chairs, tables, etc. Carry over your shoulder when cleaning on stairs.

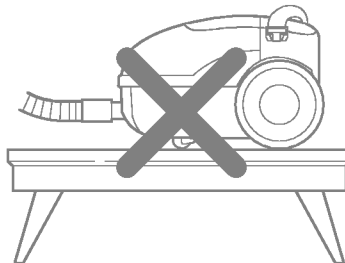

9. Never vacuum cigarette butts or fire-place ashes. Never use cleaner where flammable vapors from cleaning fluids, perfumes etc., are present. This could cause a fire.

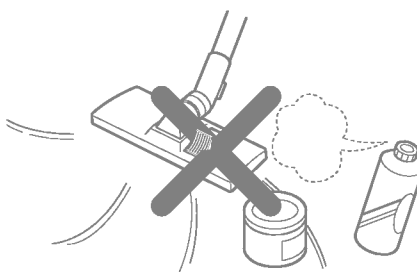

10. Store vacuum cleaner in a cool, clean and dry place.

11. Never place sharp or heavy objects on the power cord. Shock or fire hazard could occur.



12. Never operate with a damaged cord or plug.

13. Never use the cleaner to pick up sharp hard objects, small toys, pins, paper, etc. They may damage the cleaner or dust bag.

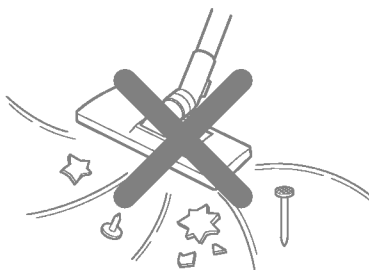

14. Use this vacuum cleaner only for those normal jobs that a home vacuum cleaner is usually used for.

OPERATING

- Connect extension wands to each other.
 - In case of telescopic pipe adjust wand to desired length by pressing the wand regulator.

• **Telescopic tube**

- Hold spring latch
- Pull out the tube to required length.
- Release spring latch to lock.

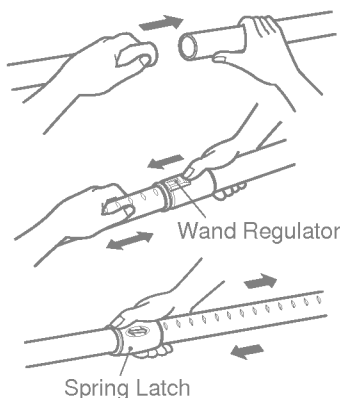

2. Insert the extension wand into the nozzle.



3. Insert the end of the hose into the cleaner pressing the hose clamp button until it snaps in place. (To remove, press the hose clamp button and pull out.)

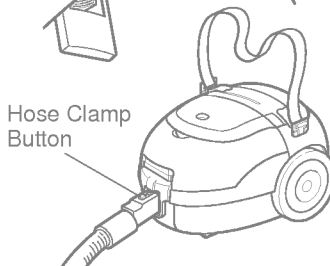

4. Insert the wand into the other side of the hose.

- The flexible hose handle has a manual air flow regulator (1) which allows you to briefly reduce the suction level (depending on model).

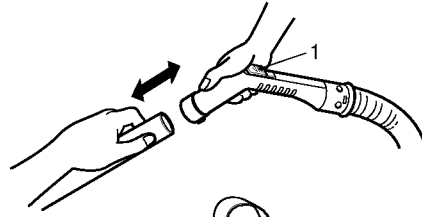

5. Pull out the cord from the back of the cleaner and plug into the outlet.

- Excessive pulling out may cause problems with the reel.

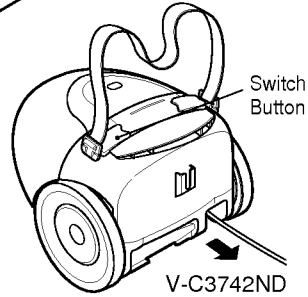

6. Press the switch button. (V-C3742ND, V-C3743ST) (ON/OFF SWITCH)

- You can control the suction power by adjusting the power control regulator. (V-C3743ST)
- Suction capacity increases steplessly up to MAX. (V-C3744HT)

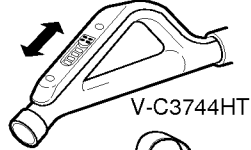

7. Pass the universal nozzle lightly over the floor. Do not exert excessive pressure on the floor nozzle, as this may damage the flooring, particularly parquet floors. Best results will be obtained by applying only light pressure to the nozzle. If the nozzle feels sluggish, raise the front end slightly to decrease the suction power as shown in the illustration.

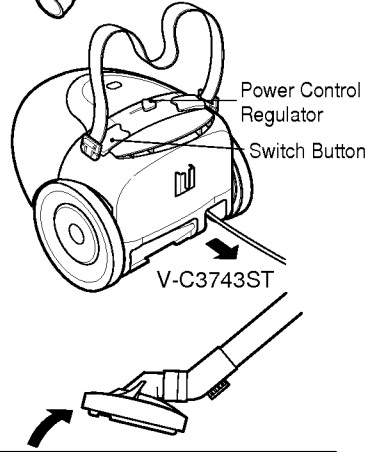

8. When cleaning on stairs and shelves, use carrying strap or handle as shown.

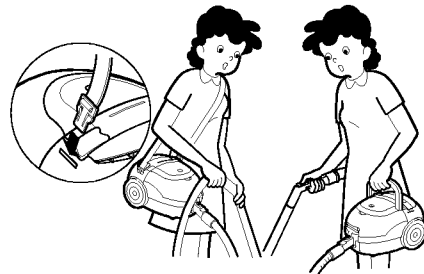

19. To use the crevice tool, pull out as shown.

- **Crevice Tool (2)**

For vacuuming in those normally inaccessible places like a window frame or a crevice in the wall.

- **Upholstery Nozzle (4)**

For vacuuming upholstery, mattresses, etc.

The thread collectors help to pick up the threads and fluff.

- **Dusting brush (3)**

For vacuuming picture frames, furniture outlines, books and other uneven objects.

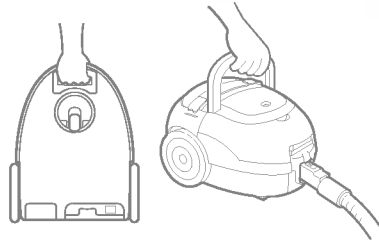
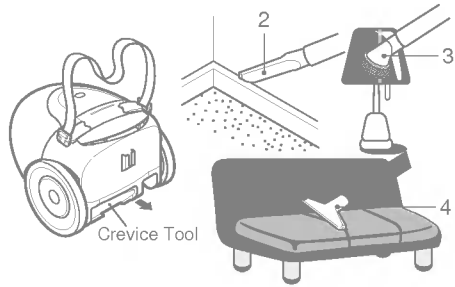

10. When carrying the cleaner, use handle or carrying hole as shown.

11. When not in use, attach the WAND HOLDER to the body hole while the body is in upright position.(Fig 1)
Also you can store the wand in horizontal position. Push the nozzle holder on the nozzle into the holder slot on the rear of the cleaner.(Fig 2)

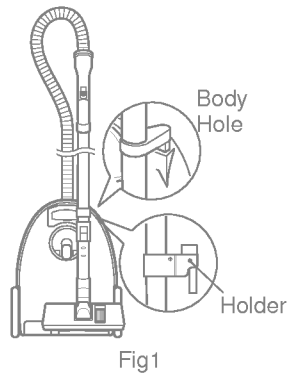

Fig1

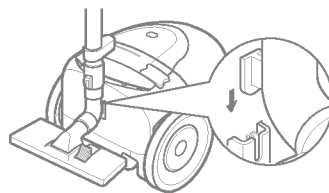
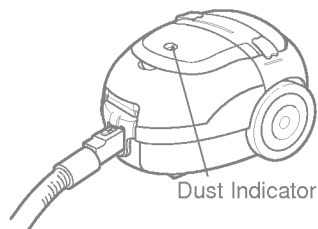

Fig2

12. How to check the dust indicator.

- Look at the dust indicator after separating the floor nozzle 10cm from the floor.
- If the sign is red, bag is full.



13. Replace the dust filter bag.

- Unplug cord from wall outlet.
- Remove the hose from the cleaner.
- Open the filter cover
- After pulling the hook as shown pull out used the dust filter bag.
- Dispose or empty the dust filter bag.
 - 1) Paper filter bag.
Dispose of the bag and set new one.
 - 2) Cloth filter bag.
Empty the bag, then reuse.

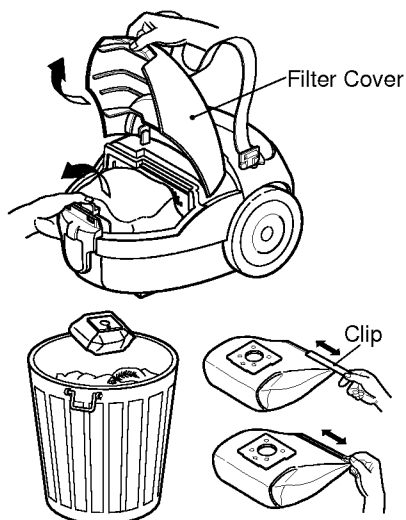

14. How to clean the motor safety filter.

- Check the motor safety filter occasionally and clean when dirty.
- Unplug cord from outlet.
- Open the filter cover
- Remove filter, wash it in warm soapy water, rinse and then dry in the shade. Do not clean in dishwasher or in washing machine.
- Push down to slide filter into the place.
- Close the filter cover.

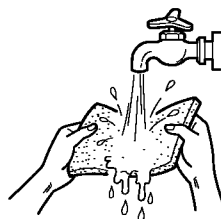
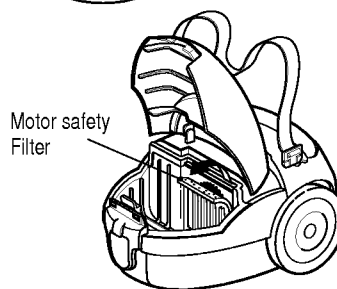

15. How to clean the exhaust filter.

- Check the exhaust filter occasionally and clean when dirty.
- Unplug cord from outlet.
- Open the exhaust cover and remove exhaust filter as shown.
- Next procedures are the same as the motor safety filter.

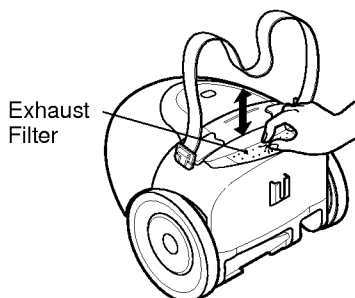

*The working life of this set is 7 years since the date of delivery to the consumer. Upon the expiry of the said period, it might be unsuitable for the use according to their destination.

BEFORE REQUESTING SERVICE

Proper assembly and safe use of your vacuum cleaner are your personal responsibilities. Read this "Owner's Manual" carefully important use and safety information.

TROUBLE SHOOTING CHART

Review this chart to find do-it-yourself solutions for minor performance problems.

WARNING— Disconnect electrical supply before servicing and/or cleaning the unit. If not, electric shock could occur and/or cleaner could suddenly start.

Problem	Possible Cause	Possible Solution
Cleaner won't run.	<ol style="list-style-type: none"> 1. Unplugged at wall outlet. 2. Push switch is not in "ON" position. 3. No voltage in wall outlet. 4. Over-heating protection for the motor is activated. 	<ol style="list-style-type: none"> 1. Plug in firmly; push switch button. 2. Push switch button. 3. Check fuse or breaker. 4. Check dustbag, blockages and allow the motor to cool down for 2 hours then switch on.
Cleaner suction low.	<ol style="list-style-type: none"> 1. Full or clogged dust bag or airflow blockade. 2. Hole in hose. 3. Clogged the universal nozzle. 4. The filter cover open. 5. Hose is not properly connected to cleaner. 6. Power control regulator is located on the low power position. 	<ol style="list-style-type: none"> 1. Clean the cloth filter bag or check the airflow passage. 2. Replace hose. 3. Clean the airflow passage of nozzle. 4. Close the filter cover. 5. Ensure hose is properly connected. 6. Slide power control regulator to the proper position.
Cleaner picks up movable rugs or the universal nozzle pushes too hard.	<ol style="list-style-type: none"> 1. Suction too strong. 	<ol style="list-style-type: none"> 1. Regulate power with the power control regulator.

SPECIFICATIONS

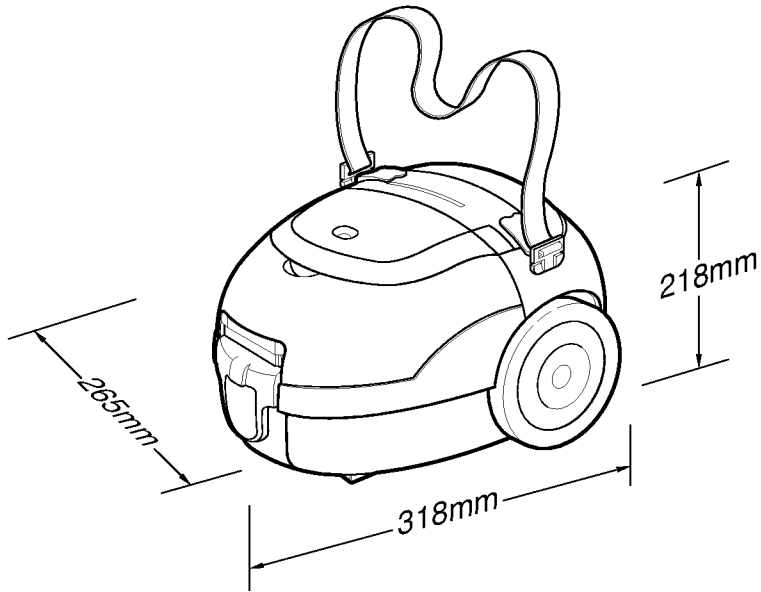

- POWER SOURCE: ON RATING PLATE
- CAPACITY: 1.8 l
- CORD LENGTH: 5m
- NET WEIGHT: 3.8kg
- NET DIMENSIONS: 265 × 318 × 218mm
- PACKING DIMENSIONS: 500 × 310 × 292mm
- ATTACHMENTS

HOSE 1 EA	NOZZLE 1 EA
EXTENSION WAND 2(1) EA (TELESCOPIC PIPE)	DUSTING BRUSH (OPTION) (1)EA
EXTRA FILTER BAG5 EA	CREVICE TOOL 1 EA
	STRAP ASM1 EA
	UPHOLSTERY NOZZLE (OPTION)(1)EA

* These specifications are subject to change according to the agent/buyer's request.

MEMO