

W1_XC62_ENG_MFL38289224



MODEL : XC62

ENGLISH

There is so much your Hi-Fi system can do

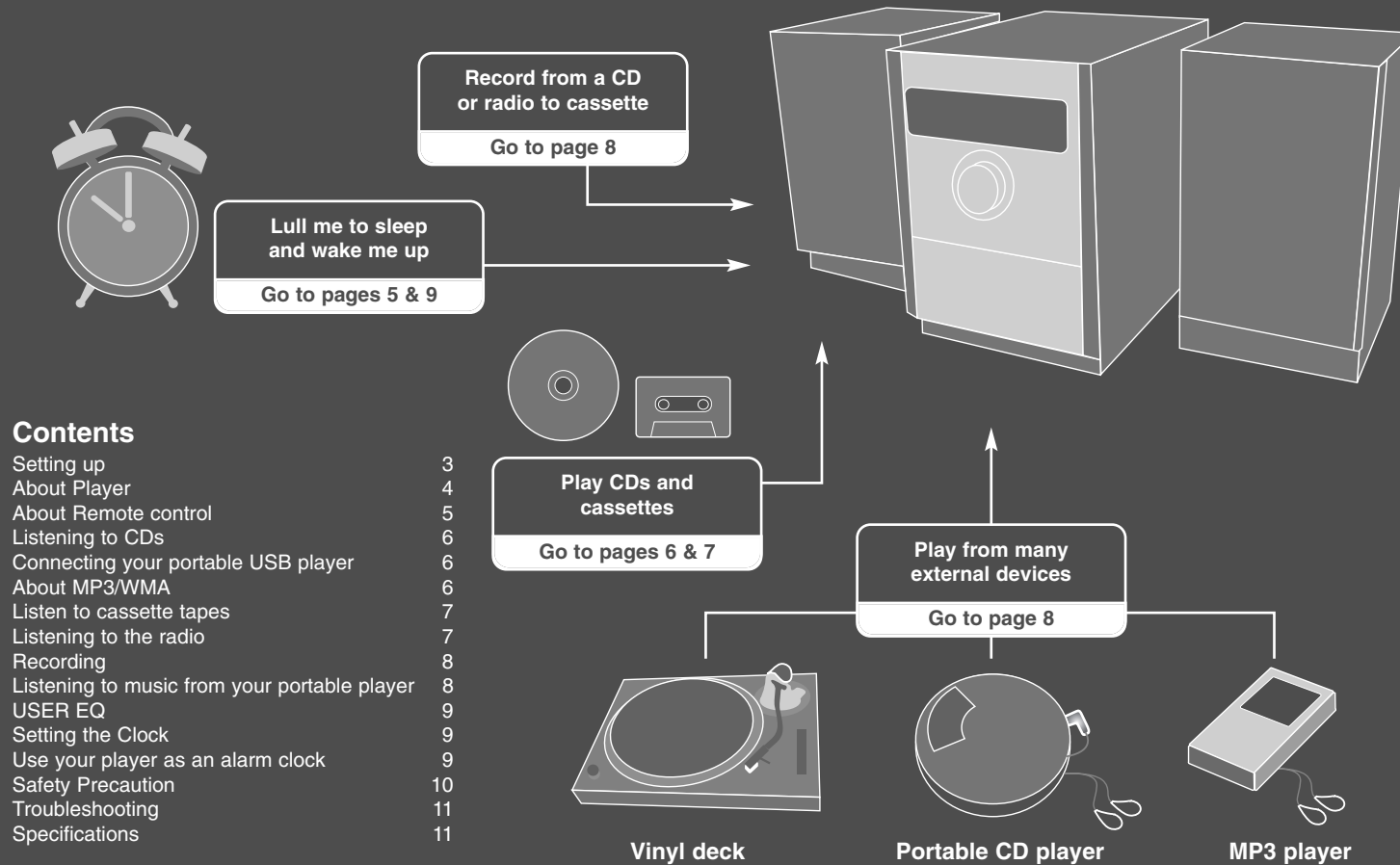

Before connecting, operating or adjusting this product, please read this instruction booklet carefully and completely.

Setting up

1 Connect the speaker cables to the player

Cables from the left-hand speaker connect to the terminal marked L (left) + (plus) and - (minus). Cables from the right-hand speaker are connected to the terminal marked R (right) + (plus) and - (minus). To connect the cable to the player, press each of the four square plastic finger pads on the rear of the player. The connector will open ready to receive a cable.

Put the batteries in the remote control

Make sure that the + (plus) and - (minus) on the batteries (size AAA) match those on the remote control.

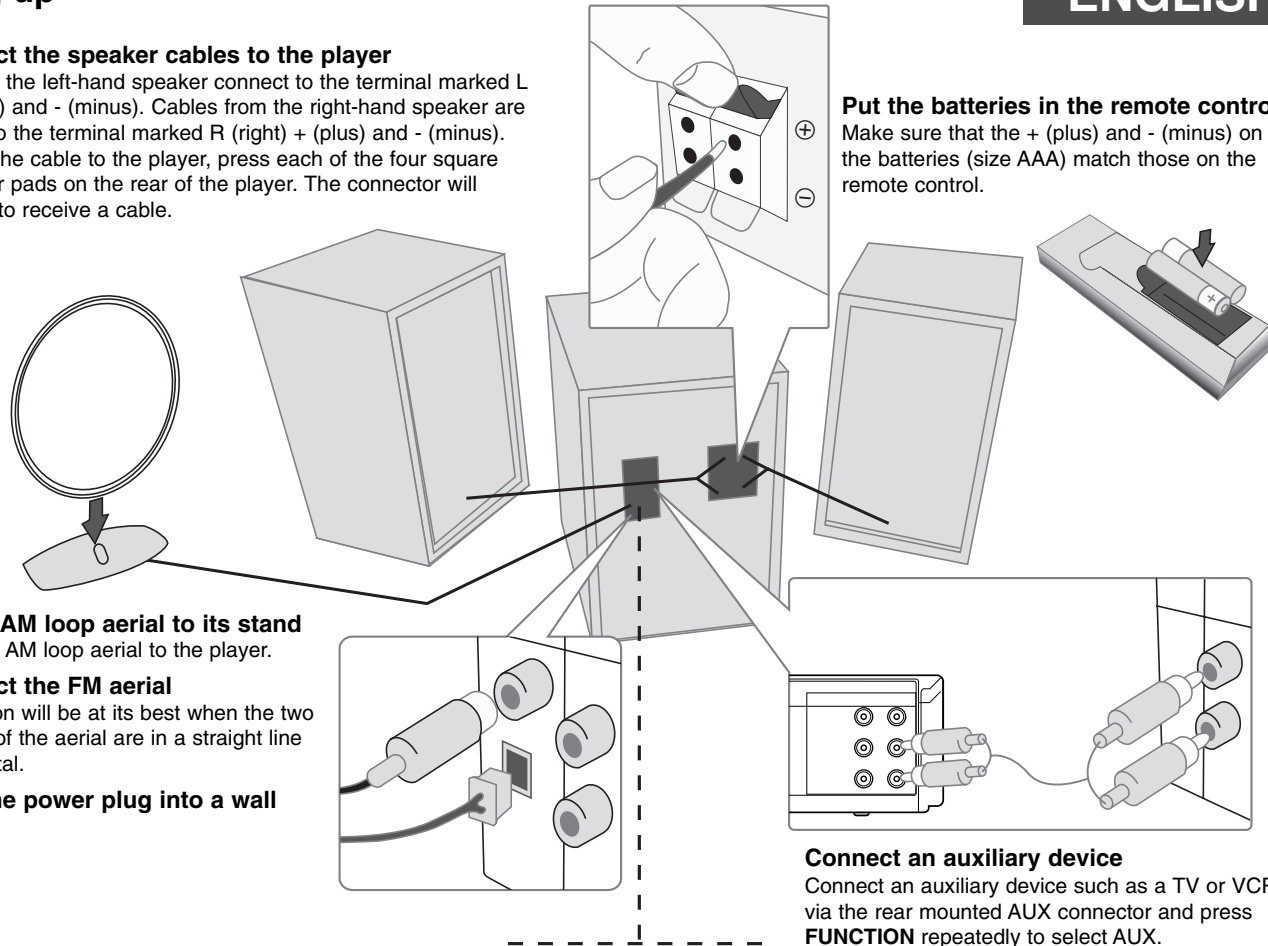

2 Fit the AM loop aerial to its stand

Connect the AM loop aerial to the player.

3 Connect the FM aerial

The reception will be at its best when the two loose ends of the aerial are in a straight line and horizontal.



4 Plug the power plug into a wall socket

Connect an auxiliary device

Connect an auxiliary device such as a TV or VCR via the rear mounted AUX connector and press **FUNCTION** repeatedly to select AUX.

About Player

(POWER)

You can set up the unit into an economic power save mode. In the power-on status, press and hold  for about 3 seconds. To cancel power save mode, press .

VOLUME

Control the volume when using any function.

PORT.IN

For connecting a portable device and playing it through the system's speakers.

Headphone jack

Connect a headphone plug (∅3.5 mm) into the jack to listen to the sound through headphones. Connecting headphones (not supplied) will switch off the speakers.

eXtreme Dynamic Sound System

Reinforce the treble, bass and surround sound effect. XDSS ON will show in the display. Press again for NORMAL.

MP3 Optimizer

Optimizes compressible MP3 files so that it improves the bass sound. (XDSS ON → MP3-- OPT ON → NORMAL)

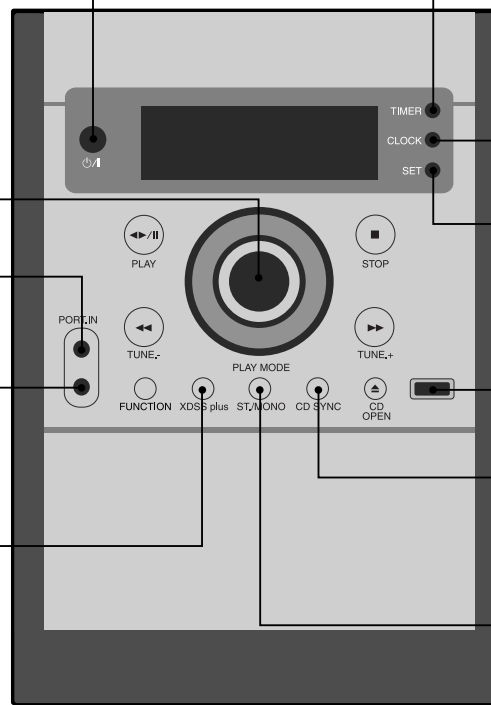

TIMER

With the TIMER function you can turn CD play and radio reception on or off at a desired time. (see Use your player as an alarm clock)

CLOCK

For setting the clock and checking the time. (see Setting the clock)

SET/RDS (OPTIONAL)

SET confirms the time you have selected when setting the clock. (see Setting the clock)
RDS shows information about radio stations. (see Listening to the radio)



USB connector

Connect a remote USB compatible player here.

CD SYNC

The CD synchro recording function dubs a complete CD and programmed titles automatically into a cassette. (see CD Synchronized Recording)

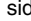
PLAY MODE

You can set the tape to play one side , both sides , or both sides six times , by pressing **PLAY MODE** one or more times. (see Listen to cassette tapes)

About Remote control

Search for a folder of MP3/WMA files

When a CD containing MP3/WMA files in several folders is being played, press **PRESET/FOLDER** to select the folder you want to play.

Choose a 'preset number' for a radio station (see Listening to the radio)

Fall asleep while listening to your player

Firstly, start a radio station or music. Press **SLEEP** one or more times to select delay time between 10 and 180 minutes, after the player will turn off.

Use when playing a CD

Moving to other cards

In case that more than two memory cards are connected to the USB port, press **D.SKIP** to select a card you want to use.

Optimise the sound

The function creates the optimum sound for you to play of the original sound. Each time you press **XTS Pro**, "XTS -- PRO ON" or "XTS -- PRO OFF" is displayed in turn. (The XTS Pro function will not be operated when a head-phone has been connected.)

See information about your music

MP3/WMA files often come with tags. The tag gives the Title, Artist, Album or Time information. Press **MP3 Info** while a file is playing to see this information.

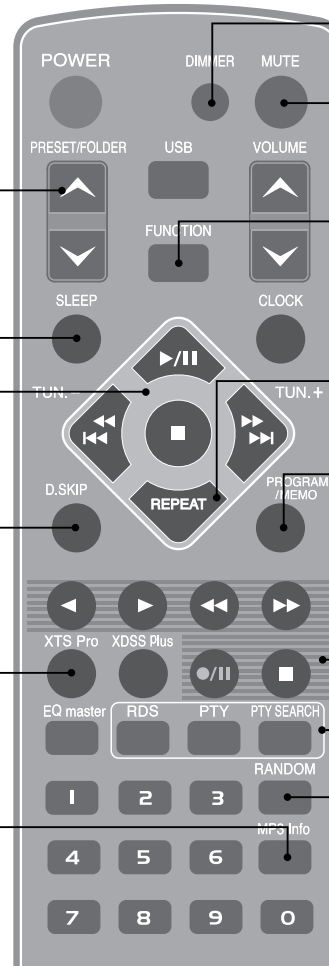

Dimm the display light

Temporarily stop the sound
Press the button again to return to the sound.

To change the functions
Change the functions between FM, AM, CD, AUX, PORTABLE, TAPE etc.

Listen to your tracks again and again
Press **REPEAT** once to repeat the track currently playing. Press **REPEAT** twice to repeat the whole CD, or if you're listening to the whole folder of MP3/WMA CD. The display will show what is being repeated.

For storing radio stations
If you have saved radio stations using **PROGRAM/MEMO**, you can scroll through them and select one. (see Listening to the radio)

Listen to your tracks in any order
(see Listening to the CDs)

Use when playing a cassette tape

Search radio stations by radio type
- **OPTIONAL** (See Listening to the radio).

Set the system playing CD tracks or MP3/WMA files in a random order. Press again to cancel.

Listening to CDs

| | ON PLAYER | ON REMOTE |
|--|-------------------|-----------------|
| 1. Open the CD drawer: | ▲ CD OPEN | |
| 2. Insert the CD: Label facing up | | |
| 3. Close the CD drawer: The display will show the total number of tracks (files) | ▲ CD OPEN | |
| 4. Select the CD function: | FUNCTION | FUNCTION |
| 5. Start the CD playing: | ◀▶/II PLAY | ▶/II |
| 6. To stop a CD playing: | ■ STOP | ■ |

Listening to CDs - more you can do

Pause or restart a CD

Press **◀▶/II PLAY** on the front panel or **▶/II** on the remote control during playback. Press this button again to resume play.

Search for a section within a track

Hold **◀◀/▶▶** on the front panel or **◀◀◀◀/▶▶▶▶** on the remote control during playback. (This function is only available for Audio CD's.)

Skip to another track

Press **◀◀/▶▶** on the front panel or **◀◀◀◀/▶▶▶▶** on the remote control.

Listen to your tracks in any order

Up to 20 tracks on a CD can be listened to in the order of your choice. Insert a CD and wait for it to be read. Press **PROGRAM/MEMO** on the remote control, then use **◀◀/▶▶** on the front panel or **◀◀◀◀/▶▶▶▶** on the remote control to select the track. Press **PROGRAM/MEMO** again to save and select the next track. Press **◀▶/II PLAY** or **▶/II**. To clear your selection, press **■** (or **■ STOP**), **PROGRAM/MEMO**, **■** (or **■ STOP**).

Connecting your portable USB player

The advantage of connecting your portable USB player through the system's USB port is that the portable device can be controlled from the system. Connect the portable player to the system using a USB cable (not supplied).

| | ON PLAYER | ON REMOTE |
|---|-------------------|-----------------|
| 1. Select the USB function: | FUNCTION | USB |
| 2. The display will show CHECKING, followed by the number of files displayed: | | |
| 3. Press: | ◀▶/II PLAY | ▶/II |
| 4. Before disconnecting the portable USB player, change to any other function by pressing: | FUNCTION | FUNCTION |
| 5. Remove the USB player: | | |

NOTE : Some portable devices are not compatible with this system.

About MP3/WMA

MP3/WMA Disc compatibility with this unit is limited as follows:

- Sampling Frequency : 8 - 48 kHz (MP3), 32 - 48 kHz (WMA)
- Bit rate : 8 - 320 kbps (MP3), 48 - 320 kbps (WMA)
- CD-R physical format should be "ISO 9660"
- If you record MP3/WMA files using the software which cannot create a FILE SYSTEM, for example "Direct-CD" etc., it is impossible to playback MP3 files. We recommend that you use "Easy-CD Creator", which creates an ISO 9660 file system.
- File names should be named using 30 letters or less and must incorporate ".mp3", ".wma" extension e.g. "*****.MP3" or "*****.WMA"
- Do not use special letters such as "/ : * ? " < >" etc.
- Even if the total number of files on the disc has more than 1000, it will only be shown up to 999.

Listen to cassette tapes

| | ON PLAYER | ON REMOTE |
|------------------------------|--------------|---------------|
| 1. Open the tape door: | ▲ PUSH EJECT | |
| 2. Insert the tape: | | |
| 3. Close the tape door: | | |
| 4. Select the TAPE function: | FUNCTION | FUNCTION |
| 5. Start the tape playing: | ◀▶/II PLAY | ◀ or ▶ |
| 6. To stop a tape playing: | ■ STOP | ■ (TAPE STOP) |

Listen to cassette tapes - more you can do

To Play Fast backward or Forward

After pressing ◀◀/▶▶ during playback, or stop, press ◀ or ▶ at a point you want.

Listening to the radio

Make sure both the FM and AM aerials are connected.

| | ON PLAYER | ON REMOTE |
|--|----------------|---------------|
| 1. Select either FM or AM: | FUNCTION | FUNCTION |
| 2. Select the radio station: | TUNE.-/ TUNE.+ | TUN.-/ TUN.+ |
| 3. To 'save' a radio station: A preset number will show in the display. | | PROGRAM/MEMO |
| 4. To select a 'saved' station: | | PRESET/FOLDER |
| 5. To confirm press: Up to 50 radio stations can be saved. | | PROGRAM/MEMO |

Listening to the radio - more you can do

Look for radio stations automatically

Press **TUNE.-/TUNE.+** on the front panel (or press **TUN.-/TUN.+** on the remote control) for more than 0.5 second. The tuner will scan automatically and stop when it finds a radio station.

Delete all the saved stations

Press and hold **PROGRAM/MEMO** for two seconds. "ERASE ALL" shows. Press **PROGRAM/MEMO** to erase all the saved stations.

Choose a 'preset number' for a radio station

Select a station you want by pressing **TUNE.-/TUNE.+** on the front panel or **TUN.-/TUN.+** on the remote control. Press **PROGRAM/MEMO**, the station flashes. Press **PRESET/FOLDER** on the remote control to select the preset number you want. Press **PROGRAM/MEMO** to save it.

Improve poor FM reception

Press **ST./MONO**. This will change the tuner from stereo to mono and usually improve the reception.

See information about your radio stations - OPTIONAL

The FM tuner is supplied with the Radio Data System (RDS) facility. This shows the letters RDS on the display, plus information about the radio station being listened to. Press **RDS** on the remote control several times to view the information.

PTY - Programme Type, such as News, Sport, Jazz Music.

RT - Radio Text, the name of the radio station.

CT - Time Control, the time at the location of the radio station.

PS - Programme Service name, the name of channel.

You can search the radio stations by programme type by pressing **PTY**. The display will show the last **PTY** in use. Press **PTY** one or more times to select your preferred programme type. Press and hold **PTY SEARCH**. The tuner will search automatically. When a station is found the search will stop.

Recording

Record from a CD or radio to cassette

| | ON PLAYER | ON REMOTE |
|---|--------------|-----------|
| 1. Open the tape door: | ▲ PUSH EJECT | |
| 2. Insert a blank tape: | | |
| 3. Close the tape door: | | |
| 4. Select a mode (FM/AM, CD, USB, AUX or PORTABLE) in which you want to record: - For CD, press ◀▶/II or ▶/II. | FUNCTION | FUNCTION |
| 5. Start the Recording: | | ●/II |
| 6. To stop a Recording: | | ■ |

CD Synchronized Recording

| | ON PLAYER | ON REMOTE |
|---|--------------|-----------|
| 1. Open the tape door: | ▲ PUSH EJECT | |
| 2. Insert a blank tape: | | |
| 3. Select the CD function: | FUNCTION | FUNCTION |
| 4. Start the Recording: The synchronized recording is started automatically after about 7 seconds. | CD SYNC | |
| 5. To stop a Recording: | ■ STOP | |

Listening to music from your portable player

The player can be used to play the music from many types of portable player.

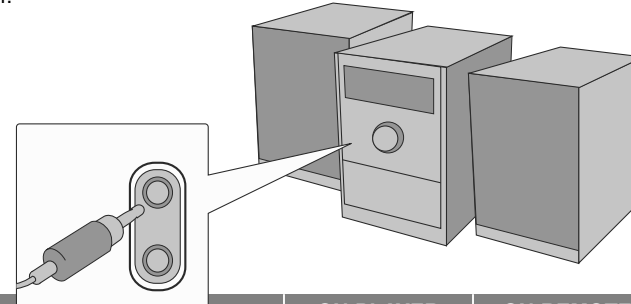

| | ON PLAYER | ON REMOTE |
|--|-----------|-----------|
| 1. Connect the portable player by plugging the unit into PORT. IN on the front of the player | | |
| 2. Turn the power on: | ⏻/II | POWER |
| 3. Select the PORTABLE function: | FUNCTION | FUNCTION |
| 4. Turn the portable player on and start it playing: | | |

USER EQ

You can listen to music with the desired sound effect (BASS, MIDDLE and TREBLE).

| | ON PLAYER | ON REMOTE |
|---|--|------------------|
| 1. Select a "USER EQ": | | EQ master |
| 2. When "USER EQ" is displayed, press: | SET | |
| 3. Select the sound effect you want among BASS, MIDDLE or TREBLE: | ◀▶/ PLAY or ■ STOP | |
| 4. Adjust sound level (MIN, -4 to +4, MAX): | ◀◀ or ▶▶ | |
| 5. Repeat the steps from 3 to 4 to set other sound effect: | | |
| 6. Press: | SET | |

Setting the Clock

| | ON PLAYER | ON REMOTE |
|--|-----------------|--------------|
| 1. Turn the power on: | ⏻/ | POWER |
| 2. Press for at least 2 seconds: | CLOCK | CLOCK |
| 3. Choose from either: AM 12:00 (for an am and pm display) or 0:00 (for a 24 hour display). | ◀◀ or ▶▶ | |
| 4. Confirm your selection: | SET | |
| 5. Select the hours: | ◀◀ or ▶▶ | |
| 6. Press: | SET | |
| 7. Select the minutes: | ◀◀ or ▶▶ | |
| 8. Press: | SET | |

Use your player as an alarm clock

Press and hold **TIMER** for two seconds. Each function, TUNER, CD, USB, TAPE flashes for two seconds. Press **SET** when the function you want to be woken by is showing. If you choose TUNER, 'PLAY' and 'REC' flash, PLAY and REC. Choose one of them.

If you choose TUNER and PLAY you will be shown the stations you have saved as presets. Use **◀◀** or **▶▶** to select the station you want, then press **SET**.

You will be shown the ON TIME display. This is where you set the time you want the alarm to go off. Use **◀◀** or **▶▶** to change the hours and minutes and **SET** to save.

You will then be shown the OFF TIME display. This is where you set the time you want the function to stop. Use **◀◀** or **▶▶** to change the hours and minutes and press **SET** to save.

Next you will be shown the volume (VOL) you want to be woken by. Use **◀◀** or **▶▶** to change the volume and **SET** to save. Switch the system off. The clock icon shows that the alarm is set.

When the system is turned off you can check the time the alarm is set for by pressing **TIMER**. You can also turn the alarm on and off by pressing **TIMER**. To set the alarm to go off at a different time, switch the system on and reprogramme following the same steps as initially.

Safety Precaution



CAUTION: TO REDUCE THE RISK OF ELECTRIC SHOCK DO NOT REMOVE COVER (OR BACK) NO USER-SERVICEABLE PARTS INSIDE REFER SERVICING TO QUALIFIED SERVICE PERSONNEL.



This lightning flash with arrowhead symbol within an equilateral triangle is intended to alert the user to the presence of uninsulated dangerous voltage within the product's enclosure that may be of sufficient magnitude to constitute a risk of electric shock to persons.



The exclamation point within an equilateral triangle is intended to alert the user to the presence of important operating and maintenance (servicing) instructions in the literature accompanying the product.

WARNING: TO PREVENT FIRE OR ELECTRIC SHOCK HAZARD, DO NOT EXPOSE THIS PRODUCT TO RAIN OR MOISTURE.

WARNING: Do not install this equipment in a confined space such as a book case or similar unit.

CAUTION: Do not block any ventilation openings. Install in accordance with the manufacturer's instructions.

Slots and openings in the cabinet are provided for ventilation and to ensure reliable operation of the product and to protect it from over heating. The openings should be never be blocked by placing the product on a bed, sofa, rug or other similar surface. This product should not be placed in a built-in installation such as a bookcase or rack unless proper ventilation is provided or the manufacturer's instruction has been adhered to.

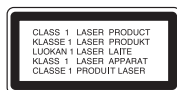

CAUTION:

This product employs a Laser System.

To ensure proper use of this product, please read this owner's manual carefully and retain it for future reference. Should the unit require maintenance, contact an authorized service center. Use of controls, adjustments or the performance of procedures other than those specified herein may result in hazardous radiation exposure.

To prevent direct exposure to laser beam, do not try to open the enclosure. Visible laser radiation when open. DO NOT STARE INTO BEAM.

CAUTION: The apparatus should not be exposed to water (dripping or splashing) and no objects filled with liquids, such as vases, should be placed on the apparatus.

CAUTION concerning the Power Cord

Most appliances recommend they be placed upon a dedicated circuit;

That is, a single outlet circuit which powers only that appliance and has no additional outlets or branch circuits. Check the specification page of this owner's manual to be certain.

Do not overload wall outlets. Overloaded wall outlets, loose or damaged wall outlets, extension cords, frayed power cords, or damaged or cracked wire insulation are dangerous. Any of these conditions could result in electric shock or fire. Periodically examine the cord of your appliance, and if its appearance indicates damage or deterioration, unplug it, discontinue use of the appliance, and have the cord replaced with an exact replacement part by an authorized servicer.

Protect the power cord from physical or mechanical abuse, such as being twisted, kinked, pinched, closed in a door, or walked upon. Pay particular attention to plugs, wall outlets, and the point where the cord exits the appliance.

To disconnect power from the mains, pull out the mains cord plug. When installing the product, ensure that the plug is easily accessible.



Disposal of your old appliance

1. When this crossed-out wheeled bin symbol is attached to a product it means the product is covered by the European Directive 2002/96/EC.
2. All electrical and electronic products should be disposed of separately from the municipal waste stream via designated collection facilities appointed by the government or the local authorities.
3. The correct disposal of your old appliance will help prevent potential negative consequences for the environment and human health.
4. For more detailed information about disposal of your old appliance, please contact your city office, waste disposal service or the shop where you purchased the product.



This product is manufactured to comply with EMC Directive 2004/108/EC and Low Voltage Directive 2006/95/EC.

European representative :

LG Electronics Service Europe B.V. Veluwezoom 15, 1327 AE Almere, The Netherlands
(Tel : +31-036-547-8940)

Troubleshooting

| Symptom | Cause | Correction |
|--|--|---|
| No power. | <ul style="list-style-type: none"> The power cord is disconnected. | <ul style="list-style-type: none"> Plug the power cord into the wall outlet securely. |
| No sound. | <ul style="list-style-type: none"> The power of the external source equipment is turned off. | <ul style="list-style-type: none"> Switch on the external source equipment. |
| | <ul style="list-style-type: none"> The speaker cable is connected to a wrong position. | <ul style="list-style-type: none"> Set the speaker cable to the correct position, then turn on the unit again by pressing POWER. |
| The unit does not start playback. | <ul style="list-style-type: none"> An unplayable disc is inserted. | <ul style="list-style-type: none"> Insert a playable disc. |
| | <ul style="list-style-type: none"> The disc is placed upside down. | <ul style="list-style-type: none"> Place the disc with the playback side down. |
| | <ul style="list-style-type: none"> The disc is not placed within the guide. The disc is dirty. | <ul style="list-style-type: none"> Place the disc on the disc tray correctly inside the guide. Clean the disc. |
| The remote control does not work properly. | <ul style="list-style-type: none"> The remote control is not pointed at the remote sensor of the unit. | <ul style="list-style-type: none"> Point the remote control at the remote sensor of the unit. |
| | <ul style="list-style-type: none"> The remote control is too far from the unit. | <ul style="list-style-type: none"> Operate the remote control within about 23 ft (7 m). |
| | <ul style="list-style-type: none"> There is an obstacle in the path of the remote control and the unit. | <ul style="list-style-type: none"> Remove the obstacle. |
| | <ul style="list-style-type: none"> The batteries in the remote control are exhausted. | <ul style="list-style-type: none"> Replace the batteries with new ones. |
| Unable to record. | <ul style="list-style-type: none"> Record protect tabs are removed. | <ul style="list-style-type: none"> Cover holes on back edge of tape with tap. |

Specifications

| | |
|-----------------------------|---|
| General | |
| Net Weight | 3.4 kg |
| External dimensions (WxHxD) | 170 x 243 x 282 mm |
| Tuner | |
| FM Tuning Range | 87.5 - 108.0 MHz or 65 - 74 MHz, 87.5 - 108.0 MHz |
| AM Tuning Range | 522 - 1620 kHz or 520 - 1720 kHz |
| Amplifier | |
| Output Power | 30 W + 30 W |
| T.H.D | 0.5 % |
| Frequency Response | 40 - 20000 Hz |
| Signal-to-noise ratio | 75 dB |
| CD | |
| Frequency response | 40 - 20000 Hz |
| Signal-to-noise ratio | 75 dB |
| Dynamic range | 75 dB |
| Cassette tape player | |
| F.F/REW Time | 120 sec (C-60) |
| Frequency Response | 250 - 8000 Hz |
| Signal to Noise Ratio | 43 dB |
| Channel Separation | 45 dB (P/B)/45 dB (R/P) |
| Erase Ratio | 50 dB (MTT-5511) |
| Speakers (XCS62F) | |
| Type | 1 Way 1 Speaker |
| Impedance | 4 Ω |
| Frequency Response | 75 - 17000 Hz |
| Sound Pressure Level | 83 dB/W (1m) |
| Rated Input Power | 30 W |
| Max. Input Power | 60 W |
| Net Dimensions (WxHxD) | 144 x 243 x 171 mm |
| Net Weight (1EA) | 1.47 kg |

Designs and specifications are subject to change without notice.



P/NO : MFL38289224