

W2\_PC12\_ENG\_MFL40699302



**MODEL : PC12 (PC12-UD)**

ENGLISH



**iPod is a trademark of Apple Computer, Inc, registered in the U.S. and other countries.**

## There is so much your Hi-Fi system can do

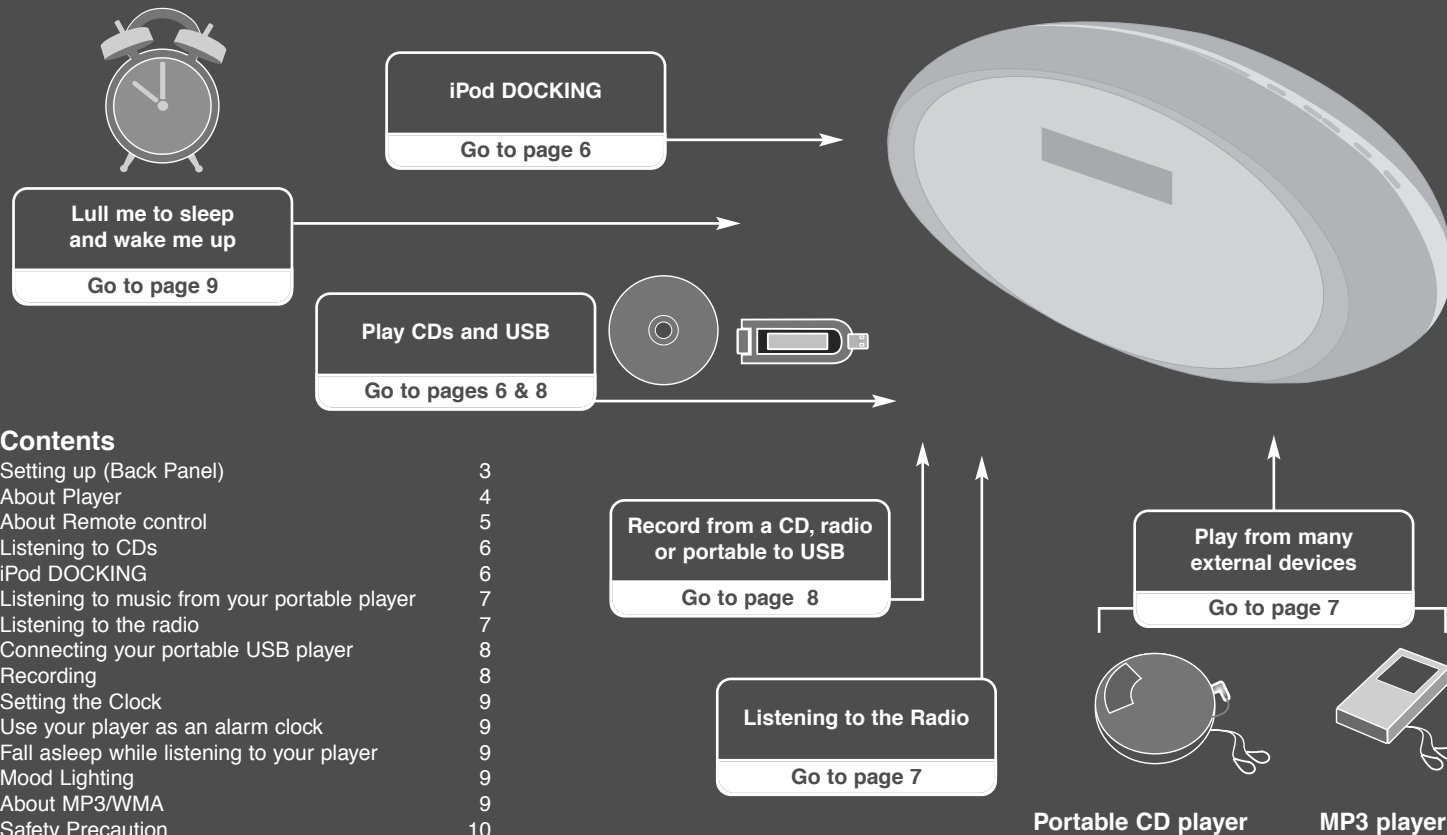

### Contents

Setting up (Back Panel)	3
About Player	4
About Remote control	5
Listening to CDs	6
iPod DOCKING	6
Listening to music from your portable player	7
Listening to the radio	7
Connecting your portable USB player	8
Recording	8
Setting the Clock	9
Use your player as an alarm clock	9
Fall asleep while listening to your player	9
Mood Lighting	9
About MP3/WMA	9
Safety Precaution	10
Troubleshooting	11
Specifications	11

Before connecting, operating or adjusting this product, please read this instruction booklet carefully and completely.

Setting up (Back Panel)

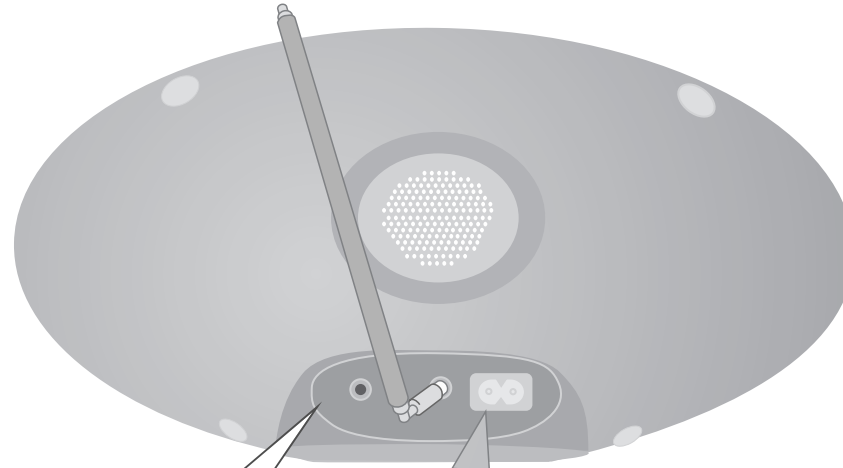

**PHONES (Headphone jack)**

Connect a headphone plug (∅3.5 mm) into the jack to listen to the sound through headphones. Connecting headphones (not supplied) will switch off the speakers.

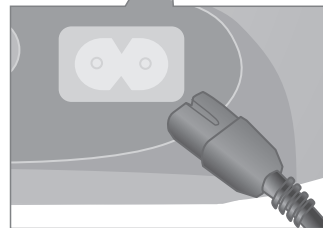

**Plug the AC power Cord into a wall socket**

- a. Before connecting the AC power cord, check whether the operating voltage of your unit is identical with the voltage of your local power supplied.
- b. Connect one end of the AC power cord (supplied) to the AC IN socket located at the backside of your unit.
- c. Plug the other end into the wall outlet.

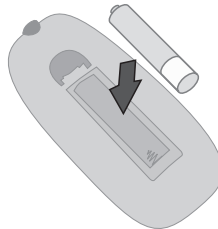

**Put the battery in the remote control**

Make sure that the + (plus) and - (minus) on the battery (size AAA) match those on the remote control.

## About Player

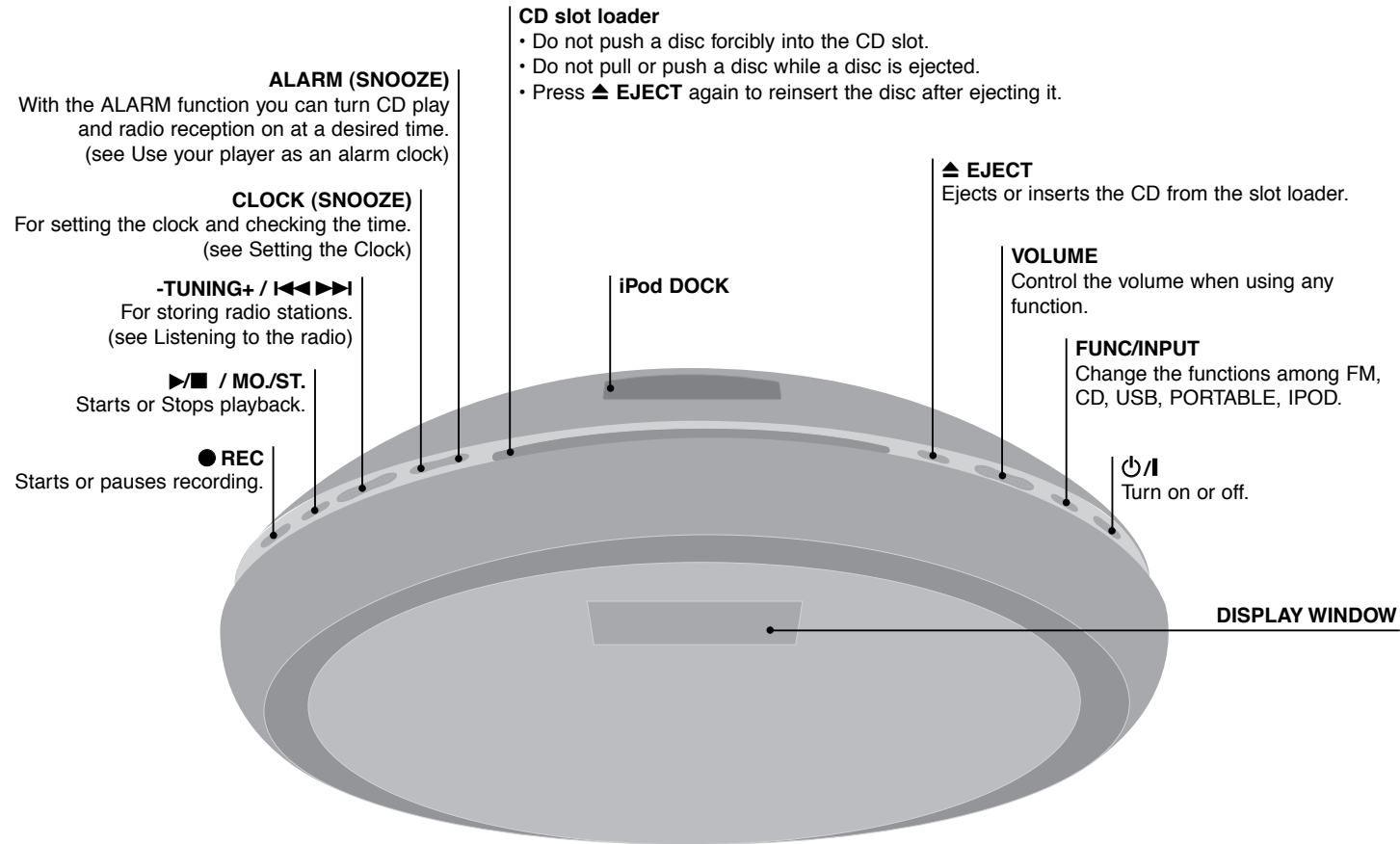

## About Remote control

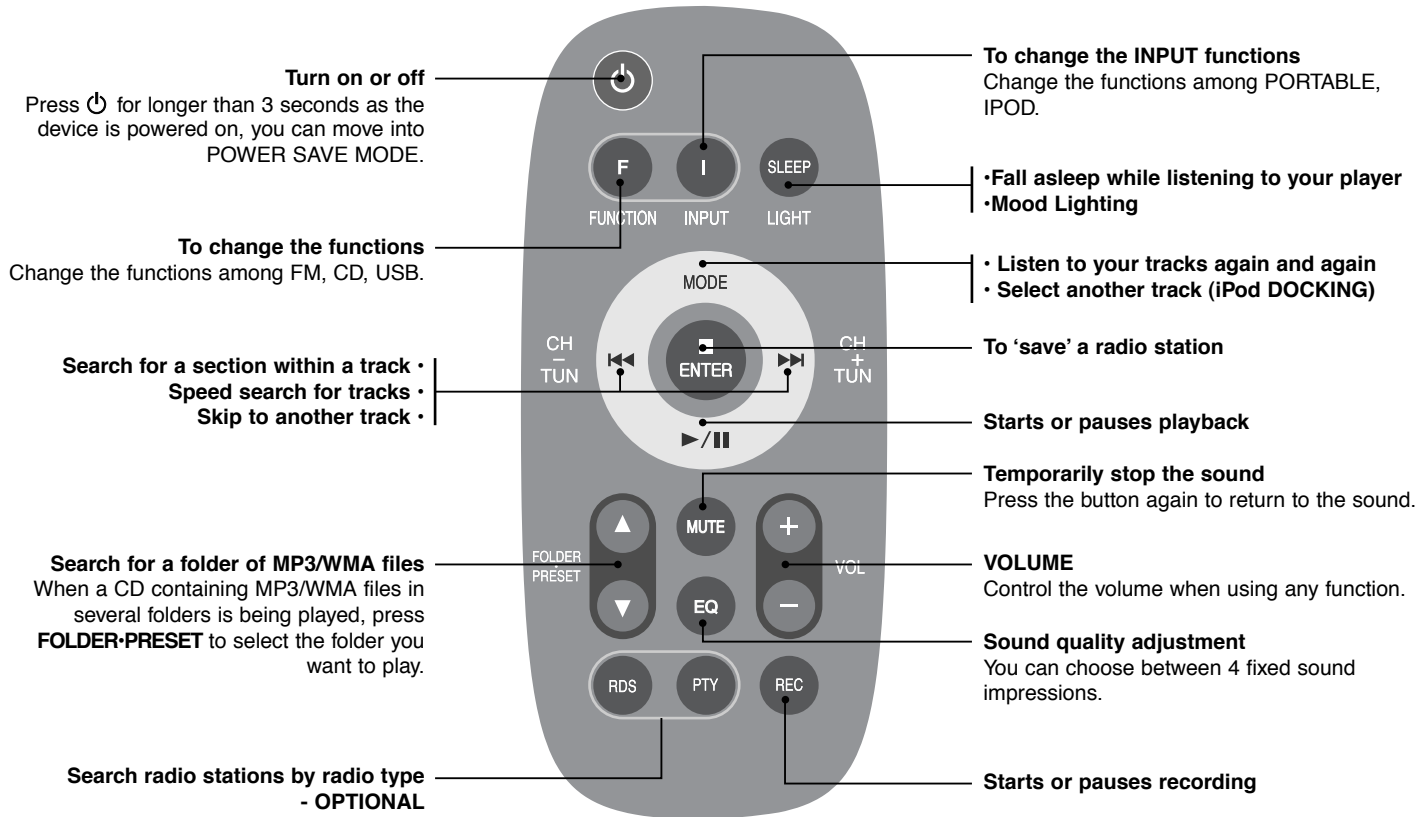

## Listening to CDs

Audio CD and MP3/WMA CD can be played back in this player.

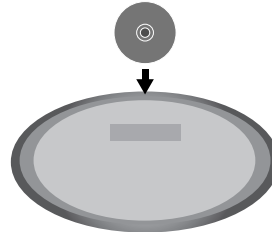

	ON PLAYER	ON REMOTE
<b>1. Insert the CD:</b> The display will show the total number of tracks (files).	▲ EJECT	
<b>2. Select the CD function:</b>	FUNC/INPUT	FUNCTION
<b>3. Start the CD playing:</b>	▶/■	▶/
<b>4. To stop a CD playing:</b>	▶/■	■ ENTER

### Listening to CDs - more you can do

#### Pause or restart a CD

Press ▶/|| on the remote control during playback. Press this button again to resume play.

#### Search for a section within a track

Hold ◀◀/▶▶ on either the player or the remote control during playback.

#### Skip to another track

Press ◀◀/▶▶ on either the player or the remote control.

#### Speed search for tracks

Hold ◀◀/▶▶ on either the player or the remote control only in stop status. Track skips continuously in turn.

#### Listen to your tracks again and again

Press MODE on the remote control repeatedly, the display changes in the following order, RPT 1 - RPT ALL - RANDOM - OFF.

## iPod DOCKING

You can listen to music by connecting iPod to the player. Connect iPod to "iPod DOCK" on the upper part of the player.

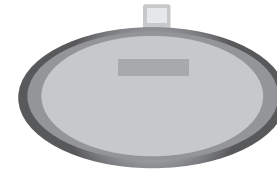

	ON PLAYER	ON REMOTE
<b>1. Select the iPod function:</b>	FUNC/INPUT	INPUT
<b>2. "IPOD" displays:</b>		
<b>3. Start the playing:</b>	▶/■	▶/
<b>4. Before disconnecting the iPod, change to any other function by pressing:</b>	FUNC/INPUT	FUNCTION or INPUT
<b>5. Remove iPod:</b>		

### iPod DOCKING - more you can do

#### Pause or restart an iPod

Press ▶/■ on the player or ▶/|| on the remote control during playback. Press this button again to resume play.

#### Search for a section within a track

Hold ◀◀/▶▶ on either the player or the remote control during playback.

#### Skip to another track

Press ◀◀/▶▶ on either the player or the remote control.

#### Select another track

Press MODE on the remote control, you can move to the previous list. Press FOLDER-PRESET on the remote control, you can move to a desired item. Then, press ■ ENTER on the remote control, you can confirm it.

#### NOTE :

- When the connection with iPod is not solid and the remaining battery is not enough, the message "ERROR" is displayed.
- iPod is automatically charged when connected to the player.

## Listening to music from your portable player

The player can be used to play the music from many types of portable player.

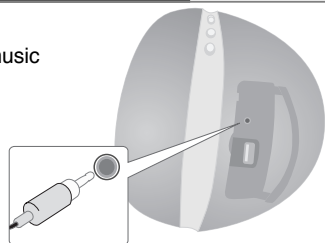

	ON PLAYER	ON REMOTE
1. Connect the portable player by plugging the unit into <b>PORTABLE IN</b> on the side of the player:		
2. Turn the power on:	⏻/⏻	⏻
3. Select the <b>PORTABLE</b> function:	<b>FUNC/INPUT</b>	<b>INPUT</b>
4. Turn the portable player on and start it playing:		

## Listening to the radio

	ON PLAYER	ON REMOTE
1. Select the <b>FM</b> :	<b>FUNC/INPUT</b>	<b>FUNCTION</b>
2. Select the radio station:	⏮/⏭	⏮/⏭
3. To 'save' a radio station: A preset number will show in the display.		■ <b>ENTER</b>
4. To select a 'saved' station:		<b>FOLDER-PRESET</b>
5. To confirm press: Up to 30 radio stations can be saved.		■ <b>ENTER</b>

## Listening to the radio - more you can do

### Look for radio stations automatically

Press **⏮/⏭** on either the player or the remote control for more than 0.5 second. The tuner will scan automatically and stop when it finds a radio station.

### Delete all the saved stations

Press and hold **■ ENTER** on the remote control for two seconds. "ERASE" shows. Press **■ ENTER** on the remote control to erase all the saved stations.

### Choose a 'preset number' for a radio station

Select a station you want by pressing **⏮/⏭**. Press **■ ENTER**, the station flashes. Press **FOLDER-PRESET** on the remote control to select the preset number you want. Press **■ ENTER** to save it.

### Improve poor FM reception

Press **MO/ST.** on the player or **▶/||** on the remote control. This will change the tuner from stereo to mono and usually improve the reception. Or connect the antenna securely.

### See information about your radio stations - OPTIONAL

The FM tuner is supplied with the Radio Data System (RDS) facility. This shows the letters RDS on the display, plus information about the radio station being listened to. Press **RDS** on the remote control several times to view the information.

**PTY** - Programme Type, such as News, Sport, Jazz.

**RT** - Radio Text, the name of the radio station.

**CT** - Time Control, the time at the location of the radio station.

**PS** - Programme Service name, the name of channel.

You can search the radio stations by programme type by pressing **RDS**.

The display will show the last **PTY** in use. Press **PTY** one or more times to select your preferred programme type. Press and hold **⏮/⏭**. The tuner will search automatically. When a station is found the search will stop.

## Connecting your portable USB player

The advantage of connecting your portable USB player through the system's USB port is that the portable device can be controlled from the system. Connect the portable player to the system using a USB cable (not supplied).

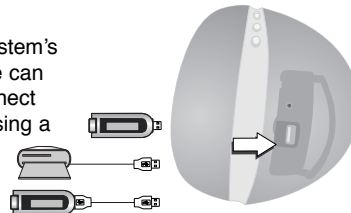

	ON PLAYER	ON REMOTE
<b>1. Select the USB function:</b>	<b>FUNC/INPUT</b>	<b>FUNCTION</b>
<b>2. The display will show "READ", followed by the number of files displayed:</b>		
<b>3. Press:</b>	<b>▶/■</b>	<b>▶/  </b>
<b>4. Before disconnecting the portable USB player, change to any other function by pressing:</b>	<b>FUNC/INPUT</b>	<b>FUNCTION or INPUT</b>
<b>5. Remove the USB player:</b>		

### NOTES :

- Some portable devices are not compatible with this system.
- When various cards are connected to the Memory Card Reader, the first detected card is recognized.
- **Do not extract the USB device in operating.**
- A back up demands to prevent a data damage.
- If you use a USB extension cable or USB hub, the USB device might not be recognized.
- A device using NTFS file system is not supported (Only the FAT (16/32) file system is supported.).
- The USB function of this unit does not support all USB devices.
- Digital camera and mobile phones are not supported.
- This unit is not supported when the total number of files is 1000 or more.

## Recording

### Record FM or PORTABLE source to USB

Connect USB to the player before recording.

	ON PLAYER	ON REMOTE
<b>1. Select a mode (PORTABLE or FM) in which you want to record:</b>	<b>FUNC/INPUT</b>	<b>FUNCTION or INPUT</b>
<b>2. Start the Recording:</b>	<b>● REC</b>	<b>REC</b>
<b>3. To stop a Recording:</b>	<b>▶/■</b>	<b>■ ENTER</b>

### Record Audio CD source to USB

You can record one desired track or all of the music tracks in Audio CD to USB. (The volume may not be adjusted to the Max limit during CD recording.)

	ON PLAYER	ON REMOTE
<b>1. Select the CD function:</b>	<b>FUNC/INPUT</b>	<b>FUNCTION</b>
<b>2. Select the track:</b>	<b>◀◀/▶▶</b>	<b>◀◀/▶▶</b>
<b>3. Start the Recording:</b>	<b>● REC</b>	<b>REC</b>
<b>4. To stop a Recording:</b>	<b>▶/■</b>	<b>■ ENTER</b>

### NOTES :

- Remove USB while recording, the recorded file may not be saved.
- Press **● REC (REC)** for longer than 3 seconds, you can select bit rate. Press **◀◀/▶▶** to select the bit rate and **● REC (REC)** again to select the recording speed. Press **◀◀/▶▶** to select a desired recording speed and **● REC (REC)** again to finish recording.
  - 1 x speed : You can listen to music while recording it. (FM, PORTABLE or Audio CD)
  - 2 x speed (Only 96kbps, 128kbps)
  - : You can just recording the music file. (Only Audio CD)

The making of unauthorized copies of copy-protected material, including computer programs, files, broadcasts and sound recordings, may be an infringement of copyrights and constitute a criminal offence. This equipment should not be used for such purposes.

**Be responsible  
Respect copyrights**



## Setting the Clock

	ON PLAYER
1. Turn the power on:	
2. Press for at least 2 seconds:	<b>CLOCK</b>
3. Choose from either: 12HR (for an am and pm display) or 24HR (for a 24 hour display).	
4. Confirm your selection:	<b>CLOCK</b>
5. Select the hours:	
6. Press:	<b>CLOCK</b>
7. Select the minutes:	
8. Press:	<b>CLOCK</b>

## Use your player as an alarm clock

Press and hold **ALARM** on the player for two seconds. Press repeatedly, the display changes in the following order, FM, CD, USB. Press **ALARM** when the function you want to be woken by is showing. Next, you set the time to get alarm activated. Use to change the hours and minutes and **ALARM** to save. Next, the volume (VOL) setting display appears. Use to change the volume and **ALARM** to save. The clock icon shows that the alarm is set. Switch the system off. When the system is turned off, you can check the time the alarm is set for by pressing **ALARM**. You can also turn the alarm on and off by pressing **ALARM**.

### NOTES :

- If you don't set clock, the alarm function doesn't work.
- When any button is not pressed for longer than 5 minutes with the alarm beeping, the alarm is automatically canceled.

### SNOOZE function

This function wakes you up every 5 minutes if you do not turn off the alarm. When alarm is on and you press **CLOCK** or **ALARM**, CD or USB is changed into pause & mute. And tuner is on mute mode for 5 minutes and then changed into play & mute off.

## Fall asleep while listening to your player

Press **SLEEP** on the remote control repeatedly, the display changes in the following order, SLP OFF - LIGHT - corresponding icons.

Press repeatedly on SLP OFF, the display changes in the following order, SLP 90 & dimmer ON -> SLP 80 & dimmer ON -> SLP 70 & dimmer ON -> SLP 60 & dimmer ON -> SLP 50 & dimmer ON -> SLP 40 & dimmer ON -> SLP 30 & dimmer ON -> SLP 20 & dimmer ON -> SLP 10 & dimmer ON -> SLP OFF & dimmer OFF.

## Mood Lighting

Press **SLEEP** on the remote control repeatedly, the display changes in the following order, SLP OFF - LIGHT - corresponding icons.

Press repeatedly on LIGHT, the display changes in the following order, L--1 -> L--2 -> L--3 -> L--OFF.

## About MP3/WMA

### MP3/WMA Disc compatibility with this unit is limited as follows:

- Sampling Frequency : 8 - 48 kHz (MP3), 32 - 48 kHz (WMA)
- Bit rate : 8 - 320 kbps (MP3), 48 - 320 kbps (WMA)
- CD-R physical format should be "ISO 9660"
- If you record MP3/WMA files using the software which cannot create a FILE SYSTEM, for example "Direct-CD" etc., it is impossible to playback MP3 files. We recommend that you use "Easy-CD Creator", which creates an ISO 9660 file system.
- Do not use special letters such as "/ : \* ? " < >" etc.
- Even if the total number of files on the disc has more than 1000, it will only be shown up to 999.

## Safety Precaution



**CAUTION:** TO REDUCE THE RISK OF ELECTRIC SHOCK DO NOT REMOVE COVER (OR BACK) NO USER-SERVICEABLE PARTS INSIDE REFER SERVICING TO QUALIFIED SERVICE PERSONNEL.



This lightning flash with arrowhead symbol within an equilateral triangle is intended to alert the user to the presence of uninsulated dangerous voltage within the product's enclosure that may be of sufficient magnitude to constitute a risk of electric shock to persons.



The exclamation point within an equilateral triangle is intended to alert the user to the presence of important operating and maintenance (servicing) instructions in the literature accompanying the product.

**WARNING:** TO PREVENT FIRE OR ELECTRIC SHOCK HAZARD, DO NOT EXPOSE THIS PRODUCT TO RAIN OR MOISTURE.

**WARNING:** Do not install this equipment in a confined space such as a book case or similar unit.

**CAUTION:** Do not block any ventilation openings. Install in accordance with the manufacturer's instructions.

Slots and openings in the cabinet are provided for ventilation and to ensure reliable operation of the product and to protect it from over heating. The openings should be never be blocked by placing the product on a bed, sofa, rug or other similar surface.

This product should not be placed in a built-in installation such as a bookcase or rack unless proper ventilation is provided or the manufacturer's instruction has been adhered to.

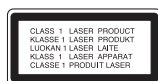

### CAUTION:

This product employs a Laser System.

To ensure proper use of this product, please read this owner's manual carefully and retain it for future reference. Should the unit require maintenance, contact an authorized service center. Use of controls, adjustments or the performance of procedures other than those specified herein may result in hazardous radiation exposure.

To prevent direct exposure to laser beam, do not try to open the enclosure. Visible laser radiation when open. DO NOT STARE INTO BEAM.

**CAUTION:** The apparatus should not be exposed to water (dripping or splashing) and no objects filled with liquids, such as vases, should be placed on the apparatus.

### CAUTION concerning the Power Cord

**Most appliances recommend they be placed upon a dedicated circuit;**

That is, a single outlet circuit which powers only that appliance and has no additional outlets or branch circuits. Check the specification page of this owner's manual to be certain.

Do not overload wall outlets. Overloaded wall outlets, loose or damaged wall outlets, extension cords, frayed power cords, or damaged or cracked wire insulation are dangerous. Any of these conditions could result in electric shock or fire. Periodically examine the cord of your appliance, and if its appearance indicates damage or deterioration, unplug it, discontinue use of the appliance, and have the cord replaced with an exact replacement part by an authorized servicer.

Protect the power cord from physical or mechanical abuse, such as being twisted, kinked, pinched, closed in a door, or walked upon. Pay particular attention to plugs, wall outlets, and the point where the cord exits the appliance.

To disconnect power from the mains, pull out the mains cord plug. When installing the product, ensure that the plug is easily accessible.



### Disposal of your old appliance

1. When this crossed-out wheeled bin symbol is attached to a product it means the product is covered by the European Directive 2002/96/EC.
2. All electrical and electronic products should be disposed of separately from the municipal waste stream via designated collection facilities appointed by the government or the local authorities.
3. The correct disposal of your old appliance will help prevent potential negative consequences for the environment and human health.
4. For more detailed information about disposal of your old appliance, please contact your city office, waste disposal service or the shop where you purchased the product.



This product is manufactured to comply with EMC Directive 2004/108/EC and Low Voltage Directive 2006/95/EC.

European representative :

LG Electronics Service Europe B.V. Veluwezoom 15, 1327 AE Almere, The Netherlands (Tel : +31-036-547-8940)

USB



## Troubleshooting

Symptom	Cause	Correction
<b>General</b>		
No power.	The power cord is not plugged in.	Plug in the power cord.
	Check whether electricity failed.	Check the condition by operating other electronic devices.
No sound.	Check whether you select right function.	Press <b>FUNC/INPUT (FUNCTION)</b> and check the selected function.
<b>CD</b>		
The unit does not start playback.	An unplayable disc is inserted.	Insert a playable disc.
	The disc is dirty.	Clean the disc.
<b>RADIO</b>		
Radio stations cannot be tuned in.	The antenna is positioned or connected poorly.	Connect the antenna securely.
<b>iPod</b>		
iPod does not work.	Check whether the player is connected to the unit correctly.	Connect it to the unit correctly.
	Check whether ipod is fully charged.	Charge the ipod. iPod is automatically charged when connected to the player.
<b>Remote control</b>		
The remote control does not work properly.	The remote control is not pointed at the remote sensor of the unit.	Point the remote control at the remote sensor of the unit.
	The remote control is too far from the unit.	Operate the remote control within about 16 ft (5 m).
	There is an obstacle in the path of the remote control and the unit.	Remove the obstacle.
	The battery in the remote control is exhausted.	Replace the battery with new one.

## Specifications

### General

Power supply	Refer to the label attached on the bottom of the unit.
Power consumption	Refer to the label attached on the bottom of the unit.
Net Weight	2.45 kg
External dimensions (WxHxD)	332 x 165 x 248 mm
Operating temperature	5 °C to 35 °C
Operating humidity	5% to 85 %
Output Power	5 W + 5 W
T.H.D	10 %
Frequency Response	200 - 18000 Hz
Signal-to-noise ratio	70 dB
Speakers	6 Ω X 2

### Tuner

FM Tuning Range	87.5 - 108.0 MHz or 65 - 74 MHz, 87.5 - 108.0 MHz
-----------------	---

### CD

Frequency response	200 - 18000Hz
Signal-to-noise ratio	70 dB
Dynamic range	60 dB

Designs and specifications are subject to change without notice.



P/NO : MFL40699302