

LA1\_MCT703\_ENG\_MFL40968707

ENGLISH



**MODEL : MCT703 (MCT703-A0U, MCS703F, MCS703W)**

## Safety Precaution



**CAUTION:** TO REDUCE THE RISK OF ELECTRIC SHOCK DO NOT REMOVE COVER (OR BACK) NO USER-SERVICEABLE PARTS INSIDE REFER SERVICING TO QUALIFIED SERVICE PERSONNEL.



This lightning flash with arrowhead symbol within an equilateral triangle is intended to alert the user to the presence of uninsulated dangerous voltage within the product's enclosure that may be of sufficient magnitude to constitute a risk of electric shock to persons.



The exclamation point within an equilateral triangle is intended to alert the user to the presence of important operating and maintenance (servicing) instructions in the literature accompanying the product.

**WARNING:** TO PREVENT FIRE OR ELECTRIC SHOCK HAZARD, DO NOT EXPOSE THIS PRODUCT TO RAIN OR MOISTURE.

**WARNING:** Do not install this equipment in a confined space such as a book case or similar unit.

**CAUTION:** Do not block any ventilation openings. Install in accordance with the manufacturer's instructions.

Slots and openings in the cabinet are provided for ventilation and to ensure reliable operation of the product and to protect it from over heating. The openings should be never be blocked by placing the product on a bed, sofa, rug or other similar surface. This product should not be placed in a built-in installation such as a bookcase or rack unless proper ventilation is provided or the manufacturer's instruction has been adhered to.

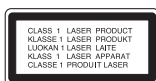

### **CAUTION:**

This product employs a Laser System.

To ensure proper use of this product, please read this owner's manual carefully and retain it for future reference. Should the unit require maintenance, contact an authorized service center. Use of controls, adjustments or the performance of procedures other than those specified herein may result in hazardous radiation exposure.

To prevent direct exposure to laser beam, do not try to open the enclosure. Visible laser radiation when open. DO NOT STARE INTO BEAM.

**CAUTION:** The apparatus should not be exposed to water (dripping or splashing) and no objects filled with liquids, such as vases, should be placed on the apparatus.

### **CAUTION concerning the Power Cord**

**Most appliances recommend they be placed upon a dedicated circuit;**

That is, a single outlet circuit which powers only that appliance and has no additional outlets or branch circuits. Check the specification page of this owner's manual to be certain.

Do not overload wall outlets. Overloaded wall outlets, loose or damaged wall outlets, extension cords, frayed power cords, or damaged or cracked wire insulation are dangerous. Any of these conditions could result in electric shock or fire. Periodically examine the cord of your appliance, and if its appearance indicates damage or deterioration, unplug it, discontinue use of the appliance, and have the cord replaced with an exact replacement part by an authorized servicer.

Protect the power cord from physical or mechanical abuse, such as being twisted, kinked, pinched, closed in a door, or walked upon. Pay particular attention to plugs, wall outlets, and the point where the cord exits the appliance.

To disconnect power from the mains, pull out the mains cord plug. When installing the product, ensure that the plug is easily accessible.



## There is so much your Hi-Fi system can do

### **Contents**

About Player	4
About Remote control	5
Setting up	6
Listening to CDs	7
Listening to the radio	7
Listen to cassette tapes	8
Tape Recording	8
Playing music using USB	9
USB direct Recording	9 - 10
About MP3/WMA	10
Listening to music from your portable player	10
USER EQ	10
Natural EQ	10
VSM (Virtual Sound Matrix)	10
VOCAL FADE	10
Setting the Clock	11
Use your player as an alarm clock	11
Fall asleep while listening to your player	11
DEMO	11
Troubleshooting	12
Specifications	13

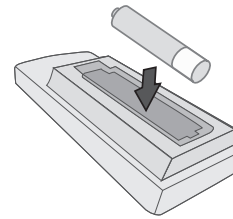

#### **Put the battery in the remote control**

Make sure that the + (plus) and - (minus) on the battery (size AAA) match those on the remote control.

The making of unauthorized copies of copy-protected material, including computer programs, files, broadcasts and sound recordings, may be an infringement of copyrights and constitute a criminal offence. This equipment should not be used for such purposes.

**Be responsible  
Respect copyrights**

**Before connecting, operating or adjusting this product, please read this instruction booklet carefully and completely.**

## About Player

### DISPLAY WINDOW

Choose a desired CD (see Listening to CDs)

**TIMER** (see Use your player as an alarm clock)  
With the TIMER function you can turn CD, tape, USB play and TUNER reception on or off at a desired time.

**Power on/off**

**CLOCK** (see Setting the Clock)

For setting the clock and checking the time.

To select **TUNER (FM or AM) function**

**eXtreme Dynamic Sound System**

Reinforce the treble, bass and surround sound effect.

**MP3 OPT**

Optimizes compressible MP3 files so that it improves the bass sound.

Look for radio stations automatically

**DEMO**

Press **DEMO** in power off state to demonstrate the function on display window.

**RVS MODE** (see Listen to cassette tapes)

**VOCAL FADE**

When you listen to music, it reduce the vocal of file.

**PORTABLE IN**

For connecting a portable device and playing it through the system's speakers.

**PHONES**

Connect a headphone plug (ø6,3 mm) into the jack to listen to the sound through headphones.

**SET** (see Setting the clock)  
Confirms the time you have selected when setting the clock.

**▲ OPEN/CLOSE**  
You can use it when inserting or removing CDs.

**Record from tape to tape**  
(Listen to cassette tapes)  
**CD to Tape Synchronized Recording**

**Disc tray**

**Skip to another track** (see Listening to CDs)  
**Select the radio station**  
(see Listening to the radio)

**NATURAL EQ**

You can choose sound impressions.

**MIC VOL.**

Adjust the microphone volume by turning **MIC VOL.**

**Starts playback** (see Listening to CDs)  
**Choose a 'preset number' for a radio station**  
(see Listening to the radio)

**Stops playback or recording**

**Look for radio stations automatically**

**Starts or pauses recording**

**PORTABLE**

The player can be used to play the music from many types of portable player.

**AUX**

You can connect many other types of audio or audio visual device to the system via the auxiliary sockets (**AUX IN**) on the back of the player.

**MIC 1/MIC 2**

You can sing to a music source by connecting a microphone (not supplied) to the unit.

## About Remote control

### NATURAL EQ

You can choose sound impressions.

### Power on/off

#### Power save mode

Press **POWER** for longer than 3 seconds as the device is powered on, you can move into power save mode.

### Search for a folder of MP3/WMA files

When a CD containing MP3/WMA files in several folders is being played, press **PRESET/FOLDER** to select the folder you want to play.

Choose a 'preset number' for a radio station (see Listening to the radio)

### Listen to your tracks again and again

### Fall asleep while listening to your player

Press **SLEEP** one or more times to select delay time between 10 and 180 minutes, after the player will turn off.

### Dimm the display light

### For storing radio stations

(see Listening to the radio)

### Listen to your tracks in any order

(see Listening to the CDs)

### Choose a desired CD

(see Listening to CDs)

This button is not available.

### VSM (Virtual Sound Matrix)

You can select the Virtual sound.

### Temporarily stop the sound

Press the button again to return to the sound.

### To change the functions

Change the functions among FM, AM, CD, TAPE.

Control the volume when using any function.

### To change the INPUT functions

Change the functions among USB, AUX, PORTABLE.

### See information about your music

MP3/WMA files often come with tags. The tag gives the Title, Artist, Album or Time information.

### Stops playback or recording

### Select the radio station

Search for a section within a track  
Play Fast backward or Forward

### Starts or pauses recording

### Starts or pauses playback

### Improve poor FM reception

This will change the tuner from stereo to mono and usually improve the reception.

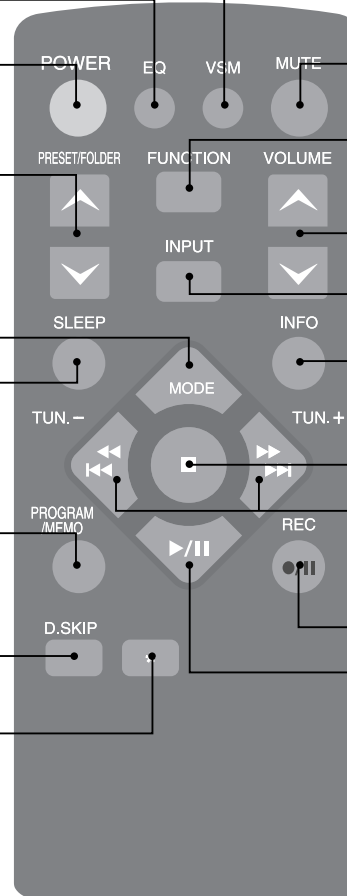

## Setting up

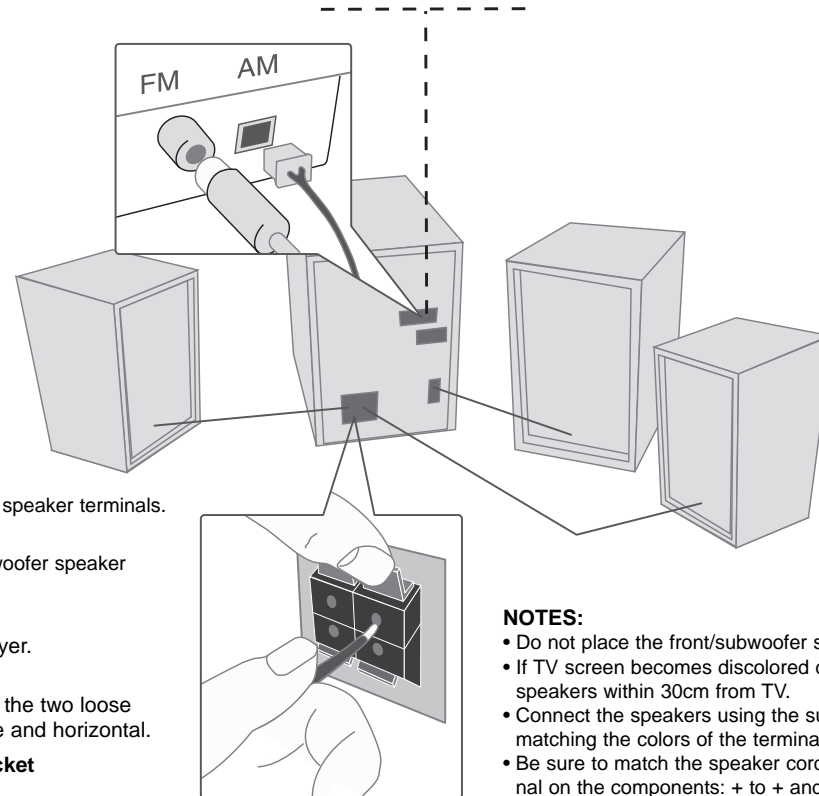

- 1 Connection of the front speakers**  
Connect the speaker cables to the front speaker terminals.
- 2 Connection of the subwoofer**  
Connect the speaker cables to the subwoofer speaker terminals.
- 3 Fit the AM loop aerial to its stand**  
Connect the AM loop aerial to the player.
- 4 Connect the FM aerial**  
The reception will be at its best when the two loose ends of the aerial are in a straight line and horizontal.
- 5 Plug the power plug into a wall socket**

### NOTES:

- Do not place the front/subwoofer speakers by TV.
- If TV screen becomes discolored do not place front speakers within 30cm from TV.
- Connect the speakers using the supplied speaker cables by matching the colors of the terminals and those of the cords.
- Be sure to match the speaker cord to the appropriate terminal on the components: + to + and - to -. If the cords are reversed, the sound will be distorted and will lack base.

### Be careful of the following

Be careful to make sure children not to put their hands or any objects into the \*speaker duct.

\*speaker duct : A holl for plentiful bass sound on speaker cabinet(enclosure).

## Listening to CDs

Audio CD and MP3/WMA CD can be played back in this player.

	ON PLAYER	ON REMOTE
1. Open the CD door:	▲ OPEN/CLOSE	
2. Select the CD tray:	DISC.SKIP	D.SKIP
3. Insert the CD: Label facing up.		
4. Close the CD door:	▲ OPEN/CLOSE	
5. Select the CD function: The display will show the total number of tracks (files).	CD	FUNCTION
6. Start the CD playing:	▶	▶/II
7. To stop a CD playing:	■ STOP	■

### Listening to CDs - more you can do

#### Pause or restart a CD

Press **CD PAUSE** on the player or **▶/II** on the remote control during playback. Press this button again to resume play.

#### Search for a section within a track

Hold **◀◀ / ▶▶** on the player or **◀◀◀◀/▶▶▶▶** on the remote control during playback.

#### Skip to another track

Use **MULTI JOG** on the player or **◀◀◀◀/▶▶▶▶** on the remote control.

#### Listen to your tracks in any order

Up to 20 tracks on a CD can be listened to in the order of your choice. Insert a CD and wait for it to be read. Press **PROGRAM/MEMO** on the remote control, then use **MULTI JOG** on the player or **◀◀◀◀/▶▶▶▶** on the remote control to select the track. Press **PROGRAM/MEMO** again to save and select the next track. Press **▶** on the player or **▶/II** on the remote control. To clear your selection, press **■ STOP** (or **■**), **PROGRAM/MEMO** and then **■ STOP** (or **■**).

#### Listen to your tracks again and again

Press **MODE** repeatedly, the display changes in the following order, RPT 1 - RPT DISC - RPT ALL - RANDOM - OFF.

## Listening to the radio

Make sure both the FM and AM aerials are connected.

	ON PLAYER	ON REMOTE
1. Select either FM or AM:	TUN.	FUNCTION
2. Select the radio station:	MULTI JOG	TUN.- / TUN.+
3. To 'save' a radio station: A preset number will show in the display.		PROGRAM/MEMO
4. To select a 'saved' station:	PRESET(-)/(+)	PRESET/FOLDER
5. To confirm press: Up to 50 radio stations can be saved.		PROGRAM/MEMO

### Listening to the radio - more you can do

#### Look for radio stations automatically

Press **◀◀ AUTO TUN / AUTO TUN ▶▶** on the player or **TUN.- / TUN.+** on the remote control for more than 0.5 second. The tuner will scan automatically and stop when it finds a radio station.

#### Delete all the saved stations

Press and hold **PROGRAM/MEMO** on the remote control for two seconds. "ERASE ALL" shows. Press **PROGRAM/MEMO** on the remote control to erase all the saved stations.

#### Choose a 'preset number' for a radio station

Select a station you want by using **MULTI JOG** on the player or **TUN.- / TUN.+** on the remote control. Press **PROGRAM/MEMO**, the station flashes. Press **PRESET(-)/(+)** on the player or **PRESET/FOLDER** on the remote control to select the preset number you want. Press **PROGRAM/MEMO** to save it.

#### Improve poor FM reception

Press **DUBB/CD SYNC** on the player or **▶/II** on the remote control. This will change the tuner from stereo to mono and usually improve the reception. Or connect the antenna securely.

#### Improve poor AM reception

When receiving the AM broadcast, beat noises may occur. Press **AM-NOISE** repeatedly, the display changes in the following order, AM -- NOISE ON → AM -- NOISE OFF.

## Listen to cassette tapes

Cassette tapes can be played back in this player.

	ON PLAYER	ON REMOTE
1. Open the tape door:	▲ PUSH EJECT	
2. Insert the tape:		
3. Close the tape door:	▲ PUSH EJECT	
4. Select the TAPE function:	TAPE	FUNCTION
5. Start the tape playing:	◀ or ▶	▶/
6. To stop a tape playing:	■ STOP	■

### Listen to cassette tapes - more you can do

#### To Play Fast backward or Forward

After pressing ◀◀/▶▶ on the player during playback, or stop, press ▶ at a point you want.

#### DUBBING

This function shows how to record from tape to tape. Press **TAPE** on the player or **FUNCTION** on the remote control to select tape function.

- TAPE 1 - Insert a playback tape to dub.
- TAPE 2 - Insert a blank tape.

Press **DUBB** on the player as shown below. To stop dubbing, press ■ **STOP** on the player.

#### RVS MODE (AUTO REVERSE DECK - TAPE2 )

You can set the tape to play one side ⇄, both sides ⇄, or both sides six times ⇄, by pressing **RVS MODE** one or more times.

**NOTE:** In case you use the tape for the first time push the ▲ **PUSH EJECT** to open the tape door and then remove the cushion in it.

## Tape Recording

### Record from a CD, AUX, USB, PORTABLE or radio to cassette

Wind the tape to the point recording starts. Use only normal tapes.

	ON PLAYER	ON REMOTE
1. Open the TAPE 2 door: Insert a blank tape:	▲ PUSH EJECT	
2. Close the TAPE 2 door:	▲ PUSH EJECT	
3. Select a mode in which you want to record: Start playing the source you want to record.	CD, TUN., PORTABLE/AUX or USB	FUNCTION or INPUT
4. Puts the unit in standby more for recording: The display changes in the following order, "USB REC → TAPE REC".	REC./	REC
5. Select the "TAPE REC": Start recording.	REC./	REC
6. To stop a Recording:	■ STOP	■

### CD to Tape Synchronized Recording

The CD synchro recording function dubs a complete CD and programmed titles automatically into a cassette.

	ON PLAYER	ON REMOTE
1. Open the TAPE 2 door: Insert a blank tape.	▲ PUSH EJECT	
2. Close the TAPE 2 door:	▲ PUSH EJECT	
3. Select the CD function:	CD	FUNCTION
4. Start the Recording: The synchronized recording is started automatically after about 7 seconds.	CD SYNC	
5. To stop a Recording:	■ STOP	■



### Playing music using USB

The advantage of connecting your portable USB player through the system's USB port is that the portable device can be controlled from the system.

	ON PLAYER	ON REMOTE
<b>1. Connect the portable player to the system using a USB cable (not supplied):</b>		
<b>2. Select the USB function:</b> The display will show READ, followed by the number of files displayed.	USB	INPUT
<b>3. Start the USB playing:</b>	▶	▶/II
<b>4. To stop a USB playing:</b>	■ STOP	■
<b>5. Before disconnecting the portable USB player, change to any other function by pressing:</b>	TUN., CD, TAPE or PORTABLE/AUX	FUNCTION or INPUT
<b>6. Remove the USB player:</b>		

### Listen to your tracks again and again

Press **MODE** repeatedly, the display changes in the following order, RPT 1 - RPT ALL - RANDOM - OFF.

#### NOTES:

- Some portable devices are not compatible with this system.
- When various cards are connected to the Memory Card Reader, the first detected card is recognized.
- **Do not extract the USB device in operating.**
- A back up demands to prevent a data damage.
- If you use a USB extension cable or USB hub, the USB device might not be recognized.
- A device using NTFS file system is not supported (Only the FAT (16/32) file system is supported.).
- The USB function of this unit does not support all USB devices.
- Digital camera and mobile phones are not supported.
- This unit is not supported when the total number of files is 1000 or more.
- USB port of the unit can not be connected to PC. The unit can not be used as a storage device.
- HDD type USBs may not work when power is not supported in it by itself.

### USB direct Recording

#### Record FM, AM, TAPE, AUX or PORTABLE source to USB

Connect USB to the player before recording.

	ON PLAYER	ON REMOTE
<b>1. Select a mode in which you want to record:</b> Start playing the source you want to record.	TUN., TAPE or PORTABLE/AUX	FUNCTION or INPUT
<b>2. Puts the unit in standby more for recording:</b> The display changes in the following order, "USB REC → TAPE REC".	REC./II	REC
<b>3. Select the "USB REC":</b> Start recording.	REC./II	REC
<b>4. To stop a Recording:</b>	■ STOP	■

#### Record CD source to USB

You can record one desired track or all of the music tracks in CD to USB.

	ON PLAYER	ON REMOTE
<b>1. Select the CD function:</b>	CD	FUNCTION
<b>2. Select the track:</b>	MULTI JOG	◀◀◀◀▶▶▶▶
<b>3. Puts the unit in standby more for recording:</b> The display changes in the following order, "USB REC → TAPE REC".	REC./II	REC
<b>4. Select the "USB REC":</b> Start recording.	REC./II	REC
<b>5. To stop a Recording:</b>	■ STOP	■

#### NOTES:

- Remove USB while recording, the recorded file may not be saved.
- When you select CD function, and then press **REC./II (REC)** as not selecting any tracks, all music files in CD are recorded.

Press **REC./II** on the player or **REC** on the remote control for longer than 3 seconds, you can select bit rate. Use **MULTI JOG** on the player or **◀◀◀/▶▶▶▶▶** on the remote control to select the bit rate. And **REC./II** or **REC** again to select the recording speed. Use **MULTI JOG** or **◀◀◀/▶▶▶▶▶** to select a desired recording speed and **REC./II** or **REC** again to finish recording.

- **X 1 SPEED** (96kbps, 128kbps, 192kbps, 256kbps)

: You can listen to music while recording it.

- **X 2 SPEED** (Only 96kbps, 128kbps)

: You can just recording the music file. (Only Audio CD)

### About MP3/WMA

**MP3/WMA Disc compatibility with this unit is limited as follows:**

- Sampling Frequency : 8 - 48 kHz (MP3), 32 - 48 kHz (WMA)
- Bit rate : 8 - 320 kbps (MP3), 48 - 320 kbps (WMA)
- CD-R physical format should be "ISO 9660"
- If you record MP3/WMA files using the software which cannot create a FILE SYSTEM, for example "Direct-CD" etc., it is impossible to playback MP3 files. We recommend that you use "Easy-CD Creator", which creates an ISO 9660 file system.
- Do not use special letters such as "/ : \* ? " < >" etc.
- Even if the total number of files on the disc has more than 1000, it will only be shown up to 999.

### Listening to music from your portable player

The player can be used to play the music from many types of portable player.

	ON PLAYER	ON REMOTE
<b>1. Connect</b> the portable player by plugging the unit into PORTABLE IN on the front of the player.		
<b>2. Turn the power on:</b>	<b>⏻/II</b>	<b>POWER</b>
<b>3. Select the PORTABLE function:</b>	<b>PORTABLE</b>	<b>INPUT</b>
<b>4. Turn the portable player on and start it playing:</b>		

### USER EQ

You can listen to music with the desired sound effect (BASS, MIDDLE and TREBLE).

	ON PLAYER
<b>1. Select a "USER EQ":</b>	<b>USER EQ</b>
<b>2. When "USER EQ" is displayed, press :</b>	<b>SET</b>
<b>3. Select the sound effect you want among BASS, MIDDLE or TREBLE:</b>	<b>PRESET (-) or PRESET (+)</b>
<b>4. Adjust sound level (MIN, -4 to +4, MAX) :</b>	<b>MULTI JOG</b>
<b>5. Repeat the steps from 3 to 4 to set other sound effect :</b>	
<b>6. Press :</b>	<b>SET</b>

### Natural EQ

You can choose sound impressions. Use **NATURAL EQ** on the player or **EQ** on the remote control the display changes in the following order, NORMAL → NATURAL → REGUETON → SAMBA → SALSA → AUTO -- EQ (Only MP3/WMA file) → POP → CLASSIC → ROCK → JAZZ.

### VSM (Virtual Sound Matrix)

You can select the Virtual sound. Press **VSM** on the remote control to set the virtual sound.

- **BYPASS**: Software with multichannel surround audio signals is played according to the way it was recorded.
- **ON STAGE** : The sound fills Concert hall.
- **VIRTUAL** : Realtime 3D positioned sound rendering technology with stereo sources, optimized for stereo speakers. Listeners may experience amazing virtual surround effects with their own multimedia players.

### VOCAL FADE

When you listen to music, it reduce the vocal of file. Press **VOCAL FADE** on the player repeatedly, the display changes in the following order, FADE ON → FADE OFF.

## Setting the Clock

	ON PLAYER
1. Press for at least 2 seconds:	<b>CLOCK</b>
2. Choose from either: AM 12:00 (for an am and pm display) or 0:00 (for a 24 hour display).	<b>MULTI JOG</b>
3. Confirm your selection:	<b>SET</b>
4. Select the hours:	<b>MULTI JOG</b>
5. Press:	<b>SET</b>
6. Select the minutes:	<b>MULTI JOG</b>
7. Press:	<b>SET</b>

### Use your player as an alarm clock

Press and hold **TIMER** on the player for two seconds. Each function, TUNER, CD, USB, TAPE flashes for two seconds. Press **SET** on the player when the function you want to be woken by is showing.

If you choose TUNER, 'PLAY' and 'REC' flash, PLAY and REC. Choose one of them. If you choose TUNER and PLAY you will be shown the stations you have saved as presets. Use **MULTI JOG** on the player to select the station you want, then press **SET**.

You will be shown the ON TIME display. This is where you set the time you want the alarm to go off. Use **MULTI JOG** on the player to change the hours and minutes and **SET** to save.

You will then be shown the OFF TIME display. This is where you set the time you want the function to stop. Use **MULTI JOG** on the player to change the hours and minutes and press **SET** to save.

Next you will be shown the volume (VOL) you want to be woken by.

Use **MULTI JOG** on the player to change the volume and **SET** to save. Switch the system off. The clock icon shows that the alarm is set.

When the system is turned off you can check the time the alarm is set for by pressing **TIMER**. You can also turn the alarm on and off by pressing **TIMER**. To set the alarm to go off at a different time, switch the system on and reprogramme following the same steps as initially.

### Fall asleep while listening to your player

Press **SLEEP** on the remote control one or more times to select delay time between 10 and 180 minutes, after the player will turn off. Press **SLEEP** on the remote control repeatedly, the display changes in the following order, corresponding icons & dimmer ON → SLEEP 180 (dimmer ON) → SLEEP 150 (dimmer ON) → SLEEP 120 (dimmer ON) → SLEEP 90 (dimmer ON) → SLEEP 80 (dimmer ON) → SLEEP 70 (dimmer ON) → SLEEP 60 (dimmer ON) → SLEEP 50 (dimmer ON) → SLEEP 40 (dimmer ON) → SLEEP 30 (dimmer ON) → SLEEP 20 (dimmer ON) → SLEEP 10 (dimmer ON) → SLEEP OFF & dimmer OFF.

### DEMO

Press **DEMO** in power off state to demonstrate the function on display window. Press again to cancel.

## Troubleshooting

	Symptom	Cause	Correction
General	No power.	The power cord is not plugged in.	Plug in the power cord.
		Check whether electricity failed.	Check the condition by operating other electronic devices.
	No sound.	Check whether you select right function.	Press <b>FUNCTION</b> or <b>INPUT</b> and check the selected function.
CD	The unit does not start playback.	An unplayable disc is inserted.	Insert a playable disc.
		The disc is dirty.	Clean the disc.
RADIO	Radio stations cannot be tuned in.	The antenna is positioned or connected poorly.	Connect the antenna securely.
TAPE	Unable to record.	Record protect tabs are removed.	Cover holes on back edge of tape with tap.
Remote control	The remote control does not work properly.	The remote control is too far from the unit.	Operate the remote control within about 23 ft (7 m).
		There is an obstacle in the path of the remote control and the unit.	Remove the obstacle.
		The battery in the remote control is exhausted.	Replace the battery with new one.

Designs and specifications are subject to change without notice.

## Specifications

Player		
General	Power supply	Refer to main label.
	Power consumption	Refer to main label.
	Net Weight	7,65 kg
	External dimensions (WxHxD)	170 x 240 x 260 mm
	Operating temperature	5 °C to 35 °C
	Operating humidity	5% to 85 %
Tuner	FM Tuning Range	87,5 - 108,0 MHz or 65 - 74 MHz, 87,5 - 108,0 MHz
	AM Tuning Range	522 - 1620 kHz or 520 - 1720 kHz
Amplifier	Output Power	Front : 280 W + 280 W, Sub Woofer : 180 W
	T.H.D	10 %
	Frequency Response	42 - 20000 Hz
	Signal-to-noise ratio	75 dB
CD	Frequency response	40 - 20000Hz
	Signal-to-noise ratio	75 dB
	Dynamic range	80 dB
Cassette tape player	F.F/REW Time	120 sec (C-60)
	Frequency Response	250 - 8000 Hz
	Signal to Noise Ratio	43 dB
	Channel Separation	45 dB (P/B)/45 dB (R/P)
	Erase Ratio	50 dB (MTT-5511)
Speakers		
Speaker Name	MCS703F	MCS703W
Type	Bass Reflex 2Way 2 Speaker	Bass Reflex 1 Way 1 Speaker
Impedance	8 Ω	12 Ω
Frequency Response	55 - 20000 Hz	50 - 1500 Hz
Sound Pressure Level Rated	86 dB/W (1m)	85 dB/W (1m)
Input Power	280 W	180 W
Max. Input Power	560 W	360 W
Net Dimensions	270 x 432 x 326 mm	315 x 432 x 356 mm
Net Weight (1EA)	8,3 kg	9,8 kg



P/NO : MFL40968707