



LG

website <http://www.lgservice.com>

LG

LG

PI485 GATEWAY

INSTALLATION MANUAL

***Models: PHNFP14A0
PSNFP14A0***

IMPORTANT

- Please read this installation manual completely before installing the product.
- Installation work must be performed in accordance with the national wiring standards by authorized personnel only.
- Please retain this installation manual for future reference after reading it thoroughly.

TABLE OF CONTENTS

■ Part Installation & Operation precaution	3~4
■ Part Description	5
■ Installation Guide	7
■ Installation Steps	7
■ DIP Switch Configuration.....	8
■ Simple Central Controller - Connection Diagram	10
■ Deluxe Central Controller - Connection Diagram	12
■ Examples For Product Installation.....	13
■ Accessory Parts	14

Safety Precautions



To prevent injury to the user or other people and property damage, the following instructions must be followed.

- Incorrect operation due to ignoring instruction will cause harm or damage. The seriousness is classified by the following indications.

⚠ WARNING This symbol indicates the possibility of death or serious injury.

⚠ CAUTION This symbol indicates the possibility of injury or damage.

- Meanings of symbols used in this manual are as shown below.

	Be sure not to do.
	Be sure to follow the instruction.

⚠ WARNING

■ Installation

Don't touch with the hands while the power is on

- There is risk of fire or electric shock.

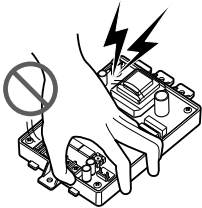

Use standard parts(connector).

- Do not disassemble or repair the product. There is risk of fire or electric shock.

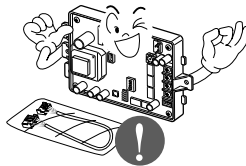

For electrical work, contact the dealer, seller, a qualified electrician, or an Authorized Service Center.

- Do not disassemble or repair the product. There is risk of fire or electric shock.



Use the correctly rated breaker or fuse.

- There is risk of fire or electric shock.

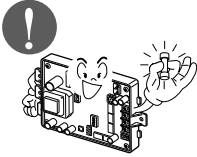

Do not install, remove, or re-install the unit by yourself (customer).

- There is risk of fire, electric shock, explosion, or injury.

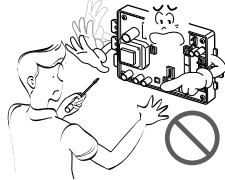

For installation, always contact the dealer or an Authorized Service Center.

- There is risk of fire, electric shock, explosion, or injury.

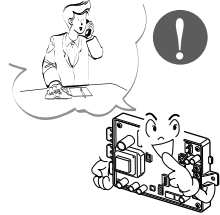

■ Operation

When the product is soaked (flooded or submerged), contact an Authorized Service Center.

- There is risk of fire or electric shock.



Be cautious that water could not enter the product.

- There is risk of fire, electric shock, or product damage.

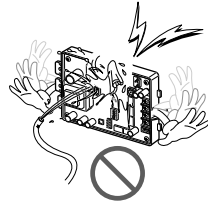

Part Description

PHNFP14A0

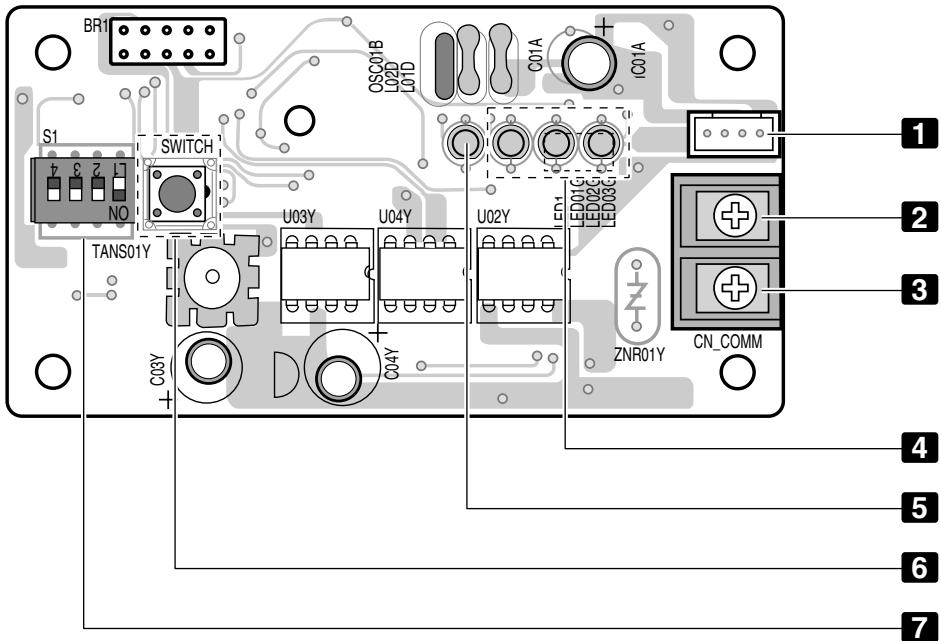

PI485 GATEWAY(C)

- 1** CN_OUT: Indoor Unit Connector
- 2** BUS_B: RS-485 (-) Terminal
- 3** BUS_A: RS-485 (+) Terminal
- 4** LED01G,02G,03G: Communication Status LED
- 5** LED1: RS-485 Communication Status LED
- 6** Reset Switch: PI485(C) Reset
- 7** DIP Switch: Product Select (Refer Page 8)

PSNFP14A0

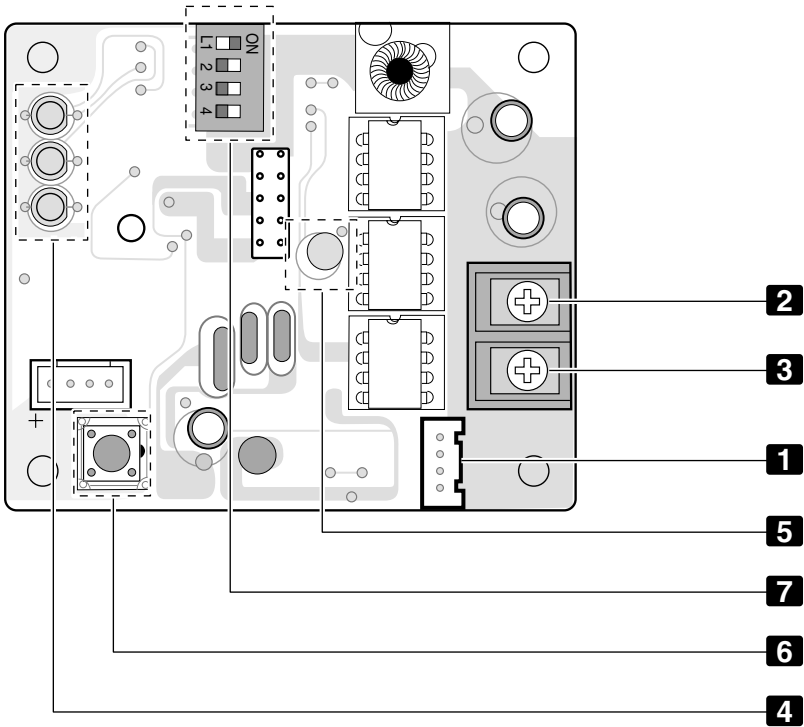

PI485 GATEWAY(R)

- 1** CN_OUT: Indoor Unit Connector
- 2** BUS_A: RS-485 (+) Terminal
- 3** BUS_B: RS-485 (-) Terminal
- 4** LED01G,02G,03G: Communication Status LED
- 5** LED1: RS-485 Communication Status LED
- 6** Reset Switch: PI485(C) Reset
- 7** DIP Switch: Product Select (Refer Page 9)

Installation Guide

Installation Steps (PHNFP14A0/PSNFP14A0)

1. **7** Select DIP Switch Configuration(Refer page 8 or 9)
2. **2 3** Connect The RS-485 BUS_A(+), BUS_B(-) with Other Network Products (ex, Simple Central Controller , CNU.....)
3. **1** Connect CN_OUT with Outdoor Unit by the cable (provided)
4. **4** Check the Communication Status LED
 - LED01G(Red): Ok operation-LED blinks for 5times and is OFF.
This process is repeated after every 3 minutes
 - NG operation : Check The Indoor unit address & Wiring Connections
 - LED02G(Yellow) ,LED03G(Orange): Ok operation-LED's blinks continuously
 - NG operation : Check The DIP Switch setting & Wiring Connections
5. **5** Check the RS-485 Communication Status LED:
 - Ok operation
 - (1) LED's blinks 2 Times in every 10~30 seconds (In case Connected CNU)
 - (2) LED's blinks continuously (In case Connected Simple Central Controller)
 - NG operation : Check The Wiring Connections
6. Finally if all the above steps are OK then , Tie the cables by Tie Wraps & Clamp

DIP Switch Configuration

• PHNFP14A0

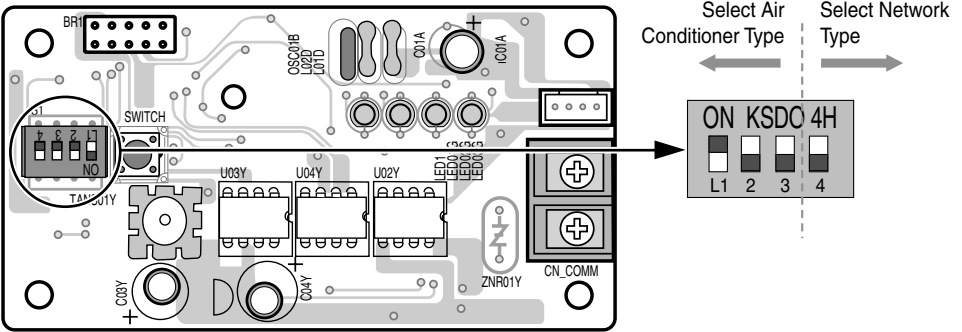

Using LGAP CAC/RAC/SRAC/PAC Products Configuration Methods

 → 3 ON+ALL OFF: Using LGAP CAC/RAC/SRAC/PAC Products Configuration Methods

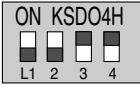
 → 3, 4 ON+ALL OFF: LGAP CAC/RAC/SRAC/PAC Products + Central Controller (ALL type)-Using LGAP

CAUTION:
Wrong Products Configuration can lead to malfunctioning

• PSNFP14A0

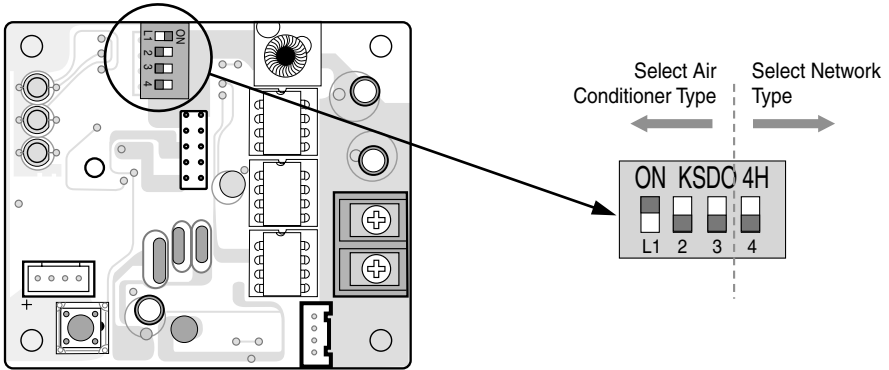

Using LGAP CAC/RAC/SRAC/PAC Products Configuration Methods



➔ 3 ON+ALL OFF: LGAP CAC/RAC/SRAC/PAC Products + Central Controller (ALL type)-Without LGAP

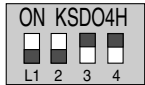

➔ 3, 4 ON+ALL OFF: LGAP CAC/RAC/SRAC/PAC Products + Central Controller (ALL type)-Using LGAP



CAUTION:

Wrong Products Configuration can lead to malfunctioning

Simple Central Controller - Connection Diagram

• PHNFP14A0

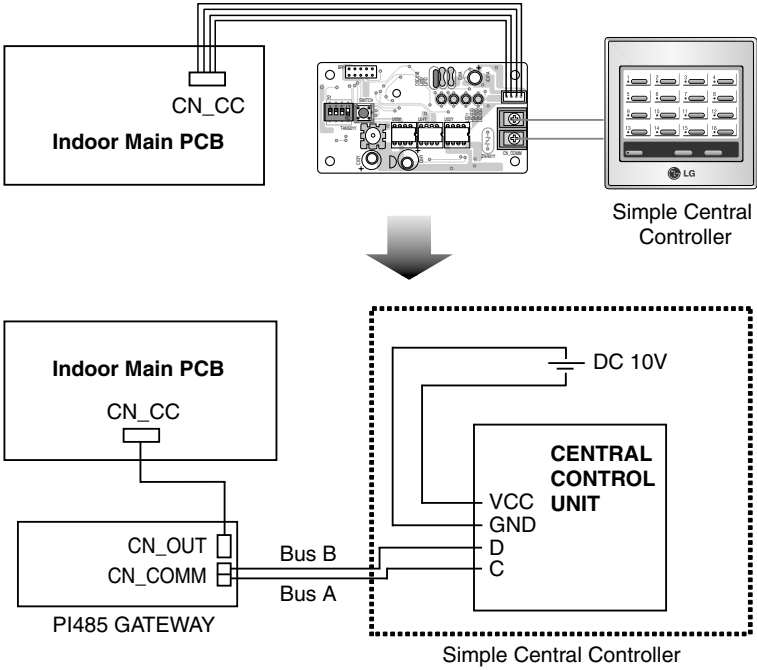

CAUTION: After Product Installation Tie the cables with the clamps & Tie-Wraps provided.

• PSNFP14A0

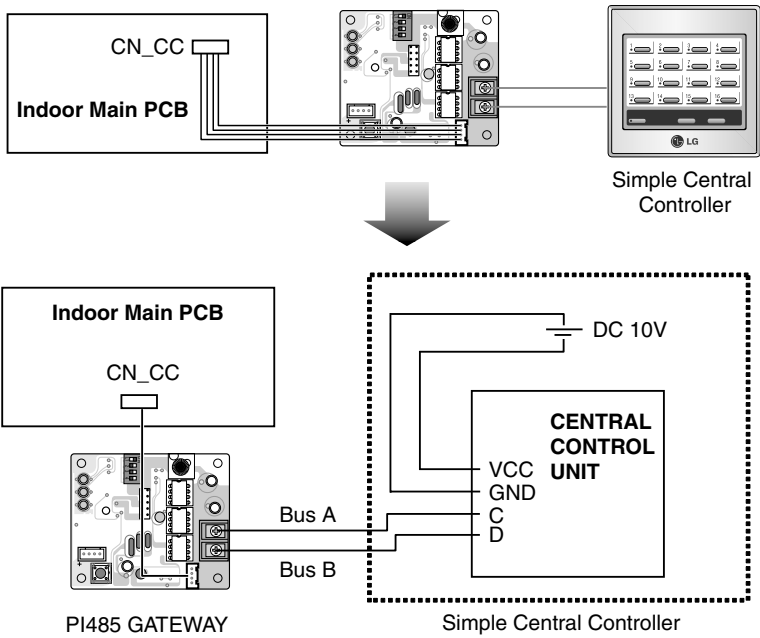

CAUTION:

After Product Installation Tie the cables with the clamps & Tie-Wraps provided.

Deluxe Central Controller - Connection Diagram

• PHNFP14A0

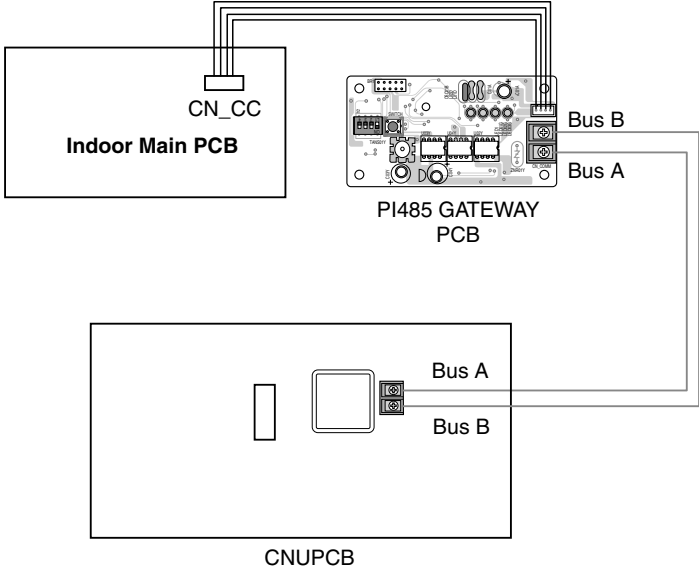

• PSNFP14A0

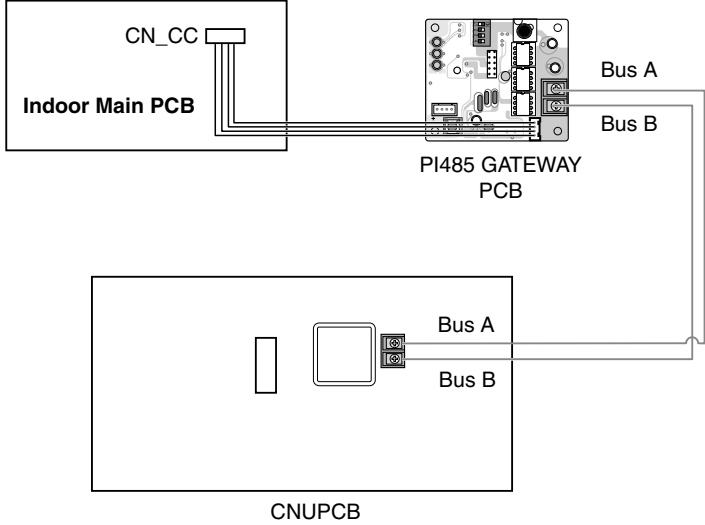

CAUTION: After Product Installation Tie the cables with the clamps & Tie-Wraps provided.

Examples For Product Installation

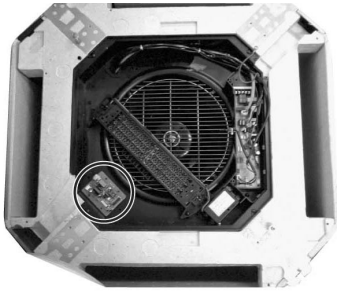

(1) The Installation for 4Way Cassette Product

→ Check Screw boss for PCB in 4way Cassette Product Then fix It

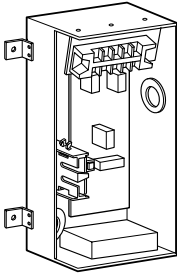

(2) The Installation for DUCT Product

→ Using PCB Holder provided

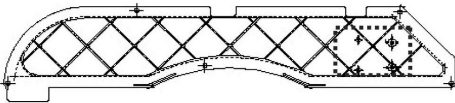

(3) The Installation for Cassette Product Cover

→ Check Screw boss for PCB in 4way Cassette Product Then fix It



CAUTION:

It can be Different location of installation in order to Each Product structure

Accessory Parts

• PHNFP14A0

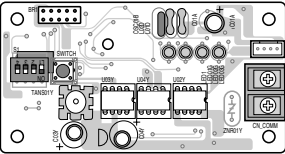
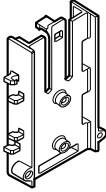
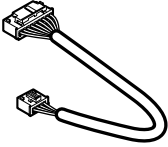
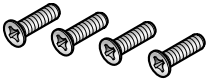
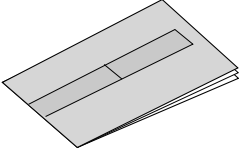
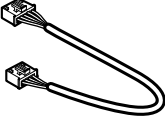
		
<p>PCB :6871A20484B</p>	<p>Holder for DUCT :3110A 20056A</p>	<p>WIRE ASSY 1(for RAC/SRAC/CAC)</p>
		
<p>Screw 4 EA</p>	<p>Installation Manual</p>	<p>WIRE ASSY(for Others)</p>

• PSNFP14A0

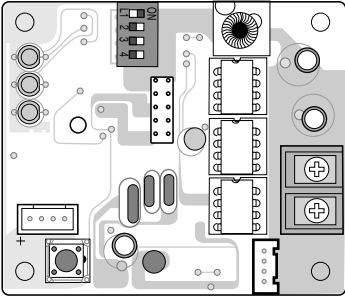
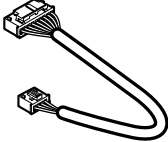
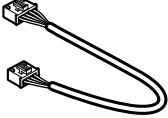
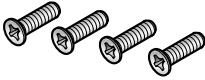
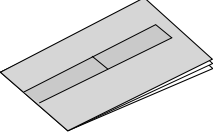
		
	<p>WIRE ASSY 1(for RAC/SRAC/CAC)</p>	<p>WIRE ASSY(for Others)</p>
<p>PCB :6871A20484C</p>		
<p>PCB :6871A20484C</p>	<p>Screw 4 EA</p>	<p>Installation Manual</p>

* **Others** : Tie Wrap (3 EA) - Cable Tie
Clamp (1 EA)

