



ENGLISH

OWNER'S MANUAL

CAR CD/MP3/WMA Receiver

Please read this manual carefully before operating your set and retain for future reference.

MODEL

LAC2950N/ LAC2910N/ LAC2900N

P/NO : MFL63284980

Table of Contents

- 3** Safety Note
- 4** Front Panel
- 5** About Detachable Control Panel
- 6** Installation
 - Basic installation
 - Removing the existing receiver unit
 - ISO-DIN installation
- 7** Connection
- 8** Basic operation
 - Mute
 - Using the EQ
 - Adjusting the sound level
 - XDSS+(Extreme Dynamic Sound System)
 - Checking the clock
 - Setting the clock
- 9** Listening to a CD
 - Pause or restart a CD
 - Search for a section within a track / file
 - Skip to another track / file
 - Intro scan
 - Repeat
 - Shuffle
 - MP3/WMA Track -10 / +10
 - MP3/WMA Folder UP/DOWN
 - Checking information about your music
- 10** Listening to the radio
 - Auto search memory
 - Storing and recalling broadcast frequencies
 - To scan the preset stations
 - To tune in the preset stations
 - Connecting an Auxiliary Equipment
- 11** Changing settings
- 12** Troubleshooting
- 13** Specifications

Safety Note



CAUTION
RISK OF ELECTRIC SHOCK
DO NOT OPEN



CAUTION : TO REDUCE THE RISK OF ELECTRIC SHOCK DO NOT SPLIT COVER(OR BACK) NO USER SERVICEABLE PARTS INSIDE. REFER SERVICING TO QUALIFIED SERVICE PERSONNEL.



This lightning flash with arrowhead symbol within an equilateral triangle is intended to alert the user to the presence of uninsulated dangerous voltage within the product's enclosure that may be of sufficient magnitude to constitute a risk of electric shock to persons.



The exclamation point within an equilateral triangle is intended to alert the user to the presence of important operating and maintenance (servicing) instructions in the literature accompanying the product.



Always operate the vehicle in a safe manner. Do not become distracted by the vehicle while driving, and always be fully aware of all driving condition. Do not change settings, or any functions. Pull over in a safe and legal manner before attempting such operations.



Do not use for many hours at extremely low or high temperature. (-10~60°C)



To reduce the risk of electric shock, do not remove the cover or back of this product. There are no user-serviceable parts inside. Refer servicing to qualified service personnel.



To reduce the risk of fire or electric shock, do not expose this product to dripping or splashing water, rain, or moisture.



The temperature of unit's outside can be extremely high, please use the unit after proper installation in your vehicle.



This unit cannot play 8cm disc (use 12cm disc only).

CAUTION : This product uses a Laser System.

To ensure proper use of this product, please read this owner's manual carefully and retain it for future reference.

Should the unit require maintenance, contact an authorized service center. Performing controls, adjustments, or carrying out procedures other than those specified herein may result in hazardous radiation exposure.

To prevent direct exposure to laser beam, do not try to open the enclosure. Visible laser radiation when open. **DO NOT STARE INTO BEAM.**

CLASS 1 LASER PRODUCT
KLASSE 1 LASER PRODUKT
LUOKAN 1 LASER LAITE
KLASS 1 LASER APPARAT
CLASSE 1 PRODUIT LASER

"This device is equipped with a portable battery or accumulator.

Safe way to remove the battery or the battery from the equipment:

Remove the old battery or battery pack, follow the steps in reverse order than the assembly. To prevent contamination of the environment and bring on possible threat to human and animal health, the old battery or the battery put it in the appropriate container at designated collection points. Do not dispose of batteries or battery together with other waste. It is recommended that you use local, free reimbursement systems batteries and accumulator."

The battery shall not be exposed to excessive heat such as sunshine, fire or the like.

Disposal of your old appliance



1. When this crossed-out wheeled bin symbol is attached to a product it means the product is covered by the European Directive 2002/96/EC.
2. All electrical and electronic products should be disposed of separately from the municipal waste stream via designated collection facilities appointed by the government or the local authorities.
3. The correct disposal of your old appliance will help prevent potential negative consequences for the environment and human health.
4. For more detailed information about disposal of your old appliance, please contact your city office, waste disposal service or the shop where you purchased the product.

Caution

When being connected in a wrong way, the unit displays as follows.

- Antenna port short : **"ANTENNA ON PORT SHORT CIRCUIT CHECK"**

After connecting it again, restart the unit

You have to set the disc format option to [Mastered] in order to make the discs compatible with the LG players when formatting rewritable discs.

When setting the option to Live File System, you cannot use it on LG players. (Mastered/Live File System : Disc format system for Windows Vista)

Front Panel

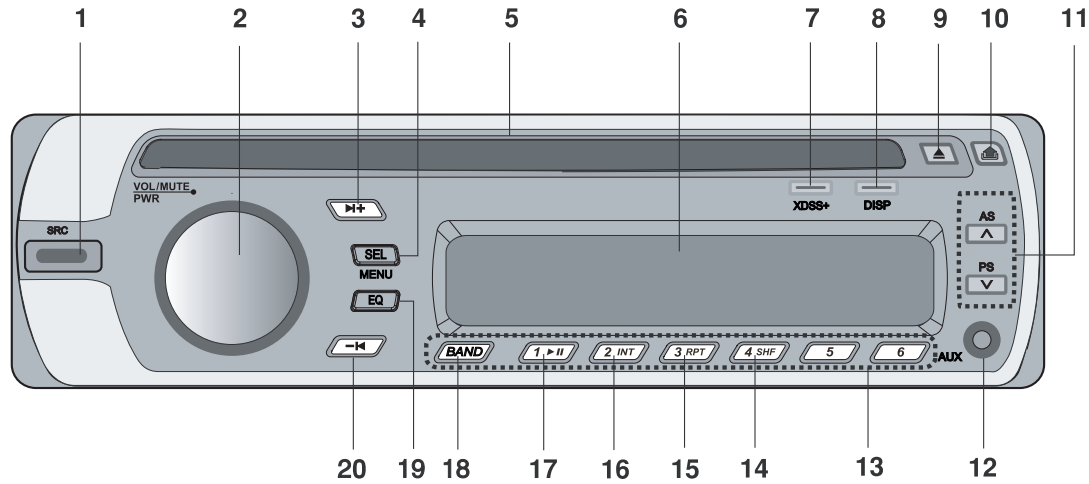

- | | |
|--|--|
| <ul style="list-style-type: none"> 1 SOURCE [SRC] 2 • Volume • [MUTE] • Power [PWR] 3 Skip / Search / Seek / Tune / ►I+ 4 Select [SEL] / MENU 5 CD slot 6 Display window 7 Extreme Dynamic Sound System [XDS+] 8 Display [DISP] 9 Eject ▲ 10 Release ▲ | <ul style="list-style-type: none"> 11 • Auto Store [AS] • Preset Scan [V/PS] • MP3/WMA Track +10/-10 ▲▼ • Folder Up/Down ▲▼ 12 AUX in 13 Preset Station [1~6] 14 Shuffle [SHF] 15 Repeat [RPT] 16 Intro Scan [INT] 17 Play/Pause ►II 18 [BAND] 19 Equalizer [EQ] 20 Skip / Search / Seek / Tune -I◀ |
|--|--|

About Detachable Control Panel

Attaching the control panel

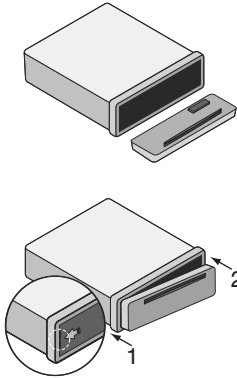



- 1 Align the left side of the panel with the stopper.
- 2 Push the right side of panel into the unit until it clicks.

Caution

- The control buttons may not work properly if the control panel is not attached properly. If this occurs, gently press the display.
- Do not leave the control panel in any area exposed to high temperatures or direct sunlight.
- Do not drop the control panel or otherwise subject it to strong impact.
- Do not allow such volatile agents as benzene, thinner, or insecticides to come into contact with the surface of the control panel.

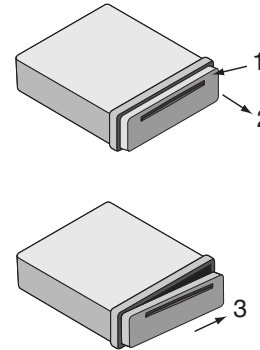
Detaching the control panel



- 1 Press the “” (RELEASE) to open the control panel.
- 2 Hold the right part of the control panel.
- 3 Pull out the control panel.
- 4 Place the control panel in the supplied protective case.

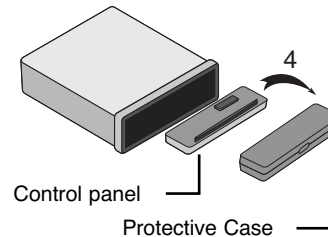

Note

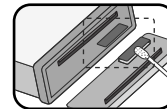

Periodically wipe the contacts on the back of the control panel with a cotton swab moistened with alcohol. For safety, turn off the ignition before cleaning, and remove the key from the ignition switch.

Installation

Basic Installation

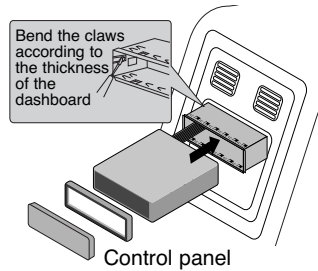

Before installing, make sure that the ignition-switch is set to OFF and remove the terminal of the car battery to avoid short-circuiting.

- 1 Remove the existing receiver unit.
- 2 Make the necessary connections.
- 3 Install the installation sleeve.
- 4 Install the unit into the installation sleeve.

ISO-DIN Installation

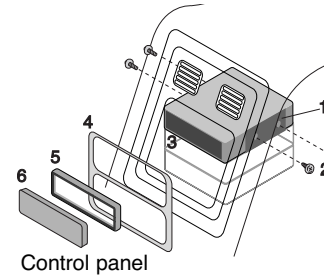

- 1 Slide the unit into the ISO-DIN frame.
- 2 Fit screws removed from the old unit.
- 3 Slide the unit and frame into the dash opening.
- 4 Install the dash panel or adapter plate.
- 5 Install the trim ring to the unit.
- 6 Install the control panel to the unit.

Removing the existing receiver unit

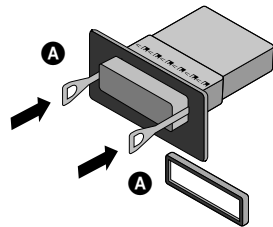

If there is already an installation sleeve for the receiver unit in the dashboard, it must be removed.

- 1 Remove the rear support from the unit.
- 2 Remove the control panel and trim ring from the unit.
- 3 Insert the lever **A** into the hole on one side of the unit. Perform the same operation on the other side and pull the unit out from the mounting sleeve.

Connection

Before connecting, make sure that the ignition switch is set to OFF, and remove the battery ⊖ terminal to avoid short circuits.

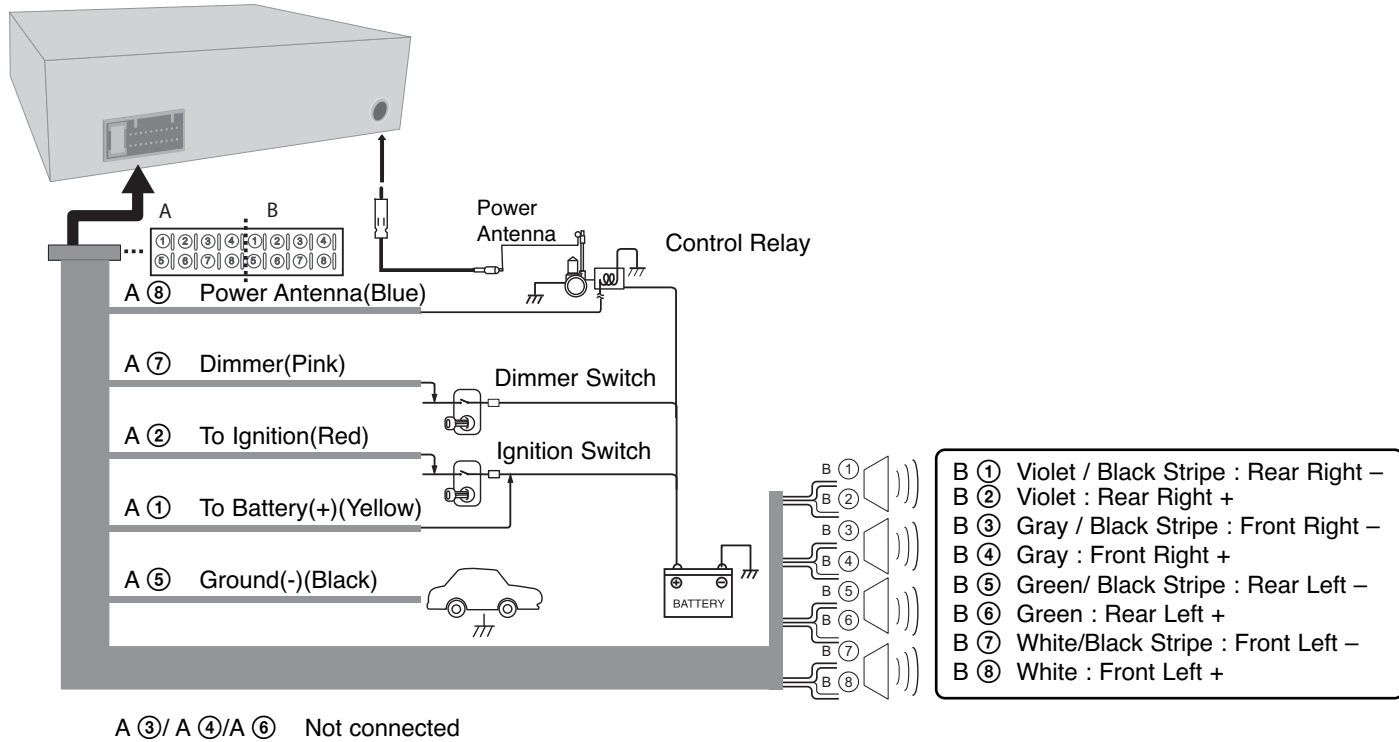

Basic Operation

	ON PLAYER
1. Turn the unit on.	Any Key
2. Select a source.	SRC
3. Adjust the volume.	Rotate PWR

Basic operation - more you can do

Mute

Press **VOL/MUTE** to cut the sound. To cancel it, press again.

Using the EQ

EQ is to increase or decrease the signal strength of audio frequencies. The function helps you to enjoy sound more plentifully. Press **EQ** repeatedly. The indicator lights up in the following order.

POP → CLASSIC → ROCK → JAZZ → VOCAL → SALSA → SAMBA → REGGAE → RUSSY → USER1 → USER2 → Off (not displayed)

Note

- When XDSS+ is set to "Off", you can adjust the EQ settings.
- You can adjust sound level to your preference. Once you select a USER mode and then adjust the sound level, it will be automatically stored for the currently selected USER mode. Refer to the "Adjusting the sound level" for USER 1/2 mode.

Adjusting the sound level

Press **SEL** repeatedly to select the mode you want to adjust from VOL(volume), BAL(left/right speaker), and FAD(front/rear speaker). To adjust sound quality, rotate **PWR**.

Note

When EQ and XDSS+ is set to "Off", you can also adjust the sound level (BAS(bass), MID(middle), TRB(treble)) settings.

XDSS+ (Extreme Dynamic Sound System)

Press **XDSS+**. (XDSS+ : Improves the treble, bass sound.) To cancel it, press again.

Checking the clock

You can see the clock pressing **DISP**.

Setting the clock

- 1 Press the **DISP** and then, press and hold it for more 1 second.
- 2 Press the **▶|+** to adjust the hour.
- 3 Press the **-|◀** to adjust the minute.
- 4 Press **DISP** again to finish the setting.

Listening to a CD

	ON PLAYER
1. Insert a CD.	-
2. Adjust the volume.	Rotate PWR

Listening to a CD - more you can do

Pause or restart a CD

Press **▶||** on the player during playback. Press this button again to resume play.

Search for a section within a track / file

1. Press **-|◀** / **▶|+** on the player for longer than 1 second during playback.
2. Press **-|◀** / **▶|+** on the player again at the point you want.

Skip to another track / file

Press **-|◀** / **▶|+** on the player. To skip to previous track, press briefly **-|◀** within 3 seconds of playing time.

Intro scan

Press or press and hold **INT** on the player. Each files in the current selected folder (**■ INT**) or the first 10 seconds of each tracks/files (**INT**) on the disc are played. To cancel it, press the button again.

Repeat

Press or press and hold **RPT** on the player. The current selected tracks/files (**1 RPT**) or folder (**■ RPT**) on the disc is played repeatedly. To cancel it, press the button again.

Shuffle

Press or press and hold **SHF** on the player. Each files in the current selected folder (**■ SHF**) or all of the tracks/files (**SHF**) on the disc is played randomly. Press **SHF** again to cancel it.

Note

During random playback, if you press **-|◀**, you won't go back to the previous track.

MP3/WMA Track -10 / +10

(If there is no folder or one folder.) During playback press **V/PS** to go back 10 tracks, or press **^/AS** to go forward 10 tracks.

MP3/WMA Folder UP/DOWN

(If there are more than two folders.) During playback, press **V/PS** to go back to the previous folder, or press **^/AS** to go forward to the next folder.

Checking information about your music

MP3/WMA files often come with tags. The tag gives the Title, Artist or Album. Press **DISP** two times to check a file/folder name, and three times to check ID3/WMA/CD TEXT during file playback. If there is no information, "NO TEXT" will be shown in the display window.

Note

- **■** : The icon is displayed during MP3/WMA playback.
- **MP3/WMA Disc compatibility with this unit is limited as follows:**
 1. Sampling Frequency / 8 - 48kHz (MP3) 22.05 - 48kHz (WMA)
 2. Bit rate / within 8 - 320kbps (include VBR) (MP3) 32 -320kbps (WMA)
 3. CD-R/CD-RW file system should be "ISO 9660"
 4. If you record MP3/WMA files using software which cannot create a FILE SYSTEM, for example "Direct-CD" etc., it will not be possible to playback MP3/WMA files. We recommend that you use "Easy-CD Creator" which creates an ISO9660 file system.

Customers should also note that permission is required in order to download MP3/WMA files and music from the Internet. Our company has no right to grant such permission. Permission should always be sought from the copyright owner.

Listening to the radio

	ON PLAYER
1. Select a source to tuner.	SRC
2. Select a band.	BAND
3. Auto seek. Manual seek.	- ◀ / ▶ + Press and hold - ◀ / ▶ +

Listening to the radio - more you can do

Auto search memory

Press **∕AS**. The six strongest broadcast frequencies will be stored under preset button 1-6 in the order of their signal strength. To cancel, press **∕AS**.

Storing and recalling broadcast frequencies

- 1 Press **BAND** to select desired band you want to store.
- 2 Select the desired frequency and press one of preset buttons 1-6 and hold until the beep sound.
- 3 Repeat steps 1-2 to preset other stations. The next time, you press the same preset button, the radio station frequency is recalled from the memory.

To scan the preset stations

Press **∕PS**. Each preset station appears. To cancel, press **∕PS**.

To tune in the preset stations

Press **BAND** to select the desired band and press the desired preset button 1-6 .

Note

- When a station is stored on the preset numbers on which another station of the same band has already been preset, the previously preset station is automatically erased.

Connecting an Auxiliary Equipment

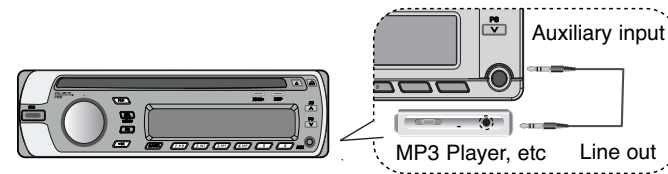

	ON PLAYER
1. Select a source to AUX.	SRC
2. Play the connected Auxiliary Equipment.	-
3. Adjust the volume.	Rotate PWR

Changing settings

	ON PLAYER
1. Activates setting menu.	Press and hold MENU
2. Select one item.	Press MENU
3. Select a source.	Rotate PWR
4. Finish the setting .	Press MENU

- **AUX (Auxiliary) ON / OFF**

It is possible to use auxiliary equipment with this unit. Activate the auxiliary setting when using auxiliary equipment connected to this unit.

- **AUX (Auxiliary) 00dB / +6dB**

Only when you set AUX to ON as switching sources, you can adjust the volume level of each source to prevent radical changes in volume.

You can set to 0 dB or +6 dB. You may be surprised at a loud sound when you change the source from the external component to another source.

- **DEMO OFF/ ON**

You can change the initial indication on the display to information name (function name, EQ name, etc...) while listening to a source.

- **DIM(Dimmer) OFF / ON / AUTO**

You can change the brightness of the display window during the power-on status. When you set DIMMER to AUTO, the dimmer operates according to the car dimmer setting.

- **DIM L (Dimmer Level)**

When you set DIM to ON/AUTO, you can adjust the dimmer level. (-2,-1,0,+1,+2)

- **A-EQ(Auto EQ) ON/OFF**

AUTO EQ operates only in the music file supported with Genre in the device.

When you set AUTO EQ to ON, POP, CLASSIC, ROCK, or JAZZ is automatically selected according to the music genre.

- **BEEP 2ND / ALL**

BEEP 2ND : The beep is generated when a key is long pressed. (1 sec)

BEEP ALL : The beep is generated when any key is pressed.

Troubleshooting

	Symptom	Cause	Correction
General	Power doesn't turn on / The unit doesn't operate.	Leads and connectors are not properly.	Confirm once more that all connections are correct.
		The fuse is blown.	Rectify the problem that caused the fuse to blow, and then replace it. Be very sure to install the correct fuse with the same rate.
		Noise and other factors are causing the built-in microprocessor to operate incorrectly.	Turn the unit off and then on.
	No sound is heard / The volume level will not rise.	Cables are not connected correctly.	Connect the cables correctly.
CD	There's audio skipping.	This unit is not firmly secured.	Secure this unit firmly.
	The playback is not possible.	The disc is dirty.	Clean the disc.
		The loaded disc is of a type this unit cannot play.	Check what type the disc.
Radio	Radio stations cannot be tuned in.	The signal strength of the stations is too weak(when tuning in with automatic tuning.)	Tune in the stations manually.
		No station has been preset or preset stations have been cleared(when tuning by scanning preset stations.)	Preset the stations.(Refer to the page 10)

Specifications

General

Output Power	53W x 4CH (Max.)
Power Source	DC 12V
Speaker impedance	4Ω
Ground System	Negative
Dimensions (W x H x D)	180 x 50 x 176 mm (Without Control Panel)
Net Weight	1.3 kg

Tuner

FM

Frequency Range	87.5-107.9, 87.5-108, 65-74 or 87.5-108 MHz
S/N Ratio	55 dB
Distortion	0.7%
Usable Sensitivity	12 dBμV

AM (MW)

Frequency Range	520-1720 or 522-1620 kHz
S/N Ratio	50 dB
Distortion	1.0%
Usable Sensitivity	28 dBμV

CD

Frequency Response	20 Hz-20 kHz
S/N Ratio	80 dB
Distortion	0.12%
Channel Separation (1kHz)	55 dB

AUX

Frequency Response	20 Hz-20 kHz
S/N Ratio	80 dB
Distortion	0.1 %
Channel Separation (1kHz)	45 dB
Max Input Level (1kHz)	1.1V

Designs and specifications are subject to change without notice.

