



CE0168

KP170 | User Guide

This guide will help you understand your new mobile phone. It will provide you with useful explanations of features on your phone.

Some of the contents in this manual may differ from your phone depending on the software of the phone or your service provider.



Disposal of your old appliance

- When this crossed-out wheeled bin symbol is attached to a product it means the product is covered by the European Directive 2002/96/EC.
- All electrical and electronic products should be disposed of separately from the municipal waste stream via designated collection facilities appointed by the government or the local authorities.
- The correct disposal of your old appliance will help prevent potential negative consequences for the environment and human health.
- For more detailed information about disposal of your old appliance, please contact your local authority, waste disposal service or the shop where you purchased the product.



P/N: MMBB0304339 (1.0)

Getting to know your phone

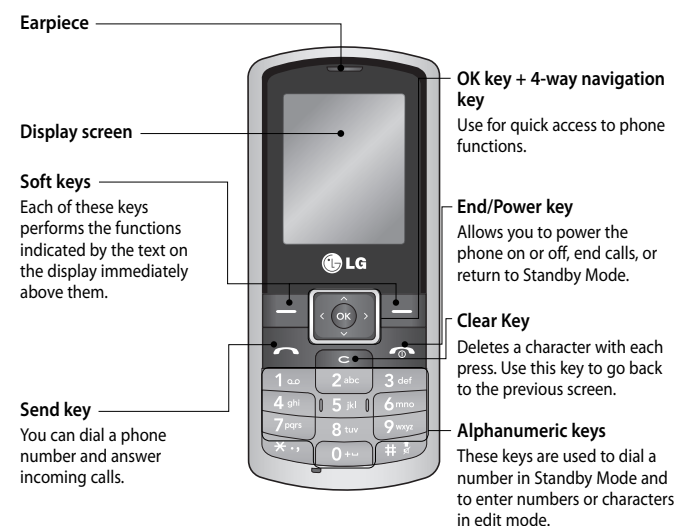

Selecting functions and options

Your phone offers a set of functions that allows you to customize the phone. These functions are arranged in menus and sub-menus, accessed via the two soft keys. Each menu and sub-menu allows you to view and alter the settings of a particular function.

The roles of the soft keys vary according to the current context; the option on the bottom line of the display just above each key indicates its current role.

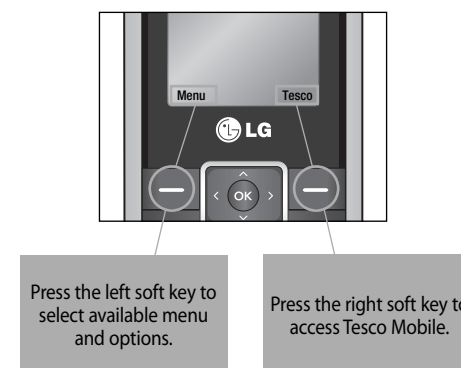

Installing the SIM Card and Charging the Battery

Installing the SIM Card

When you subscribe to a cellular network, you are provided with a plug-in SIM card loaded with your subscription details, such as your PIN, and any optional services available.

Important! The plug-in SIM card and its contacts can be easily damaged by scratches or bending, so be careful when handling, inserting or removing the card. Keep all SIM cards out of the reach of small children.

Illustrations

- Open battery cover
- Remove the battery
- Insert your SIM
- Install the battery
- Close the battery cover
- Charge your battery

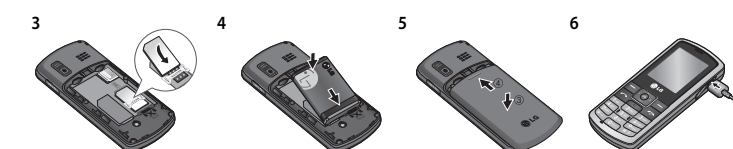

WARNING: Do not remove the battery when the phone is switched on, as this may damage the phone.

Menu map

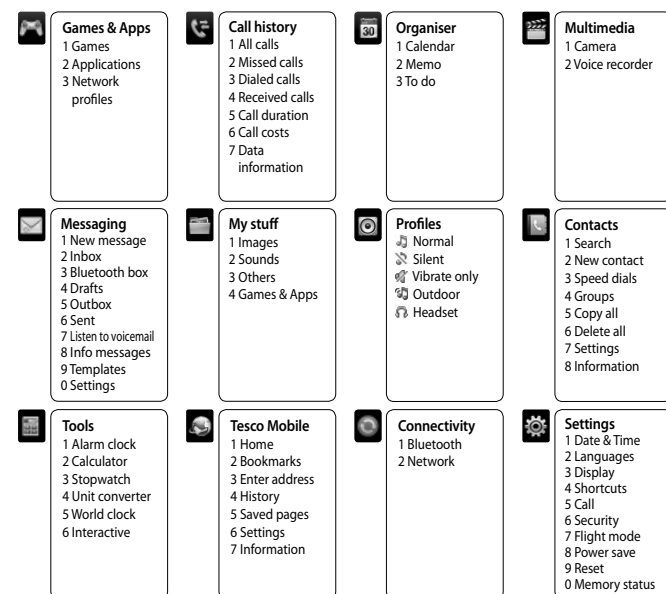

Calls

Making a call

- Key in the number using the keypad. To delete a digit press .
- Press to initiate the call.
- To end the call, press .

TIP! To enter + when making an international call, press and hold 0.

Making a call from your contacts

- Press to open Search.
- Using the keypad, enter the first letter of the contact you want to call. For example, for Office, press 6 three times.
- To scroll through the contacts and their different numbers use and .
- Press to initiate the call.

Answering and rejecting a call

- When your phone rings, press **Accept** or press to answer the call.
- While your phone is ringing, select **Silent** to mute the ringing. This is great if you have forgotten to change your profile to **Silent** for a meeting.
- Press or **Reject** to reject the incoming call.

TIP! You can change the settings on your phone to answer your calls in different ways. Press **Menu**, select **Settings** and choose **Call**. Select **Answer mode** and choose from **Any key** or **Send key only**.

123 mode

Type numbers using one keystroke per number. You can also add numbers while remaining in letter modes by pressing and holding the desired key.

Message folders

Press **Menu**, select **Messaging**.

New Message - This is where you can send a new message. Choose **Message** to send SMS or MMS. Choose **Bluetooth message** if you want to send something using Bluetooth.

Inbox - All the messages you receive are placed into your Inbox. From here you can reply, forward and more, see below for details.

Bluetooth box - Contains all your sent and received files by using Bluetooth.

Drafts - If you don't have time to finish writing a message, you can save what you have done so far here.

Outbox - This is a temporary storage folder while messages are being sent.

Sent - All the messages you send are placed into your Sent items folder.

Listen to voicemail - You can access your voice mail box (if provided by your network).

When a new voice message is received, will be displayed on the standby screen.

Info message - All info messages and updates received from your operator.

Templates - A list of useful messages, already written for a quick reply.

Settings - You can change the predefined message settings as you like.

Speed dialling

You can assign a speed dial number to a contact you call frequently.

- Press **Menu**, Select **Contacts** and choose **Speed dials**.
- Your voicemail is preset to speed dial 1 and you cannot change this. Select any other number either by using the navigation keys and selecting **Assign** or by pressing the hard key number.
- Your address book will open. Select the contact you'd like to assign to that number using the navigation keys then select **OK**.
- To call a speed dial number, press and hold the assigned number until the contact appears on screen. The call will begin automatically and there is no need to press .

Viewing your call logs

You can check the record of missed, received, and dialed calls only if the network supports the Calling Line Identification (CLI) within the service area. The number and name (if available) are displayed together with the date and time at which the call was made. You can also view call durations. Press **Menu**, select **Call history**.

Changing the call settings

You can set the menu relevant to a call. Press **Menu**, select **Settings** and choose **Call**.

• **Call divert** - Choose whether to divert All voice calls, when the line is busy, when there is no reply, when you are out of reach, or All data calls. Choose **Activate** and select whether to divert to voice mail, to other number or to favorite number. Enter your divert number or select **Search** to browse **Contacts** for your divert number.

Note: Charges are incurred for diverting calls. Please contact your network provider for details.

• **Fixed dial number** - Choose a list of numbers that can be called from your phone. You'll need your PIN2 code from your operator. Only numbers included in the fixed dial list can be called from your phone.

Using templates

You can create templates for the **Text** and **Multimedia** messages you send most frequently. There are some templates already on your phone, which can be edited if you wish.

- Press **Menu**, select **Messaging** and choose **Templates**.
- Choose **Text templates** or **Picture templates**. You can then select **Options** and choose **Edit** to change existing templates or select **Options** to add **New template** or **Delete** templates.
- To send a template, select the one you want to send, choose **Options** and select **Send via**.
- Choose how you would like to send the template; as a **Message** or **Bluetooth message**.
- Select **Options** and press **send to**.
- Choose options, select a contact and press **OK key**.

Multimedia

Camera

Taking a quick photo

Using the camera module built in your phone, you can take pictures of people. Additionally, you can send photos to other people and select photos as wallpaper.

- Press **Menu** and select **Multimedia**, select **Camera** to open the viewfinder.
- Holding the phone vertically, point the lens towards the subject of the photo.
- Press the centre soft key to take a photo.

After you've taken your photo

Your captured photo will appear on the screen. Press **Options** to use the other functions outlined below, except **Delete**.

Contacts

Adding a new contact

You can add a new contact to your contacts.

- Press **Contacts** and choose **New contact**.
- Choose whether to store your new contact on your **Phone** or **SIM** card.
- Enter all the information you have in the fields provided and select **Save**.

Note: When you are storing a contact's email address, press to enter a symbol and scroll with and until you see @.

Messaging

Your KP170 includes functions related to SMS (Short Message Service), MMS (Multimedia Message Service) and Bluetooth, as well as the network's service messages.

Sending a message

- Press **Menu**, select **Messaging** and choose **New message**.
- Choose **Message** to send an SMS or MMS.
- A new message editor will open. Message editor combines SMS and MMS into one intuitive and easy to switch between SMS mode and MMS mode. The default setting of the message editor is SMS mode.
- Enter your message using the T9 predictive mode by choose **Set T9 "On"** from **Options** or **Abc, abc, ABC** or **123** manual mode. You can switch text input mode between **Abc, abc, ABC** and **123** by pressing .

TIP! You can select your message type as SMS or MMS when you enter a text longer than 2 pages in the message field.

- Delete** - Touch to delete the photo you've just taken and confirm it by touching **Yes**.
- New photo** - Touch to take another photo straightaway. Your current photo will be saved.
- Set as** - Touch to open a sub menu to set your image as **Wallpaper** or **Picture ID**.
- Send Via** - Touch to send the photo as a **Message** or **Bluetooth**.
- Album** - Touch to look at the other photos in your album. Your current photo will be saved.

Voice recorder

Use your **Voice recorder** to record voice memos or other sounds.

Recording your voice recorder

- Press **Menu** and select **Multimedia**, then choose **Voice recorder**.
 - Press to begin recording.
 - Choose **Stop** to end the recording.
 - Press **Options** and choose **Play sound** to listen to the voice recorder.
- Note:** You can listen to all of the voice recordings you have saved by selecting **Options** and **Album**.

My stuff

You can store any multimedia files into your phone's memory so that you have easy access to all of your images, sounds, games and others. All your multimedia files will be saved in **My stuff**. Press **Menu** then select **My stuff** to open a list of folders.

- Press **Options** and choose **Insert** to add an **Image**, **Sound**, **Symbol**, **Text template**, **Emoticon**, **Name & Number**, **New slide**, **Subject** or **More** (**Contact/My business card/Schedule/Memo/To do**).

- Press **Options**, then **Send to**.

- Enter the phone number or press **Options** and select **Contacts** or **Recent list** to open your contacts list. You can add multiple contacts.

- Press **Options**, then **Send**.

WARNING: If an **Image**, **Sound**, **New slide** or **Subject** is added to the message editor, it will be automatically converted to MMS mode and you will be charged accordingly.

Entering text

You can enter alphanumeric characters using the phone's keypad. For example, storing names in **Contacts**, writing a message and creating scheduling events in the calendar all require entering text. The following text input methods are available in the phone: T9 predictive mode, **Abc** manual mode and **123** mode.

Note: Some fields may allow only one text input mode (e.g. telephone number in address book fields).

T9 predictive mode

T9 predictive mode uses a built-in dictionary to recognise words you're writing based on the key sequences you press. Simply press the number key associated with the letter you want to enter, and the dictionary will recognise the word once all the letters are entered.

Abc manual mode

This mode allows you to enter letters by pressing the key labeled with the required letter once, twice, three or four times until the letter is displayed.

