

# LG-C300 User Guide

Some of the content of this manual may differ from your phone depending on the software of the phone or your service provider.

## Disposal of your old appliance

- When this crossed-out wheeled bin symbol is attached to a product it means the product is covered by the European Directive 2002/96/EC.
- All electrical and electronic products should be disposed of separately from the municipal waste stream via designated collection facilities appointed by the government or the local authorities.
- The correct disposal of your old appliance will help prevent potential negative consequences for the environment and human health.
- For more detailed information about disposal of your old appliance, please contact your city office, waste disposal service or the shop where you purchased the product.



P/N: MMBB0392917(1.0)

## Installing the SIM Card and Charging the Battery

### Installing the SIM Card

When you subscribe to a cellular network, you are provided with a plug-in SIM card loaded with your subscription details, such as your PIN, any optional services available and many others.

**Important!** The plug-in SIM card can be easily damaged by scratches or bending, so be careful when handling, inserting or removing the card. Keep all SIM cards out of the reach of small children.

### Illustrations

- Open the battery cover
  - Remove the battery
  - Insert your SIM
  - Insert your battery
  - Close the battery cover
  - Charge your battery
- ↳ If the phone won't turn on, or if the display freezes or doesn't respond, follow the instructions for installing the battery again.

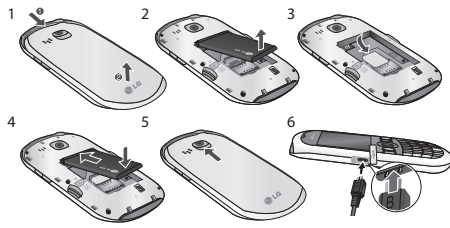

**WARNING:** Do not remove the battery when the phone is switched on, as this may damage the phone.

### After taking a photo

Your captured photo will appear on the screen. The image name is shown on the bottom top of the screen with five icons on the bottom side.

- Album** - View the pictures and videos you have taken in your Album.
- Send** - Send the photo as **Message**, as an **Email** or via **Bluetooth**.
- New** - Take another photo straight away.
- Set as** - Use the image as Wallpaper, as a **Contact** image, or in your Start up image or Shut down image.
- Delete** - Delete the photo you have just taken. The viewfinder will reappear.

### Video Camera

#### Shooting a quick video

- Press **Menu** and select **Camera** and choose **Video Camera**. The video camera's viewfinder will appear on screen.
- Focus the camera on what to record.

#### 7 Select Send.

**WARNING:** Image, Sound, Video, New slide, Subject, Business card, Schedule or My business card is added to the message editor, it will be automatically converted to MMS mode and you will be charged accordingly.

#### Entering text

You can enter alphanumeric characters using the phone's keypad. For example, storing names in contacts, writing a message and creating scheduling events in the calendar all require entering text.

The following text input methods are available in the phone: Abc mode, and 123 mode.

**NOTE:** Some fields may allow only one input mode (e.g. telephone number in contact fields).

#### Changing your text message settings

Press **Menu**, select **Messaging**, then choose **Settings** and **Text message**. You can make changes to:

- Select the **Rec.** icon on the bottom-centre of the screen and press **OK** to take a video. **Rec.** will appear at the bottom of the viewfinder. Press **OK** again to stop recording.

#### After you've shot your video

A still image representing your captured video will appear on screen. After recording a video clip, you can check the menu as follow:

- Album** - View the pictures and videos you have taken in your Album.
- Play** - Play the file.
- New** - Press to shoot another video straight away.
- Send** - Send the video as **Message**, as an **Email** or via **Bluetooth**.
- Delete** - Delete the video you have just made. The viewfinder will reappear.

- Text message centre** - Enter the details for your message centre.
  - Delivery report** - Choose to receive confirmation that your message have been delivered.
  - Validity period** - Choose how long your messages are stored at the message centre.
  - Message types** - Convert your text into **Voice**, **Fax**, **X.400** or **Email**.
  - Character encoding** - Choose how your characters are encoded. This affects the size of your message and therefore data costs.
  - Send long text as** - Choose whether to send your message as Multiple SMS or MMS when you enter a text longer than 2 pages in the message field.
- Changing your multimedia message settings**  
Press **Menu**, select **Messaging**, then choose **Settings** and **Multimedia message**. You can make changes to:
- Retrieval mode** - Choose to automatically or manually download multimedia messages depending on whether

## Getting to Know Your Phone

- Earpiece**
- Send key**
  - Dials a phone number and answers a call.
  - In standby mode:** Shows the history of calls.
- Alpha numeric keys**
  - In standby mode:** Input numbers to dial **Hold down**
    - International calls
    - Connect voice mail centre
    - Speed dials
    - Hold the key down to go Silent mode
  - In editing mode:** Enter numbers & characters
- Confirm key / OK key**
  - Selects menu options and confirms actions.
- Soft keys (Left soft key / Right soft key)**
  - These keys perform the function indicated in the bottom of the display.
- Main LCD**
- End key**
  - Switch on/off (hold down)
  - End or reject a call.
- Navigation key**
  - In standby mode:**
    - Briefly: Mp3 player
    - Briefly: Camera
    - Briefly: Toolbar when it was set. (Menu > Settings > Display > Homescreen > Display Items)
  - In menu:** Scroll up & down.

## Calling

### Making a Call

- Make sure your phone is on.
- You can use the keypad. To delete a digit press the back arrow.
- Press **Send** to begin the call.
- To end the call, press **End**.

**TIP!** To enter + when making an international call, press and hold 0.

### Making a call from your Contacts

It's easy to call anyone whose number you have stored in your Phonebook.

- Press **Menu** to open the main menu. Select **Phonebook**.
- Using the keypad, enter the first letter of the contact you want to call and scroll to the **Phonebook**.
- Press **Send** to begin the call.

## Music

### MP3 Player

Your LG-C300 has a built-in music player so you can play all your favourite music.

**NOTE:**

- Before using music player, you will need to transfer music file onto your phone.
- Music player supports codec types as follows: MP3, WMA, AAC. Music player does not necessarily support all features and variations of file formats.

To access the music player, press **Menu** and select **Music** and select **MP3 player**. From here you can access to:

- Recently played** - View all of the songs you have played recently.
- All songs** - Contains all of the songs you have on your phone.
- My Playlists** - Contains all playlists you have created.
- Artists** - Allows you to view all tracks sorted by artist.

you are at home or roaming.

- Delivery report** - Choose to request or allow a delivery report.
- Read reply** - Choose to request or allow a read reply.
- Priority** - Choose the priority level of your multimedia message.
- Validity period** - Choose how long your message is stored at the message centre.
- Slide duration** - Choose how long your slides appear on screen.
- Creation mode** - Allows you to select the contents type supported by MMS.
- Delivery time** - Configures the delivery time of message to the recipient. The multimedia message centre will deliver the message after the delivery time.
- Multi msg centre** - Allows you to configure network information such as the multimedia service centre and the internet profile to send a multimedia message.

### Answering and rejecting a call

When your phone rings, press **Accept** or press **Send** to answer the call.

While your phone is ringing you can press **Silent** to mute the ringing. This is useful if you have forgotten to change your profile to silent for a meeting.

Press **End** or select **Reject** in order to reject an incoming call.

**NOTE:** In call when speaker is activated, the speaker icon is displayed with red colour cross, when the speaker is deactivated speaker icon is displayed without red colour cross.

### Speed dialing

You can assign a speed dial number to a contact you call frequently.

### Viewing your Call History

You can only check the log of missed, received and dialed calls if the network supports Calling Line Identification (CLI) within the service area.

- Albums** - Allows you to view all tracks sorted by album.
- Genres** - Allows you to view all tracks sorted by genre.
- Shuffle all songs** - Allows you to play all of the songs in random order.

## E-Mail

### Sending an email using your new account

To send/receive an email, you should set up an email account.

- Press **Menu**, select **E-Mail** and choose the account you want to use.
- Choose **Write e-mail** and a new email window will open.
- Write a subject line then press **OK**.
- Enter your message using the keypad.

## FM Radio

### Listening to the Radio

- Press **Menu** and select **Music**, then choose **FM radio**.
- Select the channel number of the station you would like to listen to.

## More

### Setting your Alarm

Finally you can set the snooze interval at 5, 10, 20, 30 minutes, 1 hour or off.

### Adding an event to your calendar

Select the date you would like to add an event to. You can choose a date either by scrolling to it using the navigation keys or by selecting **Options** and **Go to date** in order to enter a date.

### Adding an item to your task list

You can edit an item by selecting it, pressing **Options** and **Edit**. Confirm your amends by selecting **Done**.

### Adding a memo

You can lock the memo. Press **Option** and select **Lock** for the private memo to protect privacy.

### Date finder

Date finder is a handy tool to help you calculate what the date will be once a certain number of days have passed.

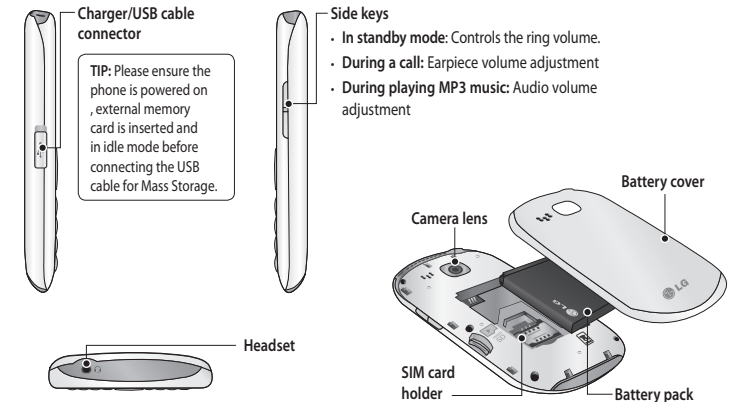

### Changing the call settings

You can set call-specific functions. Press **Menu**, select **Settings** and choose **Call**.

- Call divert** - Choose whether to divert your calls.
- Call barring** - Select which calls you would like to be barred.
- Call waiting** - Be alerted when you have a call waiting.
- Fixed dial numbers** - Choose a list of numbers that can be called from your phone.
- Excuse message**
- Call reject settings** - Select **Off** or **On** and choose to reject all calls, those from specific groups, contacts, unregistered numbers (those not in your list of contacts) or those with no caller ID.
- Send my number** - Choose whether your number will be displayed when you call someone. (Depends on your network provider.)
- Auto redial** - Allows you to set the auto redial function when a call attempt has failed.

**NOTE:** If you are in an area with bad radio reception, you may have difficulty listening to the radio. It is recommended that you insert headphones into the hands-free connector when listening to the radio to ensure good radio reception.

## Web

### Accessing the web

You can launch the WAP browser and access the homepage of the activated profile on web settings. You can also manually enter a URL address and access the associated WAP page.

- Press **Menu** and select **O2 Home**.
- To go straight to the browser home page, select **Home**. Alternately, select **Enter address** and type in the URL, followed by **Connect**.

**NOTE:** You will incur extra cost by connecting to these services and downloading content. Check data charges with your network provider.

### Voice recorder

Use your **Voice recorder** to record voice memos or other sounds.

### Sending a voice recording

Once you have finished recording, select **Options**.

### Using your calculator

- Press **Menu** and select **More**, then choose **Calculator**.
- Press the numeric keys to input numbers.

### Using the stopwatch

- Press **Menu** and select **More**, then choose **Stopwatch**.
- Select **Start** to begin the timer.

### Converting Units

- Press **Menu** and select **More**, then choose **Unit converter**.
- Choose whether you would like to convert **Currency**, **Area**, **Length**, **Weight**, **Temperature**, **Volume** or **Velocity**.

### Minute minder

- Minute minder** - Determines whether to sound a tone every 1 minute when you are in the call.
- Bluetooth answer mode** - Choose how to answer a call when using a Bluetooth headset. Select **Hands-free** or **Headset**.
- Save new number** - Selecting this option will save numbers that are not already in your contacts upon ending the call.
- Call costs** - View the charges applied to your last call or all calls. This service is network dependent, some operators are unable to support this.

## Camera

### Taking a quick photo

- Press **Menu** and select **Camera** and **Camera**.
- When the camera has focused on your subject, select the **Capture** icon on the bottom-centre of the screen and press **OK** to take a photo.

## Messaging

Your LG-C300 includes functions related to SMS (Short Message Service), MMS (Multimedia Message Service) as well as the network's service messages. To use these functions, press **Menu** and select **Messaging**.

### Sending a message

- Press **Menu**, select **Messaging** and choose **Write message**.
- A new message editor will open. Message editor combines **SMS** and **MMS** in one intuitive mode that is easy to switch between. The default setting of the message editor is **SMS** mode.
- Enter your message using the keypad. See **Entering text** on the right for more information on how to enter text.
- Select **Options** and choose **Insert** to add an **Image**, **Video**, **Sound**, **Template**, **Emoticon**, **Name & Number**, **New slide**, **Subject** or **More** (**Business card**/**Schedule**/**Memo**/**Task**/**My business card**).
- Choose **Send**.
- Choose a contact from the list of contacts or enter the phone number.

### Adding a city to your World clock

- Press **Menu** and select **More**, then choose **World clock**.
- To find out the time of specific city, press **Options** and select **New city**.

## Settings

### Changing your profiles

- Press **Menu** and select **Settings**.
- Select **Profiles** and then choose the profile you want to edit.
- Select **Options** and choose **Personalise**.
- You can change all of the tones, its volumes and alert options from here.

## Using Flight Mode

When Flight mode is activated, you will not be able to make calls, connect to the Internet or send messages.

### Changing your Device settings

- Press **Menu** and select **Settings**.
- Select **Device** settings and choose from the list below.
- Power save** - Choose to switch the factory set power saving settings On or Off.

- Languages** - Change the language of for your LG-C300's display.
- Auto key lock** - Choose a duration for locking the key automatically.

### Changing the date & time

- Press **Menu** and select **Settings**.
- Select **Device** and choose **Date and Time** and choose from the list below:
- Date and time settings** - Select On Auto update, and the phone will automatically update the date and time.

### Changing your Bluetooth settings

Touch **Bluetooth** in the SETTINGS tab, select **Settings** and choose **Connectivity**.

### Pairing with another Bluetooth device

- By pairing your LG-C300 and another device, you can set up a passcode protected connection. This means your pairing is more secure.
- Check your Bluetooth is **Turn on** and **Visible**. You can change your visibility in the **Settings of Bluetooth** menu, by selecting My device visibility, then Visible.
  - From **Bluetooth**, choose **Activate Bluetooth** and select **Search new device**.
  - Your LG-C300 will search for devices. When the search is completed **Add** and **Refresh** will appear on screen.
  - Choose the device you want to pair with, select **Add** and enter a passcode then choose **OK**.
  - Your phone will then connect to the other device, with which you should enter the same passcode.
  - Your passcode protected Bluetooth connection is now ready.

- The unit should be kept away from heat sources such as radiators or cookers.
- Do not drop.
- Do not subject this unit to mechanical vibration or shock.
- Switch off the phone in any area where you are required by special regulations. For example, do not use your phone in hospitals as it may affect sensitive medical equipment.
- Do not handle the phone with wet hands while it is being charged. It may cause an electric shock and can seriously damage your phone.
- Do not charge a handset near flammable material as the handset can become hot and create a fire hazard.
- Use a dry cloth to clean the exterior of the unit (do not use solvents such as benzene, thinner or alcohol).
- Do not charge the phone when it is on soft furnishings.
- The phone should be charged in a well-ventilated area.
- Do not subject this unit to excessive smoke or dust.
- Do not keep the phone next to credit cards or transport tickets; it can affect the information on the magnetic strips.

## Accessories

Various accessories are available for your mobile phone. These are detailed below.



### Battery



#### NOTE

- Always use genuine LG accessories. Failure to do so may invalidate your warranty.
- Accessories may be different in different regions. Please check with our regional service company or agent for further enquires.

## Technical Data

### Ambient Temperatures

- Max: +55°C (discharging) +45°C (charging)
- Min: -10°C

- Date format** - You can enter the current date. You can set the date format (DD/MM/YYYY, MM/DD/YYYY, YYYY/MM.DD).
- Date separator** - You can enter the current date. You can set the date separator (DD/MM/YYYY, DD.MM.YYYY, DD-MM-YYYY).
- Time format** - You can set the date format **12 hours** or **24 hours**.

### Changing your security settings

Change your security settings to keep your LG-C300 and the important information it holds protected.

- Press **Menu** and select **Settings** and choose **Device**.
- Select **Security** and choose from the list below:
  - PIN code request** - Choose a PIN code to be requested when you turn your phone on.
  - Device lock** - Choose a security code to lock your phone **Never, At device start up, When SIM card is changed** or **Immediately**.

### Using a Bluetooth headset

- Check your Bluetooth is **Activate Bluetooth** and **Visible**.
- Follow the instructions that came with your headset to place it in pairing mode and pair your devices.
- Your LG-C300 will automatically connect to your Bluetooth headset and switch to headset profile.

### Sending and receiving your files using Bluetooth

**To switch Bluetooth on:**

- Press **Menu** and select **Settings**. Choose **Connectivity** then select **Bluetooth**.
- Select **Activate Bluetooth**.
- Select **Deactivate Bluetooth** to switch Bluetooth off.

### To send a file:

- Open the file you want to send, typically this will be a photo, video or music file.
- Select **Options** and choose **Send**, then **Bluetooth**.
- Select **Yes** to turn Bluetooth on if it is not already activated.
- Your LG-C300 will automatically search for other Bluetooth enabled devices within range.

- Do not tap the screen with a sharp object as it may damage the phone.
- Do not expose the phone to liquid or moisture.
- Use accessories like earphones cautiously. Do not touch the antenna unnecessarily.

### Efficient Phone Operation Electronic Devices

- Do not use your mobile phone near medical equipment without requesting permission. Avoid placing the phone over pacemakers, i.e. in your breast pocket.
- Some hearing aids might experience disturbance due to mobile phones.
- Minor interference may affect TVs, radios, PCs etc.

### Road Safety

Check the laws and regulations on the use of mobile phones in the areas where you drive.

- Do not use a hand-held phone while driving.
- Give your full attention to driving.
- Use a hands-free kit, if available.

- Application lock** - You can lock the contents you want to hide. (Phonebook, Messaging, E-mail, etc.)
- Change codes** - Change your PIN code (This menu item will appear if PIN code request is set to On), PIN2 code, Security code.

<b>NOTE: Security code</b>
The security code protects the unauthorised use of your phone. The default security code is set to '0000' and the security code is required to delete all phone entries and to activate the Reset settings menu. Also, the security code is required to enable or disable the phone lock function to prevent unauthorised use of the phone. The security code default setting can be modified from the Security > Change codes.

### Viewing memory status

Your LG-C300 has three memories available: the phone, the SIM card and an external memory card (you may need to purchase the memory card separately). You can use the memory manager to determine how each memory is used and see how much space is available.

- Choose the device you want to send the file to and select **OK**.

#### To receive a file:

- To receive files, your Bluetooth must be both **Activate Bluetooth** and **Visible**.
- A message will prompt you to accept the file from the sender. Select **Yes** to receive the file.

<b>TIP!</b> Keep an eye on the progress bar to make sure your file is sent.
---

<b>TIP!</b> The Bluetooth® word mark and logos are owned by the Bluetooth SIG, Inc. and any use of such marks by LG Electronics is under licence. Other trademarks and trade names are those of their respective owners.
--

### Synchronise your phone with your PC

You can synchronise your phone with your PC to make sure all your important details and dates match, but also to backup your files to put your mind at ease.

- Pull off the road and park before making or answering a call if driving conditions so require.
- RF energy may affect some electronic systems in your vehicle, such as car stereos and safety equipment.
- If your vehicle is equipped with an airbag, do not obstruct it with installed or portable wireless equipment. This may cause the airbag to fail or cause serious injury due to improper performance.
- If you are listening to music while out and about, please ensure that the volume is at a reasonable level so that you are aware of your surroundings. This is particularly imperative when near roads.

### Avoid Damage to Your Hearing

Damage to your hearing can occur if you are exposed to loud sounds for long periods of time. We therefore recommend that you do not turn the handset on or off when it is close to your ear. We also recommend that music and call volumes are set to a reasonable level.

Excessive sound and pressure from earphones can causing hearing loss.
---

## Troubleshooting

This section lists some problems that you might encounter while using your phone. Some problems require that you call your service provider, but most of problems you encounter are easy to correct yourself.

Symptom	Possible causes	Possible Corrective measures
No connection to the network	Signal is weak or you're outside of the carrier network.	Move to a window or open space. Check service provider coverage map.
Codes do not match	When you want to change a security code you have to confirm the new code by entering it again. The two codes that you have entered do not match.	Contact your Service Provider.
Function cannot be set	Not supported by Service Provider or registration required.	Contact your Service Provider.
Calls not available	Dialing error or service limitations.	Check the number dialed and check the reception. Contact your service provider.
Calls not available	Dialing error New SIM card inserted Prepaid Charge limit reached	New network not authorized. Check for new restrictions. Contact Service Provider or reset limit with PIN 2.

Press **Menu** and select **Settings**, select **Device** and choose **Memory info** You will then see the current status of the memories in your LG-C300.

### Resetting your phone

Use **Reset Device** in **Device of Settings** menu to reset all the settings to the factory definitions. You need the security code to activate this function.

### Changing your display settings

- Press **Menu** and select **Settings**.
- Select **Display** and choose from:
  - Homescreen** - Adjust the Wallpaper and Display items.
  - Menu theme** - Quickly change the whole look of your screen.
  - Menu style** - Change the menu view from List style or Grid style.
  - Font** - Adjust the font size.
  - Backlight** - Choose how long the backlight remains on. Also, use the navigation keys to adjust the main screen brightness.

### Backing up and restoring your phone's information

- Connect the USB cable to your phone and your PC.
- Select the **PC suite** from the popp menu in your phone.
- Click on the Backup icon, and select **Backup** or **Restore**.
- Mark the contents you would like to back up or restore. Select the location you would like to backup information to, or restore information from. Click **OK**.
- Your information will be backed up.

### Viewing your phone files on your PC

Viewing the contents of your phone on your PC helps you to arrange files, organise documents and remove contents you no longer need.

### Blasting Area

Do not use the phone where blasting is in progress. Observe restrictions, and follow the rules and regulations.

### Potentially Explosive Atmospheres

- Do not use the phone at a refueling point.
- Do not use near fuel or chemicals.
- Do not transport or store flammable gas, liquid, or explosives in the same compartment of your vehicle as your mobile phone and accessories.

### In Aircraft

Wireless devices can cause interference to aircraft.

- Turn your mobile phone off before boarding any aircraft.
- Do not use it on the aircraft without permission from the crew.

### Children

Keep the phone in a safe place out of the reach of small children. It includes small parts which may cause a choking hazard if detached.

<b>TIP!</b> The longer the backlight is on for, the more battery power is used and you may need to charge your phone more often.
--

- Greeting message** - After selecting On, you can write a welcome message. The message will appear on screen whenever you start-up the phone.
- Other screens** - Choose the theme of your home screen or start-up/shut down screen.

### Social network services (SNS)

Your LG-C300 has SNS that lets you enjoy and manage your social network.

<b>NOTE:</b> An additional costs may be incurred when connecting and using online services. Check your data charges with your network provider.
---

## Guidelines for Safe and Efficient Use

### Exposure to Radio Frequency Energy Radio Wave Exposure and Specific Absorption Rate (SAR) Information

This LG-C300 mobile phone model has been designed to comply with the applicable safety requirements for exposure to radio waves. These requirements are based on scientific guidelines that include safety margins designed to ensure the safety of all users, regardless of age and health.

- The radio wave exposure guidelines employ a unit of measurement known as the Specific Absorption Rate, or SAR. SAR tests are conducted using standardized methods with the phone transmitting at its highest certified power level in all used frequency bands.
- While there may be differences between the SAR levels for various LG phone models, they are all designed to meet the relevant guidelines for exposure to radio waves.

### Battery Information and Care

- You do not need to completely discharge the battery before recharging. Unlike other battery systems, there is no memory effect that could compromise the battery's performance.
- Use only LG batteries and chargers. LG chargers are designed to maximise the battery life.
- Do not disassemble or short-circuit the battery pack.
- Keep the metal contacts of the battery pack clean.
- Replace the battery when it no longer provides acceptable performance. The battery pack maybe recharged hundreds of times until it needs replacing.
- Recharge the battery if it has not been used for a long time to maximise usability.

Symptom	Possible causes	Possible Corrective measures
Phone cannot be switched on	On/Off key pressed too briefly. Battery is not charged.	Press On/Off key for at least two seconds. Charge battery. Check charging indicator in the display.
	Battery contacts are dirty.	Clean the battery contacts.
Charging error	Battery totally empty. Contact problem.	Charge battery. Check power supply and connection to the phone. Check the battery contacts, clean them if necessary.
	No power from outlet. Charger defective. Wrong charger. Battery defective.	Plug in to a different socket or check voltage. Test with another charger. Only use original LG accessories. Replace battery.
Network connection is lost.	Signal too weak.	Reconnection to another service provider if network mode is automatic.
Number not permitted	The Fixed Dial Number function is on.	Check the Settings menu and turn the function off.

## Phone Software update

### LG Mobile Phone Software update from internet

For more information on using this function, please visit the http://update.lgmobile.com or http://www.lg.com/common/index.jsp → select country → Support. This Feature allows you to update the firmware of your phone to the latest version conveniently from the internet without the need to visit a service centre.

As the mobile phone firmware update requires the user's full attention for the duration of the update process, please make sure to check all instructions and notes that appear at each step before proceeding. Please note that removing the USB data cable or battery during the upgrade may seriously damage you mobile phone.

### Changing your connectivity settings

Your connectivity settings have already been set up by your network operator, so you can enjoy your new phone immediately. To change any settings, use this menu: Touch **Connectivity** in the SETTINGS tab.

- The SAR limit recommended by the International Commission on Non-Ionizing Radiation Protection (ICNIRP) is 2 W/kg averaged over 10 g of tissue.
- The highest SAR value for this phone model tested by DASY4 for use close to the ear is 0.986 W/kg (10 g), and when worn on the body is 0.670 W/kg (10 g).
- SAR data information for residents in countries/regions that have adopted the SAR limit recommended by the Institute of Electrical and Electronics Engineers (IEEE), which is 1.6 W/kg averaged over 1 g of tissue.

### Product Care and Maintenance

<b>⚠ WARNING:</b> Only use batteries, chargers and accessories approved for use with this particular phone model. The use of any other types may invalidate any approval or warranty applying to the phone, and may be dangerous.
---

- Do not disassemble this unit. Take it to a qualified service technician when repair work is required.
- Keep away from electrical appliances such as TVs, radios and personal computers.

- Do not expose the battery charger to direct sunlight or use it in places with high humidity, such as in the bathroom.

- Do not leave the battery in hot or cold places, as this may deteriorate the battery performance.
- There is a risk of explosion if the battery is replaced by an incorrect type.
- Dispose of used batteries according to the manufacturer's instructions. Please recycle when possible. Do not dispose of batteries in the household waste.
- If you need to replace the battery, take it to the nearest authorised LG Electronics service point or dealer for assistance.
- Always unplug the charger from the wall socket after the phone is fully charged to save unnecessary power consumption of the charger.
- Actual battery life will depend on network configuration, product settings, usage patterns, battery and environmental conditions.