



Getting to know your phone



Menu map

Messaging 1 New message 2 Inbox 3 Drafts 4 Outbox 5 Sent 6 Listen voice mail 7 Info messages 8 Templates 9 Settings	Contacts 1 Search 2 New contact 3 Speed dials 4 Copy all 5 Delete all 6 Memory status 7 Information	Call history 1 All calls 2 Missed calls 3 Dialed calls 4 Received calls 5 Call duration	Games 1 Space ball	FM radio
Profiles 1 General 2 Silent 3 Vibrate only 4 Outdoor 5 Flight mode 6 Headset	Tools 1 Torch 2 Fake call 3 Calculator 4 Stopwatch 5 Unit converter 6 World clock 7 SIM Services	Organiser 1 Alarm 2 Calendar 3 Memo	Settings 1 Date & Time 2 Language 3 Display 4 Call 5 Auto keylock 6 Security 7 Power save 8 Network selection 9 Reset settings 0 Memory status	

Calls

Making a call

- Key in the number using the keypad.
 - Press to initiate the call.
 - To end the call, press .
- TIP!** To enter + when making an international call, press and hold 0.

Making a call from your contacts

- Press to open the address book.
- Using the keypad, enter the first letter of the contact you want to call.
- To scroll through the contacts and their different numbers use and .
- Press to initiate the call.

Contacts

Searching for a contact

You can search for a contact in your contacts.

- Press **Contacts** and choose **Search**, select **Contacts** from the **Menu** screen or press from the standby screen.
- Using the keypad enter the first letter of the contact you want to call.
- To scroll through the contacts and their different numbers use and .

Messaging

Sending a message

- Press **Menu**, select **Messaging** and choose **New message**.
- A new message editor will open. The default setting of the message editor is SMS mode.
- Enter your message using either the T9 predictive mode or Abc manual mode. You can switch text input mode by pressing .
- Press **Options** and choose **Insert** to add a **Symbol**, **Template**, **Contact**, **Business card**.
- Press **Send to**.
- Enter the phone number or press **Options** and select **Contacts** or **Recent list** to open your contacts list.
- Press **Send**.

FM radio (Wireless FM)

With embedded FM antenna, you can receive FM radio without an external earphone. You can listen to your favor radio station anytime.

Note: In weak FM radio signal area the sensitivity can degrade with wireless and antenna mode. So it is advisable to insert the ear-mic for better and enhanced FM quality.

Listening to the radio

- Press **Menu** and select **FM radio**.
 - Select the channel number of the station you would like to listen to.
- Note:** You can listen to the radio via built-in speaker. Press **Options**, select **Listen via** and choose **Speaker**.

Games

Your GS108 comes with preloaded games to keep you amused when you have time to spare. If you choose to download any additional games or applications they will be saved into this folder. Press **Menu** and select **Games**.

Organiser / Tools

Setting your alarm (Menu > Organiser > Alarm)

You can set up to 3 alarm clocks to go off at a specified time.

Using the calendar (Menu > Organiser > Calendar)

When you enter this menu, a calendar appears. A square cursor is located on the current date. You can move the cursor to another date using the navigation keys.

Adding a memo (Menu > Organiser > Memo)

You can register your own memos here.

Torch (Menu > Tools > Torch)

You can turn on/off the flash light.

Installing the SIM Card and Charging the Battery

Installing the SIM Card

When you subscribe to a cellular network, you are provided with a plug-in SIM card loaded with your subscription details, such as your PIN, any optional services available and many others.

Important! The plug-in SIM card and its contacts can be easily damaged by scratches or bending, so be careful when handling, inserting or removing the card. Keep all SIM cards out of the reach of small children.
 > only 2G/2.5G SIM supported

Illustrations

- Open battery cover
- Remove the battery
- Insert your SIM
- Close the battery cover
- Charge your battery

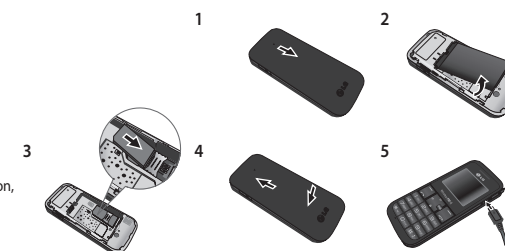

WARNING: Do not remove the battery when the phone is switched on, as this may damage the phone.

Answering and rejecting a call

When your phone rings, press **Accept** or press to answer the call. While your phone is ringing, select **Silent** to mute the ringing. This is great if you have forgotten to change your profile to **Silent** for a meeting.

Press or **Reject** to reject the incoming call.

TIP! You can change the settings on your phone to answer your calls in different ways. Press **Menu**, select **Settings** and choose **Call**. Select **Answer mode** and choose from **Any key** or **send key only**.

Changing the call settings

You can set the menu relevant to a call. Press **Menu**, select **Settings** and choose **Call**.

- Call divert** – Select methods of call divert.
- Call waiting** – Select active or cancel call waiting.

Entering text

You can enter alphanumeric characters using the phone's keypad. For example, storing names in **Contacts**, writing a message and creating scheduling events in the calendar all require entering text. The following text input methods are available in the phone: T9 predictive mode, ABC manual mode and 123 mode.

Note: Some fields may allow only one text input mode (e.g. telephone number in address book fields).

T9 predictive mode

T9 predictive mode uses a built-in dictionary to recognise words you're writing based on the key sequences you press. Simply press the number key associated with the letter you want to enter, and the dictionary will recognise the word once all the letters are entered.

ABC manual mode

This mode allows you to enter letters by pressing the key labeled with the required letter once, twice, three or four times until the letter is displayed.

123 mode

Type numbers using one keystroke per number. You can also add numbers while remaining in letter modes by pressing and holding the desired key.

Using your calculator (Menu > Tools > Calculator)

The calculator provides the basic arithmetic functions: addition, subtraction, multiplication and division.

Using the stopwatch (Menu > Tools > Stopwatch)

This option allows you to use the function of a stopwatch.

Converting a unit (Menu > Tools > Unit converter)

This converts many measurements into a unit you want.

Adding a city to your world clock (Menu > Tools > World clock)

You can check the current time of Greenwich Mean Time (GMT) and major cities around the world.

SIM services (Menu > Tools > SIM services)

This feature depends on SIM and the network services. In case the SIM card supports SAT (i.e. SIM Application Toolkit) services, this menu will be the operator specific service name stored on the SIM card.

Settings

Changing your profiles

You change your profile by pressing **Menu**>**Profiles**, then choose from General, Silent, Vibrate only, Outdoor, Flight mode and Headset.

Changing your date & time (Menu > Settings > Date & Time)

You can set functions relating to the date and time.

Changing the language (Menu > Settings > Language)

You can change the language for the display texts in your phone. This change will also affect the language input mode.

Changing your display settings (Menu > Settings > Display)

You can change the settings for the phone display.

Guidelines for safe and efficient use

Please read these simple guidelines. Not following these guidelines may be dangerous or illegal. Further detailed information is given in this manual.

WARNING

- Mobile Phones must be switched off at all times in an aircraft.
- Do not hold the phone in your hand while driving.
- Do not use your phone near petrol stations, fuel depots, chemical plants or blasting operations.
- For your safety, use ONLY specified ORIGINAL batteries and chargers.
- Do not handle the phone with wet hands while it is being charged. It may cause an electric shock or seriously damage your phone.
- Keep the phone in a safe place out of small children's reach. It includes small parts which if detached may cause a choking hazard.
- Do not charge the phone when it is on soft furnishings.
- The phone should be charged in a well ventilated area.

Product care and maintenance

WARNING

Only use batteries, chargers and accessories approved for use with this particular phone model. The use of any other types may invalidate any approval or warranty applying to the phone, and may be dangerous.

- Do not disassemble this unit. Take it to a qualified service technician when repair work is required.
- Keep away from electrical appliances such as TVs, radios, and personal computers.
- The unit should be kept away from heat sources such as radiators or cookers.
- Do not drop.
- Do not subject this unit to mechanical vibration or shock.
- The coating of the phone may be damaged if covered with wrap or vinyl wrapper.
- Use dry cloth to clean the exterior of the unit. (Do not use solvent such as benzene, thinner or alcohol.)
- Do not subject this unit to excessive smoke or dust.
- Do not keep the phone next to credit cards or transport tickets; it can affect the information on the magnetic strips.
- Do not tap the screen with a sharp object; otherwise, it may damage the phone.
- Do not expose the phone to liquid or moisture.
- Use the accessories like an earphone cautiously. Do not press the antenna unnecessarily.

Children

Keep the phone in a safe place out of small children's reach. It includes small parts which if detached may cause a choking hazard.

Emergency calls

Emergency calls may not be available under all mobile networks. Therefore, you should never depend solely on the phone for emergency calls. Check with your local service provider.

Battery information and care

- You do not need to completely discharge the battery before recharging. Unlike other battery systems, there is no memory effect that could compromise the battery's performance.
- Use only LG batteries and chargers. LG chargers are designed to maximize the battery life.
- Do not disassemble or short-circuit the battery pack.
- Keep the metal contacts of the battery pack clean.
- Replace the battery when it no longer provides acceptable performance. The battery pack maybe recharged hundreds of times until it needs replacing.
- Recharge the battery if it has not been used for a long time to maximize usability.

Setting your fake call (Menu > Settings > Fake call)

You can send the fake call after setting time.

Changing your security settings (Menu > Settings > Security)

Change your security settings to keep your GS108 and the important information it holds protected.

- **PIN code request** - Choose a PIN code to be requested when you turn your phone on.
- **Phone lock** - Choose a security code to lock your phone, **When power on**, **When SIM changed** or **Immediately**.
- **Anti Theft Mobile Tracker** - When the handset is stolen, handset sends the SMS to the numbers configured by real owner. User has to configure the ATMT settings with name, primary phone number, secondary number. User has to Set ATMT ON to activate the ATMT feature. Default ATMT code is "0000". ATMT SMS will contain information about the stolen phone IMEI, current location & number of the person who is using that handset.
- **Change codes** - Change your **Security code** or **PIN2 code**.

CAUTION

- Switch off the phone in any area where required by special regulations. For example, do not use your phone in hospitals or it may affect sensitive medical equipment.
- Emergency calls may not be available under all mobile networks. Therefore, you should never depend solely on the phone for emergency calls.
- Only use ORIGINAL accessories to avoid damage to your phone.
- All radio transmitters carry risks of interference with electronics in close proximity. Minor interference may affect TVs, radios, PCs, etc.
- Batteries should be disposed of in accordance with relevant legislation.
- Do not dismantle the phone or battery.

Exposure to radio frequency energy

Radio wave exposure and Specific Absorption Rate (SAR) information

This mobile phone model GS108 has been designed to comply with applicable safety requirement for exposure to radio waves. This requirement is based on scientific guidelines that include safety margins designed to assure this safety of all persons, regardless of age and health.

Efficient phone operation

Electronics devices

All mobile phones may get interference, which could affect performance.

- Do not use your mobile phone near medical equipment without requesting permission. Avoid placing the phone over pacemakers, i.e. in your breast pocket.
- Some hearing aids might be disturbed by mobile phones.
- Minor interference may affect TVs, radios, PCs, etc.

Road safety

Check the laws and regulations on the use of mobile phones in the areas when you drive.

- Do not use a hand-held phone while driving.
- Give full attention to driving.
- Use a hands-free kit, if available.
- Pull off the road and park before making or answering a call if driving conditions so require.
- RF energy may affect some electronic systems in your vehicle such as car stereos and safety equipment.
- When your vehicle is equipped with an air bag, do not obstruct with installed or portable wireless equipment. It can fail or cause serious injury due to improper performance.

If you are listening to music whilst out and about, please ensure that the volume is at a reasonable level so that you are aware of your surroundings. This is particularly imperative when near roads.

- Do not expose the battery charger to direct sunlight or use it in high humidity, such as the bathroom.
- Do not leave the battery in hot or cold places, this may deteriorate the battery performance.
- There is risk of explosion if the battery is replaced by an incorrect type.
- Dispose of used batteries according to the manufacturer's instructions. Please recycle when possible. Do not dispose as household waste.
- If you need to replace the battery, take it to the nearest authorized LG Electronics service point or dealer for assistance.
- Always unplug the charger from the wall socket after the phone is fully charged to save unnecessary power consumption of the charger.

Power save (Menu > Settings > Power save)

If you set **Always on**, you can save the battery power when you don't use the phone. Choose to switch the power save settings **Always on**, **Night only** or **Off**.

Resetting your phone (Menu > Settings > Reset settings)

Use **Reset** to reset all the settings to their factory definitions. You need the security code to activate this function. The default number is "0000".

Using flight mode (Menu > Profiles > Flight mode)

Use this function to switch the flight mode **On** or **Off**. You will not be able to make calls, Connect to the internet, Send messages when **Flight mode** is switched **On**.

- The radio wave exposure guidelines employ a unit of measurement known as the Specific Absorption Rate, or SAR. Tests for SAR are conducted using standardized method with the phone transmitting at its highest certified power level in all used frequency bands.
- While there may be differences between the SAR levels of various LG phone models, they are all designed to meet the relevant guidelines for exposure to radio waves.
- The SAR limit recommended by the international Commission on Non-Ionizing Radiation Protection (ICNIRP), which is 2 W/Kg averaged over ten (10) gram of tissue.
- The highest SAR value for this model phone tested by DASY4 for use at the ear is 1.20 W/Kg (10g) and when worn on the body is 0.605 W/Kg (10g).
- SAR data information for residents in countries/regions that have adopted the SAR limit recommended by the Institute of Electrical and Electronics Engineers (IEEE), which is 1.6 W/Kg averaged over one (1) gram of tissue.

Avoid damage to your hearing

Damage to your hearing can occur if you are exposed to loud sound for long periods of time. We therefore recommend that you do not turn on or off the handset close to your ear. We also recommend that music and call volumes are set to a reasonable level.

Blasting area

Do not use the phone where blasting is in progress. Observe restrictions, and follow any regulations or rules.

Potentially explosive atmospheres

- Do not use the phone at a refueling point. Don't use near fuel or chemicals.
- Do not transport or store flammable gas, liquid, or explosives in the compartment of your vehicle which contains your mobile phone and accessories.

In aircraft

Wireless devices can cause interference in aircraft.

- Turn off your mobile phone before boarding any aircraft.
- Do not use it on the ground without crew permission.

Technical data

Ambient Temperatures

Max : +55°C (discharging)
+45°C (charging)

Min : -10°C

Declaration of Conformity		LG Electronics	
Supplier Details			
Name			
L&S Electronics Inc			
Address			
LG Electronics Inc, LG Twin Towers B3, Yongin-si, Yongin-gyeongju, Seoul, Korea 100-721			
Product Details			
Product Name			
GS900 / GS900 1800 Dual band Terminal Equipment			
Model Name			
G8160, G8170, G8177, G8167N, G8170			
Trade Name			
LG			
Applicable Standards Details			
PARTS Compliance (2006/95/EC)			
EMC 2014/53/EU, 1988/CE, EN 61010-1:2011, EN 61010-2-1:2011			
EMC 2011/65/EU			
EN 50369-1:2010, EN 50369-2:2010			
EN 60950-1:2005			
Regulatory Information			
The conformity to above standards is verified by the following notified body (NB7)			
BAW, Papestrasse 44, D-50823 Cologne, Germany, 0178 870, United Kingdom			
Notified Body Identification Number: 0109			
Declaration			
I, the undersigned, declare under our sole responsibility that the product mentioned above is in full, free conformity with the above mentioned			
Standards and Directives			
Date of Declaration			
Signature of representative			
Signature of representative			
LG Electronics Inc, Yongin-si, 2017 All Areas, The Netherlands			
Tel: +81-28-247-2845, Email: jpark@lg.com			