

Model	VC3016NRTV		
Language	English+Chinese		
Page	28	Color(cover/body)	4/2
Material	Weight 100g	Size(W*H)	150 x 220(mm)
Date	2011.03.24	Designer	Jinquanliang
Part No.	MFL66099710	Description	Owner's manual

Chage Record

No.	Change content	ECO No.	Date	Designer	Confirm
①					
②					
③					
④					
⑤					
⑥					
⑦					
⑧					
⑨					



使用说明书

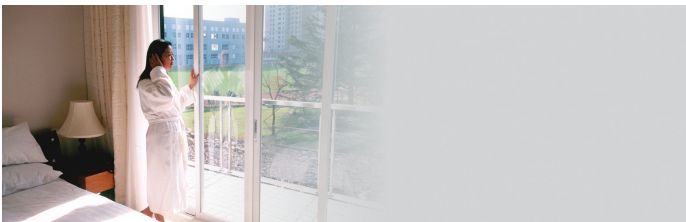

吸尘器

强劲吸力

VC3016NRTV

中文 ——> 1-15页

English ——> Page 16-29

售后服务电话



使用前请仔细阅读说明书，阅读完后请妥善保管以备需要时查阅。

目 录

产品规格	2
使用前注意事项	3-4
吸尘器的组装及吸力调节	5
部分名称与连接方法	
附件	
吸力调节	
尖吸嘴 鸭嘴 毛刷的使用及角落刷头的使用与清洁方法	6
震动刷头的使用与清洗方法	7
使用方法	
清洗方法	
集尘桶的拆卸 / 清理方法	8
灰尘分离器的清理方法	
集尘桶、灰尘分离器的清理 / 安装方法	9
清洗方法	
安装方法	
电机保护过滤器的拆卸 / 洗涤 / 安装方法	10
拆卸方法	
清洗方法	
排气过滤器的拆卸 / 清理 / 安装方法	11
拆卸方法	
清理方法	
安装方法	
申报故障维修前的确认事项	12
拆卸方法	
清洗方法	
故障通告前需确认事项	13-14
故障通告前请先确认	
装箱单	15

产品规格

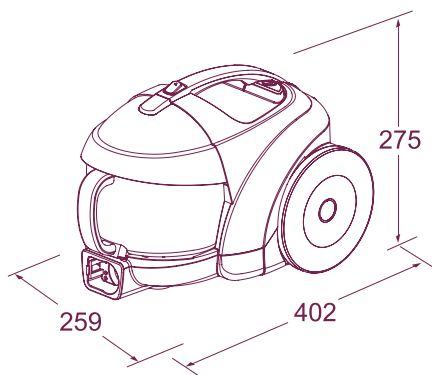

型号: VC3016NRTV
额定电压: 220 V~ 50 Hz
额定功率: 1400 W
最大功率: 1600 W
净重: 5.1 Kg
集尘容量: 1.2 L
外形尺寸: 402 mm x 259 mm x 275 mm
本产品执行标准: GB4706.1-2005
GB4706.7-2004
GB17625.1-2003
GB4343.1-2009

※ 为了提高产品质量而进行的外观及设计规格上的变更将不再另行通知。

使用前注意事项

使用前注意事项

忽视说明而导致的错误操作将会对您造成不同程度的损害，请认真阅读以下提示说明。

危险 此标识表明违反标记事项时，会立刻发生严重伤害或死亡现象。

警告 此标识表明违反标记事项时，有可能发生严重伤害或死亡现象。

注意 此标识表明违反此标记事项时，有可能发生财产损失或轻微伤害。

危险

请不要在易燃液体附近使用吸尘器，以免发生火灾。



插拔电源插头时，请先关闭电源开关，以免发生火灾或触电的危险。请不要用湿手触摸电源插头，以防触电。（不要在220V以外的电源上使用产品）

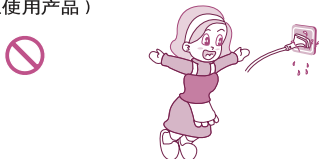

警告

请不要让大头钉等金属物存留在软管、机体延长管内，否则会造成短路故障。请不要吸入头发团、大纸团等物品，否则容易堵塞软管，如有堵塞现象，请及时清理。

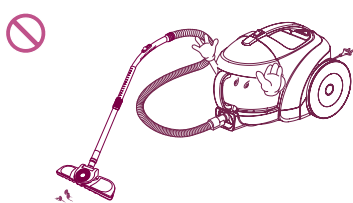

15A以上的电流请单独使用插线板，在一个插线板上同时使用多种电器可能会引发火灾。建议不要使用电源线延长线，以免引起不必要的危险。本吸尘器最大电流为6A。

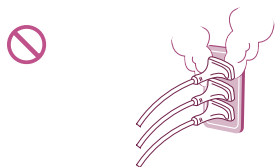

为避免发生火灾或触电的危险，在清扫时，注意不要让机体吸入液体、刀片、火种以及水泥、石膏粉等小微粒。

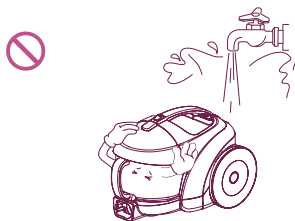

长时间不使用电器时，请记住拔掉电源插头；正处于通电时，请您不要离开。



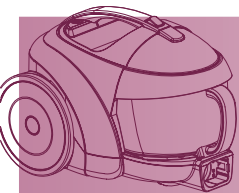

使用前注意事项

警告

请不要让电源线与吸尘器接近电暖器等热源，以免使机体变形或发生火灾。请您不要使用破损的电源和插头，如有破损，必须由指定维修站更换。

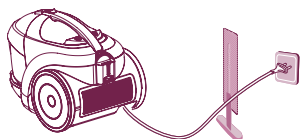

请不要让儿童把吸尘器及组件，如延长管等当做玩具，以防止意外。



请不要在吸入口和排气口堵塞时，继续长时间运作，否则可能造成机体变形或损坏。

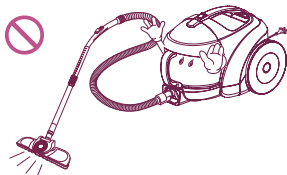

使用过程中，延长管和机体有产生静电的可能，请您使用时注意。



注意

非专业维修人员请勿开机修理。

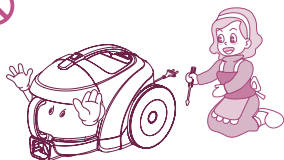

注意不要使电源线夹在门缝里或用电源线提拉吸尘器，防止电源线受损。

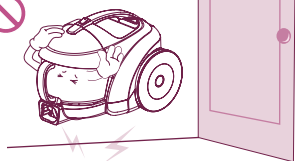

收卷电线时，请拿住电源插头后再按动卷线器按钮。

请不要将电源线拉至红色警告线以外，否则可能损坏电源线或不能回卷。

收线时请注意插头，以免损坏周围物品。



请不要弯曲、践踏、拉拽软管，如软管受损，请不要继续使用。

请不要用重物或尖刃物压线。

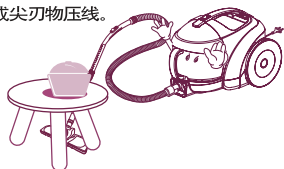

集尘筒集满时，请您正确开启集尘筒清理。请您注意不要在没安装集尘筒或过滤网时使用吸尘器。

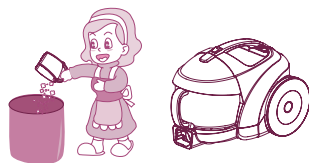

请您注意保护自身安全，使身体各部位远离吸尘器吸口或活动部位。

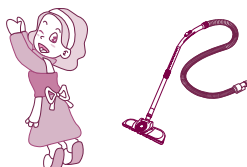

吸尘器的组装及吸力调节

部分名称与连接方法

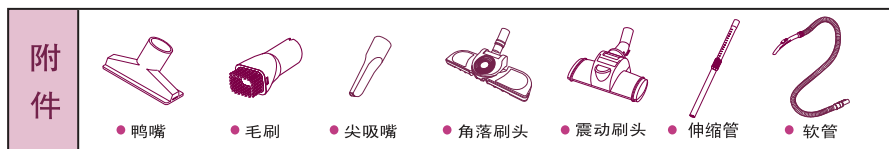
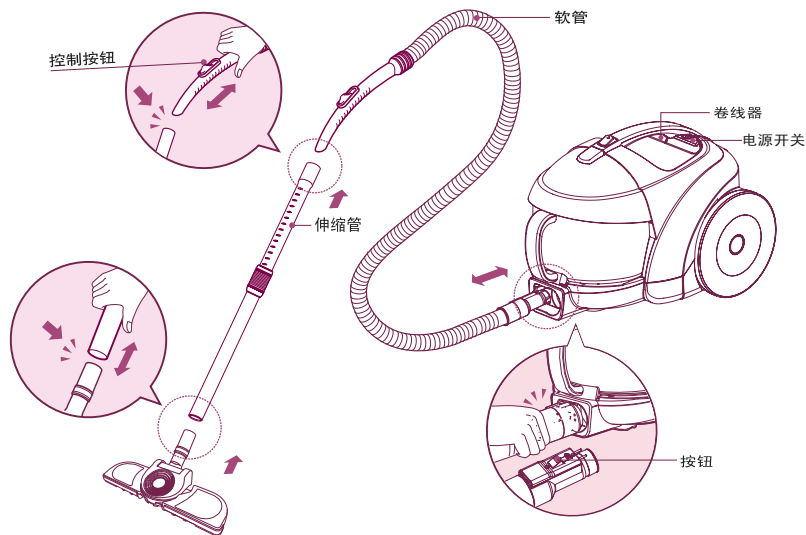

吸力调节

请按图示使用

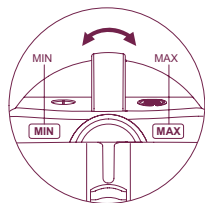

转动吸力调节按钮，
可随意调节吸力大小。

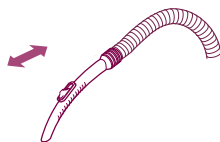

软管手柄处有一个手动的
气流控制按钮，
使您可以简单方便的
调节吸力大小。

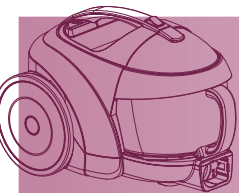

尖吸嘴 鸭嘴 毛刷的使用及角落刷头的使用与清洁方法

尖吸嘴的使用

请按图示使用

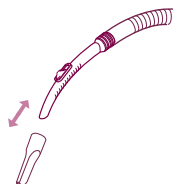

使用方法

尖嘴吸可以用来清理房间角落等不易清理到的地方。

鸭嘴与毛刷

▶ 打开附件袋，取出附件。

请按图示使用

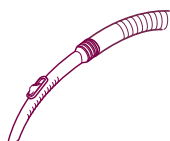
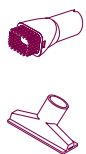

使用方法

用来清洁一般不容易接触的地方，如窗框，墙缝，画框，家具边缘，书或其它不平物体。



▶ 鸭嘴是用来对饰物、床垫等物品进行吸除的。

▶ 毛刷用于吸扫画框、家具边沿、书籍和其它不规则的表面。

角落刷头的使用

组合

▶ 角落刷头可以清洁普通地面，也可以折叠成直角来清洁墙角。

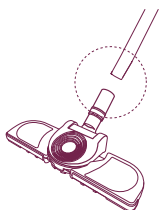

使用

▶ 不用再为清扫角落和窄小空间发愁，**角落刷头**会给您带来更多便利。

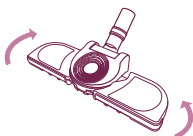

清洁

① 用尖吸嘴清洁

② 用棉质抹布擦拭

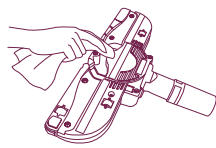
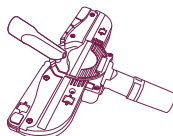

震动刷头的使用与清洗方法

使用方法

请按图示使用

组合

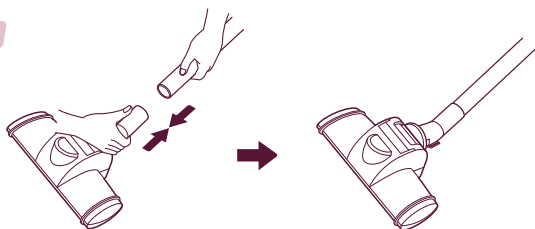

最佳效果清扫方法

- 床、床褥、厚棉被
- 薄被、毛毯

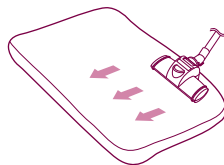
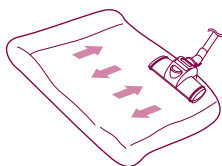

清扫薄被时，下面垫一个厚被，效果更理想！

- 若震动拍不运作，可轻轻向地面敲打刷头后再使用。
- 如还不震动，检查一下震动拍是否被棉絮卡住或需要调大吸力。
- 吸地毯时，根据地毯种类的不同，也会有发生不震动的可能性，所以最好专用于清扫床上用品。
- 集尘筒集满灰尘或吸力减小，震动幅度相应减小时，应注意及时倾倒集尘筒和清洗电机保护过滤海绵。

清洗方法

- ▶ 用毛刷简单清理震动刷头 
- ▶ 内外部都需要清理（吸入口不可用水冲洗，否则有可能产生机器故障）



① 分离刷头底盘

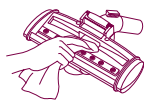

② 擦拭刷头缝隙脏物



③ 用水冲洗底盘

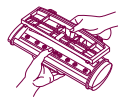

④ 将底盘嵌入卡槽
将刷头重新装好

- 内部震动结构具有严格的尺寸要求，请勿自行拆开本产品，否则会影响震动性能。注意不要让异物进入震动活塞行腔。
- 请勿拆开震动活塞行腔，否则会对拍打性能产生影响。
- 底盘应很好地与刷头结合后再使用，在重新装好震动刷头前，请确认震动拍是否已放到正确的位置上。如没有底盘震动拍，有可能不运作。
- 请只在清扫床上用品时使用震动刷头。（在普通地面或其他部位使用，会弄脏底盘或出现其他损坏）

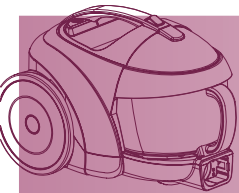

集尘桶的拆卸/清理方法

- 注意：**
- 集尘量达到集尘桶上标记的MAX线时，清理集尘桶。
 - 集尘量超过MAX时，吸入力可能降低。
 - 集尘桶至少三个月清洗一次，或根据使用频率酌情清理。

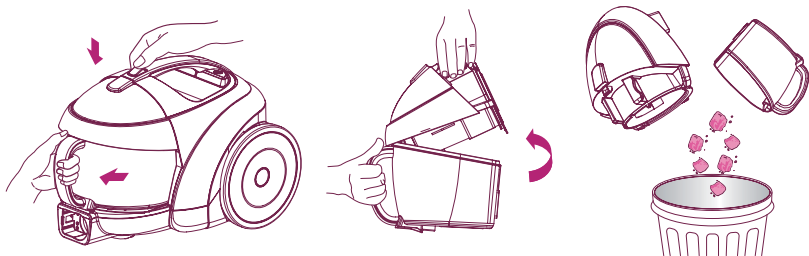

1 一手按住主机盖按钮，另一手握住集尘桶手柄，取下集尘桶。

2 手握集尘桶盖上的小把手，打开集尘桶。

3 倒掉灰尘

灰尘分离器的清理方法

- 注意：**
- 清洁集尘桶时，检查灰尘分离器内部。
 - 灰尘分离器内部有很多废纸、塑料等异物时，可能降低吸入力，请及时清理灰尘分离器。
 - 灰尘分离器至少三个月清洗一次，或根据使用频率酌情清理。

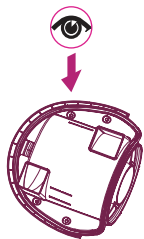

1 检查灰尘分离器内部是否有灰尘。

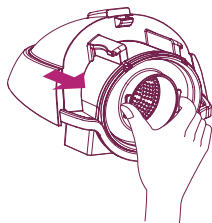

2 握住灰尘分离器盖的手柄拆卸盖子。

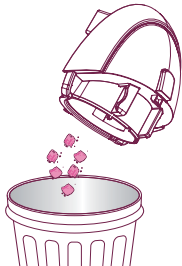

3 倒掉灰尘。

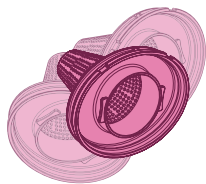

4 抖掉堵住灰尘分离器盖小孔的灰尘。

集尘桶、灰尘分离器的清洗/安装方法

清洗方法

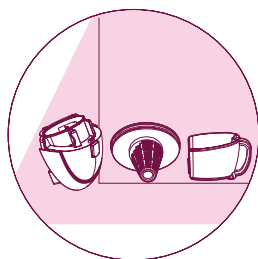
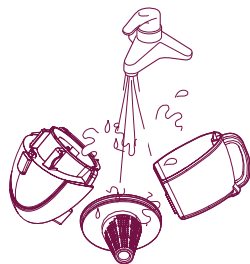

- 冲洗干净集尘桶、灰尘分离器、灰尘分离器盖。
- 在阴凉、通风处干燥一天左右，待完全干燥再使用。

安装方法

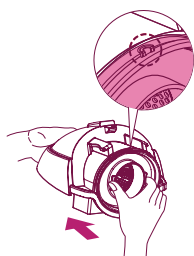

- 1 对准灰尘分离器盖的突起部和灰尘分离器槽后安装盖子。

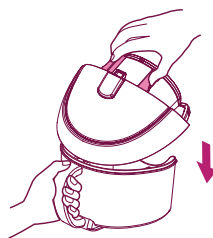

- 2 安装灰尘分离器和集尘桶。

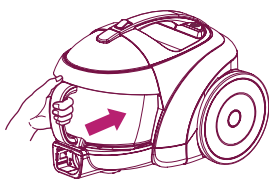

- 3 将集尘桶安装在吸尘器上。

注意：• 当手握把手将机体提起移动时，请不要用手指按动机体上方的按钮，那样容易导致集尘桶从机体上脱落。

• 在没有安装灰尘分离器盖的情况下使用吸尘器时，有可能出现噪音变大、吸入力急剧降低的现象，所以请务必再次确认是否安装好。

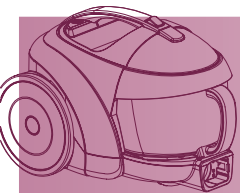

电机保护过滤器的拆卸/洗涤/安装方法

拆卸方法

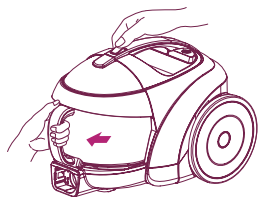

1 一手按住主机盖按钮，另一手取下集尘桶。

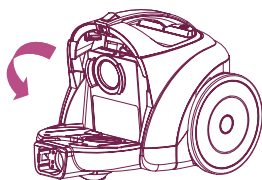

2 拆卸集尘桶后，从主机取出电机保护过滤器。

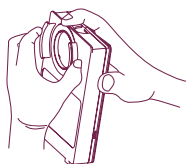

3 打开电机保护过滤器。

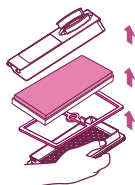

4 取出过滤海绵。

清洗方法

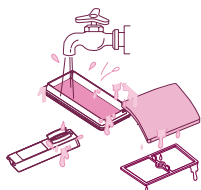

1 冲洗干净

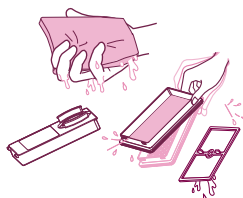

2 彻底去除水分

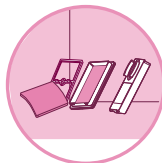

3 在阴凉、通风处干燥一天左右，待完全干燥后再使用。

注意：• 安装方法与拆卸方法相反。

• 在没有安装电机保护过滤器的情况下使用吸尘器时，可能出现噪音变大、灰尘进入电机，导致产品寿命缩短等现象，所以请再次确认安装情况。

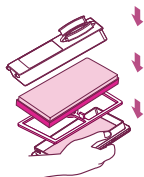

1 将电机保护过滤器装入过滤器外壳内。

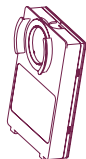

2 盖上过滤器盖。

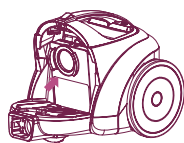

3 将组装好的过滤器放入安装部位。

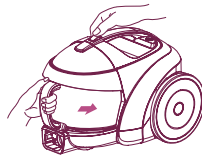

4 装入集尘桶。

排气过滤器的拆卸/清理/安装方法

拆卸方法

- ▶ 排气过滤器至少半年清理一次或根据使用频率酌情清理。

排气过滤器盖按钮

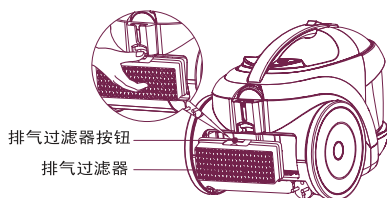
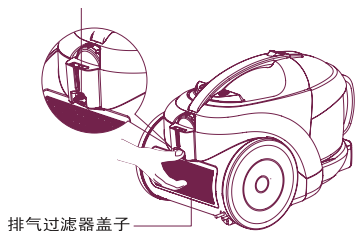

清理方法



- 1 抖动排气过滤器进行清理。

安装方法

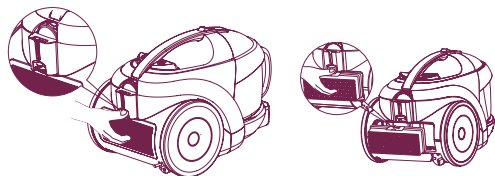

- 2 放入排气过滤器，按钮处有“咯哒”声时，表示排气过滤器盖安装准确。

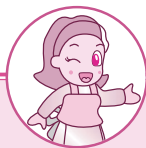

使用吸尘器后的保管方法

卷线器按钮

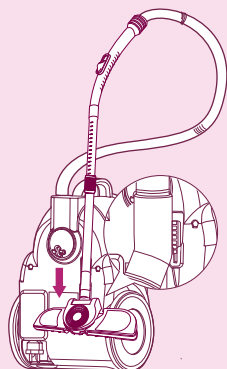
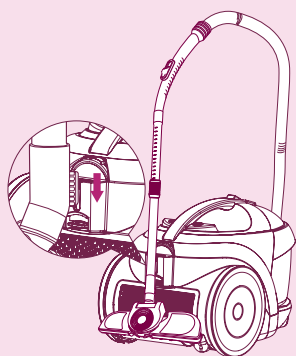
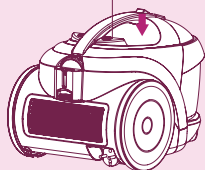

- 按下卷线器按钮时吸尘器电线自动被卷入。
- 吸入口的突起部插入主机背面或底面的凹槽后进行保管。

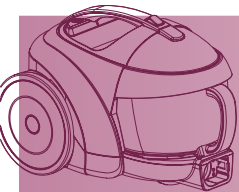

申报故障维修前的确认事项

- ▶ 我们应该避免产品并没有出现故障，却因申请维修服务而带来的不必要的麻烦。产品出现异常时，在申请服务中心或代理店的服务之前请确认以下事项。或许按照使用说明书的简单操作就可以解决了。

吸入力差？

第一阶段 确认吸入力调节键是否设置在最强位置

第二阶段 清洗电机保护过滤器。

拆卸方法

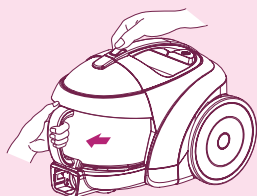

1 一手按住主机盖按钮，另一手取下集尘桶。

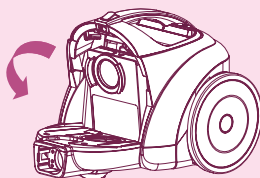

2 拆卸集尘桶后，从主机取出电机保护过滤器。

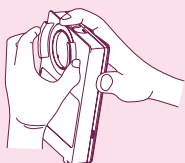

3 打开电机保护过滤器。

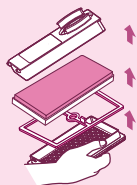

4 取出过滤海绵。

清洗方法 (用凉水清洗)

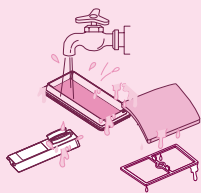

1 冲洗干净

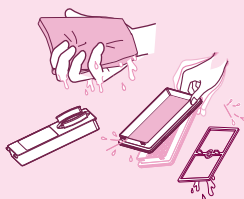

2 彻底去除水分

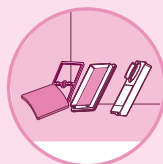

3 在阴凉、通风处干燥一天左右，待完全干燥后再使用。

故障通告前需确认事项

故障通告前请先确认

- ▶ 如果您怀疑产品发生故障，请先确认故障发生原因，再与售后服务中心或代理商联系，以确保检修的效率。

现象：

噪音加大
软管收缩



吸力忽然
下降

吸尘器求助：

请检查集尘筒
和吸入口



处理要领

- 1 查看集尘筒灰尘是否集满（到达MAX处），如果是，请及时清理集尘筒。

已经满了吗？请及时清理集尘筒哦！



- 2 请确认集尘筒滤芯是否堵塞
过滤器堵塞时会发出异常声，请及时清洗。

滤芯有问题吗？那么检查一下吸入口。



- 3 检查吸入口时，需将吸力调节到最大。

第一步

如果还有问题，
请进行第二步。

将伸缩管与刷头分离后，检查有无阻塞，如发现问题请立即清理。



第二步

如果还有问题，
请进行第三步。

分离手柄与伸缩管，检查有无阻塞，如有阻塞，请将伸缩管收缩，清除异物。



第三步

检查软管是否阻塞，将吸力调至最强，用手堵住管口，反复几次。







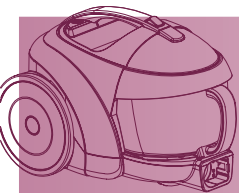

如果还有问题，
请清理一下滤芯。



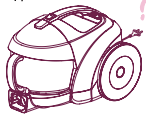

故障通告前请先确认

▶ 如果您怀疑产品发生故障，请先确认故障发生原因，再与售后服务中心或代理商联系，以确保检修的效率。

故障	检查	措施
吸尘器为何不能工作？ 	<ul style="list-style-type: none">● 电源插头是否插上？● 电源插座有电吗？● 软管是否插上？● 电机热保护处于开启期间。	<ul style="list-style-type: none">● 请将电源插牢（本产品适用于220V电压）。● 确认插座是否有电。● 将软管插牢。● 2小时后重新启动。
机体内有噪音。 	<ul style="list-style-type: none">● 吸尘器吸力过大或电机高速运转时所发出的声音，不属于异常情况，请正常使用。● 如果不是正常的电机响声，而是异常的噪音，请打电话与维修中心联系。● 集尘筒已满。● 集尘筒滤芯堵塞。● 吸入口阻塞。● 钢管阻塞。● 软管阻塞。	<ul style="list-style-type: none">● 清理集尘筒。● 用软毛刷轻轻刷滤芯，用水冲洗后放置于阴凉处风干一天。● 将吸入的异物取出再使用。● 将钢管内异物取出后再使用。● 将软管内异物取出后再使用。
机体出现异味。 	<ul style="list-style-type: none">● 电机运作时，用于固定电机的橡胶圈会受热而产生少量气味，不会影响运作或使机器发生损坏。● 机器不小心吸入一些水或集尘筒长期不清理时，会有一些异味排出，此时应及时清理集尘筒。	
电源线不能全部卷入机体，电源线不能全部拉出。 	<ul style="list-style-type: none">● 将电源线拉出一部分后重新卷入。● 请用力将电源线拉出，不会损坏电源线。● 由于线在内部互相缠绕或夏季周围温度过高所致。● 由于线在内部折曲或未缠在卷线器上，启动卷线器后，能正常运作。	
机体或排出的气体过热。 	<ul style="list-style-type: none">● 吸力是否正常？	<ul style="list-style-type: none">● 从机体内排出的热气，是由电机导热产生的热量所致，属正常温度，请继续使用。
软管内壁过脏。 	<ul style="list-style-type: none">● 请勿将水吸入，水与灰尘混合吸入后，有可能弄脏管壁。	

装箱单

装箱单

吸尘器	一台
说明书	一本
鸭嘴	一个
毛刷	一个
尖吸嘴	一个
软管	一根
伸缩管	一根
角落刷头	一个
震动刷头	一个
保修卡	一份

Table of contents

<i>Product specifications</i>	16
<i>Attention before using the appliance</i>	17 ~ 18
Assembling and adjusting the Cleaner	19
<i>Parts description and assembly</i>	
<i>Accessories</i>	
<i>Adjusting the cleaner</i>	
<i>Using crevice tool, upholstery nozzle, dusting brush, corner nozzle and cleaning the corner nozzle</i>	20
<i>Using and Cleaning the Sani Punch</i>	21
<i>Using</i>	
<i>Cleaning</i>	
<i>How to separate or empty the dust box</i>	22
<i>How to empty the dust separator</i>	
<i>How to clean and assemble the dust box and separator</i>	23
<i>Cleaning</i>	
<i>Assembling</i>	
<i>How to separate, clean and assemble the protection filter of the motor</i>	24
<i>Disassembling</i>	
<i>Cleansing</i>	
<i>How to separate, clean and assemble exhaust filter</i>	25
<i>Disassembling</i>	
<i>Cleansing</i>	
<i>Assembling</i>	
<i>Check before reporting the trouble</i>	26
If you have a problem	27 ~ 28
<i>Packing List</i>	29

Product specifications

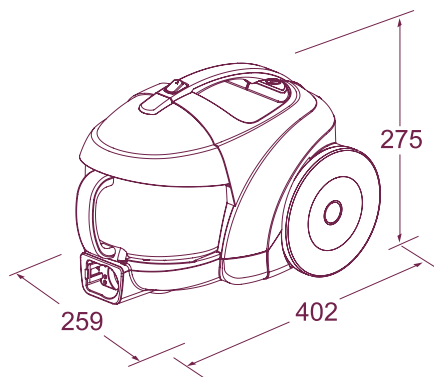

Model: VC3016NRTV

220 V~ 50 Hz

IEC: 1400 W

MAX: 1600 W

Net Weight: 5.1 Kg

Dust Capacity: 1.2 L

Dimension: 402 mm x 259 mm x 275 mm

This appliance complies with the following GB Directives:

GB4706.1-2005

GB4706.7-2004

GB17625.1-2003

GB4343.1-2009

※ You will not be informed otherwise of any changes in appearance and standard deriving for improvement of product quality.

Attention before using the appliance

Attention before using the appliance

Please read all the following information, which contains important instructions for the safety, the use of the appliance.

! DANGER May immediately cause serious injury or death.

! WARNING May possibly cause serious injury or death.

! ATTENTION May possibly cause losses of property or light injury.

! DANGER

Do not pick up anything that is burning or smoking, such as cigarettes, matches or hot ashes.



Please turn off the power before pulling out the plug to prevent fire or electric shock. Never handle plug or appliance with wet hands. (Do not use the appliance on the power above 220V.)

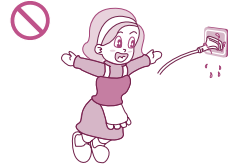

! WARNING

Avoid picking up hard, sharp objects with the cleaner. They may damage the cleaner and the tank.

Do not vacuum the objects like hair ball or big paper ball, otherwise the hose is possibly blocked up. Please clear the hose in time when it is blocked.

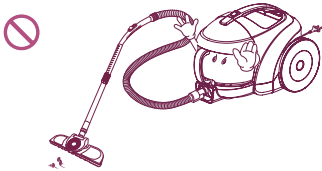

To avoid the danger of fire or electric shock, do not vacuum liquid, blade, flammable substances, or small particles like cement and gesso in cleaning.

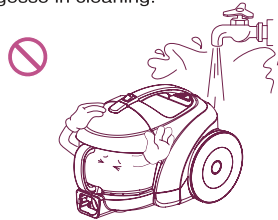

Independently use a socket when the current is $\geq 15A$. It may cause fire when many electric appliances share one socket. In order to avoid the needless danger, you had better not use the prolonged thread of power cord. The current at most 6A is allowed.

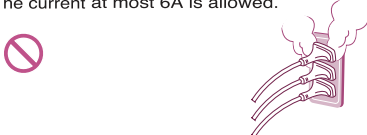

Unplug cleaner when not in use. Turn off all controls before unplugging.

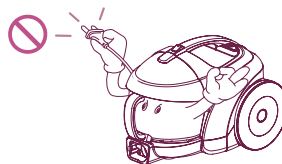

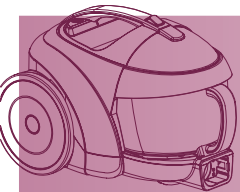

Attention before using the appliance

WARNING

Do not let the power cord near the electric heater or other heat source, lest that the cleaner should be deformed or it should cause fire. Do not use the appliance when the power cord or plug is damaged. The damaged power cord or plug must be replaced in the approved service station.

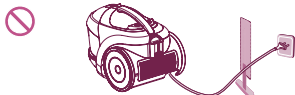

Close supervision is necessary when any appliance is used by or near children. Do not allow vacuum cleaner to be used as a toy or to run unattended at any time.



Do not operate the appliance for long when the nozzle inlet or nozzle outlet is blocked, which may have it deformed or damaged.

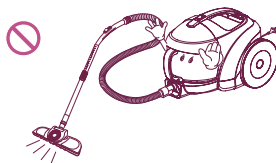

In using the appliance, pay attention to the electrostatic effect generated on the telescopic tube and cleaner body.

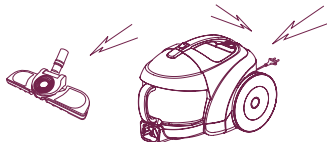

ATTENTION

Do not allow the non-professional maintenance people to repair.

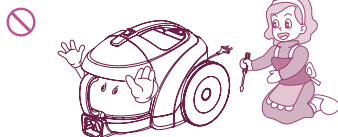

Do not pull or carry by cord, use cord as a handle, close door on cord or pull cord around sharp edges or corners. Do not run appliance over cord. Keep cord away from heated surfaces.

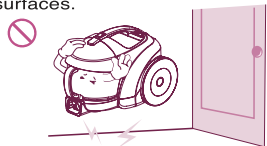

Do not bend, stamp on, or drag the hose. Do not continue to use the hose if it is damaged.

Do not use any heavy or sharp object to press the power cord.



Do not use without dust tank or filters in place. Change tank frequently when picking up very fine materials such as powder.

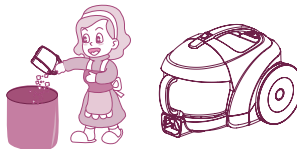

In winding the power cord, hold the plug before pressing the button of the cord reel. Do not pull the power cord beyond the red warning line, otherwise the power cord may be damaged or unable to be wound up. Pay attention to the plug in winding the cord to avoid damaging the surrounding objects.

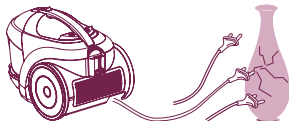

Keep hair, loose clothing, fingers, feet and all parts of body away from the nozzle or movable portion.

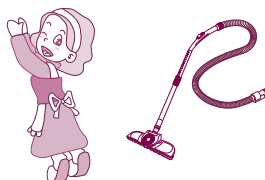

Assembling and adjusting the Cleaner

Parts description and assembly

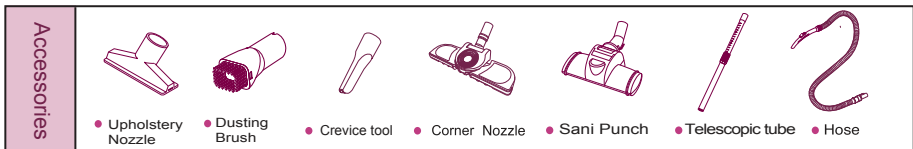
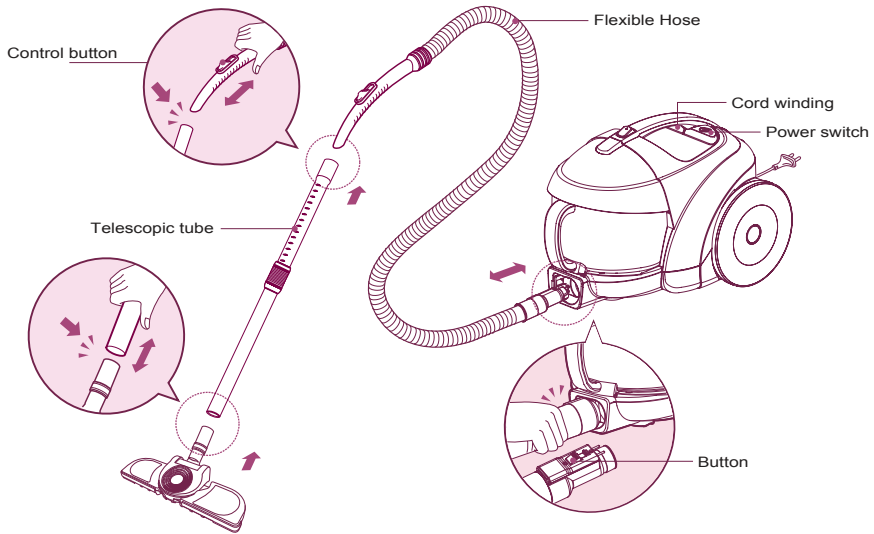

Adjusting the Cleaner

Use it as shown in the diagram

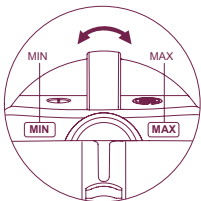

Slide the rotary control Knob to adjust the Suction power

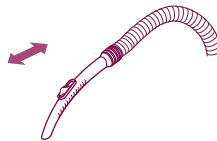

The flexible hose handle has a manual air flow regulator which allows you to briefly reduce the suction level.

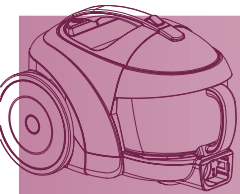

Using crevice tool, upholstery nozzle, dusting brush, corner nozzle and cleaning the corner nozzle

Using crevice tool

Use it as shown in the diagram

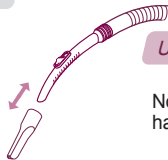

Using method

Nozzle, Crevice can be used for cleaning the place hard to reach.

Using Dust Brush & Upholstery Nozzle

▶ Tear the vinyl bag and pull out accessories.

Use it as shown in the diagram

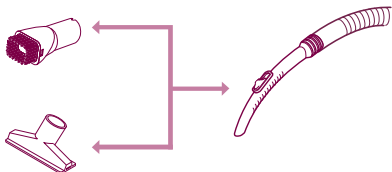

Using method

Nozzle, Crevice can be used for cleaning the place hard to reach.



Using and cleaning the corner nozzle

Assembling

▶ Corner nozzle can be used to clean common floor, also can be used to clean corner when be puckered.

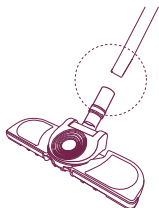

Using

▶ Corner nozzle makes you more convenient to clean corner and small space.

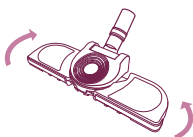

Cleaning

1 Use crevice tool to clean

2 Use calico dishcloth to clean

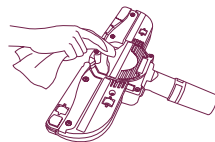
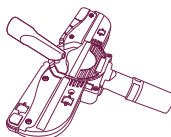

Using and Cleaning the Sani Punch

Using

Use it as shown in the diagram

Assembling

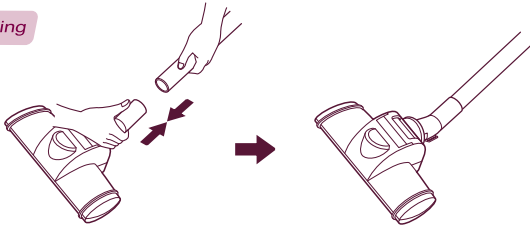

Effective cleaning

- bed, bedding, heavy blanket
- Light blanket & sheet

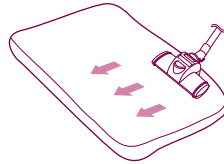
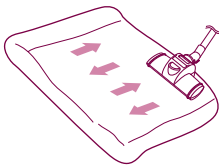

To increase cleaning efficiency for light blankets, lay on top of a bulky blanket and then clean.

- If the punch bar does not move, lift the nozzle slightly off the surface.
- If it does not move, even after doing this, check if the suction power is too low or if the nozzle base is clogged with a foreign object.
- This Sani Punch nozzle is for effective cleaning of beds and blankets to remove mites and dust.

Cleaning

▶ Use dust brush to clean quilt nozzle simply.



▶ Follow the instruction below for through washing. (Do not soak the entire body of the vacuum nozzle in water, it may cause the vibrator to malfunction)



1 Press the button on the rear side of the vacuum nozzle to separate the bottom plate.



2 Wipe all the soiled parts of the vacuum nozzle body with a cloth.



3 Wash the removed bottom plate with water and dry it..



4 Insert the attachment projections on bottom plate to the vacuum nozzle grooves.

- Since the vibrator inside is composed of precision parts, never disassemble the body. Be careful not to let foreign objects clog the air suction part on top of the vacuum nozzle.
- Since removal of the punch bar may cause performance problems, do not warp or remove it.
- Attach the bottom plate properly before using. Without this bottom plate, it may not function.
- Since this vacuum nozzle has been made exclusively for cleaning beds, blankets and upholstery, use it only for these cleaning purposes. (Using it to clean the floor may result soiling it or a drop in performance, do not use it for such purposes.)

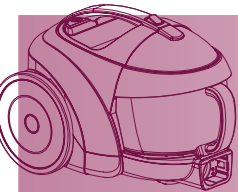

How to separate or empty the dust box

- Warning:**
- Empty the box when the dust settles up to the MAX line.
 - Too much dust beyond this line may reduce the inhaling power.
 - Dust box should be cleaned at least once per 3 months.

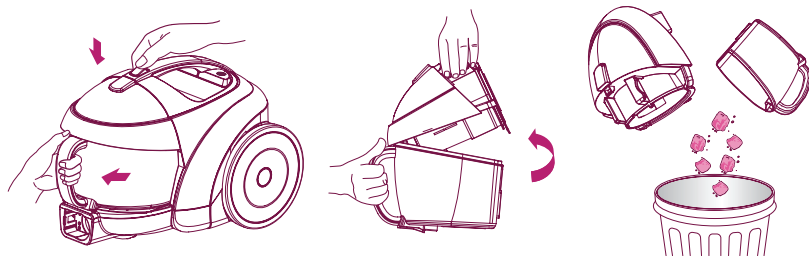

- 1 Detach the dust tank when press the button.
- 2 Uncover the dust tank cover by holding its handles.
- 3 Empty the dust tank.

How to empty the dust separator

- Warning:**
- Check the inside of the dust separator when cleaning the dust box.
 - Clean the inside of the dust separator, because too much foreign substance such as waste paper or plastic in the dust separator may reduce the inhaling power.
 - Dust separator should be cleaned at least once per 3 months.

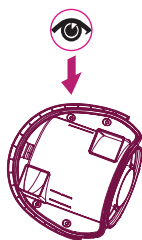

- 1 Check if the dust has settled in the dust separator.

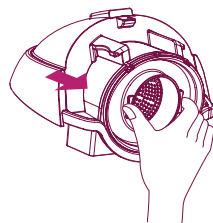

- 2 Separate the cover by holding its handle.

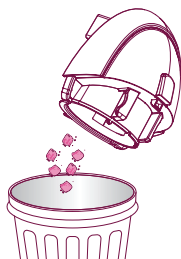

- 3 Empty the separator.

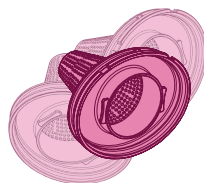

- 4 Remove the dust from the small holes cover of the separator.

How to clean and assemble the dust box and separator

Cleaning



- Cleanse the dust box, separator and its cover with running water.

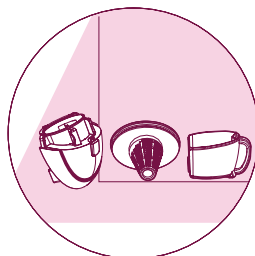

- Dry them in the well-ventilated shade for a day before using.

Assembling

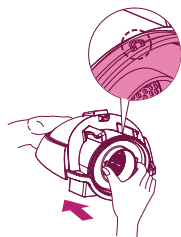

- 1 Attach the cover by inserting the spiral in the cover into the groove.

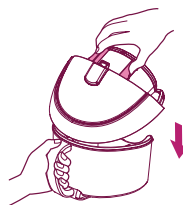

- 2 Assemble the dust separator and box.

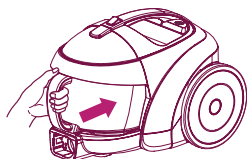

- 3 Attach the assembled dust box to the body of the cleaner.

Warning: • Do not push the button when you carry the vacuum cleaner. If push the button, it is easy to detach the dust tank from the vacuum cleaner

- If you use the cleaner without assembling the cover of the dust separator, it will increase the noise and reduce the inhaling power when cleaning. So check the assembling once again.

How to separate, clean and assemble the protection filter of the motor

Disassembling

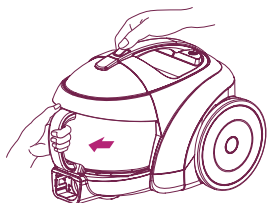

1 Detach the dust tank when press the button.

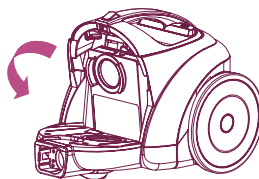

2 Detach the protection filter of the motor from the body after disassembling the dust box.



3 Separate it from the filter cover.



4 Detach the filter.

Cleansing

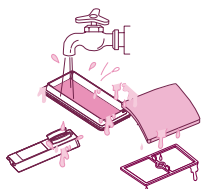

1 Clean with running water.

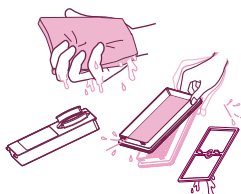

2 Remove the water completely.

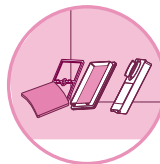

3 Dry in the well-ventilated shade for a day before using.

Warning:

- Assembling is done in reverse order of disassembling.
- If you use the cleaner without assembling the protection filter of the motor, noise increases and dust gets into the motor when cleaning, thus leading to the shorter life of the cleaner. So check the assembling once again.

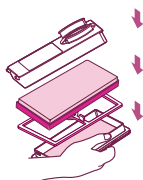

1 Put the filter into the case.

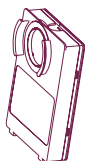

2 Cover the filter.

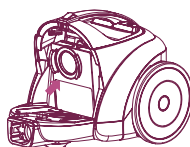

3 Fix the assembled filter.

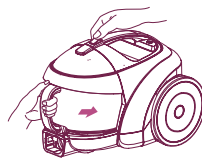

4 Assemble the dust tank.

How to separate, clean and assemble exhaust filter

Disassembling

- ▶ The exhaust filter should be cleaned at least once half a year. Allow exhaust filter to dry in a shaded location for a dry.

Cover button of the exhaust filter

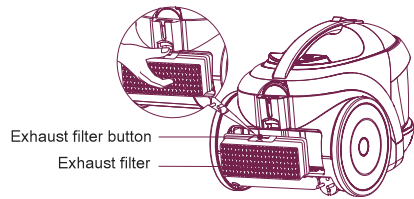
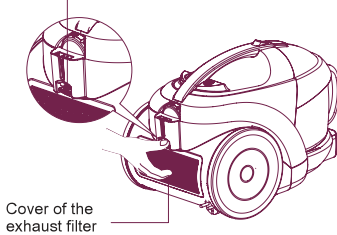

Cleansing

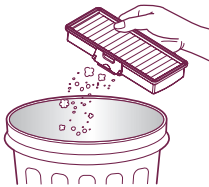

- 1 Shake off the exhaust filter.

Assembling

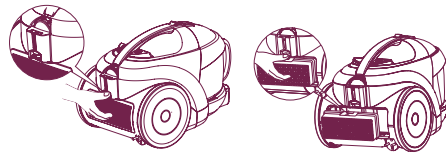

- 2 Insert the exhaust filter and join the cover properly until you hear the click of the button.



How to keep the cleaner after using

Cord winding button

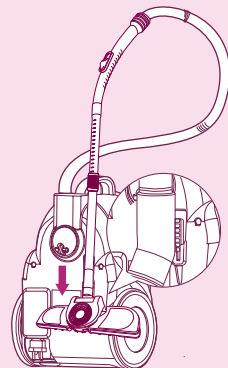
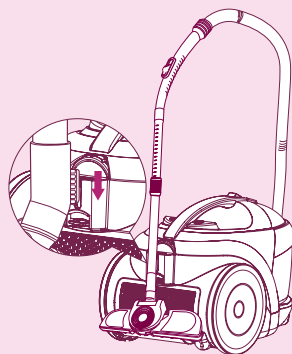
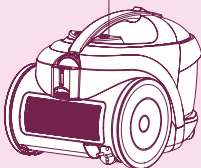

- The cord winds up when you press the button.
- Insert the spiral of the inhaler into the groove in the back or at the bottom of the body

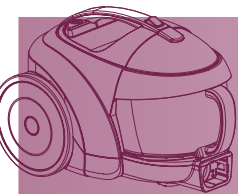

Check before reporting the trouble

- You won't be happy to waste money by calling for service when there is no trouble with the cleaner. Here is good advice to follow for trouble shooting before calling for service. Read the instructions carefully, and you can remove the trouble by yourself.

If inhaling is not well done?

Stage 1

Check if the control button of the inhaling power has been put to "MAX".

Stage 2

Clean the protection filter of the motor.

Disassembling

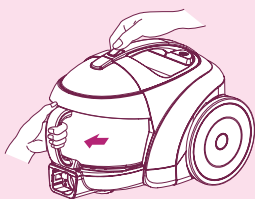

- 1 Uncover the body by pressing the button of the cover.

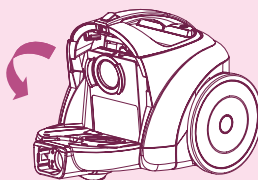

- 2 Detach the protection filter of the motor from the body after disassembling the dust box.

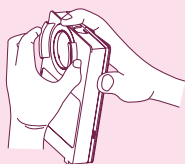

- 3 Separate the filter from the cover by holding the handle of the case.



- 4 Detach the protection filter of the motor.

Cleansing (with cold water)

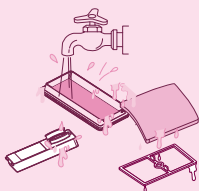

- 1 Cleanse it with running water.

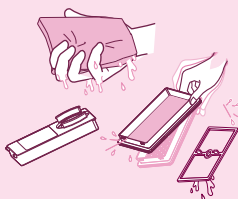

- 2 Remove the water completely.



- 3 Dry it in the well-ventilated shade for a day before using.

If you have a problem

If you have a problem

- ▶ If a minor problem occurs, it usually can be solved quite easily when the cause is found by using the check list below.

Problem:

The noise increases and the hose shrink.



Suction power is abruptly weakened.

Help:

Check the dust tank and suction inlet.



Solution

- 1 Dust tank full. (Arrive at MAX line)
Empty dust tank.



Is it full? Empty the dust tank in time!

- 2 Motor filter dirty.
Clean the motor filter with brush and water, allow to dry and replace in cleaner.



Is the filter OK? Then check the suction inlet.

- 3 When checking the suction inlet, adjust the suction level to the maximum.

First step

Turn cleaner off and disconnect from electrical outlet, then disconnect nozzle from telescopic tube. Check if it is blocked, and remove any blockages.

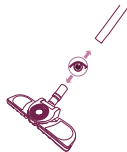

If there is still a problem, proceed the second step.

Second step

Disconnect the telescopic tube from hose. Check if it is blocked, and remove any blockages.

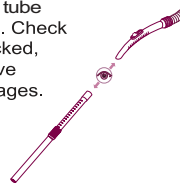

If there is still a problem, proceed the third step.

Third step

Plug cleaner in, turn on, and check hose end for suction. Remove any obstructions.



If there is also a problem, clean the filter.



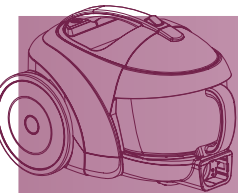

If you have a problem

Please check before notifying malfunction

- If you doubt the product meets with malfunction, please check the cause of such malfunction before contacting with the after-sales service center or agent, so as to ensure efficiency of repair.

Malfunction

The vacuum does not work?

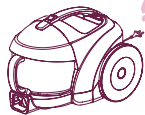

The vacuum does not work?



Peculiar smell exists inside the vacuum cleaner.



The power cord can not be scrolled thoroughly into the vacuum cleaner or the power cord can not be fully pulled.



The vacuum cleaner or the discharged air is too heat.



Inner wall of the hose is too dirt.

Check

- Is the plug inserted?
- Is the socket powered on?
- If the hose inserted?
- If the motor heat protection opened?

- When the vacuum cleaner's suction is too large or the motor is under high speed running, they do not belong to the abnormal conditions. So, please use the vacuum cleaner properly.
- If it is the noise rather than the normal motor sound, please phone the repair center.
- The duster collector is filled up.
- The filter is clogged.
- Suction inlet is jammed.
- Dual pipe is clogged.
- Hose is clogged.

- When the motor is running, the rubber band used for fixing the motor will produce a little smell due to the heat, but it will not affect the operation or damage the machine.
- When the machine sucks some water accidentally or the dust collector is not cleaned for a long period of time, the peculiar smell will be produced. So, clean up the dust collector timely.

- Pull out part of the power cord and then re-scroll it.
- Please put forth your strength to pull out the power cord, which will not be damaged.
- The power cord entwined inside the machine or it is caused by high temperature in the summer.
- The cord is bended inside the machine or not coiled around the winder. After the winder is started, the normal operation could be realized.

- Is the suction normal?

Troubleshooting

- Insert the plug tight (This product is applicable for 220V)
- Verify the power of socket is on
- Insert the hose tight
- Restart in 2 hours

- Clean out the dust collector.
- Purge the sponge filter with water and air-dry in the shady and cool place for one day.
- Take out the sucked objects before use.
- Take out the objects inside the dual pipe before use.
- Take out the objects inside the hose before use.

- The heat air discharged from the machine is arising from the heat produced by motor. So, the temperature is normal, please use the machine continuously.

- Never suck the water because after mixing of the water and dust, the tube wall will be polluted and the motor will be damaged.

Packing List

Packing List

Vacuum Cleaner	1
Owner's Manual	1
Upholstery Nozzle	1
Dust Brush	1
Crevice tool	1
Hose	1
Telescopic Tube	1
Corner Nozzle	1
Sani Punch	1
Card, Service	1

如有问题

瞬间感动 Moment Of Truth
LG 售后

请打电话



400-819-9999

售后热线

一号通

LG 电子 (天津) 电器有限公司

地址: 中国·天津市北辰区津围公路9号

传真: 022-26903476

邮编: 300402

全国技术服务中心服务咨询电话: 400-819-9999



<http://www.lg.com/cn>



MFL66099722