



ENGLISH

# LG TV Stand Installation Guide for Sound Bar (SJ8)

MODEL  
T8



Copyright © 2017 LG Electronics Inc. All rights reserved.

[www.lg.com](http://www.lg.com)

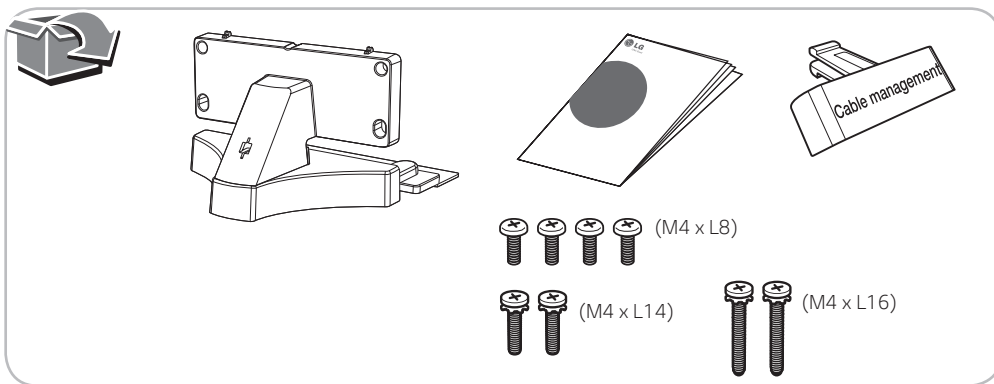

## CHECK

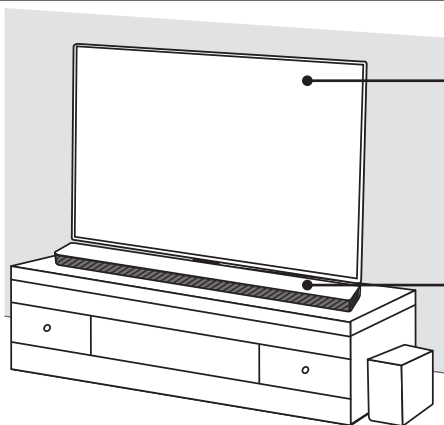

**LG TV** (Compatible TV models)

- OLED65/S5B7
- OLED65/S5C7

**LG Sound Bar**  
SJ8



Before installation, you have to detach TV's stand and retain it separately if your TV has been installed with the stand. When you are detaching the stand, please refer to the instruction manual of your TV.

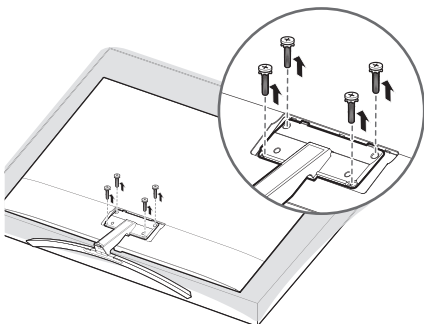

- When detaching or attaching the stand of the TV, place the screen facing down on a cushioned table or flat surface to protect the screen from scratches and damages.
- Make sure that the screws are fastened tightly. (If they are not fastened securely enough, the TV may tilt forward after being installed.)

## Installation

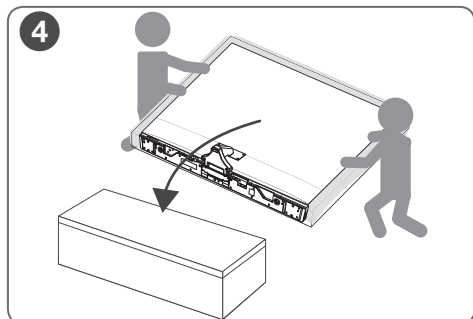
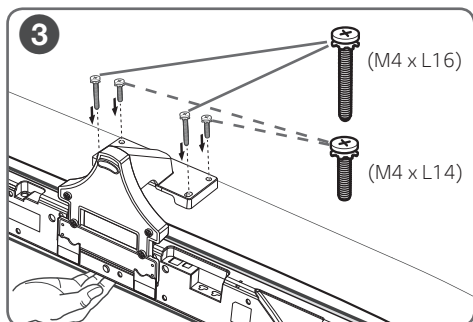
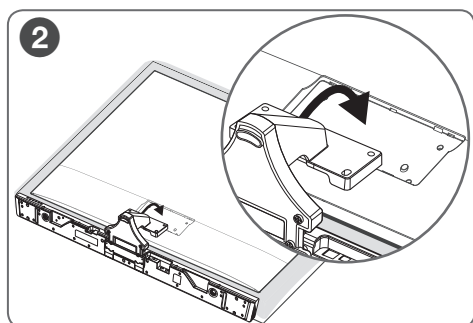
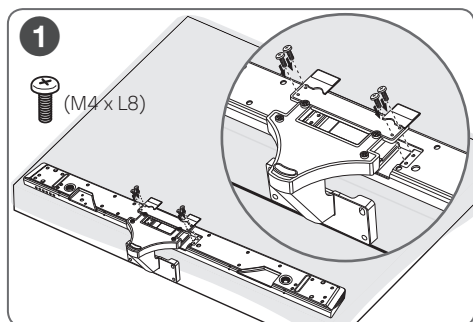

## CAUTION for moving a TV

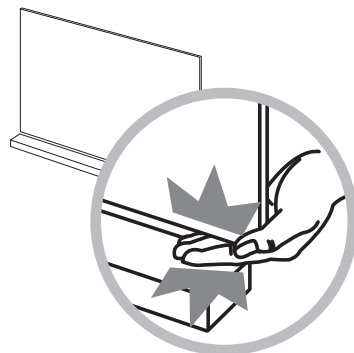

! Be careful not to get your fingers caught between the TV and the Sound Bar.

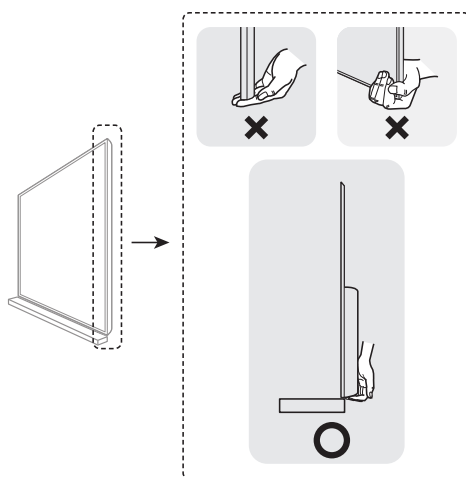

## CAUTION

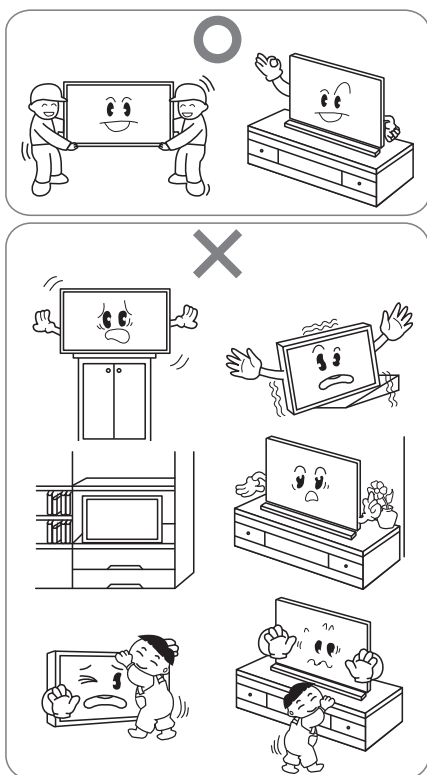

## Positioning

For safety installation, there should be enough space between the wall and the installed product.

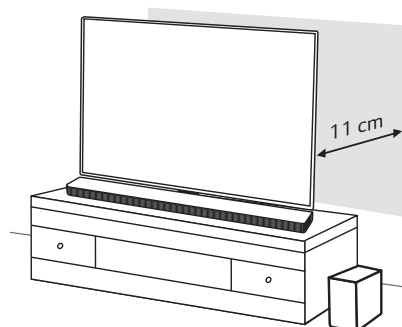

## Cable management

You can arrange the cables behind of your TV by using a supplied cable management clip.

