

## Mini Hi-Fi System

Model : CM4650P

### ENGLISH | SIMPLE MANUAL (1 of 2)

To view the instructions of advanced features, visit <http://www.lg.com> and then download Owner's Manual. Some of the content in this manual may differ from your unit.

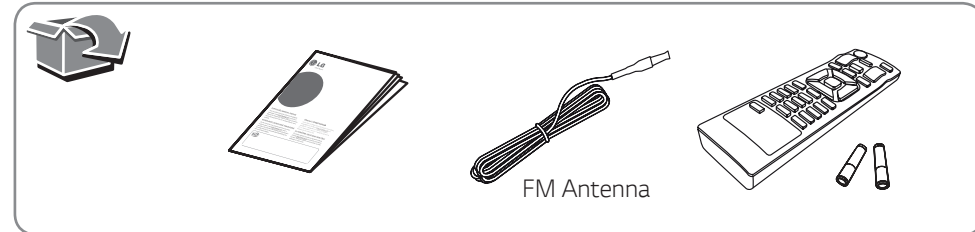

[www.lg.com](http://www.lg.com)



### Speaker connection

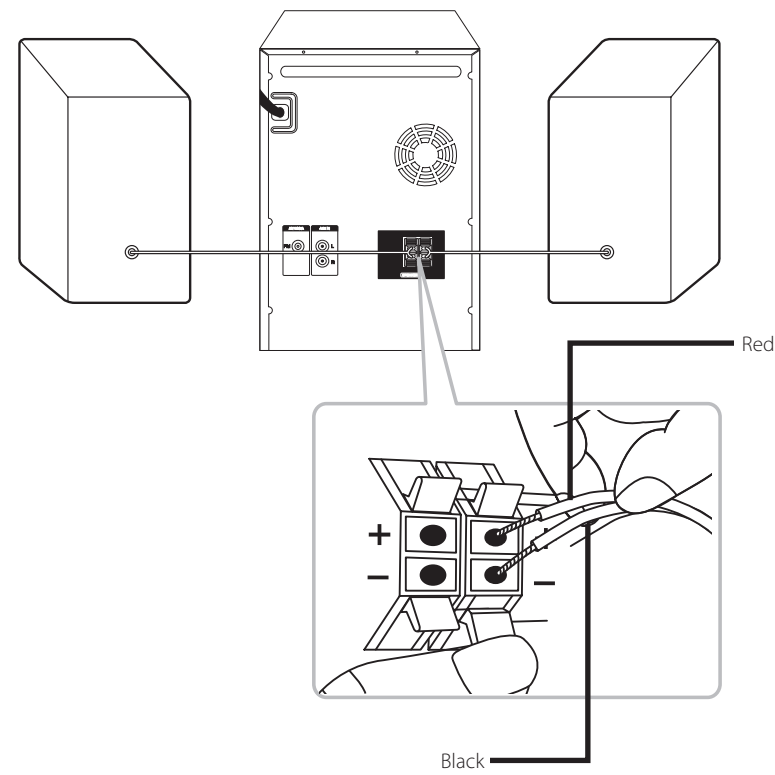

! Use the speakers far away from either TV screen or PC monitor.



### Using External Device ( or )

1

AUX Connection

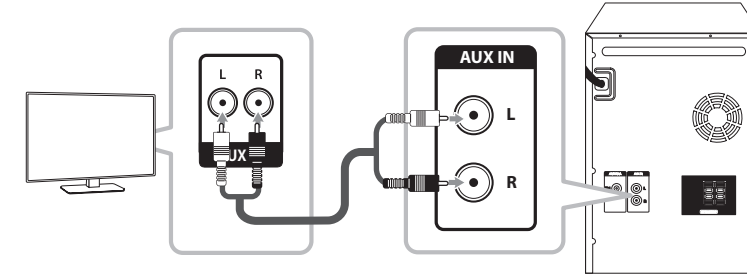

PORT. IN Connection

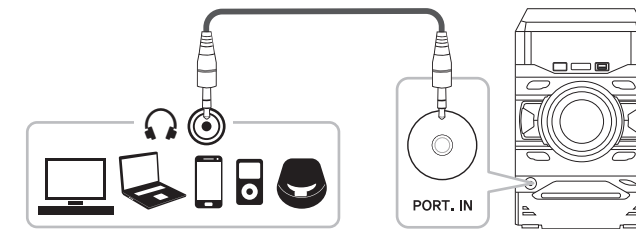

Select the AUX or PORTABLE.

2

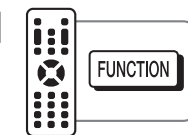

3

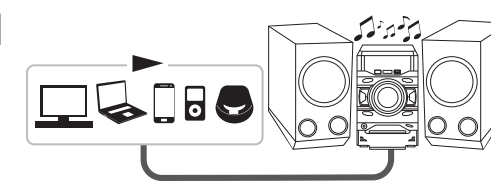

Play the music on the connected external device.



### Disc & Data Playback

1

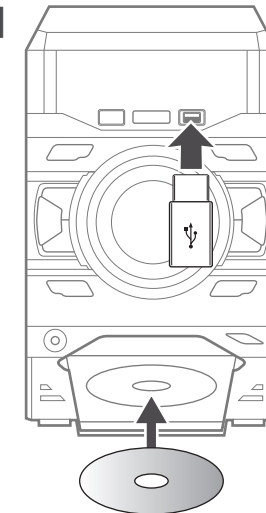

Connect the USB or insert the CD you want to play.

2

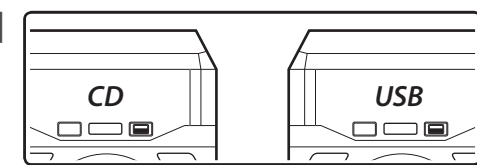

Select the CD or USB.

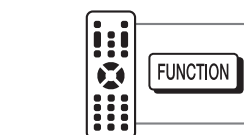

3



Select the desired song and then the song is played.

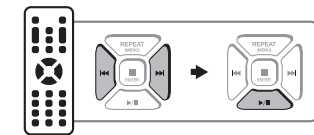

### iPod & iPhone Playback iPod & iPhone Playback

1

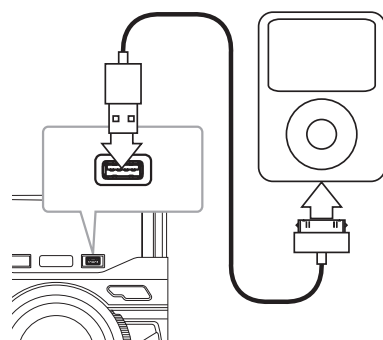

Connect iPod & iPhone to the USB port.

2

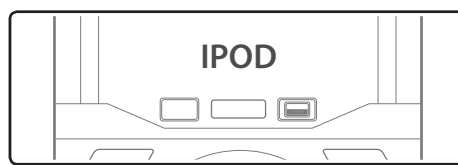

Select USB function.

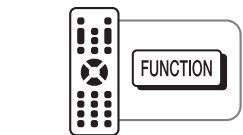

3

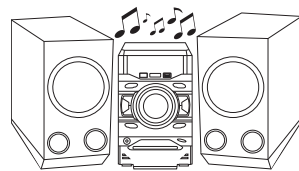

Select the desired song and then the song is played.

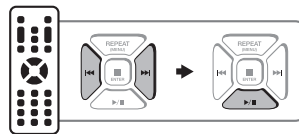

!

Depending on your iPod & iPhone's version or device, its operation may differ or not be possible to control your device with this unit.

!

Compatible iPod/iPhone : iPhone 5, iPhone 4S, iPhone 4, iPhone 3GS, iPod touch 5th, iPod touch 4th, iPod touch 3th, iPod nano 7th, iPod nano 6th, iPod nano 5th, iPod nano 4th

!

iPhone, iPod nano, and iPod touch are trademarks of Apple Inc., registered in the U.S. and other countries. Lightning is a trademark of Apple Inc.



### Radio Operation

1

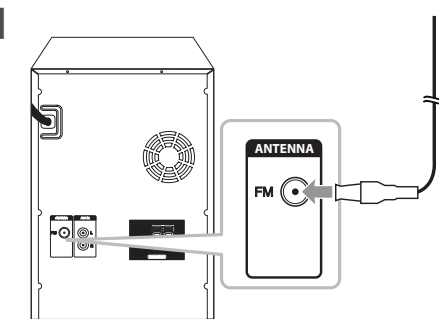

Select the Radio.

2

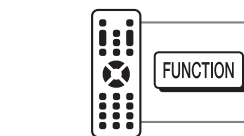
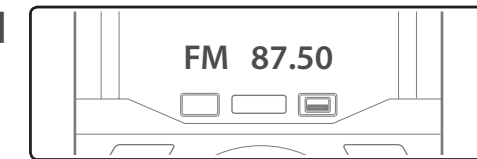

3

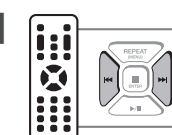

Tune the desired frequency.

! **Auto tuning** : Press and hold.

! **Manual tuning** : Press.



## Presetting Radio Station

- Select the station to preset.
- Select the preset number and store the station.
- Select the preset station to listen.

- To delete all the saved station**
- Press and hold.
  - Press **PROGRAM/MEMORY** when "ERASEALL" blinks to confirm



## LG Sound Sync

LG Sound Sync enables you to control some functions of this unit by a remote control of your LG TV. Controllable functions are volume up/down and mute. Make sure that your TV has LG Sound Sync logo as shown above.

- Select LG TV function.
- Set up the sound output of your TV : TV setting menu → [Sound] → [TV Sound output] → [LG Sound Sync (Wireless)]

↓

Sound Sync  
Wireless

- ! For specific information of operating, refer to the instruction manual of your TV.
- ! If the connection fails, check the conditions of this unit and your TV : power, function.
- ! Time turning the unit off is different depending on your TV.



## Using **BLUETOOTH**®

- Select the **Bluetooth** function.
  - Set on the **Bluetooth** and select "LG CM4650P (XX)" on your **Bluetooth** device.
- ! Enter the PIN code (0000) as needed.
  - ! When this unit is successfully connected with your **Bluetooth** device, "PAIRED" will be appear on the display window. The display will change to the **Bluetooth** device's name soon after.
  - ! If the device name isn't available on the unit, "\_\_" will be displayed.

- Play a music on your **Bluetooth** device.
- ! Even when this unit is connected to 3 **Bluetooth** devices in the **Bluetooth** mode, you can play and control music by using only one of the connected devices.
  - ! The multi pairing connection is only supported on Android or iOS devices. (Multi pairing connection may not be supported depending on the connected device specifications.)
  - ! A removable/detachable **Bluetooth** device (Ex : Dongle etc.) doesn't support multi pairing.

- ! Even when this unit is connected with multiple **Bluetooth** devices, only one device which is playing will keep the **Bluetooth** connection, even if you change the function of the other devices.



## Using "Music Flow Bluetooth" App

To use this unit more comfortably, install "Music Flow Bluetooth" on your **Bluetooth** devices. Select a way of installation (a, b).

- Searching for "Music Flow Bluetooth" on the Google Play Store.
  - Scanning QR code.
- ! Android O/S : Ver 4.0.3 (or later)
  - ! Refer to the guide from the "Music Flow Bluetooth" app on your smart device.



## Auto Power On

- 
- This unit automatically turns on by an input source : LG TV or **Bluetooth**. If you have already paired with this unit, automatically this unit can turn on by an input source even when unit is off.



## Auto Function Change

This unit recognizes input signals such as **Bluetooth** and LG TV and then changes suitable function automatically.

# Mini Hi-Fi System

Model : CM4650P

## ENGLISH | SIMPLE MANUAL (2 of 2)

To view the instructions of advanced features, visit <http://www.lg.com> and then download Owner's Manual. Some of the content in this manual may differ from your unit.



MF168860775



## Additional Feature

**SOUND EFFECT**

STANDARD  
TRE/BASS  
BOOST  
FLAT  
FOOTBALL  
BASS  
ROCK  
NATURAL  
POP  
CLASSIC  
JAZZ

**INFO**

FILE-XXX\_0001

**1** **CLOCK** Press and hold.

**2** AM 12:00 ↔ 0:00

**3** XX:00

**4** 00:XX

**MUTE**

**SLEEP** 180 150 120 ... 10 OFF

**1** **ALARM** Press and hold.

**2** XX:00

**3** 00:XX

**4** **TUNER** CD USB

**5** VOL XX

**1** **ALARM** Press and hold.

**2** XX:00

**3** 00:XX

**4** **TUNER** CD USB

**5** VOL XX

**!** Alarm function works only after clock is set.



## Deleting file

**!** This function is supported only in stop status. (USB only)

**1** Select the file you want to delete.

**2** Select the folder you want to delete.

**3** Select the DEL FILE, DEL DIR or FORMAT.

**!** Press to exit the current mode.



## USB Recording

**1** Connect a USB storage and select the source (CD, AUX, PORTABLE, TUNER) to record.

**2** Press to start recording. During recording, "REC" displayed.

**!**

Status	Recording (Only CD function)
Playback	One track/file
Programmed playback	Programmed the track(s)/file(s)
Full stop	All track(s)/file(s)

## To select bitrate and recording speed

**1** Press and hold for 3 seconds.

**2** Select the bitrate and confirm.

**3** Select the recording speed and confirm. (Only CD function)

**!** Press to stop the recording.

Press to pause the recording. (Only TUNER, AUX, PORTABLE)

**!** It'll be stored as follows. \* The other source : AUX and the like.

AUDIO CD	MP3/WMA	The other source*	TUNER
CD_REC TRK_0001 TRK_0002 ...	FILE_REC ABC (File name) DEF (File name) ...	OTHERS_REC AUDIO_0001 AUDIO_0002 ...	TUNER_REC AUDIO_0001_100.0FM AUDIO_0002_101.0FM ...

**!** A file is recorded by about 512 Mbyte when you record for a long term.

**!** When you stop recording during playback, the file that has recorded at that time will be stored. (Except MP3/WMA file)



## Folder Searching

**1** Press to move superior or subordinate folder from the root folder.

**!** Empty folders are not searched.

**2** Select the folder to play. The first file of the folder is played.





## Programmed Playback

You can make a playlist of your favourite tracks/files from a disc or USB device using Programmed Playback.

**!** This function is supported only on stop status.

### To make Programmed Playback list

- Press to enter the edit mode.
- Select a track/file and confirm.
- Press again to exit from the edit mode.

**!** A playlist of up to 20 tracks/files can be entered for CD/USB.

**!** Repeat steps **2** to store other files.

### To enjoy Programmed Playback

- Press again after you make the list.
  - Press to play the list.
- Press twice to exit from Programmed Playback mode.

### To delete Programmed Playback List

- Press in stop status.
- Press repeatedly to select a track/file.
- Press to delete selected song.



## AUTO DJ

Auto DJ blends the end of one song into the beginning of another for seamless playback.

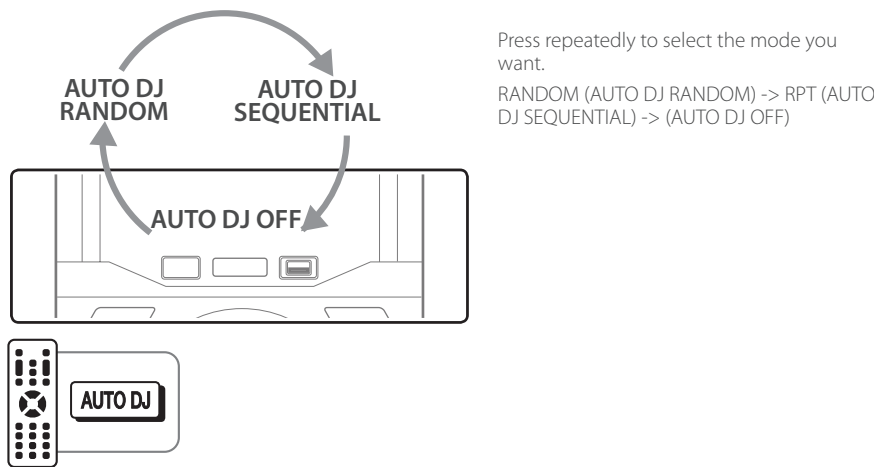

**!** Only AUTO DJ SEQUENTIAL is selected when played Programmed list.



## Additional Information

<b>Music File Requirement</b>	
Sampling frequency	<ul style="list-style-type: none"><li>MP3 : 32 ~ 48 kHz</li><li>WMA : 32 ~ 48 kHz</li></ul>
Bit rate	<ul style="list-style-type: none"><li>MP3 : 32 ~ 320 kbps</li><li>WMA : 40 ~ 192 kbps</li></ul>
Maximum files	Data CD : 999 / USB : 2000
Maximum folders	Data CD : 99 / USB : 200
File extensions	<ul style="list-style-type: none"><li>"mp3"</li><li>"wma"</li></ul>
CD-ROM file format	ISO9660+JOLIET
USB Flash Drive	Devices that support USB2.0 or USB1.1.
<b>Bluetooth</b> Codec	SBC

- !** The USB function of this unit does not support all USB devices.
- !** Using NTFS file system is not supported. (Only FAT(16/ 32) file system is supported.)
- !** External HDD, Card readers, Locked devices, or hard type USB devices are not supported.
- !** The DTS is not supported. In case of DTS audio format, audio is not output.
- !** **How to disconnect the wireless network connection or the wireless device**  
Turn off the unit by pressing the power button for more than 5 seconds.



## Safety Information

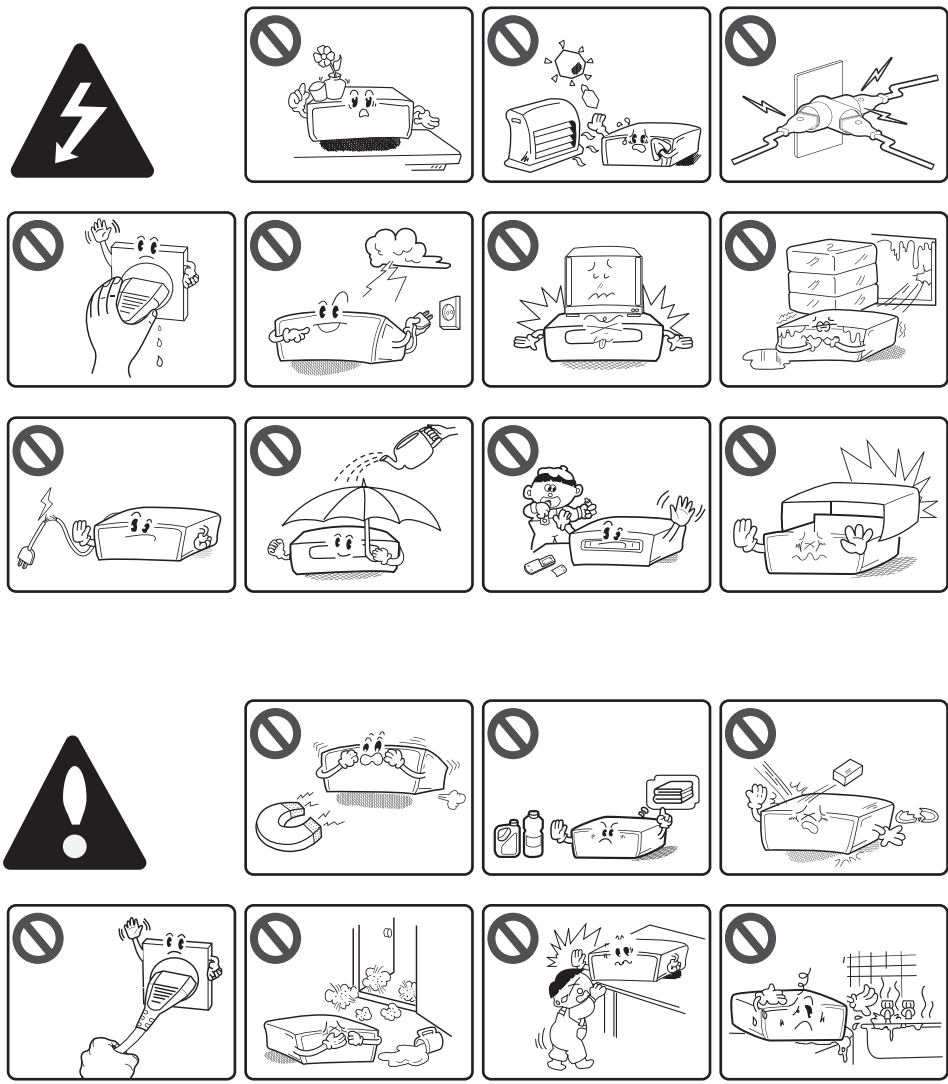

## Specification

<b>ENGLISH</b>	
Power Requirements	Refer to the main label on the unit.
Power Consumption	Refer to the main label on the unit.
Bus Power Supply (USB)	5 V --- 1 A
Total Output	600 W

Design and specifications are subject to change without notice.

## Safety Information

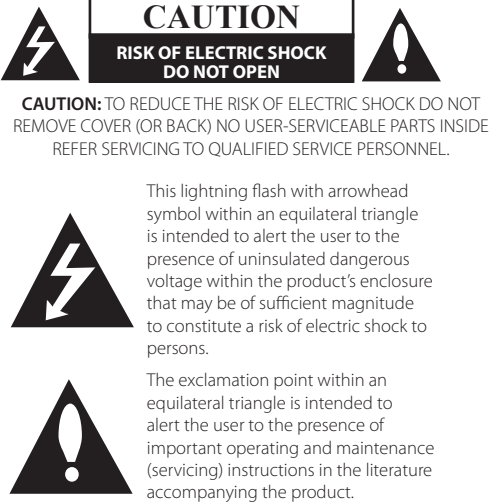

**WARNING:** TO PREVENT FIRE OR ELECTRIC SHOCK HAZARD, DO NOT EXPOSE THIS PRODUCT TO RAIN OR MOISTURE.

**WARNING:** Do not install this equipment in a confined space such as a book case or similar unit.

**CAUTION:** The apparatus shall not be exposed to water (dripping or splashing) and no objects filled with liquids, such as vases, shall be placed on the apparatus.

**CAUTION:** Do not use high voltage products around this product. (ex. Electrical swatter) This product may malfunction due to electrical shock.

**CAUTION:** Do not block any ventilation openings. Install in accordance with the manufacturer's instructions. Slots and openings in the cabinet are provided for ventilation and to ensure reliable operation of the product and to protect it from over heating. The openings shall be never be blocked by placing the product on a bed, sofa, rug or other similar surface. This product shall not be placed in a built-in installation such as a bookcase or rack unless proper ventilation is provided or the manufacturer's instruction has been adhered to.



**CAUTION:** This product employs a Laser System. To ensure proper use of this product, please read this owner's manual carefully and retain it for future reference. Shall the unit require maintenance, contact an authorized service center. Use of controls, adjustments or the performance of procedures other than those specified herein may result in hazardous radiation exposure. To prevent direct exposure to laser beam, do not try to open the enclosure.

**CAUTION concerning the Power cord**  
Most appliances recommend they be placed upon a dedicated circuit;  
That is, a single outlet circuit which powers only that appliance and has no additional outlets or branch circuits. Check the specification page of this owner's manual to be certain. Do not overload wall outlets. Overloaded wall outlets, loose or damaged wall outlets, extension cords, frayed power cords, or damaged or cracked wire insulation are dangerous. Any of these conditions could result in electric shock or fire. Periodically examine the cord of your appliance, and if its appearance indicates damage or deterioration, unplug it, discontinue use of the appliance, and have the cord replaced with an exact replacement part by an authorized service center. Protect the power cord from physical or mechanical abuse, such as being twisted, kinked, pinched, closed in a door, or walked upon. Pay particular attention to plugs, wall outlets, and the point where the cord exits the appliance.  
The Power Plug is the disconnecting device. In case of an emergency, the Power Plug must remain readily accessible.  
This device is equipped with a portable battery or accumulator.  
**Safety way to remove the battery or the battery from the equipment:** Remove the old battery or battery pack, follow the steps in reverse order than the assembly. To prevent contamination of the environment and bring on possible threat to human and animal health, the old battery or the battery put it in the appropriate container at designated collection points. Do not dispose of batteries or battery together with other waste. It is recommended that you use local, free reimbursement systems batteries and accumulators. The battery shall not be exposed to excessive heat such as sunshine, fire or the like.  
**RF Radiation Exposure Statement**  
This equipment should be installed and operated with minimum distance 20 cm between the radiator and your body.

- The appliance is not intended for use by young children or infirm persons without supervision.
- Young Children should be supervised to ensure that they do not play with appliance.
- If the appliance is supplied from a cord extension et or an electrical portable outlet device, the cord extension set on electrical portable outlet device must be positioned so that it is not subject to splashing (of water or any form of liquid) or ingress of moisture.