



LG

Life's Good

用户手册

LG

Hi-Fi Plus

LG Hi-Fi精灵

与所有国家/地区的

G5 兼容（韩国 除外）

REV 2.0 CN



LG

Life's Good

用户手册

LG Hi-Fi Plus

LG Hi-Fi精灵
与所有国家/地区的
G5 兼容（韩国 除外）

简体中文

保留所有权利。

LG Electronics Inc., 2016

注意：使用 LG Hi-Fi Plus
之前，请先仔细阅读所有信息，
以获得最佳性能并防止损坏产品。

产品概述

LG Hi-Fi Plus 是一款 32 位 Hi-Fi 数模转换器 (DAC) 模块，它可连接到 G5 的底部。

- 通过将音频设备（例如耳机和扬声器）连接到此 32 位 DAC，您可以享受丰富的 Hi-Fi 音效。
- 可以播放 32 位高质量音频内容，让您尽享动听原声。
- LG Hi-Fi Plus 可以提升并向上采样质量低于 32 位的现有音频内容，让原声变得更加动听。

重要安全信息

- 使用产品前请阅读使用说明。
- 保留备用。
- 务必使用正版产品。请勿将本产品用于任何非预期目的。
- 使用或连接非正版产品可能缩短产品寿命或引起爆炸。这样做还可能损坏产品并导致保修失效。
- 如果插入不符合服务提供商要求的模块，例如从其他服务提供商处或服务提供商未覆盖的区域购买的模块，您的设备可能无法正常工作。
- 请勿拆解产品或使其受到撞击。这样做可能会导致电击、短路或火灾。
- 对产品施加重压可能会使其受损。
- 如果弯折或挤压本产品且未及时维修，可能会导致部分功能受损，或者外观变形或损坏。
- 为防止损坏，请注意勿使产品跌落到坚硬表面或受到强烈撞击。

- 使产品远离水、酒精、苯等。
- 请勿在极限温度中使用或存放产品。请勿将产品长时间曝露在阳光直射下。
这样做可能导致损坏或引起爆炸。
- 请勿使用酒精、苯、稀释剂或清洁剂清洁本产品。
这样做可能引发火灾。
- 请使用软布擦拭本产品。
- 请勿使本产品靠近金属物体，如项链、钥匙、硬币、钉子或钟表。如发生短路，也会有爆炸危险。
- 请将产品置于儿童和宠物接触不到的地方。请勿将产品放入口中或使其受到强烈撞击。这可能导致电击、爆炸或窒息等危险。
- 请勿将导电材料（金属件、铅笔芯等）接入或插入连接器。
- 请勿在使用过程中用毛毯覆盖或包裹本产品。

- 长时间使用后，本产品会发热。在本产品发热后，请勿触摸，以免造成低温灼伤。
- 请勿将本产品当作生活垃圾处理。这样做可能引发火灾或破坏环境。

产品组件



后盖



便携袋



用户手册

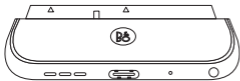

LG Hi-Fi精灵



USB数据线

- 在包装时，LG Hi-Fi Plus 的后盖与 Hi-Fi Plus 的主机相连。
- 如果缺少任何组件，请与您购买本产品的零售商联系。
- 某些部件可能因具体环境而更改，恕不提前通知。
- 为提高性能，本产品的外观和规格可能会有更改，恕不提前通知。

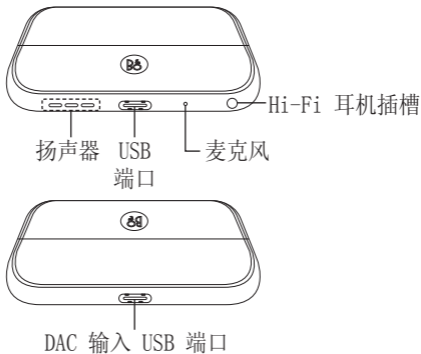

视产品规格而定，某些功能可能无法使用。

连接

插入电池

1 对齐电池和模块上的箭头，将电池端子牢固连接到模块。



2 将电池与下边缘对齐，小心地将模块滑回设备内。

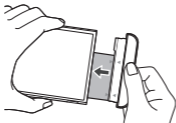

- 将模块插入设备中时，切勿按模块弹出键。
- 将电池插入设备中时，确保电池已连接到模块。

取出电池

1 按模块弹出键以将模块从设备中弹出一部分。

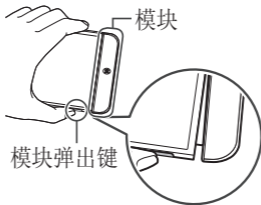

2 握住已弹出模块的中部，并将它拉出。

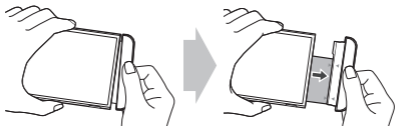

- 3 用双手握住电池和模块，并沿外弧方向（如下图所示）使两者分离以断开电池端子。



- 在使用过程中，请勿断开模块。
- 在使用过程中，如果模块变松或已断开，请立即将其连接到主机。
- 在连接或取出模块时，请注意不要伤到双手或手指。
- 请注意不要让产品或模块的边缘伤到您。
- 确保正确插入电池和模块。否则，产品可能会损坏或无法打开。
- 不遵守本用户手册的说明操作可能会损坏产品。

说明

- 即使不同的国家/地区或运营商支持您的 G5 和 LG Hi-Fi Plus，此产品也可能无法正常工作。
- 将耳机连接到 LG Hi-Fi Plus 时，USB 数据通信将不可用（可使用 Hi-Fi 功能和充电，但不可进行高速充电）。
- 将耳机连接到 LG Hi-Fi Plus 时，不能在“设置 > 常规 > 辅助工具 > 听觉”中调节音频。
- LG Hi-Fi Plus 连接至 G5 后，在不使用时，从 LG Hi-Fi Plus 上拔下耳机有助于降低功耗。
- 支持 384 kbps Hi-Fi 音频。使用此功能时，功耗将会略有增加。
- 播放 DSD 文件（.dff、.dsf）时，将阻止除铃声和闹钟以外的所有其他声音。当收到任何通知时，您的设备将会振动。

- 如果在通话期间已连接蓝牙™耳机，则该蓝牙™设备将用于音频输出。如果没有连接任何蓝牙™设备，则与手机相连的任何耳机将用于音频输出。如果您的耳机仅与 Hi-Fi Plus 相连，则此耳机将用于音频输出。
- 要播放 FM 收音机或 DMB（如果它是可用的 DMB 型号），请将耳机连接到 G5 上方的耳机插孔，以将其用作天线。
- 当您的 LG Hi-Fi Plus 和耳机同时与 G5 设备连接时，在录音或录像过程中，G5 将通过 LG Hi-Fi Plus 上的麦克风录制任何语音和外部音频。
- 当您使用 3 极耳机时，此时通话功能将不受支持。

- 通过使用 OTG 数据线，您可以在除 G5 以外的其他手机上使用 Hi-Fi 功能。

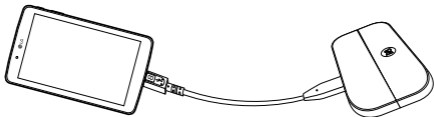

如果将 OTG 设备连接到已与 G5 相连的 LG Hi-Fi Plus, OTG 设备将无法识别 (不支持 OTG)。

- 如果将 LG Hi-Fi Plus 连接到在北美或加拿大销售的 G5, 手机将无法开机。

PC 驱动程序下载

- 从 LG Electronics 网站（韩国：www.lgmobile.co.kr，全球：www.lg.com）下载并安装“Hi-Fi Plus PC Driver.exe”后，您可以将 LG Hi-Fi Plus 连接到 PC。

固件升级

- 从 LG Electronics 网站（韩国：www.lgmobile.co.kr，全球：www.lg.com）下载并安装“Hi-Fi Plus Manager.exe”以升级您的固件。
- 也可以通过使用 LG Friends Manager 应用程序来进行固件升级。

规格和功能

USB 类型	USB 2.0 (Type-C)
电压	5 V \pm 10%
电流消耗	220 mA (有麦克风插孔), 3 mA (无麦克风插孔)
耳机插孔	4 极/3 极 3.5 pi
音频	扬声器和数字麦克风
声压	1 m 声压大于 60 dB \uparrow (100%) *基于满电
天线	GSM/CDMA、WCDMA、LTE
工作温度	-20 $^{\circ}$ C ~ 40 $^{\circ}$ C
尺寸/重量	73.9 x 43.9 x 7.4mm / 23.6g

产品中有害物质的名称及含量

部件名称	有害物质					
	铅 (Pb)	汞 (Hg)	镉 (Cd)	六价铬 (Cr(VI))	多溴联苯 (PBB)	多溴二苯醚 (PBDE)
印刷电路板组件	×	○	○	○	○	○
塑料	○	○	○	○	○	○
金属	×	○	○	○	○	○
附件	○	○	○	○	○	○

本表格依据SJ/T 11364 的规定编制。

○：

表示该有害物质在该部件所有均质材料中的含量均在GB/T 26572 规定的限量要求以下。

×:

表示该有害物质至少在该部件的某一均质材料中的含量超出GB/T 26572 规定的限量要求。

标记为X的部品以现在的技术尚不能减少有害物质。LG电子正在尽最大的努力开发有害物质减少技术。



本产品的环保使用期限标识如图所示。

该标识的环保使用期限以本说明书中所述的正常使用条件为基准。

有限保修

根据此有限保修的条件，LG Electronics 保证本产品自消费者最初购买产品的时间起并在随后的一（1）年时期内在设计、材料和制造工艺上无缺陷。如果您的产品需要保修服务，请将它退回到购买时的经销商，或者联系您本地的 LG Electronics 联系中心以获得其它信息。



LG

Life's Good

User Guide

LG

Hi-Fi Plus

with B&O PLAY

AFD-1200

ENGLISH

All rights reserved. LG Electronics Inc., 2016

Note: Please read all information carefully prior to using the LG Hi-Fi Plus in order to enjoy the best performance and prevent damage to the product.

Product Overview

The LG Hi-Fi Plus is a 32-bit hi-fi digital to analog converter (DAC) module that can be attached to the bottom of your LG G5.

- You can enjoy a rich hi-fi sound by connecting your audio devices, such as headsets and speakers, to this 32-bit DAC.
- 32-bit high-quality audio content can be played as it was originally intended to sound.
- The LG Hi-Fi Plus can upbit and upsample your existing audio content with less than 32-bit quality so that it plays closer to the originally intended sound.

Important Safety Information

- Always use genuine products. Do not use this product for any unintended purpose.
- Using or connecting products that are not genuine may shorten the product's longevity or cause an explosion. Doing so may also damage the product and thereby voids the service warranty.
- If you insert a module that is not compatible with your service provider, for example, a module bought from another service provider or in an area that is not covered by your service provider, your device does not operate normally.
- Do not disassemble the product or allow anything to impact it. Doing so may cause an electrical shock, short circuit, or fire.
- Applying heavy pressure to the product may damage it.
- Some functions of this product may be damaged, or its appearance may be altered or impaired if it is bent or crushed and not repaired right away.
- In order to prevent damage, be careful not to drop the product on a hard surface or subject it to severe shock.
- Keep the product away from water, alcohol, benzene, etc.
- Do not use or store the product in extreme temperatures. Do not leave the product in direct sunlight for long periods of time. Doing so may cause damage or an explosion.
- Do not use alcohol, benzene, thinners, or detergents to clean the product. Doing so may cause a fire.
- Use a soft cloth to wipe the product.
- Do not place the product near metal objects, such as necklaces, keys, coins, nails, or clocks. In the case of a short-circuit, there is also the risk of an explosion.
- Keep the product out of the reach of small children and pets. Do not put the product in your mouth or subject it to severe shock. There is a risk of electric shock, an explosion, or suffocation.

- Do not connect or insert conductive materials (metal pieces, pencil leads, etc.) into the connectors.
- Do not cover or wrap the product with a blanket while using the product.
- The product may become hot after long periods of use. Avoid touching the product when it becomes hot as it may cause a low-temperature burn.
- Do not dispose of the product as household waste. Doing so may cause a fire or damage the environment.

Product Components



Cap



Pouch



User Guide



LG Hi-Fi Plus



OTG Cable
(USB Type-C to Type-B)

- The cap of LG Hi-Fi Plus is attached to the main unit of the Hi-Fi Plus when packaged.
- If there are any missing components, contact the retailer where you purchased the product.
- Some items are subject to change without prior notice depending on the circumstances.
- The appearance and specifications of the product are subject to change without prior notice to improve performance.

Product Description

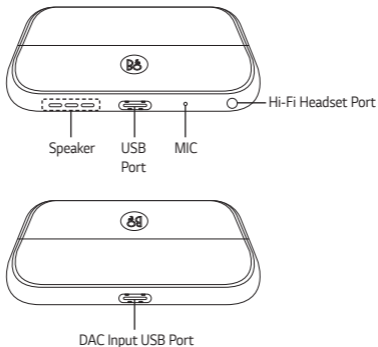

Some functions may not be available depending on the product specifications.

Connections

Inserting the Battery

1 Align the arrows on both the battery and the module and firmly connect the battery terminals to the module.



2 Align the battery with the lower edge and carefully slide the module back into the device.

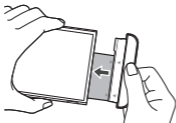

- Never press the Module Eject Key when inserting the module into the device.
- When inserting the battery into the device, make sure the battery is attached to the module.

Removing the Battery

1 Press the Module Eject Key to partly eject the module from the device.

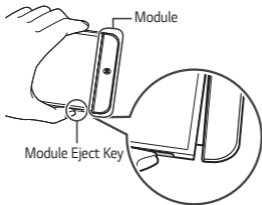

2 Grab the middle of the ejected module and pull it out.



3 Hold the battery and module with both hands and separate them from one another in an outward arc (as indicated below) to disconnect the battery terminals.



- Do not detach the module while it is in use.
- Immediately attach the module to the main unit if it becomes loose or is detached during use.
- Be careful to not hurt your hands or fingers when attaching or detaching the module.
- Be careful to not be injured by the edges of the product or the module.
- Make sure the battery and the module are properly inserted. Otherwise, the product may be damaged or fail to turn on.
- Failing to follow the instructions in this user guide may damage the product.

Instructions

- This product will not operate normally if your G5 and LG Hi-Fi Plus are supported by different countries or operators.
- When earphones are connected to the LG Hi-Fi Plus, USB data communication is not available. (Hi-Fi features and charging are available, but high-speed charging is not available.)
- When earphones are connected to the LG Hi-Fi Plus, the audio cannot be adjusted in Settings > General > Accessibility > Hearing.
- When the LG Hi-Fi Plus is attached to your LG G5, unplugging your earphones from the LG Hi-Fi Plus while it is not in use will help reduce power consumption.
- 384 kbps hi-fi audio is supported. Power consumption will slightly increase when this feature is in use.
- All sounds except for the ringtone and alarm will be blocked while playing DSD files (.dff, .dsf). Your device will vibrate if you receive any notifications.
- If a *Bluetooth*® headset is connected during a call, the *Bluetooth*® device will be used for the audio output. If there is not a *Bluetooth*® device connected, then any earphones connected to your phone will be used for the audio output. If your earphones are connected to only the Hi-Fi Plus, then those earphones will be used for the audio output.
- To play FM radio or DMB (if it is a DMB-capable model), connect earphones to the earphone jack on the upper part of the LG G5 to serve as an antenna.
- When your LG Hi-Fi Plus is attached to your G5 while your earphones are connected, any voice and external audio will be recorded via the microphone on your LG Hi-Fi Plus when recording voice or videos.
- The call feature is not supported while you are using 3-pole earphones.

- You can use the hi-fi feature on phones other than the LG G5 using OTG cables, etc.

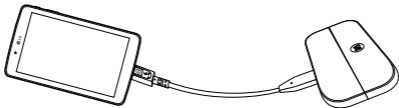

If you connect OTG devices to an LG Hi-Fi Plus that is attached to an LG G5, the OTG devices will not be recognized (OTG is not supported).

- If the LG Hi-Fi Plus is attached to an LG G5 that is sold in North America or Canada, the phone will not turn on.

PC Driver Downloads

- The LG Hi-Fi Plus can be connected to a PC once you download and install "Hi-Fi Plus PC Driver.exe" from the LG Electronics website (Korea: www.lgmobile.co.kr, Global: www.lg.com).

About Firmware Upgrades

- Firmware upgrades are available by downloading and installing "Hi-Fi Plus Manager.exe" from the LG Electronics website (Korea: www.lgmobile.co.kr, Global: www.lg.com).
- Firmware upgrades are also available using the LG Friends Manager app.

Specifications and Features

USB Type	USB 2.0 (Type-C)
Voltage	5V \pm 10%
Current Consumption	220 mA (with earphone jack), 3 mA (without earphone jack)
Earphone Jack	4 Pole/3 Pole 3.5 pi
Audio	Speaker and Digital MIC
Sound Pressure	1 m Sound Pressure 60 dB \uparrow (100%) *Based on full charge
Antenna	GSM/CDMA, WCDMA, LTE™
Operating Temperature	-20 °C ~ 40 °C
Dimensions/Weight	73.9 mm x 43.9 mm x 7.4 mm / 23.6 g

Limited Warranty

SUBJECT TO THE CONDITIONS OF THIS LIMITED WARRANTY, LG ELECTRONICS WARRANTS THIS PRODUCT TO BE FREE FROM DEFECTS IN DESIGN, MATERIAL AND WORKMANSHIP AT THE TIME OF ITS ORIGINAL PURCHASE BY A CONSUMER, AND FOR A SUBSEQUENT PERIOD OF ONE (1) YEAR. SHOULD YOUR PRODUCT NEED WARRANTY SERVICE, PLEASE RETURN IT TO THE DEALER FROM WHOM IT WAS PURCHASED OR CONTACT YOUR LOCAL LG ELECTRONICS CONTACT CENTER TO GET FURTHER INFORMATION.



www.lg.com

Any modifications or changes to this manual due to typographical errors or inaccuracies of stated information shall only be made by LG Electronics Inc.