

Additional Information

Specifications

Power Requirements	Refer to the main label on the unit.
Power Consumption	Refer to the main label on the unit. Networked standby : 0.5 W (If all network ports are activated.)
Dimensions (W x H x D)	Approx. 818 mm X 318 mm X 388 mm
Net Weight	Approx. 17.2 kg
Bus Power Supply (USB)	5 V  1 A
Amplifier (Total RMS output power)	600 W

Design and specifications are subject to change without notice.

Note

- Do Not look directly at the light emitting path when lighting function is operational.
- If the brightness from the illuminating light source causes excessive glare and eye discomfort during operation then turn On room lights or turn Off the LIGHTING of the unit.

How to disconnect the wireless network connection or the wireless device

Turn off the unit by pressing the power button for more than 5 seconds.

Replacement of battery

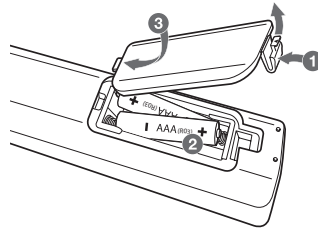

SIMPLE MANUAL

HIGH POWER SPEAKER SYSTEM

To view the instructions of advanced features, visit <http://www.lg.com> and then download Owner's Manual. Some of the content in this manual may differ from your unit.

MODEL
FH6



www.lg.com

ENGLISH

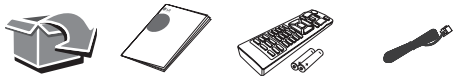

Top panel

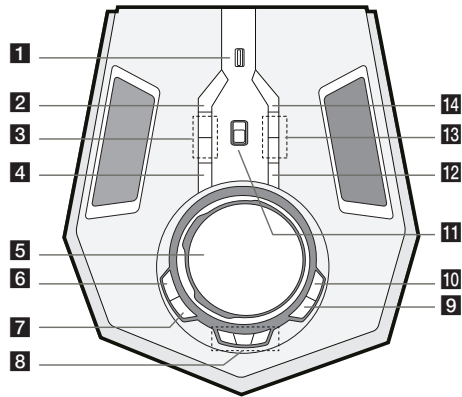

- 1 USB**
You can play or record sound by connecting the USB device.
- 2 USB REC / DEMO**
- Records to USB.
- Shows Demo mode.
- 3 MIC (Microphone) VOL +/-**
- 4 VOICE CANCELLER**
VOICE CANCELLER can reduce the Vocals of Singer in certain source/content allowing you to enjoy the music.
Press to switch this Mode On or Off.
- 5 SCRATCH / SEARCH & LEVEL CONTROL**
- Turns clockwise or counterclockwise to make Scratch sound.
- Searches a folder or a file.
- Adjust DJ EFFECT level.
- 6 DJ EFFECT**
Selects DJ EFFECT mode.

- 7 LIGHTING**
- Turns ON/OFF the lighting effects.
- Press and hold to turn on/off the Flash Lighting.
- 8 CLUB, DRUM, USER (DJ PRO)**
Press and hold to select CLUB, DRUM or USER sound effect for mix.
(If you want to use USER, you have to register a source with "Music Flow Bluetooth" app.)
1, 2, 3 (DJ PRO PAD)
Press a desired sound pad.
- 9 OK**
Selects a folder when searching a file.
- 10 SEARCH**
Moves to folder or file in selection mode.
- 11 BLUETOOTH**
Changes input source to the Bluetooth.
(Even in power off mode, if you press BLUETOOTH, then power is on and automatically changed to Bluetooth function.)
- 12 USER EQ / BASS BLAST**
- Selects the sound effect created by your own.
- Press and hold to select BASS effect directly.
- 13 KEY CHANGER (# / b)**
Changes the key to suit your vocal range.
- 14 WIRELESS LINK**
Selects Wireless Party Link mode.

Front panel / Rear panel

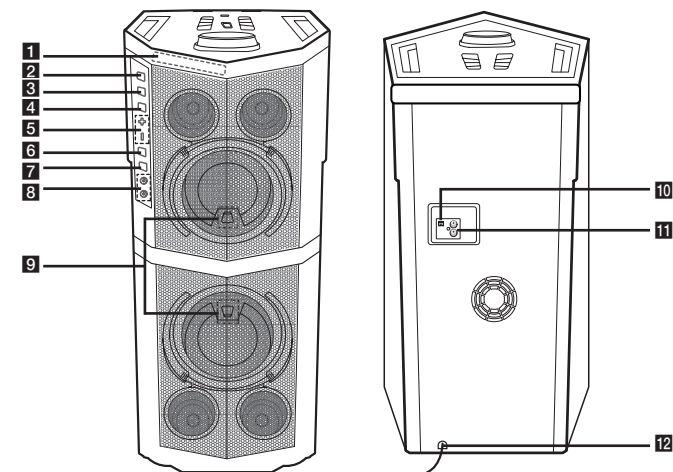

- 1 Display window**
- 2 (Skip/Search)**
- Skips forward.
- Searches for a section within a file.
- Selects the radio stations.
- 3 (Play/Pause)**
- Starts or pauses playback.
- Selects Stereo/Mono (Horizon mode Only)
- 4 (Skip/Search)**
- Skips backward.
- Searches for a section within a file.
- Selects the radio stations.
- 5 +/- (Volume)**
Adjusts speaker volume.
- 6 F (Function)**
Selects the function and input source.
- 7 (Standby/On)**
- 8 MIC (Microphone) 1 / 2 jack**
- 9 Remote control receiver**
- 10 FM ANTENNA**
- 11 AUX IN (L/R)**
- 12 Power cord**

How to place the unit

Vertical

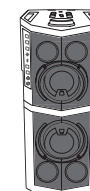

Horizon

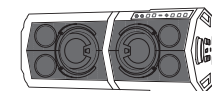

Controller App



Download the **Music Flow Bluetooth** App to your device.

LG Sound Sync (Wireless)



For more information, download the online owner's manual. <http://www.lg.com>