



OWNER'S MANUAL

LG Pra.L Galvanic Ion Booster



Please read this manual carefully before operating your set and retain it for future reference.

MODEL
BBL1

Copyright © 2019 LG Electronics Inc. All Rights Reserved.



MFL71182292

1912_Rev02

www.lg.com

Table of Contents

1 Skin Safety Information .3

Recommendations for safe use
of the product..... 3

2 Setting up.....10

Unique features.....10

Notification.....12

Parts13

Unit description14

3 Operation16

Cleansing Mode16

Absorption promotion Mode
(BOOST).....21

Charging the battery.....24

Charging.....24

Checking the charging status .26

Checking battery status.27

How to use the unit.....28

Changing Care mode.....28

Voice Assistance Setting ...30

Language Setting30

4 Troubleshooting.....31

Troubleshooting.....31

5 Appendix.....32

Specifications32

Maintenance33

Handling the Unit33

6 Precautions for use .34

Safety Information34

Recommendations for safe use of the product

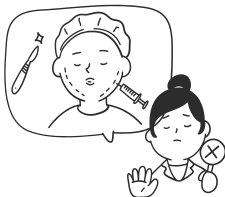

- Do not use this device if you are currently undergoing or underwent in the last 2 months, skin related procedures, cosmetic surgery or procedures for hair loss. Please only use it after consultation with a specialist.

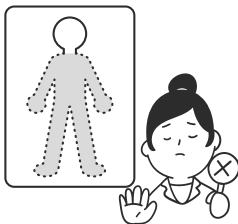

- Device to be used as a facial treatments only, it is not recommended for use on body.
- Do not use the device on mucous membranes including oral cavity. Do not place this device directly on your ear.



- When using this unit on the neck, avoid the part of the neck where the thyroid is located.

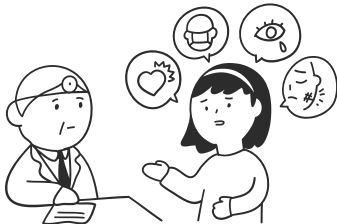

- The technology used in Pra.L is suitable for general usage and has minimal side effects. Its safety has been verified by 3rd party external agencies.
- However, individuals who are undergoing treatment for serious diseases like cancer and thyroid complications should consult a doctor before use.
- Our skin is subject to temporary changes caused by external factors such as temperature or seasons. Internal factors such as consumption of alcohol or stress can also cause negative effects to the skin. We recommend using the device only when the skin condition is at its normal state or after consulting a doctor.
- If you are currently being treated or were treated for a thyroid-related disease, we recommend that you use the product only after consulting a specialist.
- Depending on individual skin condition, the device may cause a variety of skin irritations.
If such irritation occurs, please stop use.



- Device use not recommended for pregnant, menstruating or lactating women. (Unstable hormonal balance may cause temporary skin issues.)

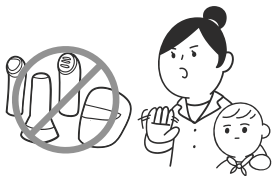

- Do not allow people to use who can not clearly express their own will, including infants.



- Do not use this unit immediately after shaving.



- Do not use this unit while driving or walking.



- Do not use a head of the device (skin contact area) with it stopped in one place continuously, but please use it according to the guide of this manual.



- Please follow recommended hours of use when long time use because there is a possibility of a low-temperature burn.



- Before use, please remove the precious metal parts that this unit touches.



- Do not use the device for purposes other than those set out in this guide.



Q&A

Q1

" What cosmetics should I buy and use for each mode in the product? "

To make your skin cleaner, it is effective to use cleansing mode (CLEANSING) before using absorption promotion mode (BOOST). Please use water-soluble products such as moisturizing gel that fits your skin.

Absorption promotion mode (BOOST) is a process that helps the active ingredients in cosmetics penetrate the skin. It is recommended to use the cosmetics that were used in the past or cosmetics for your skin type. Please pay attention to using cosmetics that contain the following ingredients as it may reduce the effect: denatured alcohol, sunscreen, retinol, oil

Q2

" How can I know if this unit is fit for my skin? "

Before using it on your face, it is recommended to test the cosmetics you are wearing with the unit on inside your arm.

Q3 "What should I do if I feel dry?"

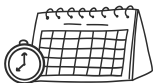

- Please reduce the frequency of use in a week.



- It is recommended to use moisturizing cream or mask pack for moisturizing immediately after use.



- If you are taking medication, consult your health care professional before using this medicine to induce skin dryness.

Unique features

Complex absorption promotion by two modes

Two modes of cleansing and absorption promotion are managing deep into the skin, opening the skin barrier to clean the skin and pushing the cosmetic ingredients to promote absorption.

- **Cleansing Mode (CLEANSING)**

- It is a mode that helps deep cleansing and it opens the skin barrier with heat and cleans the skin with positive (+) ion.
- It is effective to use this mode before using absorption promotion mode.

- **Absorption promotion Mode (BOOST)**

- Warm massage: It relieves skin tension and gently applies cosmetics to help naturally absorb.
- Ultrasonic wave: Ultrasonic vibration makes transient cracks in the stratum corneum and it helps penetrating of the active ingredients of cosmetics.
- Galvanic ion: It is negative (-) ion mode that helps the skin absorb the cosmetics by pushing the active ingredient of cosmetics with negative ion into the skin.

Skin contact safety material and Head protection cap

- The head (skin contact area) is used with medical material which is safe for skin.
- The Head protection cap protects the head part, enabling clean storage management.

Triangle head design

You can easily manage curved areas such as the eyes / nose area.

Voice guidance

As voice guidance, guide how to care easily during use.

Notification

Symbols used in this manual



Note

Indicates special notes and operating features.



Caution

Indicates cautions for preventing possible damages from abuse.

Parts



Unit

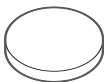

Head
protection cap



Charging cradle

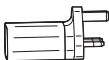

Charging adapter



USB cable
(C Type)

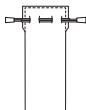

Pouch



Owner's manual /
Quick start guide

Unit description

Unit

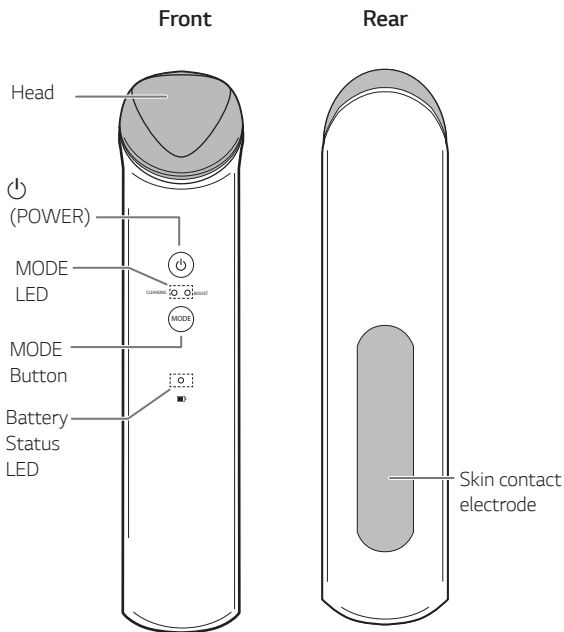

Bottom

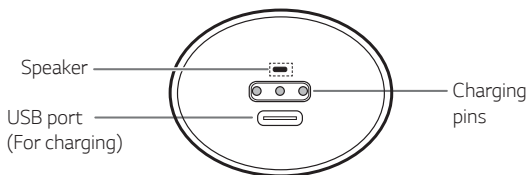

Charging cradle

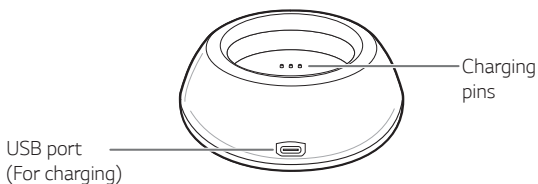

Cleansing Mode

To make your skin cleaner, it is effective to use this mode before using absorption promotion mode.

Recommended usage period

Recommend product use is once a day by mode. Using more than twice a day may cause a burning sensation on skin.

Using product

Recommend using water-soluble products such as moisturizing gel for your skin.

How to use

1. Start the cleansing mode after remove makeup and wash the face.
2. After wash the face, please use this appliance with plenty of water gel on the area of your face or device head to be used.

3. Gently wrap the skin contact electrode on the back of this unit so that it touches the palm of your hand. (If you do not touch the skin contact electrode, the device will not work.)

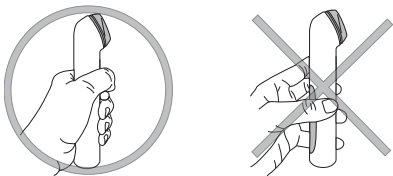

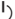
4. Press the  (Power) button to turn on the power, then check the cleansing mode. Press the MODE button to change to the cleansing mode in case of the absorption promotion mode.

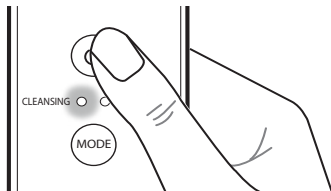

18 Operation

5. Follow the voice guidance function, slowly cleanse your face like gently wiping away from around your eyes.

- Cleansing consists of 5 steps for 3 minutes.

(Left cheek → Right cheek → Nose → Chin → Forehead → Power off)

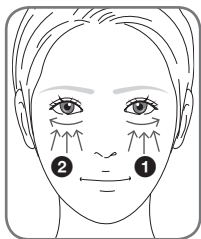

When you hear the voice guidance or a sound effect, use the device to gently cleanse your both cheeks area from bottom to top and your under both eyes from inside to outside for about 30 seconds.

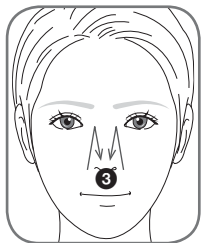

When you hear the voice guidance or a sound effect, slowly move the device head from your cheek to your nose.

Gently cleanse the nose area from bottom to top for about 45 seconds.

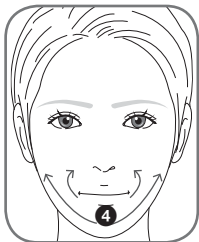

When you hear the voice guidance or a sound effect, slowly move the device head from your nose to your chin.

Gently cleanse the chin area from bottom to top for about 30 seconds.

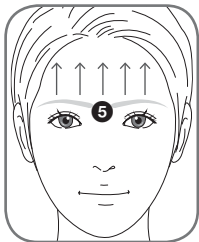

When you hear the voice guidance or a sound effect, gently move the device head around the forehead from bottom to top for about 45 seconds.

This unit automatically turns off after cleansing.

6. Rinse your face sufficiently with tepid water after cleansing.
7. After use, wipe the unit with a dry towel, and put the head protection cap on the head and store the unit.



Note

- It is effective to use this mode before using absorption promotion mode.
- The water gel is sold separately. We recommend using a moisturizing gel for your skin type.
- If you set the voice guidance function to mute, the unit doesn't provide voice guidance and sound effect.

Absorption promotion Mode (BOOST)

The complex function of the mode helps the penetration of active substances contained in cosmetics.

Recommended usage period

Recommend product use is once a day by mode. Using more than twice a day may cause a burning sensation on skin.

Using product

Recommend using previously used cosmetics or cosmetics for your skin type.

How to use

1. Wash your face before starting absorption promotion mode.
2. Before using this product, apply cosmetics (such as vitamin C serum) to pat on the cleansed face to permeate.

22 Operation

3. Gently wrap the skin contact electrode on the back of this unit so that it touches the palm of your hand. (If you do not touch the skin contact electrode, the device will not work.)

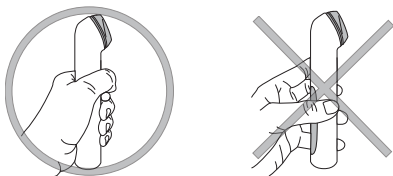

4. Press the  (Power) button to turn on the power, then press the MODE button to select absorption promotion mode.

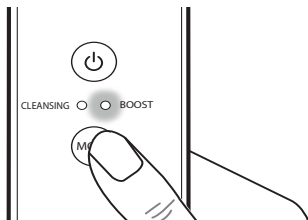

5. Slowly care the area of your desired like gently wiping from top to bottom depending on the skin texture.

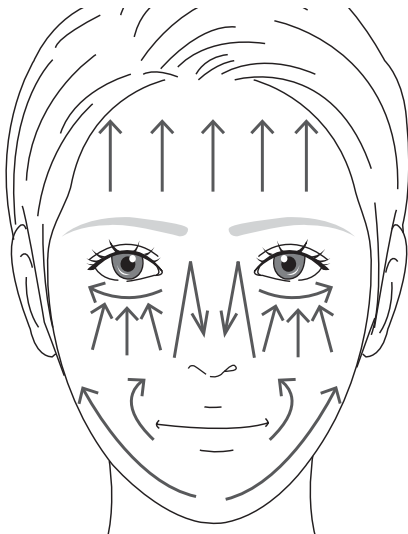

6. This unit automatically turns off after 3 minutes of care time.
7. After use, wipe the unit with a dry towel, and put the head protection cap on the head and store the unit.

Charging the battery

Charging

Charge the battery enough before using the unit.



Caution

- Always use the provided charging adapter.
- Using other charging adapters may cause malfunction and can not be repaired.

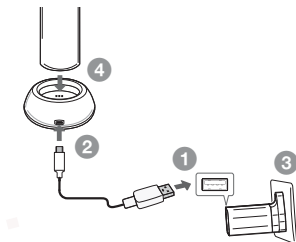

1. Connect the charging adapter using USB cable.
2. Connect USB cable to the charging cradle.
3. Connect the charging adapter to the power outlet.
4. Charging is started, when you connect the unit into the charging pins of charging cradle. Refer to Checking the charging status and Checking battery status regarding the charging status of battery. (Page 26-27)

**Note**

- This unit cannot be used during charging.
- You can charge the unit to USB port (for charging) on the bottom of unit.
- After the battery is fully charged, unplug the power to save energy.
- The unit can be charged with a secondary battery with a current output of 1 A and more at 5 V voltage.
- Keep the charging cradle and the charging pins of unit free of moisture. Moisture can cause the charging pins to corrode.

Checking the charging status



When you place the unit on the charging cradle, you can check the charge status of the battery through the battery status LED.

LED	Status
Red	Battery is charging.
Green	Battery is fully charged.

Checking battery status

When you disconnect the unit from the charging cradle, you can check the charge status of the battery through the battery status LED.

If the power turned on, you can check the charging status by pressing  button.

The battery status LED will change depending on the battery charging status.

LED	Status
Red (blinking)	The battery is low and needs to be charged. "Battery is low." An voice guidance or sound effect is provided and the red LED blinks. Then the power is automatically turned off.
Red	Battery is low. The red LED is turned on and maintained.
Green	Battery is charged. The green light turns on for three seconds and then disappears.



Note

If you set the voice guidance function to mute, the unit doesn't provide voice guidance and sound effect.

How to use the unit

Changing Care mode

CLEANSING ○ ○ BOOST



Pressing the MODE button while this unit is turned on changes the care mode. Each MODE LED lights according to the care mode.

Mode	Status and effect
CLEANSING (Cleansing)	To make your skin cleaner, it is effective to use this mode before using absorption promotion mode.
BOOST (Absorption promotion)	The complex function of the mode helps the penetration of active substances contained in cosmetics.

**Note**

- The unit operates only when it is in contact with skin. When using this unit to care for others, the caregiver should hold this device with one hand in contact with the skin-contact electrode, and at the same time, the other hand must be in contact with the care recipient's skin, such as the face, hands, or the like. This will cause the unit to operate normally.
- If the unit is aparted from the skin, it will be paused and the MODE LED indicator in the current mode will blink.
- Care time will continue even if the unit is not in contact with the skin.
- This unit automatically turns off after 3 minutes of care time.
- Vibration periodically sounds for purposes of notification during operating.

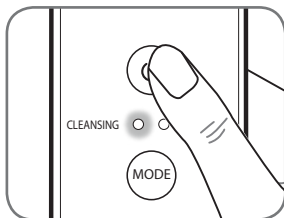

Voice Assistance Setting

With power on, press and hold the  (Power) button for about 5 seconds to cycle through each mode:

(Voice assistance → Sound effect guide → Turn off guide (Mute))

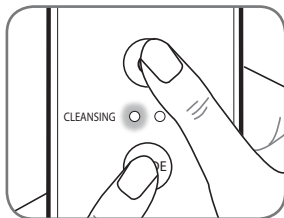

Language Setting

With power on, press and hold both  (Power) button and the MODE button simultaneously for 3 seconds to cycle through each language:

(Hong Kong Chinese → English → Chinese)

Troubleshooting

Symptoms	Cause & Solution
The unit does not operate normally.	<ul style="list-style-type: none"> • Make sure that you have pressed the on/off button properly. • Charge the unit according to the instructions in this user manual. • Check if the battery status LED on the unit lights up to make sure the unit is charging. • It will not work while charging. Please stop charging before use.
No Power.	<ul style="list-style-type: none"> • The battery is discharged. Recharge the battery. • Connect the unit to the power supply with the charging adapter. • Check the charger to which you connect the unit is live. • Check whether the voltage indicated on the unit corresponds to the local mains voltage.
Temperature of unit rises during use.	<ul style="list-style-type: none"> • This unit has a thermal function to increase the effect. • But, if you feel the unit is much hotter than your body temperature, then stop the skin care and contact LG Electronics customer care center.

Specifications

Power supply (AC Adapter) :

- Model : ADS-12BA-06Y 05010EPB C
- Manufacturer : Shenzhen Honor Electronic Co., Ltd.
- Input : 100 - 240 V ~ 50 / 60 Hz
- Output : 5 V  2 A

Dimensions (W x H x D) :

- Approx. 40 mm x 163.2 mm x 42 mm (Unit)
- Approx. 71.8 mm x 25.4 mm x 71.8 mm (Charging cradle)

Operating temperature : 5 °C to 35 °C

Operating humidity : 0 % to 90 %

Recommended usage times : once per day

- ※ It is available for about 1.5 hours when using the Absorption promotion mode after charge once.
- ※ Usage time may vary depending on the battery, ambient temperature and usage conditions.

Full charging time : Within 3 hours

- ※ Charging time may vary depending on the remaining capacity of the battery, ambient temperature, or charging conditions.
- Design and specifications are subject to change without notice.

Maintenance

Handling the Unit

When shipping the unit

Please save the original shipping carton and packing materials. If you need to ship the unit, for maximum protection, re-pack the unit as it was originally packed at the factory.

Keeping the exterior surfaces clean

- Do not use volatile liquids such as insecticide spray near the unit.
- Wiping with strong pressure may damage the surface.
- Do not leave rubber or plastic products in contact with the unit for a long period of time.

Cleaning the unit

Use a soft, dry cloth for cleaning the unit. For a more thorough clean, use a soft cloth with water or a wet tissue.

Do not use strong solvents such as alcohol, benzine, or thinner, as these might damage the surface of the unit.

Safety Information



CAUTION

RISK OF ELECTRIC SHOCK
DO NOT OPEN



CAUTION: TO REDUCE THE RISK OF ELECTRIC SHOCK DO NOT REMOVE COVER (OR BACK) NO USER-SERVICEABLE PARTS INSIDE REFER SERVICING TO QUALIFIED SERVICE PERSONNEL



This lightning flash with arrowhead symbol within an equilateral triangle is intended to alert the user to the presence of uninsulated dangerous voltage within the product's enclosure that may be of sufficient magnitude to constitute a risk of electric shock to persons.



The exclamation point within an equilateral triangle is intended to alert the user to the presence of important operating and maintenance (servicing) instructions in the literature accompanying the product.

WARNING: TO PREVENT FIRE OR ELECTRIC SHOCK HAZARD, DO NOT EXPOSE THIS PRODUCT TO RAIN OR MOISTURE.

WARNING: Do not install this equipment in a confined space such as a book case or similar unit.

CAUTION: Do not use high voltage products around this product. (ex. Electrical swatter) This product may malfunction due to electrical shock.

CAUTION: No naked flame sources, such as lighted candles, should be placed on the apparatus.

CAUTION: The apparatus should not be exposed to water (dripping or splashing) and no objects filled with liquids, such as vases, should be placed on the apparatus.

CAUTION: Do not block any ventilation openings. Install in accordance with the manufacturer's instructions.

Slots and openings in the cabinet are provided for ventilation and to ensure reliable operation of the product and to protect it from over heating. The openings should never be blocked by placing the product on a bed, sofa, rug or other similar surface. This product shall not be placed in a built-in installation such as a bookcase or rack unless proper ventilation is provided or the manufacturer's instruction has been adhered to.

NOTICE: For safety marking information including product identification and supply ratings, please refer to the main label on the bottom or the other surface of the product.

1. The appliance is not to be used by persons (including children aged from 8 years) with reduced physical, sensory or mental capabilities, or lack of experience and knowledge, unless they have been given supervision or instruction concerning use of the appliance by a person responsible for their safety.
2. Children being supervised not to play with the appliance.
3. Cleaning and user maintenance shall not be made by children without supervision.
4. This appliance is only to be used with the battery charger provided.
5. For a part of class III construction supplied from a detachable power supply unit, the instructions state that the appliance is only to be used with the unit provided.
6. Instructions for class III appliances state that it must only be supplied at SELV.

CAUTION concerning the Power Cord

The Power Plug is the disconnecting device. In case of an emergency, the Power Plug must remain readily accessible.

Check the specification page of this owner's manual to be certain of the current requirements.

Do not overload wall outlets. Overloaded wall outlets, loose or damaged wall outlets, extension cords, frayed power cords, or damaged or cracked wire insulation are dangerous. Any of these conditions could result in electric shock or fire. Periodically examine the cord of your device, and if its appearance indicates damage or deterioration, unplug it, discontinue use of the device, and have the cord replaced with an exact replacement part by an authorized service center. Protect the power cord from physical or mechanical abuse, such as being twisted, kinked, pinched, closed in a door, or walked upon. Pay particular attention to plugs, wall outlets, and the point where the cord exits the device.

CAUTION: Only use the AC adapter supplied with this device. Do not use a power supply from another device or another manufacturer. Using any other power cable or power supply may cause damage to the device and void your warranty.

CAUTION when using this product in environments of low humidity

- It may cause static electricity in environments of low humidity.
- It is recommended to use this product after touching any metal object which conducts electricity.

For models using a battery

This device is equipped with a portable battery or accumulator.

How to Safely remove the batteries or the battery pack from the equipment: To Remove the old batteries or battery pack, follow the assembly steps in reverse order. To prevent contamination of the environment and bring on possible threat to human and/or animal health, the old batteries or the battery pack must be put in an appropriate container at designated collection points. Do not dispose of batteries or battery pack together with other waste. It is recommended that you use local, free reimbursement systems batteries or battery packs, (may not be available in your area). The batteries or the battery pack should not be exposed to excessive heat such as sunshine, fire or the like.

Symbols

~	Refers to alternating current (AC).
— — —	Refers to direct current (DC).
⊞	Refers to class II equipment.
⏻	Refers to stand-by.
I	Refers to "ON" (power).
⚡	Refers to dangerous voltage.

Product storage and maintenance

- Do not drop the charging adapter into a drain or sink or place it in a place where it may fall into water or other liquids. Do not use a charging cradle in the shower or immerse in water.
- Do not touch the charging cable that is in the water and disconnect the charging adapter immediately.
- Keep the cord away from heated surfaces.
- Always use the provided charging adapter.
- If not used for a long time, charge the battery at least once every 3 months to maintain battery life.
- Do not prick the unit gap with sharp metal objects such as keys, hairpins, necklaces, or nails.
- Please keep it in the packing box. If it is necessary to carry the product, please repack it in the packing box at the time of purchase.
- Do not place volatile liquids, such as pesticides, near them.
- Wiping the unit surface hard can damage the unit.
- Do not place plastic products or rubber on the unit for a long time.
- Use a soft, dry cloth for cleaning the unit. For a more thorough clean, use a soft cloth with water or a wet tissue. Do not use strong chemicals such as alcohol, benzene or thinner as they may deteriorate the surface of the unit.
- Do not put the unit in dishwasher, oven, washing machine.
- Do not expose the unit to direct sunlight, excessive heat or boiling water.
- Do not allow cleansing liquids to come into contact with the product's surface as this may cause damage to the product or fire.

IMPORTANT SAFETY NOTICE

The cord grip for the plug fitted to this product is built into the existing power cord as supplied. If, for any reason you need to shorten the cord.

DO NOT RE-USE THE PLUG.

A new plug must be used to ensure your continued safety by securing the plug to the power cord in accordance with Plug & Socket Regulations 1994.

Beauty Product Warranty Policy

(1) LG Electronics Hong Kong Limited (hereafter “LGEHK”) provides Warranty Period (hereafter “Period”) from the date of purchased are as follows and only valid for Beauty Product purchase in Hong Kong / Macau only (any promotion gift item is not included):

- i. Product : 12 months
- ii. Embedded Battery : 6 months

(2) Warranty is valid only for authorized product; parallel import and counterfeit product are invalid.

(3) Product is under warranty against manufacturing defects in faulty workmanship or internal electronic parts materials. This warranty does not cover defects arising from any wear and tear of the product (Including casing, button, and accessories, etc.)

(4) Customer is expected to deliver and collect their products to and from the LGEHK Service Centre. This warranty is applied in Beauty Product only.

(5) If check-up or repairing are required, customer must present both the original invoice and warranty card. Upon any failure to present the above documentation, customer must pay for the costs of the services provided.

(6) All parts replaced within the warranty period are the property of LGEHK. We have rights to handle those parts as necessary. All changed parts are non-returnable.

(7) Warranty will be voided under the following conditions, and LGEHK reserves the right to refuse providing service and/or shall demand charges for any costs of servicing from customer:

- i. Product has been modified or repaired outside of LGEHK Service Centre.
- ii. Product has been mishandled, negligence such as leaving batteries unattended and thereby causing battery fluid leakage, applying the wrong voltage, forces of nature or accident.
- iii. Installation maintenance of the product without following proper instruction from manufacturer.
- iv. The model number of the item code attached has been erased or modified,
- v. The content of warranty policy has been modified without authorization.

(8) LGEHK reserves the right to terminate or modify the terms of this warranty card without notice. For exceptional cases, subject to report of our investigation, we reserve the right to terminate this warranty card or modify terms of warranty policy.

(9) Our company will not be liable for any loss and damage directly or indirectly caused by the breakdown of the product.

(10) This warranty card is restricted within Hong Kong SAR / Macau SAR only.

(11) LGEHK and its Authorized Service Centers reserve the right to use refurbished or reconditioned parts or whole products for the same or functionally equivalent model when conducting product repairs and replacement.

(12) The warranty does not apply to any non-LGEHK products, parts and accessories.

(13) LGEHK reserves the right to interpret any terms and conditions set forth above in its sole and final discretion.

(14) In case of disputes, LGEHK have absolute and final decision, and which be fully agreed upon and followed by customers.

