



# OWNER'S MANUAL WASHING MACHINE



Please read this manual carefully before operating your washing machine and retain it for future reference.

WD12590D6  
WD12595D6



MFL48165948

[www.lg.com](http://www.lg.com)

# C contents

<b>Contents</b> .....	2
-----------------------	---

<b>Product feature</b> .....	3
------------------------------	---

## **Warnings**

Important safety instructions .....	4
Save these instructions .....	4

<b>Specification</b> .....	5
----------------------------	---

## **Installation**

Transit bolts .....	6
Removing transit bolts .....	6
Installation place requirement .....	7
Positioning .....	7
Electrical connection .....	8
Connecting water supply hose .....	9
Installation of drain hose .....	11
Level adjustment .....	12

## **Care before washing**

Before the first washing .....	13
Caring before washing .....	13

## **Adding detergent**

Adding detergent and fabric softener ..	14
---	----

<b>Function</b> .....	16
-----------------------	----

## **How to use washer**

Control Panel .....	17
- Power .....	18
- Program .....	18
- Start/Pause .....	19
- Wash .....	19
- Child lock .....	20
- Rinse .....	20
- Spin .....	21
- Water Temperature .....	21
- Medic Rinse .....	22
- Tub Clean .....	22
- Add Load .....	22
- Crease Care .....	23
- Beep On / Off .....	23
- Favorite .....	23
- Delay Wash .....	23
- Door Lock .....	23
- Display .....	24

Thank you for buying a LG Fully Automatic Washing Machine.

Please read your owner's manual carefully, it provides instruction on safe installation, use and maintenance. Retain it for future reference.

Record the model and serial number of your washing machine.

---

Model No.

---

Serial No.

---

Date of Purchase

---

## **Maintenance**

The water inlet filter .....	25
The drain pump filter .....	26
Dispenser drawer .....	27
The drawer recess .....	27
The washing drum .....	27
The water circulation nozzle .....	28
Cleaning your washer .....	28
Winterizing instructions .....	28

## **Trouble shooting guide** .....

Using Smart Diagnosis™ .....	32
------------------------------	----

# Product Feature



## ■ Direct Drive System

The advanced Brushless DC motor directly drives the drum without belt and pulley.



## ■ Water Circulation

Sprays detergent solution and water onto the load over and over. Clothes are soaked more quickly and thoroughly during wash cycle. The detergent suds can be removed more easily by the water shower during rinse cycle. The water circulation system uses both water and detergent more efficiently.



## ■ Tilted Drum and Extra Large Door Opening

Tilted drum and extra large opening make it possible to load and unload clothing more easily.

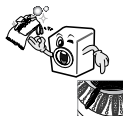

## ■ Embossing drum & waved lifter

Embossing drum enhances the washing performance and reduces clothes damage. The waved lifter spray and help clothes to enhance washing performance during the washing cycle.



## ■ Automatic Wash Load Detection

Automatically detects the load and optimizes the washing time.



## ■ Built-in Heater

Internal heater helps to maintain water temperature at its optimum level for selected cycles.



## ■ Child Lock

The Child lock prevents children from pressing any button to change the settings during operation.

# Warnings

## READ ALL INSTRUCTIONS BEFORE USE



### WARNING!

For your safety, the information in this manual must be followed to minimize the risk of fire or explosion, electric shock, or to prevent property damage, personal injury, or loss of life.

## IMPORTANT SAFETY INSTRUCTIONS

**WARNING :** To reduce the risk of fire, electric shock, or injury to persons when using the washer, follow basic precautions, including the following:

- Do not install or store the washer where it will be exposed to the weather.
- Do not tamper with controls.
- Do not repair or replace any part of the washer or attempt any servicing unless specifically recommended in the user-maintenance instructions or published user-repair instructions that you understand and have the skills to carry out.
- Keep the area underneath and around your appliances free of combustible materials such as lint, paper, rags, chemicals, etc.
- Close supervision is necessary if this appliance is used by or near children or infirm persons. Do not allow them to play on, with, or inside this or any other appliance.
- Keep washer away from fire.
- Do not leave the washer door open.  
An open door could entice children to hang on the door or crawl inside the washer.
- Never reach into washer while it is moving. Wait until the drum has completely stopped.
- The laundry process can reduce the flame retardant of fabrics.
- Do not wash articles that have been cleaned in, washed in, soaked in, or spotted with combustible or explosive substances (such as wax, oil, paint, gasoline, degreasers, dry cleaning solvents, kerosene, etc.) which may ignite or explode.
- Always follow the fabric care instructions supplied by the garment manufacturer.
- Do not slam the washer door closed or try to force the door open when locked. This could result in damage to the washer.
- To minimize the possibility of electric shock, unplug this appliance from the power supply or disconnect the washer at the household distribution panel by removing the fuse or switching off the circuit breaker before attempting any maintenance or cleaning.
- Never attempt to operate this appliance if it is damaged, malfunctioning, partially disassembled, or has missing or broken parts, including a damaged cord or plug.
- If the washer has been exposed to water, call an authorized service provider to avoid any risk of fire or electric shock.

## SAVE THESE INSTRUCTIONS

### GROUNDING INSTRUCTIONS

This appliance must be grounded. In the event of malfunction or breakdown, grounding will reduce the risk of electric shock by providing a path of least resistance for electric current. This appliance is equipped with a cord having an equipment-grounding conductor and grounding plug. The plug must be plugged into an appropriate outlet that is properly installed and grounded in accordance with all local codes and ordinance.

- Do not use an adapter or otherwise defeat the grounding plug.
- If you don't have the proper outlet, consult an electrician.

**WARNING :** Improper connection of the equipment-grounding conductor can result in risk of electric shock. Check with a qualified electrician or serviceman if you are in doubt as to whether the appliance is properly grounded. Do not modify the plug provided with the appliance - if it does not fit the outlet, have a proper outlet installed by a qualified electrician.

# S pecification

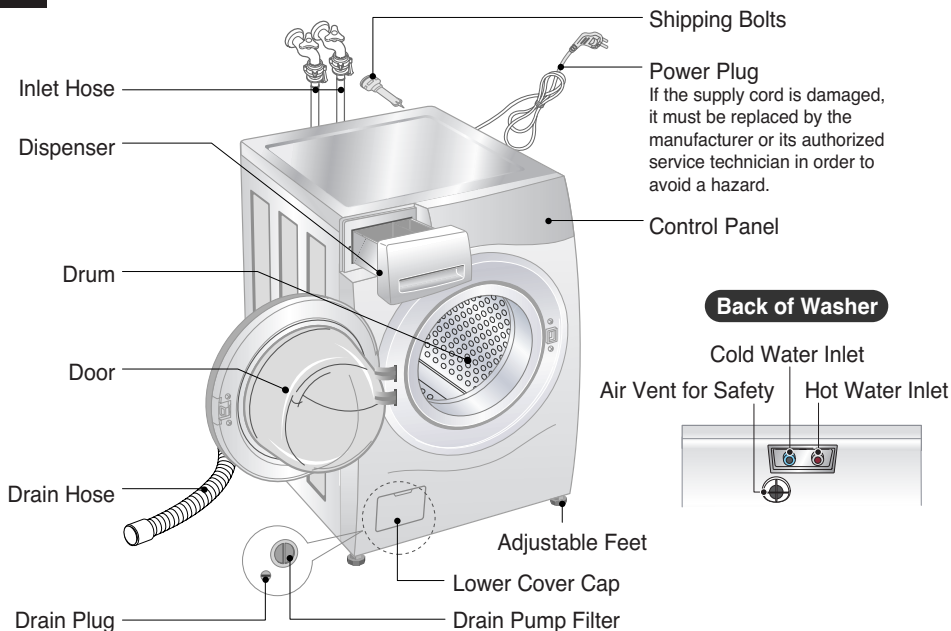

- **Name** : Front loading washing machine
- **Power supply** : 220 - 240 V~, 50 Hz
- **Size** : 686 mm (W) x 767 mm (D) x 982 mm (H)
- **Weight** : 87 kg
- **Wash capacity (Max. Watt)** : 10 kg (2200 W)
- **Spin speed** : No Spin / Extra Low / Low / Medium / High / Extra High
- **Water consumption** : 102 ℓ (10.2 ℓ / kg )
- **Permissible water pressure** : 7.3 ~ 116 PSI (50 ~ 800 kPa)
- **The external hot water supply must not exceed 65°C**
- **Permissible cold water temperature** : 4 - 25°C
- **No further backflow protection required for connection to the water supply.**

\* The appearance and specifications may be varied without notice to improve the units quality.

\* Specifications subject to change by manufacturer.

## ■ Accessories

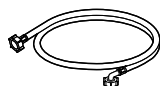

**Inlet hose**  
(1EA)  
(Option: Hot  
(1EA))



**Spanner**



**Elbow Bracket**  
(for securing  
drain hose)



**Non-skid pads**



**Caps for covering shipping bolt holes**



**Tie strap**

# I nstallation

Install or store where it will not be exposed to temperatures below freezing or exposed to the weather.

Properly ground washer to conform with all governing codes and ordinances.

The base opening must not be obstructed by carpeting when the washing machine is installed on a carpeted floor.

In countries where there are areas which may be subject to infestation by cockroaches or other vermin, pay particular attention to keeping the appliance and its surroundings in clean condition at all times.

Any damage which may be caused by cockroaches or other vermin will not be covered by the appliance guarantee.

## ■ Transit bolts

The appliance is fitted with transit bolts to prevent internal damage during transport.

- Packing and all transit bolts must be removed before using the washer.

☞ When unpacking the base, be sure to remove the additional packing support in the middle of the base packing.

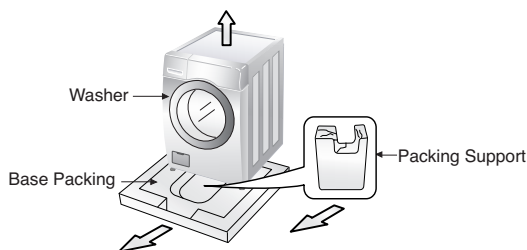

## ■ Removing transit bolts

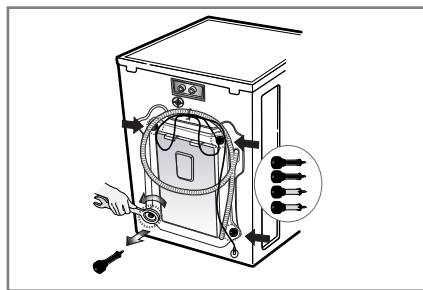
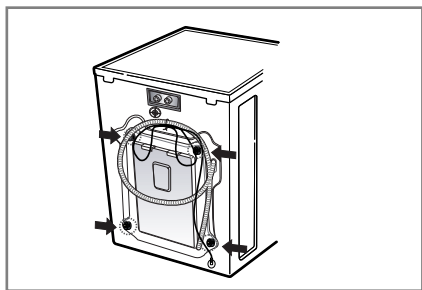

1. To prevent internal damage during transport, the special 4 bolts are locked. Before operating the washer, remove the bolts along with the rubber bungs.
  2. Unscrew the 4 bolts with the spanner supplied.
  3. Take out the 4 bolts along with the rubber bungs by slightly twisting the bung. Keep the 4 bolts and the spanner for future use.
  4. Close the holes with the caps supplied.
- If they are not removed, it may cause heavy vibration, noise and malfunction.
  - Whenever the appliance is transported, the transit bolts must be refitted.

# I nstallation

## ■ Installation place requirement

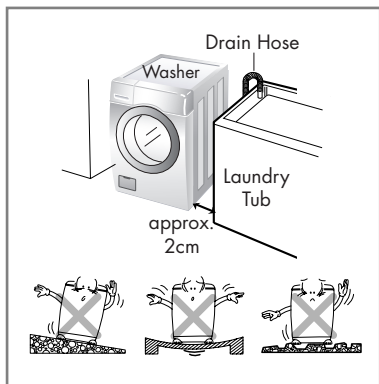

### **Level floor :**

Allowable slope under entire washer is 1°

### **Power outlet :**

Must be within 1.5 meters of either side of location of washer. Do not overload the outlet with more than one appliance.

### **Additional Clearance :**

The following clearances should be adhered to.  
(10 cm : rear / 2 cm : right & left side)

Do not place or store laundry products on top of washer at any time.

They can damage the finish or controls.

## ■ Positioning

Install the washer on a flat hard floor.

Make sure that air circulation around the washer is not impeded by carpets, rug etc.

- Before placing the washer on tiles, apply a rubber mat under the feet.
- Never try to correct any unevenness in the floor with pieces of wood, cardboard or similar materials under the washer.
- If it is impossible to avoid positioning the washer next to a gas cooker or coal burning stove, an insulating(85x60cm) covered with aluminum foil on the side facing the cooker or stove, must be inserted between the two appliance.
- The washer must not be installed in rooms where the temperature can drop below 0°C.
- Please ensure that when the washer is installed, it is easily accessible for the engineer in the event of a breakdown.
- With the washer installed adjust all four feet using the transit bolt spanner provided ensuring the appliance is stable, and a clearance of approximately 20mm is left between the top of the washer and the underside of the work-top.

# I nstallation

## ■ Electrical connection

1. Do not use an extension cord or double adapter.
  2. If the supply cord is damaged, it must be replaced by the manufacturer or its service agents or similarly qualified person in order to avoid a hazard.
  3. Always unplug the machine and turn off the water supply after use.
  4. Connect the machine to an earthed socket in accordance with current wiring regulations.
  5. The appliance must be positioned so that the plug is easily accessible.
- Repairs to the washing machine must only be carried out qualified personnel. Repairs carried out by inexperienced persons may cause injury or serious malfunctioning. Contact your local service center
  - Do not install your washing machine in rooms where temperatures below freezing may occur. Frozen hoses may burst under pressure. The reliability of the electronic control unit may be impaired at temperatures below freezing point.
  - If the appliance is delivered in the winter months and temperatures are below freezing : Store the washing machine at room temperature for a few hours before putting it into operation.

### CAUTION

This appliance is not intended for use by young children or infirm persons without supervision. Young Children should be supervised to ensure that they do not play with appliance.

### CAUTION

#### CAUTION concerning the Power Cord

Most appliances recommend they be placed upon a dedicated circuit; that is, a single outlet circuit which powers only that appliance and has no additional outlets or branch circuits. Check the specification page of this owner's manual to be certain.

Do not overload wall outlets. Overloaded wall outlets, loose or damaged wall outlets, extension cords, frayed power cords, or damaged or cracked wire insulation are dangerous. Any of these conditions could result in electric shock or fire. Periodically examine the cord of your appliance, and if its appearance indicates damage or deterioration, unplug it, discontinue use of the appliance, and have the cord replaced with an exact replacement part by an authorized servicer.

Protect the power cord from physical or mechanical abuse, such as being twisted, kinked, pinched, closed in a door, or walked upon. Pay particular attention to plugs, wall outlets, and the point where the cord exits the appliance.

If this appliance is supplied from a cord extension set or electrical portable outlet device, the cord extension set or electrical portable outlet device must be positioned so that it is not subject to splashing or ingress of moisture.

# I nstallation

## ■ Connecting water supply hose

- Water supply pressure must be between 7.3 ~ 116 PSI (50 ~ 800 kPa).
- Do not strip or crossthread when connecting inlet hose to the valve.
- If the water supply pressure is more than 800 kPa, a decompression device should be installed.
- Periodically check the condition of the hose and replace the hose if necessary.

### ► Step1 : Check rubber seal inlet hose

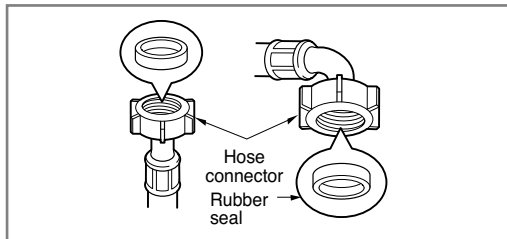

- Two rubber seals are supplied with the water inlet hoses. They are used for preventing water leaks. Make sure the connection to taps is sufficiently tight.

### ► Step2 : Connect hose to water tap

#### Type-A : Connecting Screw-type hose to tap with thread

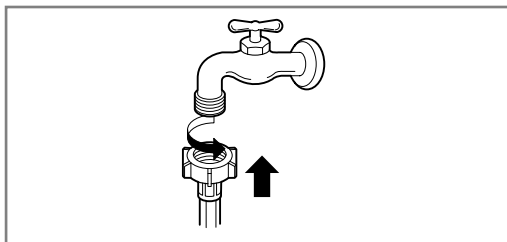

- Screw the hose connector onto water supply tap.

#### Type-B : Connecting Screw-type hose to tap without thread

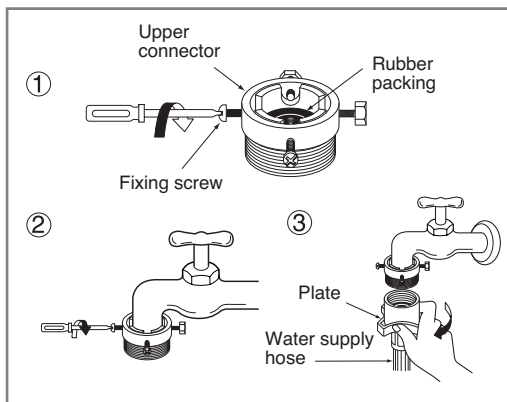

1. Unscrew the adapter ring plate and the 4 adapter retaining screws.
2. Push the adapter onto the end of the tap so that the rubber seal forms a watertight connection. Tighten the adapter ring plate and the 4 screws.
3. Push the water supply hose vertically upwards so that the rubber packing within the hose can adhere completely to the tap and then tighten it by screwing it to the right.

# I nstallation

## Type-C : Connecting one touch type hose to tap without thread

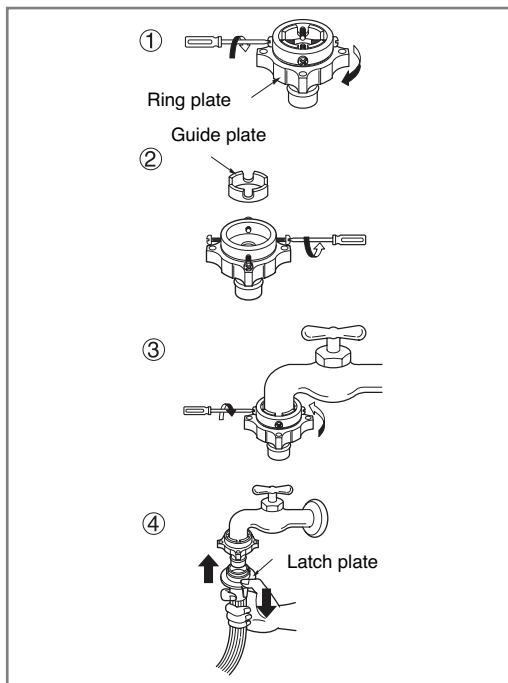

1. Unscrew the adapter ring plate and the 4 adapter retaining screws.
2. Remove the guide plate if the tap is too large to fit the adapter.
3. Push the adapter onto the end of the tap so that the rubber seal forms a watertight connection. Tighten the adapter ring plate and the 4 screws.
4. Pull the connector latch plate down, push the inlet hose onto the adapter, and release the connector latch plate. Make sure the adapter locks into place.



After connecting inlet hose to water tap, turn on the water taps to flush out foreign substances (dirt, sand or sawdust) in the water lines. Let water drain into a bucket, and check the water temperature.

## ► Step3: Connect hose to washer

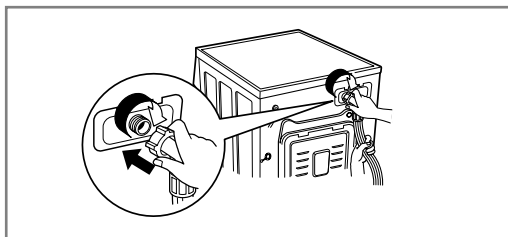

- Make sure that there are no kinks in the hose and that they are not crushed.

### ► When your washer has two valves.

- The Inlet hose which has red connector is for the hot water tap.
- If the washer has two valves, the energy is saved by using hot valve.



After completing connection, if water leaks from the hose, repeat the same steps. Use the most conventional type of faucet for water supply. In case the faucet is square or too big, remove the spacing ring before inserting the faucet into the adaptor.

### Use the horizontal tap

Horizontal tap



Extension tap



Square tap



# I nstallation

This equipment is not designed for maritime use or for use in mobile installations such as caravans, aircraft etc.

Turn off the tap if the machine is to be left for any length of time (e.g. holiday), especially if there is no floor drain(gully) in the immediate vicinity.

When disposing of the appliance, cut off the mains cable, and destroy the Plug.

Disable the door lock to prevent young children being trapped inside.

Packaging material (e.g. Films, Styrofoam) can be dangerous for children. There is a risk of suffocation ! Keep all packaging well away from children

## ■ Installation of drain hose

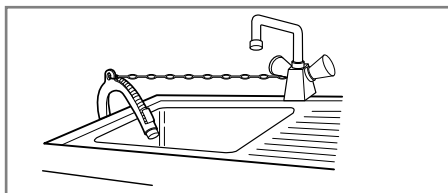
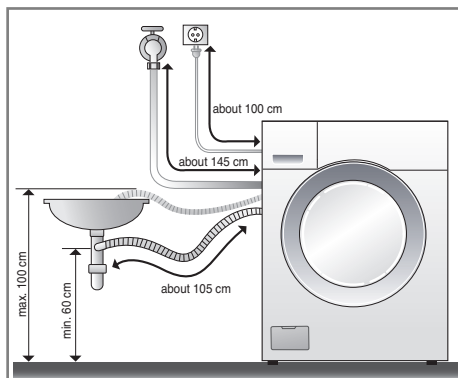

- When installing the drain hose to a sink, secure it tightly with a string.
- Proper securing of the drain hose will protect the floor from damage due to water leakage should the drain hose become loose.

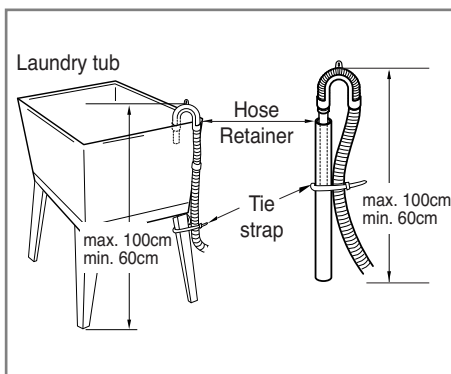
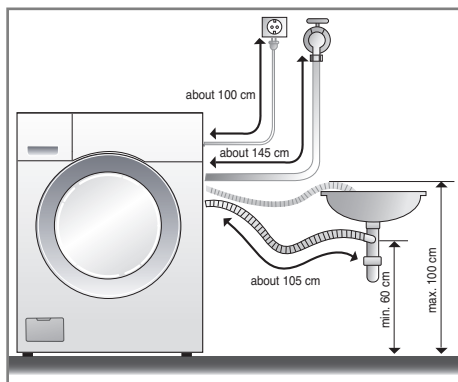

- The end of the drain hose should not be placed higher than 100 cm above the floor.
- Proper securing of the drain hose will protect the floor from damage due to water leakage.
- When the drain hose is too long, do not force back into the washer. This will cause abnormal noise, malfunction, and water leakage.

# I nstallation

## ■ Level adjustment

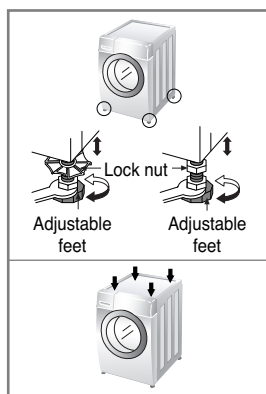

1. Adjusting the washing machine level properly prevents excessive noise and vibration.  
Install the appliance on a solid and level floor surface, preferably in a corner of the room.

**NOTE** Timber or suspended type flooring may contribute to excessive vibration and unbalance errors.

2. If the floor is uneven, adjust the adjustable feet as required. (do not insert pieces of wood etc. under the feet)  
Make sure that all four feet are stable and resting on the floor and then check that the appliance is perfectly level. (use a spirit level)  
✳ *After the washer is level, tighten the lock nuts up towards of the base of the washer. All lock nuts must be tightened.*

**NOTE** In the case that the washing machine is installed on a raised platform, it must be securely fastened in order to eliminate the risk that it might fall off.

### ✳ *Diagonal Check*

*When pushing down the edges of the washing machine top plate diagonally, the machine should not move up and down at all. (Please, check both of two directions)  
If machine rocks when pushing the machine top plate diagonally, adjust the feet again.*

## ■ Concrete floors

- The installation surface must be clean, dry and level.
- Install washer on a flat hard floor.

## ■ Tile floors (Slippery floors)

- Position each foot on the Tread Mate and level the machine to suit. (Cut Tread Mate into 70x70 mm sections and stick the pieces on to the dry tile where machine is to be placed.)

✳ *Tread Mate is a self adhesive material used on ladders & steps that prevents slipping.*

## ■ Wooden floors (Suspended floors)

- Wooden floors are particularly susceptible to vibration.
- To reduce, vibration we recommend you place rubber cups under each foot, at least 15mm thick under the washer, secured to at least 2 floor beams with screws.
- If possible install the washer in one of the corners of the room, where the floor is more stable.

✳ *Insert the rubber cups to reduce vibration.*

✳ *Rubber cups ( p/no. 4620ER4002B ) can be purchased from the LG spare parts department.*

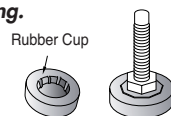

✳ It can be purchased from hardware suppliers.

### Important!

- Proper placement and levelling of the washer ensures long, regular and reliable operation.
- The washer must be absolutely horizontal and stand firmly in position.
- It must not "Seesaw" across corners under load.
- The installation surface must be clean, free from floor wax and other lubricant coatings.
- Do not let the feet of the washer get wet. If feet of the washer get wet, slipping may occur.

# Care before washing

## ■ Before the first washing

Select a cycle (COTTON 60°C, add a half load of detergent) allow the unit to wash without clothing. This will remove residues from the drum that may have been left during manufacturing.

## ■ Caring before washing

### 1. Care Labels

Look for a care label on your clothes. This will tell you about the fabric content of your garment and how it should be washed.

### 2. Sorting

To get the best results, Sort clothes into loads that can be washed with the same wash cycle. Water temperature and spin speed and different fabrics need to be washed in different ways. Always sort dark colors from pale colors and whites. Wash separately as dye and lint transfer can occur causing discoloration of white etc. If possible, do not wash heavily soiled items with lightly soiled one.

Soil (Heavy, Normal, Light)

Separate clothes according to amount of soil.

Color (White, Lights, Darks)

Separate white fabrics from colored fabrics.

Lint (Lint producers, Collectors)

Wash lint producers and lint collectors separately.

### 3. Caring before loading

■ Combine large and small items in a load. Load large items first. Large items should not be more than half the total wash load.

Do not wash single items. This may cause an out-of-balance load. Add one or two similar items.

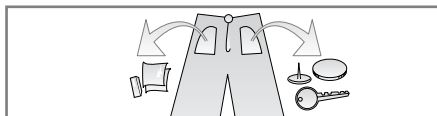

- Check all pockets to make sure that they are empty. Items such as nails, hair clip, matches, pens, coins and keys can damage both your washer and your clothes.

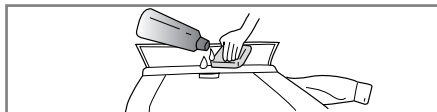

- Pre treat dirt and stains by brushing a little detergent dissolved in water onto stains like collars and cuffs to help shift dirt.

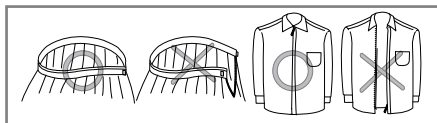

- Close zippers, hooks and strings to make sure that these items don't snag on other clothes.

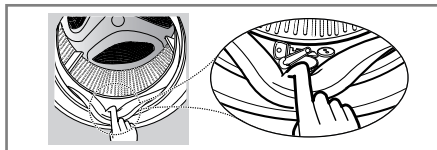

- Check the folds of the flexible gasket (gray) and remove any small articles, if any.
- Check inside of the drum and remove any left items in it for next wash cycle.



- Remove any clothing or items on the flexible gasket to prevent clothing and the gasket damages.

# Adding detergent

## ■ Adding detergent and fabric softener

### 1. The Dispenser Drawer

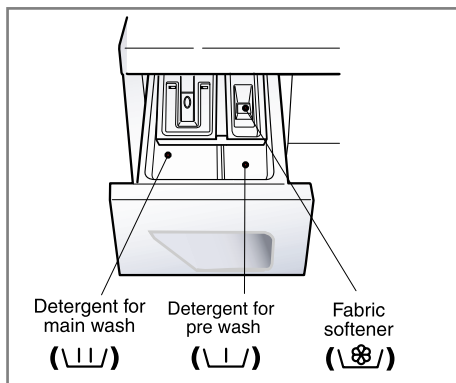

- Main wash only →
- Pre Wash + Main Wash → •

### 2. Adding Fabric Softener

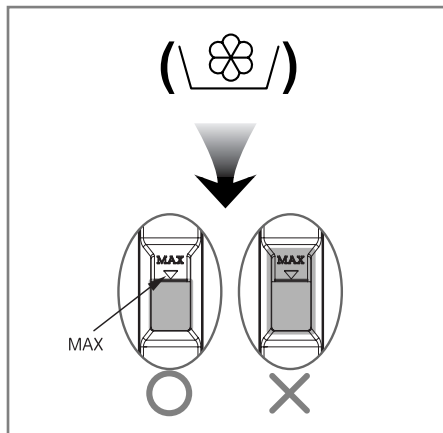

- Do not exceed the maximum fill line. Close the dispenser drawer slowly. Overfilling can cause early dispensing of the fabric softener which could stain clothes.
- Do not leave the fabric softener in the detergent drawer for more than 2 days. (Fabric softener could harden)
- Softener will automatically be added during the last rinse cycle.
- Do not open the drawer when water is supplied.
- Solvents (benzene, etc) are not allowable.

**NOTE** Do not pour fabric softener directly on the cloths

# A dding detergent

## 3. Detergent dosage

- *The detergent should be used according to the instruction of the detergent manufacture.*
- *If too much detergent is used, too many suds can occur and this will decrease the washing result or cause heavy load to the motor.*
- *Use powder detergent only for the front loading washer.*
- *Using the powdered detergent after dissolving in warm water is highly recommended for better washing performance.*

✱ *If suds occur too much, please reduce the detergent amount.*

- Detergent usage may need to be adjusted for water temperature, water hardness, size and soil level of the load. For best results, avoid oversudsing.

## 4. Water softener

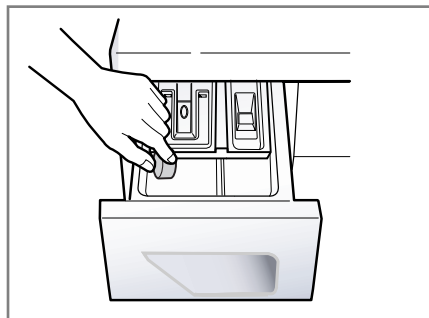

- A water softener, such as Anti limescale (Clagon) can be used to cut down on the use of detergent in extremely hard water areas. Dispense according to the amount specified on the packaging. First add detergent and then the water softener.
- Use the quantity of detergent as for soft water.

## ✱ Tips

**Full load : according to manufacturer's recommendation.**

**Part load : 3/4 of the normal amount.**

**Minimum load : 1/2 of full load.**

- Detergent is flushed from the dispenser at the beginning of the cycle.

## 5. Using the Tablets

- 1) Open the door and Tablets into the drum.

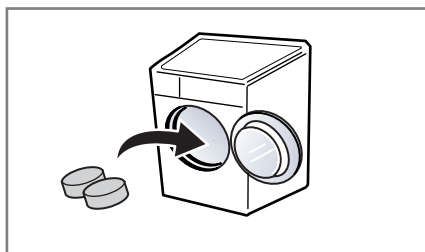

- 2) Load the laundry into the drum.

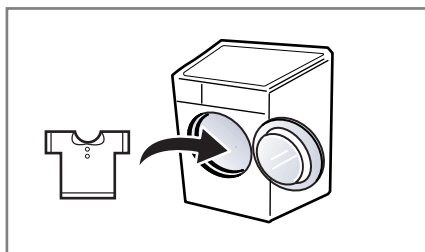

- 3) Close the door.

## ■ Recommended courses according to the laundry type

Program	Fabric Type	Proper Temp. (Option)	Additional Option	Maximum Load
Cotton	Color fast garments (shirts, nightdresses, pajamas, etc) and normally soiled cotton load (underwear).	40°C (Cold, 30°C, 60°C)	Soak Pre Wash Intensive Medium Soiled Light No Wash Medic Rinse Crease Care	Rating
Sports Wear	This cycle is suitable for sports wear such as jogging clothes and running wear	30°C (Cold)	Medium Soiled No Wash Crease Care	Less than 5.0 kg
Dark Wash	Use this cycle to wash “multi-color” clothes to maintain their color	40°C (Cold, 30°C)	Medium Soiled No Wash Crease Care	Less than 5.0 kg
Cold Wash	This cycle is suitable for lightly soiled clothing. Use this cycle to save energy, by using cold water while ensuring proper washing.	Cold	Soak Pre Wash Intensive Medium Soiled Light No Wash Crease Care	Rating
Wool	Enable to wash wool fabrics. (Please use detergent for machinewashable woolens).	40°C (Cold, 30°C)	Medium Soiled No Wash	Less than 4.0 kg
Duvet	Cotton bedding with filling, duvet, pillow, blanket, sofa cover with light filling.	Cold (30°C, 40°C)	Medium Soiled Light No Wash	1 king size (9 Tog)
Rinse+Spin	Rinse and Spin	-	Crease Care	-
Baby Care	Lightly soiled baby wear.	60°C	Pre Wash No Wash Medic Rinse Crease Care	Less than 4.5 kg
Silent	Color fast garments (shirts, nightdresses, pajamas, etc) and lightly soiled white cotton (underwear).	40°C (Cold, 30°C, 60°C)	Soak Pre Wash Intensive Medium Soiled Light No Wash Medic Rinse Crease Care	Less than 5.0 kg
Speed Wash	Lightly soiled clothing and small loads	40°C (Cold, 30°C)	Medium Soiled No Wash	Less than 5.0 kg
Sanitary	Heavily soiled underwear, work clothes, diapers, etc	95°C	Soak Medium Soiled No Wash Medic Rinse Crease Care	Less than 3.0 kg
Heavy Duty	Heavily soiled cotton fabrics	60°C (40°C)	Soak Pre Wash Intensive No Wash Medic Rinse Crease Care	Less than 3.0 kg

\* Water Temperature : Select the water temperature to the wash cycles. Always follow garment manufacture's care label or instructions when laundering.

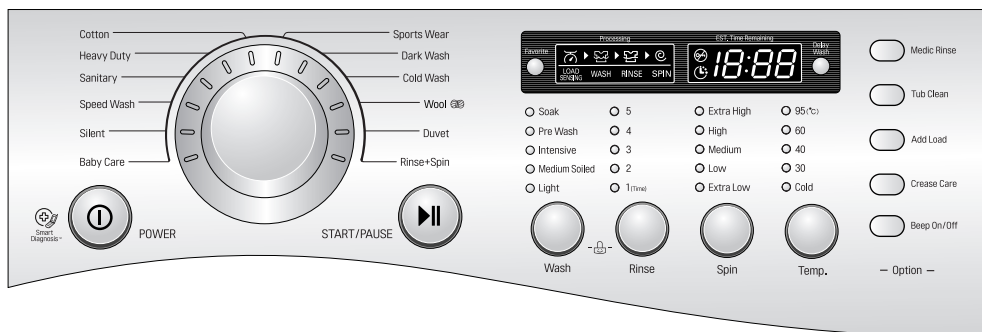

\* Pre Wash : If the laundry is heavily soiled, “Pre Wash” option is recommended.  
Pre Wash is available in Cotton, Cold Wash, Baby Care, Silent, Heavy Duty Program.

# How to use washer



- **Water Temperature:** Select water temperature to suit wash cycles. Always follow garment manufacture's care label or instructions when washing.
- Set program at "Cotton 40°C, Intensive, 3 Rinses, Extra High Spin" is for normally soiled load (10 kg) and test in accordance or in conformity with AS/NZS 2040.1.
- The test result depend on water pressure depend, water hardness, water inlet temperature, room temperature, type and amount of load, degree of soiling utilized detergent, fluctuations in the main electricity supply and chosen additional options.
- For best washing results, we recommend to mix dry detergent with warm water.

## 1. Cotton automatically selected upon power on.

- Press the **Power**() button to start.
- Press the **Start/Pause**() button.
- Initial condition
  - *Wash : Medium Soiled*
  - *Rinse : 3*
  - *Spin : High*
  - *Temp. : 40°C*
  - *Program : Cotton*

## 2. Manual Selecting

- Press the **Power**() button to turn the washer on.
- Select the desired cycle with the program dial and if required, make any changes to the washing conditions by pressing the buttons accordingly.

*For selecting the each conditions, please refer to the page18~page24*

- Press the **Start/Pause** button to commence the cycle.

# How to use washer

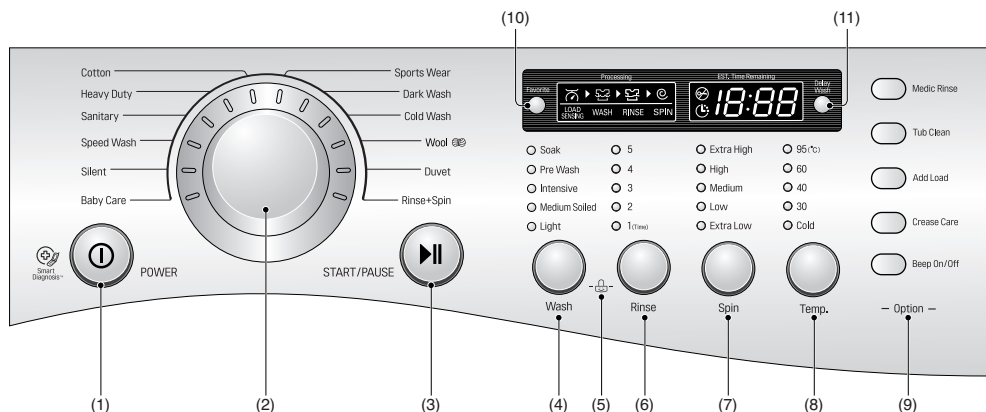

- (1) Button: Power  
(2) Dial: Program  
(3) Button: Start/Pause

- (4) Button: Wash  
(5) Child lock  
(6) Button: Rinse

- (7) Button: Spin  
(8) Button: Temperature  
(9) Button: Option

- (10) Button: Favorite  
(11) Button: Delay Wash

## Power



### 1. Power

- Press the Power(⏻) button to turn power on and off.
- To cancel the **Delay Wash** function, the Power(⏻) button should be pressed.

## 2. Initial Program

- When the Power(⏻) button is pressed, the washer is ready for Cotton program. And the other initial conditions as follows.
- So, if you want to advance into the washing cycle without changing the program, just press **Start/Pause**(⏸) button and then the washer will proceed.

### ■ Initial program

- Cotton Program / Wash : Medium Soiled / Rinse : 3 / Spin : High / Temp. : 40 °C

## Program

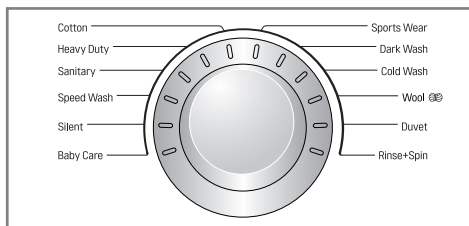

- 12 programs are available according to the laundry type.
- Lamp will light up to indicate selected program.
- When **Start/Pause**(⏸) button is pressed, the Cotton program is automatically selected.
- By turning the Program dial, the program is Selected of "Cotton – Sports Wear – Dark Wash – Cold Wash – Wool – Duvet – Rinse+Spin – Baby Care – Silent – Speed Wash – Sanitary – Heavy Duty"

*For information regarding laundry type for each program, please refer to page 16.*

# How to use washer

## Start/Pause

START/PAUSE



### 1. Start

- This **Start/Pause** button is used to start wash cycle or pause the wash cycle.

### 2. Pause

- If temporary stop of wash cycle is needed, press “**Start/Pause**” button.

## Wash

- ☐ Soak
- ☐ Pre Wash
- ☐ Intensive
- ☐ Medium Soiled
- ☐ Light



Wash

- By pressing the Wash button, the Wash type can be selected.

### NOTE:

Depending on the selected program cycle, not all Options may be selectable.

### 1. Soak

- Use this mode to wash normal clothes or thick and heavy clothes which are excessively dirty.

### 2. Pre Wash

- Use this option for loads that need pretreatment. This adds 15 minutes of pre washing before draining.
- When using Pre Wash option, do not use a liquid detergent for the main wash. Use powder for the main wash.

### 3. Intensive

- By selecting the Intensive option, the wash time may be extended, depending on the program selected.
- To use this option select the Intensive option once before the wash programme is started.

### 4. Medium Soiled

- This option is automatically selected in every course except for Rinse+Spin.

### 5. Light

- This cycle is suitable for lightly soiled clothing.

# How to use washer

## Child lock

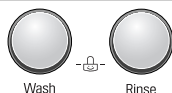

If you choose to lock the buttons on the control assembly to prevent tampering, this function may be selected.

- Child lock can be set by pressing and holding the **Wash** and **Rinse** button simultaneously. (About three seconds)

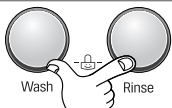

- When child lock is set, all buttons are inoperable except for power button.
- When child lock is set, and remaining time are displayed by turns.
- To deactivate Child lock system, press and hold the **Wash** and **Rinse** button simultaneously again. (About three seconds)

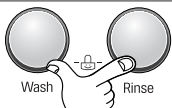

- To change to the desired program, whilst in child lock mode.

1. Press and hold both **Wash** and **Rinse** button together once again. (About three seconds)
2. Press the **Start/Pause** button.
3. Select the desired program and press the **Start/Pause** button again.

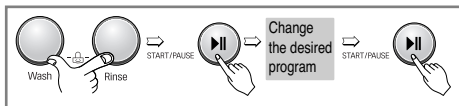

- The child lock can be set at any time and it is automatically canceled when operational errors occur.

## Rinse

- 5
- 4
- 3
- 2
- 1 (time)



- By pressing the Rinse button, the Rinse type can be selected.

- By pressing the Rinse button, the Rinse type can be selected.
- **Duvet, Baby Care, Silent** performs 4 Rinses.
- **Cotton, Sports Wear, Dark Wash, Cold Wash, Wool, Sanitary, Heavy Duty** performs 3 Rinses.
- **Speed Wash** performs 2 Rinses.
- **Rinse+Spin** performs 1 Rinse.

*The required lamp will light up for identification.*

# H ow to use washer

## Spin

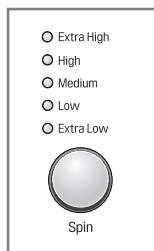

- By pressing the Spin button, the spin speed can be chosen.

### 1. Spin selection

- Spin speed is available according to the program as follows.
- **Cotton & Dark Wash & Cold Wash & Baby Care & Silent & Speed Wash & Sanitary & Heavy Duty**  
Extra High – High – Medium – Low – Extra Low – No Spin
- **Rinse+Spin**  
Extra High – High – Medium – Low – Extra Low
- **Duvet**  
Medium – Low – Extra Low – No Spin
- **Wool**  
Low – Extra Low – No Spin
- **Sports Wear**  
Extra Low – No Spin

*The required lamp will light up for identification.*

## Water Temperature

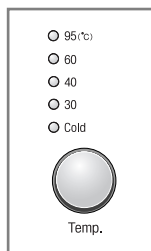

- By pressing the Temp. button, the water temperature can be selected.

- **Cold**  
- 30°C / 40°C / 60°C / 95°C

- Water temperature can be selected as below according to the program.
- **Cotton & Silent**  
60°C – 40°C – 30°C – Cold
- **Dark Wash & Wool & Duvet**  
40°C – 30°C – Cold
- **Heavy Duty**  
60°C – 40°C
- **Sanitary**  
95°C
- **Baby Care**  
60°C
- **Cold Wash**  
Cold

*The required temperature lamp will light up for identification.*

*For the more detailed information, please refer to the page 16.*

# How to use washer

## Medic Rinse



Medic Rinse

For best results or for cleaner rinsing.

This allows the final rinse

to be heated to 40 degrees.

1. Press the Power button.
2. Select a cycle.
3. Press the Medic Rinse button.
4. Press the Start/Pause button.

## Tub Clean



Tub Clean

**TUB CLEAN** is special cycle to clean the inside of the washer. This cycle uses higher water level with higher spin speed. Perform this cycle regularly.

### How to use the Tub Clean cycle:

1. Remove any clothing or items from the washer and close the door.
  2. Open the dispenser drawer and add Anti limescale (Calgon) to the Main wash compartment.
- NOTE:** Do not add any detergent to the detergent compartments. Excessive suds may generate and leak from the washer.
3. Close the dispenser drawer slowly.
  4. Power On and then press **Tub Clean** ( Tub Clean) button.
  5. Press the Start/Pause button to start.
  6. After the cycle is complete, leave the door open to dry around the washer door opening, flexible gasket and door glass.



**CAUTION:** If there is a small child, be careful not to leave the door open for too long.

## Add Load



Add Load

Use this function to add loads or remove the foreign material.

- How to use “Add Load”
  - Press the “Add Load” button.
  - Close the door after add loads or remove the foreign material(e.g. coin or pin etc.)
  - Press the “Start/Pause” button.
- Open the door when “Door Lock” is off after checking the safety.
- Results when choosing “Add Load” during cycles
  - When the tub is spinning: Tub stops and “Door Lock” is off.
  - When water temperature in the tub is higher than 45°C: “Add Load” is not available with short warning sound for safety.
  - When lots of water is in the tub: “Door Lock” is off after draining by safe water level.
- “Add Load” doesn’t work when “Tub Cleaning” course is in progress for safety

### NOTE

Put the laundry into the tub completely. Laundry caught in between door closing part can damage door packing (rubber part) and might cause failure.

# How to use washer

## Crease Care



Crease Care

If you want to prevent creasing, select Crease Care option.

1. Press the Power button.
2. Select a cycle.
3. Press the Crease Care button.
4. Press the Start/Pause button.

## Beep On / Off



Beep On/Off

The Beep on/off function can be set only during the washing cycle.

1. Press the Power button.
2. Press the Start/Pause button.
3. Press the Beeper button to set Beep on/off function.

Once the Beep on/off function is set, the setting is memorized even after the power is turned off.

### NOTE

- If you want to turn the Beeper off, simply repeat this process.

## Favorite

Favorite program allows you to store a customized wash cycle for future use.

1. Press the Power button.
2. Select a cycle.
3. Select the course.  
(Washing method, number of rinses, spin speed, water temperature etc.)
4. Press and hold Favorite program button for 3 seconds.

The Favorite program is now stored for future use.

To reuse the program, select Favorite program and press the Start/Pause.

## Delay Wash

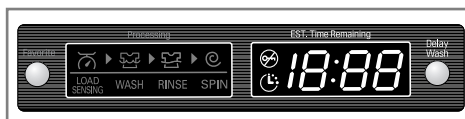

### Preparing washing before starting "DELAY WASH"

- Turn on the water tap.
- Load laundry and close the door.
- Place the detergent and fabric softener in the drawer.

- How to set "DELAY WASH"
  - Press **Power** (⏻) button.
  - Turn the **Program** dial to select the program you require.
  - Press **DELAY WASH** button and set the desired time.
  - Press the **Start/Pause** (⏸) button.
- If **DELAY WASH** button is pressed, "3:00" is displayed. The maximum delayed time is 19:00 hours and the minimum time is 3:00 hours.
- Each pressing of the button advances time delay by one hour.
- To cancel the time delay, press the **Power** (⏻) button.
- **DELAY WASH** is 'expected time' from the present to the completion of washing cycle or selected process (Wash, Rinse, Spin).
- *According to the condition of water supply and temperature, the delayed time and the actual washing time may vary.*

## Door Lock

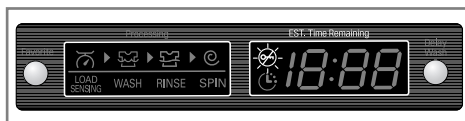

- Lights whenever the door of the washer is locked.
- The door can be unlocked by pressing the Start/Pause button to stop the washer.
- The door can be opened after a short delay.

# How to use washer

## Display

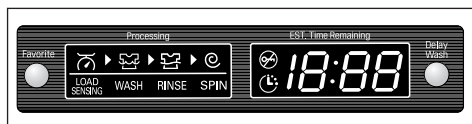

### 1. Special function display

- When time delay is selected, it shows the remaining times to finish the selected program.

### 2. Self diagnose display

- If the washer encounters a fault during operation, the associated fault will be displayed.
  - “PE” : Water pressure sensing error
  - “FE” : Problem of overfilling water
  - “dE1”, “dE2” : Door is not closed
  - “LE” : Over load in motor
  - “IE” : Water inlet trouble
  - “DE” : Drainage trouble
  - “UE” : Unbalanced load
  - “tE” : Water temperature trouble
  - “FF” : Drain hose, supply hose or drain pump is frozen

*If these error letters are displayed, please refer to the troubleshooting page 31 and follow the guide.*

### 3. Completion of washing

- When washing cycle is completed, “End” is displayed on the “Multi display”.

### 4. Time left

- During washing cycle, the remaining washing time is displayed.
- The washing time may vary by the amount of laundry, water pressure, water temperature and other washing conditions.
- If an unbalanced load is detected or if the suds removing program operates, the wash time may be extended.  
(Max. increasing time is 45 minutes.)

# Maintenance

- \* Before cleaning the washer interior, unplug the electrical power cord to avoid electrical shock to avoid electrical shock hazards.
- \* When disposing of the appliance, cut off the mains cable, and destroy the plug Disable the door lock to prevent young children being trapped inside.

## ■ The water inlet filter

- " I E " error message will blink on the control panel when water does not enter the detergent drawer.
- If water is very hard or contains traces of lime deposit, the water inlet filter may become clogged.  
It is therefore a good idea to clean it from time to time.

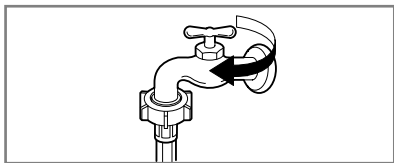

1. Turn off the water tap.

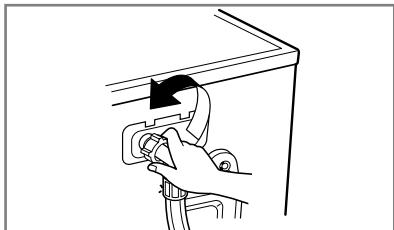

2. Unscrew the water inlet hose.

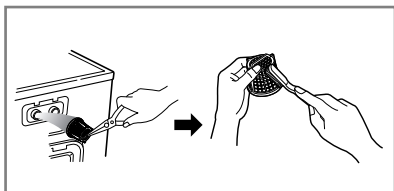

3. Clean the filter using a hard bristle brush.



4. Tighten up the inlet hose.

## ■ The drain pump filter

\* The drain filter collects threads and small objects left in the laundry.

Check regularly that the filter is clean to ensure smooth running of your machine.

**⚠ CAUTION** First drain using the drain hose and then open the pump filter to remove whatever any threads or objects.

Be careful when draining if the water is hot.

\* Allow the water to cool down before cleaning the drain pump, carrying out emergency emptying or opening the door in an emergency.

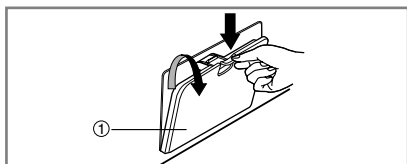

1. Open the lower cover cap (①) by using a finger. Turn the drain plug (②) to pull out the hose.

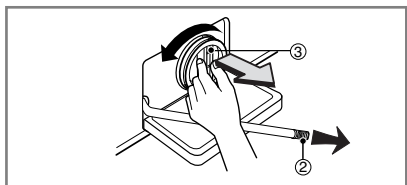

2. Unplug the drain plug (②), allowing the water to flow out. At this time use a vessel to prevent water flowing on to the floor. When water does not flow any more, turn the pump filter (③) open to the left.

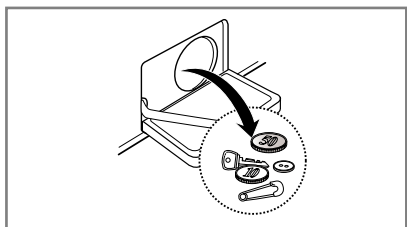

3. Remove out any foreign material from the pump filter (③).

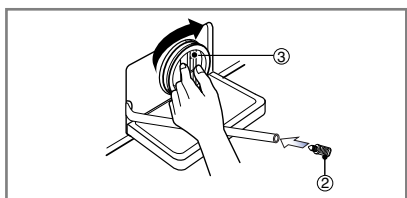

4. After cleaning, turn the pump filter (③) clockwise and insert the drain plug (②) to the original place. Close the lower cover cap.

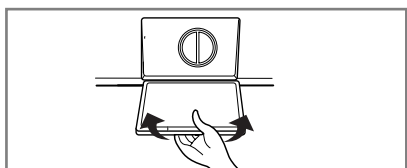

# Maintenance

## ■ Dispenser drawer

- \* After a while detergents and fabric softeners leave a deposit in the drawer.
- It should be cleaned from time to time with a jet of running water.
- If necessary it can be removed completely from the machine by pressing the catch downward and by pulling it out.
- To facilitate cleaning, the upper part of the fabric softener compartment can be removed.

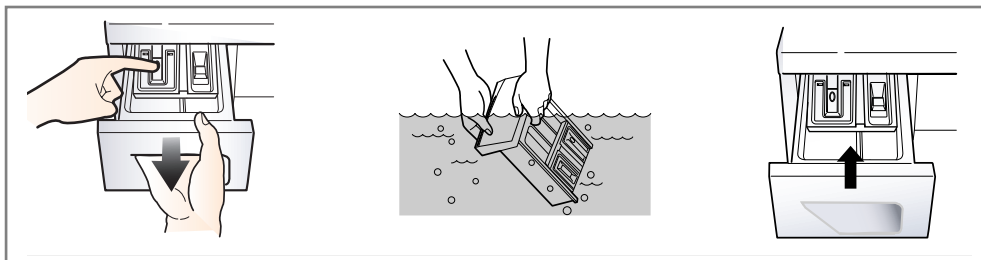

## ■ The drawer recess

- \* Detergent can also accumulate inside the recess which should be cleaned occasionally with an old toothbrush.
- Once you have finished cleaning, replace the drawer and run a rinse cycle without laundry.

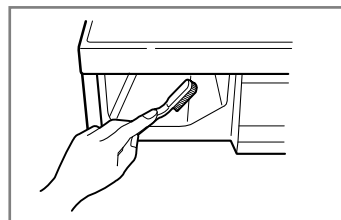

## ■ The washing drum

- If you live in a hard water area, lime scale may continuously build up in places where it cannot be seen and thus not easily removed.  
Over time the build up of scale clogs appliances, and if it is not kept in check, expensive maintenance or repairs may result.
- Although the washing drum is made of Stainless steel, specks of rust can be caused by small metal articles (paper clips, safety pins) which have been left in the drum.
- The washing drum should be cleaned from time to time.
- If you use descaling agents, dyes or bleaches, make sure they are suitable for washing machine use.
- \* Descaler may contain chemicals that may damage part of your washing machine.
- \* Remove any spots with a stainless steel cleaning agent.
- \* Never use steel wool.

# Maintenance

## ■ The water circulation nozzle

- Clean the water circulation nozzle, if clogged.

## ■ Cleaning your washer

### 1. Exterior

Proper care of your washer can extend its life.

The outside of the machine can be cleaned with warm water and a neutral non abrasive household detergent.

Immediately wipe off any spills. Wipe with damp cloth.

Try not to hit surface with sharp objects.

\* IMPORTANT: Do not use methylated spirits, diluents or similar products.

### 2. Interior

Dry around the washer door opening, flexible gasket and door glass.

Run washer through a complete cycle using hot water.

Repeat process if necessary.

**NOTE** Remove hard water deposits using only cleaners labeled as safe for washing machine.

## ■ Winterizing instructions

If the washer is stored in an area where freezing may occur or moved in freezing temperatures, follow these instructions to prevent damage to the washer:

1. Turn off water supply tap.
2. Disconnect hoses from water supply and drain water from hoses.
3. Plug electrical cord into a properly grounded electrical outlet.
4. Add 1gallon(3.8L) of nontoxic recreational vehicle(RV) antifreeze into an empty wash drum.  
Close the door.
5. Set spin cycle and let washer spin for 1minute to drain out all water.  
Not all of the RV antifreeze will be expelled.
6. Unplug electrical power cord, dry the drum interior, and close the door.
7. Remove dispenser drawer, drain and dry excessive water from the compartments.
8. Store washer in an up right position.
9. To remove antifreeze from washer after storage, run empty washer through a complete cycle using detergent. Do not add wash load.

# Troubleshooting guide

**\* This washing machine is equipped with automatic safety functions which detect and diagnose faults at an early stage and react appropriately.**











**When the machine does not function properly or does not function at all, check the following points before you contact your service provider.**

Symptom	Possible Cause	Solution
Rattling and clanking noise	<ul style="list-style-type: none"> <li>Foreign objects such as coins or safety pins maybe in drum or pump.</li> </ul>	<p>Stop washer and check drum and drain filter.</p> <p>If noise continues after washer is restarted, call your authorised service centre.</p>
Thumping sound	<ul style="list-style-type: none"> <li>Heavy wash loads may produce a thumping sound. This is usually normal.</li> </ul>	<p>If sound continues, washer is probably out of balance. Stop and redistribute wash load.</p>
Vibrating noise	<ul style="list-style-type: none"> <li>Have all the transit bolts and packing been removed?</li> <li>Are all the feet resting firmly on the ground?</li> </ul>	<p>If not removed during installation. Refer to Installation guide for removing transit bolts.</p> <p>Wash load may be unevenly distributed in drum. Stop washer and rearrange wash load.</p>
Water leaks.	<ul style="list-style-type: none"> <li>Fill hoses or drain hose are loose at tap or washer.</li> <li>House drain pipes are clogged.</li> <li>There is something between the gasket and the glass.</li> </ul>	<p>Check and tighten hose connections.</p> <p>Unclog drain pipe. Contact plumber if necessary.</p> <p>Clean the gasket and the glass with the towel.</p>
Over sudsing		<p>Too much detergent or unsuitable detergent may cause excessive foaming which may result in water leaks, and vibration during spin.</p>
Water does not enter washer or it enters slowly	<ul style="list-style-type: none"> <li>Water supply is not adequate in area.</li> <li>Water supply tap is not completely open.</li> <li>Water inlet hose(s) are kinked.</li> <li>The filter of the inlet hose(s) clogged.</li> </ul>	<p>Check another tap in the house.</p> <p>Fully open tap.</p> <p>Straighten hose.</p> <p>Check the filter of the inlet hose.</p>

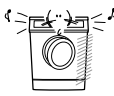
# Troubleshooting guide

Symptom	Possible Cause	Solution
Water in the washer does not drain or drains slowly.	<ul style="list-style-type: none"> <li>• Drain hose is kinked or clogged.</li> <li>• The drain filter is clogged.</li> </ul>	<p>Clean and straighten the drain hose.</p> <p>Clean the drain filter.</p>
Washer does not start	<ul style="list-style-type: none"> <li>• Electrical power cord may not be plugged in or connection may be loose.</li> <li>• House fuse blown, circuit breaker tripped, or a power outage has occurred.</li> <li>• Water supply tap is not turned on.</li> </ul>	<p>Make sure plug fits tightly in wall outlet.</p> <p>Reset circuit breaker or replace fuse. Do not increase fuse capacity. If problem is a circuit overload, have it corrected by a qualified electrician.</p> <p>Turn on water supply tap.</p>
Washer will not spin	<ul style="list-style-type: none"> <li>* Check that the door is firmly shut.</li> </ul>	<p>Close the door and press the Start/Pause button. After pressing the Start/Pause button, it may take a few moments before the clothes washer begins to spin. The door must lock before spin can be achieved.</p>
Door does not open		<p>Once started, the door can not be opened for safety reasons. Wait one or two minutes before opening the door to give the electric locking mechanism time to release.</p>
Washer pauses for longer intervals than normal during tumbling.	<p>The bowl will tumble for 3 seconds and then pause for 50 seconds repeatedly for part of the wash cycle. This is normal during the Hand Wash &amp; Wool cycles.</p>	<p>This action allows the more delicate clothes to soak which assists in stain removal.</p>
Wash cycle time delayed	<ul style="list-style-type: none"> <li>• It takes time to balance the laundry before the spin cycle</li> </ul>	<p>The washing time may vary by the amount of laundry, water pressure, water temperature and other usage conditions. If the imbalance is detected or if the suds removing program works, the wash time shall be increased. Stop the wash and pull out the laundry then put it again to untwist</p>

# Troubleshooting guide

Symptom	Possible Cause	Solution
	<ul style="list-style-type: none"> <li>• Water supply is not adequate in area</li> <li>• Water supply taps are not completely open.</li> <li>• Water inlet hose(s) are kinked.</li> <li>• The filter of the inlet hose(s) are clogged.</li> </ul>	<p>Check another tap in the house. Fully open tap.</p> <p>Straighten hose(s). Check the filter of the inlet hose(s).</p>
	<ul style="list-style-type: none"> <li>• Drain hose is kinked or clogged.</li> <li>• The drain filter is clogged.</li> </ul>	<p>Clean and straighten the drain hose. Clean the drain filter.</p>
	<ul style="list-style-type: none"> <li>• Load is too small.</li> <li>• Load is out of balance.</li> <li>• The appliance has an unbalance detection and correction system. If individual heavy articles are loaded (ex. bath mat, bath robe, etc.), this system may stop spinning or even interrupt the spin cycle altogether.</li> <li>• If the laundry is still too wet at the end of the cycle, add smaller articles of laundry to balance the load and repeat the spin cycle.</li> </ul>	<p>Add 1 or 2 similar items to help balance the load. Rearrange load to allow proper spinning</p>
	 <ul style="list-style-type: none"> <li>• Is the door opened or not completely closed?</li> </ul>	<p>Close the door completely. * If “dE 1”, “dE 2” is not released, call for service.</p>
		Unplug the power plug and call for service.
	<ul style="list-style-type: none"> <li>• Water overfills due to the faulty water valve.</li> </ul>	<p>Close the water tap. Unplug the power plug. Call for service.</p>
	<ul style="list-style-type: none"> <li>• Water level sensor has malfunctioned.</li> </ul>	
	<ul style="list-style-type: none"> <li>• Over load in motor.</li> </ul>	
	<ul style="list-style-type: none"> <li>• Is Inlet/outlet hose or drainage pump frozen?</li> </ul>	<p>Supply warm water into the tub and unfreeze outlet hose and drainage pump. Wet a towel in warm water and apply to inlet hose.</p>

# Troubleshooting guide

## NOTE

- If the moisture inside the drum is not removed well after the use, it can cause odor or stains (Mold). After using the washer, keep the door open until the moisture inside the drum dries up.

## ■ Using Smart Diagnosis™

- Only use this feature when instructed to do so by the call center.  
The transmission sounds similar to a fax machine, and so has no meaning except to the call center.
- Smart Diagnosis™ cannot be activated if the washer does not power up.  
If this happens, then troubleshooting must be done without Smart Diagnosis™.

If you experience problems with your washer, call to Customer Information Center.

Follow the call center agent's instructions, and do the following steps when requested:

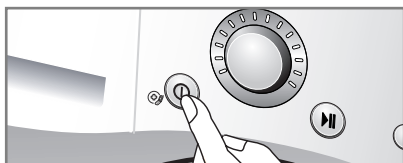

1. Press the Power button to turn on the washer.  
Do not press any other buttons or turn the cycle selector knob.

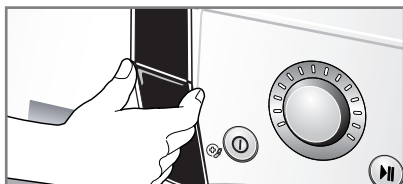

2. When instructed to do so by the call center, place the mouthpiece of your phone very close to the Power button.

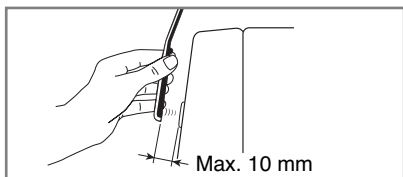
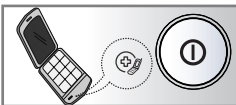

3. Press and hold the "Temp." button for three seconds, while holding the phone mouthpiece to the icon or Power button.
  4. Keep the phone in place until the tone transmission has finished.  
This takes about 6 seconds, and the display will count down the time.
    - For best results, do not move the phone while the tones are being transmitted.
    - If the call center agent is not able to get an accurate recording of the data, you may be asked to try again.
    - Pressing the Power button during the transmission will shut off the Smart Diagnosis™.
  5. Once the countdown is over and the tones have stopped, resume your conversation with the call center agent, who will then be able to assist you using the information transmitted for analysis at the call to Customer information center.
- \* Smart Diagnosis is a troubleshooting feature designed to assist, not replace, the traditional method of troubleshooting through service calls. The effectiveness of this feature depends upon various factors, including, but not limited to, the reception of the cellular phone being used for transmission, any external noise that may be present during the transmission, and the acoustics of the room where the machine is located. Accordingly, LG does not guarantee that Smart Diagnosis would accurately troubleshoot any given issue.







