

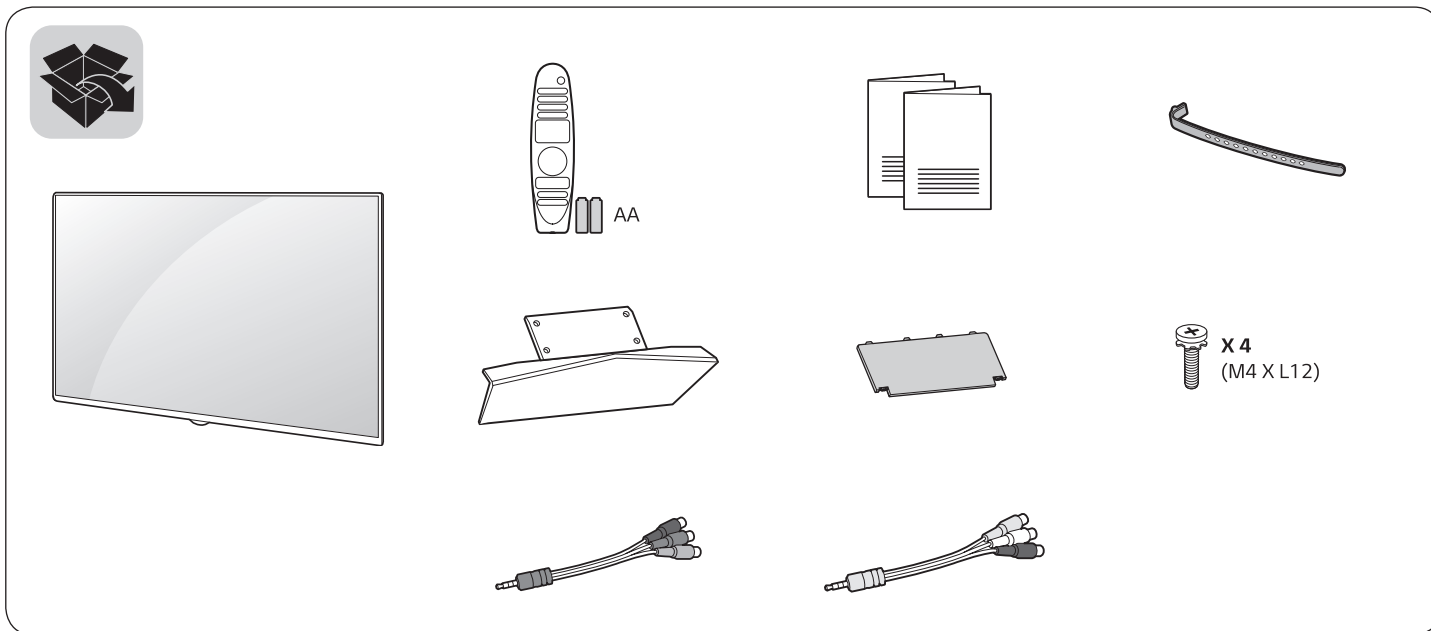

Quick Start Guide

OLED TV
OLED55B7*
OLED65B7*



Unpacking

Check your product box for the following items. If there are any missing accessories, contact the local dealer where you purchased your product. The illustrations in this manual may differ from the actual product and item.

*Image may vary depending on models

⊕ : Depending on model



www.lg.com

P/No: MFL69446185 (1703-REV00)



English

- Read **Safety and Reference.**
- For the power supply and power consumption, refer to the label attached to the product.

USING THE USER GUIDE



Press the  button
to access home menu



Navigate & Select
User Guide



Refer User Guide for
detail information

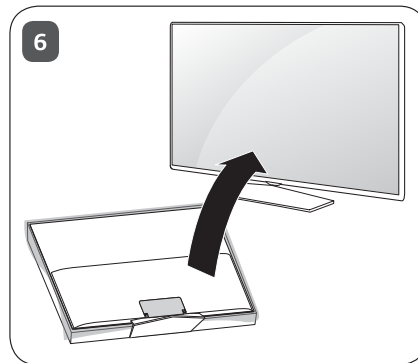
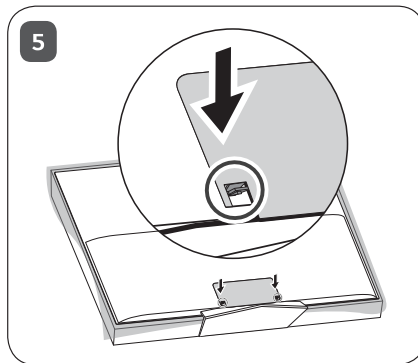
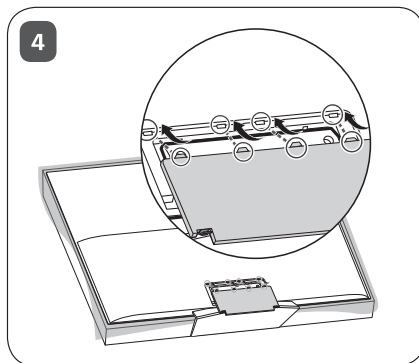
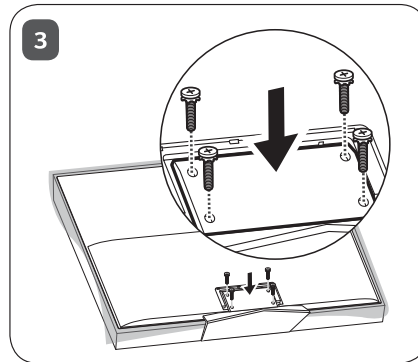
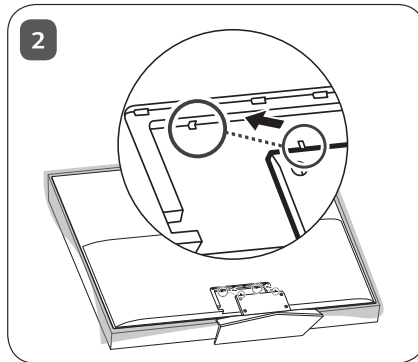
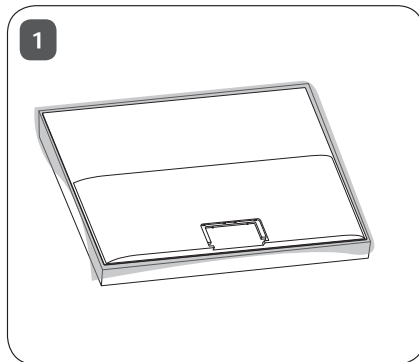

CAUTION

Image shown may differ from your TV

When attaching the stand to the TV set, place the screen facing down on a cushioned table or flat surface to protect the screen from scratches.

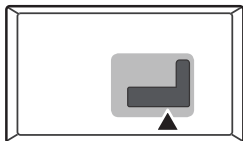

CAUTION

Image shown may vary depending on model.
All connection cables & devices shown in the picture are not included along with the TV set.

ANTENNA/
CABLE IN

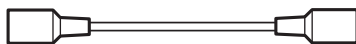

HDMI IN

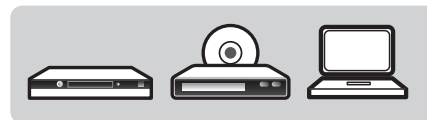
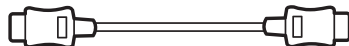

HDMI IN/ARC

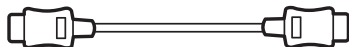

USB IN

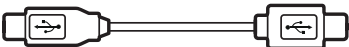

LAN

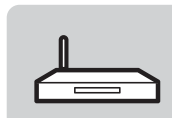
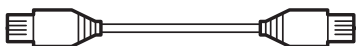
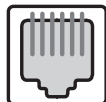

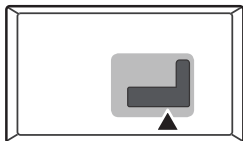

AUDIO OUT/ H/P OUT



OPTICAL DIGITAL AUDIO OUT

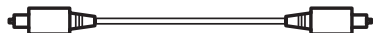

! NOTE

Image shown may vary depending on model.
All connection cables & devices shown in the picture are not included along with the TV set.

! NOTE

- Some USB Hubs may not work. If a USB device connected using a USB Hub is not detected, connect it to the USB port on the TV directly.
- Connect the external power source if your USB is needed.

! NOTE

- Do not look into to the it is optical output port, Looking at the laser beam may damage your vision.
- Audio with ACP (Audio Copy Protection) function may block digital audio output.

ARC (Audio Return Channel)

- An external audio device that supports SIMPLINK and ARC must be connected using HDMI IN/ARC port.
- When connected with a high-speed HDMI cable, the external audio device that supports ARC outputs SPDIF audio without additional audio cable and supports the SIMPLINK function.

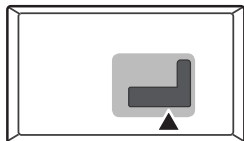

CAUTION

Image shown may vary depending on model.
All connection cables & devices shown in the picture are not included along with the TV set.

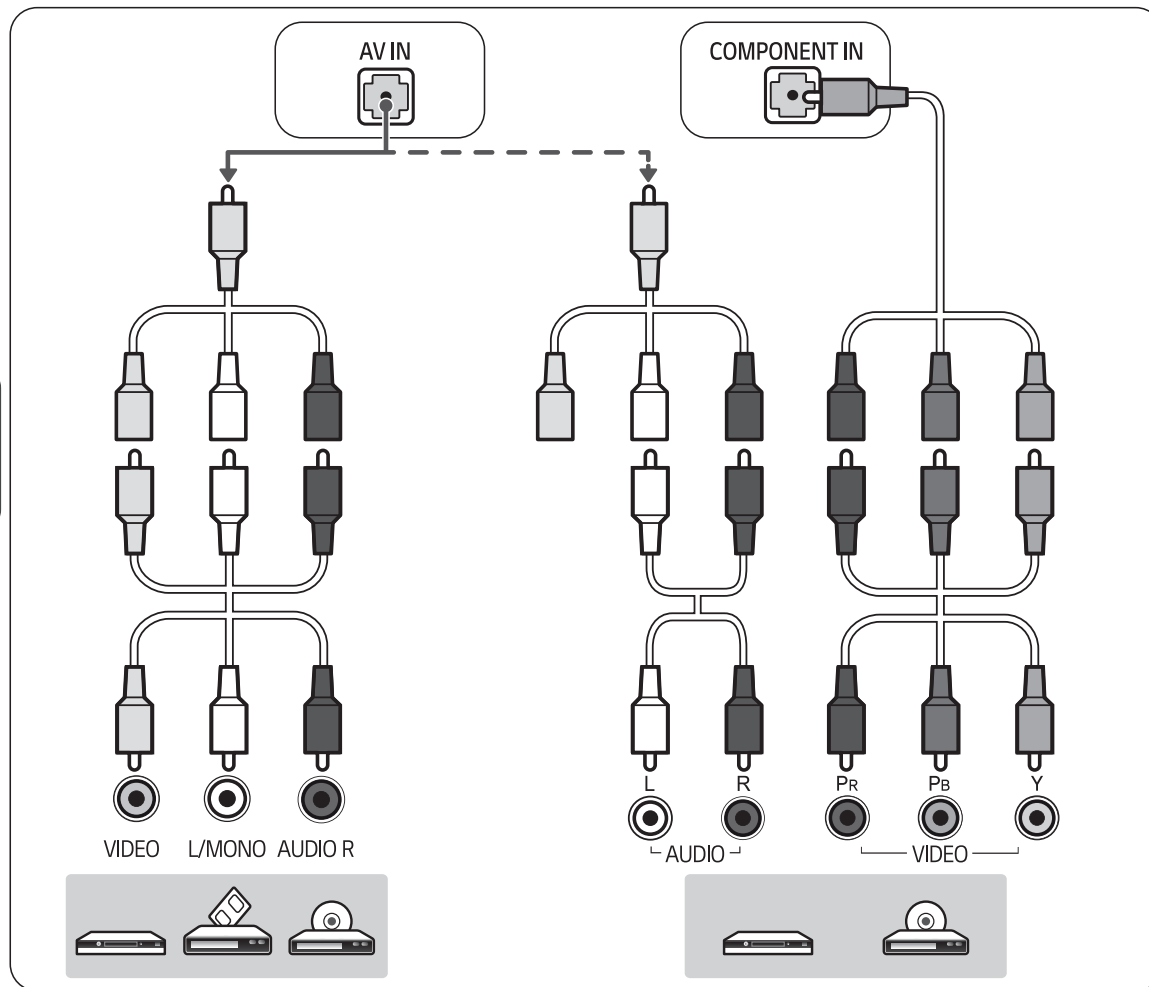

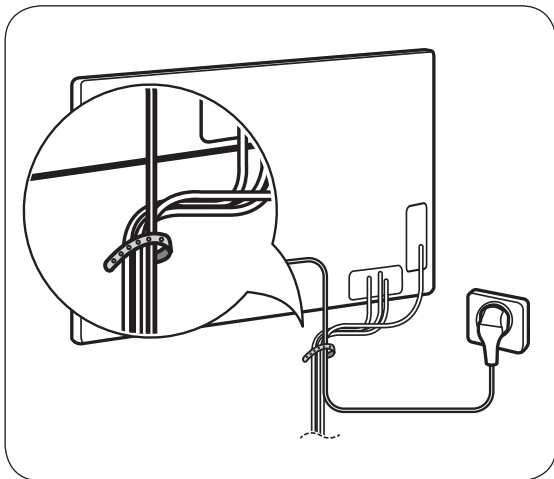

NOTE

Image shown may vary depending on model.

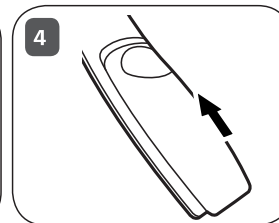
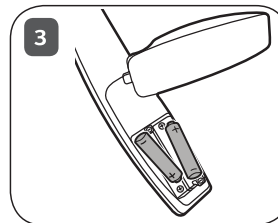
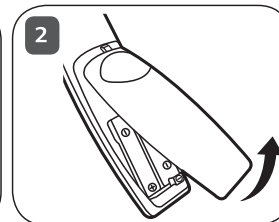
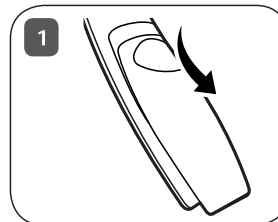

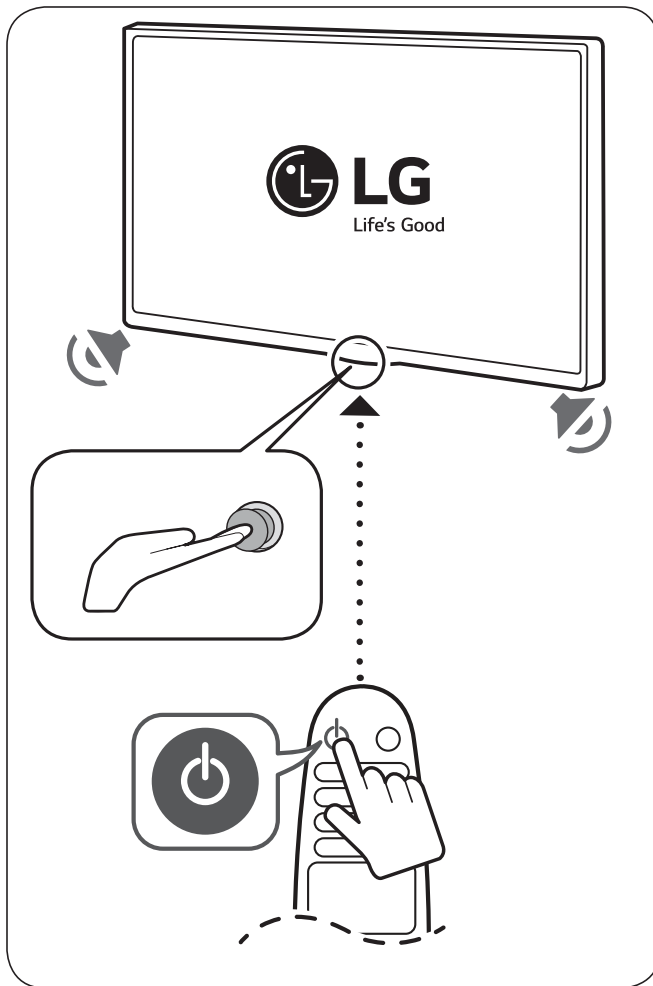

NOTE

Image shown may vary depending on model.

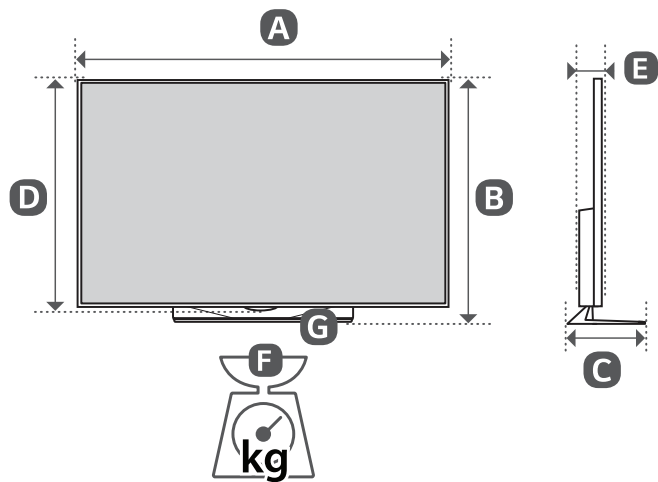

	A (mm)	B (mm)	C (mm)	D (mm)	E (mm)	F (kg)	F - G (kg)
OLED55B7T-T OLED55B7V-T OLED55B7Y-T	1229	759	225	708	48.6	20.5	17.2
OLED65B7T-T OLED65B7V-T OLED65B7Y-T	1451	882	225	831	48.6	26.4	23.1
Power requirement					AC 100-240 V ~ 50 / 60 Hz		

**NOTE**

Image shown may vary depending on model.

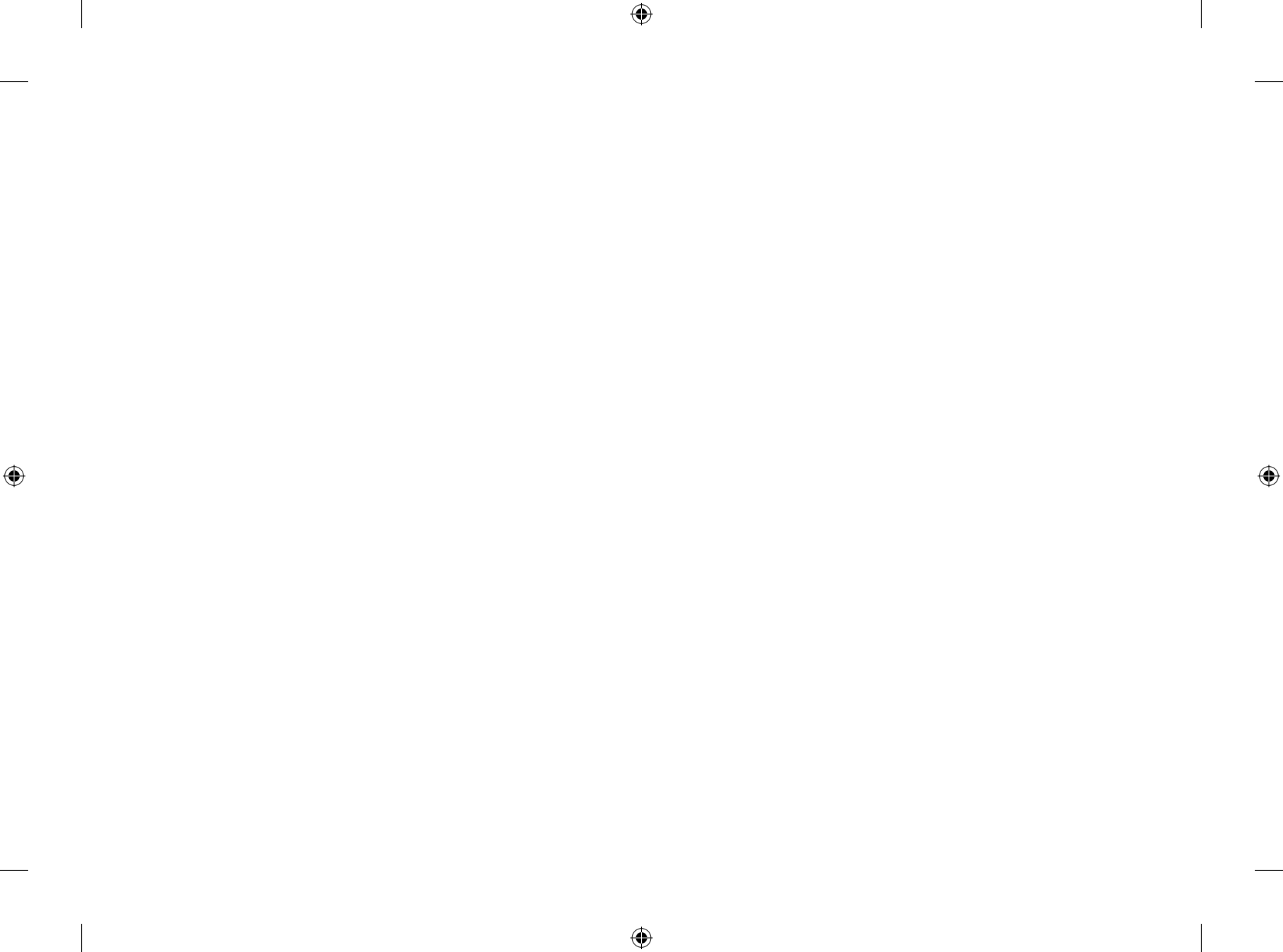

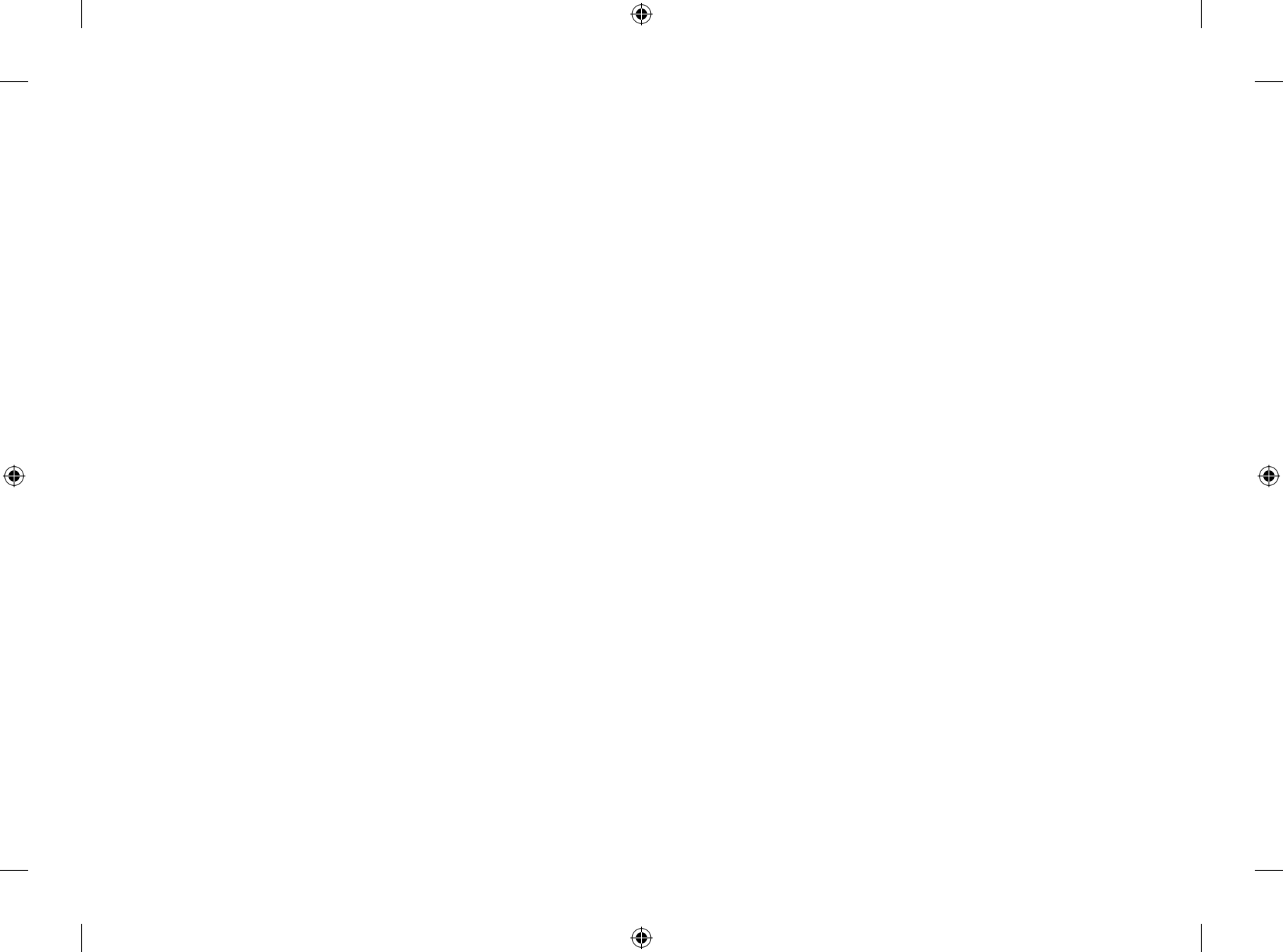



IN002043