

## Additional Information

### Specifications

Power Requirements	Refer to the main label on the unit.
Power Consumption	Refer to the main label on the unit. Networked standby : 0.5 W (If all network ports are activated.)
Dimensions (W x H x D)	Approx. 330 mm x 815 mm x 302 mm
Net Weight	Approx. 16.8 kg
Bus Power Supply (USB)	5 V  500 mA
Amplifier (Total RMS output power)	1,000 W

Design and specifications are subject to change without notice.

### Caution

- Connect the power cord to wall outlet directly if possible. Or when you use an extension cable, it is highly recommended to use an extension cable of 110 V / 15 A or 230 V / 15 A, otherwise the unit may not operate properly because of the lack of power supply.
- Do not overload the extension cord with excessive electrical load.

### Note

- Do not look directly at the light emitting part when the LIGHTING is turned on.
- If the illumination brightness is glaring, switch on the room lights or turn off the LIGHTING of the unit.

### How to disconnect the wireless network connection or the wireless device

Turn off the unit by pressing the power button for more than 5 seconds.

### Replacement of battery

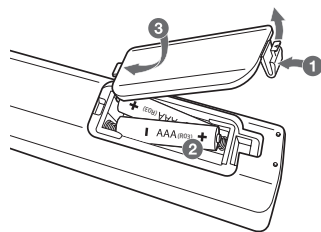

## SIMPLE MANUAL

# Mini Hi-Fi Audio

To view the instructions of advanced features, visit <http://www.lg.com> and then download Owner's Manual. Some of the content in this manual may differ from your unit.

MODEL  
OM7560



[www.lg.com](http://www.lg.com)



## Top panel

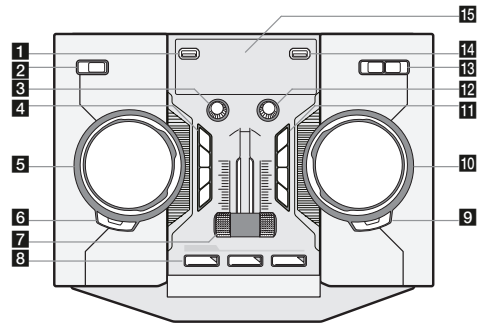

- 1** USB 1 Port  
You can play or record sound files by connecting the USB device.
- 2** (Standby/On)
- 3** MIC. (Microphone volume)  
Controls microphone's volume.
- 4** VOICE CANCELLER  
- You can enjoy the function while playing the music, by reducing singer vocal of music in the various source.  
Press to switch this mode on or off.  
**KEY CHANGER (b/#)**  
Changes the key to suit your vocal range.
- LIGHTING / PARTY LINK**  
- Turns on/off the lighting effects.  
- Press and hold to select the PARTY LINK.
- 5** SCRATCH / LEVEL / SYNC SET  
Turn clockwise or counterclockwise to make Scratch sound.  
/ Adjust DJ EFFECT level. / Sets Delay value in PARTY LINK mode.
- 6** DJ EFFECT  
Selects DJ EFFECT mode.  
**USER EQ**  
Selects the sound effect created by your own.
- 7** PARTY THRUSTER  
Slide the lever to create a party atmosphere.
- 8** CLUB, DRUM, USER (DJ PRO)  
Selects CLUB, DRUM or USER sound effect to mix.  
(If you want to use USER, you have to register a source with "Music Flow Bluetooth" app.)  
**1, 2, 3** (DJ PRO PAD)  
Press a desired sound pad.

- 9** SEARCH  
Moves to folder or file in selection mode.  
**OK**  
Selects a folder when searching a file.
- 10** & SEARCH (Skip/Search)  
- Searches a folder or a file.  
- Searches for a section within a track/file.  
- Selects the radio stations.
- 11** (Play/Pause)  
- Starts or pauses playback.  
- Selects Stereo/Mono.  
 (Stop)  
Stops playback or cancels DELETE function.  
 (Open/Close)  
Opens and closes the disc tray.
- REGION EQ / BASS BLAST**  
- Chooses region equalizer.  
- Press and hold to select BASS effect directly.
- 12** VOL. (Volume)  
Adjusts speaker volume.
- 13** USB REC / DEMO  
Records to USB. / Shows Demo mode.  
**F (Function) / WIRELESS LINK**  
- Selects the function and input source.  
- Press and hold for 3 seconds to select WIRELESS PARTY LINK mode.
- 14** USB 2 Port  
You can play or record sound files by connecting the USB device.
- 15** Display window

## Front panel / Rear panel

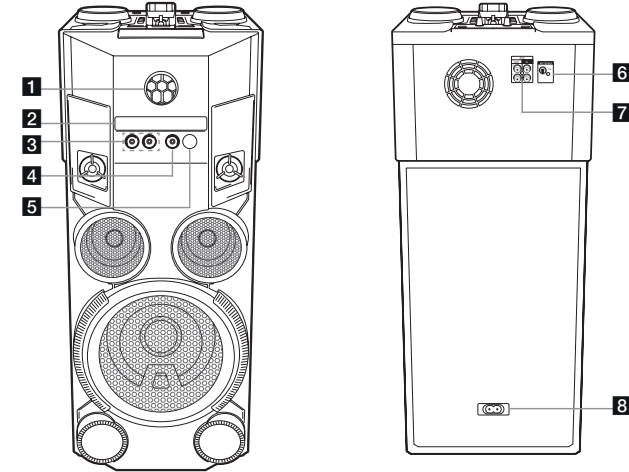

- 1** DANCE LIGHTING (Lighting ball)  
- Shows the various lighting patterns and color.  
- You can control angle up and down with your finger.
- 2** Disc tray
- 3** MIC (Microphone) 1 / 2 jack
- 4** PORT. IN
- 5** Remote sensor

- 6** ANTENNA (FM)
- 7** AUX IN / OUT
- 8** AC in socket

### Controller App



Download the **Music Flow Bluetooth** App to your device.

### LG Sound Sync (Wireless)



For more information, download the online owner's manual. <http://www.lg.com>