

Quick Start Guide

LED TV
LH60**

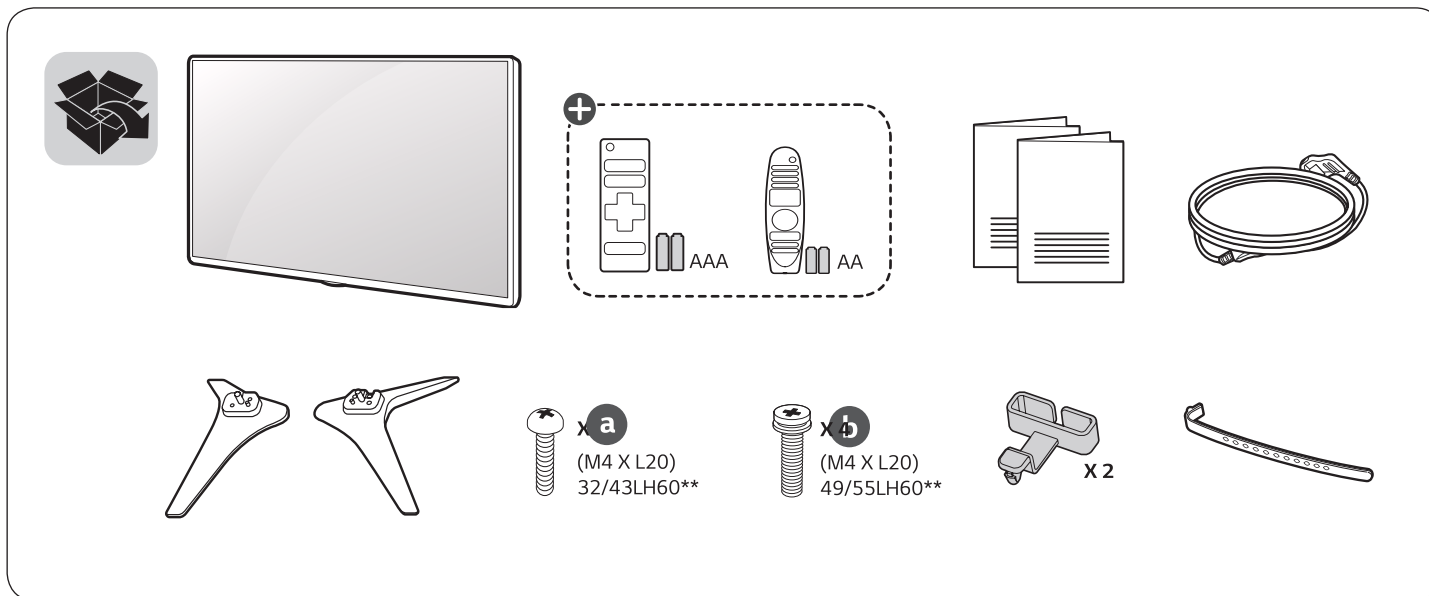

*Images may vary depending on models.

⊕ : Depending on model

Unpacking

Check your product box for the following items. If there are any missing accessories, contact the local dealer where you purchased your product. The illustrations in this manual may differ from the actual product and item.



www.lg.com

P/NO : MFL69446111(1601-REV00)



English

- Read **Safety and Reference**.
- For the power supply and power consumption, refer to the label attached to the product.

USING THE USER GUIDE



Press the (🏠) button
To access home button.

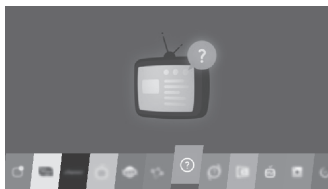

Navigate & Select
User Guide.



Refer User Guide for
Detail information

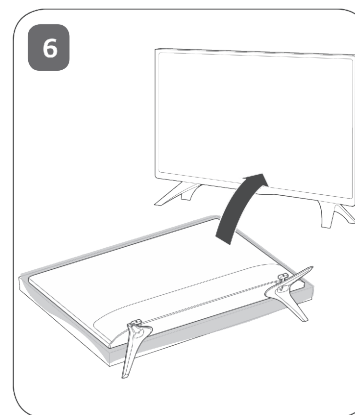
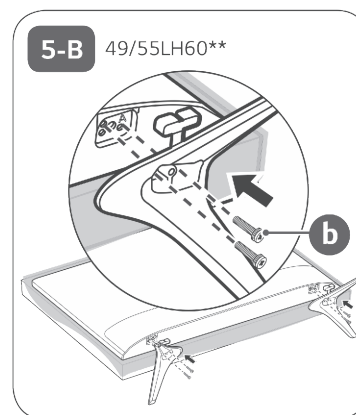
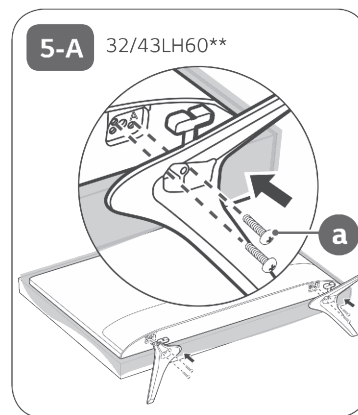
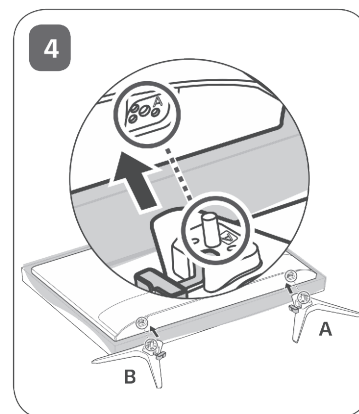
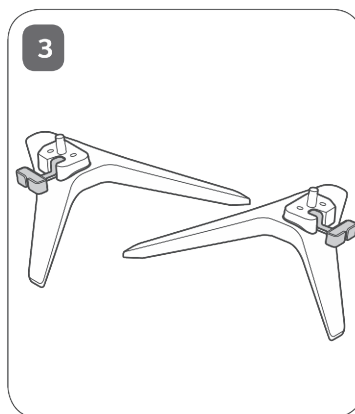
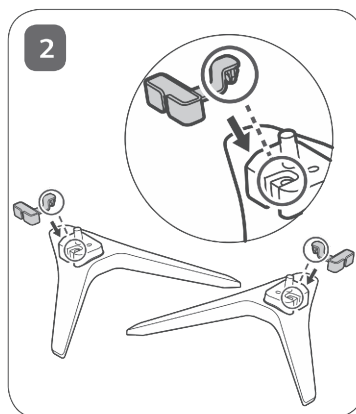

CAUTION

Image shown may differ from your TV

When attaching the stand to the TV set, place the screen facing down on a cushioned table or flat surface to protect the screen from scratches.

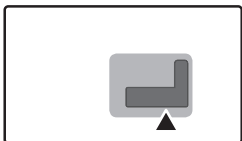

ANTENNA/
CABLE IN

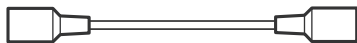

HDMI IN

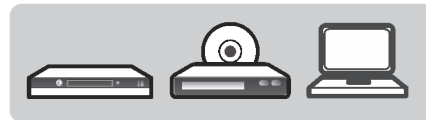
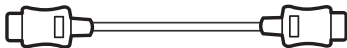

HDMI IN/ARC

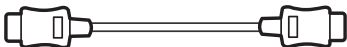

USB IN



LAN

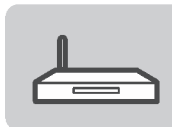
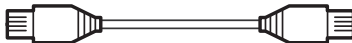
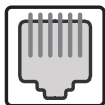

NOTE

Image shown may vary depending on model.
All connection cables & devices shown in the picture are not included
along with the TV set.

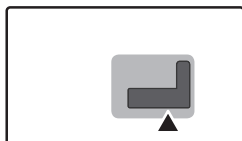

H/P OUT



OPTICAL DIGITAL
AUDIO OUT



⊕ : Depending on model

ARC (Audio Return Channel)

- An external audio device that supports SIMPLINK and ARC must be connected using HDMI IN 2 (ARC) port.
- When connected with a high-speed HDMI cable, the external audio device that supports ARC outputs SPDIF audio without additional audio cable and supports the SIMPLINK function.

! NOTE

Image shown may vary depending on model.
All connection cables & devices shown in the picture are not included along with the TV set.

! NOTE

Some USB Hubs may not work. If a USB device connected using a USB Hub is not detected, connect it to the USB port on the TV directly.
Connect the external power source if your USB is needed.

! NOTE

- Headphone impedance : 16Ω
- Max audio output of headphone : 0.627 mW to 1.334mW
- Headphone jack size: 0.35 cm

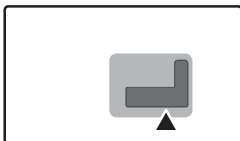

NOTE

Image shown may vary depending on model.
All connection cables & devices shown in the picture are not included
along with the TV set.

COMPONENT IN

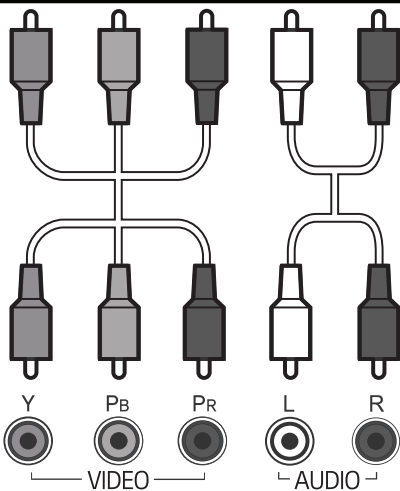
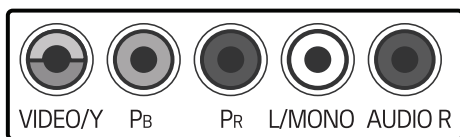

AV IN

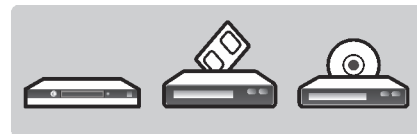
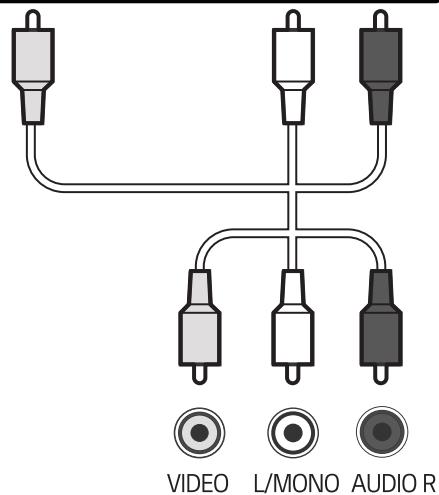
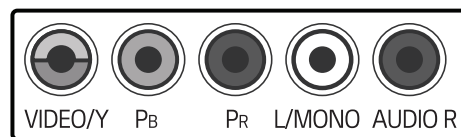

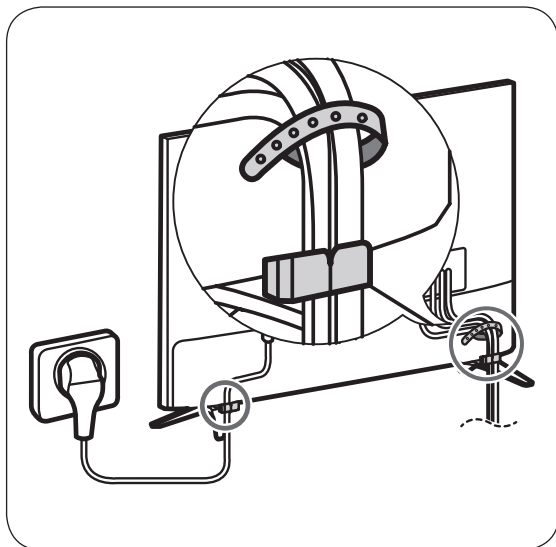

! NOTE

Image shown may vary depending on model.

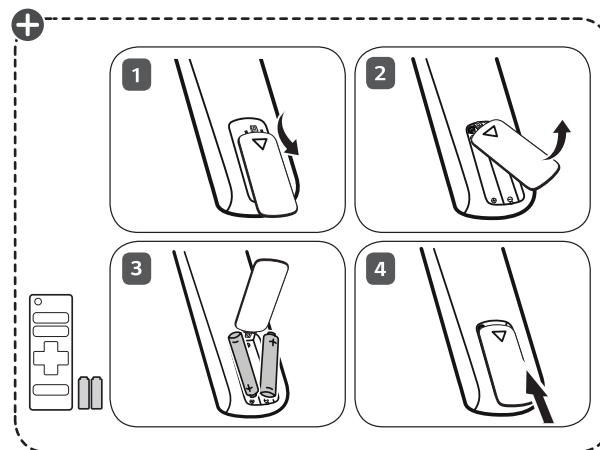
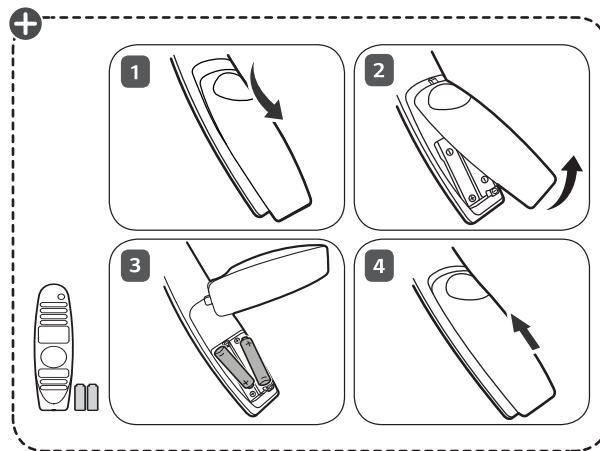

+ : Depending on model

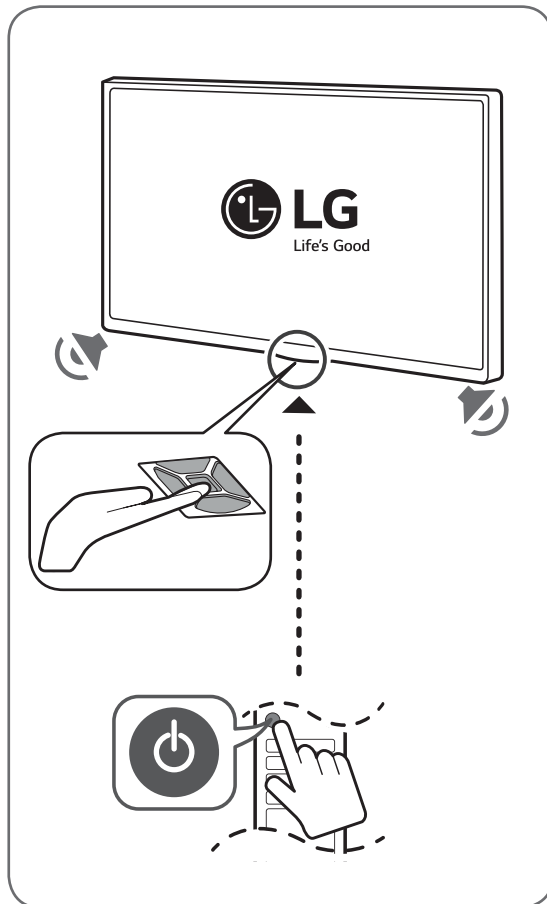

NOTE

Image shown may vary depending on model.

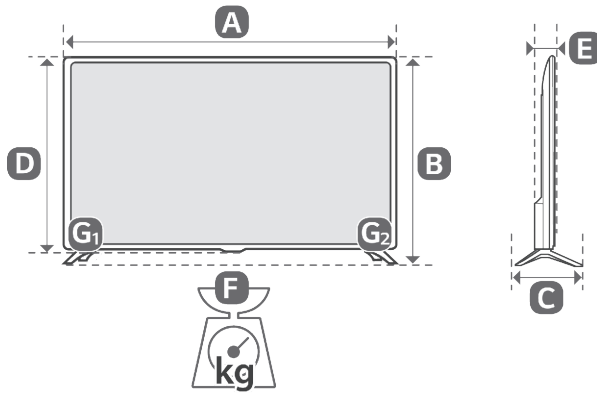

	A (mm)	B (mm)	C (mm)	D (mm)	E (mm)	F (kg)	F - (G ₁ + G ₂) (kg)
32LH600B-TB 32LH600D-TB 32LH601D-TC 32LH602D-TD 32LH602U-TD 32LH602Z-TD 32LH604D-TB 32LH604U-TB 32LH604Z-TB	733	483	170	436	76.3	5.08	4.94
32LH600T-TB 32LH601T-TC 32LH602T-TD 32LH604T-TB	733	483	170	436	76.3	5.46	5.32

Power requirement	AC 100-240 V ~ 50 / 60 Hz
-------------------	---------------------------

NOTE

Image shown may vary depending on model.



	A (mm)	B (mm)	C (mm)	D (mm)	E (mm)	F (kg)	F - (G ₁ + G ₂) (kg)
43LH600T-TB 43LH601T-TC 43LH602T-TD 43LH600V-TB 43LH602V-TD 43LH600Y-TB 43LH602Y-TD	974	620	199	571	79.4	9.45	9.25
49LH600T-TB 49LH601T-TC 49LH602T-TD 49LH600V-TB 49LH602V-TD 49LH600Y-TB 49LH602Y-TD	1107	702	216	645	79.4	12.1	11.84
55LH600T-TB 55LH601T-TC 55LH602T-TD 55LH600V-TB 55LH602V-TD 55LH600Y-TB 55LH602Y-TD	1241	775	216	720	63.0	16.6	16.34

Power requirement

AC 100-240 V ~ 50 / 60 Hz

! NOTE

Image shown may vary depending on model.





ML694611