



SIMPLE MANUAL

Micro Hi-Fi Audio

To view the instructions of advanced features,
visit <http://www.lg.com> and then download Owner's Manual.
Some of the content in this manual may differ from your unit.

MODEL
CM2760



MFL70021523

www.lg.com

Copyright © 2019 LG Electronics Inc. All Rights Reserved.

ENGLISH

DEUTSCH

ESPAÑOL

FRANÇAIS

ITALIANO

PORTUGUÊS

ČESKY

SLOVENČINA

ΕΛΛΗΝΙΚΑ

POLSKI



Front Panel

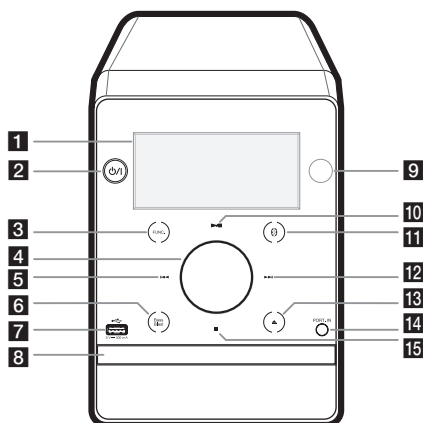

- 1 Display window
- 2 **⏻/I** (Power) : Switches the unit ON or OFF.
- 3 **FUNC.** : Selects the function or input source.
- 4 Adjusts volume of speaker.
- 5 **⏮** (Skip/Search) : Searches backward. / Skips to the previous track/file. / Selects the radio stations.
- 6 **Bass Blast** : Selects BASS effect.
- 7 **USB** : Plays the audio files by connecting the USB device.
- 8 Disc tray
- 9 Remote sensor
- 10 **▶/II** (Play/Pause) : Starts or pauses playback. / Selects Stereo/Mono.
- 11 **📶** : Changes input source to the **Bluetooth**.
- 12 **⏭** (Skip/Search) : Searches forward. / Skips to the next track/file. / Selects the radio stations.
- 13 **⬆** : Opens or closes the disc tray.
- 14 **PORT. IN** : Connects to a Portable device.
- 15 **■** (Stop) : Stops playback.

Rear Panel

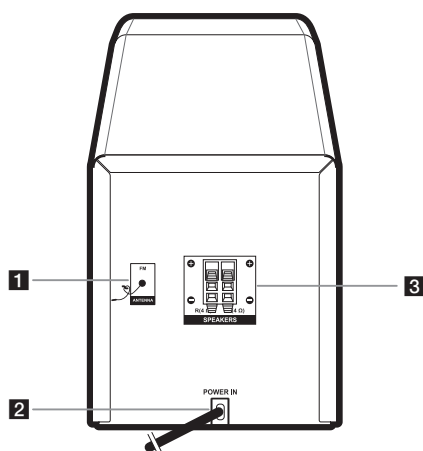

- 1 **FM ANTENNA**
- 2 **POWER IN**
- 3 **SPEAKERS (L/R)** terminals

Controller App



Download the **Music Flow Bluetooth** App to your device.

LG Sound Sync (Wireless)



For more information, download the online owner's manual. <http://www.lg.com>

Speaker Connection

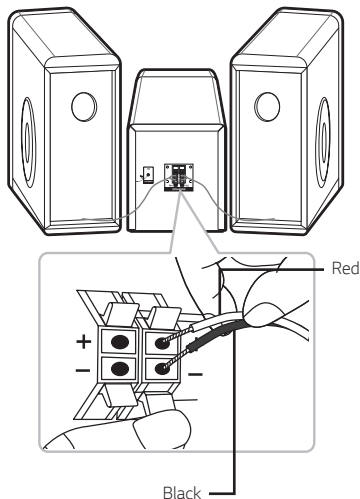

How to disconnect the wireless network connection or the wireless device

Turn off the unit by pressing the power button for more than 5 seconds.

Replacement of battery

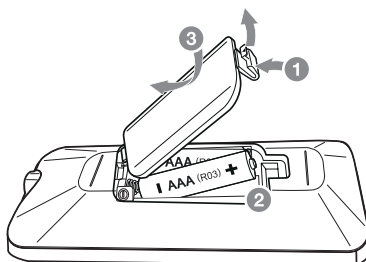

Additional Information

Specifications

Power Requirements	Refer to the main label on the unit.
Power Consumption	Refer to the main label on the unit.
	Networked standby : 0.5 W (If all network ports are activated.)
Dimensions (W x H x D)	Approx. 170 mm x 230 mm x 276 mm
Bus Power Supply (USB)	5 V  500 mA
Amplifier (Total RMS output power)	160 W RMS

Design and specifications are subject to change without notice.

Declaration of Conformity



Hereby, LG Electronics declares that the radio equipment type MICRO HI-FI SYSTEM is in compliance with Directive 2014/53/EU. The full text of the EU declaration of conformity is available at the following internet address:

<http://www.lg.com/global/support/cedoc/cedoc#>

For consideration of the user, this device should be installed and operated with a minimum distance of 20 cm between the device and the body.

Frequency range	Output power (Max.)
2402 to 2480 MHz	10 dBm

