



SIMPLE MANUAL

Streaming Blu-ray Disc™ / DVD Player

To view the instructions of advanced features,
visit <http://www.lg.com> and then download Owner's Manual.
Some of the content in this manual may differ from your unit.

MODEL
BPM35

LG Customer Information Center	
1-800-243-0000	USA, Consumer
1-888-865-3026	USA, Commercial
Register your product Online!	
www.lg.com	



www.lg.com
Printed in China
Copyright © 2017-2021 LG Electronics Inc. All Rights Reserved.

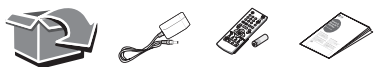

Front Panel

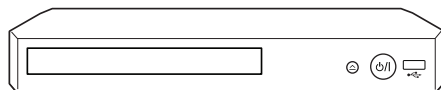

- Disc Tray Open / Close
- Power On / Off
- USB Port** Connect a USB device.

1 TV Connection

- 1 Connect the HDMI jack on the player to the HDMI jack on the TV using a HDMI cable.

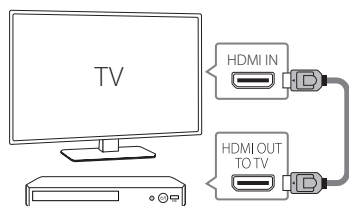

- 2 Set the input selector to HDMI on the TV.
- 3 Follow the instructions on the TV screen using remote control.



To enjoy online services, the player should be connected to internet through wired or wireless connection.

Controller App



Download the **LG AV Remote** App to your device.

Rear Panel

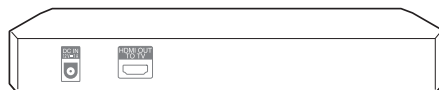

- DC IN 12V \equiv 1 A** Connect to AC Adaptor.
- HDMI OUT (TO TV)** Connect to TV.

2 Home Menu

After initial setup, Home menu appears on the TV screen. Enjoy various functions on the player.

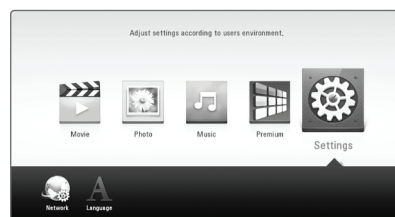

Additional Information

Specification

AC adapter	<ul style="list-style-type: none"> Model : WA-12M12FU Manufacturer : Asian Power Devices Inc. Input : 100-120V~ 50-60 Hz 0.5 A Max. Output : 12 V \equiv 1 A
	<ul style="list-style-type: none"> Model : AD2071F10 Manufacturer : PI ELECTRONICS Input : 100 - 120 V~, 50 / 60 Hz 0.3 A Max. Output : 12 V \equiv 1 A
Dimensions (W x H x D)	Approx. 270 mm x 43 mm x 195 mm (10.62 inch x 1.69 inch x 7.68 inch)
Net Weight (Approx.)	0.85 kg (1.87 lb)
Bus Power Supply (USB)	5 V \equiv 500 mA

Design and specifications are subject to change without notice.

Replacement of battery

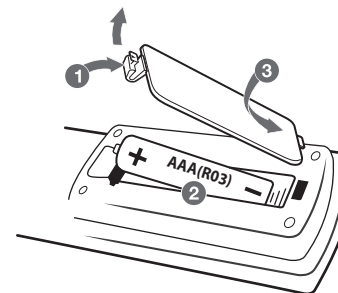

OPEN SOURCE SOFTWARE NOTICE INFORMATION

To obtain the source code under GPL, LGPL, MPL, and other open source licenses, that is contained in this product, please visit <http://opensource.lge.com>.

In addition to the source code, all referred license terms, warranty disclaimers and copyright notices are available for download.

LG Electronics will also provide open source code to you on CD-ROM for a charge covering the cost of performing such distribution (such as the cost of media, shipping, and handling) upon email request to opensource@lge.com. This offer is valid for a period of three years after our last shipment of this product. This offer is valid to anyone in receipt of this information.

FCC Compliance Statement

This equipment has been tested and found to comply with the limits for a Class B digital device, pursuant to Part 15 of the FCC Rules. These limits are designed to provide reasonable protection against harmful interference in a residential installation. This equipment generates, uses, and can radiate radio frequency energy and, if not installed and used in accordance with the instructions, may cause harmful interference to radio communications. However, there is no guarantee that interference will not occur in a particular installation. If this equipment does cause harmful interference to radio or television reception, which can be determined by turning the equipment off and on, the user is encouraged to try to correct the interference by one or more of the following measures:

- Reorient or relocate the receiving antenna.
- Increase the separation between the equipment and the receiver.
- Connect the equipment to an outlet on a circuit different from that to which the receiver is connected.
- Consult the dealer or an experienced radio/TV technician for help.

This device complies with part 15 of the FCC Rules. Operation is subject to the following two conditions: (1) this device may not cause harmful interference and (2) this device must accept any interference received, including interference that may cause undesired operation. Any changes or modifications in construction of this device which are not expressly approved by the party responsible for compliance could void the user's authority to operate the equipment.

FCC RF Radiation Exposure Statement: This equipment complies with FCC radiation exposure limits set forth for an uncontrolled environment. This transmitter must not be co-located or operating in conjunction with any other antenna or transmitter.

This equipment should be installed and operated with minimum distance 20 cm (7.8 inches) between the antenna and your body. Users must follow the specific operating instructions for satisfying RF exposure compliance.

Supplier's Declaration of Conformity

Trade Name	LG
Responsible Party	LG Electronics USA, Inc.
Address	111 Sylvan Avenue, North Building Englewood Cliffs, New Jersey 07632
Email	lg.environmental@lge.com

