

**Specification****Power requirements**

- Refer to the main label.

**Power consumption**

- Refer to the main label.

Dimensions (W x H x D): Approx. 404.0 mm x 916.0 mm x 428.0 mm

Bus Power Supply (USB): 5 V  500 mA

Amplifier (Total RMS Output power): 1,000 W RMS

Operating Temperature: 5 °C - 40 °C

Operating Humidity: 5 % - 80 % RH

Ingress Protection: IPX4

- Liquid: Protected against splashing water.
- Do not leave the unit on an unstable place. It may fall down because of the vibration of the sound.

**CAUTION** when using this product in environments of low humidity.

- It may cause static electricity in environments of low humidity.
- It is recommended to use this product after touching any metal object which conducts electricity.



## SIMPLE MANUAL

# Portable Bluetooth Speaker

---

XL9T



MFL72017123

2309\_Rev01

[www.lg.com](http://www.lg.com)

Copyright © 2023-2024 LG Electronics Inc. All Rights Reserved.

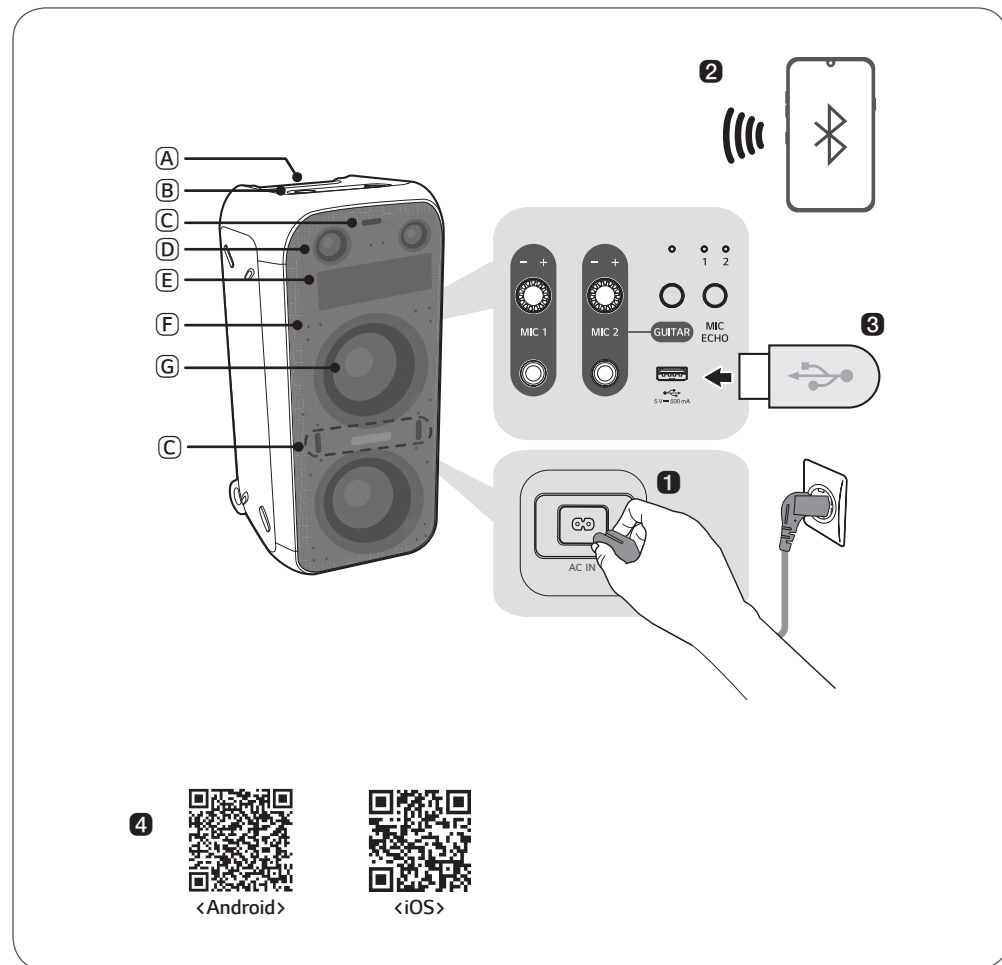

## ENGLISH Installing and Using the Product

Please read this manual carefully before operating your set and retain it for future reference. To view the instructions of advanced features, visit <http://www.lg.com> or scan QR code and then download Owner's Manual. Some of the content in this manual may differ from your product.



- (A) Handle
- (B) Controls
- (C) Flash Lighting
- (D) Speaker (Tweeter)
- (E) Pixel Art Display
- (F) Sparkle Lighting
- (G) Speaker (Woofer) / Multi Color Ring Lighting

### 1 Connect the power cord to the product by opening the rear cover

### 2 Connecting the Speaker to a Smartphone via Bluetooth

- 1 Press the **Power** (⏻) button to turn on the product.
- 2 Press the **Function** (⏮) button on the product repeatedly to select the BT function. The BT LED blinks.
- 3 Tap the **Settings** (⚙️) button on your smartphone and select **Bluetooth**. Turn on the **Bluetooth** function. (⏻ Off > ⏻ On)
- 4 From the list of smartphone devices, find and tap on "LG-XL9T(XX)."
- 5 Once the smartphone is connected to the product via **Bluetooth**, the BT LED will turn on. Play a desired track in the music app on your smartphone.

### 3 Playing Music from the USB

- 1 Open the back cover of the product and plug the USB storage device into the USB terminal.
- 2 Press the **Power** (⏻) button to turn on the product.
- 3 Press the **Function** (⏮) button on the product repeatedly to select the USB function. The USB LED will turn on.
- 4 Press the **Play/Pause** (⏮) button to enjoy the music.

### 4 Connecting to the LG XBOOM App

- 1 Find the **LG XBOOM app** on the Google Play or App Store and install it on your smartphone.
- 2 Run the **LG XBOOM app** and use its functions. (EQ, Wireless Party Link, Pixel Art Display, Lighting, Setting etc.)

### 5 Power Saving

If there is no playback or button input for 15 minutes, the product turns off automatically. On the **LG XBOOM app**, you can enable or disable [Auto Power Management].

- Design and specifications are subject to change without notice.