



FCC Compliance Statement

This equipment has been tested and found to comply with the limits for a Class B digital device, pursuant to Part 15 of the FCC Rules. These limits are designed to provide reasonable protection against harmful interference in a residential installation. This equipment generates, uses, and can radiate radio frequency energy and, if not installed and used in accordance with the instructions, may cause harmful interference to radio communications. However, there is no guarantee that interference will not occur in a particular installation. If this equipment does cause harmful interference to radio or television reception, which can be determined by turning the equipment off and on, the user is encouraged to try to correct the interference by one or more of the following measures:

- Reorient or relocate the receiving antenna.
- Increase the separation between the equipment and the receiver.
- Connect the equipment to an outlet on a circuit different from that to which the receiver is connected.
- Consult the dealer or an experienced radio/TV technician for help.

This device complies with part 15 of the FCC Rules. Operation is subject to the following two conditions: (1) this device may not cause harmful interference and (2) this device must accept any interference received, including interference that may cause undesired operation. Any changes or modifications in construction of this device which are not expressly approved by the party responsible for compliance could void the user's authority to operate the equipment.

FCC RF Radiation Exposure Statement: This equipment complies with FCC radiation exposure limits set forth for an uncontrolled environment. This transmitter must not be co-located or operating in conjunction with any other antenna or transmitter.

This equipment should be installed and operated with minimum distance 20 cm (7.8 inches) between the antenna and your body. Users must follow the specific operating instructions for satisfying RF exposure compliance.

FCC Radio Frequency Interference Requirements:

High power radars are allocated as primary users of the 5.25 to 5.35 GHz and 5.65 to 5.85 GHz bands. These radar stations can cause interference with and/or damage this device. This device cannot be co-located with any other transmitter.

Responsible Party:

LG Electronics USA, Inc.
1000 Sylvan Avenue
Englewood Cliffs, NJ 07632
Tel: 1-800-243-0000



SIMPLE MANUAL
Wireless
Sound Bar

Please read this manual carefully before operating your set and retain it for future reference. To view the instructions of advanced features, visit <http://www.lg.com> and then download Owner's Manual. Some of the content in this manual may differ from your unit.

LG Customer Information Center	
1-800-243-0000	USA, Consumer
1-888-865-3026	USA, Commercial
Register your product Online!	
www.lg.com	

MODELS
LAS485B SK3B



Printed in China

www.lg.com
Copyright © 2018 LG Electronics Inc. All Rights Reserved.



Front Panel

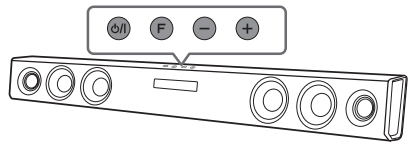

- ϕ/II Standby / On
- F Selects Function
- + Adjusts Volume

Rear Panel

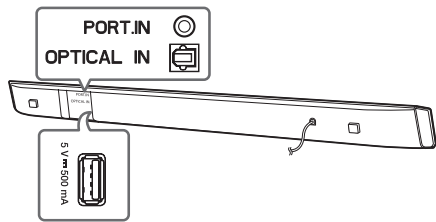

- PORT. IN Connect to a Portable device
- OPTICAL IN Connect to an Optical device

1 Subwoofer Connection

Place the wireless subwoofer near the sound bar and follow steps below.

- 1 Connect the power cord of wireless subwoofer to the outlet.
- 2 Turn on the sound bar :
The sound bar and wireless subwoofer will be **automatically** connected. The subwoofer's yellow - green LED turns on.

Subwoofer Connection Manually

- 1 Reset the Subwoofer
If the yellow - green LED on the subwoofer blinks rapidly, skip this step and go to 2
 - Press and hold **PAIRING** button for 5 seconds.
 - The LED lights up alternately in red and yellow - green.
 - Unplug the power cord. After the LED turns off completely, plug in the power cord again.

When the reset is completed, the subwoofer's yellow - green LED blinks rapidly.

- 2 Reset the sound bar
 - Adjust volume to minimum until the red LED on the sound bar lights up for a while.
 - Press and hold **MUTE** (Mute) button on the remote control for 3 seconds.
 - The red LED on the sound bar blinks rapidly.
 - Turn the sound bar's power off and on while the subwoofer's yellow - green LED blinks.

When the connection is completed, you can see the yellow - green LED on the subwoofer.



Keep the sound bar and the subwoofer away from the following (ex. wireless router, microwave oven, etc.) over 1m (3.3 ft) to prevent wireless interference.

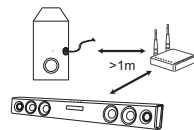

2 TV Connection

- 1 Connect the the sound bar to the TV using Optical cable.
- 2 Set up [External Speaker (Optical)] on your TV setting menu.

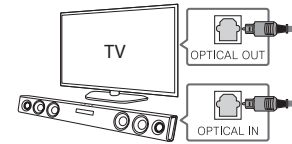

Additional Device Connection

- 1 Connect to the external device as follows.

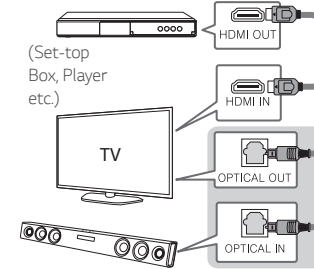

- 2 Set the input source by pressing **F** on the remote control or unit repeatedly.

Remote control



- ASC/BASS BLAST/CINEMA: Selects sound effect.
- NIGHT ON/OFF: Turns down the volume at night.
- WOOFER LEVEL +/-: Adjusts the volume level of subwoofer.
- AUTO POWER ON/OFF: Automatically turns on by an input source.

Replacement of battery

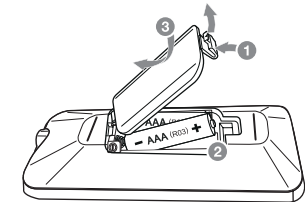

Additional Information

Specification

Power requirements	Refer to the main label.
Power consumption	Refer to the main label.
Dimensions (W x H x D)	Approx. 950 mm x 71 mm x 47 mm (37.4 inch x 2.8 inch x 1.9 inch)
Amplifier (Total RMS Output power)	300 W RMS

Design and specifications are subject to change without notice.