



# INSTALLATION MANUAL

# AIR CONDITIONER

Please read this installation manual completely before installing the product. Installation work must be performed in accordance with the national wiring standards by authorized personnel only. Please retain this installation manual for future reference after reading it thoroughly.

## HVAC Controller(ACP 5)

PACP5A000

Original instructions



MFL69981502  
Rev.08\_102025



[www.lg.com](http://www.lg.com)

Copyright © 2018 - 2025 LG Electronics Inc. All Rights Reserved.

SLOVENČINA	PORTUGUÊS	ENGLISH
SLOVENŠČINA	MAGYAR	ITALIANO
LATVIŠĻVALODA	БЪЛГАРСКИ	ESPAÑOL
LIEUVUJ KALBA	SRPSKI	FRANÇAIS
GAEILGE	HRVATSKI	DEUTSCH
МАКЕДОНСКИ	SVENSKA	ΕΛΛΗΝΙΚΑ
SHQIP	NORSK	ČEŠTINA
BOSANSKI	DANSK	NEDERLANDS
	EESTI KEEL	POLSKI
	MALTI	LIMBA ROMÂNĂ

## SAFETY INSTRUCTIONS

The following safety guidelines are intended to prevent unforeseen risks or damage from unsafe or incorrect operation of the appliance.

The guidelines are separated into 'WARNING' and 'CAUTION' as described below.

 This symbol is displayed to indicate matters and operations that can cause risk.  
Read the part with this symbol carefully and follow the instructions in order to avoid risk.

### **WARNING**

This indicates that the failure to follow the instructions can cause serious injury or death.

### **CAUTION**

This indicates that the failure to follow the instructions can cause the minor injury or damage to the product.

### **WARNING**

#### Installation

- To reinstall the product, please contact the dealer from where you purchased the product, or a service center.
  - Installation of the product by an unauthorised person may result in fire, electric shock, explosion, injury, or a malfunctioning of the product.
- Do NOT twist or damage the power cord.
  - Follow the below precautions properly; else it might result in a fire disaster, risk of incurring electric shock injuries or product malfunctioning.
- For electrical work, please contact the dealer from where you purchased the product, or a service center.
  - Follow the below precautions properly; else it might result in a fire disaster, risk of incurring electric shock injuries or product malfunctioning.

- Install the product in an area shielded from rain.
  - Follow the below precautions properly; else it might result in a fire disaster, risk of incurring electric shock injuries or product malfunctioning.
- Do NOT install the product in a humid area.
  - Follow the below precautions properly; else it might result in a fire disaster, risk of incurring electric shock injuries or product malfunctioning.
- For installation of the product, please contact the dealer from where you purchased the product, or a service center.
  - Installation of the product by an unauthorised person may result in fire, electric shock, explosion, injury, or a malfunctioning of the product.
- For electrical work, it is advisable for the electrician to refer the installation manual and specified circuit diagram.
  - Using an unsuitable cord, or having a non-professional work on the electricals may result in fire or electrical shock.
- Do NOT place the product near a fire source.
  - It may result in combustion.
- If the product is installed in a hospital or a communication base station, shield the product from electrical noise by providing sufficient protective equipment.
  - Protective equipment prevents the product from malfunctioning.
- Securely install the product.
  - If the product is not secured during installation, it may fall or malfunction.
- Read the manual thoroughly to correctly install the product.
  - Follow the below precautions properly; else it might result in a fire disaster, risk of incurring electric shock injuries or product malfunctioning.
- When wiring the product, do not use a non-standard cable, nor extend the cable excessively.
  - Follow the below precautions properly; else it might result in a fire disaster, risk of incurring electric shock injuries or product malfunctioning.

- Securely install the power cord and communication cable.
  - Follow the below precautions properly; else it might result in a fire disaster, risk of incurring electric shock injuries or product malfunctioning.
- Do NOT connect the power cord to the communication terminal.
  - Follow the below precautions properly; else it might result in a fire disaster, risk of incurring electric shock injuries or product malfunctioning.
- Do NOT install the product in an area near combustible gases.
  - Follow the below precautions properly; else it might result in a fire disaster, risk of incurring electric shock injuries or product malfunctioning.

### Operation

- Do NOT place a heavy object on the power cord.
  - Follow the below precautions properly; else it might result in a fire disaster, risk of incurring electric shock injuries, product malfunctioning or damage to property.
- Do NOT change or extend the power cord arbitrarily.
  - Follow the below precautions properly; else it might result in a fire disaster, risk of incurring electric shock injuries, product malfunctioning or damage to property.
- Use the cord specific to the product.
  - Using an unauthorised non-standard cord may result in a fire or electric shock.
- Do NOT use a heat device near the power cord.
  - Follow the below precautions properly; else it might result in a fire disaster, risk of incurring electric shock injuries, product malfunctioning or damage to property.
- Ensure that water never gets into the product.
  - Follow the below precautions properly; else it might result in a fire disaster, risk of incurring electric shock injuries, product malfunctioning or damage to property.
- Do NOT place any container with liquid on the product.
  - Follow the below precautions properly; else it might result in a fire disaster, risk of incurring electric shock injuries, product malfunctioning or damage to property.

- Do NOT touch the product with wet hands.
  - Follow the below precautions properly; else it might result in a fire disaster, risk of incurring electric shock injuries, product malfunctioning or damage to property.
- Use standard components.
  - Follow the below precautions properly; else it might result in a fire disaster, risk of incurring electric shock injuries, product malfunctioning or damage to property.
- If the product has been submerged in water, you should contact a service center.
  - Follow the below precautions properly; else it might result in a fire disaster, risk of incurring electric shock injuries, product malfunctioning or damage to property.
- Do NOT shock the product.
  - Follow the below precautions properly; else it might result in a fire disaster, risk of incurring electric shock injuries, product malfunctioning or damage to property.
- Do NOT store or use any combustible gas or flammable substances near the product.
  - Follow the below precautions properly; else it might result in a fire disaster, risk of incurring electric shock injuries, product malfunctioning or damage to property.
- Do NOT disassemble, repair, or revamp the product arbitrarily.
  - Follow the below precautions properly; else it might result in a fire disaster, risk of incurring electric shock injuries, product malfunctioning or damage to property.
- Children and the elderly should use the product under the supervision of a guardian.
  - Follow the below precautions properly; else it might result in a fire disaster, risk of incurring electric shock injuries, product malfunctioning or damage to property.
- The guardian should prevent children from accessing the product.
  - The product can be damaged or it may fall, causing injury to children.
- Note that the operating temperature range of the product is between 0 and 40 °C (32 and 104 °F).
  - If the product is used outside this range, the product may be severely damaged.

- Do NOT depress the switch or button using a sharp object.
  - Follow the below precautions properly; else it might result in a fire disaster, risk of incurring electric shock injuries, product malfunctioning or damage to property.
- Do NOT wire the product while it is turned ON.
  - It may cause a fire or electric shock.
- If the product sounds different or emanates an unpleasant odor, stop using the product.
  - Follow the below precautions properly; else it might result in a fire disaster, risk of incurring electric shock injuries, product malfunctioning or damage to property.
- Do NOT place a heavy object on the product.
  - Follow the below precautions properly; else it might result in a fire disaster, risk of incurring electric shock injuries, product malfunctioning or damage to property.
- Do NOT spray water on the product, or clean it with a water-soaked cloth.
  - Follow the below precautions properly; else it might result in a fire disaster, risk of incurring electric shock injuries, product malfunctioning or damage to property.
- Do NOT use the product for the preservation of animals and plants, precision instruments, art pieces, or for other special purposes.
  - Follow the below precautions properly; else it might result in a fire disaster, risk of incurring electric shock injuries, product malfunctioning or damage to property.
- Dispose the packing material safely.
  - Follow the below precautions properly; else it might result in a fire disaster, risk of incurring electric shock injuries, product malfunctioning or damage to property.

## CAUTION

### Installation

- Securely install the product in an area where the weight of the product can be supported.
  - The product may fall and be destroyed.

- Do NOT use the product where there is oil, steam, or sulfuric gas.
  - It may affect the product's performance, or damage it.
- Check the rated power capacity.
  - It may cause a fire, or a product malfunction.
- Be careful not to drop or damage the product when moving it.
  - The product may malfunction or the person may sustain an injury.
- Ensure that the cord is connected securely to protect the product from dew, water, or insects.
  - If a foreign substance gets inside, it may cause an electric shock or the product may malfunction.
- This appliance is not intended for use by persons (including children) with reduced physical, sensory or mental capabilities or lack of experience and knowledge, unless they have been given supervision or instruction concerning use of the appliance by a person responsible for their safety. Children should be supervised to ensure that they do not play with the appliance.
- Installation work must be performed in accordance with the national wiring standards by authorized personnel only. This equipment shall be provided with a supply conductor complying with the national regulation.
- The appliance is only to be used with the power supply unit provided with the appliance.
- The appliance must only be supplied at safety extra low voltage corresponding to the marking on the appliance.
- Do not install the unit in potentially explosive atmospheres.
- Means for disconnection must be incorporated in the fixed wiring in accordance with the wiring rules.

## Operation

- Do NOT clean the product with solvent based detergents; instead use cloth.
  - The use of a solvent-based detergent may cause a fire or deform the product.

- Do NOT touch the panel using a pointed or sharp object.
  - It can result in an electric shock, or the product may malfunction.
- Do NOT expose the product to a metal substance.
  - The product may malfunction.
- When sterilizing or disinfecting, stop using the product.
  - The product may work abnormally.
- Do NOT touch internal components of the product.
  - The product may malfunction.
- Check whether the product is in a proper condition after using the product for an extended period of time.
  - Deteriorating condition of the product, may cause injury to the user.
- Do NOT leave the product near a flower base, water bottle, or any other liquids.
  - It may cause a fire or electric shock.
- If the liquid crystal of the product is broken, please do NOT allow the product to come in contact with your skin (hands, face).
  - This may result in personal injury or property damage.
- This appliance can be used by children aged from 8 years and above and persons with reduced physical, sensory or mental capabilities or lack of experience and knowledge if they have been given supervision or instruction concerning use of the appliance in a safe way and understand the hazards involved. Children shall not play with the appliance. Cleaning and user maintenance shall not be made by children without supervision.
- The appliance shall be disconnected from its power source during service and when replacing parts.

## Disposal of Waste Batteries

- All batteries should be disposed separately from the municipal waste stream via designated collection facilities appointed by the government or the local authorities.
  - The correct disposal of your old batteries will help to prevent potential negative consequences for the environment, animal and human health.
  - For more detail information about disposal of your old batteries, please contact your city office, waste disposal service or the shop where you purchased the product. Also You can contact our LG Support Representative Call center from below Link  
[https://www.lg.com/sa\\_en/support/contact/telephon](https://www.lg.com/sa_en/support/contact/telephon)
- ✳ The above information applies only to Saudi Arabia.

## التخلص من مخلفات البطاريات

- يجب التخلص من جميع البطاريات بشكل منفصل عن مجاري النفايات البلدية عن طريق مرافق الجمع المعينة التي تعينها الحكومة أو السلطات المحلية.
  - يساعد التخلص الصحيح من البطاريات القديمة في منع الآثار السلبية المحتملة على البيئة وصحة الحيوان والبشر.
  - لمزيد من المعلومات التفصيلية حول التخلص من البطاريات القديمة ، يرجى الاتصال بمكتب خدمة التخلص من النفايات في مدينتك أو المتجر الذي اشتريته منه المنتج.
- كما يمكنك الاتصال بمركز اتصال ممثل دعم LG عن طريق الدخول علي الرابط التالي  
[https://www.lg.com/sa\\_en/support/contact/telephone](https://www.lg.com/sa_en/support/contact/telephone)
- تنطبق المعلومات الواردة أعلاه فقط على المملكة العربية السعودية.

- \* Safely dispose all materials in accordance with federal/state/local laws or ordinances.

التخلص الآمن من كافة المواد بما يتوافق مع القوانين والأوامر المحلية.

**Class A device****NOTE**

This equipment has been tested and identified as complying with the limits for a Class A digital device, and acts in accordance with part 15 of the FCC Rules. These rules are designed to provide protection for the equipment from any detrimental damages while operating in a commercial environment. This equipment generates, uses, and can emit radio frequency energy.

If it is not installed and used according to the instruction manual, it may cause detrimental damage to the radio communications. Ensure that this product is NOT operated within residential premises as it might emit dangerous radiations. In such a scenario, the user is responsible for damage repair.

**! CAUTION**

Changes or modifications that are not approved by the manufacturer responsible for compliance could render the user authority as invalid.

**Disposal of your old appliance**

1. This crossed-out wheeled bin symbol indicates that waste electrical and electronic products (WEEE) should be disposed of separately from the municipal waste stream.
2. Old electrical products can contain hazardous substances so correct disposal of your old appliance will help prevent potential negative consequences for the environment and human health. Your old appliance may contain reusable parts that could be used to repair other products, and other valuable materials that can be recycled to conserve limited resources.
3. You can take your appliance either to the shop where you purchased the product, or contact your local government waste office for details of your nearest authorised WEEE collection point. For the most up to date information for your country please see [www.lg.com/global/recycling](http://www.lg.com/global/recycling)

**Disposal of waste batteries/accumulators**

1. This symbol may be combined with chemical symbols for mercury (Hg), cadmium (Cd) or lead (Pb) if the battery contains more than 0.0005% of mercury, 0.002% of cadmium or 0.004% of lead.
2. All batteries/accumulators should be disposed separately from the municipal waste stream via designated collection facilities appointed by the government or the local authorities.
3. The correct disposal of your old batteries/accumulators will help to prevent potential negative consequences for the environment, animal and human health.
4. For more detailed information about disposal of your old batteries/accumulators, please contact your city office, waste disposal service or the shop where you purchased the product.  
(<http://www.lg.com/global/sustainability/environment/take-back-recycling/global-network-europe>)

# ACP 5 FUNCTIONS AND SPECIFICATION

ACP 5 is the central controller that can manage up to 256 equipments in one space individually or as combined. ACP 5 can monitor or control the equipments installed in each room of the building from the places such as the management office of a building or the administration office of a school.

## ACP 5 Functions

Major functions of the ACP 5 are as follows.

- Controlling of up to 256 air conditioner indoor units.
- Monitoring of error and operation status
- Controlling the peak power / demand power
- System setting function
- Up to 16 AHU can be interlocked

## ACP 5 Components

Inside the packaged box of the ACP 5, there are the components as in the following drawing. Open the packaged box of the ACP 5, and check if all of the corresponding components are included.



ACP 5

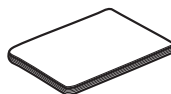

Manual

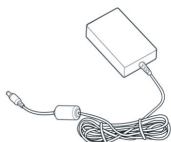

Power Supply Adaptor  
Input: 100-240 V~ 50/60 Hz, 1.2 A  
Output: 12 V --- 3.33 A, 40 W MAX



Power Cord  
250 V~, 3 A



Screw



SD Card 8 GB

### CAUTION

SD Card provided by LG is for the data backup and recovery when specialized service technician supports the service, so be careful not to lose it by using it for other purposes.

### CAUTION

If the supply cord is damaged, it must be replaced by the manufacturer, its service agent or similarly qualified persons in order to avoid a hazard.

### NOTE

Components or options may differ from the actual product picture.

## Names of each part of ACP 5

ACP 5 is composed as follows.

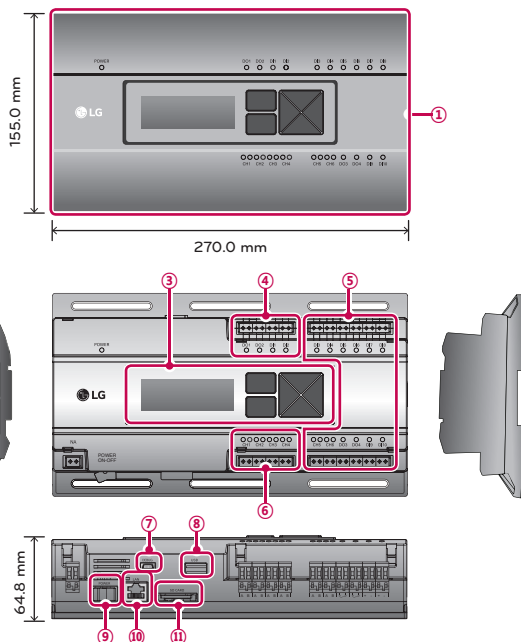

Number	Item	Description
①	Cover	Front cover of the ACP 5
②	Adaptor connection jack	Jack for 12 V $\overline{\text{---}}$ to connect to the power supply adaptor
③	Buttons and LCD	Buttons and LCD to set network environment and to display other information
④	Basic external input/ output signal connectors	Connection ports to connect to external input/output signals (DI:2, DO:2)
⑤	Optional input/output and RS-485 communication port	Connection port to connect to external input/output signals and RS-485 communication port for external expansion. (8 DI's, 2 DO's, 2 RS-485 communication ports)
⑥	RS-485 communication port	RS-485 communication ports to connect to air conditioner and ERV equipment (4 in total)
⑦	Mini USB port	USB to Serial port for software debugging
⑧	USB port	For SW update, data backup and Lonworks Commission with U60FT module
⑨	Power switch	Switch to turn on or off the power of the ACP 5
⑩	Ethernet port	Ethernet port to connect to internet and AC Manager 5
⑪	SD card slot	For RS-485 communication data backup.

## ACP 5 Hardware specification

ACP 5 hardware specification is as follows.

No	Category	Description
①	Operating temperature	0 °C ~ 40 °C
②	Rated voltage	12 V---
③	Rated current	Max 2.3 A
④	Communication port	<ul style="list-style-type: none"> <li>• Ethernet 10 / 100 BASE-T</li> <li>• USB : USB Host (SW update, data backup, Lonworks Commission with U60FT module)</li> <li>• Mini USB Device (Debug)</li> <li>• RS-485 communication ports 6 EA</li> <li>• SD card slot (RS-485 communication logging)</li> </ul>
⑤	External input/output ports	DI 10 EA, DO 4 EA
⑥	LED	27 EA (power status, communication status)
⑦	LCD	20 ×4 Character-LCD (network environment setting and information display)
⑧	Protection class	IP20

# INSTALLING ACP 5

## Installing ACP 5

This chapter describes how to install the ACP 5 to use.

In order to use the ACP 5, the installation should be performed by the following order.

### STEP 1. Check the cautions during the ACP 5 installation

Before installing the ACP 5, check the cautions.

### STEP 2. Study the cable connections diagram of the entire system.

Study the cable connection diagram of the site where the ACP 5 is installed.

### STEP 3. Set the indoor unit address

Set the address of the ACP 5 not to be overlapped with the connecting indoor unit.

### STEP 4. Set PI485 and connect cables

Set DIP switch of PI485 correctly, and connect RS-485 communication cable.

### STEP 5. Install ACP 5 and connect cables

Install the ACP 5, and set network and other settings.

### STEP 6. Set ACP 5 network address

Set the network address to be able to access the ACP 5 through internet.

### STEP 7. Set ACP 5 functions

Set language, peak/demand, etc.

### STEP 8. Set web GUI access environment

Set the access environment in web GUI, which is the operation program of the ACP 5.

### STEP 9. Input indoor unit and ventilator information

Set the access environment in web GUI, which is the operation program of the ACP 5.

### STEP 10. Verify and check ACP 5 installation

Verify and check whether the ACP 5 is properly installed.

## CAUTION

- The ACP 5 installation work needs the professional technique. Therefore, the installation described in this chapter should be performed by the certified installation professional.
- Consult the service center or the professional installation agency certified by us about any question or request related to the installation.

## Check points during the ACP 5 installation

- The number of PI485 connected to one RS-485 communication line. ACP 5 provides 4 RS-485 ports for indoor unit connection. (CH1 ~ CH4) Up to 16 PI485 for outdoor unit can be connected to one RS-485 port, and up to 31 PI485 for SINGLE/ERV can be connected. For optimal communication performance, it is recommended to connect up to 64 units to one RS-485 port. Communication speed delay may occur if connecting more than 128 units.
- The number of the indoor units that can be connected to one ACP 5. One ACP 5 can be connected up to 256 indoor units. With ACS I/O interlocking, you can connect 128 indoor units and 16 I/O modules. And with chiller interlocking, you can connect 128 indoor units and 10 chiller units. To improve the communication performance of RS-485, it should be divided and connected to 4 ports. The maximum quantity of connected indoor unit is different depending on the quantity of connected I/O modules. Please refer to following information related to product connection quantity.

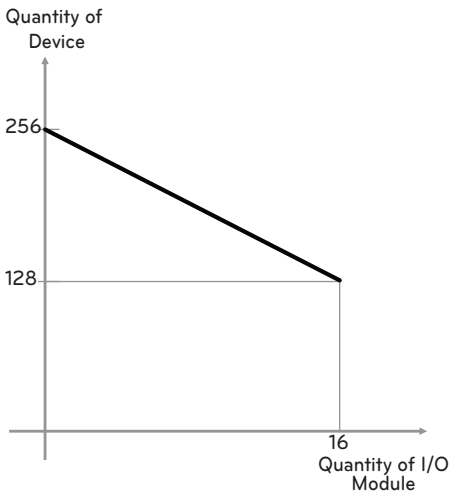

\* Devices: Indoor units, ERV, DI/DOs, DOKITs, Heatings, AHUs

- RS-485 communication cable connection  
There is a polarity in RS-485 communication cable connection, so be careful not to reverse the connection of the two cables. Do not let the length of RS-485 communication cable exceed total of 1 km. RS-485 communication cable must be connected with BUS type. For the RS-485 communication line, shield cable with a core area of 1.0 ~ 1.5 mm<sup>2</sup> must be used.
- IP address of the ACP 5  
IP address of the ACP 5, address of Gateway, and Net mask must be requested to the person in charge of the network of the corresponding site.

### CAUTION

#### RS-485 Connection of the ERV equipment

To connect ERV equipment, it is recommended to use the ports other than RS-485 communication ports which are connected to air conditioners.

Quantity of I/O Module	Quantity of Device
0	256
1	248
2	240
3	232
4	224
5	216
6	208
7	200
8	192
9	184
10	176
11	168
12	160
13	152
14	144
15	136
16	128

## Setting the indoor unit address

By considering the entire installation configuration connecting to one ACP 5, set the address to each indoor unit not to be overlapped. 00~FF in hexadecimal can be set to the indoor unit address. However, in case of I/O module, address 00 should not be set because address 00 is used as Broadcast in MODBUS communication.

### NOTE

#### Assigning indoor and outdoor unit number

If the outdoor unit product is Multi V, it is recommended to assign the address by setting the first digit of the address as the number of the outdoor unit, and classifying the second digit as the number or the indoor unit, for easy composition and classification of the system.

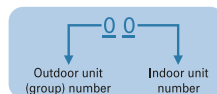

### NOTE

#### Precautions for setting the central control address when controlling the indoor unit group

In order to control all indoor units with the central controller and use the TMS function, both the master and slave indoor units need to set the central control address. Slave indoor units must set the central control address in the master state before setting them as slaves.

Here is an example of configuring ACP 5 and the device.

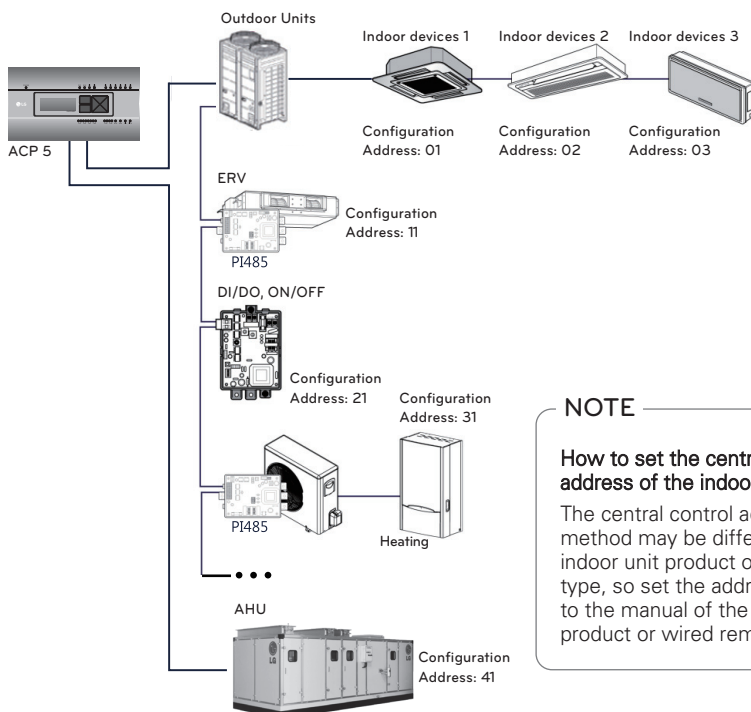

### NOTE

#### How to set the central control address of the indoor unit

The central control address setting method may be different for each indoor unit product or remote control type, so set the address by referring to the manual of the indoor unit product or wired remote controller.

When the ACP 5 is interconnected with the AC Manager 5, the ERV can be installed together and controlled. The above figure shows the example that sets the address of 11 to the ERV and connects to the ACP 5.

## Installing ACP 5 and connecting cables

After setting PI485, the ACP 5 shall be installed in an adequate place, and RS-485 cable shall be connected for the communication with PI485.

And, Ethernet cable (LAN cable) shall be connected for the connection with internet or AC Manager 5.

To fix the ACP 5, the following 2 methods may be used.

Install in DIN RAIL or fix to the wall considering the environment of the site.

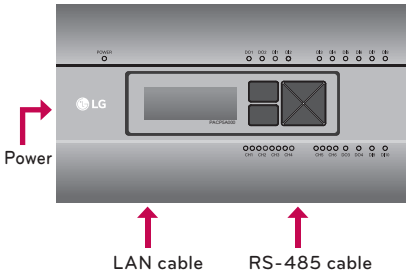

### CAUTION

Use the designated parts must be connected to a power source.

- Connector manufacturers: PHOENIX CONTACT
- PartNo: MVSTBR 2,5 / 2-ST-5,08 2P 5.00 mm



## Installing the ACP 5 in DIN RAIL

ACP 5 can be installed in DIN RAIL with width 35 mm and height 7.5 mm.

Proceed as the follows to install the ACP 5 in an adequate place.

The installation method of the ACP 5 is explained here with the example of installing the ACP 5 in DIN RAIL.

- Decide the space to install the ACP 5.
- Before installing the ACP 5, check if it is the adequate place to connect the ACP 5 with the power, RS-485, and LAN cable.
- Install DIN RAIL.
- Hook the top part of the ACP 5 on DIN RAIL.
- Push the main body of the ACP 5 until you hear the sound of installation.
- Pull the ACP 5 to check if it is fixed.

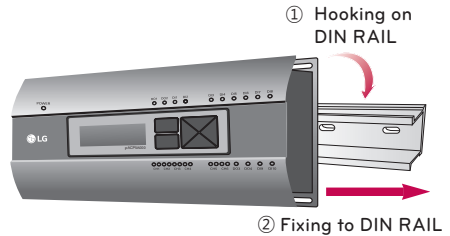

### CAUTION

- After installing to DIN RAIL, do not fix to the wall using screws.
- ACP 5 may be damaged.
- DIN Rail fixing Screw Spec: M3, screw head height 1.75 mm ~ 2.0 mm, screw head diameter 5.5 mm ~ 7.0 mm

## Fixing the ACP 5 to the wall

ACP 5 can be installed by fixing to the wall. To install the ACP 5 in an adequate place, proceed according to the following explanation. It explains here on how to install the ACP 5 with the example of installing the ACP 5 on the wall.

- Decide the space to install the ACP 5. Before installing the ACP 5, check if it is the adequate place to connect the ACP 5 with the power, RS-485, and LAN cable.
- Fix to the wall using the driver. It can be fixed as in the following figure according to the location to install.

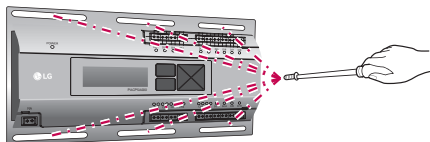

## Connecting RS-485 cable to the ACP 5

After fixing the ACP 5 in the installation place, RS-485 cable that was connected to PI485 shall be connected to the ACP 5. To connect RS-485 cable to the ACP 5, proceed as the following order.

- First, among the connectors that can be connected to the ACP 5, connect the end of RS-485 cable connected to BUS A of PI485 to Tx part. Next, connect the end of RS-485 cable connected to BUS B of PI485 to Rx part.
- RS-485 cable that was connected to PI485 shall be connected to CH port (RS-485 port) of the ACP 5.
  - Plug the connector connecting RS-485 cable into one of CH1 ~ CH4 ports.
  - There are CH1 ~ CH6 ports, and it must be plugged into one of CH1 ~ CH4 ports for use.
  - For AHU, plug the connector connecting RS-485 cable into CH5 ports.
  - For chiller, plug the connector connecting RS-485 cable into CH6 ports.

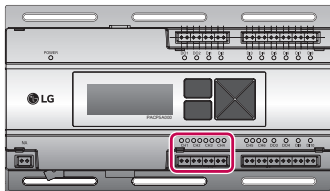

## CAUTION

If a different type of connection is made other than BUS format as in the figure, the product may malfunction. So be careful during the installation. ACP 5 shall be installed in accordance with national wiring regulations.

## Connecting Ethernet cable (LAN cable) to the ACP 5

After connecting the ACP 5 and RS-485 cable, Ethernet cable shall be connected to the ACP 5.

ACP 5 may be connected to hub through Ethernet cable, or directly to AC Manager 5.

## Connecting the ACP 5 and hub

It is the case of connecting the ACP 5 to the basic internet network installed at the site, and it is generally connected to the hub.

In such case, Ethernet cable shall be connected as a direct cable.

Use Ethernet cable (direct cable) to connect to LAN port of the ACP 5.

### Connecting ACP 5 and PC

It is the case of connecting ACP 5 and PC directly.

In such case, Ethernet cable shall be connected as a cross cable.

Use Ethernet cable to connect to LAN port of the ACP 5.

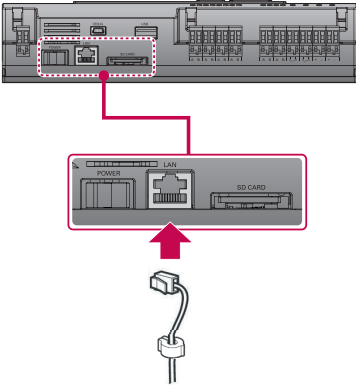

### Connecting ACP 5 and Lonworks module

U60FT module shall be connected to USB port of the ACP 5.

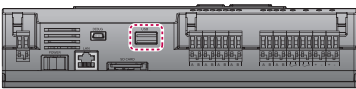

### Setting the ACP 5 network address

After connecting the ACP 5 to various devices via the cable, the network environment of the ACP 5 should be set by driving the ACP 5. The following information should be set for using the ACP 5.

- IP address of the ACP 5
- Gateway address
- Net mask

#### ! CAUTION

##### Setting the network environment information

If the above information is not entered, the communication error may be occurred or it may be impossible to control by the ACP 5. So, be careful to correctly input.

### Before configuring the ACP 5 environment

The network environment of the ACP 5 can be set by the LCD and the buttons at the front side of the ACP 5.

The current ACP 5 information and the menu are displayed on the LCD, and the menu can be changed and selected by pressing **ENT** and **ESC** button and Up/Down/Left/Right (**▲**, **▼**, **◀**, **▶**) buttons.

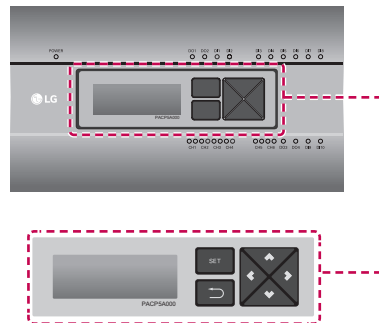

## Turning on the ACP 5

Turn on the ACP 5 to set the network environment of the ACP 5.

When the power switch is turned on, the ACP 5 booting screen is displayed on the LCD as shown at the following figure, and when booting is completed, the initial ACP 5 screen is displayed.

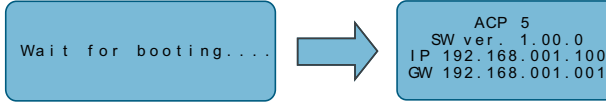

### NOTE

#### Software version

The software version of the current ACP 5 is displayed at the initial ACP 5 screen.

Also, the software version may be different according to the manufacturing date of the ACP 5.

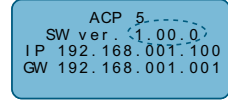

## Entering into the environment setup mode

Press [SET] button of the ACP 5 to enter into the environment setup mode of the ACP 5.

When the [SET] button is pressed for the first time, the menu to set the IP address is displayed as shown below.

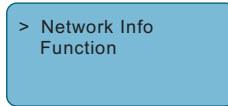

Press up/down(▲, ▼) button to place the arrow on the desired function.

- When you select [Network Info] and press [SET] button, it enters the No. 1 menu in the following figure. In [Network Info] menu, input the network information such as IP address of the ACP 5.
- When you select [Function] and press [SET] button, it enters the No. 2 menu in the following figure. In [Function] menu, ACP 5 software service function is supported.

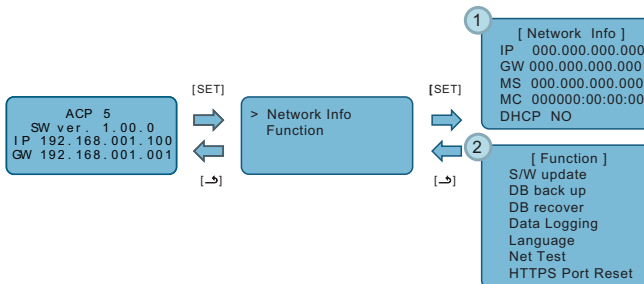

## CAUTION

- [Function] menu is used by the system air conditioner service technician, so user shall never use this function.
- If this function is incorrectly used, it may cause disorder of the ACP 5.

# INITIALISING

It describes about how to access the system before completely using the ACP 5.

## Login and logout

The following explains how to log in and out of ACP 5.

ACP 5, can be controlled either by the equipment or the web. If you enter the IP address of the ACP 5 in the address bar of the command window of web browser (Run>cmd>ipconfig) without the installation of another program, the central control program ACP 5 Web server is executed automatically.

### NOTE

- Special characters (^), (!), (!), (,), (|), (\) cannot be used.

## Login

You can login as follows.

- 1 Run ACP 5.
- 2 Input ID and password in log-in window and touch [Log in] button.

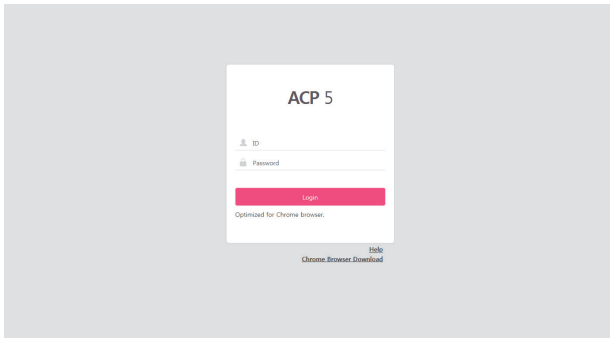

## Log-in (for first time access)

In case of initially accessing, set password for the manager account (ID : admin).

- 1 Run ACP 5.
- 2 Input password of manager account to use in the account creation window and touch [Create admin] button.

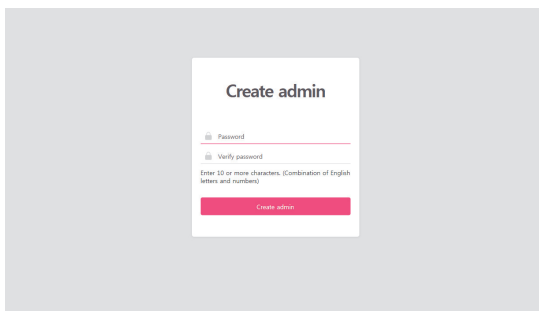

**CAUTION**

- Do NOT disclose account related info to unauthorised personnel.
- In case you have forgotten your password, contact the installer.

**NOTE**

- To maintain confidentiality, change the password once in every 90 days (as prompted by the pop-up window).

**Logout**

You can logout as follows.

- 1 In ACP 5 menu, choose the sub-menu 'Account'.
- 2 From the list of options as displayed by the 'Account' sub-menu press 'Log Out'.

**User manual**

You can view the user manual as follows.

- 1 In ACP 5 log-in screen, input ID and password and touch [Log in] button.
- 2 Press 'Help' at the top right side of ACP 5 screen.
  - The user manual is displayed.

**Lonworks setting**

1. In ACP 5 menu, click 'Setting' > 'BACnet/Modbus/Lonworks Setting' menu.
2. After setting 'Lonworks enable' and 'Temperature Unit Setting', click [Apply] button. 'SVC pin Setting' will be activated.
3. If 'press SVC Pin' request is shown on BMS Engineering tool, press [Connect] button activated when BMS communication is normal.

Lonworks enable  Set  Clear

Temperature Unit Setting  °C  °F

SVC pin Setting

When the communication with the BMS is confirmed, the [Connect] button will be activated.

# HINT

## Pre-Tech Support Checklist

If the abnormality occurs in products, please first check the following points before requesting to service center.

Symptom	Measures
Because there is no icon on the desktop, it is impossible to control.	Please refer to the connection guide.
Although running on the desktop icon, Web GUI does not run.	Please check LAN cable and the power supply of Hub.
Indoor remote control does not work.	ACP 5 in the lock feature is enabled, the remote control function is not set. Peak control state must function setting from the remote control at the indoor unit. If the function is active, set the time schedule may be disabled.
I would like to change the name of the indoor unit.	Log in as superuser → System Settings → After select the device you want to change, modify the name of or the device → Apply → Complete group settings

















## Disposal of your old appliance(as per e-waste Rules)

1. When this crossed out wheeled bin symbol is depicted on the product and its operator's manual, it means the product is covered by the e-waste Management and Handling Rules , 2011 and are meant to be recycled, dismantled, refurbished or disposed off.
2. Do
  - a. The product is required to be handed over only to the authorized recycler for disposal.
  - b. Keep the product in isolated area, after it becomes non-functional/unrepairable so as to prevent its accidental breakage.

### Don't

- a. The product should not be opened by the user himself/herself, but only by authorized service personnel.
  - b. The product is not meant for re-sale to any unauthorized agencies/scrap dealer/kabariwala.
  - c. The product is not meant for mixing into household waste stream.
  - d. Do not keep any replaced spare part(s) from the product in exposed area.
3. Any disposal through unauthorized agencies/person will attract action under Environment (Protection) Act 1986.
  4. Hazards of improper handling or accidental breakage.
    - a. If batteries are disposed incorrectly, it can greatly harm the environment. The chemical byproducts are hazardous. The metals and chemicals found in batteries can mix into soil which may be hazardous to humans, plants and animals. If thrown in fire, they can cause blast and release toxic gases which may be harmful for health.
    - b. The refrigerant used can be combustible at low pressure.  
The potential health effect of over exposure is dizziness, headache and heart irregularities.
  5. This product is complied with the requirement of Hazardous Substances as specified under Rule 13 (1) & (2) of the E-Waste (Management & Handling) Rules, 2011.
  6. To locate a nearest collection centre or call for pick-up (limited area only) for disposal of this appliance, please contact Toll Free No. 1800-180-3575 for details. All collection centre and pick up facilities are done by third parties with LG Electronics India Ltd. Merely as a facilitator. For more detailed information , please visit : <http://www.lge.com/in>

※ The above information applies only to India.

### Recycling Info.

EPR registration number :  
11595375254588000000



## अपने पुराने निपटान के उपकरण ( ई-अपशिष्ट नियम के अनुसार)

१. जब इस काटे गए पहिये वाले बिन का चिह्न किसी उपकरण और इसके ओपरेटर की पुस्तिका के साथ संलग्न होता है तो इसका मतलब है कि इसे "ई-अपशिष्ट" (प्रबंधन और हथालन) नियम २०११ के अंतर्गत सम्मिलित किया गया है, और इसे नवीनीकरणकरण, विघटन और निपटान के लिए बनाया गया है।

### २. करें

- क. उपकरण को सिर्फ अधिकृत पुनः नवीनीकरणकर्ता को ही निपटारण करने हेतु हस्तांतरित करें।  
ख. जब उपकरण कार्यरत न हो इसे अलग क्षेत्र में रखें ताकि उपकरण से होने वाली दुर्घटनाओं से बचा जा सके।

### न करें

- क. इस उपकरण को स्वयं/खुद नहीं खोलना चाहिए ! उपकरण को केवल अधिकृत अधिकारी के द्वारा ही खोला जाना चाहिए।  
ख. इस उपकरण को पुनः बिक्री के लिए किसी भी कबाड़ीवाला / भंगार-वाला / अनाधिकृत संस्था को न दें।  
ग. इस उपकरण को किसी घरेलू अपशिष्ट सामान के साथ मिलाकर न रखें।

घ. उपकरण के बदले हुए या आंतरिक पुरजो को खुले क्षेत्र में न रखें।

३. यदि किसी अनाधिकृत विभाग या व्यक्ति के द्वारा निपटारण किया जाता है तो यह पर्यावरण (सुरक्षा) धारा १९८६ के अंतर्गत आता है।

४. दर्पु टना टूट / फूट अव्यवस्थित रख-रखाव से बचें।

- क. यदि बट्टे रियों का निपटारण अशुद्ध रूप से कर रहे हैं, तो यह वातावरण को बहुत नुकसान पहुँचा सकता है। रासायनिक उपकरण खतरनाक होते हैं। जो रसायन और धातु बैटरियों में पाए जाते हैं। इसे मि टटी में मि लाने पर यह मनुष्यों, पौधों और पशुओं दस लि प् खतरनाक हो सकती है। यदि इसे आग में फें कते हैं तो ये विस्फोट कर सकती है और ये जहरीली गैस दे सकती है जो स्वास्थ्य के लि ए हानिकारक है।  
ख. रेफ्रिजरेट काम दबाव पर दहनशील हो सकती है तथा इससे स्वास्थ्य पर दषु प्रभाव पड़ सकता है जैसे चक्कर आना, सर दर्द और हृदय गति रुकना।

५. यह उत्पाद ई-अपशिष्ट (प्रबंधन और हथालन) नियम 2011 के अन्तर्गत 13(1) एवं (2) के तहत निर्दिष्ट खतरनाक पदार्थों की आवश्यकता का पालन करता है।

६. उपरोक्त पदार्थों के निपटारण के लिए नजदीकी निपटारण संस्थान (संकीर्ण क्षेत्र) में कॉल करें। अधिक जानकारी के लिए हमारे टोल फ्री नंबर 1800-315-9999 / 1800-180-9999 पर कॉल करें. सभी संग्रहण केंद्र व पिक-अप की सुविधाएं किसी थर्ड- पार्टी जो "LG Electronics India Ltd. "को अपनी सेवाएं प्रदान कर रही हों, से करवाएं। ज्यादा जानकारी के लिए देखें वेब:साइट - <http://www.lge.com/in>

※ ऊपर दी गई जानकारी केवल भारत पर लागू होती है।

## [For Equipment under battery regulation]



### English

The battery is in compliance with the Regulation (EU) 2023/1542

### Italiano

La batteria è conforme al Regolamento (UE) 2023/1542

### Español

La pila cumple con el Reglamento (UE) 2023/1542

### Français

La pile est conforme à la réglementation (UE) 2023/1542

### Deutsch

Die Batterie entspricht der Verordnung (EU) 2023/1542

### Ελληνικά

Η μπαταρία συμμορφώνεται με τον κανονισμό (ΕΕ) 2023/1542

### Česky

Baterie odpovídá Nařízení (EU) 2023/1542

### Nederlands

Deze accu voldoet aan de verordening (EU) 2023/1542

### Polski

Bateria spełnia wymogi rozporządzenia (UE) 2023/1542

### Română

Bateria este în conformitate cu Regulamentul (UE) 2023/1542

### Português

A bateria está em conformidade com o Regulamento (EU) 2023/1542

### Magyar

Az akkumulátor megfelel az (EU) 2023/1542 rendeletnek

### Български

Батерията е в съответствие с Регламент (ЕС) 2023/1542

### Srpski

Baterija je u skladu sa Uredbom (EU) 2023/1542.

### Hrvatski

Baterija je u skladu s Uredbom (EU) 2023/1542.

### Svenska

Batteriet överensstämmer med förordning (EU) 2023/1542

### Norsk

Batteriet overholder forordningen (EU) 2023/1542

### Dansk

Batteriet er i overensstemmelse med forordning (EU) 2023/1542

### Eesti

Aku vastab määrusele (EL) 2023/1542

### Malti

Il-batterija hija konformi mar-Regolament (UE) 2023/1542

### Slovenčina

Batéria je v súlade s nariadením (EÚ) 2023/1542

### Slovensčina

Baterija je v skladu z Uredbo (EU) 2023/1542.

### Latviešu

Akkumulators ir atbilstīgs Regulai (ES) 2023/1542.

### Lietuvių K.

Baterija atitinka Reglamentą (ES) 2023/1542

### Gaeilge

Tá an cadhnra i gcomhréir le Rialachán (AE) 2023/1542

### Македонски

Батеријата е во согласност со Регулативата (ЕУ) 2023/1542.

### Shqip

Bateria është në përputhje me Rregulloren (BE) 2023/1542

### Bosanski

Baterija zadovoljava zahtjeve navedene u Propisu (EU) 2023/1542

LG Electronics EU Importer names and addresses / Имена и адреси на вносителите на LG Electronics в ЕС / Nazivi i adrese uvoznika LG Electronics u EU / Nazivi i adrese uvoznika LG Electronics u EU / Názvy a adresy dovozců LG Electronics v EU / Navne og adresser på importører af LG Electronics i EU / Namen und Adressen der LG Electronics EU-Importeure / Ονόματα και διευθύνσεις εισαγωγέων της LG Electronics EU / Nombres y direcciones de importadores para la UE de LG Electronics / LG Electronics EL maaletootajate nimed ja aadressid / LG Electronics – EU:n maahantuojien nimet ja osoitteet / Noms et adresses des importateurs pour LG Electronics EU / Ainmeacha agus seolai lompórtálaí AE LG Electronics / Nazivi i adrese uvoznika proizvoda tvrtke LG Electronics u Europskoj uniji / Az LG Electronics európai uniós importőreinek neve és címe / Nöfn og heimilisföng LG Electronics innflytjenda innan ESB / Nomi e indirizzi degli importatori UE di LG Electronics / LG Electronics ES importuotojų pavadinimai ir adresai / LG Electronics ES importētāju nosaukumi un adreses / Имиња и адреси на увозници на LG Electronics за ЕУ / LG Electronics: ismijiet u indirizzi tal-importaturi tal-UE / Namen en adressen van importeurs voor LG Electronics EU / Navn og adresser for EU-importører for LG Electronics / Nazwy i adresy importerów produktów LG Electronics w Europie / Nomes e endereços dos importadores para LG Electronics EU / Numele și adresele Importatorului UE al LG Electronics / Názvy a adresy dovozcov LG Electronics do EÚ / Imena in naslovi uvoznikov za LG Electronics EU / Emrat dhe adresat e importuesve të LG Electronics në BE / Nazivi i adrese EU uvoznika kompanije LG Electronics / Namn och adresser för LG Electronics EU-importörer

LG Electronics Benelux B.V.	Krijgsman 1, 1186 DM Amstelveen, The Netherlands
LG Electronics Deutschland GmbH	Alfred-Herrhausen-Allee 3-5, 65760, Eschborn, Germany
LG Electronics France, SAS	Immeuble Workstation, 25 quai du Président Paul Doumer, 92 400 Courbevoie, France
LG Electronics España S.A.U.	Calle Chile 1, 28290, Las Rozas, Madrid, Spain
LG Electronics Portugal S.A.	Taguspark, Av. Jacques Delors 3, Edifício Inovacao I, Corpo 1, 2740-122, Porto Salvo, Portugal
LG Electronics Hellas S.A.	Ethnarhou Makariou str. 1, 17501, Delta Paleo Faliro, Greece
LG Electronics Italia S.p.A.	Via Aldo Rossi 4, 20149, Milan, Italy
LG Electronics Latvia SIA	Gustava Zemgala gatve 74A, Rīga, LV-1039, Latvia
LG Electronics Magyar Kft.	Konyves K. krt.3/a, 1097, Budapest, Hungary
LG Electronics Polska Sp. z o.o.,	Woloska 22, 02-675, Warszawa, Poland
LG Electronics Magyar Kereskedelmi Kft. Budapesta Sucursala București,	11-15, Tipografilor Street, S-Park Business Centre, Building B3, 5th Floor, District 1, 013714 Bucharest, Romania
LG Electronics Nordic AB	Esbogatan 18, 164 94, Kista, Sweden
LG Electronics Shared Services Center B.V.	Krijgsman 1, 1186 DM Amstelveen, The Netherlands

Depending on products or models, actual importers may be limited to some subsidiaries. For EU-produced units, there is no applicable EU importer. / В зависимост от продуктите или моделите действителните вносители може да са ограничени до някои дъщерни дружества. За апарати, произведени в ЕС, няма приложим вносител в ЕС. / U zavisnosti od proizvoda ili modela, uvoznici mogu biti ograničeni na neka povezana društva. Za jedinice proizvedene u EU ne postoji važeći uvoznik iz EU. / U zavisnosti od proizvoda ili modela, uvoznici mogu biti ograničeni na određene podružnice. Za jedinice proizvedene u EU ne postoji EU uvoznik. / V závislosti na výrobcích nebo modelech mohou být aktuální dovozci omezeni na některé dceřiné společnosti. U výrobků vyráběných v EU není žádný relevantní dovozce do EU. / Afhængigt af produkter eller modeller kan de faktiske importører være begrænset til enkelte datterselskaber. For EU-fremstillede enheder er der ingen relevant EU-importør. / Je nach Produkt oder Modell können die tatsächlichen Importeure auf einige Tochtergesellschaften beschränkt sein. Für in der EU produzierte Geräte gibt es keinen anwendbaren EU-Importeur. / Ανάλογα με τα προϊόντα ή τα μοντέλα, οι πραγματικοί εισαγωγείς ενδέχεται να περιορίζονται σε ορισμένες θυγατρικές. Για μονάδες που παράγονται στην ΕΕ δεν υπάρχει ισχύων εισαγωγέας της ΕΕ. / Dependiendo de los productos o modelos, los importadores efectivos podrían quedar limitados a algunos subsidiarios. Para las unidades producidas en la UE, no hay ningún importador para la UE aplicable. / Sõltuvalt toodetest või mudelistest võivad tegelikud maaletoojad olla piiratud mõnede tütarettevõtetega. EL-is toodetud seadmete puhul ei ole kohaldatavat EL maaletoojat. / Tuotteista tai malleista riippuen todelliset maahantuojaat voivat rajoittua muutamiin tytäryhtiöihin. EU:ssa valmistetuilla laitteilla ei ole sovellettavaa EU:n maahantuoja. / Selon les produits ou les modèles, les importateurs effectifs peuvent être limités à certaines filiales. Pour les unités produites dans l'UE, il n'y a pas d'importateur applicable pour l'UE. / Ag brath ar tháirgí nó múnlaí, d'fhéadfaí go mbeadh iompórtálaithe iarmhír srianta go roinnt fochomhlachtaí. Maidir le aonaid déanta sa AE, níl iompórtálai AE infheidhme. / Ovisno o proizvodima ili modelima uvoznici mogu biti ograničeni na neke podružnice. Za uređaje proizvedene u Europskoj uniji nije predviđena tvrtka za uvoz iz EU. / A termékektől vagy modellektől függően előfordulhat, hogy a tényleges importőrök egyes leányvállalatokra korlátozódnak. Az EU-ban gyártott készülékek esetében nincs vonatkozó európai uniós importőr. / Raunverulegir framleiðendur geta verið takmarkaðir við tiltekin dótturfélög, en það fer eftir vörum eða vörumódelum. Engin ESB innflytjandi er fyrir hluti sem eru framleiddir innan ESB. / A seconda dei prodotti o dei modelli, gli importatori effettivi potrebbero essere limitati ad alcune filiali. Per le unità prodotte nell'UE, non esiste un importatore UE applicabile. / Priklausomai nuo gaminių ar modelių, tikrieji importuotojai gali apsiriboti kai kuriomis dukterinėmis įmonėmis. ES pagamintiems vienetams nėra tinkama ES importuotojo. / Atkarībā no produktiem vai modeļiem, faktiskie importētāji var būt dažādi meitasuzņēmumi. ES ražotām vienībām nav piemērojama ES importētāja. / Зависно од произведени или моделите, актуелните увозници можеби се ограничени на некои подружници. За единиците произведени за ЕУ, нема применлив увозник за ЕУ. / Skont il-prodott jew il-mudell, l-importaturi attwali jistghu jkunu limitati għal ċerti sussidjarji. Għall-unitajiet prodotti fl-UE, m'hemmx importatur applikabbli tal-UE. /

Afhankelijk van de producten of modellen, kunnen de eigenlijke importeurs beperkt zijn tot enkele dochterondernemingen. Voor in de EU geproduceerde eenheden is er geen toepasselijke EU-importeur. / Avhengig av produkter eller modeller, kan faktiske importører være begrenset til enkelte datterselskaper. Det er ingen gjeldende EU-importør for EU-produserte enheter. / W zależności od produktów lub modeli, rzeczywiscy importerzy mogą polegać na swoich podmiotach zależnych. W przypadku wyrobów produkowanych w UE nie ma odpowiedniego importera na region Unii. / Dependendo dos produtos ou modelos, os importadores existentes podem ser limitados a algumas filiais. Para as unidades produzidas na UE, não há nenhum importador da UE aplicável. / În funcție de produse sau modele, importatorii actuali ar putea fi limitați la anumite filiale. Pentru unitățile produse în UE, nu există niciun importator UE aplicabil. / V závislosti od výrobov alebo modelov môžu byť skutoční dovozcovia obmedzení na niektoré dcérske spoločnosti. Pre zariadenia vyrobené v EÚ neexistuje žiadny príslušný dovozca do EÚ. / Odvisno od izdelkov ali modelov so lahko dejanski uvozniki omejeni na nekatere hčerinske družbe. Za enote, proizvedene v EU, ni ustreznega uvoznika iz EU. / Nē varēsī tē produkteve ose modeleve, importuesit aktual mund tē jenē tē kufizuar vetēm nē disa degē. Pēr njesītē e produhara nē BE, nuk ka importues tē zbatueshēm tē BE-sē. / U zavisnosti od proizvoda ili modela, stvarni uvoznici mogu biti ograničeni na neke podružnice. Za jedinice proizvedene u EU ne postoji merodavni EU uvoznik. / Beroende på produkter eller modeller kan faktiska importörer vara begränsade till vissa dotterbolag. För EU-tillverkade enheter finns det ingen tillämplig EU-importör.

LG Electronics Inc. <sup>①</sup> Single Contact Point <sup>②</sup> (EU/UK) :  
 LG Electronics Deutschland GmbH  
 Alfred-Herrhausen-Allee 3-5, 65760 Eschborn, <sup>③</sup> Germany

	①	②	③
ENGLISH	Single Contact Point	EU	Germany
ITALIANO	Punto di contatto unico	UE	Germania
ESPAÑOL	Punto de contacto único	UE	Alemania
FRANÇAIS	Point de contact unique	UE	Allemagne
DEUTSCH	Einheitliche Anlaufstelle	EU	Deutschland
ΕΛΛΗΝΙΚΑ	Ενιαίο σημείο επαφής	EE	Γερμανία
ČEŠTINA	Jednotné kontaktní místo	EU	Německo
NEDERLANDS	Eén enkel contactpunt	EU	Duitsland
POLSKI	Punkt kontaktowy	UE	Niemcy
LIMBA ROMÂNĂ	Punct unic de contact	UE	Germania
PORTUGUÊS	Ponto de contacto único	UE	Alemanha
MAGYAR	Egyetlen kapcsolattartó pont	EU	Németország
БЪЛГАРСКИ	Единна контактна точка	ЕС	Германия
SRPSKI	Jedinstvena kontaktna tačka	EU	Nemačka
HRVATSKI	Jedinstvena kontaktna točka	EU	Njemačka
SVENSKA	Enskild kontaktpunkt	EU	Tyskland
NORSK	Enkelt kontaktpunkt	EU	Tyskland
DANSK	Enkelt kontaktpunkt	EU	Tyskland
SLOVENČINA	Jednotné kontaktné miesto	EÚ	Nemecko
SLOVENŠČINA	Enotna kontaktna točka	EU	Nemčija
GAEILGE	Pointe Teagmhála Aonair	AE	an Ghearmáin
SHQIP	Pikë e vetme kontakti	BE	Gjermania
BOSANSKI	Jedinstvena kontaktna tačka	EU	Njemačka
EESTI KEEL	Üks kontaktpunkt	EL	Saksamaa
LATVIEŠU VALODA	Vienotais kontaktpunkts	ES	Vācija
LIETUVIŲ KALBA	Bendras kontaktas visiems	ES	Vokietija
MALTI	Punt ta' Kuntatt Uniku	UE	il-Ġermanja
МАКЕДОНСКИ	Единствена контакт точка	EY	Германија



U.K. Importer : LG Electronics U.K. Ltd.

Velocity 2, Brooklands Drive, Weybridge, KT13 0SL, U.K.

Manufacturer : LG Electronics Inc. Changwon 2nd factory, 84, Wanam-ro,  
Seongsan-gu, Changwon-si, Gyeongsangnam-do, KOREA