



SIMPLE MANUAL

Wireless Sound Bar

Please read this manual carefully before operating your set and retain it for future reference.
To view the instructions of advanced features, visit <http://www.lg.com> and then download Owner's Manual. Some of the content in this manual may differ from your unit.

MODELS

SJ7

SJ7-C



www.lg.com

ENGLISH



CAUTION: TO REDUCE THE RISK OF ELECTRIC SHOCK DO NOT REMOVE COVER (OR BACK) NO USER-SERVICEABLE PARTS INSIDE. REFER SERVICING TO QUALIFIED SERVICE PERSONNEL.



This lightning flash with arrowhead symbol within an equilateral triangle is intended to alert the user to the presence of uninsulated dangerous voltage within the product's enclosure that may be of sufficient magnitude to constitute a risk of electric shock to persons.



The exclamation point within an equilateral triangle is intended to alert the user to the presence of important operating and maintenance (servicing) instructions in the literature accompanying the product.

WARNING: TO PREVENT FIRE OR ELECTRIC SHOCK HAZARD, DO NOT EXPOSE THIS PRODUCT TO RAIN OR MOISTURE.

WARNING: Do not install this equipment in a confined space such as a book case or similar unit.

CAUTION: Do not use high voltage products around this product. (ex. Electrical swatter) This product may malfunction due to electrical shock.

CAUTION: Do not block any ventilation openings. Install in accordance with the manufacturer's instructions.

Slots and openings in the cabinet are provided for ventilation and to ensure reliable operation of the product and to protect it from over heating. The openings shall be never be blocked by placing the product on a bed, sofa, rug or other similar surface. This product shall not be placed in a built-in installation such as a bookcase or rack unless proper ventilation is provided or the manufacturer's instruction has been adhered to.

CAUTION concerning the Power Cord

The Power Plug is the disconnecting device. In case of an emergency, the Power Plug must remain readily accessible.

CAUTION: The apparatus shall not be exposed to water (dripping or splashing) and no objects filled with liquids, such as vases, shall be placed on the apparatus.

This device is equipped with a portable battery or accumulator.

Safety way to remove the battery or the battery from the equipment: Remove the old battery or battery pack, follow the steps in reverse order than the assembly. To prevent contamination of the environment and bring on possible threat to human and animal health, the old battery or the battery put it in the appropriate container at designated collection points. Do not dispose of batteries or battery together with other waste. It is recommended that you use local, free reimbursement systems batteries and accumulators. The battery shall not be exposed to excessive heat such as sunshine, fire or the like.

NOTICE: For safety marking information including product identification and supply ratings, please refer to the main label on the bottom or the other surface of the product.

Caution: No naked flame sources, such as lighted candles, should be placed on the apparatus.

For models using an adapter

Only use the AC adapter supplied with this device. Do not use a power supply from another device or another manufacturer. Using any other power cable or power supply may cause damage to the device and void your warranty.

- The appliance is not intended for use by young children or infirm persons without supervision.
- Young Children should be supervised to ensure that they do not play with appliance.
- If the appliance is supplied from a cord extension set or an electrical portable outlet device, the cord extension set on electrical portable outlet device must be positioned so that it is not subject to splashing (of water or any form of liquid) or ingress of moisture.

RF Radiation Exposure Statement

This equipment should be installed and operated with minimum distance 20 cm between the radiator and your body.



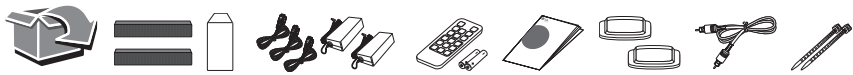

Front/Side Panel

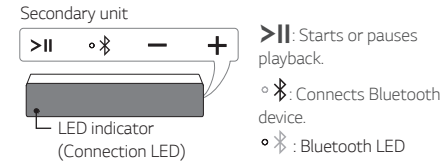

TV Connection

Connect with the Sound Bar and TV using Optical or HDMI ARC.

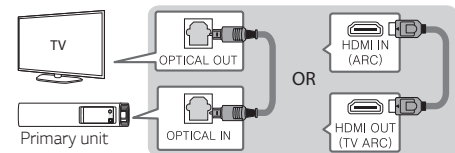

- 1 Connect the sound bar to the TV using Optical or HDMI cable.
- 2 Set up [External Speaker (Optical)] or [External Speaker (HDMI ARC)] on your TV setting menu.



- HDMI connection is unavailable if your TV does not support HDMI ARC.
- If this unit is connected by OPTICAL and ARC at the same time, the ARC signal is a high priority.

Additional Device Connection

- 1 Connect to the external device. It is recommended to connect as follows.

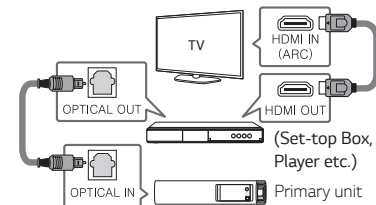

- 2 Set the input source by pressing **F** on the remote control or unit repeatedly.

Speaker Connection

You can use speaker connection in the SOUND BAR or REAR usage mode only.

Secondary unit connection

Place the Secondary unit near the Primary unit and follow steps below.

- 1 Connect the power cord of Secondary unit and Primary unit to the outlet.
- 2 Turn on the Primary unit by pressing **power**. Turn on the Secondary unit by switching the Usage Mode Switch to REAR or SOUND BAR.

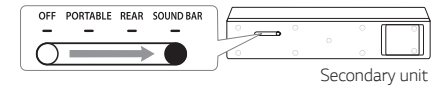

The Primary unit and Secondary unit will be **automatically** connected. The Secondary unit's white LED turns on.

Secondary unit Connection Manually

If the Secondary unit does not make sound, try to connect manually.

- 1 Turn off the Primary unit.
- 2 Press **PAIRING** button on the rear of the Secondary unit. The white LED on the front of Secondary unit blinks.
- 3 Turn on the Primary unit.
- 4 Pairing is completed. The white LED on the front of Secondary unit turns on.

Subwoofer connection

Place the wireless subwoofer near the speaker and follow steps below.

- 1 Connect the power cord of wireless subwoofer and sound bar to the outlet.
- 2 Turn on the Primary unit. : The sound bar and wireless subwoofer will be **automatically** connected. The subwoofer's green LED turns on.

Subwoofer Connection Manually

If the subwoofer does not make sound, try to connect manually.

- 1 Press **Pairing** button on the rear of the wireless subwoofer. The green LED blinks quickly.
- 2 Turn on the Primary unit.
- 3 Pairing is completed. The green LED turns on.

Positioning the Unit

SOUND BAR usage mode

Primary unit and Secondary unit play as FRONT L/ R(Left/Right) speaker like a sound bar.

Turn on the Primary unit by pressing **power**. Turn on the Secondary unit by switching the Usage Mode Switch to SOUND BAR.

When disconnecting AC Adapter of Secondary unit, the audio output may be reduced.

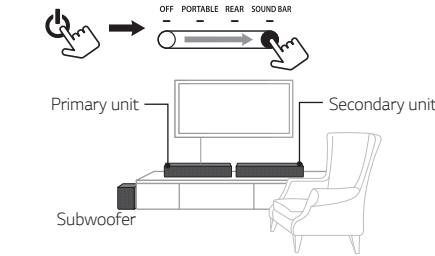

PORTABLE usage mode

You can play Secondary unit without Primary unit.

Primary unit and Secondary unit play separately with each connected device.

Turn on the Secondary unit by switching the Usage Mode Switch to PORTABLE.

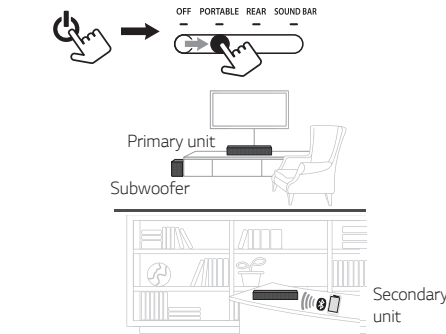

REAR usage mode

Primary unit plays as front speaker and Secondary unit plays as rear surround speaker.

Turn on the Primary unit by pressing **power**. Turn on the Secondary unit by switching the Usage Mode Switch to REAR.

When disconnecting AC Adapter of Secondary unit, the audio output may be reduced.

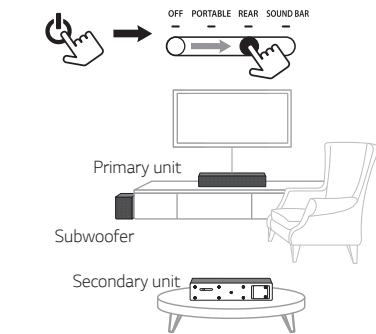

BLUETOOTH Connection (Secondary unit)

Select LG SJ7-2ND (xx) from device list to pair your mobile device.

When successfully Paired, Bluetooth LED turns on white with beep sound.

BLUETOOTH Connection (Primary unit)

- 1 Press **F** button to select the BT (Bluetooth) Function.
- 2 Select LG SJ7 (xx) from device list to pair your mobile device. When successfully Paired, "PAIRED" Your device's name "BT" appears in the display window in this order.

OFF usage mode

Primary unit plays alone without Secondary unit

Turn on the Primary unit by pressing **power**. Turn on the Secondary unit by switching the Usage Mode Switch to OFF.

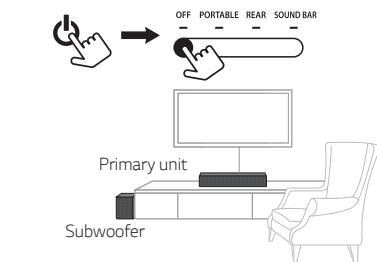

Charging the Unit

Before using it, charge the battery by connecting the AC Adapter. (Secondary unit only)

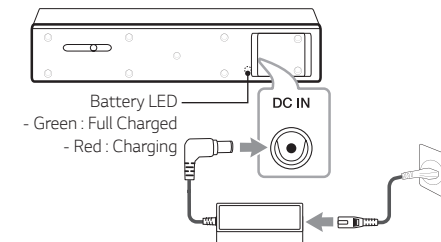

Connect the AC adapter applied a ferrite core to the secondary unit.

Remote control

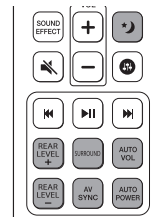

power: Turns down the volume at night.

REAR LEVEL +/-: Adjusts rear level of Secondary unit on the REAR usage mode.

SURROUND: Turns on/off Surround function.

AV SYNC: Synchronizes the audio and video.

AUTO VOL: Automatically adjusts too loud or low output volume level appropriately.

AUTO POWER: Automatically turns on by an input source.

Replacement of battery

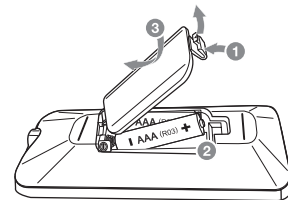

Additional Information

Specification

Power consumption	Refer to the main label.
AC adapter	<ul style="list-style-type: none">• Model : DA-38A25• Manufacturer : Asian Power Devices Inc.• Input : 100 - 240 V - 50 - 60 Hz• 1.2 A• Output : 25 V $\overline{\sim}$ 1.52 A
Dimensions (W x H x D)	Approx. 340 mm x 74 mm x 110 mm With foot (In each of Primary unit and Secondary unit)
Amplifier (Total RMS Output power)	320 W RMS (In state of connecting AC Adapter).
Operating time (Battery)	Approx. 4 hours (Varies by volume level and audio content.)

Design and specifications are subject to change without notice.

OPEN SOURCE SOFTWARE NOTICE INFORMATION

To obtain the source code under GPL, LGPL, MPL, and other open source licenses, that is contained in this product, please visit <http://opensource.lge.com>.

In addition to the source code, all referred license terms, warranty disclaimers and copyright notices are available for download.

LG Electronics will also provide open source code to you on CD-ROM for a charge covering the cost of performing such distribution (such as the cost of media, shipping and handling) upon email request to opensource@lge.com. This offer is valid for three (3) years from the date on which you purchased the product.

