

PACKAGE AIR CONDITIONERS INSTALLATION INSTRUCTIONS

Please read this instruction sheets completely before using the products

Applied Model:

(1) 28K/30K(Btu/h)

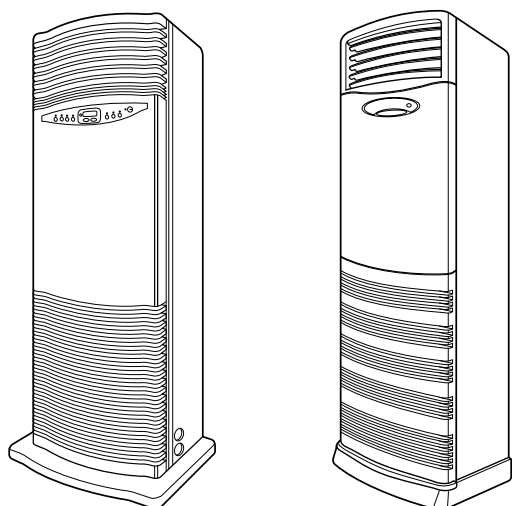

(2) 80K(Btu/h)

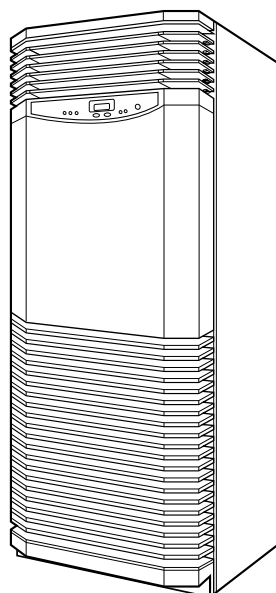

(3) 44K/50K(Btu/h)

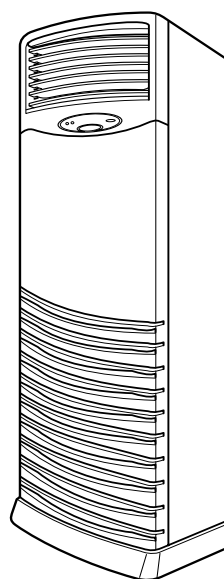
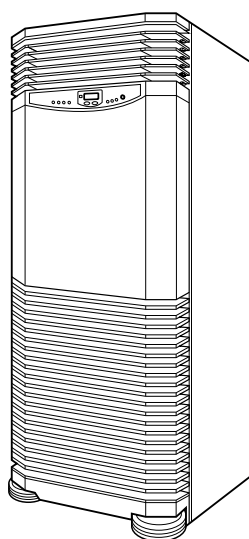

Contents

1. Installation of Indoor, Outdoor Unit	3
2. Connecting the Cable to Indoor Unit	4
3. Power Supply and Wiring	5
4. Checking the Drainage.....	6
5. Final Check and Test Run	7

Note.

Please, call the service center and ask an authorized personnel for installation, if you wish to install at a particular or another place.

1. Installation of Indoor, Outdoor unit

1) Selection of the best location

□ Indoor unit

- There should not be any heat source or steam near the unit.
- There should not be any obstacles to prevent the air circulation.
- A place where air circulation in the room will be good.
- A place where drainage can be easily obtained.
- A place where noise prevention is taken into consideration.
- Do not install the unit near the door way.
- Ensure the spaces indicated by arrows from the wall, ceiling, fence, or other obstacles.

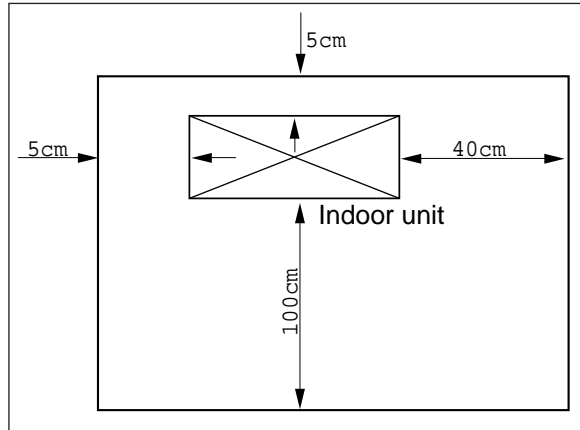

□ Outdoor unit

- If an awning is built over the unit to prevent direct sunlight or rain exposure, be careful that heat radiation from the condenser is not restricted.
- There should not be any animals or plants which could be affected by discharged hot air.
- Ensure the space indicated by arrows from the wall, ceiling, fence, or other obstacles.

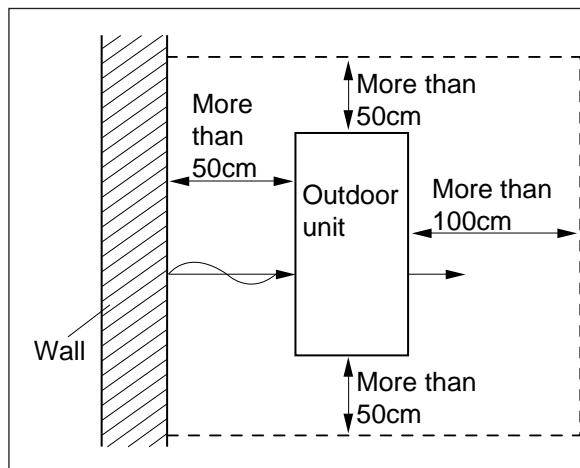

□ Piping length and the elevation

MODEL	Pipe Size		Max. length A (m)	Max. Elevation B (m)
	GAS	LIQUID		
28K/30K (BTU/h)	5/8"	3/8"	10	5
44K/50K (BTU/h)	50Hz	3/4"	15	7
	60Hz	3/4"		
80K (BTU/h)	3/4"	1/2"	15	7

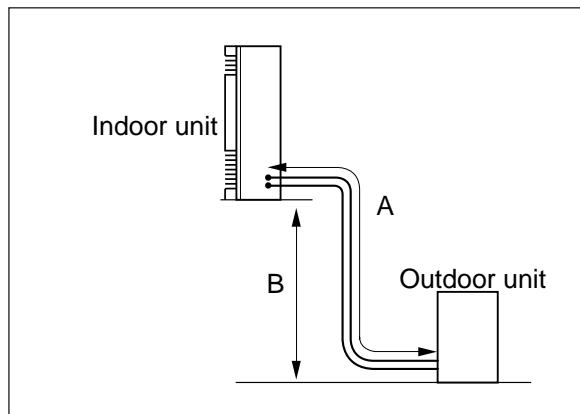

2. Connecting the Cable to Indoor Unit

The inside and outside connecting cable can be connected after opening the inlet grille.

- **Open the inlet grille manually.**

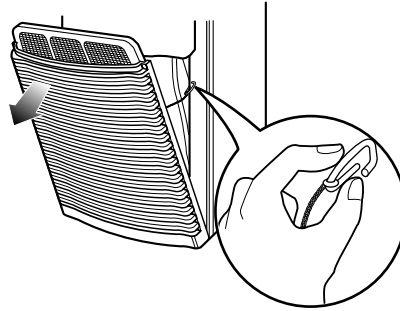

- **Open the control cover with a screw driver(§ 1).**

- **Connect the supplied cables to the connector in the control box. (Method "A") (Heat pump Mode only)**

- **Connect the supplied cables to the connector in the control box. (Method "B") (Cooling Model only)**

- **Secure the control cover to the original position with the screw.**

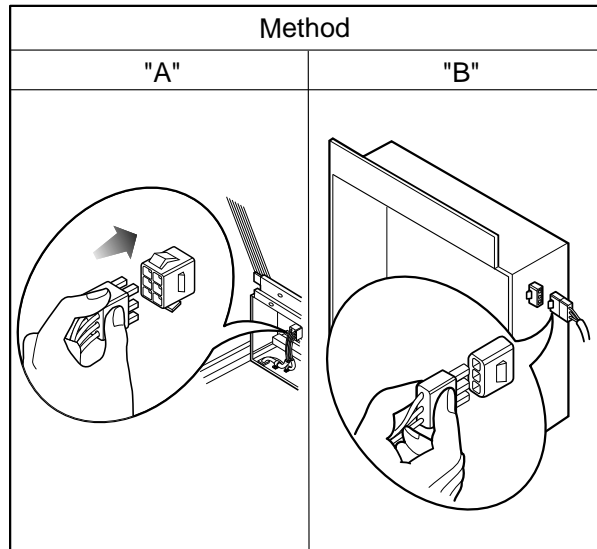

- **Close the inlet grille.**

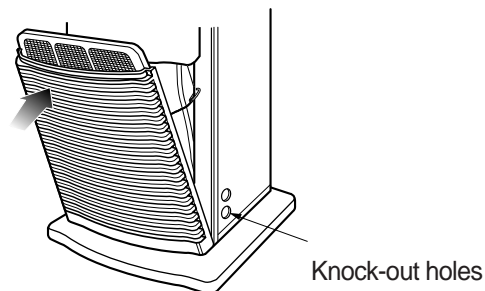

[Note] For an electric heater,
Perhaps there should be another cable.

In connecting the cable to the outdoor unit,
please connect it to the outside terminal block(6P or 4P) like the stickered wiring diagram.

3. Power Supply and Wiring

The unit is completely wired internally at the factory according to general rule of electrical technology, but local rules, if they are required, should be complied with.

1) Power supply

Power source must fulfill the following conditions:

- **The working voltage should be higher than 90% and lower than 110% of the rated voltage marked on the name plate.**
- **The starting voltage should be higher than 85% of the rated voltage marked on the name plate.**

UNIT	VOLTS	Conductor cross-sectional area	Outside diameter
28K/30K(H/P)	450/750V	4.0mm ²	13.3mm
28K/30K(C/O)	450/750V	2.5mm ²	11.8mm
44K/50K	450/750V	4.0mm ²	17.0mm
80K(C/O)	450/750V	4.0mm ²	17.0mm

- **Install a recognized circuit breaker as below between power source and unit. A disconnection device to adequately disconnect all supply lines must be fitted. (for service operations)**

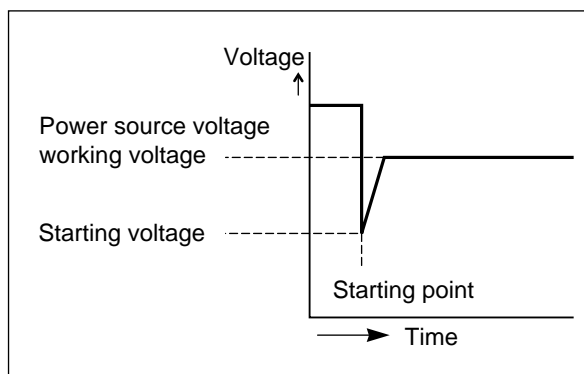

UNIT	Circuit breaker capacity
28K/30K(H/P)	30A
28K/30K(C/O)	20A
44K/50K	40A
80K(C/O)	50A

2) Wiring

After the confirmation of the above conditions, prepare the wiring as follows:

- **Use the power supply cord(TÜV or VDE approved rubber insulation : H07RN, rubber-neoprene type) suitable for the product's electrical capacity.**

- **The screws which fasten the wiring in the casing of electrical fittings are liable to come loose from vibrations to which the unit is subjected during the course of transportation. Check them and make sure that they are all tightly fastened. (If they are loose, it could give rise to burn-out of the wires.)**
- **See to it that the starting voltage is maintained at more than 90 percent of the rated voltage marked on the name plate.**
- **The following troubles would be caused by voltage drop-down. Vibration of a magnetic switch, damage on the contact point thereof, fuse breaking, disturbance to the normal function of a overload protection device.**

4. Check the Drainage

1) Checking the Drainage

- Remove the inlet grille with your hands as shown (right and left) and pull in the direction indicated by the arrow.

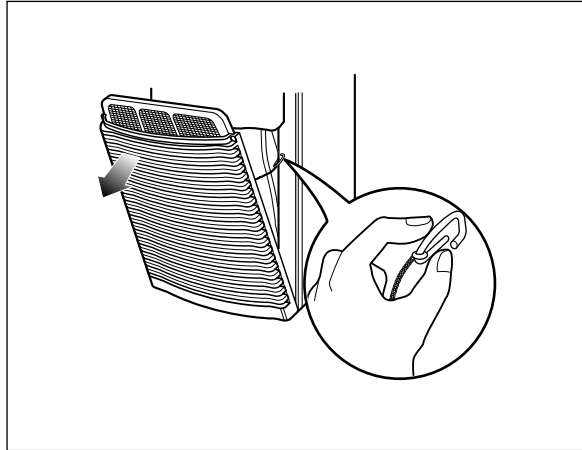

□ Check the drainage

- Pour a glass of water into the drain pan.
- Ensure if water flows drain hose of indoor unit.

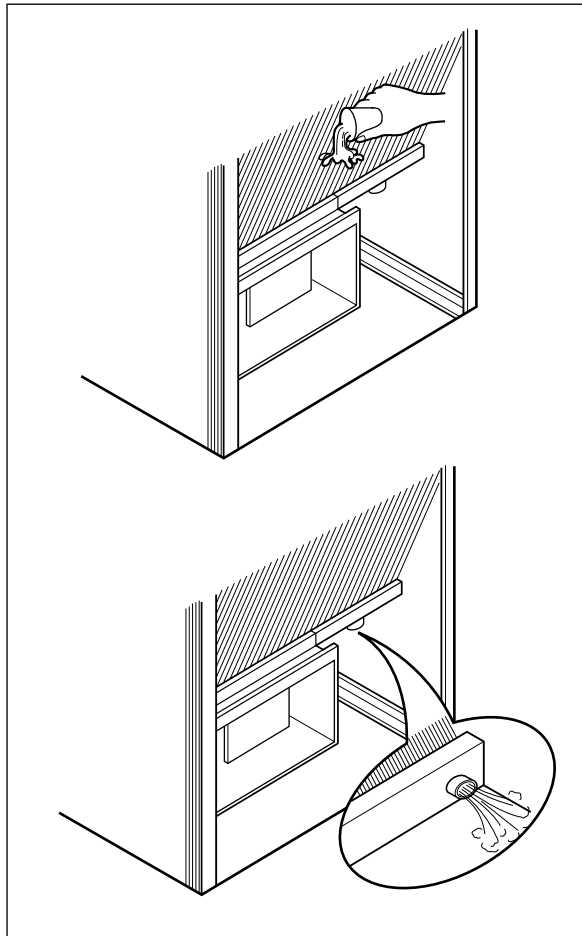

5. Final Check and Test Run

After installing the unit, perform the final check and running test as follows:

Final check points

- **Is the unit securely mounted?**
- **Is the installation location adequate?**
- **Is the water piping work adequately and without leakage?**
- **Are trapped drain lines installed at condensate drain connections?**
- **Has the refrigeration cooling cycle been kept sealed?**
- **Is the electrical wiring adequate and are the screws tightened on terminals?**

After the above final checkings, prepare the running test as follows:

- **Connect compound gauges to the check joints at discharge and suction sides of the compressor.**
- **Turn all switched "OFF".**
- **Turn the main switched "ON".**

Running test should be accomplished as follows:

- **Set operation switch at "FAN" and the fan will start. Check to ensure that the fan sounds normal.**
- **Next, set it at "COOL" and the compressor will start. Check to ensure that the compressor sounds normal.**
- **Check discharge and suction pressure on the compound gauges.**
- **Check working voltage, phase balance and running current.**
- **Check to ensure that the thermistor functions properly.**
- **Check to ensure that the high pressure control switch functions correctly.**