



Washing Machine

OWNER'S MANUAL

MODELS : WF-552S(C)PC
WF-552S(C)PP
WF-552S(C)PH



Please read this manual carefully before operating your set.
Retain it for future reference.
Record model number and serial number of the set.
See the label attached on the back cover and quote this
information to your dealer when you require service.

CONTENTS

FEATURES	3
PARTS IDENTIFICATION.....	4
NAMES OF THE FUNCTION SELECTORS	5
INSTALLATION.....	6~8
NORMAL WASH PROGRAM.....	9
OTHER WASHING PROGRAMS	10~11
RESERVATION WASHING PROGRAM.....	12~13
SELECTABLE WASHING METHODS	14
MAINTENANCE	15
GUIDANCE FOR SAFETY AND DURABILITY	16
TROUBLE-SHOOTING GUIDE	17~18
SPECIFICATION.....	19

FEATURES

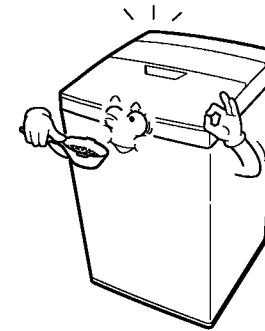

TELL YOU JUST HOW MUCH DETERGENT IS NECESSARY

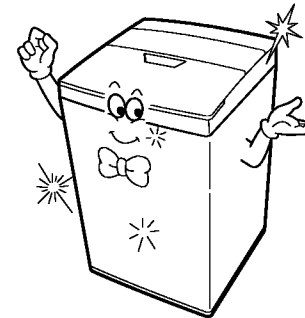

ELEGANTLY ROUNDED DESIGN

Adds more sophisticated touch to comfortable uses.

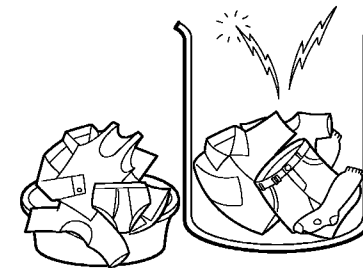

WASHING ADJUSTED TO LOAD VOLUME

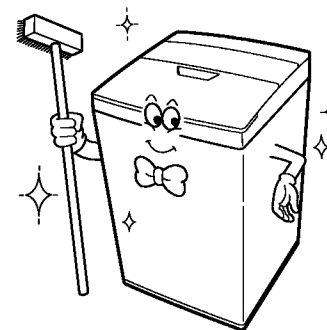

ANTISEPTIC WASH

Antimicrobial additive which restrains mold or mildew from growing around the tub is applied to the washing tub for cleaner wash.

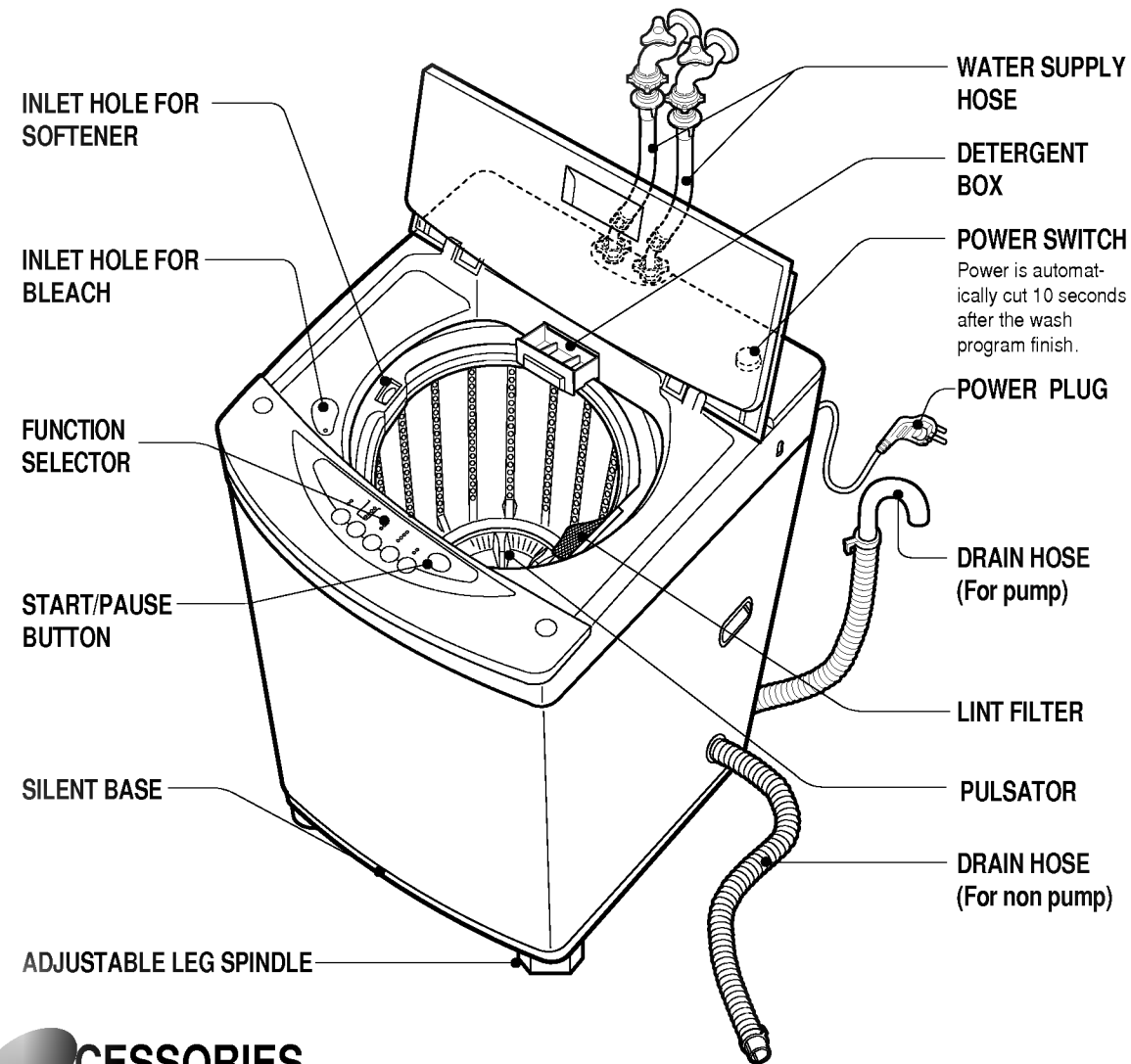

ACCESSORIES

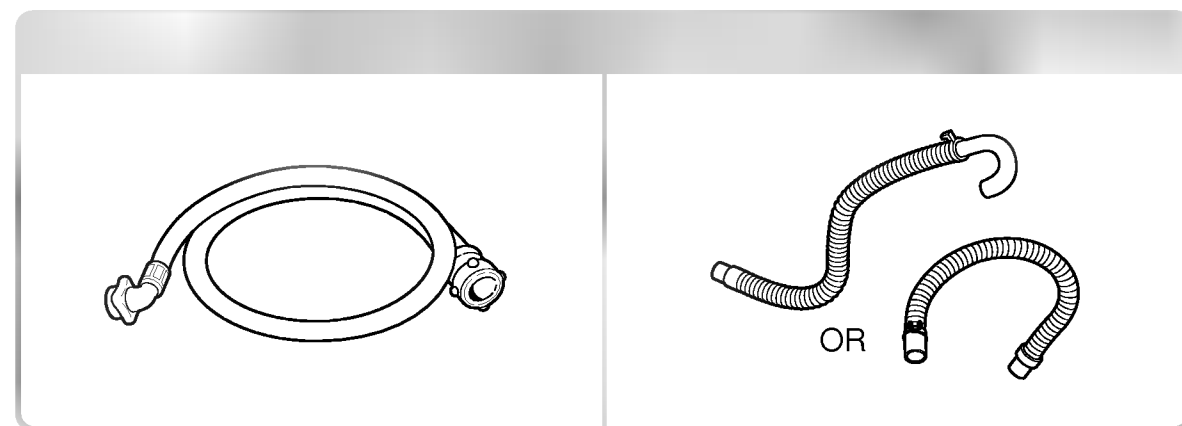

- INDICATOR LAMP ○ OFF ● ON ☀ BLINK
- EXAMPLE [] OPTION

WATER TEMP.

- Used to select proper water temperature of washing water.

DETERGENT VOLUME

- Used to select proper amount of detergent for the water level.

PROCESS SELECTOR

- Used to select the desired function among WASH, RINSE and SPIN.
- If the [water supply] lamp is turned on, the water supply rinse is executed. (For non-pump only)

START/PAUSE SELECTOR

- Use to start or stop the washing machine temporarily.
- After 10 minutes in pause state, the power is automatically turned off.

WATER LEVEL SELECTOR

- Used to select the proper amount of water in relation to the weight and type of laundry.
- Controlled automatically in the normal wash program.

PROGRAM SELECTOR

- According to laundry and stain you can select suitable program yourself.
- By pressing the button washing program changes in order of [NORMAL(FUZZY) → ECONOMY(SPEED) → SOAK → WOOL → NORMAL(FUZZY)].

RESERVATION

- Press this button for reservation.
- Select how many hours from now you would like your wash to finish [6 → 9 → 6] repeat.
- To cancel delay time, turn the power switch off.

INSTALL THE WASHING MACHINE ON FIRM AND EVEN PLACE

- Install the washing machine on a flat and firm surface.
- Keep the washing machine over 10cm away from the wall to prevent a noisy sound while spinning.

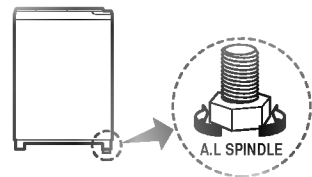

- When washing machine does not even adjust A.L. spindle.
- Turn the A.L. spindle CCW or CW and adjust level.

CONNECT THE DRAIN HOSE

■ PUMP MODEL

- Connect the drain hose to the outlet of the drain pump located at the back side of the washing machine.

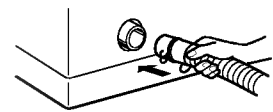

- Fix the drain hose with the clip. And then push it toward the body as in the figure.

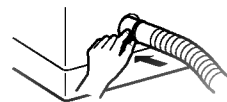

- Check out if the drain hose is hung up to proper location for drainage.
- Do not use an extension hose.
- The discharge height is approximately 0.9~1.3m from the floor.

■ NON-PUMP MODEL

- Connect the drain hose to the outlet of the drain hose located at the right hand side of the washing machine.

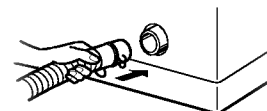

- * Keep downward while the washing machine is working. (Non pump)
- * Ensure the hose is free from kinking.

CHANGE THE DIRECTION OF THE DRAIN HOSE FOR NON-PUMP MODEL

- 1 Unfasten the set screw which secures the drain hose joint, and then push the inside drain hose into the body.

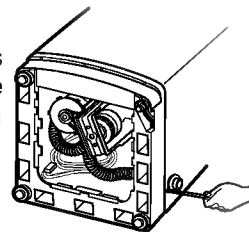

- 2 Change the direction of the drain hose to the hole of the opposite side.

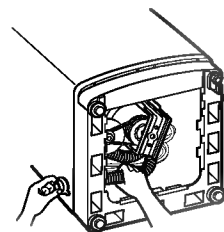

- 3 Fasten the set screw to secure the drain hose joint.

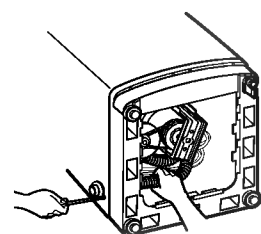

CONNECT THE INLET HOSE

- How to connect the hose of one touch type.

Used the horizontal faucet.

Horizontal faucet



Extension faucet



Square faucet



- 1 Untighten the upper connector screw.

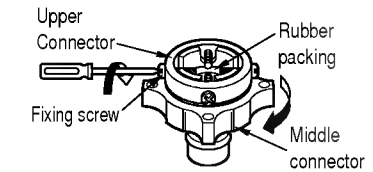

- In case the diameter of the faucet is large remove the guide plate.

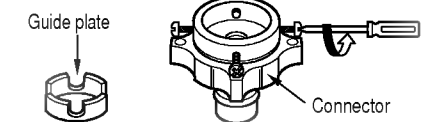

- 2 Push the upper connector up till the rubber packing is in tight contact with the faucet. Then tighten the 4 screws.

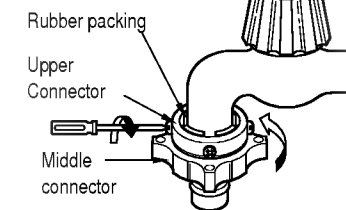

- Turn the middle connector not to have water leaked.

- 3 Connect the water supply hose to the middle connector, pushing the plate down.

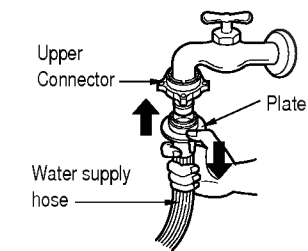

- To separate the water supply hose from the middle connector shut off the faucet. Then pull the inlet hose down, pushing the plate down.

- Connect the inlet hose to inlet valve of the washing machine, and then lock it by turning the hose connecting part. Check to see if there is a rubber seal inside the connector.

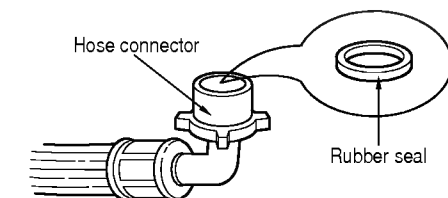
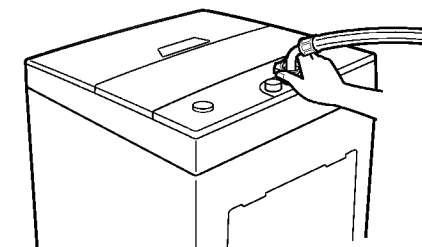

INSTALLATION

How to connect the hose of Nut type

- Turn the inlet Nut to the right hand direction as shown in the below figure. Tighten it firmly to prevent water leakage.
- Connect the other end of the hose to the water valve on washer securely.
- Make sure that the rubber packing is inside the union nut.

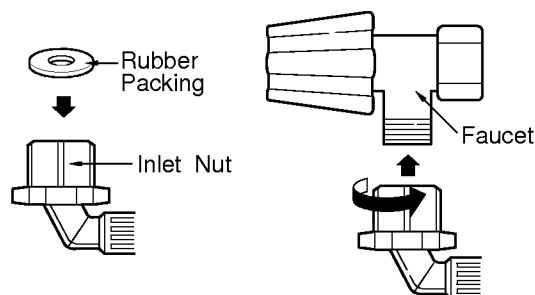

GROUND THE EARTH WIRE

- Earth wire is installed to prevent electric shock caused by the current leakage.
- Earth wire is secured on the back side of the washing machine. Connect the earth wire to a metal faucet. In case the earth wire is connected to a plastic faucet, no effect is expected. When an earth wire is in the power cord assembly, an additional earth wire does not need.

CAUTION

- Ground before the power plug is connected to the wall outlet.
- Never connect the earth wire to a gas pipe, a phone wire and a lightning rod.
- If the power supply cord is damaged, it must be replaced by a special cord or assembly available from the manufacturer or its service agent. All material used for enclosing the power supply cord connection have to be retained as origin after any services.
- The base openings must not be obstructed by carpeting, when the washing machine is installed on a carpet floor.

PREPARATION BEFORE WASH

<ul style="list-style-type: none"> ● Check if laundry is washable in water. 	<ul style="list-style-type: none"> ● Be sure to remove things such as keys, pins and coins from the laundry. 	<ul style="list-style-type: none"> ● Wash oily or dyed laundry separately. 	<p>READY?</p> <ul style="list-style-type: none"> ● Plug the power plug into the outlet. ● Let water flow into the tub after connecting the inlet hose with the faucet.
<ul style="list-style-type: none"> ● Shake loose dirt off before washing. 	<ul style="list-style-type: none"> ● Wash fluffy laundry by turning it inside out. 	<ul style="list-style-type: none"> ● Wash delicate clothes, wrapping them in a nylon net. 	

NORMAL WASH PROGRAM

NORMAL WASH (FUZZY)



- Wash normal clothes except for a blanket, woolen clothes, lingerie.
- Operate WASH, RINSE, SPIN by pressing the process button.

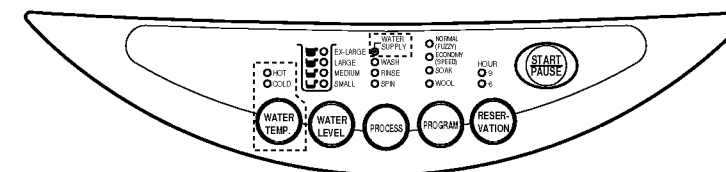

WASHING PROCEDURE

- 1 Press the power switch.

POWER

 - Normal wash indicator lamp illuminates when the power is on.
 - All selection changes are possible.
- 2 Put laundry and detergent in the tub.
- 3 Begin.

START/PAUSE

 - Press the START/PAUSE button.
 - Press the START/PAUSE button again to stop operation temporarily (Washing operation resumes by pressing the START/PAUSE button again.)
 - Select WASH, RINSE or SPIN convertible.

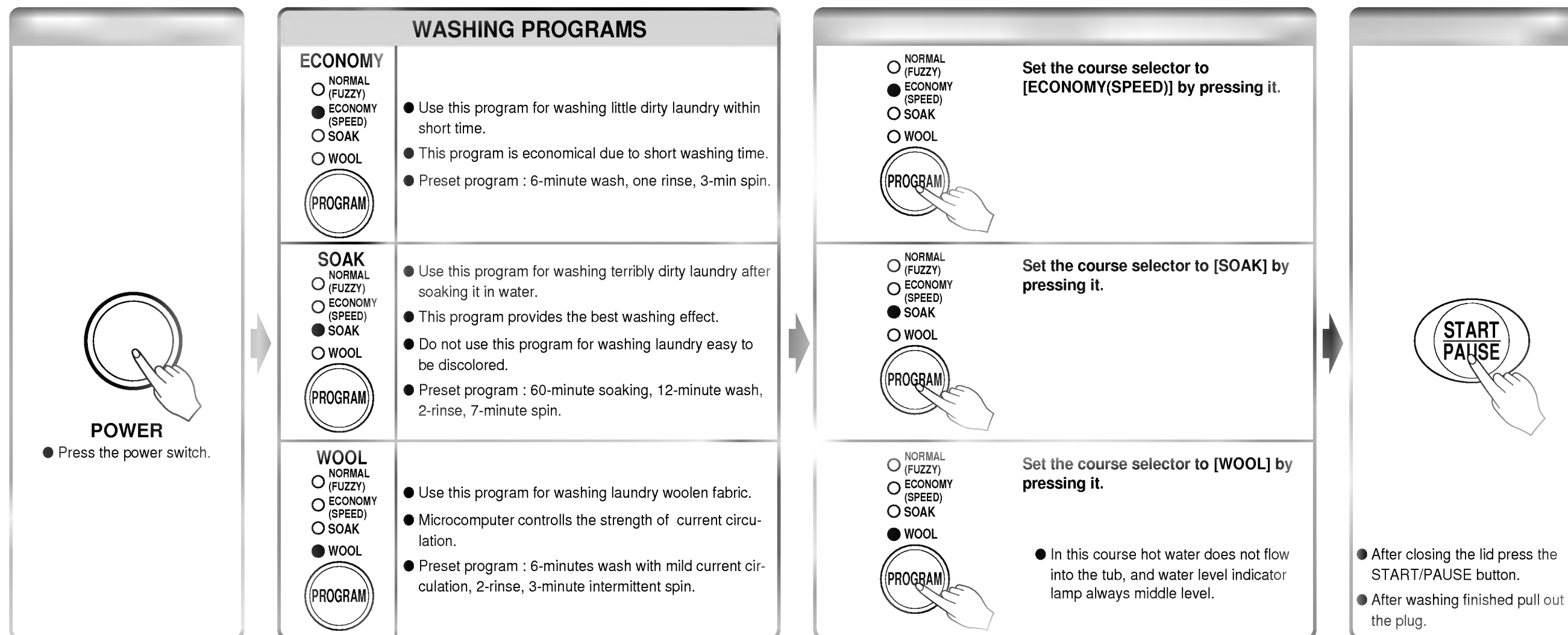

- * When you would like to change washing conditions, select them manually.
- * Preset programs mentioned above can be changed without notice.

- Take out laundry.
- Dry woolens in shade.
- Plug out the power plug.
- Lock the faucet, and separate the connection hose.
- Clean the washing machine.

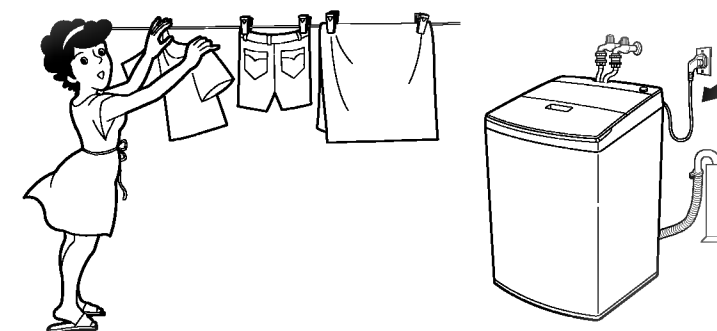

RESERVATION WASHING PROGRAM

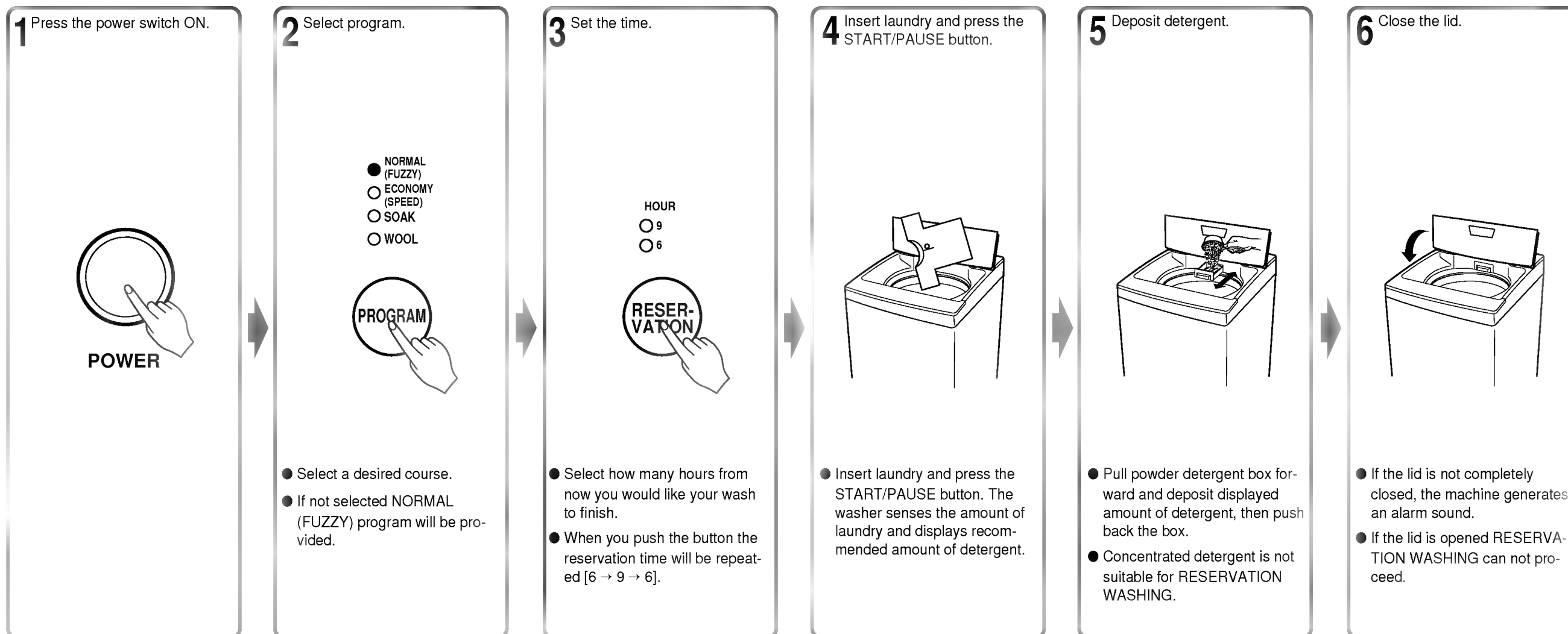

- Select a desired course.
- If not selected NORMAL (FUZZY) program will be provided.

- Select how many hours from now you would like your wash to finish.
- When you push the button the reservation time will be repeated [6 → 9 → 6].

- Insert laundry and press the START/PAUSE button. The washer senses the amount of laundry and displays recommended amount of detergent.

- Pull powder detergent box forward and deposit displayed amount of detergent, then push back the box.
- Concentrated detergent is not suitable for RESERVATION WASHING.

- If the lid is not completely closed, the machine generates an alarm sound.
- If the lid is opened RESERVATION WASHING can not proceed.

CAUTION

- A wet drawer may cause the detergent to clump together.
- Do not use powdered hand soap.
If the lid is open, the machine will not operate and an error warning will occur.
- When you would like to cancel this program press the POWER switch OFF.

SELECTABLE WASHING METHODS

ONLY WASHING

● Press the power switch. ● Set the WASH position press the PROCESS button. ● Press the START/PAUSE button after closing the lid. ● Wash ends. (At this time the water in the tub does not drain.)

ONLY RINSE

If selecting "Rinse Only", insert Fabric Softener at the last cycle of rinsing.

● Press the power switch. ● Set the RINSE position press the PROCESS button. ● Press the START/PAUSE button after closing the lid. ● Rinse ends. (At this time the water in the tub does not drain.)

ONLY SPIN

● Press the power switch. ● Set the SPIN position press the PROCESS button. ● Press the START/PAUSE button. ● Spin ends.

MAINTENANCE

□ Clean the filter in the inlet valve. When water supply into the tub is bad or the inlet valve is clogged with impurity.

- 1 Plug out the power cord from the outlet first.
- 2 Pull out the filter from the inlet valve with fingers.
- 3 Use a tooth brush to get rid of filth. Insert the filter.

□ Clean the water thread collection net.

- 1 Pull out the waste thread collection net from the tub like the arrow direction below.
- 2 Turn inside out to get rid of filth.
- 3 Insert it to the original location.

□ Clean the pump casing (when drainage is bad).











- 1 Unfasten 2 screws of the back cover.
- 2 Turn the cap to the arrow direction (CCW) and unfasten it.
- 3 Reassemble the cap to the arrow direction (CW) and fasten it.

(Bottom view) (Bottom view)

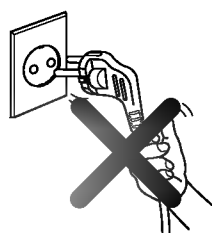
* CAUTION : Check to see if water leaks after reassembling. (Rubber ring is in the cap)

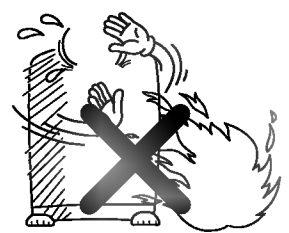
GUIDANCES FOR SAFETY AND DURABILITY

□ Observe the following guidances for the durability of the washing machine and safety problems.

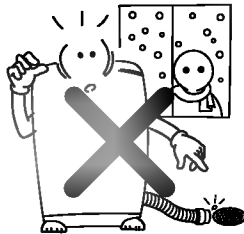
<p>● Do not expose the washing machine to a direct sunlight or rain.</p> 	<p>● Do not install the washing machine around a damp place.</p> 	<p>● Do not sprinkle water over switches.</p> 
<p>● Do not plug many cords in one outlet at the same time.</p> 	<p>● When plugging out the power cord, do not hold the wire.</p> 	<p>● Have children stay away from the washing machine.</p> 
<p>● Keep the washing machine away from fire or heat source.</p> 	<p>● Do not pour caustic soda and bleach over the washing machine. It causes damage to rubber parts.</p> 	<p>● Do not pour over 70°C water into the tub</p> 
<p>● Make sure of closing the lid, In particular during spinning.</p> 	<p>● Do not put hands into the rotating tub.</p> 	<p>● Let water drain away from the drain hose thoroughly.</p> 

TROUBLE-SHOOTING GUIDE

No water supply.

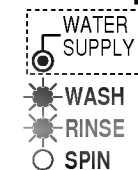

Process indicator lamp flickers (Wash, Rinse) when water does not flow in the tub.

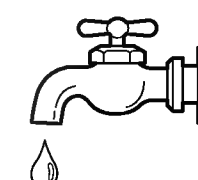

Is not the water faucet shut off?

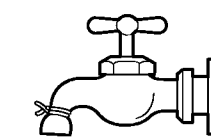

Is not the water supply cut off?

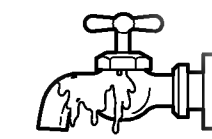

Is not the faucet frozen?

No drain.

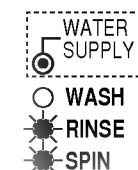

Process indicator lamp flickers (Rinse, Spin) when no drain is done.

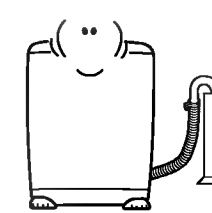

Check out if electric power goes off.

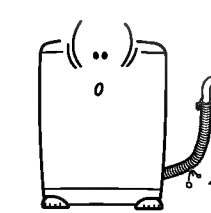

Is not the drain hose frozen?

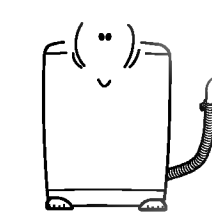

Is the drain hose hung up properly? The proper height of stand pipes is 0.9~1.3m (For pump)

No spinning.



Process indicator lamp flickers (Wash, Rinse, Spin) when tub does not spin.

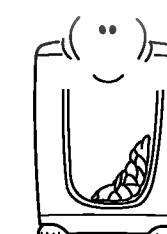

Is the laundry unevenly balanced?



Is the lid closed?

TROUBLE-SHOOTING GUIDE

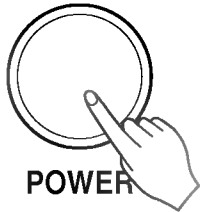
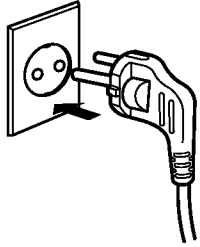
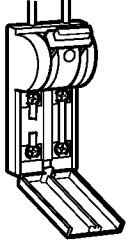
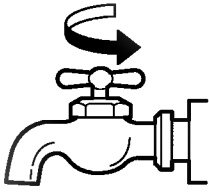
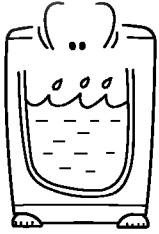
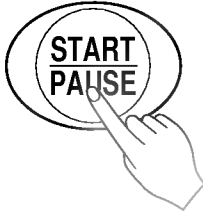
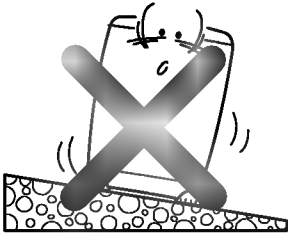
<p>No power.</p>	<div style="display: flex; justify-content: space-around; align-items: center;"> <div style="text-align: center;">  <p>Is the power switch pressed?</p> </div> <div style="text-align: center;">  <p>Is the power cord unplugged?</p> </div> <div style="text-align: center;">  <p>Power failure? Fuse blown?</p> </div> </div>
<p>No working.</p>	<div style="display: flex; justify-content: space-around; align-items: center;"> <div style="text-align: center;">  <p>Is not the water faucet shut off?</p> </div> <div style="text-align: center;">  <p>Is the water level normal?</p> </div> <div style="text-align: center;">  <p>Has the START/PAUSE button been pressed?</p> </div> </div>
<p>The high level of vibration and noise during spinning.</p>	<div style="text-align: center;">  <p>Is the washing machine installed on a level place?</p> </div>

SPECIFICATION

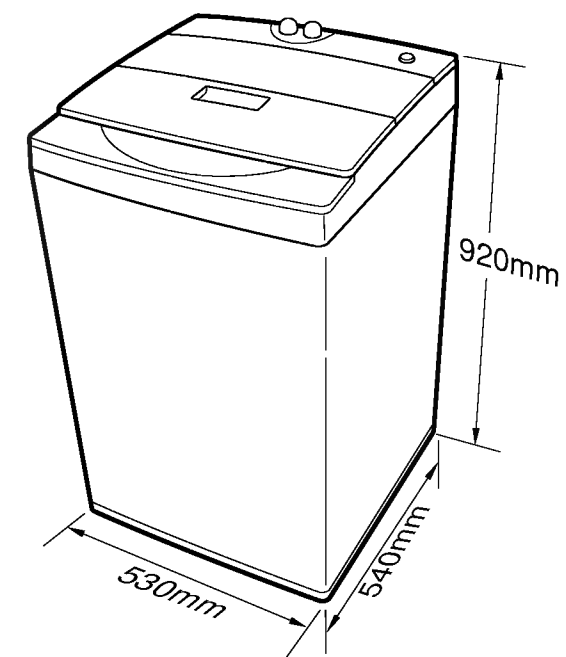

- ELECTRICITY SOURCE : ON THE RATING LABEL
- THE USE RANGE OF WATER PRESSURE : 0.3~10kgf/cm² (30~1000kPa)
- MOTOR OUTPUT : 90W
- WEIGHT : 32 kg
- SIZE : 530(W) × 540(D) × 920(H)
- STANDARD WATER LEVEL : EX-LARGE : 47 ℓ
LARGE : 39 ℓ
MEDIUM : 29 ℓ
SMALL : 21 ℓ