

GoldStar

Upright Vacuum Cleaner Owner's Manual

MODEL: V-7515T
V-7513T

Website: <http://www.LGService.com>

E-mail: <http://www.LGService.com/techsup.html>

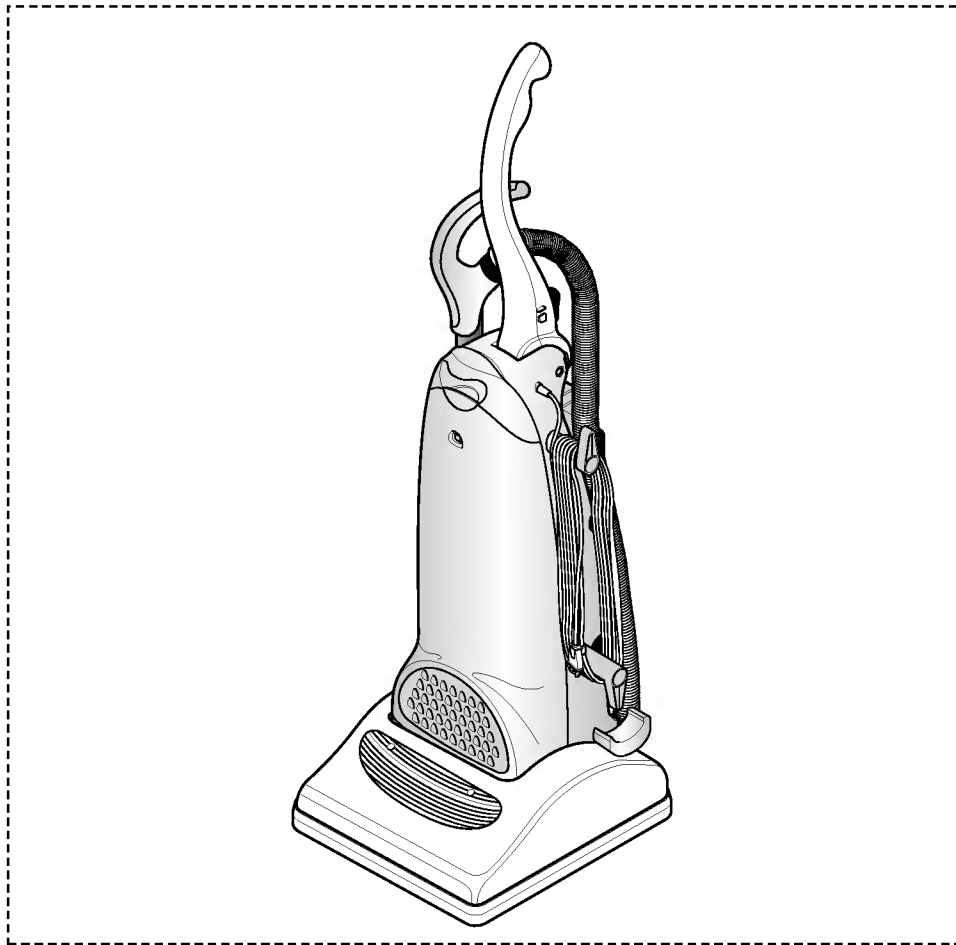

**PLEASE READ THIS MANUAL
THOROUGHLY AND CAREFULLY
BEFORE OPERATING THE CLEANER**

TABLE OF CONTENTS

IMPORTANT SAFEGUARDS	3
ASSEMBLING CLEANER.....	4
- STEP 1. UNPACK CARTON.....	4
- STEP 2. ASSEMBLE HANDLE.....	5
- STEP 3. ATTACH TOOLS.....	5
CLEANER DESCRIPTION	6
SPECIAL FEATURES.....	7
- Automatic Adjusting Nozzle	7
- Folding Handle	7
- Using Attachment	7
- Edge Cleaning Feature	7
OPERATION.....	8
- Important Safety Tips	8
- On/Off Switch	8
- Body Positions	8
- Transporting Cleaner	9
- Using the Cord Hanger	9
- Using Cord Hook.....	10
- Carpet/Bare Floor Selector	10
- Using Attachments	11
REMOVING CLOGS.....	12
- Hose/Connect Pipe	12
- Extension Wand.....	12
- Short Hose	12
REPLACEMENT INSTRUCTIONS	13
- Replacing the Head Light Bulb.....	13
- Removing/Installing the Bottom Plate	13
- Replacing Belt and/or Agitator	14
- Replacing HEPA Filter	14
- Replacing Micron Filter	14
- Replacing Dust Bag	15
- Replacing Clean Filter.....	15
MAINTENANCE.....	16
- Cleaning Agitator.....	16
SPECIFICATIONS	16
BEFORE REQUESTING SERVICE.....	17
GOLDSTAR LIMITED WARRANTY	18

IMPORTANT SAFEGUARDS

When using GoldStar upright vacuum cleaners, basic safety precautions should always be followed to reduce the risk of fire, electric shock, and injury to persons, including the following.

READ ALL INSTRUCTIONS BEFORE ASSEMBLING OR USING THIS APPLIANCE

WARNING: To reduce the risk of fire, electric shock, or injury:

1. Disconnect power supply before servicing and/or cleaning the unit.
2. Do not leave appliance plugged in. Unplug from outlet when not in use or before servicing.
3. Do not use outdoors or on wet surfaces. Do not pick up water or wet materials.
4. Do not handle plug or appliance with wet hands.
5. Do not allow it to be used as a toy. Close attention is necessary when used by or near children.
6. Use only as described in this manual. Use only attachments recommended by manufacturer.
7. Do not use with damaged cord or plug. If the supply cord is damaged, it must be replaced by the manufacturer or an Authorized Service Center or a similarly qualified person in order to avoid a hazard.
8. Do not pull or carry by the power cord as a handle, close door on cord, or pull the cord around sharp edges or corners. Do not run appliance over the cord. Keep the cord away from heated surfaces.
9. Do not unplug by pulling the cord. To unplug, grasp the plug, not the cord.
10. Do not put any object into openings. Do not use with any opening blocked. Keep free from dust, lint, hair and anything that may reduce air flow.
11. Keep hair, loose clothing, fingers, and all parts of body away from the openings and moving parts.
Do not use vacuum cleaner to pick up sharp, hard objects, small toys, pins, etc.
12. Do not pick up anything that is burning or smoking, such as cigarettes, matches, or hot ashes.
13. Do not use to pick up flammable or combustible liquid or vapors such as gasoline or use in areas where they may exist.
14. Do not use vacuum cleaner without dust bag and/or filters in place.
15. Always turn off all controls before unplugging.
16. Do not keep vacuum cleaner on chairs, tables, etc. Extra care must be taken when cleaning stairs.
17. Always unplug the unit or turn off the switch when the unit automatically stops unintentionally. If not, cleaner could re-start unintentionally.

Polarized plug: This appliance has a polarized plug (one blade is wider than the other). As a safety feature to reduce the risk of electric shock, this plug is intended to fit in polarized outlet only one way. If the plug does not fit fully into the outlet, reverse the plug. If still does not fit, contact a qualified electrician. Do not attempt to defeat this safety feature.

SAVE THESE INSTRUCTIONS
THIS PRODUCT IS FOR HOUSEHOLD USE ONLY

ASSEMBLING CLEANER

STEP 1: UNPACK CARTON

Remove all parts from carton and identify each items as shown in figure.
Make sure all parts are located before disposing of carton box.

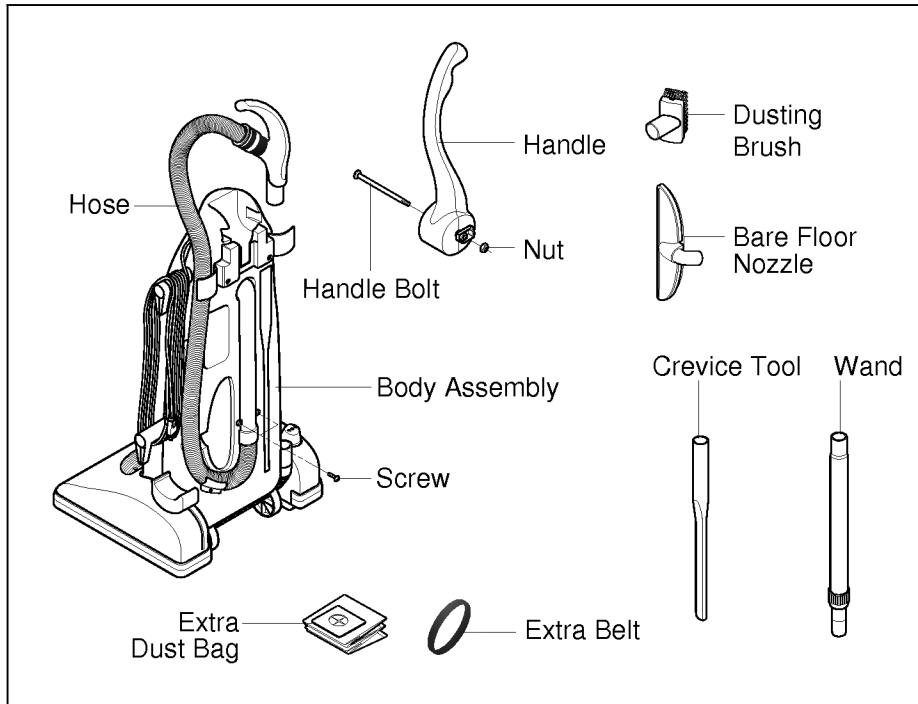

ASSEMBLING CLEANER

STEP 2: ASSEMBLE HANDLE

Insert rotating shaft of handle into the slots of upper part of body. (Fig.A)

In the hole for handle bolt, insert handle bolt, aligning centers of holes. (Fig. B)

Insert nut for the hole of nut. Tighten bolt securely. (Fig. C)

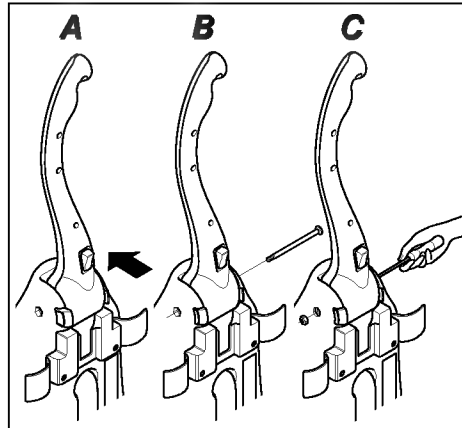

STEP 3: ATTACH TOOLS

Position the dusting brush and the bare floor nozzle into the slots in body assembly.

Make sure that the crevice tool is in the proper position.

Arrange the hose as shown in figure D and connect grip handle with the extension wand. (Fig. A)

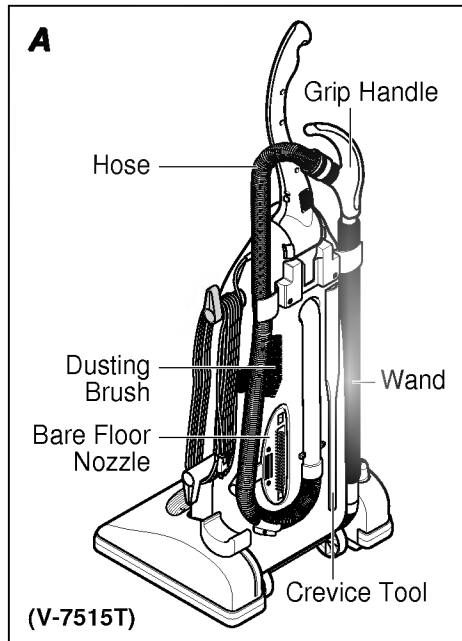

CLEANER DESCRIPTION

After assembly, the cleaner will look like the picture below.

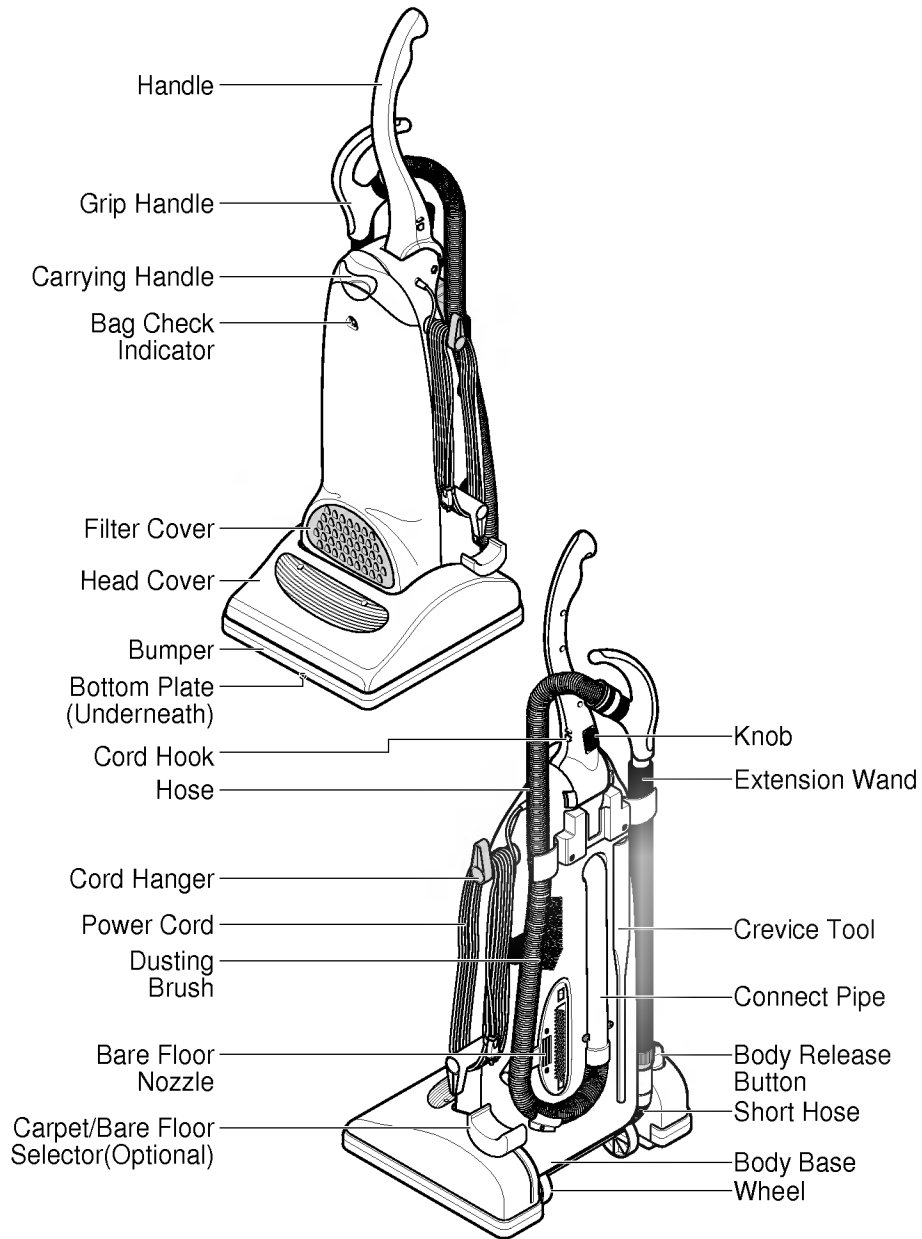

SPECIAL FEATURES

Automatic Adjusting Nozzle

Your GoldStar upright vacuum cleaner is designed with an automatic adjusting nozzle. No manual adjustments are required. The height of nozzle is instantly and automatically adjusted to any carpet pile height.

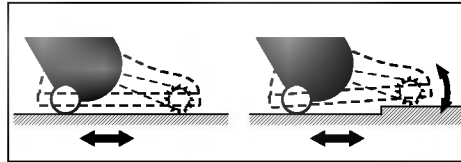

Folding Handle

Your GoldStar upright vacuum cleaner is designed with a folding handle. The handle can be folded downward for storage.

First, remove the grip handle from extension wand and place the hose on the rear of vacuum cleaner.

To fold handle pull the knob of handle up and lower the handle backward.

This feature makes storing vacuum cleaner in a limited area more convenient.

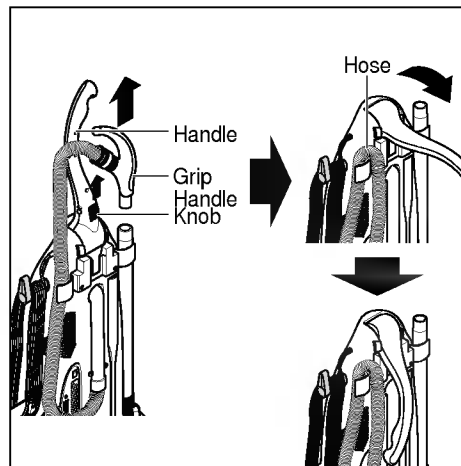

Using Attachment

The hose is connected to the lower part of the body to make the cleaner less likely to turn over while using the hose. With this feature, attachments connected to hose can be used more easily.

Edge Cleaning Feature

Edge cleaning provides for improved cleaning of carpets near walls and furniture.

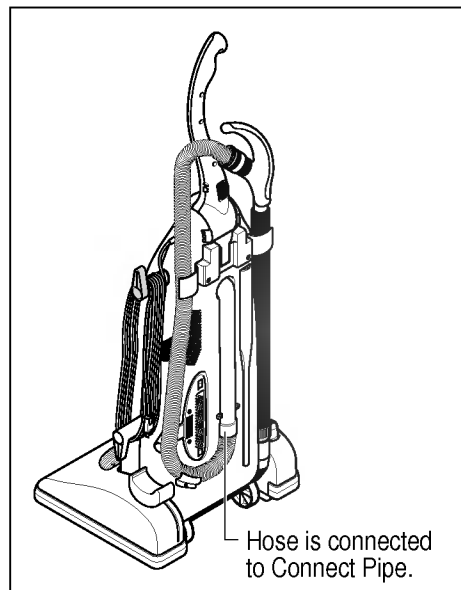

OPERATION

Important Safety Tips

Before you plug in your vacuum cleaner, make sure that the voltage indicated on the rating label of the vacuum cleaner is the same as your local supply.

On/Off Switch

Plug the power cord to operate cleaner.

I is marked on ON position.

0 is marked on OFF position.

When cleaner stops automatically, always turn off the switch and unplug the unit before checking.

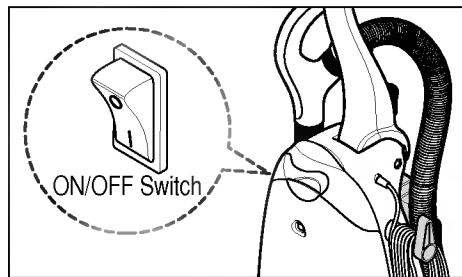
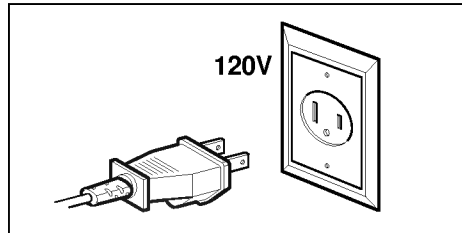

Body Positions

The body may be adjusted to any position required. Incline the body backward with the handle, step on the body release button as shown in figure.

Then remove your foot from button. The body is released to move up and down freely. Adjust the body to any position you required.

When cleaning under furniture, parallel position may be used.

To get to the parallel position, press the body release button again.

To store cleaner or use attachments, set the body to the upright position.

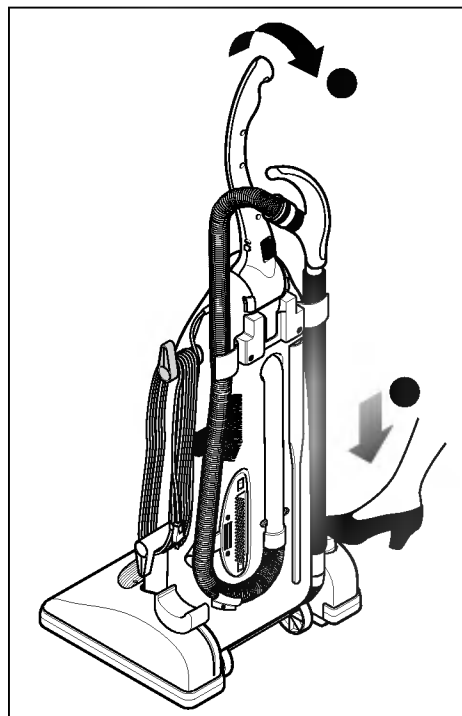

OPERATION

Transporting Cleaner

To move your cleaner from room to room, put the handle in upright position, tilt the cleaner back on its rear wheels, and push forward.

The cleaner can also be moved by lifting it, as shown.

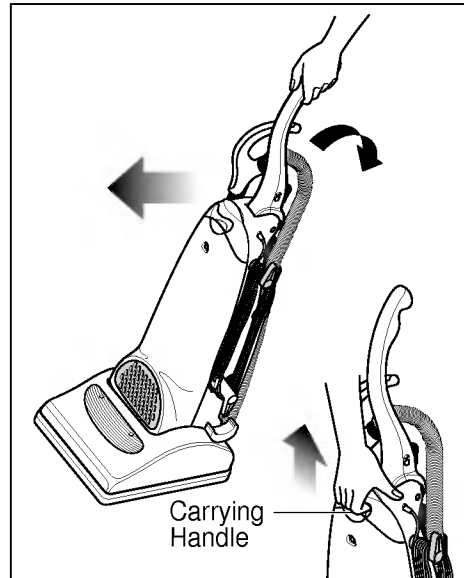

Using the Cord Hanger

The upper cord hanger has a quick-release action. To release the power cord, rotate the hanger downward and the entire power cord will drop off the hook for immediate use.

Do not unplug the cord by pulling on the cord. Grasp the plug head and pull to unplug the vacuum cleaner.

Return the hanger to the upright position before attempting to rewind the cord.

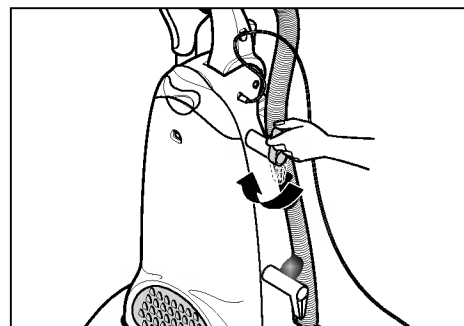
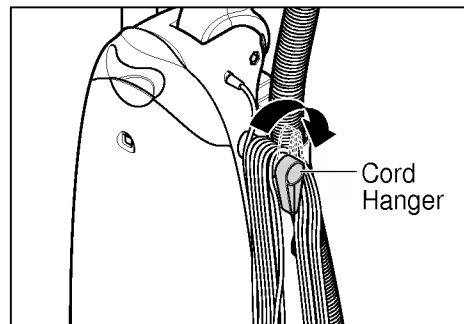

OPERATION

Using Cord Hook

There is a recessed area on the handle, designed to secure the power cord during vacuuming.

Insert the power cord into this groove to help keep the power cord from hanging and being damaged by agitator or other moving parts.

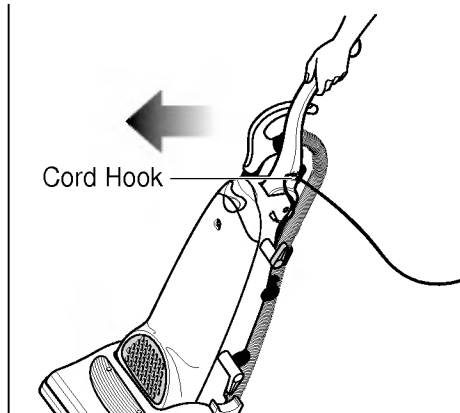

Carpet/Bare Floor Selector

(for model V-7515T)

To use cleaner on bare floors, the carpet/bare floor selector should be adjusted to the position as shown in the figure. The selector should be rotated down toward the bottom of the nozzle until it locks into place.

; Remember, the floor position is down by the foot.

To use attachments, set the selector on Bare Floor position. In this position, the agitator does not run.

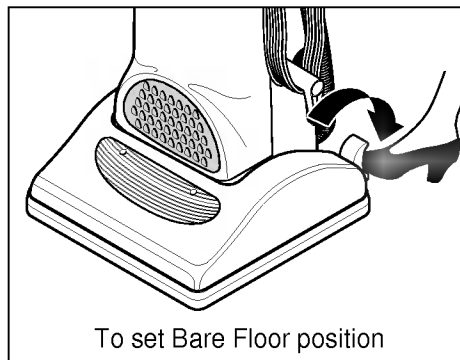

To use the cleaner on carpet, the selector should be moved to the Carpet position. In this position, the agitator will run.

When selecting either position, the selector should be pushed fully and quickly as possible to desired position.

Failure to do so can cause the belt to rub on the motor shaft and may result in overheating the belt and causing a burned rubber smell.

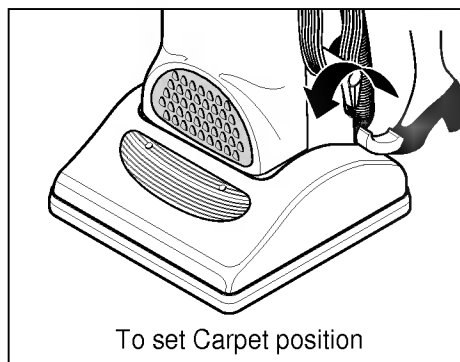

OPERATION

Using Attachments

To use attachments, place the vacuum cleaner in the upright position.

Set the carpet/bare floor selector to the Bare Floor position. (Fig. A)
(for model V-7515T)

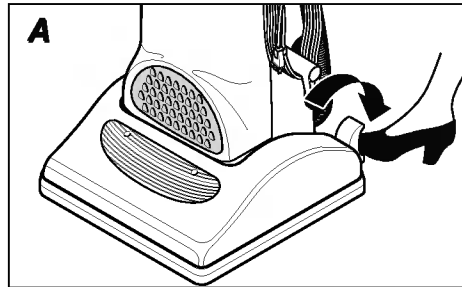

Pull the extension wand off the body. (Fig. B)

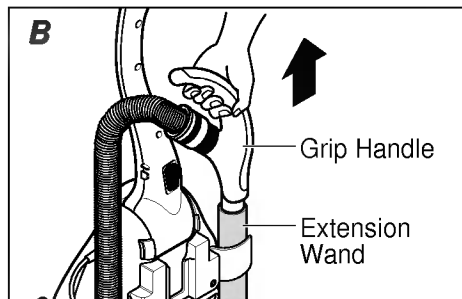

Turn the adjusting ring to make the wand move freely and adjust the wands to the desired length. Then turn the adjusting ring in the opposite direction to lock wands. When you need to control suction power, adjust control cover. (Fig. C)

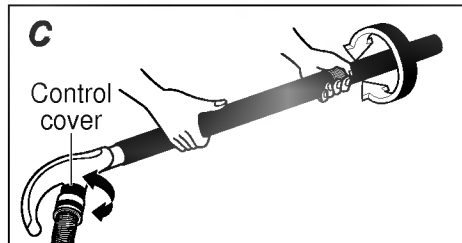

Remove and connect the desired attachment, such as bare floor nozzle, dusting brush, or crevice tool. (Fig. D)

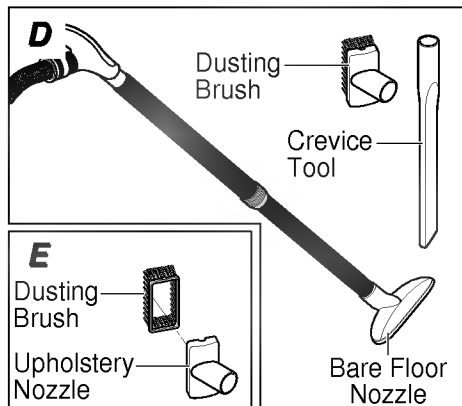

The dusting brush has two options. When the front brush is removed, the remaining part can be used as a upholstery nozzle. (Fig. E)

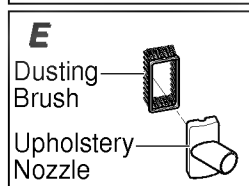

REMOVING CLOGS

WARNING: Unplug the unit to avoid electric shock when servicing.

When the hose or extension wand is clogged:

Hose/Connect Pipe

Unplug the power cord from outlet before checking. Unscrew and pull the end of Connect Pipe out to allow hose to come out. Remove hose to check.

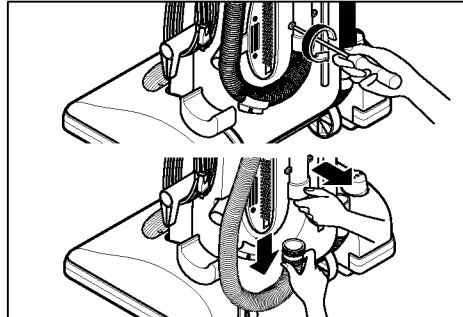

Extension Wand

Disconnect grip handle from extension wand to check. (Fig. A)

Remove the extension wand from the main body of vacuum cleaner to check. (Fig. B)

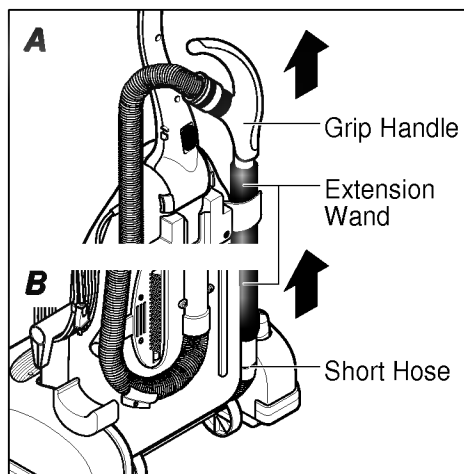

Short Hose

If the clog still exists, turn the vacuum cleaner off and unplug the power cord. Turn the vacuum cleaner over to expose the underside. Unscrew and remove the short hose from the main body to check.

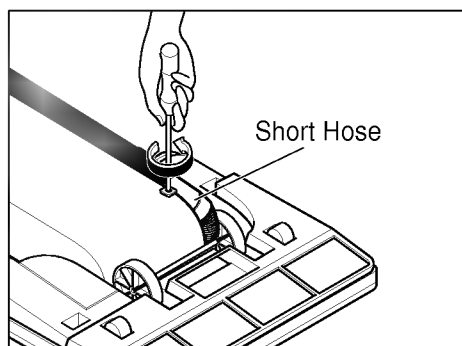

REPLACEMENT INSTRUCTIONS

WARNING: Unplug the unit to avoid electric shock when servicing.

Replacing The Head Light Bulb

Unscrew and remove the light cover. To remove old bulb, push it in toward bulb socket while turning counter-clock wise, then remove.

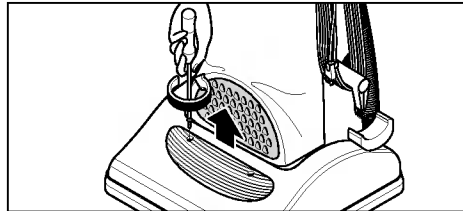

Use a bayonet base bulb having the rating of 20W. To install a new bulb, push it in toward the bulb socket and turn it clockwise.



Replace the light cover and secure it with screws.

Removing/Installing The Bottom Plate

Before replacing any parts, disconnect the vacuum cleaner from the electrical outlet.

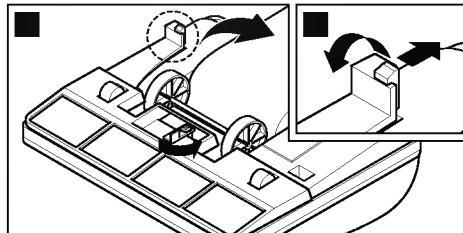

Turn the vacuum cleaner over to expose the underside. Slide the latch off the bottom plate.(Fig. A)

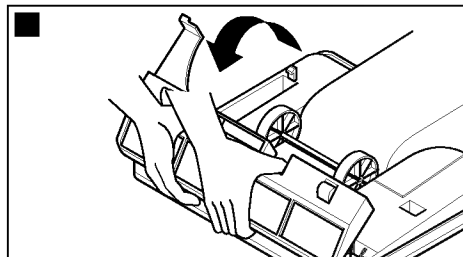

DO NOT remove screws on the bottom plate. These screws are only for holding metal piece. (for model V-7515T)

Release a hook on the rear side. (Fig. B)

Then position your thumbs as shown in the figure and pull the bottom plate forward to release the remaining hooks. (Fig. C)

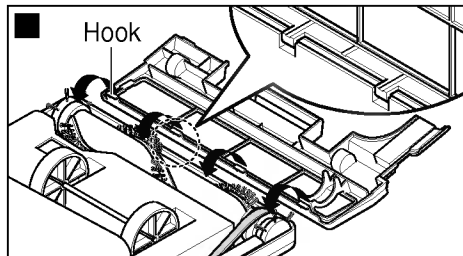

Hook the front end of base cover into the slots on the front of nozzle. Press the bottom plate into the place until the locking hooks snap into place then slide the latch over the bottom plate to secure. (Fig. D)

REPLACEMENT INSTRUCTIONS

WARNING: Unplug the unit to avoid electric shock when servicing.

Replacing Belt and/or Agitator

ATTENTION: Belt tension is high. Set the Carpet/Bare Floor selector to Carpet position.

Check the belt and agitator frequently. When the belt or agitator is broken or worn out, replace with a new one.

Turn the unit over and remove the bottom plate as described in [Removing/Installing the bottom plate](#) section on the previous page.

To remove the belt or agitator, grasp the both ends of agitator and lift it slowly. Remove the belt from agitator pulley and motor shaft.

Loop the new belt around the motor shaft and agitator pulley.

Reinsert the agitator making sure that both ends of the agitator fit in the groove of the nozzle head.

After installing the agitator, turn it by hand, making sure that the belt is not twisted or pinched and all parts turn freely.

Replace the bottom plate as described in [Removing/Installing the bottom plate](#) section on the previous page.

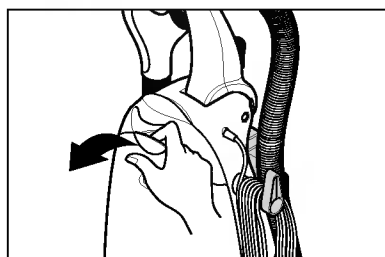
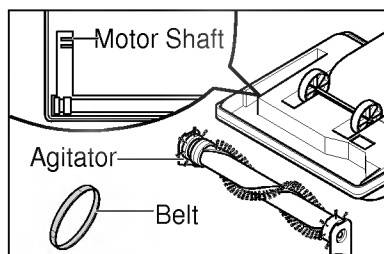
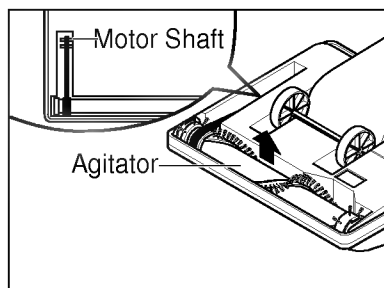

Replacing HEPA Filter

(for model V-7515T)

The HEPA filter is located inside the dust cover. When installing or changing dust bag, check this filter.

When the filter is dirty, remove the filter and install a new one. To remove this filter, grasp the projection of filter frame, and just pull it out. Replace twice a year or after every six bag changes.

DO NOT CLEAN WITH WATER.

Place the new filter in the retainer and push back into the dust cover.

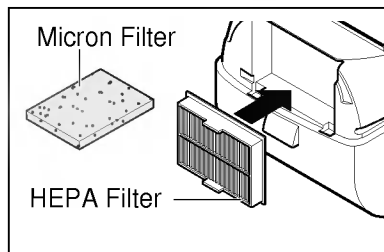

Replacing Micron Filter

(for model V-7513T)

Clean old micron filter or replace a new one. Replace the micron filter after every third bag change.

REPLACEMENT INSTRUCTIONS

WARNING: Unplug the unit to avoid electric shock when servicing.

Replacing Dust Bag

Check the bag from time to time. When excessive dirt accumulates, your cleaner may not operate effectively.

When the Check Bag Indicator turns red, check the bag.

DISCONNECT CLEANER FROM ELECTRICAL OUTLET.

Pull the door latch forward and remove the door from the cleaner. Grasp the dust bag collar and pull it out.

Attach a new dust bag onto the bag holder holding the dust bag collar and pushing back as shown in figure.

Reinsert the tab provided on the end of the filter cover into the grooves on the dust compartment.

Rotate the filter cover up into the closed position and press it until the door latch snaps into place.

Replacing Clean Filter

The clean filter is located inside the dust compartment. When installing or changing dust bag, always check this filter. When the filter becomes dirty, clean the filter or install a new one.

To remove this filter, open the filter cover and pull it out from the bottom of dust compartment.

To clean the old filter, rinse it in water and dry it.

Slide this filter back into place. It should be fully inserted into the projections of the bottom of dust compartment.

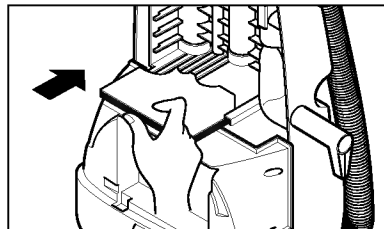
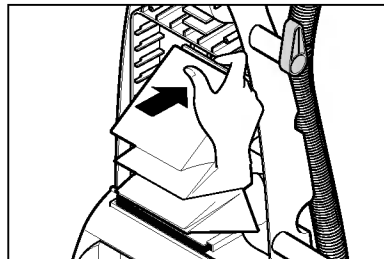
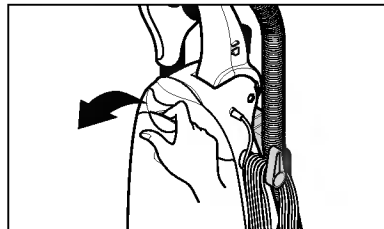
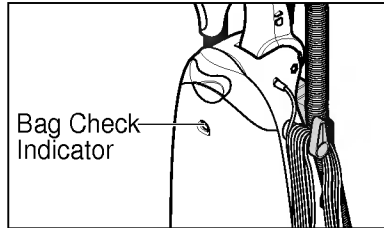

MAINTENANCE

WARNING: Unplug the unit to avoid electric shock when servicing.

Cleaning Agitator

In order to keep the cleaning efficiency high, clean the agitator frequently.

Make sure to unplug the unit.

Turn the unit over on the floor. If necessary, remove bottom plate as described in [Removing/Installing the bottom plate](#) section, page 13.

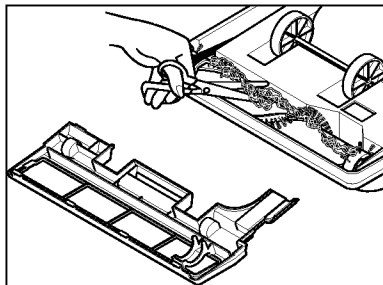

Remove the entangled materials, such as carpet pile and lint, etc.

SPECIFICATIONS

Model	V-7515T	V-7513T
Power supply	on the rating label	
Ampacity	on the rating label	
Dimension/upright position (WxDxH)	approx. 390 x 330 x 1060mm	
Cord length	35'	25'
Weight (approx.)	20 lbs	19 lbs

BEFORE REQUESTING SERVICE

Review this chart to find out a possible solution if a minor problem occurs. Any service needed, other than those described here, should be performed by an authorized service center.

Problem	Possible cause	Possible solution
Cleaner won't run	<ol style="list-style-type: none"> 1. Not firmly plugged in. 2. No voltage in wall outlet. 3. On/Off switch not turned on. 4. Broken fuse 	<ol style="list-style-type: none"> 1. Plug in firmly. 2. Check fuse or breaker. 3. Push On/Off switch. 4. Ask authorized service center
Cleaner won't pick up	<ol style="list-style-type: none"> 1. Broken or worn belt. 2. Worn agitator brush. 3. Full or clogged dust bag. 4. Hole in hose. 5. Filter cover improperly installed. 6. Belt not installed on motor shaft. 7. Incorrect Carpet/Bare floor setting. 	<ol style="list-style-type: none"> 1. Replace belt 2. Replace agitator 3. Change bag 4. Replace hose 5. Properly install 6. Install belt on motor shaft 7. Set in correct position
Dust escapes the paper bag	<ol style="list-style-type: none"> 1. Bag improperly installed. 2. Torn bag. 	<ol style="list-style-type: none"> 1. Properly install bag 2. Replace bag
Light won't work	<ol style="list-style-type: none"> 1. Burned out light bulb 	<ol style="list-style-type: none"> 1. Replace light bulb

GoldStar VACUUM LIMITED WARRANTY

for the United States and Canada

LG Electronics will repair or exchange your product which proves to be defective in material or workmanship under normal use, during the warranty period listed below from the date of original purchase. This warranty is good only to the original purchaser of the product during the warranty period as long as it is in the U.S., including Alaska, Hawaii, U.S. Territories; and all Canadian Provinces.

WARRANTY PERIOD:

US	CANADA	HOW SERVICE IS HANDLED
Two Years for Parts, One Year for Labor	Two Years for Parts, One Year for Labor	Call 1 (800) 243-0000 and select the appropriate menu option to locate your nearest Authorized Service Center 24 hrs a day, 7 days per week. Please have your product type (VACUUM) and ZIP/Postal code ready.

No other express warranty is applicable to this product. THE DURATION OF ANY IMPLIED WARRANTIES, INCLUDING THE IMPLIED WARRANTY OF MERCHANTABILITY, IS LIMITED TO THE DURATION OF THE EXPRESS WARRANTY HEREIN. LG ELECTRONICS SHALL NOT BE LIABLE FOR THE LOSS OF THE USE OF THE PRODUCT, INCONVENIENCE, LOSS OR ANY OTHER DAMAGES, DIRECT OR CONSEQUENTIAL, ARISING OUT OF THE USE OF, OR INABILITY TO USE, THIS PRODUCT OR FOR ANY BREACH OF ANY EXPRESS OR IMPLIED WARRANTY, INCLUDING THE IMPLIED WARRANTY OF MERCHANTABILITY APPLICABLE TO THIS PRODUCT. Some states do not allow the exclusion or limitation of incidental or consequential damages or limitations on how long an implied warranty lasts; so these limitations or exclusions may not apply to you. This warranty gives you specific legal rights any you may also have other rights which vary from state to state or province to province.

THE ABOVE WARRANTY DOES NOT APPLY:

- To damages or problems which result from delivery or improper installation.
- To damages or problems which result from misuse, abuse, accident, alteration, or incorrect electrical current or voltage.
- To service calls, which do not involve defective workmanship or material, such as explaining the operation of the unit.

Therefore, these costs are paid by you.

CUSTOMER ASSISTANCE NUMBERS:

To Prove Warranty Coverage:

Retain your sales receipt to prove date of purchase.
A copy of your sales receipt must be submitted at the time warranty service is provided.

To obtain Customer Assistance or Technical Support:

CALL 1 (800) 243-0000 and select the appropriate menu option.
See our website at <http://www.LGService.com>
or send e-mail to <http://www.LGService.com/techsup.html>

For Your Nearest Authorized Service Center

Call 1 (800) 243-0000 and select the appropriate option
Please have your product type (VACUUM) and ZIP/Postal Code ready.