

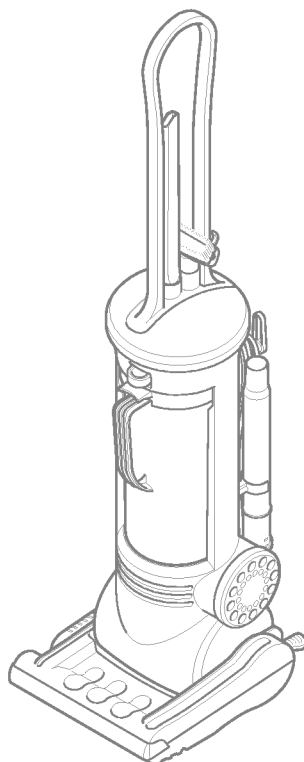

# Upright Vacuum Cleaner Owner's Manual Bürststaubsauger Bedienungsanleitung

MODEL, MODELL:  
V-UP142NJP

LG Service Hotline Tel:01805-47378423 (0180-LGSERVICE)



PLEASE READ THIS MANUAL  
THOROUGHLY AND CAREFULLY BEFORE  
OPERATING THE VACUUM CLEANER  
BEVOR SIE DAS GERÄT IN BETRIEB NEHMEN,  
LESEN SIE BITTE DIE  
BEDIENUNGSANLEITUNG GRÜNDLICH DURCH

P/No.: 3828FI5872C

# TABLE OF CONTENTS

---

<b>IMPORTANT SAFEGUARDS</b> .....	3
<b>ASSEMBLING THE VACUUM CLEANER</b> .....	4
- STEP 1: UNPACKING THE CARTON .....	4
- STEP 2: ASSEMBLING THE HANDLE .....	5
- STEP 3: CORD STORAGE .....	5
- STEP 4: ATTACHING THE TOOLS .....	6
<b>CLEANER DESCRIPTION</b> .....	7
<b>SPECIAL FEATURES</b> .....	8
<b>MOTOR PROTECTOR</b> .....	8
<b>OPERATION</b> .....	9
- Important Safety Tips .....	9
- On/Off Switch .....	9
- Handle Positions .....	9
- Transporting the Vacuum Cleaner .....	10
- Using the Cord Hanger .....	10
- Using the Cord Hook .....	10
- Using Attachments .....	11
<b>REMOVING CLOGS</b> .....	12
- Removing Blockages .....	12
- Pre-motor Filter .....	13
<b>REPLACEMENT INSTRUCTIONS</b> .....	14
- Exhaust Filter .....	14
- Removing/Installing the Bottom Plate .....	14
- Replacing the Belt and/or Agitator .....	15
<b>MAINTENANCE</b> .....	16
- Cleaning the Agitator .....	16
<b>SPECIFICATIONS</b> .....	16
<b>PARTS</b> .....	16
<b>BEFORE REQUESTING SERVICE</b> .....	17
<b>WARRANTY</b> .....	18

# IMPORTANT SAFEGUARDS



## WARNING

Your safety is important to us. To reduce the risk of fire, electrical shock, injury to persons, or damage when using your vacuum cleaner, please follow these basic safety precautions.

1. **Disconnect** power supply before cleaning the unit.
2. **Do not** leave appliance plugged in. Unplug from the socket when not in use.
3. **Do not** use outdoors or on wet surfaces. Do not pick up water or wet materials.
4. **Do not** handle plug or appliance with wet hands.
5. **Do not** allow it to be used as a toy. Close attention is necessary when used by or near children.
6. **Use only** as described in this manual. Use only attachments recommended by the manufacturer.
7. **Do not** use with a damaged cord or plug. If the supply cord is damaged, it must be replaced by the manufacturer or an Authorised Service Centre or a similarly qualified person in order to avoid a hazard.
8. **Do not** pull or carry by the power cord as a handle, close door on cord, or pull the cord around sharp edges or corners. Do not run appliance over the cord. Keep the cord away from heated surfaces.
9. **Do not** unplug by pulling the cord. To unplug, grasp the plug, not the cord.
10. **Do not** put any object into openings. Do not use with any opening blocked. Keep free from dust, lint, hair, and anything that might reduce air flow.
11. **Keep** hair, loose clothing, fingers, and all parts of the body away from the openings and moving parts.
12. **Do not** use vacuum cleaner to pick up sharp, hard objects, small toys, pins, etc.
13. **Do not** use to pick up anything that is burning or smoking, such as cigarettes, matches, or hot ashes.
14. **Do not** pick up flammable or combustible liquid or vapour such as gasoline or use in areas where they may exist.
15. **Do not** use vacuum cleaner without dust container and/or filters in place.
16. **Always** turn off all controls before unplugging.
17. **Do not** keep vacuum cleaner on chairs, tables, etc. Extra care must be taken when cleaning stairs.
18. **Always** unplug the unit or turn off the switch when the unit stops unexpectedly. If you don't, the cleaner could re-start unintentionally.

**Thermal protector:** This vacuum cleaner has a special thermostat that protects the cleaner in case of motor overheating. If the cleaner suddenly shuts off, turn off the switch and **unplug** the cleaner. Check the cleaner for a possible source of overheating such as a full dust container, a blocked hose or clogged filter. If these conditions are found, fix them and wait at least 30 minutes before attempting to use the cleaner. After the 30 minutes period, plug the cleaner back in and turn on the switch. If the cleaner still does not run, contact a qualified electrician.

## SAVE THESE INSTRUCTIONS

THIS PRODUCT IS FOR HOUSEHOLD USE ONLY

# ASSEMBLING THE VACUUM CLEANER



## WARNING

### Electrical Shock Hazard

Do not plug into the electrical supply until assembly is complete.  
Failure to do so could result in electrical shock or injury.

### **STEP 1: UNPACKING THE CARTON**

Remove all parts from the carton and use the figure below to identify each part. Make sure that you have removed all parts before disposing of the carton and packing materials.

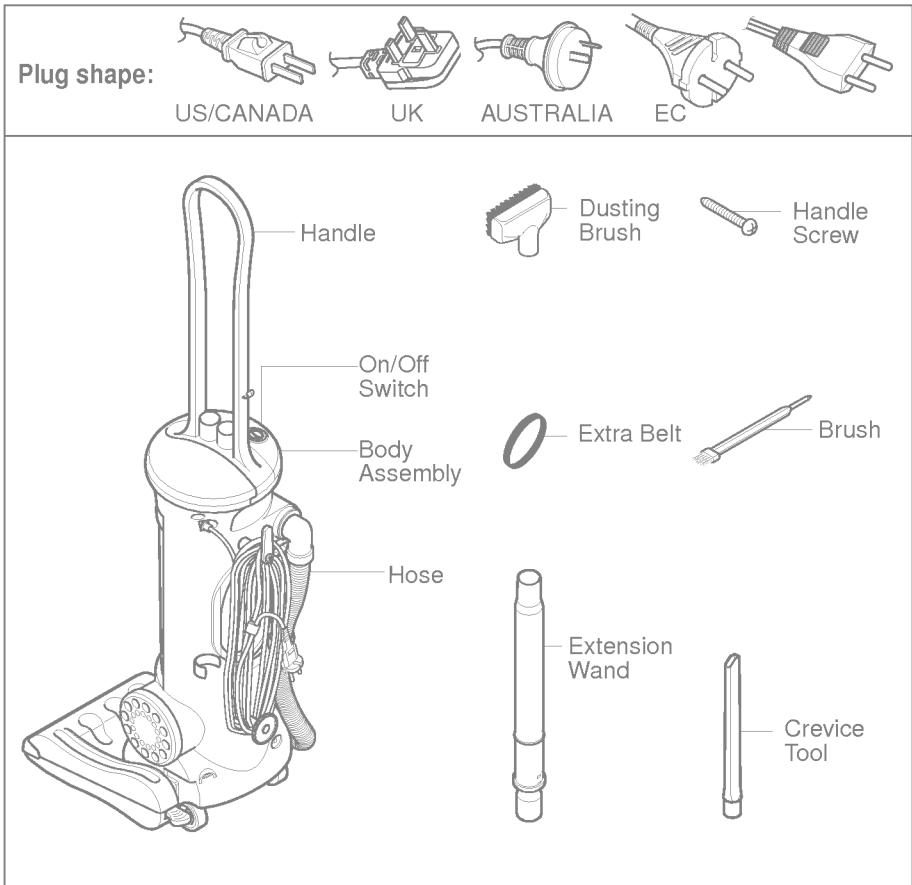

# ASSEMBLING THE VACUUM CLEANER

## **STEP 2: ASSEMBLING THE HANDLE**

Slide the handle into the opening at the back of the vacuum cleaner body. (Fig. A)

Insert the screw into the handle screw hole and tighten with a screwdriver. (Fig. B)

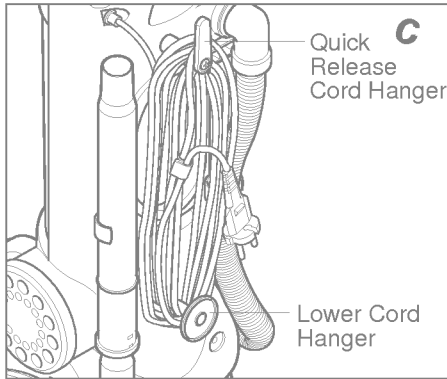
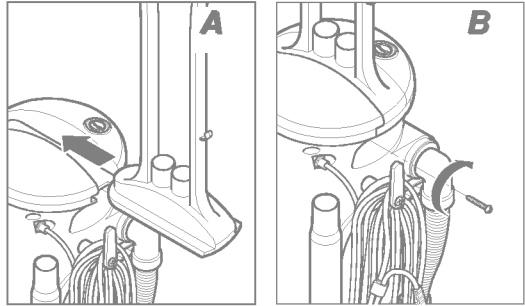

## **STEP 3: CORD STORAGE**

Make sure that the quick-release cord hanger is in the upright position.

Wrap the cord around the quick-release cord hanger and lower cord hanger. (Fig. C)

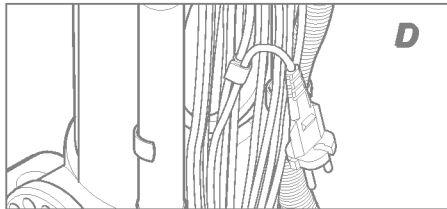

Clip the power cord plug onto the power cord. (Fig. D)

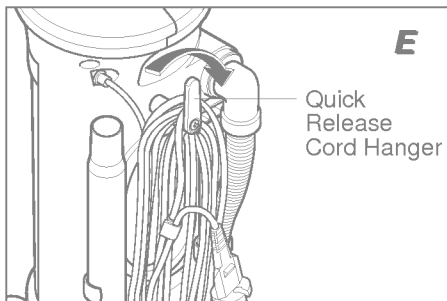

To release the cord, rotate the quick-release cord hanger downward. (Fig. E)

# ASSEMBLING THE VACUUM CLEANER



## WARNING

### Electrical Shock Hazard

Do not plug into the electrical supply until assembly is complete.  
Failure to do so could result in electrical shock or injury.

### STEP 4: ATTACHING THE TOOLS

Store the crevice tool and dusting brush in the clip at the bottom of the handle.

Clip the extension wand into place on the left side of the vacuum cleaner.

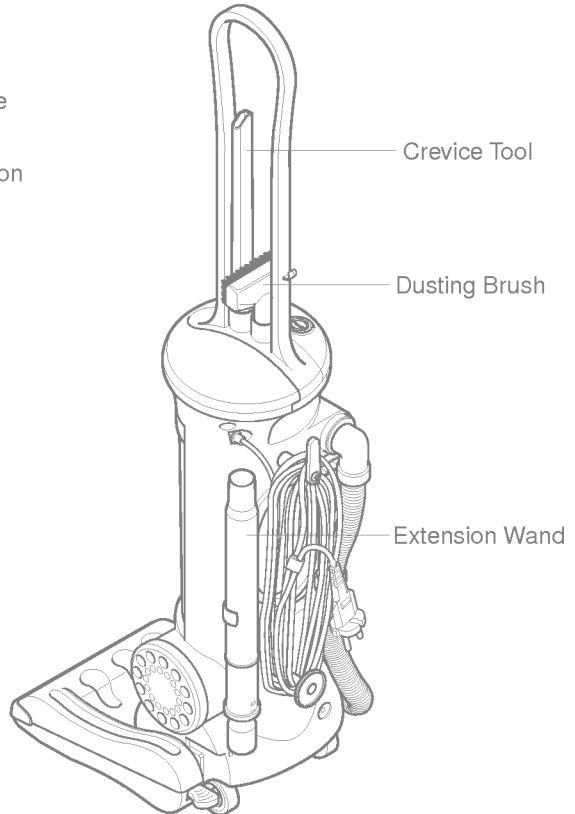

# CLEANER DESCRIPTION

After assembly, the vacuum cleaner will look like the picture below.

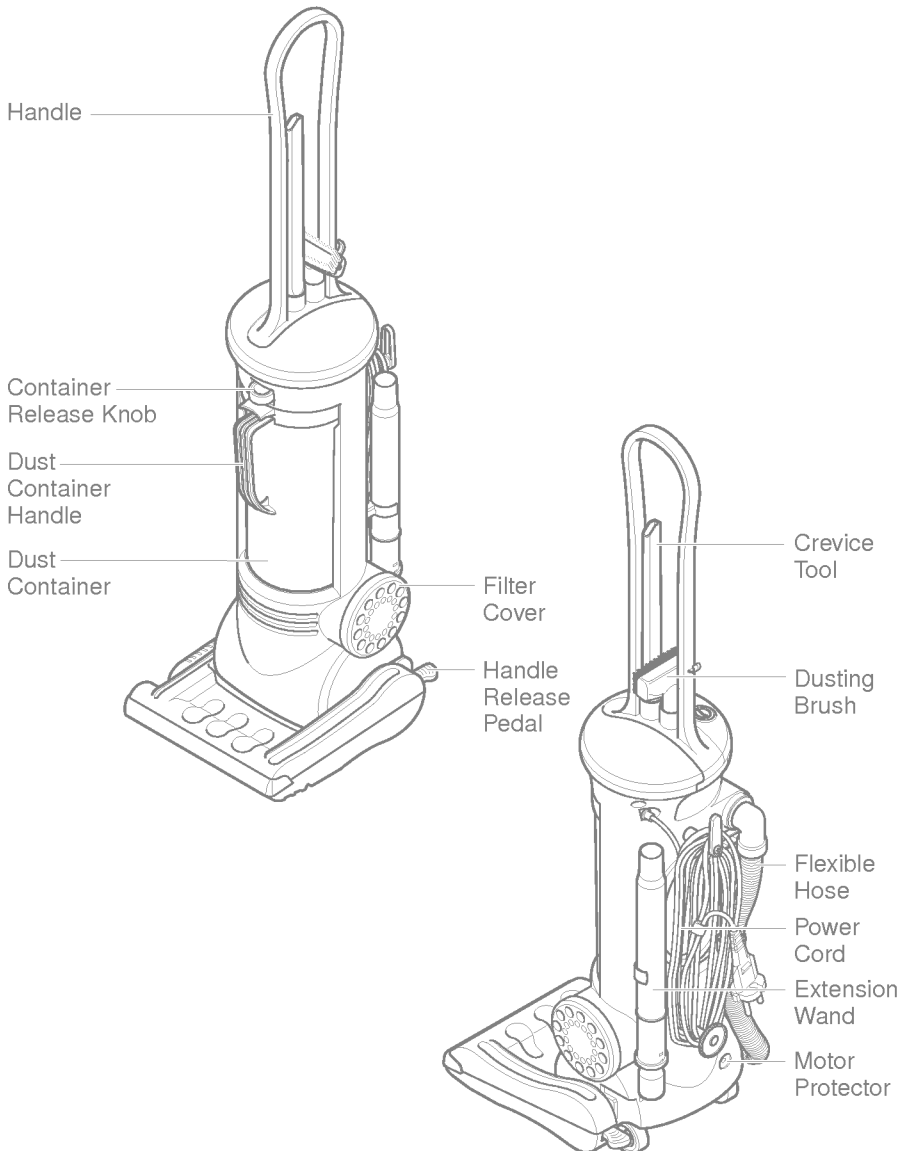

# SPECIAL FEATURES

---

## **EDGE CLEANING FEATURE**

The edge cleaning feature provides improved cleaning of carpets along walls and furniture.

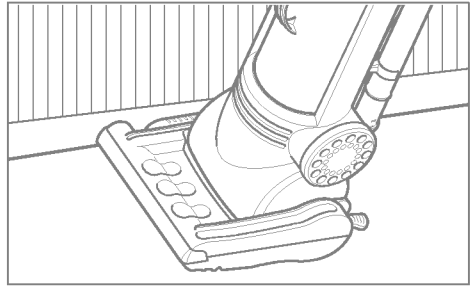

# MOTOR PROTECTOR

---

This vacuum has a motor protector by-pass valve which automatically opens to provide cooling air to the motor when a clog prevents the normal flow of air. If the by-pass valve opens to prevent motor overheating and possible damage to the vacuum, a change of sound will be noticed as air rushes through the valve opening. If this occurs, turn the vacuum off and unplug the power cord from the outlet. Then check for blockage as described under the BLOCKAGE REMOVAL section.

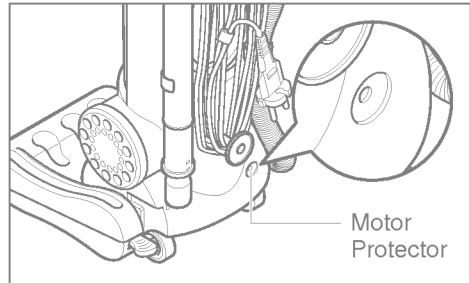

The motor protector by-pass valve may open when using attachments or when cleaning new carpet, due to reduced air flow caused by the attachments themselves or by new carpet reduce filling the dust container quickly.



# OPERATION



## WARNING

### Personal Injury and Product Damage Hazard

- DO NOT use outlets above work surfaces. Damage to items in the surrounding area could occur.

### **IMPORTANT SAFETY TIPS**

Before you plug in your vacuum cleaner, make sure that the voltage indicated on the rating label of the vacuum cleaner matches that of your local electrical supply.

### **ON/OFF SWITCH**

Plug in the power cord.

**Press the ON/OFF switch to turn the vacuum cleaner on or off.**

If the cleaner stops unexpectedly, always turn off the switch and unplug the vacuum cleaner before checking for the cause. The vacuum cleaner could start on its own and cause injury.

### **HANDLE POSITIONS**

The handle may be adjusted to any position required.

Depress the handle release pedal. The handle is then released to move up and down freely.

To clean under furniture, depress the handle release pedal a second time.

To store the vacuum or attachments, set the handle to the upright position.

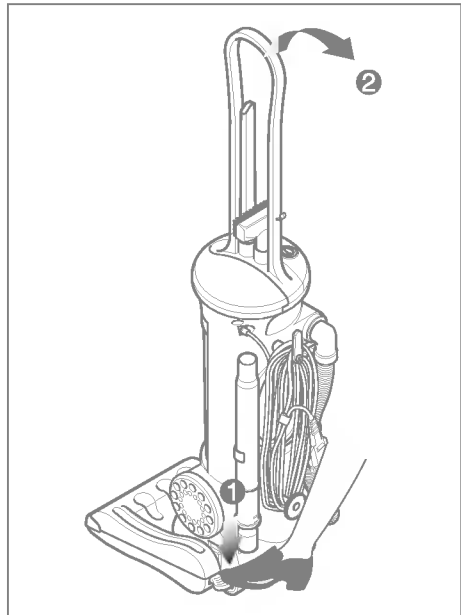
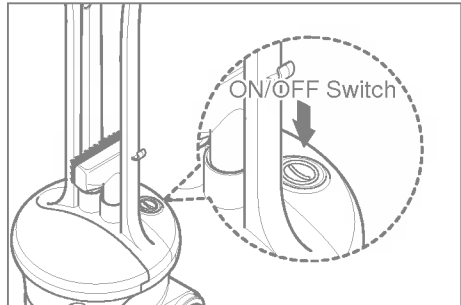

# OPERATION



## WARNING

### Personal Injury and Product Damage Hazard

- DO NOT use outlets above work surfaces. Damage to items in the surrounding area could occur.

### TRANSPORTING THE VACUUM CLEANER

To move your vacuum cleaner from room to room, place the handle in the upright position, tilt the vacuum back on its rear wheels and push it forward.

The vacuum cleaner can also be picked up and carried using the built-in carrying handle.



### USING THE CORD HANGER

To release the power cord, rotate the quick release cord hanger downward and the entire power cord can be slid off the hanger for immediate use.

Do not unplug the cleaner by pulling on the cord. Always unplug by grasping the plug and pulling it straight out from the socket.

Return the quick release cord hanger to the upright position before rewinding and storing the power cord.

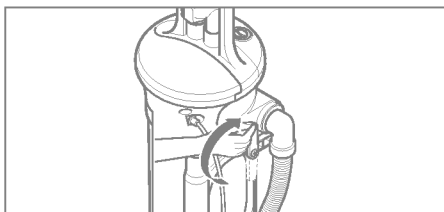
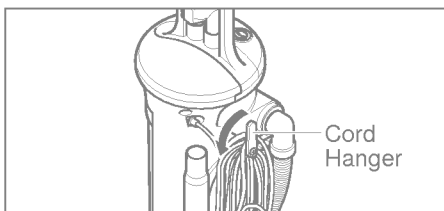

### USING THE CORD HOOK

There is a groove on the handle to secure the power cord while you are vacuuming.

To help prevent possible damage to the power cord, clip it into this groove to help keep the power cord from hanging down where it can be caught up in the agitator or other moving parts.

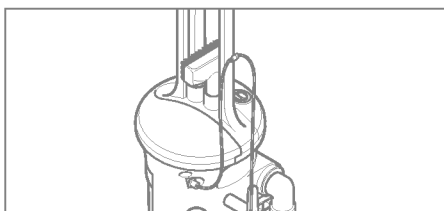

# OPERATION



## WARNING

### Personal Injury and Product Damage Hazard

- DO NOT use outlets above work surfaces. Damage to items in the surrounding area could occur.

### USING ATTACHMENTS

Remove the lower end of the flexible hose from the vacuum cleaner by pull the hose collar out of the clip on the base. (Fig. A)

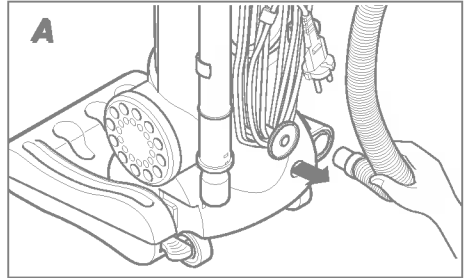

Remove the telescopic extension wand from its storage position. (Fig. B)



Turn the lower extension wand to the UNLOCK position. (Fig. C)

Extend the wand to its full length. Turn the lower extension wand to the LOCK position. (Fig. C)

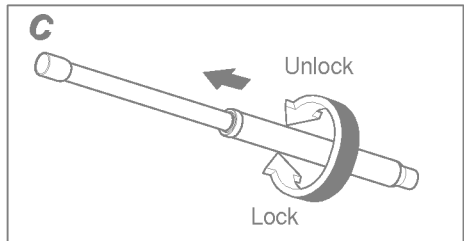

Slide the extension wand onto the hose collar.

Connect the crevice tool and dusting brush onto the end of the extension wand. (Fig. D)

The crevice tool or dusting brush will also fit directly onto the hose collar.

The dusting brush can also be used as an upholstery cleaning brush by removing the brush. (Fig. E)

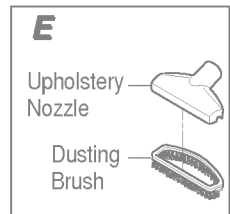
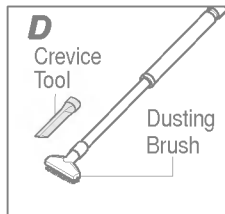

## CAUTION

- When using attachments, be careful not to over-extend the hose. This could cause the cleaner to tip over.

# REMOVING CLOGS



## WARNING

### Electrical Shock and Personal Injury Hazard

- Unplug the vacuum cleaner before cleaning the unit. Failure to do so could result in electrical shock or personal injury from the vacuum cleaner starting unexpectedly.

If your vacuum cleaner makes a strange noise or suction decreases, check for blockages or whether the pre-motor filter is dirty.

### ***REMOVING BLOCKAGES***

First check the hose and extension wand. Visually inspect the hose and the opening of the vacuum cleaner body into which the hose is inserted. (Fig. A)

Remove the dust container and check the pre-motor filter. (See page 15)

Check the dust inlet on the vacuum cleaner body for blockages. (Fig. B)

If the blockage remains, turn the vacuum cleaner over and check the agitator area and suction inlet. (Fig. C)

Stand the vacuum cleaner back up in an upright position before plugging into the electrical outlet.

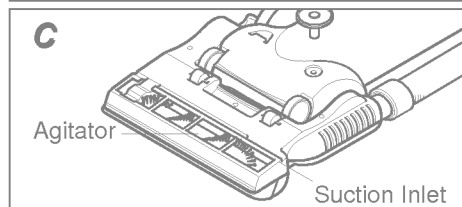
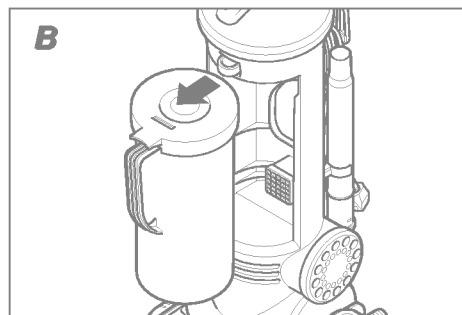
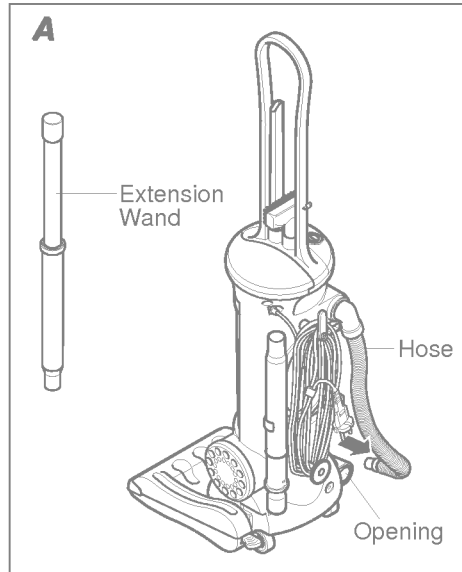

# REMOVING CLOGS



## WARNING

### Electrical Shock and Personal Injury Hazard

- Unplug the vacuum cleaner before cleaning the unit. Failure to do so could result in electrical shock or personal injury from the vacuum cleaner starting unexpectedly.

### PRE-MOTOR FILTER

Check and clean the pre-motor filter regularly.

If the motor pre-filter is covered with too much dust, vacuum cleaner will stop moving as the thermal protect work.

You should also check the pre-motor filter whenever the vacuum cleaner makes a strange noise or suction decreases.

First, turn off the vacuum cleaner and unplug the power cord from the electrical outlet.

Remove the dust container by pushing the release button and pulling out on the dust container handle. (Fig. A)

Remove the cover and empty the container. (Fig. B)

Clean the pre-motor filter (on the dust container cover) by tapping it gently. (Fig. C)

If the pre-motor filter is excessively dirty, rinse the filter with water.

Easy to rinsing, separate pre-motor filter from the filter cap. (Fig. D,E)

After rinsing, allow the pre-motor filter to dry in a shaded location for 24 hours. **Never reinstall the pre-motor filter while it is wet.**

Before reinstalling the dust container, make sure that the cover is positioned properly.

To reinstall the dust container, hook the bottom of the container onto the lower part of the handle and push the top of the dust container into the handle until it latches in place. (Fig. F)

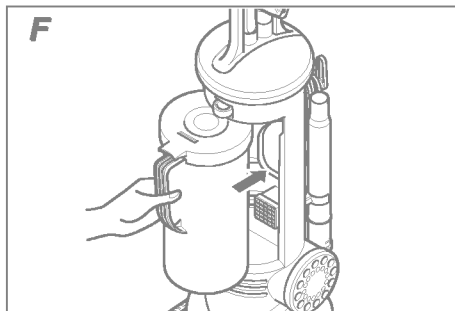
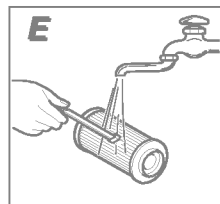
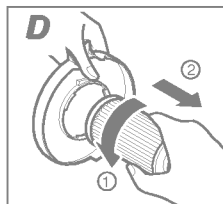
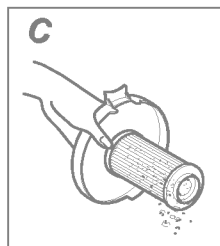
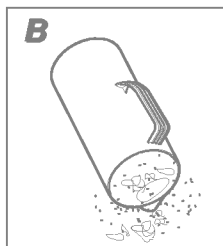
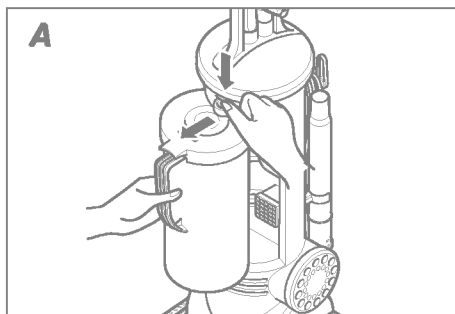

# REPLACEMENT INSTRUCTIONS



## WARNING

### Electrical Shock and Personal Injury Hazard

- Unplug the vacuum cleaner before cleaning the unit. Failure to do so could result in electrical shock or personal injury from the vacuum cleaner starting unexpectedly.

### **EXHAUST FILTER**

The exhaust filter is washable HEPA filter.  
The exhaust filter must be rinsed when it becomes dirty.

Rotate to the left side to remove the filter cover. (Fig.A,B)

We advise you to rinse at least once a year.  
After rinsing, allow the exhaust filter to dry in a shaded location for 24 hours.

Never reinstall the exhaust filter while it is wet.  
Do not operate the vacuum cleaner without the filter in place.

Replacement filter can be obtained from your dealer.

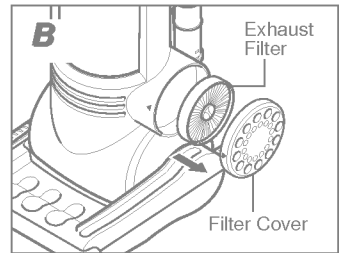
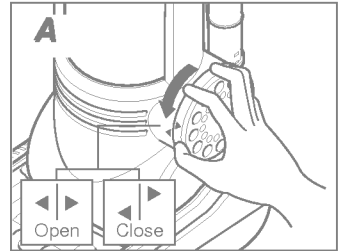

### **REMOVING/INSTALLING THE BOTTOM PLATE**

Before replacing any parts, disconnect the vacuum from the electrical outlet.

To remove the bottom plate, unscrew the bottom plate first. Then pull the bottom plate away from the nozzle housing. (Fig. C)

To install the bottom plate, hook the front end of bottom plate into the slots on the front of nozzle. (Fig. D)

Press the bottom plate then tighten the screws.

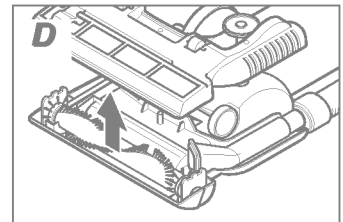
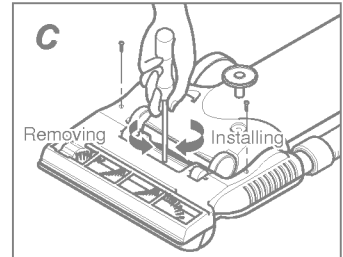

# REPLACEMENT INSTRUCTIONS



## WARNING

### Electrical Shock and Personal Injury Hazard

- Unplug the vacuum cleaner before cleaning the unit. Failure to do so could result in electrical shock or personal injury from the vacuum cleaner starting unexpectedly.

### REPLACING THE BELT AND/OR AGITATOR

Check the belt and agitator regularly. If they are broken or worn out, replace them.

Turn the unit over and remove the bottom plate as described in [Removing/Installing the Bottom Plate](#) section.

To remove the agitator, grasp both ends of the agitator and lift it slowly. Remove the belt from the agitator pulley and the motor shaft. If the belt is broken, be sure all pieces are removed.



## WARNING

### Personal Injury Hazard

The belt is under high tension; be careful when removing the agitator.

Failure to do so could result in personal injury caused by the agitator releasing quickly and snapping away.

Loop the new belt around the motor shaft and agitator pulley.

Reinsert the agitator, making sure that both ends of the agitator fit into the grooves in the nozzle head.

After installing the agitator, turn it by hand to make sure that the belt is not twisted or pinched and that all parts turn freely.

Reinstall the body cover by reversing the steps in the [Removing/Installing the Bottom Plate](#) section.

The agitator must also be cleaned according to the following schedule:

### Vacuum Use

**HEAVY** - (used daily)

**MODERATE** - (used 2-3 times/week)

**LIGHT** - (used 1time/week)

### Clean Agitator

every week

every week

every 2 months

Replacement part are available from your dealer.

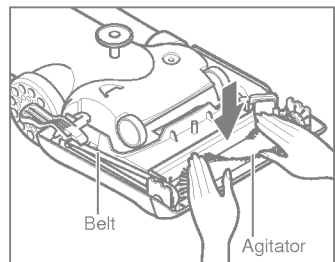
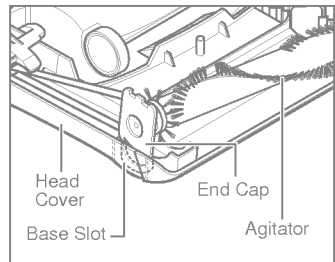
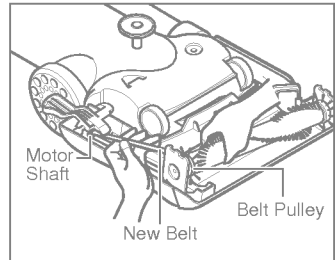
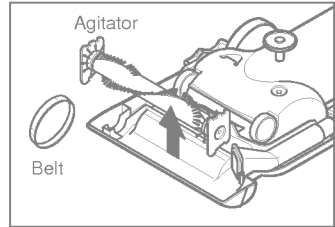

# MAINTENANCE



## WARNING

### Electrical Shock and Personal Injury Hazard

- Unplug the vacuum cleaner before cleaning the unit. Failure to do so could result in electrical shock or personal injury from the vacuum cleaner starting unexpectedly.

### **CLEANING THE AGITATOR**

In order to keep the cleaning efficiency high, clean the agitator regularly.

Make sure you unplug the unit.

If necessary, remove the body cover by following the [Removing/Installing the bottom plate](#) section.

Remove the entangled materials, such as carpet pile and lint, strings etc Unwing them or cut them off with scissors, as shown.

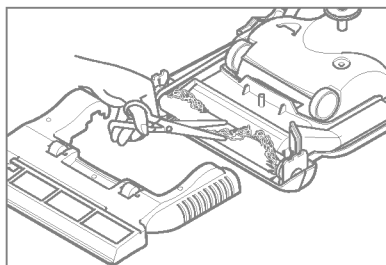

# SPECIFICATIONS

Model	V-UP142NJP
Power supply	230V/50Hz
Power	IEC-1200W, MAX-1400W
Dimension/upright position (WxDxH)	approx 334 x 1096 x 347mm
Cord length	7.7m
Weight (approx.)	6.3kg

# PARTS

Model	V-UP142NJP
Belt	4400FI3348A
Exhaust Filter(Washable HEPA)	3210FI2434C
Pre Motor-filter	5231FI3783A

These parts are available from your dealer.



# BEFORE REQUESTING SERVICE

Review the chart below for possible solutions in the event of a minor problem. Any service needed, beyond the procedures described below and elsewhere in this manual, should be performed by an authorised service centre.



## WARNING

Electrical Shock and Personal Injury Hazard

- Unplug the vacuum cleaner before servicing or cleaning the unit. Failure to do so could result in electrical shock or personal injury.

Problem	Possible Cause	Possible Solution
Vacuum cleaner won't run	<ol style="list-style-type: none"> <li>1. Not plugged firmly into wall outlet</li> <li>2. No voltage in wall outlet</li> <li>3. On/Off switch not turned on</li> <li>4. Thermal overload protection activated</li> </ol>	<ol style="list-style-type: none"> <li>1. Plug firmly into wall outlet.</li> <li>2. Check fuse or circuit breaker.</li> <li>3. Press the On/Off switch.</li> <li>4. Turn the vacuum cleaner off, unplug it, and allow it to cool. (See page 3)</li> </ol>
Vacuum cleaner won't pick up	<ol style="list-style-type: none"> <li>1. Belt worn or broken</li> <li>2. Worn agitator brush</li> <li>3. Dust container full</li> <li>4. Hose or nozzle blocked</li> <li>5. Hose damaged</li> <li>6. Dust container installed incorrectly</li> <li>7. Belt not installed on the motor shaft</li> </ol>	<ol style="list-style-type: none"> <li>1. Replace the belt.</li> <li>2. Replace the agitator.</li> <li>3. Empty the dust container and check the pre-motor filter.</li> <li>4. See REMOVING BLOCKAGES on page 12.</li> <li>5. Replace the hose.</li> <li>6. Make sure the dust container is seated properly in the handle.</li> <li>7. Install the belt on the motor shaft. (See page 15.)</li> </ol>
Dust escaping the dust container	<ol style="list-style-type: none"> <li>1. Dust container installed incorrectly</li> <li>2. Pre-motor filter cap installed incorrectly</li> </ol>	<ol style="list-style-type: none"> <li>1. Make sure the dust container is seated properly in the handle.</li> <li>2. Make sure the pre-motor filter is in place and seated correctly.</li> </ol>

## Warranty Certificate

### For offer a 24-month warranty for this apparatus

During the 24-month warranty period, we will repair your apparatus at no cost to you or make available spare parts to your dealer free, if this apparatus fails due to manufacturing or material defects. Further claims are excluded. We are not liable for damages due to acts of providence or damages occurring during transport. The buyer assumes shipping and packaging costs. **Your warranty conditions on the rear also apply!**

Type of apparatus: \_\_\_\_\_

Serial number:

Name of buyer: \_\_\_\_\_

Purchase date: \_\_\_\_\_

Dealer's stamp and signature

## Warranty conditions for vacuum cleaner

- 1. The warranty period begins** on the purchase date and is valid for 24 months. Begin of warranty period is proven if, the buyer submits purchase receipt together with the warranty card, filled in and signed by the seller. The serial number of the product must agree with the number entered onto the warranty card.
- 2. During the warranty period, we will** correct any defects at no cost to you, if it can be proven that these are attributed to manufacturing or material defects.
- 3. Damages due to incorrect handling, non-compliance with instructions for use and normal wear are not covered by this warranty.** Also, the warranty does not cover wear parts or easily broken parts (for example, viewing glass, light bulbs). The buyer is responsible for any damages during transport as well as shipping and packaging costs.
- 4. We decide whether to make repairs, exchange or replace parts.** Exchanged or replaced parts are our property. The original warranty period is not prolonged if a refrigerator is repaired or certain parts are replaced.
- 5. The warranty is nullified** if any person intervenes in the apparatus that are not authorised by LG Electronics, if the apparatus is used for commercial purposes.
- 6. Always keep the original packaging,** so that if the apparatus requires servicing, it can be transported without damaging it.
- 7. If a repair is covered by this warranty,** always contact your dealer or an authorised service centre.
- 8. Further claims are excluded.** If parts of these provisions are invalid, they apply in the sense of the wording. The validity of the other provisions is not effected.



**LG Electronics Inc.**

<http://www.lge.com/>