

V-CP542ND

V-CP552ND

V-CP562ST/STQ/STS

V-CP562HT/HTQ/HTS

E | English

M | Magyarul

C | Český jazyk

L | Limba Română

S | NA SRPSKOM

B | БЪЛГАРСКИ

H | NA HRVATSKOM



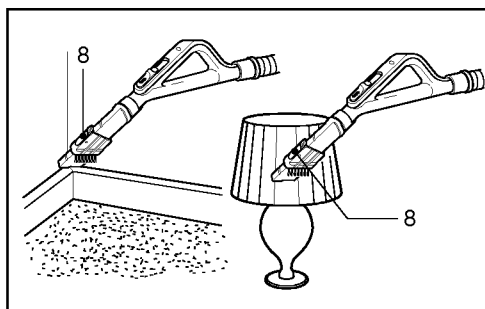
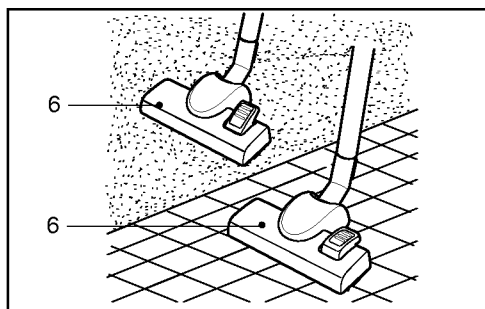
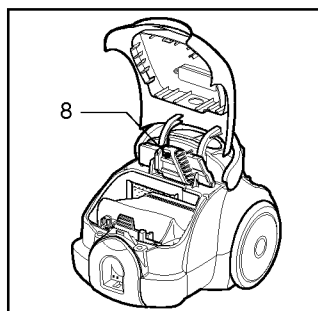
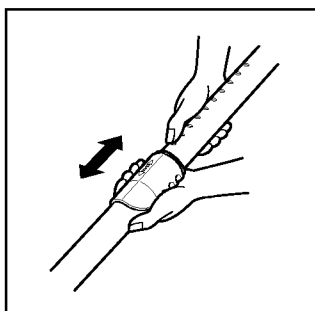
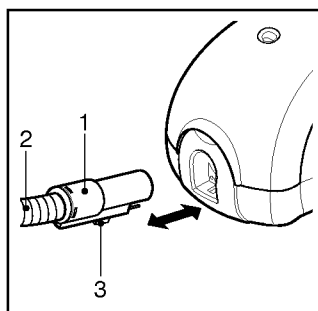
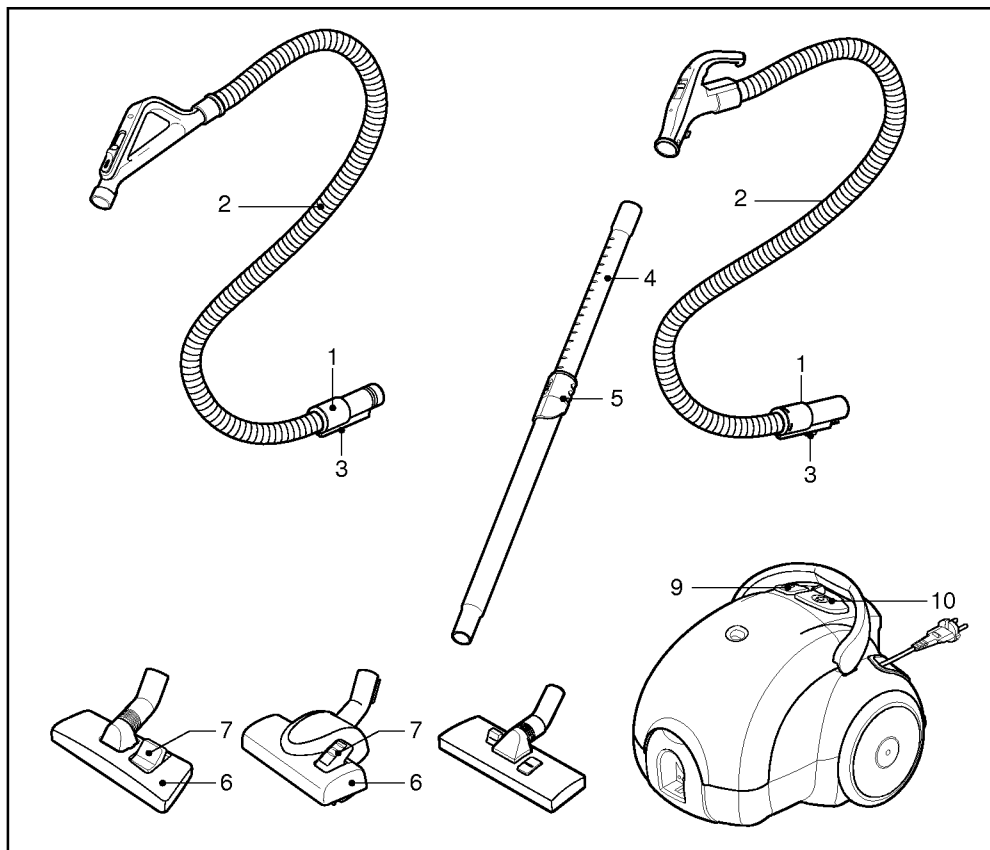

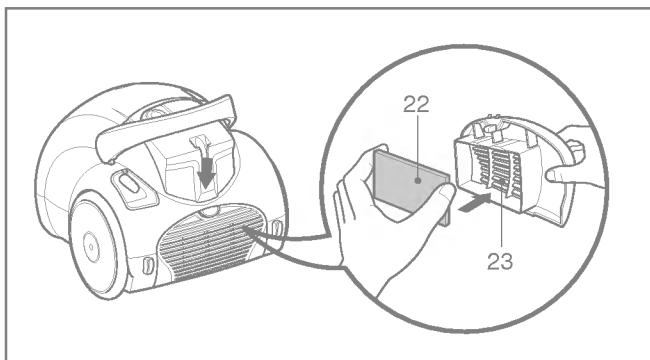
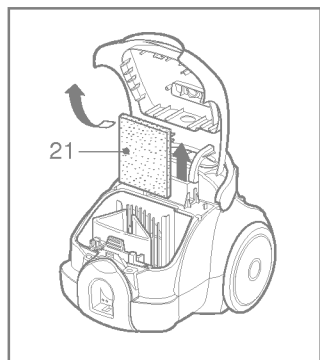
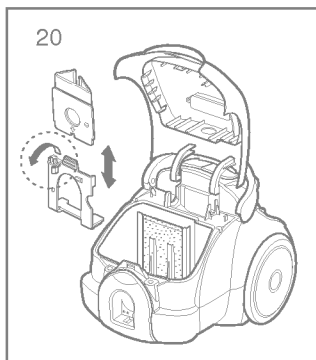
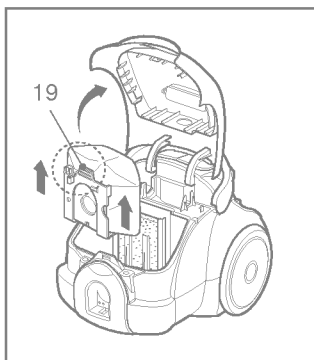
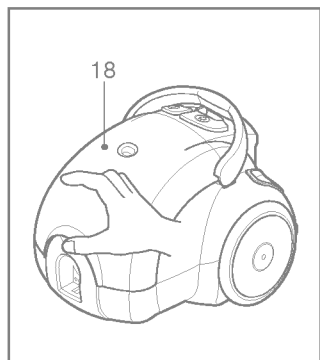
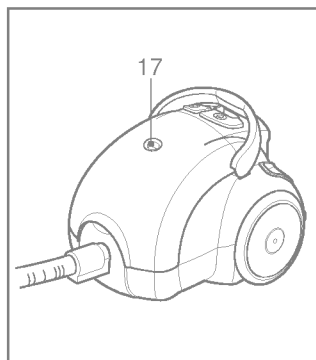
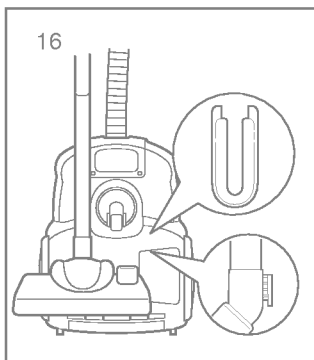
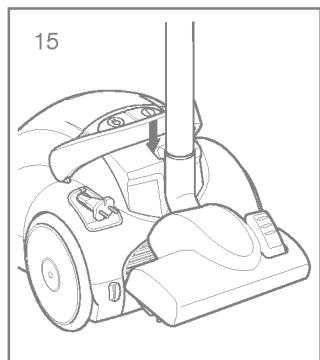
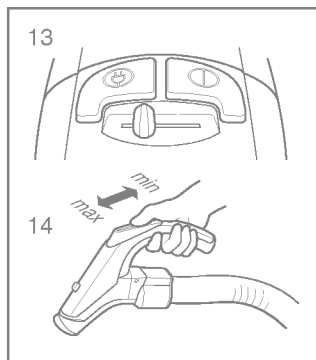
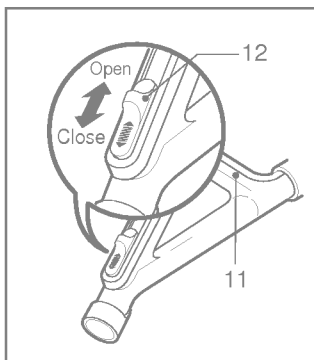
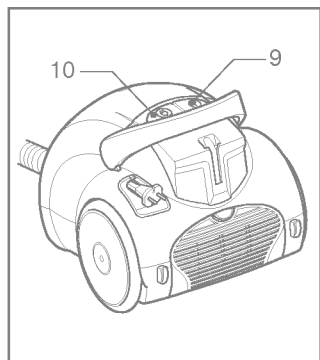

Information for your safety

Please read all the following information, which contains important instructions for the safety, the use and the maintenance of the appliance.

This appliance complies with the following EC Directives: -73/23/EEC, 93/68/EEC-Low Voltage Directive-89/336EEC -EMC Directive.

- Never allow children to use the appliance unsupervised.
- Do not use the appliance if the main lead is damaged or faulty.
- If the main lead is damaged, it must be replaced by an approved LG Electronics Service Agent to avoid a hazard.
- Always switch the vacuum cleaner off before :
 - changing the dust bag
 - changing or cleaning the filters.
- **If no dustbag is inserted, the cover cannot be closed. Please do not use force!**
- Do not vacuum flammable or explosive substances (liquids or gases).
- Do not vacuum hot ash, embers etc. nor sharp objects.
- Do not vacuum water or other liquids.
- When you vacuum with an attachment appliance that has a rotating brush roller, do not reach into the running brush roller.

WARNING! Should it become necessary to replace the moulded on plug then the detective plug should be destroyed to avoid any possible shock hazard that could occur should such a plug be inserted into a 13 amp socket elsewhere in the house.

How to Use

Connecting the flexible hose

Push the end of the head **(1)** on the flexible hose **(2)** into the attachment point on the vacuum cleaner.

To remove the flexible hose from the vacuum cleaner, press on the button **(3)** situated on the head, then pull upwards.

Assembling the tubes

• Telescopic tube **(4)**

- Hold spring latch **(5)**
- Pull out the tube to required length.
- Release spring latch to lock.

Using the cleaning head and Accessory

Fit the large cleaning head onto the end of the tube.

- **The 2 position head (6)** is equipped with a pedal **(7)** which allows you to alter its position according to the type of floor to be cleaned. **Hard floor position** (tiles, parquet floors...). Press on the pedal to lower the brush. **Carpet or rug position.** Press on the pedal to lift the brush up.

Dusting brush & Crevice Tool **(8)**

Dusting Brush is for vacuuming picture frames, furniture outlines, books and other uneven objects.

Crevice Tool is for vacuuming in those normally inaccessible places i.e. reaching coveys, or down the side of a sofa.

How to plug in and use

Pull out the mains lead to the desired length and plug into the socket.

Press button **(9)** to start the vacuum cleaner. To stop it press the button **(9)** again.

Adjusting the power level

(depending on model)

- The flexible hose handle **(11)** has a manual air flow regulator **(12)** which allows you to briefly reduce the suction level.

- **Electronic power control (13)**

Suction capacity increases steplessly up to MAX.

Electronic power control (14)

OFF : Power off **MIN** : Low

MAX : Full power.

Park-System (15)

For short breaks during vacuuming, for example to move a small piece of furniture or a rug, use the Park system to support the flexible hose and cleaning head.

- Slide the hook attached to the large cleaning tool into the slot on the rear of the appliance.

Carring and storage (16)

When you have switched off and unplugged the appliance, press on the button (10) to automatically rewind the cord.

You can move or store your appliance in a vertical position by sliding the hook on the large cleaning head into the clip on the underside of the appliance.

Changing the dust bag

The dustbag needs changing when the cleaner is set to maximum power and the cleaner head is off the floor but the "bag full" indicator window (17) is completely coloured red.

Even if the dustbag does not appear to be full at this stage, it should be changed.

It could be that a great deal of very fine dust has clogged up the pores of the dust bag.

- Turn off the appliance and unplug it.
- Open the cover by pulling the cover(18).
- Pull out the filter bag carrier.
- Push the latch (19) forwards in the direction of the arrow and remove the full dust bag throw it away.
- Insert the new dust bag into the cleaner(20).

Note: as the appliance is fitted with a safety device which checks that the bag is in place you cannot close the cover if the bag is not fitted correctly.

Cleaning the motor filter

The motor filter is situated inside the appliance between the dust bag and the motor. Each time that you change the air outlet filter we advise you to remove the motor filter (21) and to clean it by tapping to remove the dirt and then replacing it in the vacuum cleaner.

Changing the air outlet filters

- To change filter (22) remove the cover of the filter compartment (23) situated at the rear of the appliance, by pushing the little catch.

What to do if your appliance does not work

Check that the appliance is correctly plugged in and that the electrical socket is working.

What to do when the suction performance reduces?

- Stop the appliance and unplug it.
- Check that the tubes, flexible hose and cleaning tool are not blocked.
- Check that the dust bag is not full. Replace it if necessary.
- Check that the air outlet filter is not blocked. Replace it if necessary.

