

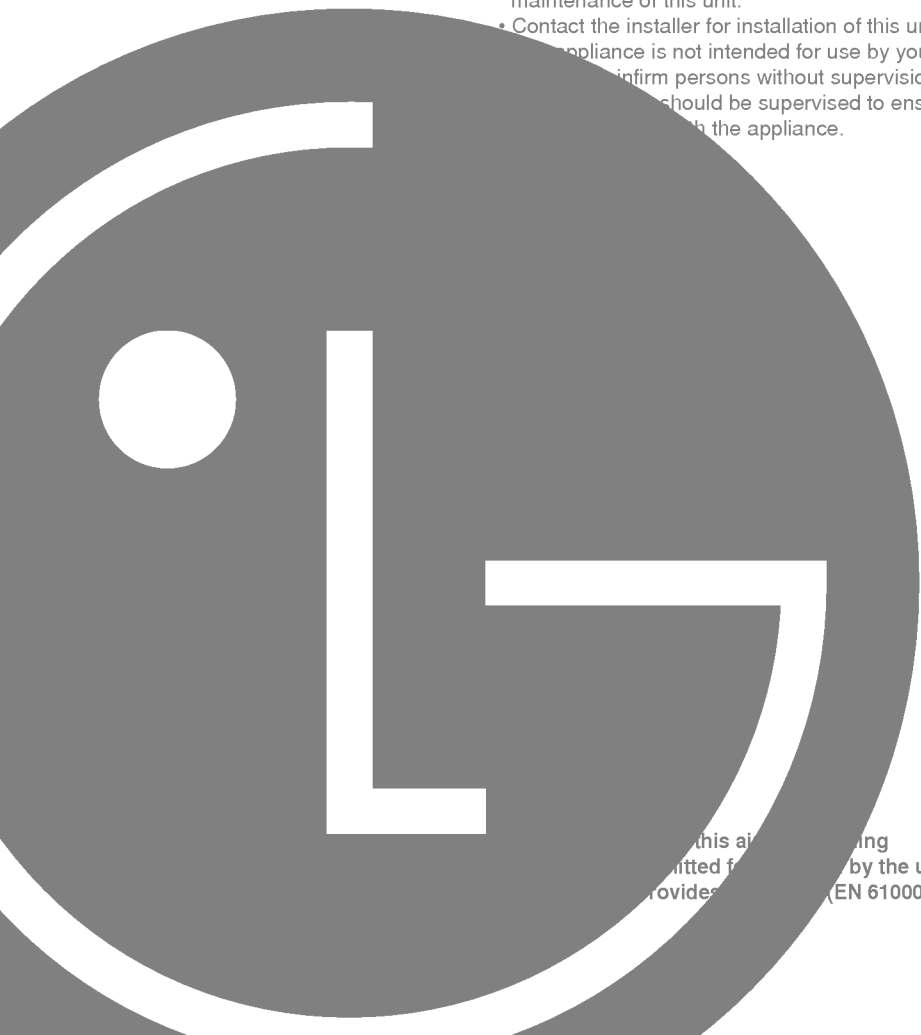

# Multi Type Air Conditioner OWNER'S MANUAL

- Please read carefully and thoroughly this manual before operating this unit.
  - Contact the authorized SVC man for repair or maintenance of this unit.
  - Contact the installer for installation of this unit.
- This appliance is not intended for use by young children or infirm persons without supervision. Children should be supervised to ensure that they do not play with the appliance.



ENGLISH

ITALIANO

ESPAÑOL

FRANÇAIS

DEUTSCH

This air conditioner is designed to be used in accordance with the instructions provided by the utility company (EN 61000-3 Norm).



# Safety precautions

To prevent injury and property damage, follow these instructions.

⚠ Incorrect operation due to ignoring instructions will cause harm or damage, the seriousness of which is indicated by the following symbols.



## WARNING

This symbol shows the possibility of death or serious injury.



## CAUTION

This symbol indicates the possibility of injury or damage to property.



**Never Do This**



**Always Do This**

■ The following items are classified by these symbols.

## ⚠ WARNING



- Otherwise, it will cause electric shock or fire due to heat generation or electric shock.



- It will cause electric shock or fire due to heat generation.



- It will cause electric shock or fire.
- In the supply cord is damaged, it must be replaced by the manufacturer or its service agent or a similarly qualified person in order to avoid a hazard.



- It will cause electric shock or fire due to heat generation.



- It may cause electric shock.



- This could damage your health.



- No grounding may cause electric shock (See Installation Manual).



- It may cause failure of machine or electric shock.



- No installation may cause fire and electric shock accident.



- It may cause fire and electric shock accident.



- It may cause fire and electric shock.



- It may cause electric shock.



- It may cause fire.



- It may cause fire and electric shock.



- It may cause an explosion or fire.

**CAUTION**

- Contact the authorized Service technician for repair or maintenance of this unit.
- Contact the installer for installation of this unit.
- The air conditioner is not intended for use by young children or infirm persons without supervision.
- Young children should be supervised to ensure that they do not play with the air conditioner.

**CAUTION**



- It may cause an injury.
- Should be disconnected from supply



- Water may enter the unit and degrade the insulation. It may cause an electric shock.



- An oxygen shortage may occur.



- Since the fan rotates at high speed during operation, it may cause an injury.



- This could injure the pet or plant.



- The unit may drop or fall down and cause an injury.



- It may cause a fire or deformation of the cabinet.



- It may affect combustion.



- It may cause an injury through dropping or falling down.



- It will cause an injury by the rotating blower.



- If not, dirt may collect and cause a fire.



- It may cause an injury, etc. by falling down.



- Do not use this air conditioner to preserve precision devices, food, animal, plants, and art objects. It may cause deterioration of quality, etc.



- In the cooling mode, if it is operated in a room with high humidity (80%RH or more) for a long time, water condensed in the air conditioner may drop and may wet and spoil furniture, etc.

# Preparation before operation

## How to Insert the Batteries

- 1 Remove the battery cover by pulling it according to the arrow direction.
- 2 Insert new batteries making sure that the (+) and (-) of battery are installed correctly.
- 3 Reattach the cover by sliding it back into position.

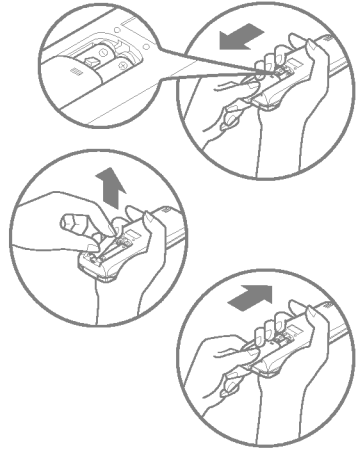

### NOTES:

- Use 2 AAA(1.5volt) batteries. Do not use rechargeable batteries.

## Storage and Tips For Using the Remote Control

- The remote control may be stored mounted on a wall.
- To operate the room air conditioner, aim the remote control at the signal receptor.

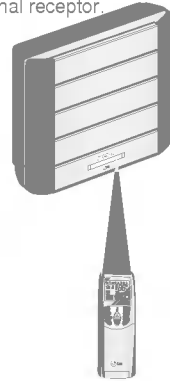
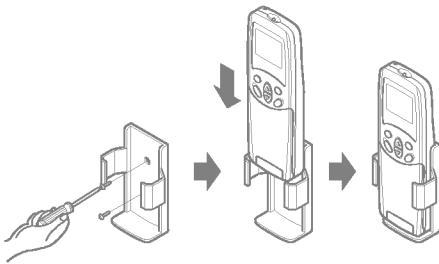

## Signal Receptor

Receives the signals from the remote control.(Signal receiving sound: two short beeps or one long beep.)

## Operation Indication Lamps

- |          |                        |   |
|----------|------------------------|---|
| ⓘ        | On/Off                 | : Lights up during the system operation.                                      |
| ★        | Sleep Mode             | : Lights up during Sleep Mode Auto operation.                                 |
| ⌚        | Timer                  | : Lights up during Timer operation.   |
| ❄️       | Defrost Mode           | : Lights up during Defrost Mode or Hot Start operation.(Heat pump model only) |
| OUT DOOR | Outdoor unit operation | : Lights up during outdoor unit operation. (Cooling model only)               |
| BB       | Temperature            | : Indicate the setting temperature.   |

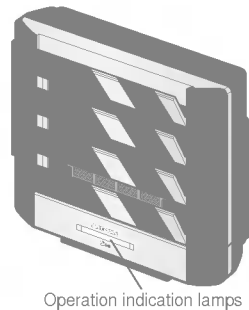

# About the remote control on the system

The remote control transmits the signals to the system.



## Features of the Remote Control

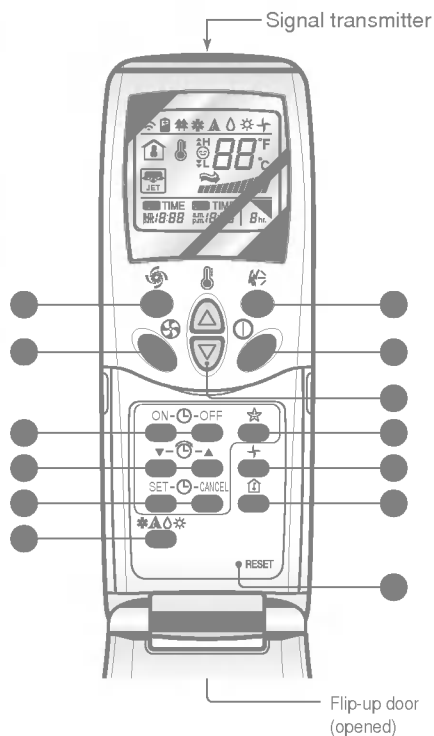

- START/STOP BUTTON**  
 Operation starts when this button is pressed and stops when the button is pressed again.
- OPERATION MODE SELECTION BUTTON**  
 Used to select the operation mode.
- ROOM TEMPERATURE SETTING BUTTONS**  
 Used to select the room temperature.
- INDOOR FAN SPEED SELECTOR**  
 Used to select fan speed in four steps low, medium, high, or CHAOS.
- JET COOL/HEAT**  
 Used to start or stop the speed cooling or heating. (Speed cooling/heating operates super high fan speed in each mode.)
- CHAOS SWING BUTTON**  
 Used to stop or start louver movement and set the desired up/down and right/left airflow direction.
- ON/OFF TIMER BUTTONS**  
 Used to set the time of starting and stopping operation.
- TIME SETTING BUTTONS**  
 Used to adjust the time. (See page 13)
- TIMER SET/CANCEL BUTTONS**  
 Used to set the timer when the desired time is obtained and to cancel the Timer operation.(See page 13)
- SLEEP MODE AUTO BUTTON**  
 Used to set Sleep Mode Auto operation.(See page 13)
- AIR CIRCULATION BUTTON**  
 Used to circulate the room air without cooling or heating (turns indoor fan on/off).(See page 14)
- ROOM TEMPERATURE CHECKING BUTTON**  
 Used to check the room temperature.
- RESET BUTTON**  
 Used prior to resetting time or after replacing batteries.

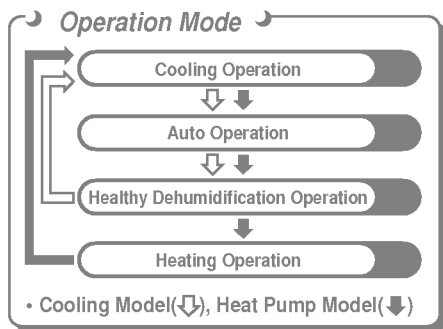

# How to use the Operation Mode Selection button



## Cooling Operation

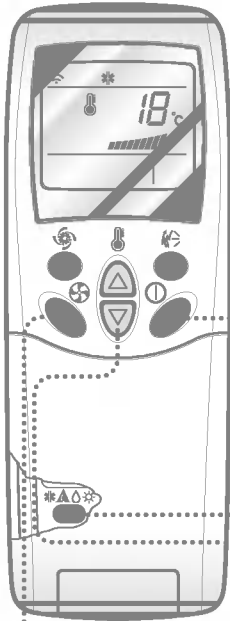

- 1 Press the Start/Stop button. The unit will respond with a beep.



- 2 Open the door on the remote control. To select **Cooling Operation**, press the Operation Mode Selection button. Each time the button is pressed, the operation mode is shifted in the direction of the arrow.

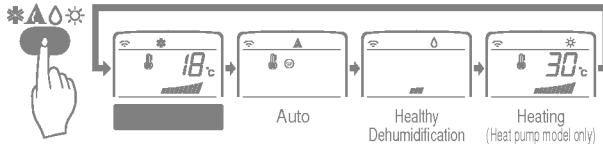

- 3 Close the door on the remote control. Set the temperature lower than the room temperature. The temperature can be set within a range of 18°C~30°C in 1°C increments.

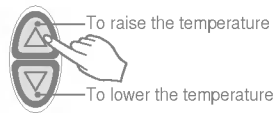

- 4 Set the fan speed again with the door of the remote control still closed. You can select the fan speed in four steps—low, medium, high, or CHAOS. Each time the button is pressed, the fan speed mode is shifted.



### Natural wind by the CHAOS logic

- For more fresh feeling than other fan speed, press the Indoor Fan Speed Selector and set to CHAOS mode. In this mode, the wind blows like natural breeze by automatically changing fan speed according to the CHAOS logic.



## Auto Operation

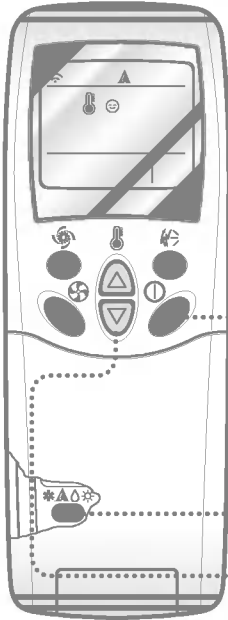

- 1** Press the Start/Stop button.  
The unit will respond with a beep.



- 2** Open the door on the remote control. To select **Auto Operation**, press the Operation Mode Selection button. Each time the button is pressed, the operation mode is shifted in the direction of the arrow.

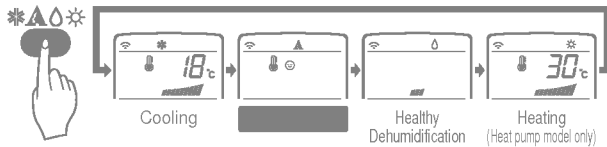

- 3** The temperature and fan speed are automatically set by the electronic controls based on the actual room temperature. If you want to change the set temperature, close the door on the remote control and press the Room Temperature Setting buttons. The cooler or warmer you feel, the more times (up to two times) you should press the button. The set temperature will then be changed automatically.

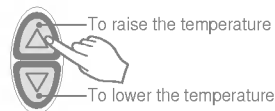

### During Auto Operation:

- You cannot switch the indoor fan speed. It has already been set by the Fuzzy rule.
- If the system is not operating as desired, manually switch to another mode. The system will not automatically switch from the cooling mode to the heating mode, or from heating to cooling, it must be done by manually resetting.
- During Auto Operation, pressing the chaos swing button makes the horizontal louvers swing up and down automatically. If you want to stop auto-swing, press the chaos swing button again.



## Healthy Dehumidification Operation

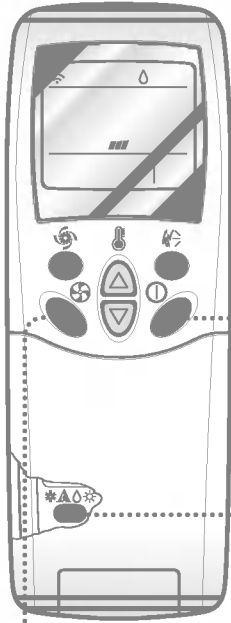

- 1** Press the Start/Stop button.  
The unit will respond with a beep.



- 2** Open the door on the remote control. To select **Healthy Dehumidification Operation**, press the Operation Mode Selection button.  
Each time the button is pressed, the operation mode is shifted in the direction of the arrow.

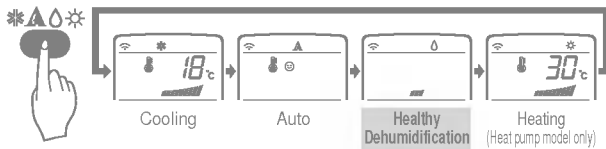

- 3** Set the fan speed again with the door of the remote control still closed. You can select the fan speed in four steps—low, medium, high, or CHAOS. Each time the button is pressed, the fan speed mode is shifted.



### Natural wind by the CHAOS logic

- For more fresh feeling than other fan speed, press the Indoor Fan Speed Selector and set to CHAOS mode. In this mode, the wind blows like natural breeze by automatically changing fan speed according to the CHAOS logic.

### During Healthy Dehumidification Operation:

- If you select the dehumidification mode on the operation selection button, the A/C starts to run the dehumidification function, automatically setting the room temp. and airflow volume to the best condition for dehumidification based on the sensed current room temp.

In this case, however, the setting temp. is not displayed in the remote control and you are not able to control the room temp. either.

- During the healthy dehumidification function, the airflow volume is automatically set according to the optimization algorithm responding to the current room temp. status and makes the room condition healthy and comfortable even in the high humidity season.



## Heating Operation(Heat pump model only)

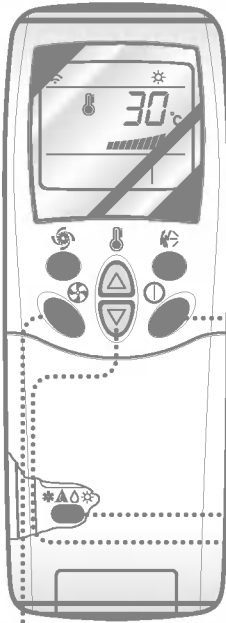

- 1** Press the Start/Stop button.  
The unit will respond with a beep.



- 2** Open the door on the remote control. To select **Heating Operation**, press the Operation Mode Selection button. Each time the button is pressed, the operation mode is shifted in the direction of the arrow.

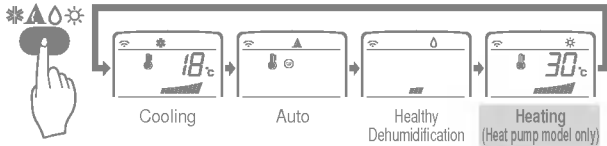

- 3** Close the door on the remote control.  
Set the temperature higher than the room temperature.  
The temperature can be set within a range of 16°C~30°C in 1°C increments.

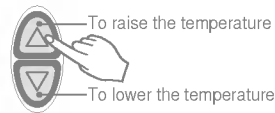

- 4** Set the fan speed again with the door of the remote control still closed. You can select the fan speed in four steps—low, medium, high, or CHAOS. Each time the button is pressed, the fan speed mode is shifted.



### Natural wind by the CHAOS logic

- For more fresh feeling than other fan speed, press the Indoor Fan Speed Selector and set to CHAOS mode. In this mode, the wind blows like natural breeze by automatically changing fan speed according to the CHAOS logic.



## Jet Cool Operation

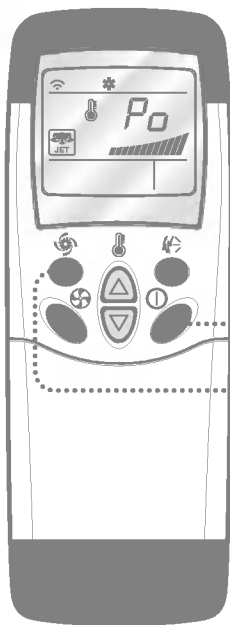

- 1 Press the Start/Stop button.  
The unit will respond with a beep.



- 2 Press the **Jet Cool** button to operate the speed cooling mode and the unit will operate in super high fan speed on cooling mode for 30 minutes.



- 3 To cancel the **Jet Cool** mode, press the **Jet Cool** button again or the fan speed button or the room temperature setting button and the unit will operate in high fan speed on cooling mode.



### NOTE:

- During the JET COOL function at any moment, the A/C starts to blow the cool air with side louvers closed at extremely high speed for 30 minutes setting the room temp. automatically to 18 °C. It is especially used to cool the room temp. in the shortest time in a hot summer. But the JET COOL function is just available for cooling or dehumidification mode.
- In order to return to the normal cooling mode from the JET COOL mode, you just press either the operation mode selection button, airflow volume selection or temp. setting button or the JET COOL button again.



## Jet Heat Operation

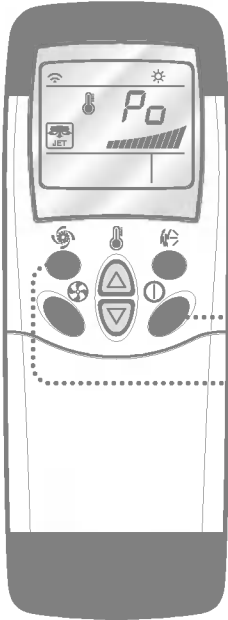

- 1** Press the Start/Stop button.  
The unit will respond with a beep.



- 2** Press the **Jet Heat** button to operate the speed heating mode and the unit will operate in super high fan speed on heating mode for 60 minutes.



- 3** To cancel the **Jet Heat** mode, press the **Jet Heat** button again or the fan speed button or the room temperature setting button and the unit will operate in high fan speed on heating mode.



### NOTE:

- ❑ During the JET HEAT function at any moment, the A/C starts to blow the hot air with side louvers closed at extremely high speed for 60 minutes setting the room temp. automatically to 30 °C. It is especially used to heat the room temp. in the shortest time in a cold winter. But the JET HEAT function is just available for Heating mode.
- ❑ In order to return to the normal heating mode from the JET HEAT mode, you just press either the operation mode selection button, airflow volume selection or temp. setting button or the JET HEAT button again.

# Additional features



## Sleep Mode

● Press the Sleep Mode Auto button to set the time you want the unit to turn off automatically.



To cancel the Sleep Mode, press the sleep Mode Auto button several times until the star (★) disappears from the operation display.

● The Timer is programmed in one-hour increments by pressing the Sleep Mode Auto button 1 to 7 times.

The sleep mode is available for 1 to 7 times. To alter the time period in steps of 1 hour, press the Sleep Mode Button while aiming at air conditioner.

**Note:** The Sleep Mode will be operated at low fan speed (cooling) or medium fan speed (heat pump only) for quiet sleeping.

● Make sure the Sleep Mode Auto LED lights up.

IN COOLING MODE: The temperature will automatically rise by 1°C over the next 30 minutes and by 2°C in 1 hour for comfortable sleeping.



## Setting the Time

● Time can be set only when you have pressed the Reset button. If you have just replaced the batteries, the Reset button should be pressed to reset the time.

Press the Start/Stop button.



● Press the Time Setting buttons until the desired time is set.



● Press the Timer SET button.



**Note:** Check the indicator for A.M. and P.M.



## Delay Start/Pre-Set Stop

● Make sure the time is set correctly on the remote control display.

● Press the ON/OFF Timer buttons to turn Timer on or off.



● Press the Time Setting buttons until the desired time is set.



● Press the selected on/off setting by pressing the Timer SET button while aiming the remote control at the signal receptor.



**To cancel the setting the timer.**



Press the Timer Cancel button while aiming remote control at the signal receptor.

(The timer lamp on the air conditioner and the display will go out.)

**NOTE:** Select one of the following four types of operation.

with the unit running



Delay OFF Timer



Delay ON Timer



Delay OFF and ON Timer



Delay ON and OFF Timer



## Airflow Direction Control

The up/down and right/left airflow can be adjusted by using the remote control.

Press Chaos Swing button and the louvers will swing.

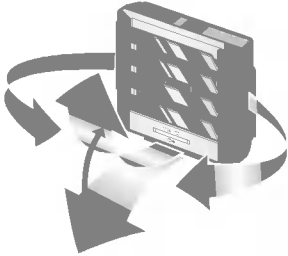

Press the Start/Stop button to start the unit.



Press the button again and the louvers will stop. After 30 minutes, the louvers return to the maximum airflow position automatically.



## Air Circulation Mode

Circulates the room air without cooling or heating.

- Press the Start/Stop button. the unit will respond with a beep.
- Open the door on the remote control. Press the Air Circulation button. Close the door on the remote control. Now each time that you press the Indoor Fan Speed Selector, the fan speed is shifted from low to CHAOS and back to low again.

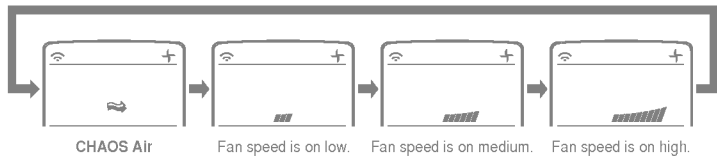

### Note:

- **CHAOS Air** economizes power consumption and prevents overcooling. The fan speed is automatically changed from high to low or vice versa, depending on the ambient temperature.



## Forced Operation

Operation procedures when the remote control can't be used.  
The operation will be started if the power button is pressed.  
If you want to stop operation, re-press the button.

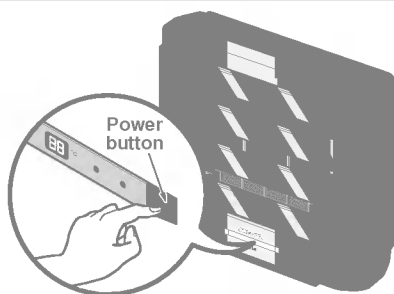

|                     | Cooling Model        | Heat pump Model                      |  |                                   |
|---------------------|----------------------|--------------------------------------|--|-----------------------------------|
|                     |                      | Room Temp. $\geq 24^{\circ}\text{C}$ | $21^{\circ}\text{C} \leq \text{Room Temp.} < 24^{\circ}\text{C}$ | Room Temp. $< 21^{\circ}\text{C}$ |
| Operating mode      | Cooling              | Cooling                              | Healthy Dehumidification   | Heating                           |
| Indoor FAN Speed    | High                 | High                                 | High   | High                              |
| Setting Temperature | $22^{\circ}\text{C}$ | $22^{\circ}\text{C}$                 | $23^{\circ}\text{C}$   | $24^{\circ}\text{C}$              |

### Test operation

During the TEST OPERATION, the unit operates in cooling mode at high speed fan, regardless of room temperature and resets in 18 minutes.

During test operation, if remote controller signal is received, the unit operates as remote controller sets. If you want to use this operation, open the front panel upward and Press the power button let it be pressed for about 3 seconds.

If you want to stop the operation, re-press the button.

### Auto restart

In case the power comes on again after a power failure, Auto Restarting Operation is the function to operate procedures automatically to the previous operating conditions.

So there is no need of activating this function by pressing any key or button.

In the initial mode, the fan operates at a low speed and the compressor starts 2.5~3 minutes later.

As the compressor starts, the fan speed also resumes its previous setting mode.

### Helpful information

Fan speed and cooling capacity.

The cooling capacity indicated in the specification is the value when the fan speed is set to high, and the capacity will be lower at low or medium fan speed.

High fan speed is recommended when you wish to cool the room quickly.

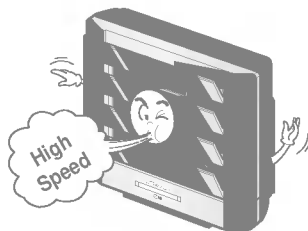

# Care and maintenance of the air conditioner

**CAUTION:** Before performing any maintenance, turn off the main power to the system.

## Indoor Unit

### Grille, Case, and Remote Control

- Turn the system off before cleaning. To clean, wipe with a soft, dry cloth. Do not use bleach or abrasives.

**NOTE:**

Supply power must be disconnected before cleaning the indoor unit.

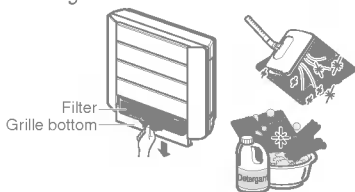

### AIR FILTERS

The air filters behind the front grill should be checked and cleaned once every 2 weeks or more often if necessary.

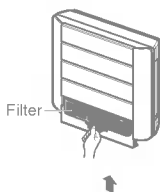

- Never use any of the followings:

- Water hotter than 40 °C.  
Could cause deformation and/or discoloration.
- Volatile substances  
Could damage the surfaces of the air conditioner.



- Pull down the grille bottom, After lifting up the filter tab a bit and take the filter out slowly (Notice : Clean the filter after being stopped the product)
- Clean the filter with a vacuum or warm, soapy water.
  - If dirt is conspicuous, wash with a solution of detergent in lukewarm water.
  - If hot water (40 °C or more) is used, it may be deformed.
- After washing with water, dry well in the shade.
- Re-install the air filter.

## When the air conditioner is not going to be used for a long time.

- 1 Operate the air conditioner on Air circulation mode (Refer to page 14) for 2 to 3 hours.

- This will dry out the internal mechanisms.

- 2 Turn off the circuit breaker.



### CAUTION

Turn off the circuit breaker when the air conditioner is not going to be used for a long time.

Dirt may collect and may cause a fire.

- 3 Remove the batteries from the remote control.

- 1 Clean the air filter and install it in the indoor unit.  
(Refer to page 16 for cleaning filters.)

- 2 Check that the air inlet and outlet of the indoor/outdoor unit are not blocked.

## Operation Tips

This is not good for the health and wastes electricity.

Do not let direct sunshine enter the room when the air conditioner is in operation.

Adjust the vertical and horizontal airflow direction to ensure a uniform temperature in the room.

Avoid opening doors and windows as much as possible to keep the cool air in the room.

Blockages in the air filter reduce the airflow and lower cooling and dehumidifying effects. Clean at least once every two weeks.

Since windows are kept closed, it is a good idea to open them and ventilate the room now and then.

# Before you call for service...



## Troubleshooting Tips! Save time and money!

Check the following points before requesting repairs or service.... If the fault persists, please contact your dealer or service center.

| Case   | Explanation  | See page |
|--|--|----------|
| The air conditioner does not operate.                                | • Have you made a mistake in timer operation?  | 13       |
|  | • Has the fuse blown or has the circuit breaker been tripped?  | -        |
| The room has a peculiar odor.  | • Check that this is not a damp smell exuded by the walls, carpet, furniture, or cloth items in the room.  | -        |
| It seems that condensation is leaking from the air conditioner.      | • Condensation occurs when the airflow from the air conditioner cools the warm room air.   | -        |
| Air conditioner does not operate for about 3 minutes when restarted. | • This is the protector of the mechanism.<br>• Wait about three minutes and operation will begin.  | -        |
| Does not cool or heat effectively.                                   | • Is the air filter dirty? See air filter cleaning instructions.   | 16       |
|  | • Has the temperature been set incorrectly?  | 7, 10    |
|  | • Are the indoor unit's air inlet or outlet vents obstructed?  | -        |
| The air conditioner operation is noisy.                              | • For a noise that sounds like water flowing.<br>-This is the sound of freon flowing inside the air conditioner unit.<br>• For a noise that sounds like the compressed air releasing into atmosphere.<br>-This is the sound of the dehumidifying water being processed inside the air conditioning unit. | -        |
| Remote control display is faint, or no display at all.               | • Are the batteries depleted?<br>• Are the batteries inserted in the opposite (+) and (-) directions?  | 5        |
| Crack sound is heard.  | • This sound is generated by the expansion/constriction of the front panel, etc. due to changes of temperature.  | -        |

### NOTE

WATER RESISTANT: The outdoor side of this appliance is WATER RESISTANT.

The indoor side is not water resistant and should not be exposed to excess water.