



## ***Car CD/MP3 Receiver***

### ***OWNER'S MANUAL MODEL : LAC-M1500***



Before connecting, operating or adjusting this product,  
please read this instruction booklet carefully and completely.

The working life of this product is 7 years since the date of purchase.



# Table of Contents

## INTRODUCTION

Table of Contents . . . . .	2-3
Safety Precautions . . . . .	4
Before Use . . . . .	5-7
Symbol Used in this Manual . . . . .	5
Notes on Discs . . . . .	5
Use and care of the remote control (OPTIONAL) . . . . .	6
Using the remote control (OPTIONAL) . . . . .	6
Handling the Unit . . . . .	6
Protecting your unit from theft . . . . .	7
Attaching the front panel . . . . .	7
Front Panel . . . . .	8
Remote Control (OPTIONAL) . . . . .	9

## PREPARATION

Installation . . . . .	10-11
Basic Installation . . . . .	10
ISO-DIN Installation . . . . .	11
Connections . . . . .	12-13
Connecting to Car . . . . .	12-13
Connecting to Auxiliary Equipment (OPTIONAL) . . . . .	13

## OPERATION

Basic Operation . . . . .	14-15
Turning the unit on . . . . .	14
Turning the unit off . . . . .	14
Selecting a source . . . . .	14
Adjusting the volume . . . . .	14
Setting the clock . . . . .	14
Checking the clock . . . . .	14
SOUND Adjustment . . . . .	15
Using the EQ (Equalizer) . . . . .	15
MUTE . . . . .	15
SELECTION (SEL) Button . . . . .	15
XDSS (Extreme Dynamic Sound System) . . . . .	15

Table of Contents



Radio Operation . . . . . 16-17

    Listening the radio stations . . . . . 16

    Storing and recalling broadcast frequencies . . . . . 16

    Auto Search Memory . . . . . 17

Operation with Audio CD, MP3 Disc and CD changer . . . . . 18-19

    Playing an Audio CD and MP3 Disc . . . . . 18

    Playing a CD changer (OPTIONAL) . . . . . 18

        Playback Setup . . . . . 18

        Moving to another Disc . . . . . 18

        Pause . . . . . 18

        Moving to another Track . . . . . 18

        Search . . . . . 18

        Repeat . . . . . 19

        Random . . . . . 19

        MP3 TRACK -10/+10 . . . . . 19

        Intro scan . . . . . 19

        ID 3 TAG . . . . . 19

Notes on MP3 Recordings . . . . . 20

    About MP3 . . . . . 20

**REFERENCE**

Troubleshooting . . . . . 21

Specifications . . . . . 22





## Safety Precautions

### CAUTION

RISK OF ELECTRIC SHOCK DO NOT OPEN



Warning: To reduce the risk of electric shock, do not remove the cover or back of this product. There are no user-serviceable parts inside. Refer servicing to qualified service personnel.



Warning: To reduce the risk of fire or electric shock, do not expose this product to dripping or splashing water, rain, or moisture. Do not place objects filled with water such as vases, on the product.

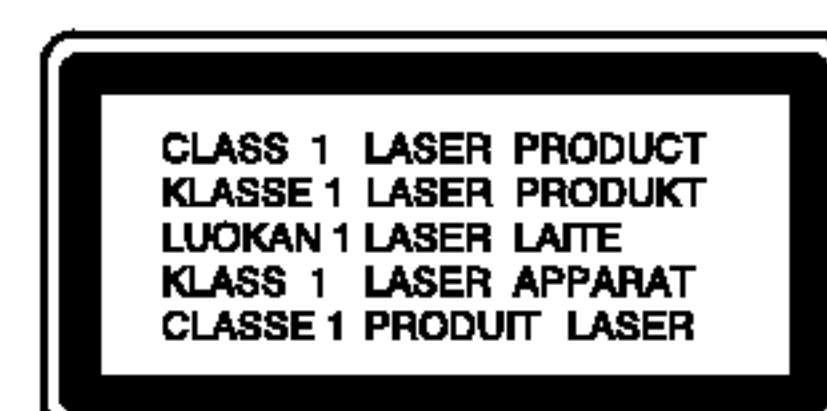

Caution: Do not install this product in a confined space such as a book case or similar unit.



Caution: Protect this product from moisture.



Caution: If the battery is disconnected or discharged, the preset memory will be erased and must be reprogrammed.

### CAUTION:

This unit employs a Laser System.

To ensure proper use of this product, please read this owner's manual carefully and retain for future reference should the unit require maintenance, contact an authorized service location (see service procedure).

Use of controls, adjustments, or the performance of procedures other than those specified herein may result in hazardous radiation exposure.

To prevent direct exposure to laser beam, do not try to open the enclosure. Visible laser radiation when open. DO NOT STARE INTO BEAM.



## Before Use



To ensure proper use of this product, please read this owner's manual carefully and retain for future reference.

### Symbol Used in this Manual



The lightning flash symbol alerts you to the presence of dangerous voltage within the product enclosure that may constitute a risk of electric shock.



Indicates hazards likely to cause harm to the unit itself or other material damage.

#### NOTE

Indicates special notes and operating features.

#### TIP

Indicates tips and hints for making the task easier.

### Notes on Discs

#### Handling Discs

Do not touch the playback side of the disc. Hold the disc by the edges so that fingerprints do not get on the surface. Never stick paper or tape on the disc.



#### Storing Discs

After playing, store the disc in its case. Do not expose the disc to direct sunlight or sources of heat and never leave it in a parked car exposed to direct sunlight.

#### Cleaning Discs

Fingerprints and dust on the disc can cause poor picture quality and sound distortion. Before playing, clean the disc with a clean cloth. Wipe the disc from the center out.

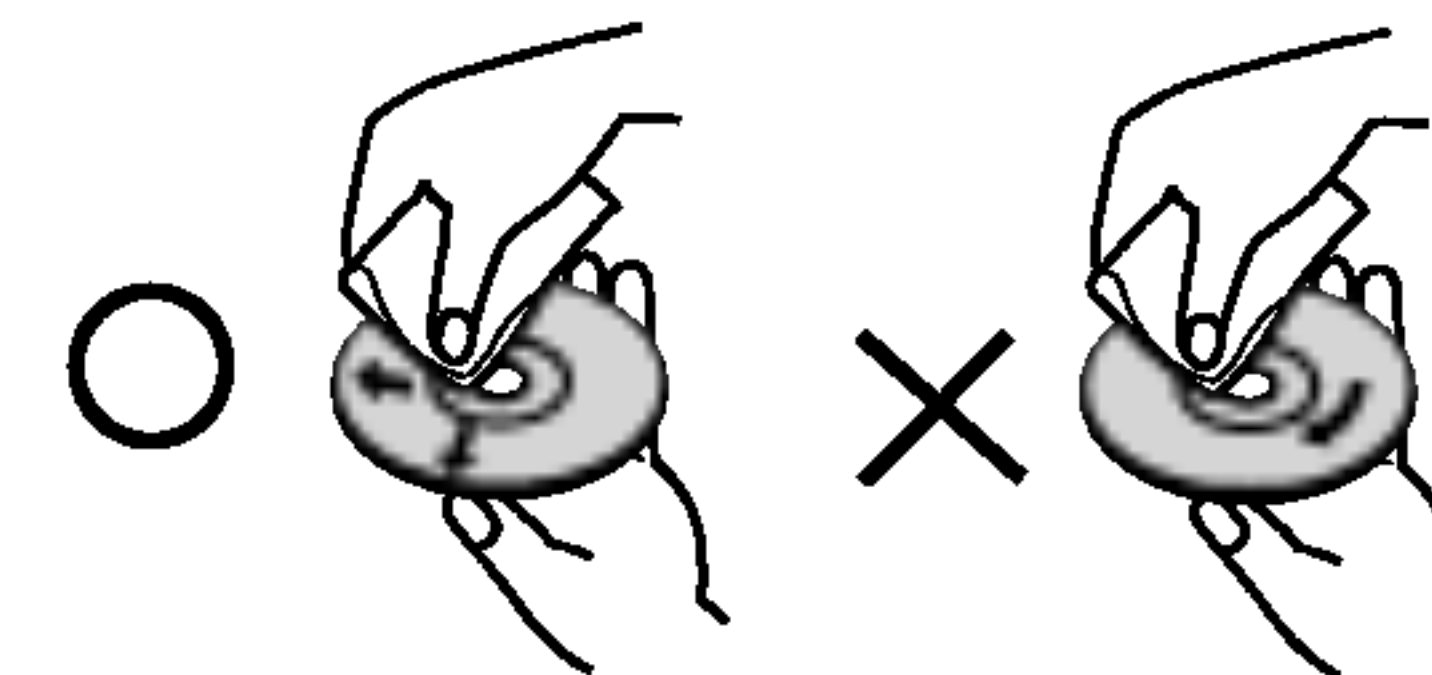

Do not use strong solvents such as alcohol, benzine, thinner, commercially available cleaners, or anti-static spray intended for older vinyl records.

This unit cannot be operated by 8cm disc (using 12cm disc only).

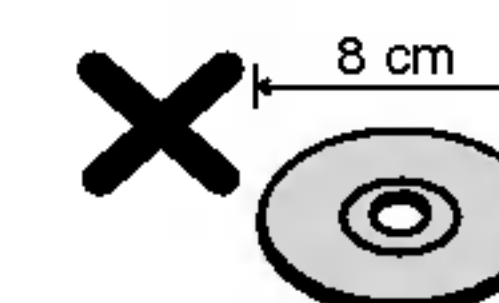





## Before Use

### Use and care of the remote control (OPTIONAL)

#### Installing the battery

Pull the tray outward on the back of the remote control with a pencil or ball point pen and insert the battery with the plus (+) minus (-) poles pointing in the proper direction.

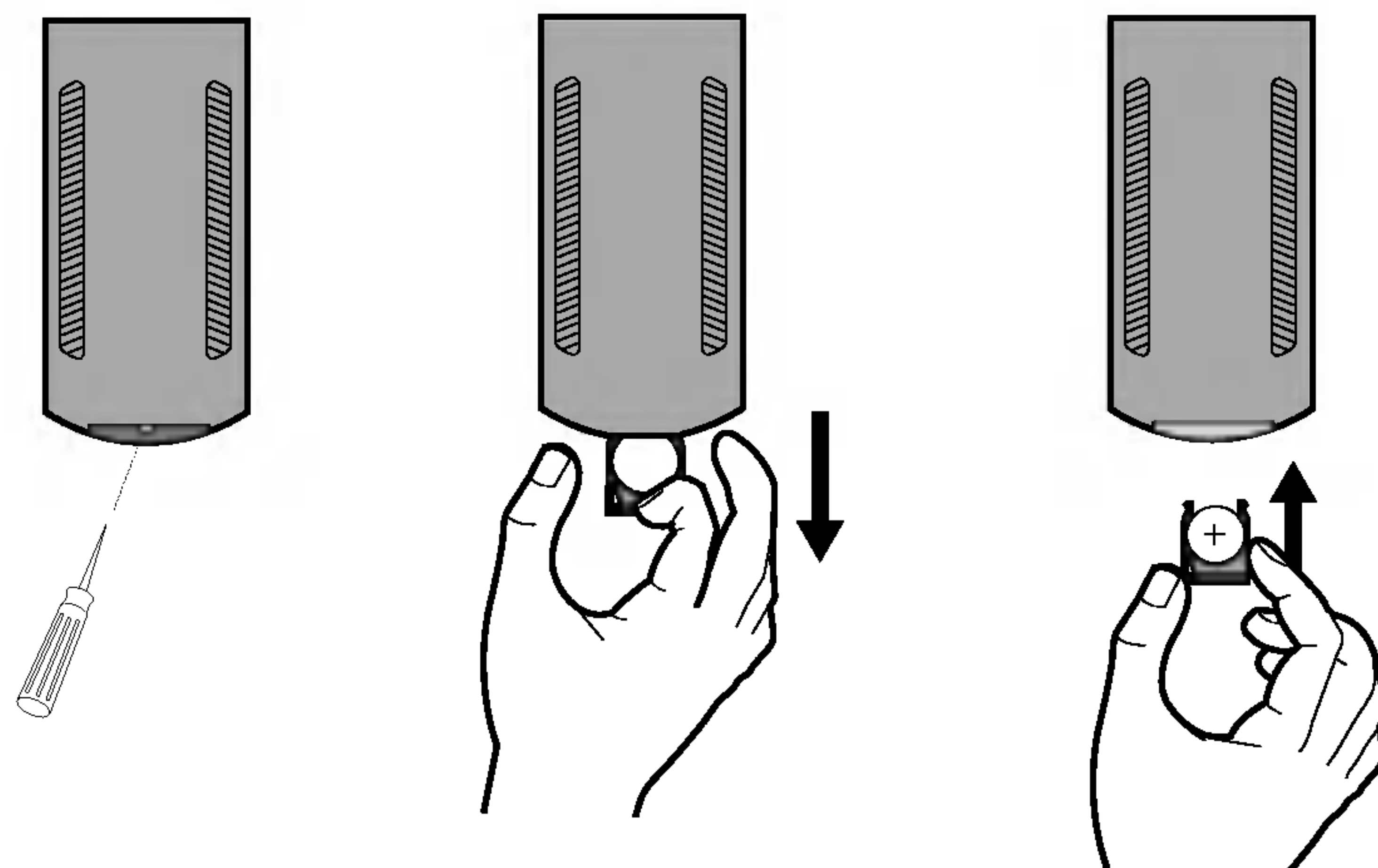

#### NOTES

- Use only one CR2025 (3V) lithium battery.
- Remove the battery if the remote control is not used for long.
- Do not recharge, disassemble, heat or dispose of the battery in fire.
- Do not handle the battery with metallic tools.
- Do not store the battery with metallic materials.
- In the event of battery leakage, wipe the remote control completely clean and install a new battery.

### Using the remote control (OPTIONAL)

Point the remote control in the direction of the front panel to operate.

#### NOTES

- The remote control may not function properly in direct sunlight.
- Do not store the remote control in high temperatures or sunlight.
- Do not let the remote control fall onto the floor, where it may become jammed under the brake or accelerator pedal.

### Handling the Unit

- This unit is designed to be operated on a 12 volt DC negative ground electrical system only.
- When replacing the fuse, be sure to use the fuse whose amperage rating is identical. Use of a fuse with higher amperage may cause serious damage to the unit.
- Periodically wipe the contacts on the back of the front panel with a cotton swap moistened with alcohol.

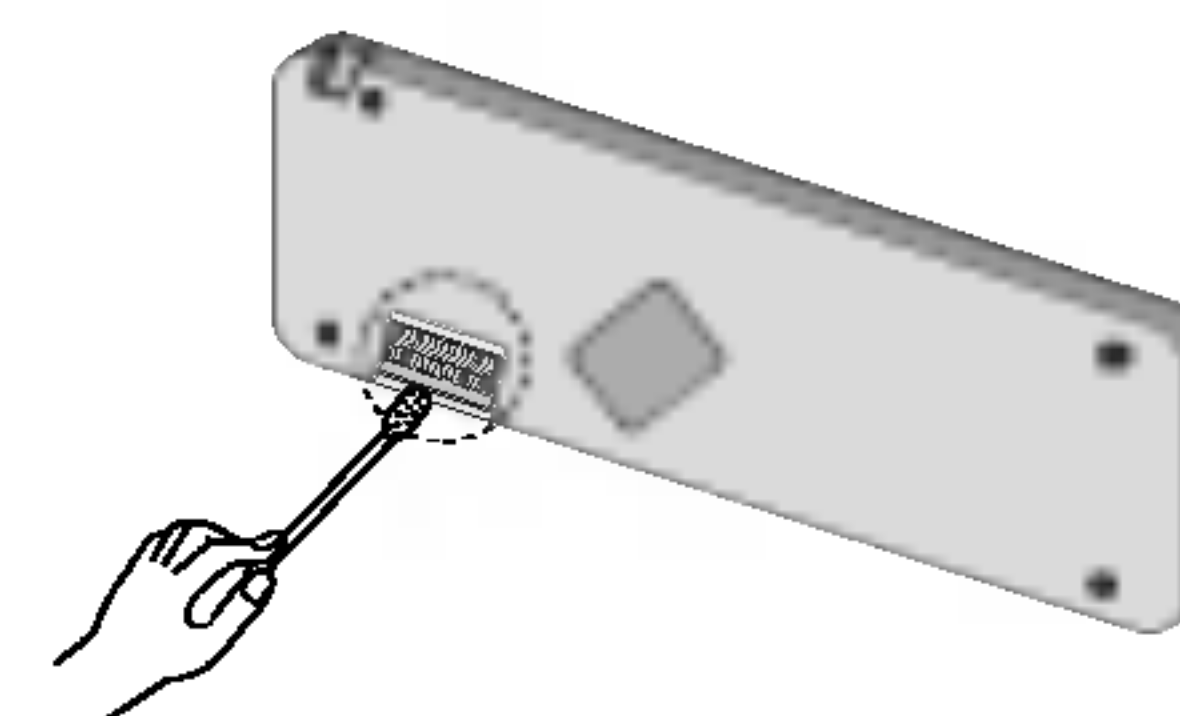

### Protecting your unit from theft

The front panel can be detached from the head unit and stored in the protective case provided to discourage theft.

1. Press **RELEASE**  to open the front panel.

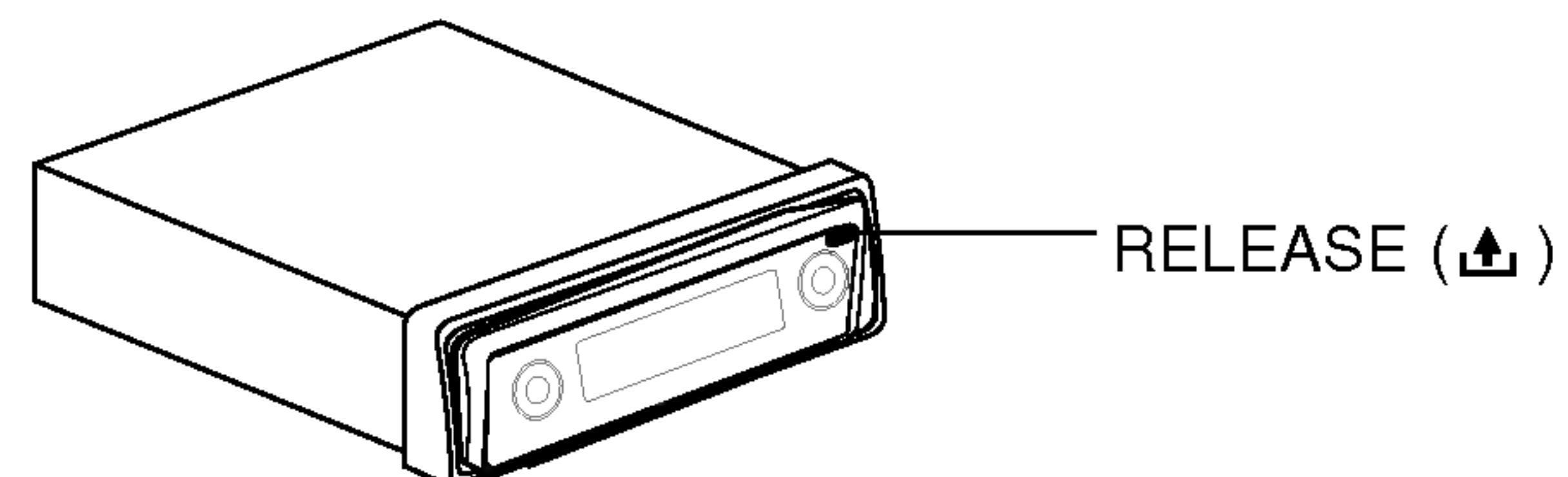

2. Grip the left side of the front panel and pull it gently outward.

Take care not to grip it tightly or to drop it.

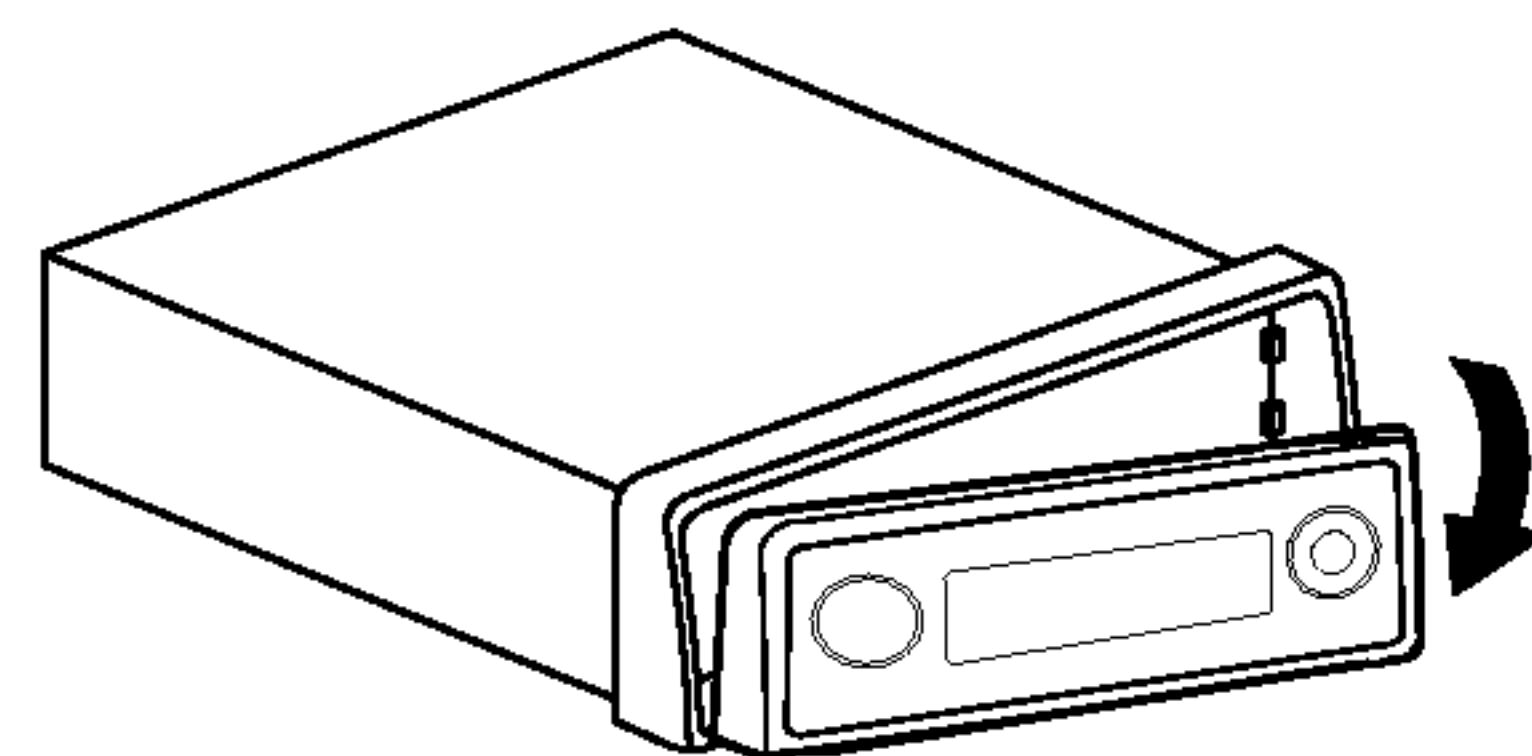

3. Put the front panel into the protective case provided for safe keeping.

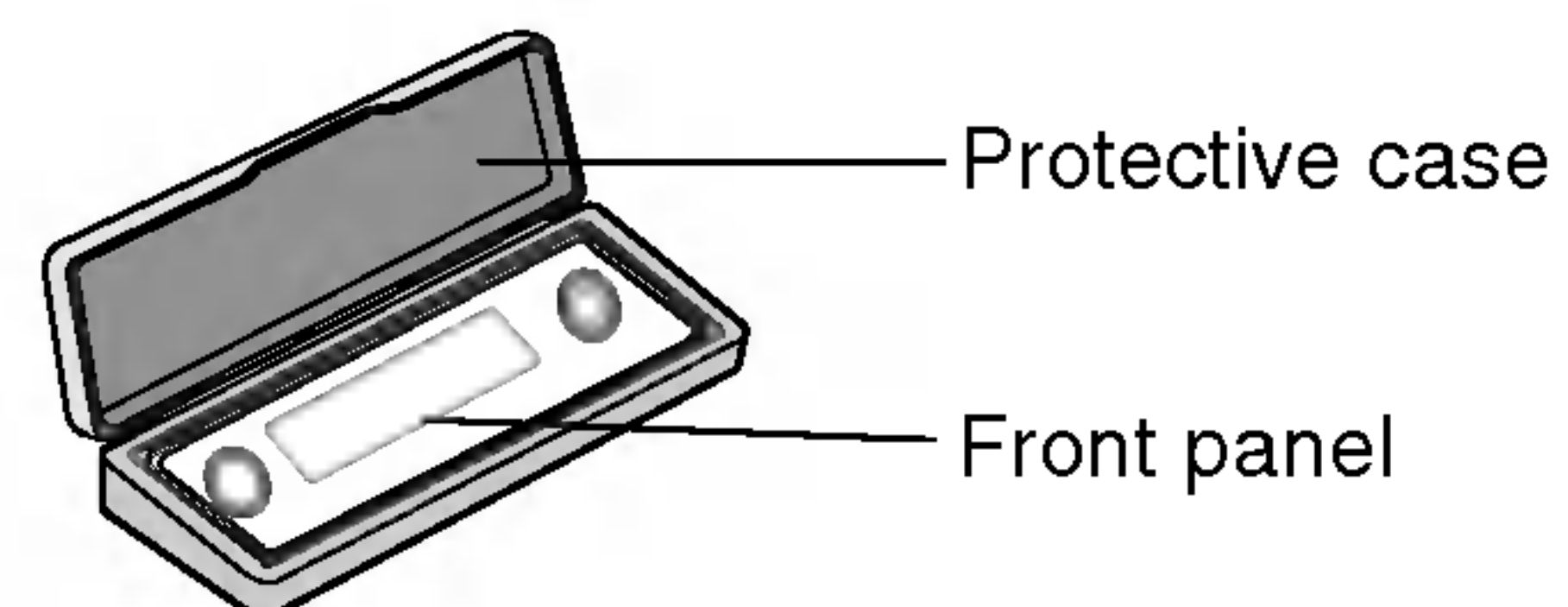

### Attaching the front panel

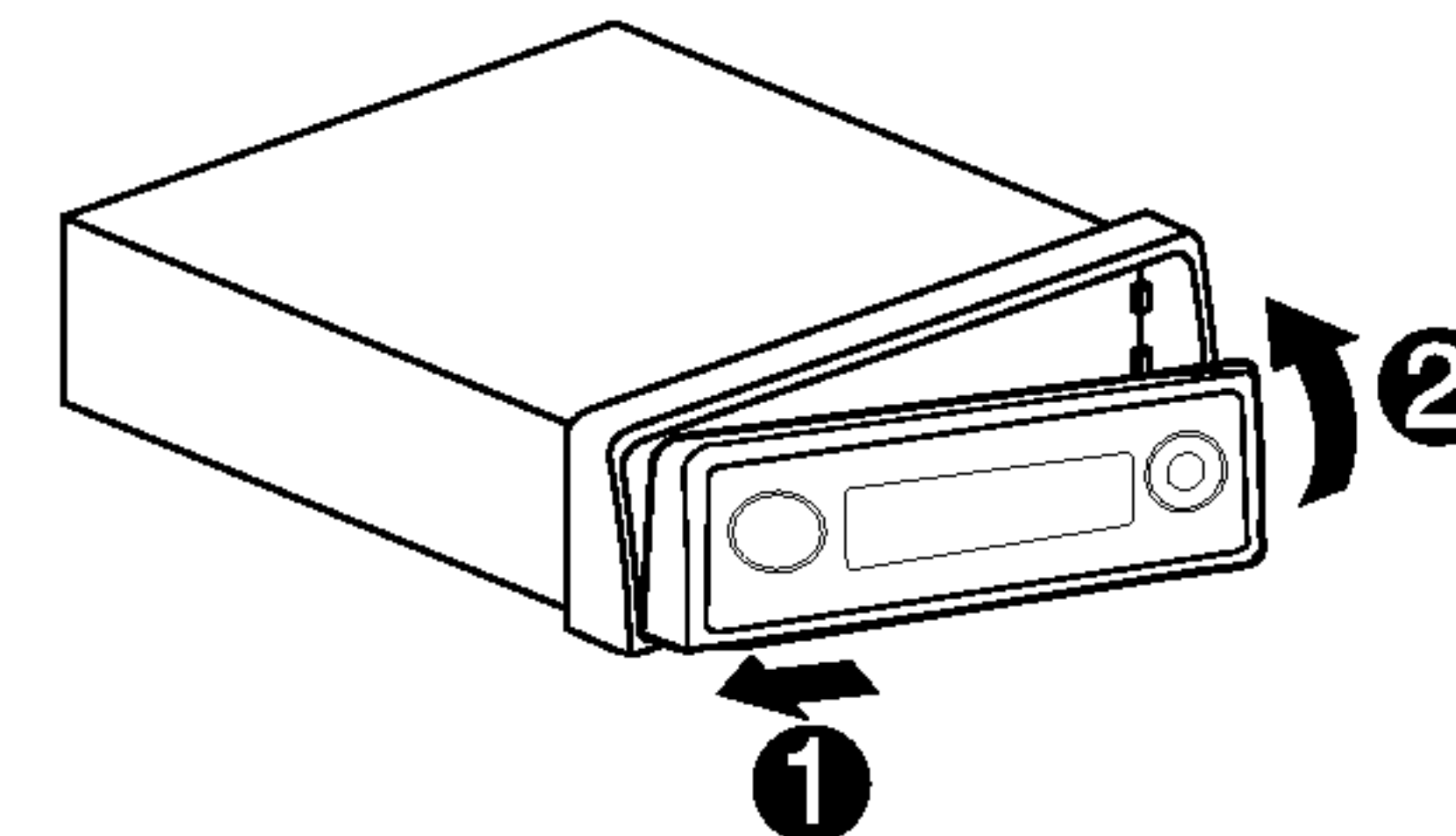

Align the left side of the panel with the stopper, and then push the right side of the panel into the unit until it clicks.



## Front Panel

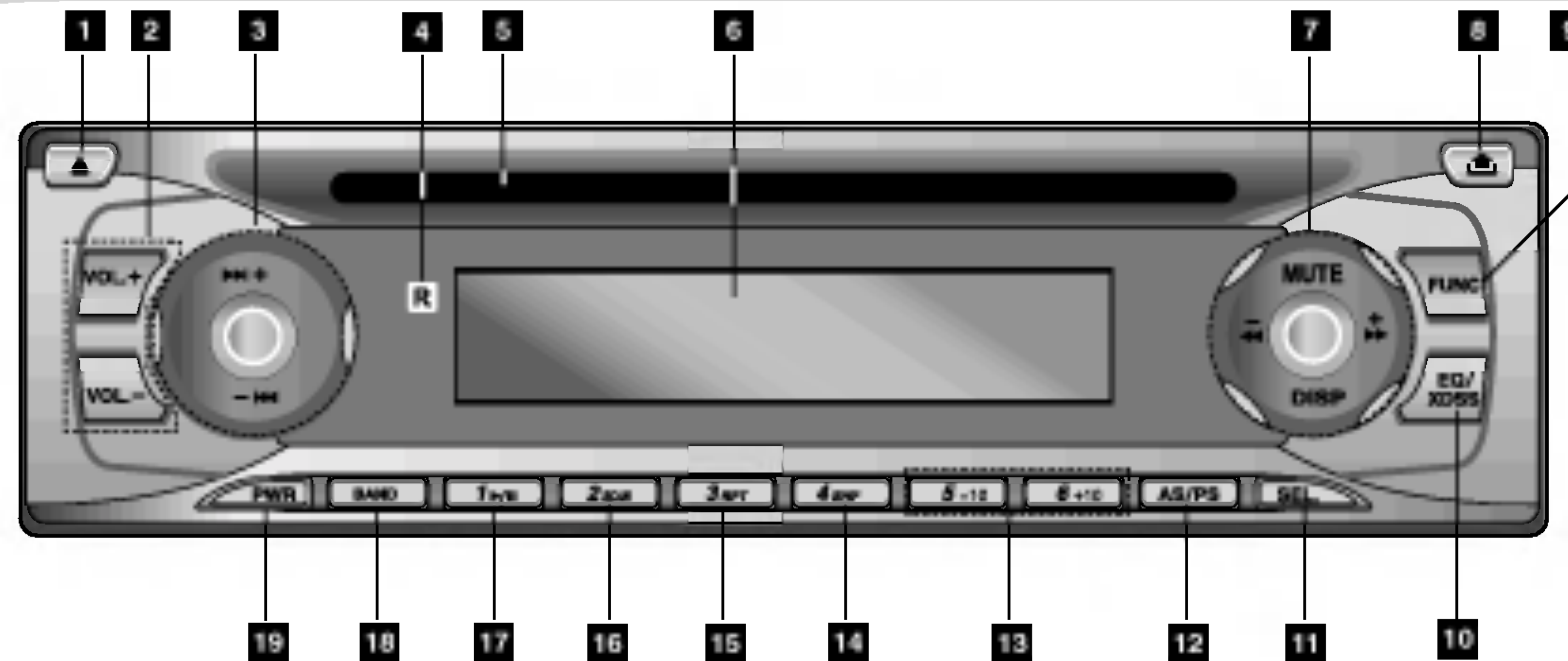

- |                                   |   |
|-----------------------------------|---|
| <b>1</b> EJECT (▲) button         | <b>10</b> EQUALIZER/XDSS (EQ/XDSS) button               |
| <b>2</b> • VOLUME (VOL./+) button | <b>11</b> SELECTION (SEL.) button                       |
| • CONTROL UP/DOWN button          | <b>12</b> AUTO STORE/PRESET SCAN (AS/PS) button         |
| <b>3</b> • CD SKIP(◀▶) buttons    | <b>13</b> MP3 TRACK +/-10 (D-/+) button                 |
| • SEEK (-/+) buttons              | <b>14</b> SHUFFLE (SHF) button                          |
| <b>4</b> REMOTE SENSOR (OPTIONAL) | <b>15</b> REPEAT (RPT) button                           |
| <b>5</b> CD disc slot             | <b>16</b> INTRO SCAN (SCAN) button                      |
| <b>6</b> DISPLAY WINDOW           | <b>17</b> CD PLAY/PAUSE (▶  ) button                    |
| <b>7</b> • MUTE button            | <b>18</b> BAND button                                   |
| • CD SEARCH(◀▶) buttons           | <b>19</b> PWR button                                    |
| • TUNE (-/+) buttons              | <b>13, 14, 15, 16, 17</b> Preset Station buttons. (1-6) |
| • DISPLAY (DISP) button           |   |
| <b>8</b> RELEASE (▲) button       |   |
| <b>9</b> FUNCTION (FUNC) button   |   |



## Remote Control (OPTIONAL)

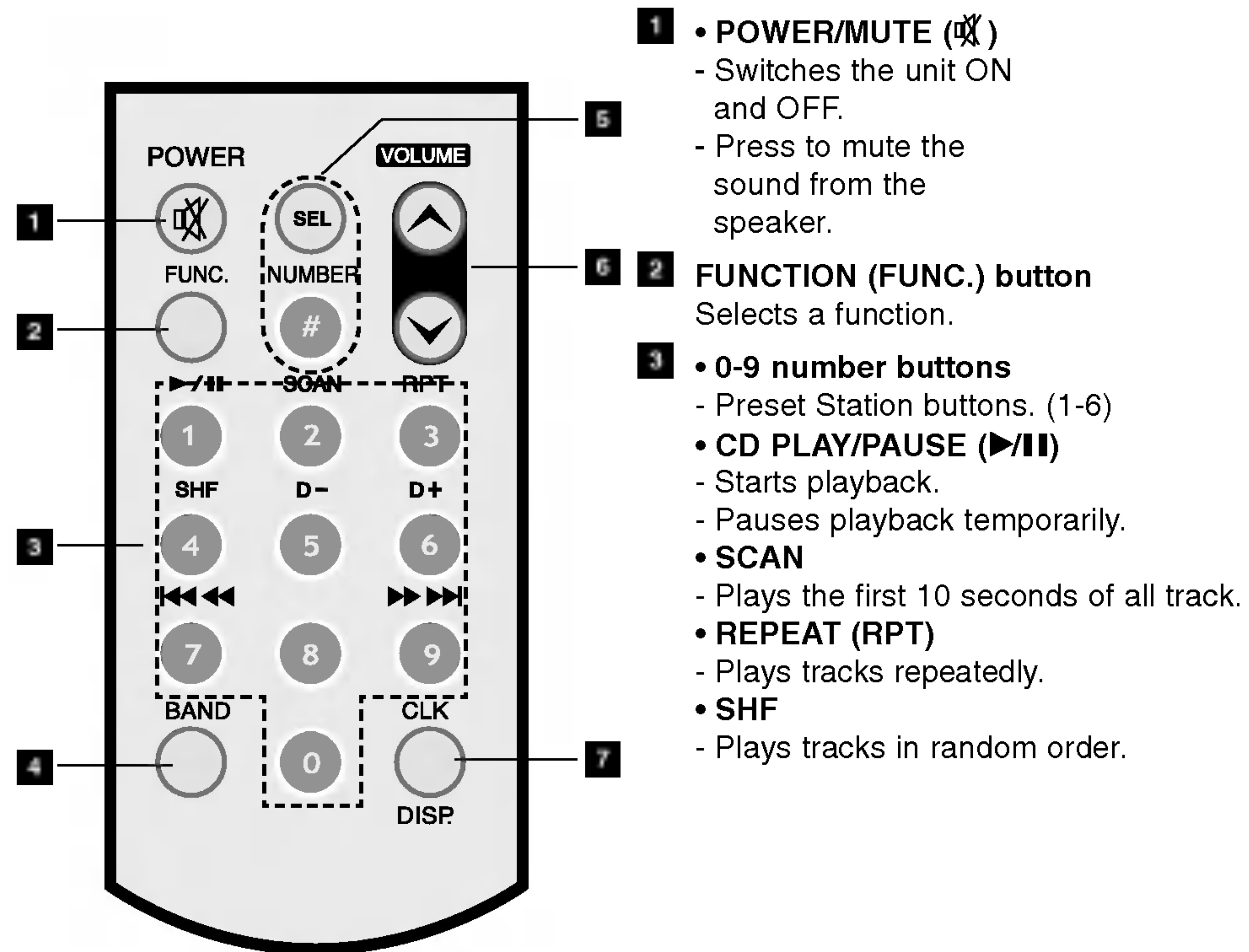

- 1 • POWER/MUTE (🔊)**
  - Switches the unit ON and OFF.
  - Press to mute the sound from the speaker.
- 2 • FUNCTION (FUNC.) button**
  - Selects a function.
- 3 • 0-9 number buttons**
  - Preset Station buttons. (1-6)
- CD PLAY/PAUSE (▶/⏸)**
  - Starts playback.
  - Pauses playback temporarily.
- SCAN**
  - Plays the first 10 seconds of all track.
- REPEAT (RPT)**
  - Plays tracks repeatedly.
- SHF**
  - Plays tracks in random order.

- 4 • SKIP/SEARCH (⏮⏭ / ⏭⏮)**
  - Backward or forward search playback.
  - Go to next track. Returns to beginning of current track or go to previous track.
- DISC SELECTOR (D-/+) button (Optional)**
- 5 • BAND**
  - Selects three FM and MW (AM) bands.
- 6 • SEL**
  - Enters the audio settings.
- NUMBER (#)**
- 7 • VOLUME (🔊 / 🔇)**
  - Adjusts the volume level.
- 8 • DISPLAY (DISP.)**
  - Changes the display.
- CLOCK (CLK)**
  - Clock display.



## Installation

### Basic Installation

Before installing, make sure that the ignition-switch is set to OFF and remove the terminal of the car battery to avoid short-circuiting.

1. Remove the existing receiver unit.
2. Make the necessary connections.
3. Install the installation sleeve.
4. Install the unit in to the installation sleeve.

### **Removing existing receiver unit**

If there is already an installation sleeve for the receiver unit in the dashboard, it must be removed.

### **When removing the unit from the installation sleeve**

If you need to remove the unit from the installation sleeve, proceed as follows.

1. Remove the rear supporter from the unit.
2. Remove the front panel and trim ring from the unit.
3. Insert the lever  into the hole on one side of the unit. Do the same operation on the other side and pull out the unit from the installation sleeve.

Bend the claws according to the thickness of the dashboard

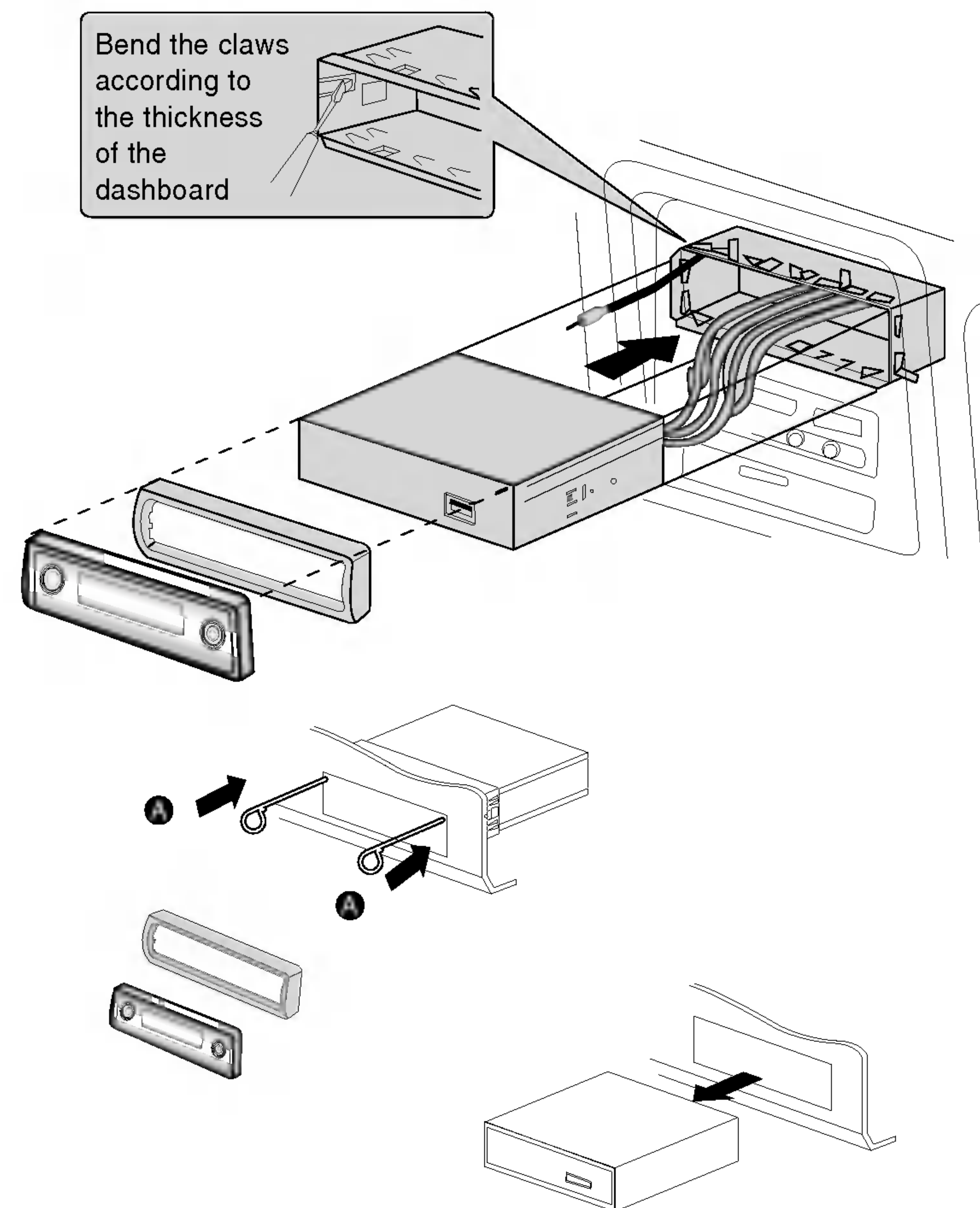



## ISO-DIN Installation

1. Slide the unit into ISO-DIN frame.
2. Install screws removed from old unit.
3. Slide the unit and frame into dash opening.
4. Install dash panel or adapter plate.
5. Install trim ring to the unit.
6. Install faceplate by fitting right edge into position then pushing left edge closed.

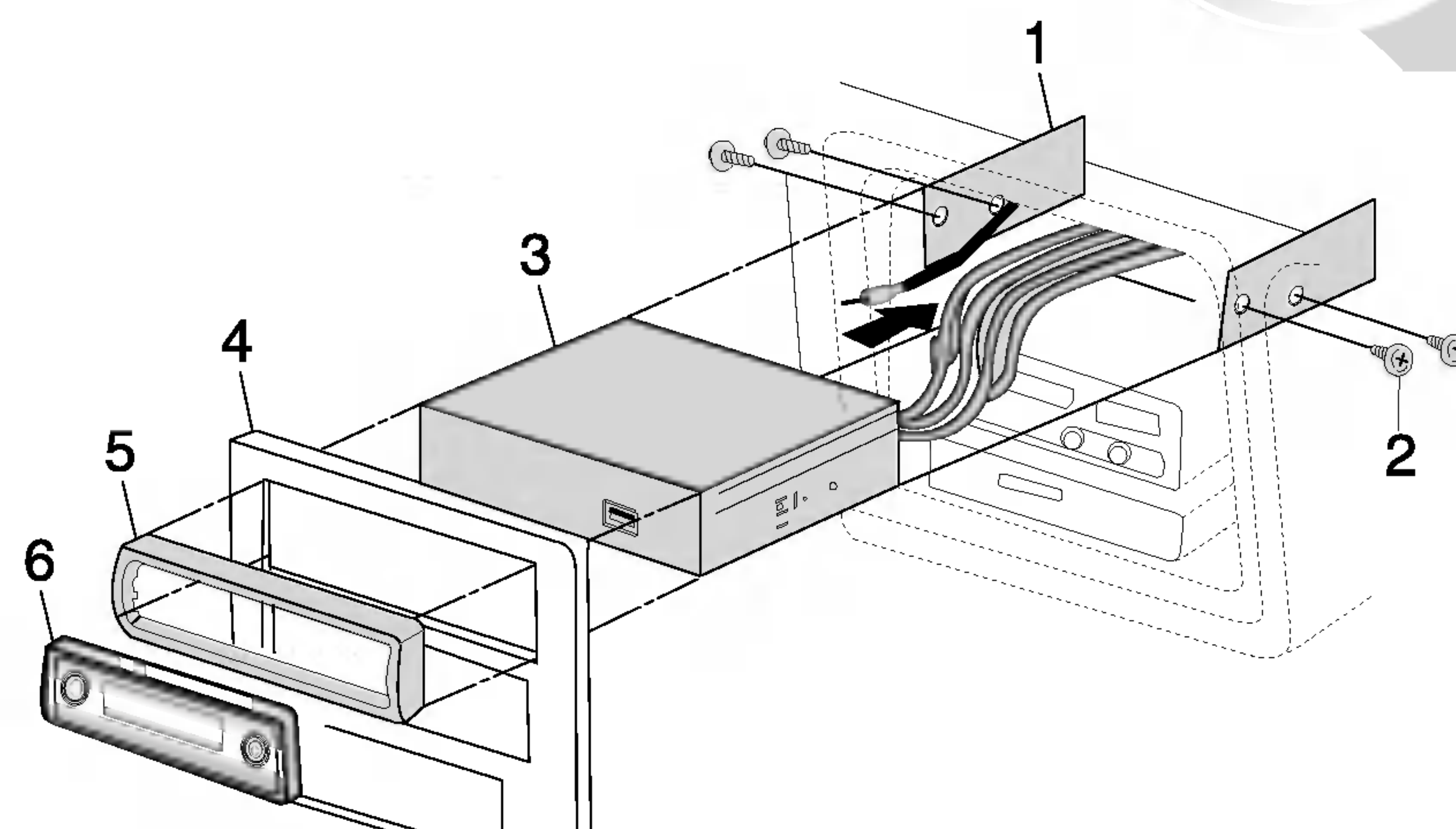



## Connections

### Connecting to Car

Before connecting, make sure that ignition switch is set to OFF, and remove the ⊖ terminal of the battery to avoid short circuits.

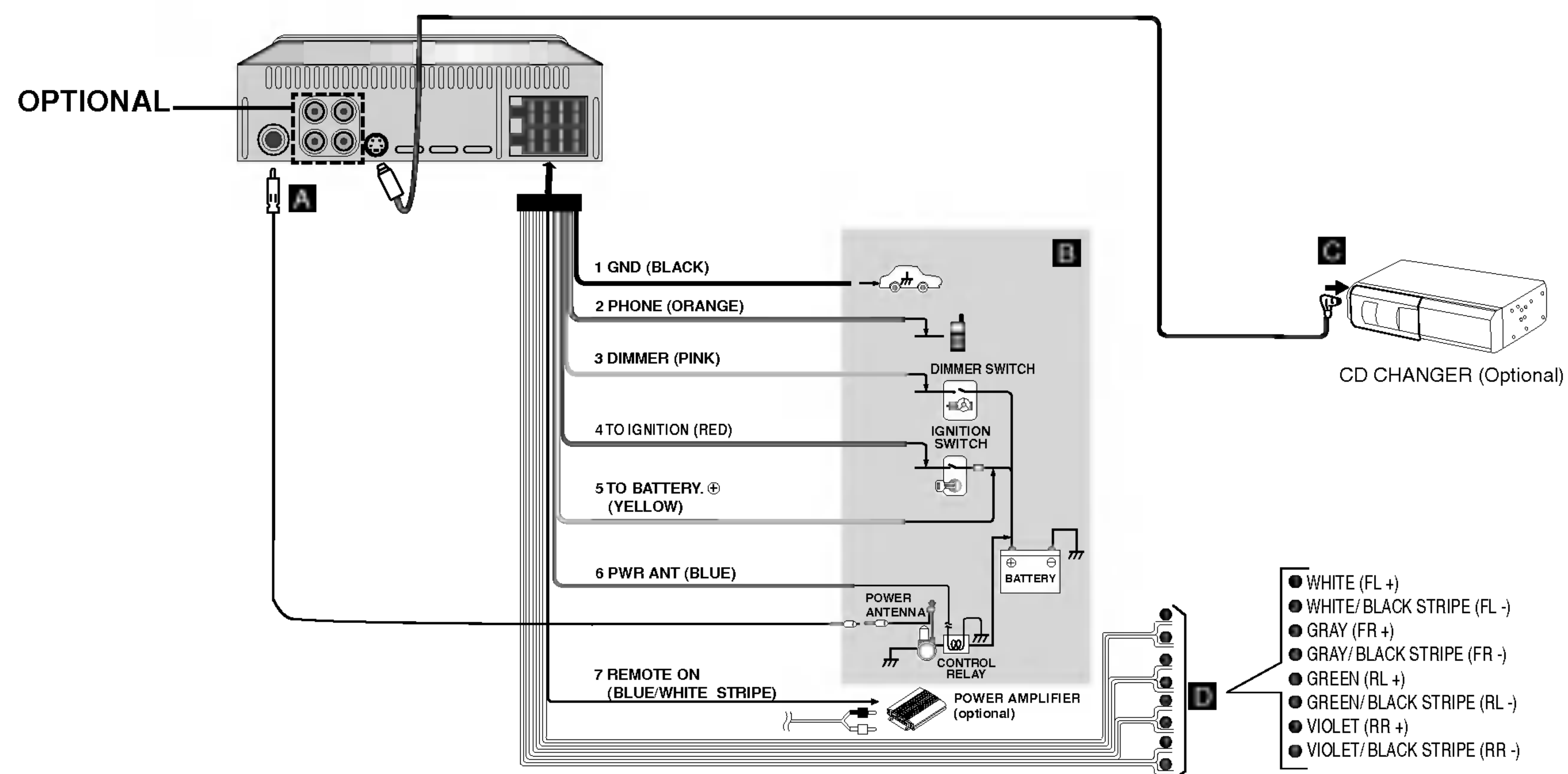



# Connections

## Connecting to Car

### A From antenna

### B To the wiring of vehicle Colors of leads

- 1 **BLACK** : This lead is for connection to the Ground.
- 2 **ORANGE** : This lead is for connection to the phone line.
- 3 **PINK** : This lead is for connection to the Dimmer line
- 4 **RED** : This lead is for connection to the terminal from which the power is supplied when the ignition switch is set to ACC.
- 5 **YELLOW** : This lead is for connection to the Battery (back-up) terminal from which the power is always supplied.
- 6 **BLUE** : This lead is for connection to the power antenna.
- 7 **BLUE/WHITE STRIPE** : This lead is for connection to the amplifier remote on.

### C Connect the CD changer

- Your car receiver works as control unit for a CD changer which you can buy, if not yet done, later.
- The suitable cord shown on the scheme will be provided together with the CD changer.

### D Speaker Connections

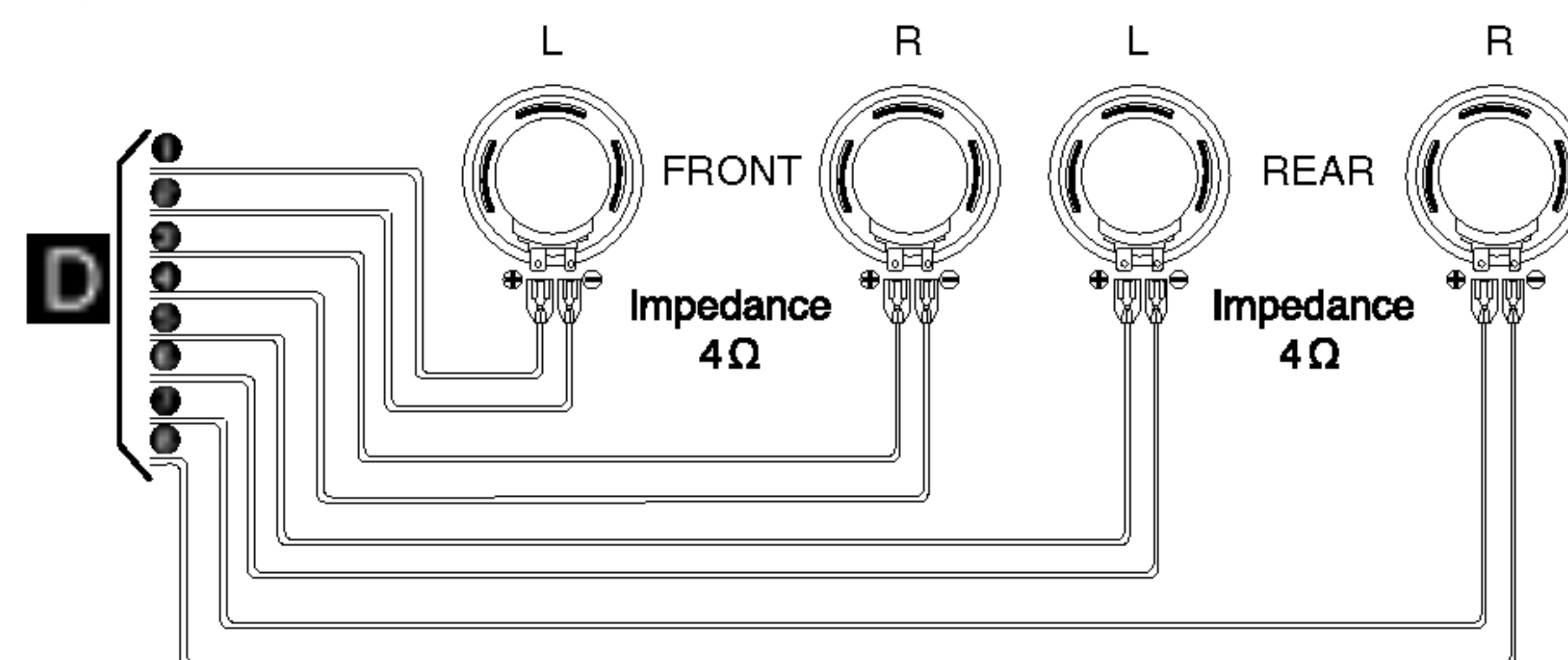

## Connecting to Auxiliary Equipment (OPTIONAL)

- Connect the **AUDIO OUTPUT** connector of this unit to the **AUDIO INPUT** connector of Auxiliary Equipment.

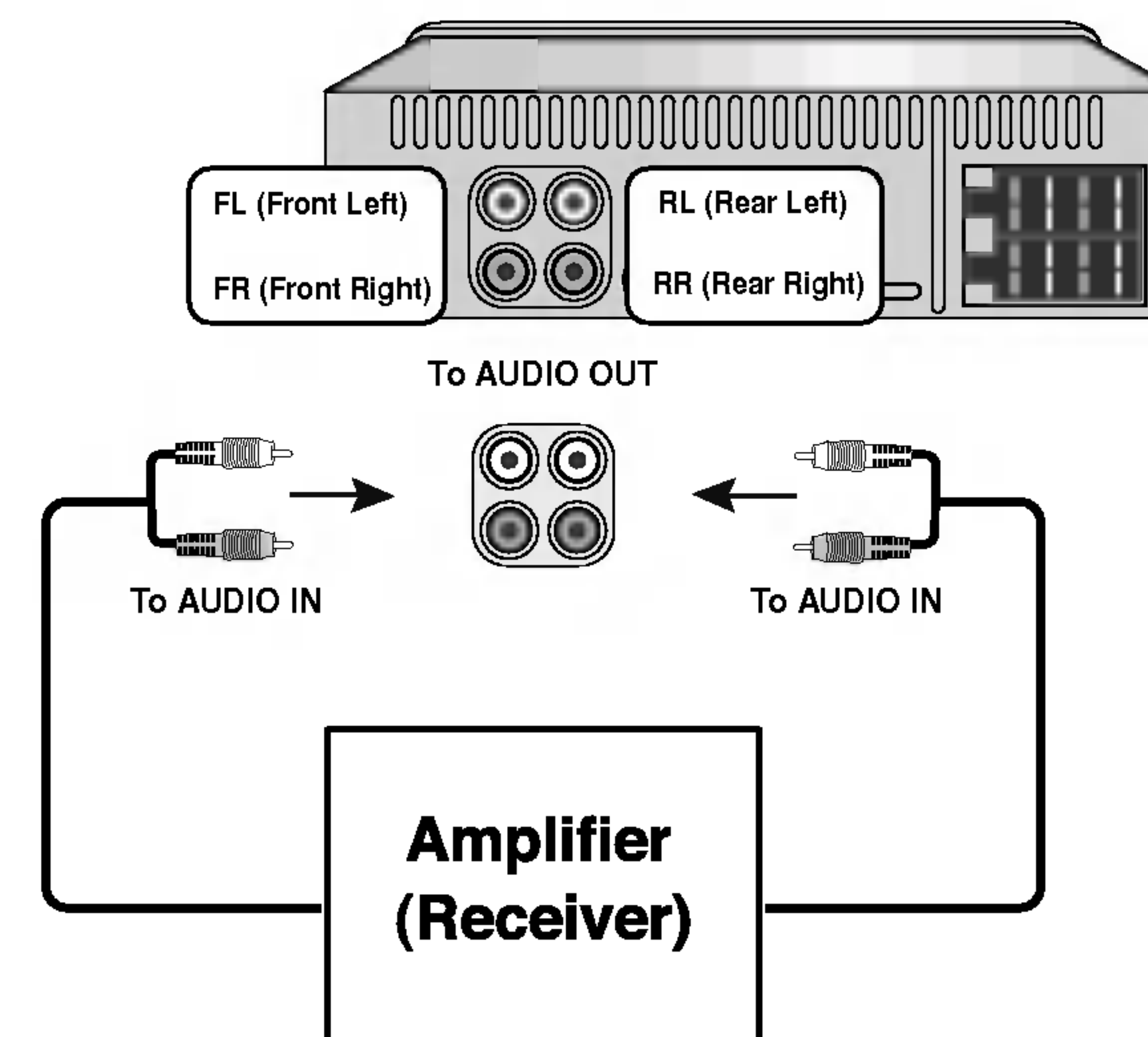

PREPARATION



## Basic Operation

### Turning the unit on

Press **PWR** or any other button on the front panel

### Turning the unit off

Press **PWR** on the front panel to turn the unit off.

### Selecting a source

You can select a source you want to listen to.

Press **FUNC** to select a source.

Press **FUNC** repeatedly to switch between the following sources:  
Tuner → CD → CD Changer (optional) → Tuner...

#### **NOTE**

- When you turn off, the unit is memorized automatically the current volume level before you turn off. Whenever you turn on the unit, it will operate at the memorized volume level.

### Adjusting the volume

Use **VOLUME** to adjust the sound level.

Press **VOLUME (VOL.+/-)** button on the front panel to increase or decrease the volume.

### Setting the clock

1. Press **DISP** and press **DISP** for more than 1 second.  
(Clock indicator will be displayed for 5 seconds. Adjust the clock within 5 seconds.)
2. Press **▶▶** on the front panel to adjust the hour.
3. Press **◀◀** on the front panel to adjust the minute.
4. Press **DISP**.

### Checking the clock

You can see the clock pressing **DISP**.



## Basic Operation

### SOUND Adjustment

#### Using the EQ (Equalizer)

The equalizer lets you adjust the equalization to match car interior acoustic characteristics as desired.

There are 3 stored equalizer curves which you can easily recall at any time.

Here is a list of the equalizer curves:

- EQ POP : Reproduces the acoustics of pop music.
- EQ CLASSIC : Reproduces the acoustics of orchestral music.
- EQ ROCK : Reproduces the acoustics of rock music.

1. Press **EQ/XDSS** on the front panel to select the equalizer.
2. Press **EQ/XDSS** repeatedly to select among the following equalizer.  
POP → CLASSIC → ROCK → FLAT (NO display) → POP....

#### MUTE

1. Press **MUTE** to cut the sound.
2. To cancel it press **MUTE** again.

#### SELECTION (SEL) Button

1. Press the **SELECTION (SEL.)** repeatedly to select the mode you want to adjust from volume, bass, treble, balance and fader. The mode indicator lights up in the following order.

→ VOL → BAS → TRB → BAL → FAD →

2. Press CONTROL UP (**VOL.+**) or DOWN (**VOL.-**) to adjust the sound quality.

	Turn right	Turn left
VOL	Increase the volume level.	Decrease the volume level.
BAS	Increase the bass level.	Decrease the bass level.
TRB	Increase the Treble level.	Decrease the Treble level.
BAL	Decrease the level of the left speaker(s).	Decrease the level of the right speaker(s).
FAD	Decrease the level of the front speaker(s).	Decrease the level of the rear speaker(s).

#### NOTE

The unit cannot adjust the bass and treble in the **EQ** on mode.

#### XDSS (Extreme Dynamic Sound System)

Press and hold **EQ/XDSS** button to reinforce treble, bass and surround effect.



## Radio Operation

### Listening the radio stations

1. Press **PWR** button to turn the unit on.
  - When you select a source the unit is turned on.
2. Press **FUNC** button to select the tuner.
3. Press **BAND** button to select a band.
  - Press **BAND** button until the desired band is displayed, FM1, FM2, FM3, MW(AM).
4. To perform seek tuning, press the SEEK(-/+) button with quick presses.
  - The tuner will scan the frequencies until a broadcast strong enough for good reception is found.
  - You can cancel seek tuning by pressing either the SEEK(-/+) button with quick presses.
5. To perform manual tuning, press the TUNE(-/+) button with quick presses.
  - The frequencies move up or down step by step.

#### **NOTE**

- When the selected frequency is being broadcast in stereo, “**ST**” indicator will light.

### Storing and recalling broadcast frequencies

You can easily store up to six broadcast frequencies for later recall with the touch of a button.

1. Select the desired frequency
2. Press one of the **preset station** buttons (1 - 6) for more than 1 seconds. The number of the pressed preset station button is displayed.
3. Repeat steps 1 and 2 to preset other stations.

#### **NOTES**

- As F1, F2, F3 have the same frequency range, up to 18 station can be preset for FM.
- When a station is preset on the preset station button on which another station of the same band has already been preset, the previously preset station is automatically erased.



### Auto Search Memory

This function lets you automatically store the six strongest broadcast frequencies.

1. Press **FUNC** button to select the tuner.
2. Press **AS/PS** button on the front panel for about 1 second.
  - The scanning starts from the currently displayed frequency to higher frequencies and stops when 6 stations have been preset or the receivable frequencies have been scanned once.

### **NOTES**

- The presetting is not performed if there is no station to be tuned in.
- When the automatic presetting is performed, the previous preset stations are automatically erased.
- To stop the automatic presetting, press **BAND** or **AS/PS** button.

### **To scan the preset stations**

Press **AS/PS** button on the front panel.  
To stop the scanning, press **AS/PS** button.

### **To tune in the preset stations**

Press **BAND** to select the desired band and press the desired number buttons (1-6).  
The number of the preset station button is displayed and the preset station is received.



## Operation with Audio CD, MP3 Disc and CD changer

### Playing an Audio CD and MP3 Disc

**CD MP3**

The unit can play MP3 formatted recordings on CD-ROM, CD-R or CD-RW discs.

Before playing MP3 recordings, read the notes on MP3 Recordings on page 20.

### Playing a CD changer (OPTIONAL) **CDC**

#### Playback Setup **CDC**

- Connect the CD Changer connector of this unit to connector of this CD Changer on page 12.
- Audio system: Turn on the audio system and select the input source connected to the unit.

1. Press **PWR** to turn the unit on.
2. Select the CD changer function pressing **FUNC** repeatedly.
3. Insert a disc you want to play into the magazine.  
Playback starts automatically.

#### Moving to another Disc **CDC**

Press **D(-/+)** briefly during playback to go to the next disc or step back to the previous disc.

#### Pause **CD MP3 CDC**

1. Press **PLAY/PAUSE (▶/II)** during playback.
2. To return to playback, press **PLAY/PAUSE (▶/II)** again.

#### Moving to another Track **CD MP3 CDC**

- Press the **⏮/⏭** briefly during playback to go to the next track or to return to the beginning of the current track.
- Press the **⏮** twice briefly to step back to the previous track.  
(If playing times is in less then 3 seconds and then this function is not operated.)

#### Search **CD CDC**

Press and hold the **⏮/⏭** during playback and then release at the point you want.





## Operation with Audio CD, MP3 Disc and CD changer



### Repeat

- a. Press **RPT** during playback. **CD MP3 CDC**  
The "RPT" appears in the display window.  
(It is played repeatedly the whole music within disc)
- b. Press and hold **RPT** during playback. **CDC**  
The "DRT" appears in the display window.  
(It is played repeatedly the whole music within disc of CD changer)
2. Press **RPT** again.  
The "RPT" disappears in the display window.  
(The repeat mode is cancelled.)

### Random

- a. Press **SHF** during playback. **CD MP3 CDC**  
The "SHF" appears in the display window.  
(It is played redomly the whole music within disc)
- b. Press and hold **SHF** during playback. **CDC**  
The "DSF" appears in the display window  
(It is played redomly the whole music within disc of CD changer)
2. Press **SHF** again.  
The "SHF" disappears in the display window.  
(The random playback is cancelled.)

### NOTE

- During random playback, if you press **⏮** button to don't go back to the previous track

### MP3 TRACK -10/+10 **CD CDC**

During playback, press the -10 (D-) button to go back to the previous 10th track, and press +10 (D+) button to go forward to the next 10th track.

### For your reference

#### • Auto Loading

When the disc is ejected by pressing **⏏** during playback, it will be loaded automatically after 10 seconds unless you pull out the disc from the unit.

### Intro scan

- a. Press **SCAN**. **CD MP3 CDC**  
The "SCAN" appears in the display window.  
(It is played first 10 seconds of the whole music within disc)
- b. Press and hold **SCAN**. **CDC**  
The "DSN" appears in the display window.  
(It is played first 10 seconds of the whole music within disc of CD changer)
2. Press **SCAN** again.  
The "SCAN" disappears in the display window.  
(The intro scan is cancelled.)

### ID 3 TAG **MP3**

When playing a disc containing information, you can see the information (ID3 TAG, Title, Artist and Album) in the display window. If there is no information, "No Title, No Artist and No Album" or "NO TEXT" will be shown in the display window.

Press twice the **DISP** button during MP3 file playback.



## Operation with Audio CD, MP3 Disc and CD changer

### Notes on MP3 Recordings

#### **About MP3**

- An MP3 file is audio data compressed by using the MPEG1 audio layer-3 file-coding scheme. We call files that have the “.mp3” file extension “MP3 files”.
- The unit can not read an MP3 file that has a file extension other than “.mp3”.

#### **MP3 Disc compatibility with this unit is limited as follows:**

1. Sampling Frequency / 8 - 48kHz (MP3)
2. Bit rate / within 8 - 320kbps (include VBR) (MP3)
3. CD-R/CD-RW physical format should be “ISO 9660”
4. If you record MP3 files using the software which cannot create a FILE SYSTEM, for example “Direct-CD” etc., it is impossible to playback MP3 files. We recommend that you use “Easy-CD Creator” which creates an ISO9660 file system.
5. A single session disc requires MP3 files in the first track. If there is no MP3 file in the 1st track, it cannot playback MP3 files. If you wish to playback MP3 files, format all the data in the disc or use a new one.
6. ID3 TAG: Title, Artist or Album names should have a maximum 30 letters or less.  
The file must incorporate “.mp3” extension e.g. “\*\*\*\*\*.MP3”.

This unit requires discs/recordings to meet certain technical standards in order to achieve optimal playback quality. There are many different types of recordable disc formats (including CD-R/CD-RW containing MP3 files). That require certain pre-existing conditions (see above) to insure compatible playback.

**Customers should also note that permission is required in order to download MP3 files and music from the Internet. Our company has no right to grant such permission. Permission should always be sought from the copyright owner.**



## Troubleshooting



### REFERENCE

Symptom	Cause	Correction
Power doesn't turn on. The unit doesn't operate.	<ul style="list-style-type: none"><li>• Leads and connector are incorrectly connected.</li><li>• The fuse is blown.</li><li>• Noise and other factors are causing the built-in microprocessor to operate incorrectly.</li></ul>	<ul style="list-style-type: none"><li>• Confirm once more that all connections are correct.</li><li>• Rectify the reason for the fuse blowing, then replace the fuse. Be very sure to install the correct fuse with the same rate.</li><li>• Turn the unit off and then on.</li></ul>
The unit does not operate correctly even when the appropriate remote control buttons are pressed.	<ul style="list-style-type: none"><li>• Battery power is low.</li><li>• Some operations are prohibited with certain discs.</li></ul>	<ul style="list-style-type: none"><li>• Load new battery.</li><li>• Check using another disc.</li></ul>
Playback is not possible.	<ul style="list-style-type: none"><li>• The disc is dirty.</li><li>• The loaded disc is a type this unit cannot play.</li></ul>	<ul style="list-style-type: none"><li>• Clean disc.</li><li>• Check what type the disc is.</li></ul>
No sound are heard. The volume level will not rise.	<ul style="list-style-type: none"><li>• Cables are not connected correctly.</li></ul>	<ul style="list-style-type: none"><li>• Connect the cables correctly.</li></ul>
There's no sound.	<ul style="list-style-type: none"><li>• The volume level is low.</li></ul>	<ul style="list-style-type: none"><li>• Adjust the volume.</li></ul>
There's audio skipping.	<ul style="list-style-type: none"><li>• This unit is not firmly secured.</li></ul>	<ul style="list-style-type: none"><li>• Secure this unit firmly.</li></ul>

# Specifications

## General

Output Power	.50W x 4CH(Max.)
Power Source	.DC 12V
Speaker impedance	.4 Ω
Ground System	.Negative type
Dimensions (W x H x D)	.182 x 51 x 173 mm (Without Front Panel)
Net Weight (approx.)	.1.8 kg

## FM tuner

Frequency Range	.87.5-107.9MHz or 87.5-108 MHz or 65-74 MHz, 87.5-108 MHz
S/N Ratio	.55 dB
Distortion	.1.0%
Usable sensitivity	.12 dBmv

## MW(AM) tuner

Frequency Range	.520-1720kHz or 522-1620 kHz
S/N Ratio	.45 dB
Distortion	.1.0%
Usable sensitivity	.32 dBmV

## CD

Frequency response	.40 - 20000 Hz
S/N Ratio	.70 dB
Distortion	.0.15%

- Design and specifications are subject to change without notice.