

ENGLISH



AV Multimedia System

OWNER'S MANUAL

MODEL : LAD-9600R

Please read this instruction booklet carefully and completely before connecting, operating or adjusting this product.



Safety note



CAUTION
RISK OF ELECTRIC SHOCK
DO NOT OPEN



CAUTION : TO REDUCE THE RISK OF ELECTRIC SHOCK DO NOT SPLIT COVER(OR BACK) NO USER SERVICEABLE PARTS INSIDE. REFER SERVICING TO QUALIFIED SERVICE PERSONNEL.



The lightning flash with the arrowhead symbol, within an equilateral triangle is intended to alert the user about the presence of uninsulated dangerous voltage within the product's enclosure that may be of sufficient magnitude to constitute a risk of electric shock.



The exclamation point within an equilateral triangle is intended to alert the user to the presence of important operating and maintenance (servicing) instructions in the literature accompanying the appliance.



Always operate the vehicle in a safe manner. Do not become distracted by the vehicle while driving, and always be fully aware of all driving conditions. Do not change settings or any functions. Pull over in a safe and legal manner before attempting such operations.

To promote safety, certain functions are disabled unless the handbrake is on.



Do not use for many hours at extremely low or high temperature. (-10~60°C)



To reduce the risk of electric shock, do not remove the cover or back of this product. There are no user-serviceable parts inside. Refer servicing to qualified service personnel.



To reduce the risk of fire or electric shock, do not expose this product to dripping or splashing water, rain, or moisture.



The temperature of unit's outside can be extremely high, please use the unit after proper installation in your vehicle.



While driving, keep the sound volume at a proper level.



Do not drop it and avoid heavy impacts at anytime.

Safety note



The driver must not watch the monitor while driving. If the driver watches the monitor while driving, it may lead to carelessness and cause an accident.



This unit is for vehicles with a 12-volt battery and negative grounding. Before installing it in a recreational vehicle, lorry or bus, check the battery voltage. To avoid shorts in the electrical system, be sure to disconnect the  battery cable before beginning the installation.

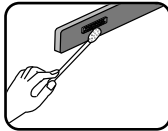

Periodically wipe the contacts on the back of the front panel with a cotton swab moistened with alcohol.

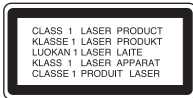

CAUTION : This product uses a Laser System.

To ensure proper use of this product, please read this owner's manual carefully and retain it for future reference. Should the unit require maintenance, contact an authorized service center.

Performing controls, adjustments, or carrying out procedures other than those specified herein may result in hazardous radiation exposure.

To prevent direct exposure to laser beam, do not try to open the enclosure. Visible laser radiation when open. **DO NOT STARE INTO BEAM.**

Disposal of your old appliance



1. When this crossed-out wheeled bin symbol is attached to a product, it means the product is covered by the European Directive 2002/96/EC.
2. All electrical and electronic products should be disposed of separately from the municipal waste stream via designated collection facilities appointed by the government or the local authorities.
3. The correct disposal of your old appliance will help prevent potential negative consequences for the environment and human health.
4. For more detailed information about disposal of your old appliance, please contact your city office, waste disposal service or the shop where you purchased the product.



This product is manufactured to comply with Directive 2005/83/EEC(ANNEX I , 3.2.9), 72/245/EEC, and 2006/95/EC.



Table of contents

Safety notes	2-3
Table of contents	4-6
Before operation	7-8
Basic operation	9-19
Front panel	9
Monitor	10
Accessories	10
Remote control	11
Install the battery of remote control	12
Using the remote control	12
Connecting the system	13-15
Detaching the control panel	16
Attaching the control panel	16
Installing the hide-away unit	16
Basic installation	17
Removing the existing receiver unit	17
ISO-DIN installation	17
Turning the unit on	18
Turning the unit off	18
Opening / Closing the LCD	18
Changing the monitor angle	18
Turning the LCD panel horizontally	18
Inserting a disc	18
Ejecting a disc	19
Adjusting the volume	19
Mute (To drop the volume in a moment)	19
Selecting a source	19
Selecting a EQ (Equalizer)	19
Dual mode operation	20
Using a monitor connected to REAR OUT	20
Selecting a source	20
Canceling the dual mode	20
About rear camera view	20
Setup operation	21-27
SETUP	21
SCREEN	21-22
SOUND	23-24
DVD	24-25
Defining the parental control	25
Changing the password	26
Changing the area code	26
RDS	27
SOURCE	27

Table of contents

Bluetooth operation 28-35

Using a Bluetooth wireless connection	.28
Starting Bluetooth on your phone	.28
Pairing your unit and Bluetooth phone	.28-30
Headset functionality	.30
SETUP	.31
CONNECT PHONE	.31
INFORMATION (CONNECT PHONE)	.31
BT Information (Bluetooth information)	.32
PHONE BOOK	.32-33
INFORMATION (PHONE BOOK)	.33
Making a call	.34
Making a call with speed dial numbers	.34
Answering calls	.35
Making a call from recent calls	.35
Selecting the output device for phone voice between car speaker and Bluetooth phone during a call	.35

Radio (RDS) operation 36-39

Listening to radio stations	.36
AS (Auto Scan)	.36
Storing and recalling stations	.36
RDS display options	.37
AF (Alternative frequency)	.37
TA (Traffic announcement identification)	.38
PTY (Program type recognition)	.38
REGION	.38
R-TEXT (Radio text recognition)	.39

CD/MP3/WMA operation 40-42

Playing an audio CD and MP3/WMA disc	.40
Skip to the next track/file	.40
Skip to the previous track/file	.40
Return to the beginning of the current track/file	.40
Search	.40
Skip to the previous folder/next folder	.40
Locating a folder/file using the list	.41
REPEAT	.41
SHUFFLE	.41
SCAN	.41
INFORMATION	.42



Table of contents

DVD/VCD operation	43-46
Playing a DVD/VCD disc	.43
If menu screen is displayed	.43
Play / Stop / Pause	.44
Skip to the next chapter/track	.44
Skip to the previous chapter/track	.44
Return to the beginning of the current chapter/track	.44
Search	.44
MENU/VCD MENU	.44
SEARCH	.45
AUDIO	.45
SUBTITLE	.45
ANGLE	.45
REPEAT	.46
Using ◊	.46
DivX Operation	47-49
Playing a Divx disc	.47
Play / Stop / Pause	.48
Skip to the next file	.48
Skip to the previous file	.48
Search	.48
Locating a folder/file using the list	.48
REPEAT	.49
AUDIO	.49
SUBTITLE	.49
Photo operation	50
Playing photo files	.50
Picture format	.50
USB operation	51
Playing a USB device	.51
Locating a folder/file using the list	.51
Troubleshooting	52
Country code list	53
Bluetooth phone compatibility list	54
Specifications	55
Support-Hotline	56

Before operation

A section whose title has one of the following symbols is applicable only to the disc represented by the symbol.

 DVD	 Video CDs
 Audio CDs	 MP3 files
 WMA files	 DivX files

About the Symbol Display

When you are watching a DVD and attempt to perform an operation, it may not be performed due to the programming on the disc. When this happens, the unit indicates the button  on the screen.

Types of Playable Discs

	DVD (12 cm disc)
	Video CD (VCD) (12 cm disc)
	Audio CD (12 cm disc)

In addition, this unit plays DVD±R, DVD±RW and CD-R or CD-RW containing audio titles, MP3 or WMA.

- Depending on the conditions of the recording equipment or the CD-R/RW (or DVD±R/±RW) disc itself, some CD-R/RW (or DVD±R/±RW) discs cannot be played on the unit.
- Do not attach any seal or label to either side (the labeled side or the recorded side) of a disc.
- Do not use irregularly shaped CDs (e.g., heart-shaped or octagonal). It may result in malfunction.

Notes on DVDs and Video CDs

Some playback operations of DVDs and Video CDs may be intentionally programmed by software manufacturers. This unit plays DVDs and Video CDs according to disc contents designed by the software manufacturer, therefore some playback features may not be available or other functions may be added.

Before operation



- A defective or soiled disc inserted into the unit can cause sound to drop during playback.
- Handle the disc by holding its inner and outer edges.
- Do not touch the surface of the unlabeled side of the disc.



- Do not stick paper or tape etc. on the surface.



- Do not expose the disc to direct sunlight or excessive heat.



- This unit cannot play 8cm disc (use 12cm disc only).

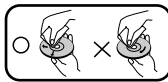

- Clean the disc before playback. Wipe the disc from the center outward with a cleaning cloth.
- Never use solvents such as benzine or alcohol to clean the disc.

Regional code



This unit is designed and manufactured for playback of region “2” encoded DVD software. This unit can only play DVD discs labeled “2” or “ALL”.

Notes on Regional Codes

- Most DVD discs have a globe with one or more numbers on it clearly visible on the cover. This number must match your Car DVD Receiver’s regional code or the disc cannot play.
- If you try to play a DVD with a different region code from your player, the message “Check regional code” appears on the screen.

Basic operation

Front panel

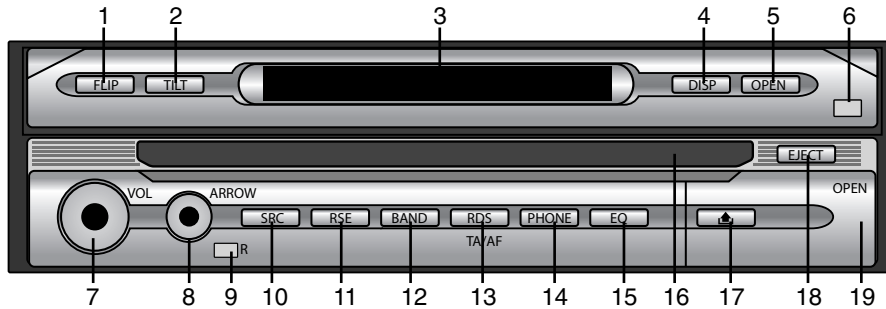

- 1. FLIP**
Turns the LCD panel horizontal temporarily when the LCD panel is upright.
- 2. TILT**
Adjusts the monitor angle.
- 3. DISPLAY WINDOW**
- 4. DISP**
Selects a different display.
- 5. OPEN/CLOSE**
Opens (or Closes) the monitor.
- 6. DIMMER SENSOR**
- 7. VOL. (Volume)**
 - Adjusts the volume.
 - Power off (Press for a long time)
 - Mute (Press for a short time)
- 8. ARROW ▲/▼/◀/▶ (up/down/left/right)**
 - Selects the folders (up/down)
 - Selects the menus (up/down/left/right)
 - Skip (left/right)
 - Search (left/right)
 - Selects a preset station (up/down)
 - Enter
- 9. REMOTE SENSOR**
- 10. SRC (Source)**
Changes the sources.
- 11. RSE (Rear service)**
Plays back two different sources as a main a source and a subsidiary source.
- 12. BAND**
Selects the band.
- 13. RDS**
 - Selects the TA on/off (Press for a short time)
 - Selects the AF on/off (Press for a long time)
- 14. PHONE**
Selects the phone.
- 15. EQ**
Selects various equalizer curves.
- 16. Disc slot**
- 17. 🏠**
Removes the control panel.
- 18. EJECT**
Ejects a disc from the unit,
- 19. 📀 USB port**
Pulls the cover on the front.



Basic operation

Monitor

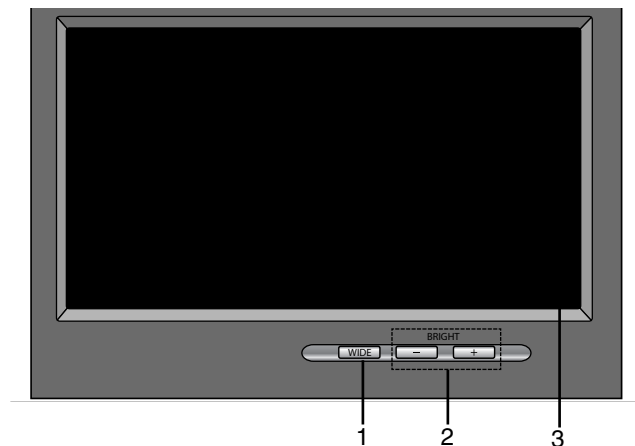

1. WIDE

Changes the screen mode.

DVD VCD DivX

2. BRIGHT -/+

Adjusts the monitor brightness

3. LCD

Accessories



Remote Control



Protective Case



Lever x2



Microphone



Main unit/Hide-away unit
Connecting Cable



Radio Antenna Extension Code



Battery



Power Cable (Main unit)



Power Cable (Hideaway unit)



Reverse Extension Code



Brackets x2 (Main unit)



Brackets x2 (Hideaway unit)



Round Head Screw x2
(Main unit)



Round Head Screw x4
(Hideaway unit)



Tapping Screw x4
(Hideaway unit)

Basic operation

Remote control

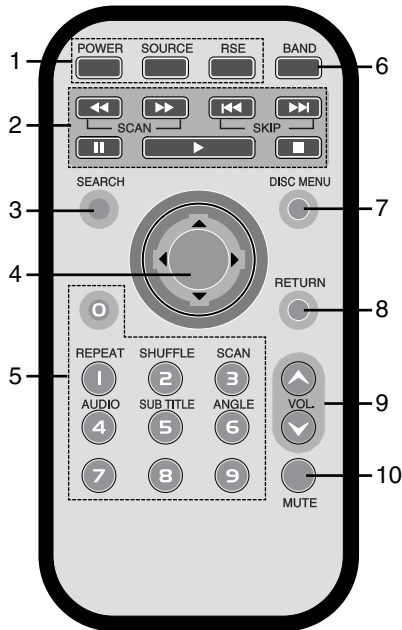

- 1. POWER**
Switches the unit ON/OFF.
SOURCE
Selects a source.
RSE (Rear service)
Plays two different sources as a main source and a secondary source.
- 2. SKIP I<<</>>>I**
 - Goes to the next (previous) chapter, track or file.
 - Returns to the beginning of the current chapter, track, or file.**SCAN <<</>>>**
Backward (Forward) search playback.
STOP ■ PLAY ► PAUSE ■■
- 3. SEARCH DVD**
Selects a chapter or title.
- 4. ARROW ▲/▼/◀/▶** (up/down/left/right)
 - Selects the folders (up/down)
 - Selects the menus (up/down/left/right)
 - Skip (left/right)
 - Search (left/right)
 - Selects a preset station (up/down)**ENTER**
Confirms menu selection.
- 5. 0-9 number buttons**
 - Selects numbered items in the menu.
 - Selects a stored radio station frequency (1-6).**REPEAT**
 - Repeats chapter, track, title or file.**SHUFFLE** CD MP3 WMA
 - Plays tracks or files in random order.**SCAN** CD
 - Plays the first 10 seconds of all track.**AUDIO**
 - Selects audio language.**SUBTITLE** DVD DIVX
 - Selects audio subtitle language.**ANGLE** DVD
 - Selects a DVD camera angle if available.
- 6. BAND**
Selects FM and MW(AM) bands.
- 7. DISC MENU**
Accesses the menu on a DVD disc.
- 8. RETURN**
Displays the disc menu with PBC.
- 9. VOLUME**
Adjusts the volume level.
- 10. MUTE**
Mutes the volume.



Basic operation

Install the battery of remote control

Pull the tray on the back of battery of remote control outward with a pencil or ball point pen and insert the battery with the plus (+) minus (-) poles pointing in the proper direction.

- 1 Remove the battery holder with a pencil or ball point pen.
- 2 Install the battery on the battery holder.
- 3 Install the battery holder back into its original position.

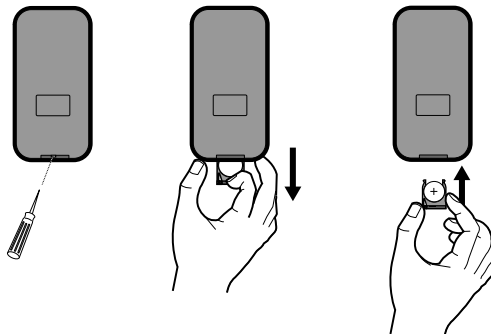

Using the remote control

Point the remote control in the direction of the front panel to operate.

Notes

- Use only one CR2025 (3V) lithium battery.
- Remove the battery if the remote control is not going to be used for a long period of time.
- Do not leave the product in a hot or humid place.
- Do not handle the battery with metallic tools.
- Do not store the battery with metallic materials.
- In the event of battery leakage, wipe the remote control completely clean and install a new battery.

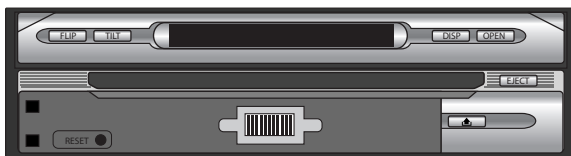

RESET

If the unit fails to operate properly, press the reset button using a ball point pen or a similar tool.

Basic operation

Connecting the system

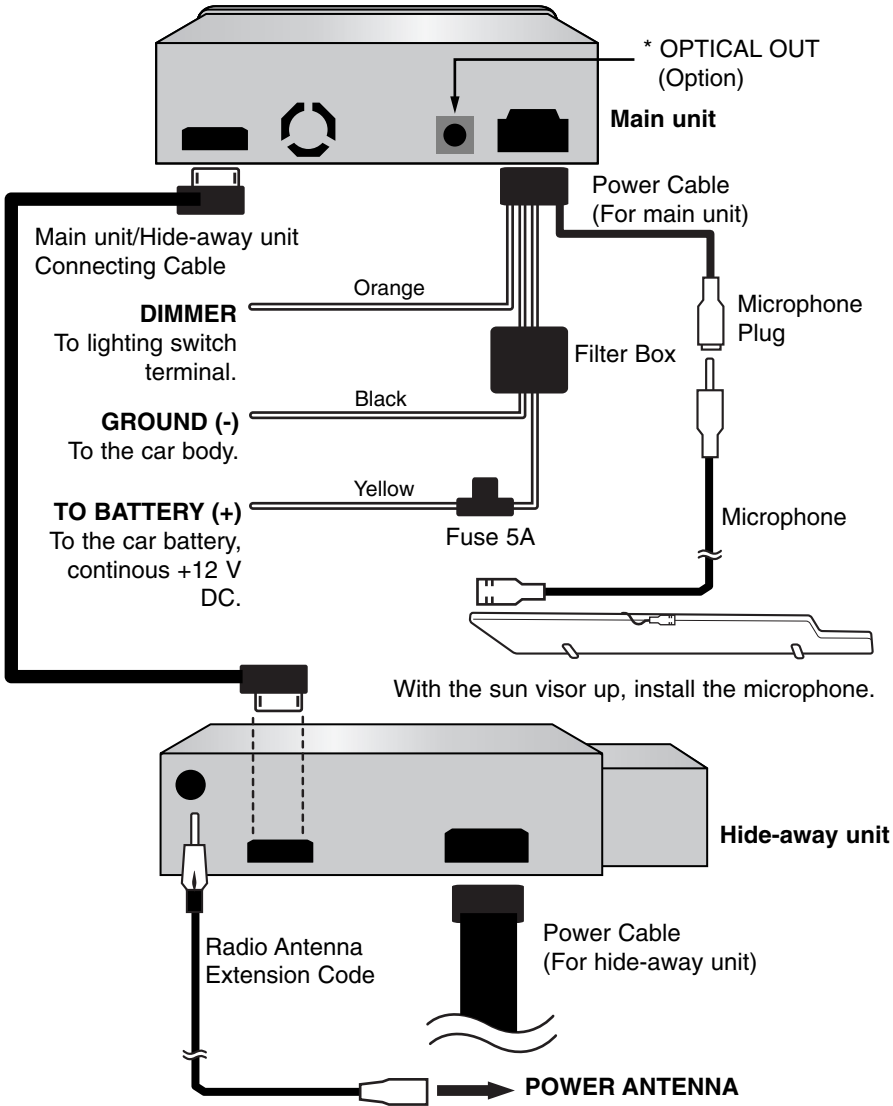

* Connecting to Optical equipment.
Connecting to an amplifier equipped with two channel digital stereo or to an Audio/Video receiver equipped with a multi-channel decoder.

Basic operation

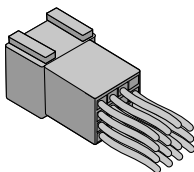
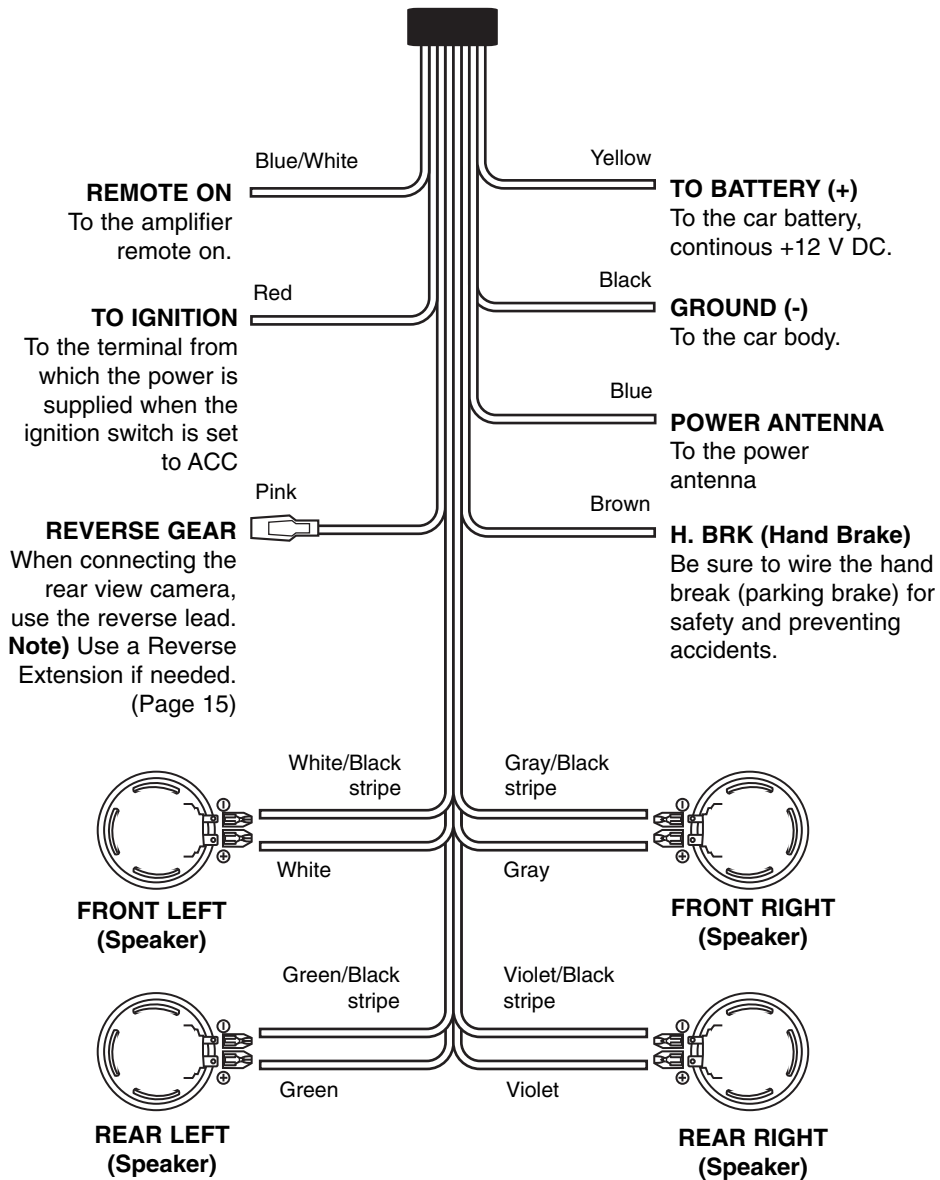

If your car has the ISO connector, connect by using the ISO connector plug that is in front of the Power cable.

Basic operation

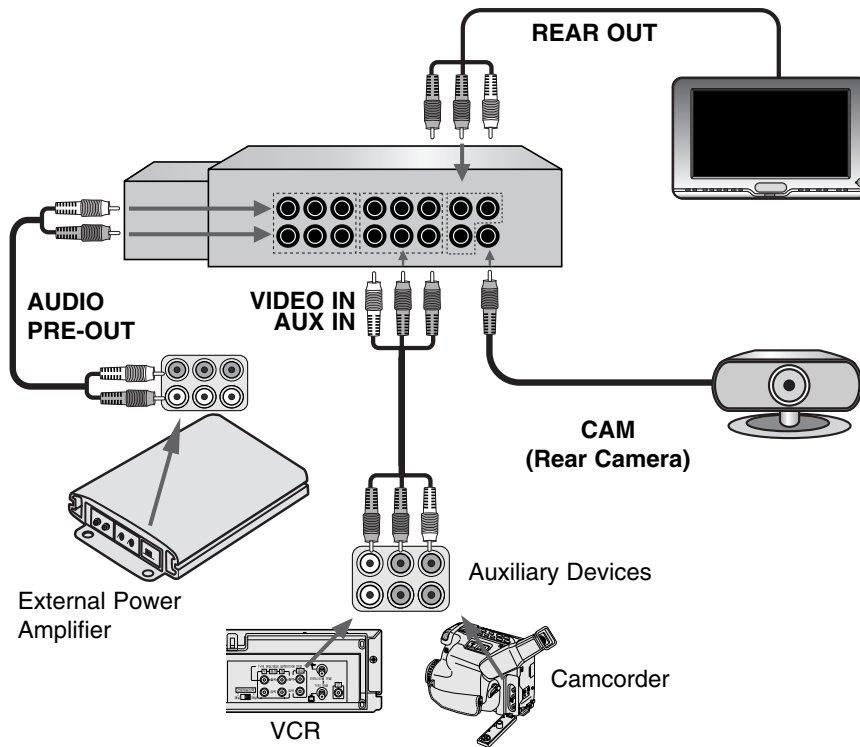

● Connecting the Reverse Gear

If using an optional rear view camera, the reverse lead must be connected.

1. Clamp the reversing lamp lead.
2. Clamp firmly with needle-nosed pliers.

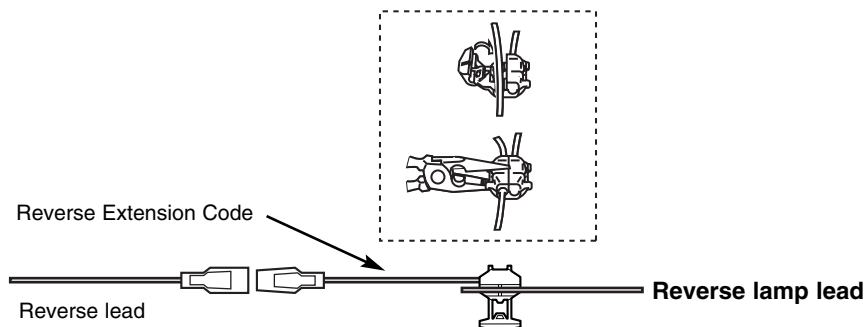

Basic operation

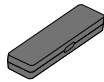
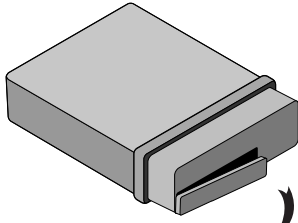
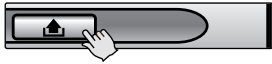

Protective Case

Detaching the control panel

You can detach the control panel when leaving the car. When detaching or attaching the control panel, be careful not to damage the connectors on the back of the control panel and on the panel holder.

1. Press the “” button to unlock the control panel.
2. Pull the control panel out of the unit.
3. Put the detached control panel into the provided case.

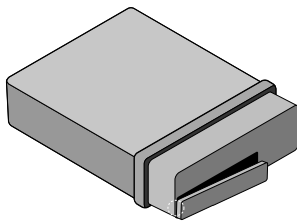

Attaching the control panel

1. Insert the left side of control panel into the groove on the panel holder.
2. Press the right side of control panel to fix it to the panel holder.

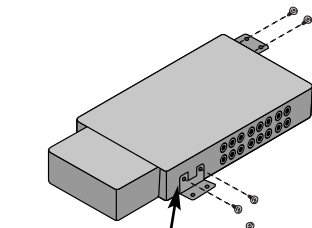

Round Head Screw

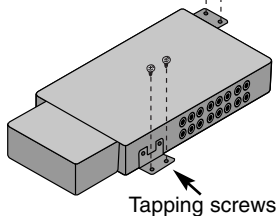

Tapping screws

Installing the hide-away unit (Under the front seat)

Be sure to use the tapping screws of appropriate length so that they will not damage any parts of the car.

Basic operation

Basic installation

Before installing, make sure that the ignition-switch is set to OFF and remove the terminal of the car battery to avoid short-circuiting.

1. Remove the existing receiver unit.
2. Make the necessary connections.
3. Install the installation sleeve.
4. Install the unit into the installation sleeve.

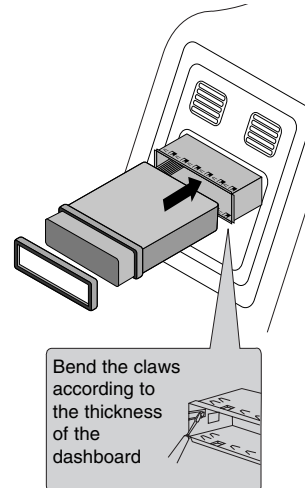

Removing the existing receiver unit.

If there is already an installation sleeve for the receiver unit in the dashboard, it must be removed.

1. Remove the rear support from the unit.
2. Remove the front panel and trim ring from the unit.
3. Insert the lever **A** into the hole on one side of the unit. Perform the same operation on the other side and pull the unit out from the mounting sleeve.

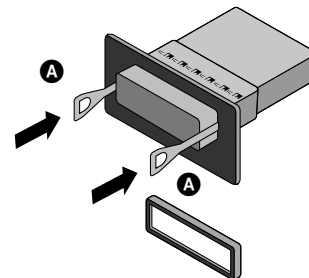

ISO-DIN Installation

1. Slide the unit into the ISO-DIN frame.
2. Install screws removed from the old unit.
3. Slide the unit and frame into the dash opening.
4. Install the dash panel or adapter plate.
5. Install the trim ring to the unit.

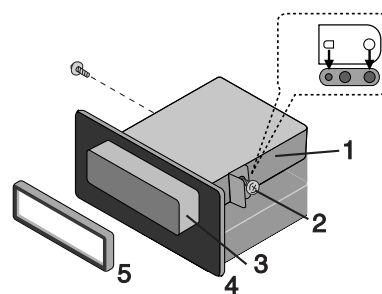

Basic operation

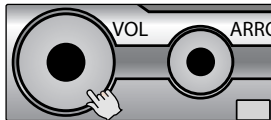

Turning the unit on

Press any buttons. (Except the DISP or EJECT)

Turning the unit off

Press and hold the "VOL" button.



Opening / Closing the LCD

Press the "OPEN(CLOSE)" button.
The LCD panel will be opened or closed.

Note

The LCD panel will be closed automatically with turning the power off.



Changing the monitor angle

Press the "TILT" button to adjust the LCD panel to an easily viewable angle.
Each time you press the button, the LCD panel changes its angle step by step.

Note

The adjusted LCD panel angle will be memorized and the monitor panel will automatically return to this angle next time the monitor panel is opened.



Turning the LCD panel horizontally

Press the "FLIP" button.
When the LCD panel is upright and hinders the operation of the air conditioner, the position of the panel can be turned horizontal in a moment.
To return to the original position, press the "FLIP" button again.

Note

The LCD panel returns to the original position automatically with beep sounds in 10 seconds after operation.

Inserting a disc

The disc is drawn in and playback starts automatically.

Basic operation

Ejecting a disc

Press the "EJECT" button.
The disc is ejected from the loading slot.

Note

If the ejected disc is not removed in approximately 10 seconds, the disc is automatically inserted again into the loading slot.



Adjusting the volume

Rotate the "VOL" knob to adjust the sound level.

Note

When you turn the unit off, the current volume level is automatically memorized. Whenever you turn the unit back on again, it will operate at the memorized volume level.

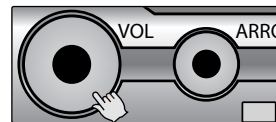

Mute (To drop the volume in a moment)

Press the "VOL" knob while listening to any source.
To resume the previous volume level, press any buttons.
(Except the TILT, FLIP, OPEN(CLOSE) or EJECT)

Selecting a source

Press the "SRC" button repeatedly to select a source.
The mode switches as follows.
FM → DISC → USB → VIDEO → AUX
You cannot select a source if it is not ready.



Selecting a EQ (Equalizer)

Press the "EQ" button repeatedly to select an equalizer.
The mode switches as follows.
FLAT → POP → CLASSIC → ROCK → JAZZ → VOCAL
→ SALSA → SAMBA → USER → WOW

- POP : Optimized for R&B, Soul and Country music.
- CLASSIC : Optimized for orchestral music.
- ROCK : Optimized for Hard Rock and Heavy Metal.
- JAZZ : Sweet sound with soft feeling.
- VOCAL : Powerful realism with strong sound quality.
- SALSA : Salsa music acoustics.
- SAMBA : Samba music acoustics.
- USER : Use the menu to set the sound level you want.
- WOW : Enjoy the SRS and TruBass simultaneously.

Notes

-  is a trademark of the SRS Labs, Inc.
- WOW technology is incorporated under license of the SRS Labs, Inc.

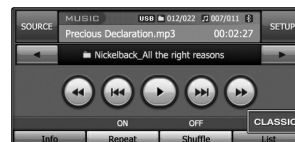

Dual mode operation

Using a monitor connected to REAR OUT

You can play back two different sources as a main source and a secondary source.

You can listen to the main source through the speakers and to the secondary source through the monitor connected to the REAR OUT jacks.



Selecting a source

Press the “RSE” button repeatedly to select a source. The mode switches as follows.

RSE DVD → RSE USB → RSE VIDEO → RSE AUX

- RSE DVD
You can select the built-in DVD drive.
- RSE USB
You can select the built-in USB.
- RSE VIDEO
You can select the component connected to the VIDEO IN jacks.
- RSE AUX
You can select the component connected to the AUX IN jacks.

Note

You cannot select a source if it is not ready.

Cancelling the dual mode

Press and hold the “RSE” button.

RSE OFF appears.

About rear camera view

With an optional rear view camera, you are able to back into a tight parking spot by keeping on eye on trailers.

Notes

- You can connect the video camera as a rear view camera to the REAR OUT CAM jack to guide you the car.
- When the vehicle’s gearstick is reverse(R), you can see what is behind the vehicle as connecting a rear view camera.

Setup operation

SETUP

You can customize the various options according to your particular needs.

Touch the "SETUP" button.

The setup screen appears on the screen.



SCREEN

● Language

You can set the display language.

Touch the language button you want.

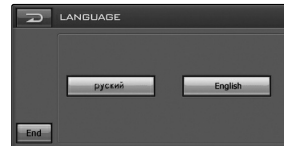
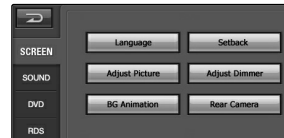

● Setback

You can move the LCD panel a little forward or backward.

- Yes : Activates the functions.
- No : Cancels the functions.

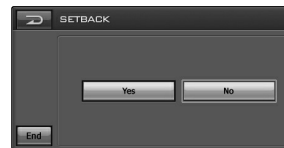

● Adjust Picture

Brightness

You can set the monitor brightness.

Touch the ◀ or ▶ buttons to adjust the settings.

Contrast

You can set the monitor contrast.

Touch the ◀ or ▶ buttons to adjust the settings.

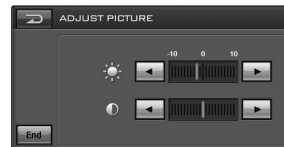

● Adjust Dimmer

Auto Dimmer control

The dimmer adjustments for daytime, evening, and nighttime ambient lights are stored separately.

The brightness of LCD screen adjusts automatically to the optimum level in accordance with the ambient light based on the set values.

- Yes : Activates the functions.
- No : Cancels the functions.



✎ Note

Touch the  button to exit the current screen to the previous screen

Setup operation



- **BG Animation**

You can select one of the 5 modes. It displays the change of sound output during playback. Touch the image button you want.



- **Rear Camera**

- On : The rear view through the rear view camera is automatically displayed on the monitor when the rear gear is applied.
- Off : Cancels the function.

Note

Touch the  button to exit the current screen to the previous screen.

Setup operation

SOUND

● Balance/Fader

1. Touch the “Left” or “Right” button.
Adjust the balance—speaker output balance between the left and right speakers.
2. Touch the “Front” or “Rear” button.
Adjust fader—speaker output balance between the front and rear speakers.

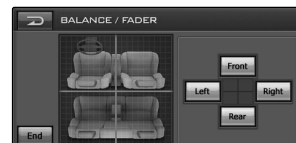

● Woofer

Output Level

Touch the ◀ or ▶ button to select the output level.

Cut-off Frequency

Frequencies 80/120/160 Hz are sent to the subwoofer. The cut-off frequency is chosen according to the Woofer setting so that you can enjoy low frequency effects purely from the subwoofer if it is connected.

Off : Cancels the function.



● SRS WOW

You can set the various 3D sound effects (1~10).

Touch the ◀ or ▶ buttons to adjust settings.

- SRS : Enjoy SRS and TruBass simultaneously.
- FOCUS : Improve the resolution sound.
- TruBass : Improve the bass sound to make it spectacular.



✎ Notes

- **SRS WOW** is a trademark of the SRS Labs, Inc.
- WOW technology is incorporated under license of the SRS Labs, Inc.

● User Equalizer

Adjusts the sound mode and store your own adjustments in memory.

Touch the ▲ or ▼ button to adjust the level of each frequency band.



● High Pass Filter

Outputs all frequencies higher than selected according to your preference.



Setup operation

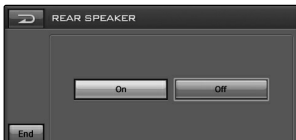

- **Rear Speaker**
On : Activates the rear speaker output.
Off : Cancels the function.



- **Beep**
Beep Pattern
 - Long Key : When you press the button for a long time, a beep sound occurs.
 - All : When any button is pressed, a beep sound occurs.**Beep Volume**
 Adjusts the Beep Volume. (High/Medium/Low)



DVD



- **DVD Language**
Audio Language
 If the disc contains multi-audio languages, you can change to a different audio language.

Subtitle Language

If the disc contains multi-subtitle languages, you can change to a different subtitle language.
 To erase the subtitle, select the "Off" button.

Menu Language

If the disc contains multi-menu languages, you can change to a different menu language.

Other

If the language you want is not listed in language menu list.
 Refer to the page 53 to find the language code.



- Confirm the entered code.
- Keypad button.
- Delete the previous character at the cursor position.
- Cancels the function.

Setup operation

● Aspect Ratio

Wide

Select when your screen's aspect ratio is fixed at 16:9 (Wide screen).

Letter Box

Select when your screen's aspect ratio is fixed at 4:3 (Conventional screen). While viewing a wide screen picture, the black bars appear on the top and the bottom of the screen.

Panscan

Select when your screen's aspect ratio is fixed at 4:3. While viewing a wide screen picture, the black bars do not appear. The left and right edges of the pictures will not be shown on the screen.



● Lock

You can secure the device against unauthorized use by assigning a password. In addition, you can specify a rating level with it. If you set a rating level that is lower than the one found on the inserted DVD, it can be played only after entering the password.

If you have already assigned a password, first enter the old password with the numeric buttons 0-9.



Defining the parental control

Select the desired age-appropriate button 1-8.

To erase the desired age-appropriate button, select the "Off" button.



✎ Notes

- Rating level means that some DVDs are equipped with a code that defines the age-appropriate release.
- If you have not yet assigned a password, the default password is 0000.
- If you forget your password.
Input the 6-digit number "210499" and the password is cleared. (First, after eject the disc, use the numeric button of the remote control on the DVD screen.)

Setup operation



Changing the password

1. Touch the “Password” button.
2. Enter the new password with the numeric buttons 0-9.
3. Confirm the new password with the numeric buttons 0-9.
4. Touch the “Enter” button to reset the password to the newly assigned one.



Changing the area code

1. Touch the ▲ or ▼ button to select the area code. Refer to the page 53 to find the area code.
2. Touch the “END” button to exit the setup menu.

Notes

- If you have not yet assigned a password, the default password is 0000.
- Do not forget your password. A new password cannot be set without your old password.



DivX Registration

We provide you with the DivX® VOD (Video On Demand) registration code that allows you to rent and purchase videos using the DivX® VOD service.

For more information, visit www.divx.com/vod.

Use the registration code to purchase or rent the videos from the DivX® VOD service at www.divx.com/vod.

Follow the instructions and download the video onto a disc for playback on this unit.

Setup operation

RDS

- **TA Mode**

- **TA Seek**

- When the newly tuned station does not receive TP information for 5 seconds, the receiver retunes to the next station which has the same TP information as well as the same PI as the last station.

- **TA Alarm**

- When a newly tuned station has no TP information for 5 seconds, a double beep sound is output.

- **PI Mode**

- **PI Mute**

- If the sound of a station with different PI is heard intermittently, the receiver mutes the sound right now.

- **PI Sound**

- If the sound of a station with different PI is heard intermittently, the receiver mutes the sound after 1 second.



SOURCE

You can select the source on the screen to make it operate according to your particular needs.

Touch the "SOURCE" button.

The source screen displays on the screen.

You cannot use a source if it is not ready.

- **FM/MW :** You can select the radio stations.
- **DVD / CD :** You can select the built-in DVD drive.
- **SETUP :** You can select the SETUP menu.
- **USB :** You can select the inserted USB.
- **VIDEO IN :** You can select the component connected to the VIDEO IN jacks.
- **AUX :** You can select the component connected to the AUX IN jacks.
- **SOURCE OFF :** You can see the current time. Press the "SRC" button in the front panel to return to the previous screen.



Bluetooth operation

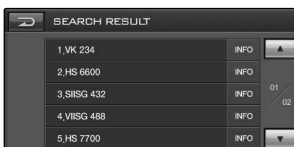

Using a Bluetooth wireless connection.

Your unit supports Bluetooth wireless connection. You can set up a wireless link with a Bluetooth phone.

Starting Bluetooth on your phone.

Your phone's Bluetooth feature may be set to off by default. To use your car Bluetooth feature, Bluetooth must be turned on in your phone. - Refer to the page 54 for details.

Notes

- Refer to your phone's user guide.
- Due to the variety of Bluetooth phones and their firmware version, this unit may respond differently when performing over Bluetooth.
- If a phone as described in this list meets requirements of Bluetooth Hand-free Profile 1.0 and Object Push Profile 1.1, it can operate. However, it is noted that this function can or can not be supported according to Bluetooth phone features.
- As difference in functional operation are mainly resulted from features of a hand-free phone, consult manufacturer of a phone if you have any question.

Pairing your unit and Bluetooth phone.

● Connection through the unit

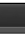
1. Press the PHONE button to select the phone. The "SETUP" screen displays on the screen.
2. Touch the  button. The "CONNECT PHONE" screen appears on the screen.
3. Touch the "Connect Phone" button. The "CONNECT PHONE" screen appears on the screen.
4. Touch the "Search" button. The "Searching" pop-up screen appears on the screen. It will take about 20 seconds to continue the process. To cancel, touch the "CANCEL" button.
5. Select a Bluetooth phone you desire from the "SEARCH RESULT".

Notes



- During the settings for Bluetooth phone, make sure to select "visible to all devices" from Visibility. Otherwise, it cannot search Bluetooth phones.
- The successfully connected bluetooth phone will be registered in the "CONNECT PHONE" screen. Once registered, the phone can be connected without searching.

Bluetooth operation

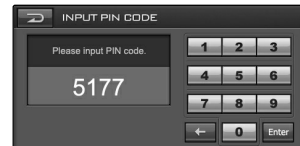
6. In an initial connection, the user will see the "INPUT PIN CODE" screen as shown in the figure. (PIN CODE :1234)
For successful connection, make sure to enter the same PIN code for Bluetooth phone and the unit.
7. Touch the 0~9 buttons, then confirm.
8. Touch the "Enter" button to complete the pairing .
9. If the connection is successful, the Bluetooth phone is registered. You can confirm it with the  checking mark in the "CONNECT PHONE" screen.



Notes

- When the connection is successful, the  icon will be displayed on the upper right side of the "PHONE" screen.
- The  icon is displayed with Headset connection. Refer to the "Headset functionality" for headset connections.

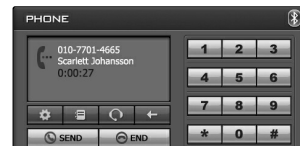

- The icon for hands-free connection.
- The icon for headset connection.

● Auto connection

1. Bluetooth phone with a previous record showing that it has successfully connected will automatically start the connection process when starting the car.
2. Auto connection functionality operates if there is a registered Bluetooth phone in the "CONNECT PHONE" screen and the "Auto Connection" is selected on the "INFORMATION" screen.
- Rerer to the page 31 for details.

Bluetooth operation



● Connection through a bluetooth phone

Turn on a Bluetooth phone.
Refer to your phone's user guide.

1. Press the PHONE button to select the phone.
2. Touch the button.
The "SETUP" screen appears on the screen.
3. Touch the "Connect Phone" button.
The "CONNECT PHONE" screen appears on the screen.
The Bluetooth phones can be found (searched) only on the "CONNECT PHONE" screen.
4. Perform "Searching a Bluetooth device" in the Bluetooth phone.
5. Initiate the pairing and connection process on the unit searched.
6. In an initial connection, the user will see the "INPUT PIN CODE" screen.

✦ Notes

- For successful connection, make sure to enter the same PIN code for Bluetooth phone and the unit.
- The same instructions as "connecting through the unit" apply correspondingly to the following.

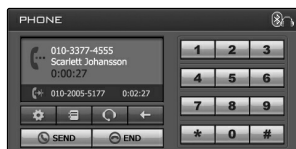

Headset functionality

The connection method is the same as "Hands-free connection", but the icon is displayed on the upper right side of the "PHONE" screen right after connected.

- It works in the same way as the wired headset for bluetooth phone. The headset functionality is for telephone conversation.

It is not for listening to music.

- Unlike the hands-free functionality, Headset connection will allow only two functions "answering calls" and "making a call from the latest call".

Also the caller's number is not displayed when answering calls.

✦ Notes

- If connecting through the unit, initiate the hands-free connection first. If your Bluetooth phone does not recognize the hands-free connection, then initiate the headset connection.
- If connecting through a Bluetooth phone, the hands-free connection or headset connection may not operate depending on the type of the phone.

Bluetooth operation

SETUP

- **Connect Phone**
You can check the connected Bluetooth phone.
- **BT Information. (Bluetooth Information)**
You can check the Bluetooth phone information.



CONNECT PHONE

- **Search**
You can search the connected Bluetooth phone.
- **Edit**
You can display the "INFORMATION" screen.
Pop-up screen appears on the screen. a pop-up screen containing three buttons such as Info., Delete, and Cancel. Press the Info. button among then, and you can enter into the "INFORMATION" screen.
- **Info. (Information)**
The "INFORMATION" screen appears on the screen.
- **Delete**
You can delete the selected list.
- **Cancel**
Cancels the functions.

INFORMATION (CONNECT PHONE)

- **Auto Connection**
Bluetooth phone can be automatically connected, if there is a registered Bluetooth phone in the "CONNECT PHONE" screen and the "Auto Connection" is selected on the "INFORMATION" screen.
- **Manual Connection**
Bluetooth phone can be manually connected, if there is a registered Bluetooth phone in the "CONNECT PHONE" screen and the "Manual Connection" is selected on the "INFORMATION" screen.
In these cases, try to connect from the registered list on the "CONNECT PHONE".

✦ Notes

- Touch the  button in the current screen to exit previous screen.
- A maximum of 6 Bluetooth phones can be registered at one time.
- Touch the  or  button to select the list you want to view.

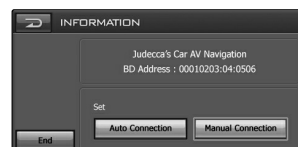

Bluetooth operation

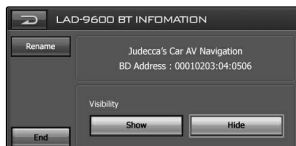

BT Informtion (Bluetooth Information)

You can check the Bluetooth phone information.

- **Rename**
Renames the Bluetooth phone name.
- **End**
Exits the current screen.
- **Show/Hide**
Selects whether bluetooth phones are able to search the unit or not.



- The entered name is displayed
- Keypad button
- Confirm the entered name
- Changes the language.
- Inserts a space at the cursor position
- Delete the previous character at the cursor position
- Erase all entered character

Note

Touch the  button in the current screen to return to previous screen.



PHONE BOOK

You can view all entry numbers according to Phone, Home, or Office.

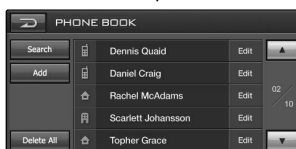

- **Search**
Enter a part of registration number or letter to search a contacts entry you want.
- Refer to the page 32 for details (BT Information).



- **Add**
You can copy the phone book entries that are supplied on the memory of the phone to the unit.

1. The "waiting..." screen displays on the screen.
2. When you choose "Telephone No. Item Transmission" in the bluetooth phone, you can search the unit.
(The bluetooth phone control method may differ according to the manufacturer. Refer to the Owner's manual.)
3. Press "Sending the phone number" in Bluetooth phone.
4. The telephone number is transmitted to the unit from the Bluetooth phone.

Bluetooth operation

- **Delete All**

You can delete all lists.

- **Edit**

You can display the "INFORMATION" screen.

Pop-up screen appears on the screen. a pop-up screen containing tree buttons such as Info., Delete, and Cancel. Press the Info. button among them, and you can enter into the "INFORMATION" screen.



Note

If the hands-free or headset connection has already been made, disconnect the corresponding connection to add a new contacts entry.

INFORMATION (PHONE BOOK)

You can view all entry numbers one person has.

If the entry has more than one phone number. you can set up one of them as a main number.

From this screen, you can make a call as displayed here.

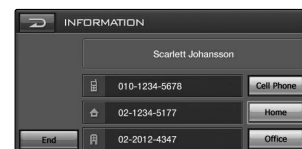

Note

The hands-free connection should be made before connecting to a phone.

Bluetooth operation



Making a call

There are various ways to make calls with this unit. To make a call by entering numbers on your number buttons.

1. Enter the phone number you want to call, by touching the numeric buttons.
2. Touch the "SEND" button to make a call with the entered phone number.
3. When you finished the call, touch the "END" button.

Notes

- Touch the "SEND" button for long to make a call from a latest call.
- The user's recent call history applies only to the hands-free connection. (Making a call from a recent call with the headset connection depends on the call history of the Bluetooth phone.)
- The headset connection allows only to make a call from a recent call.



Making a call with speed dial numbers

To make a call from a speed dial numbers, press "SEND" for long after pressing the speed dial number assigned to the Bluetooth phone, or press the last digit of the speed dial number for long.

- When making a call from the speed dial number 10, press 10 and press "SEND" button for long.
- When making a call from the speed dial number 10, press 1 and press 0 for long.

Note

Make sure that the speed dial the function in the Bluetooth phone is enabled before using.

Bluetooth operation

Answering calls

When you receive a call, your phone rings and display an incoming call message.

1. The “CALL FROM” screen appears on the screen.
2. Touch the “Accept” button to answer the call.
If you want to reject a call, touch the “Reject” button.

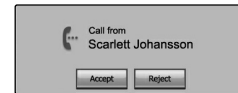

Notes

- If the Call-ID service is available, the caller's phone number is displayed.
- If the phone number is in the phone book, phone book entry's name is displayed.
- If the incoming call is from a number stored in your Contacts, the entry's name is displayed. The caller's phone number may also be displayed, if available.
- If “Rejecting” function is unusable, then the phone connected to the device does not support the rejecting calls function.



Making a call from recent calls

Your unit keeps a record of your recently received and dialed calls.

Touch and hold the “SEND” button.



Selecting the output device for phone voice between car speaker and Bluetooth phone during a call

When you turn the car speaker on, your unit displays the  button in the screen. The car speaker remains on until you press the  button.

Note

If you make a mistake while dialing, touch the  button to erase one digit at a time.

Radio (RDS) operation



Listening to the radio stations

1. Press the “SRC” button to select the radio.
2. Press the “BAND” repeatedly to select a band.
The mode switches as follows.
FM1 → FM2 → FM3 → AM (MW)
3. **Seek tuning :**
Touch the ◀◀ or ▶▶ buttons.
The tuner will scan the frequencies until a broadcast with strong enough signal is found.
Manual tuning :
Touch the ◀◀ or ▶▶ buttons repeatedly until a preset number you want is selected.



AS (Auto Scan)

This function lets you automatically store the 6 strongest broadcast frequencies.

1. Select the band (FM1, FM2, FM3, AM (MW)) which you want to store a station into.
2. Touch the “AS” button.
Local stations with the strongest signals are searched and stored automatically in the selected radio band.
3. To cancel, touch it again.

Storing and recalling stations.

You can easily store up to 6 preset stations for later recall at the touch of a button.

1. Select the band (FM1, FM2, FM3, AM (MW)) you want to store a station into.
2. Touch the ◀◀ or ▶▶ buttons to select the desired frequency.
3. Touch and hold one of the numeric buttons (1-6).
The preset station information will be displayed.
The selected preset station has been stored in memory.
4. Repeat the steps 2 and 3 to preset other stations.
Next time, if you touch the number button (1-6), the station is recalled from the memory.

✦ Notes

- As FM1, FM2, FM3 have the same frequency range, up to 18 stations can be preset for FM.
- When a new station is stored in the preset station button, the previously preset station is automatically erased.

Radio (RDS) operation

RDS display options

The RDS system is capable of transmitting a wide variety of information in addition to the initial call sign that appears when a station is first tuned. In normal RDS operation the display will indicate the station name, broadcast network or call letters.

- **AF** (Alternative Frequencies for the actual program)
- **TA** (Traffic Announcement Identification)
- **PTY** (Program type recognition)
- **RT** (Radio text recognition)
- **PS** (Program Service name)
- **PI** (Program Identification) : contains additional information for regional program operation
- **TP** (Traffic Program Identification)



AF (Alternative frequency)

When the reception quality drops, the tuner automatically changes to another station in the network, broadcasting a better reception quality, using the PI and AF codes.

This means : wherever you drive, you can continue to listen to the same program without interruptions.

1. Touch the "AF" button.
"On" appears on the screen.
2. To cancel, touch it again.

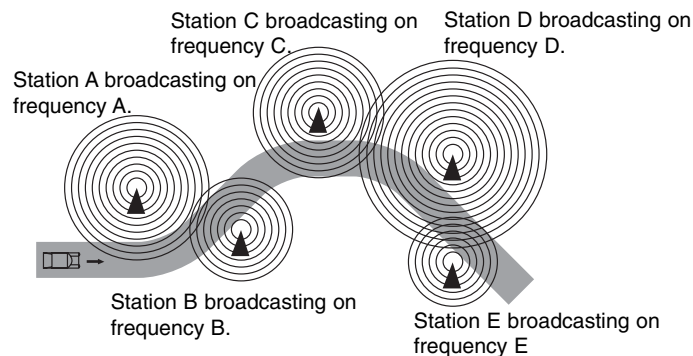

Radio (RDS) operation



TA (Traffic announcement identification)

This is an ON/OFF switching signal that indicates when a traffic announcement is on air.

1. Touch the "TA" button.
The "On" appears on the screen.
2. To cancel, touch it again.



PTY (Program type recognition)

You can select your favorite program type.

1. Touch the "PTY" button.
2. The PTY list is displayed in the screen.
3. Touch one of your favorite program types. (Music or Speech)
4. Touch one of your favorite PTY code name.
5. "PTY SEARCH" appears on the screen.
6. To cancel, touch the "Off" button.



REGION

1. Touch the "Region" button.
The "On" appears on the screen.
2. To cancel, touch it again.

ON : Network-Tracking is activated.

The unit switches to another station, within the same network, broadcasting the same program when the receiving signals from the current station become weak.

OFF : Network-Tracking is activated.

The unit switches to another station, within the same network when the receiving signals from the current station become weak. (This mode, the program may differ from the one currently received.)

Notes

- RDS is only available for FM reception.
- In some areas, the PTY search will not work correctly.
- Touch the  button in current screen to return to the previous screen.

Radio (RDS) operation

R-TEXT (Radio text recognition)

The information of radio station is displayed on the screen.

1. Touch the “R-Text” button.
Radio text appears on the screen.
2. To cancel, touch it again.



Note

Some RDS stations may not choose to include some of these additional features. If the data required for the selected mode is not being transmitted, the screen will show a “Radio Text Information” message.

CD/MP3/WMA operation



Playing an audio CD and MP3/WMA disc

The disc is drawn in and play starts automatically.

Notes

- The unit can play MP3/WMA file format recordings on CD-ROM, CD-R or CD-RW (DVD-ROM, DVD-R, DVD+R, DVD-RW, DVD+RW) discs.
- MP3/WMA Disc compatibility with this unit is limited as follows:
 1. Sampling Frequency / 16 - 48 kHz (MP3) 8 - 44.1 kHz (WMA)
 2. Bit rate / within 8 - 320 kbps (include VBR) (MP3) 5 - 160 kbps (WMA)
 3. CD-R/CD-RW physical format should be "ISO 9660"
 4. If you record MP3/WMA files using software which cannot create a FILE SYSTEM, for example "Direct-CD" etc., it will not be possible to playback MP3/WMA files.
We recommend that you use "Easy-CD Creator" which creates an ISO9660 file system.
Customers should also note that permission is required in order to download MP3/WMA files and music from the Internet. Our company has no right to grant such permission. Permission should always be sought from the copyright owner.

Skip to the next track/file

Touch briefly the ►►I button to select the next track.

Skip to the previous track/file

Touch briefly the I◄◄ button within 3 seconds of playing time.

Return to the beginning of the current track/file

Touch briefly the I◄◄ button after 4 seconds of playing time.

Search

Touch and hold the ◄◄ or ►► buttons during playback and then release at the point you want.

Skip to the previous folder/next folder

This functions only for **MP3** **WMA**.

Touch briefly the ◄ or ► buttons to select the previous folder/the next folder.

CD/MP3/WMA operation

Locating a folder/file using the list

You can display the folder list/track list before starting to play.

This is available only for **MP3** **WMA**.

1. Touch the “LIST” button during playback.
2. Touch the folder button you want.
3. Touch the file you want, and then file will be played.

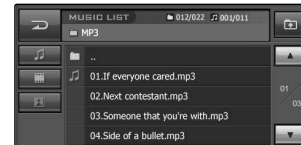

- Touch the button to select an upper folder.
- Touch the button in the current screen to return to the previous screen
- Touch the or buttons to select the list you want to view.
 : Previous/Next page of the list.
- If you want to classify by kind, press the , or button.

REPEAT

Touch the “Repeat” button during playback.

The item changes as follows.

Off → Track... **CD**

Off → One → Folder... **MP3** **WMA**

- Track : Plays repeatedly the current track.
- One : Plays repeatedly the current file.
- Folder : Plays repeatedly all tracks of the current folder.
- Off : Cancels repeat play.



SHUFFLE

Touch the “Shuffle” button during playback.

The item changes as follows.

Off → On... **CD**

Off → Folder... **MP3** **WMA**

- On : Plays all files randomly on the disc.
- Folder : Plays all files randomly on the current folder.
- Off : Cancels SHUFFLE play.

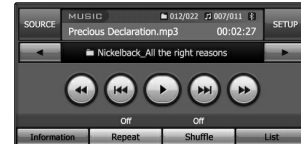

SCAN

Touch the “Scan” button during playback.

The item changes as follows.

Off → On... **CD**

- ON : Plays the first 10 seconds of all tracks on the disc.
- Off : Cancels scan play.

CD/MP3/WMA operation



INFORMATION

Touch the “Information” button during playback.

When playing a disc containing information, you can see the CD TEXT/ID3 TAG information.

In a CD TEXT, some information about the disc (disc title, performer and track title) is recorded.

In a ID3 TAG, some information about the file (album title, Performer name, song title, recording year, music genre and a brief comment)is recorded.

This unit can show ID3 TAG (artist name, title name, album name).

DVD/VCD operation

Playing a DVD/VCD disc

The disc is drawn in, and “Disc reading” appears on the display window, and playback starts automatically. If playback does not start, press the ► button.

✦ Notes

- It takes several seconds for the unit to detect a disc type.
- In some cases, the disc menu might appear instead.
- If “” appears on the screen, the disc cannot accept the operation you have tried.
- DVDs may have a region code.
Your unit will not play the disc that has a region code different from the one for your unit.
- When VCD with PBC is detected, the PBC indicator appears on the screen.

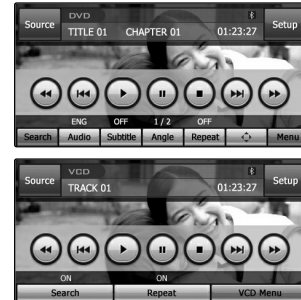







If menu screen is displayed

A menu screen may be displayed first after loading a DVD or Video 2.0 offering a menu.

This is available only for **DVD**.

1. Touch the ◀, ▶, ▲ or ▼ buttons to select the title/chapter you want to view.





-   : Move a cursor to up or down.
-   : Move a cursor to left or right.
-  : Move a menu bar to up or down.
-  : Enter a submenu.
-  : Cancels the functions.

2. Touch the “ENTER” button to start playback.



This is available only for **VCD**.

1. Touch the numeric 0~9 buttons, then confirm.

-  : Move a menu bar to up or down.
-  : Return to the previous screen.
-  : Cancels the functions.
-  : Enter a submenu.

2. Touch the “ENTER” button to start playback.



DVD/VCD operation

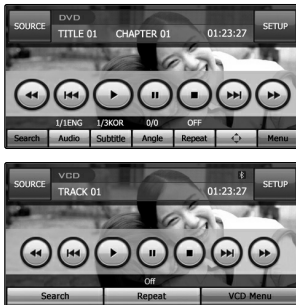

Play

Touch the ► button to start playback.

Stop

Touch the ■ button to stop.

Pause

1. Touch the || button during playback.
2. To return to playback, press the ► button.

Skip to the next chapter/track

Touch briefly the ►| button to select the next chapter/track.

Skip to the previous chapter/track

Touch briefly the |◀ button within 3 seconds of playing time.

Return to the beginning of the current chapter/track

Touch briefly the |◀ button after 4 seconds of playing time.

Search

Touch the ◀◀ or ▶▶ buttons repeatedly to select the required speed (X2, X4, X8, X16, X100).

✦ Notes

- With a VCD, the Search speed changes : (X2, X4, X8, X16)
- To return to the normal speed, press the ► button.

MENU **DVD** / VCD MENU **VCD**

The menu may contain camera angles, spoken language, subtitle options and chapters for the title.





1. Touch the screen during playback.
The setup screen displays on the screen.
2. Touch the “MENU (VCD MENU)” button.
3. Touch the ▲, ▼, ◀ or ▶ button to select a title you want.
4. Touch the “ENTER” button to start playback.
ENTER : Enter a submenu / Playback.



DVD/VCD operation

SEARCH

Use the numeric buttons to select the chapter or title you want to view.

1. Touch the screen during playback.
The setup screen displays on the screen.
2. Touch the "Search" button.
The number screen displays on the screen.
3. Touch the numeric 0~9 buttons, then confirm.
 -   : Move a cursor to a desired information point. (TITLE/CHAPTER/TIME)
 -  : Delete the inputted number(s).
 -  : Enter a submenu.
4. Touch the "ENTER" button.



AUDIO

This is available only for **DVD**.

Touch the "Audio" button during playback.

If the disc contains multi-audio languages, you can change to a different audio language during playback.

SUBTITLE

This is available only for **DVD**.

Touch the "Subtitle" button during playback.

If the disc contains multi-subtitle languages, you can change to a different subtitle language during playback.

ANGLE

This is available only for **DVD**.

Touch the "Angle" button during playback.

If the disc contains multi-angle views, you can change to a different camera angle during playback.

DVD/VCD operation

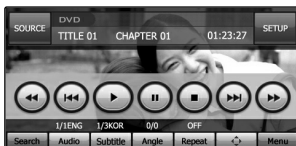

REPEAT

Touch the “REPEAT” button during playback.
The menu item changes as follows.

Off → Chapter → Title... **DVD**

Off → Track → All... **VCD**

- Chapter : Plays repeatedly the current chapter.
- Title : Plays repeatedly the current title.
- Track : Plays repeatedly the current track.
- All : Plays repeatedly all files on the current disc.
- Off : Cancels repeat play.

Note

If you change the source, turn the power off or eject the disc.
Next time you select the DVD/CD player as the source or turn the power on, disc play back starts from where playback stopped previously.

Using

This is available only for **DVD**.

You can use this function on the screen requiring menu selection while playing DVDs.

The menu screen appears on the screen.

Refer to the page 44 for details.

DivX operation

Playing a DivX disc

The disc is drawn in, and “Disc reading” appears on the display window, and playback starts automatically. If playback does not start, press the ► button.

Notes

DivX disc compatibility with this player is limited as follows:

- Available resolution size of the DivX file is under 720x576 (W x H) pixels.
- The file name of the DivX subtitle has a length of 40 characters.
- If there is impossible code to express in the DivX file, it may be displayed as “_” mark on the display.
- If the number of the screen frame is over 30 per 1 second, this unit may not operate normally.
- If the video and audio structure of recorded file is not interleaved, either video or audio is outputed.
- Playable DivX file : .avi, .mpg, .mpeg
- Playable Subtitle format
 - SubRip(*.srt/*.txt)
 - SAMI(*.smi)
 - SubStation Alpha(*.ssa/*.txt)
 - MicroDVD(*.sub/*.txt)
 - SubViewer 1.0(*.sub)
 - SubViewer 2.0(*.sub/*.txt)
 - TMPlayer(*.txt)
- Playable Codec format
“DIVX3.xx”, “DIVX4.xx”, “DIVX5.xx”, “XVID”, “MP43”, “3IVX”.
- Playable Audio format
“Dolby Digital”, “PCM”, “MP3”, “DTS”
 - Sampling frequency: within 8 - 48 kHz (MP3),
 - Bit rate: within 8 - 320kbps (MP3)



DivX operation



Play

Touch the ► button to start playback.

Stop

Touch the ■ button to stop.

Pause

1. Touch the || button during playback.
2. To return playback, press the ► button.

Skip to the next file

Touch briefly the ►►| button to select the next file.

Skip to the previous file

Touch briefly the |◀◀ button.

Search

Touch the ◀◀ or ►► buttons repeatedly to select the required speed (X2, X4, X8, X16).

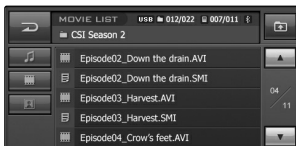

Locating a folder/file using the list

You can display the folder list/file list before starting playback.

1. Touch the "LIST" button during playback.
2. Touch the folder button you want.
3. Touch the file you want.

The file will be played.

- Touch the [Folder] button to select upper folder.
- Touch the [Back] button in the current screen to exit previous screen.
- Touch the [Up] or [Down] button to select the list you want to view.
[Left] [Right] : Move to the Previous/Next page of the list.
- When you want to classify the list by the kind of file (music file, movie file or photo file), press the desired file button among the [Music], [Movie] or [Photo] buttons.

DivX operation

REPEAT

Touch the “REPEAT” button during playback.
The item changes as follows.

Off → One → Folder → All..

- One : Plays repeatedly the current file.
- Folder : Plays repeatedly all files of the current folder.
- All : Plays repeatedly all files of the current disc.
- Off : Cancels repeat play.

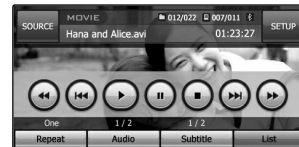

AUDIO

Touch the “Audio” button during playback.
If the disc contains multi-audio languages, you can change to a different audio language during playback.

SUBTITLE

Touch the “Subtitle” button during playback.
If the disc contains multi-subtitle languages, you can change to a different subtitle language during playback.

Photo operation



Playing photo files

The Photo viewer lets you view pictures from your device. This application recognizes JPG files.

The previous Image and next Image arrow keys let you display the previous or next image in the sequence of image files located in the selected folder.



The "Rotate" buttons let you move the image clockwise (or count clockwise). Each touch rotates the image 90 degrees.







The Slide Show button lets you view all JPG images in the current folder in Slide Show mode. Photo viewer shows all pictures in the full-screen mode automatically at a certain rate.

Picture format

The Load Failure warning message is displayed when the image file is too large. If the picture format is not supported and especially, the image file is not saved in JPG format, warning message is displayed.

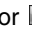
JPG : Image file size should use less than 2M pixels as 5120 x 3840 (Baseline) or 2048 x 1536 (Progressive).

- Touch the  button to select the upper folder.
- Touch the  button in the current screen to exit the previous screen
- Touch the  or  buttons to select the list you want to view.
  : Previous/Next page of the list.

USB operation

Playing a USB device

Plug the USB device, "USB detected" appears on the display window and playback starts automatically.

If playback does not start, press the ► button.

The way to use the files recorded in a USB memory device is the same as when using a DISC.

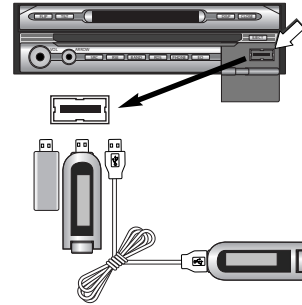









Locating a folder/file using the list

You can display the folder list/track list before starting to play.

1. Touch the "LIST" button during playback.
2. Touch the folder button you want.
3. Touch the file you want.

The file will be played.

- Touch the  button to select an upper folder.
- Touch the  button in the current screen to exit a previous screen.
- Touch the  or  buttons to select the list you want to view.
  : Move to the Previous/Next page of the list.
- When you want to classify the list by the kind of file (music file, movie file or photo file), press the desired file button among the ,  or  button.

Notes

- Don't remove a MP3 player or memory stick while playing via a USB device.
- Some memory sticks or devices may not be recognized depending on the type of memory.
- Card reader is not supported.
- The total number of files and folders on the memory should be less than 999.

Troubleshooting

Symptom	Cause	Correction
Power doesn't turn on. The unit doesn't operate.	<ul style="list-style-type: none"> Leads and connectors are not properly connected. The fuse is blown. Noise and other factors are causing the built-in microprocessor to operate incorrectly. 	<ul style="list-style-type: none"> Confirm once more that all connections are correct. Rectify the problem that caused the fuse to blow and then replace it. Be very sure to install the correct fuse with the same rate. Turn the unit off and then on.
Playback is not possible.	<ul style="list-style-type: none"> The disc is dirty. The loaded disc is of a type this unit cannot play. 	<ul style="list-style-type: none"> Clean disc. Check what type the disc.
No sound is heard. The volume level will not rise.	<ul style="list-style-type: none"> Cables are not connected correctly. 	<ul style="list-style-type: none"> Connect the cables correctly.
There's no sound.	<ul style="list-style-type: none"> The volume level is low. 	<ul style="list-style-type: none"> Adjust the volume.
There's audio skipping.	<ul style="list-style-type: none"> This unit is not firmly secured. 	<ul style="list-style-type: none"> Secure this unit firmly.
The unit does not operate correctly even when the appropriate remote control buttons are pressed.	<ul style="list-style-type: none"> Battery power is low. Some operations on certain discs are limited. 	<ul style="list-style-type: none"> Load new battery. Check using another disc.

Country code list

Language Codes

Use this list to input your desired language for the following initial settings:
Disc Audio, Disc Subtitle, Disc Menu.

Language	Code	Language	Code	Language	Code	Language	Code
Abkhazian	6566	Fiji	7074	Lingala	7678	Singhalese	8373
Afar	6565	Finnish	7073	Lithuanian	7684	Slovak	8375
Afrikaans	6570	French	7082	Macedonian	7775	Slovenian	8376
Albanian	8381	Frisian	7089	Malagasy	7771	Somali	8379
Ameharic	6577	Galician	7176	Malay	7783	Spanish	6983
Arabic	6582	Georgian	7565	Malayalam	7776	Sudanese	8385
Armenian	7289	German	6869	Maltese	7784	Swahili	8387
Assamese	6583	Greek	6976	Maori	7773	Swedish	8386
Aymara	6588	Greenlandic	7576	Marathi	7782	Tagalog	8476
Azerbaijani	6590	Guarani	7178	Moldavian	7779	Tajik	8471
Bashkir	6665	Gujarati	7185	Mongolian	7778	Tamil	8465
Basque	6985	Hausa	7265	Nauru	7865	Tatar	8484
Bengali; Bangla	6678	Hebrew	7387	Nepali	7869	Telugu	8469
Bhutani	6890	Hindi	7273	Norwegian	7879	Thai	8472
Bihari	6672	Hungarian	7285	Oriya	7982	Tibetan	6679
Breton	6682	Icelandic	7383	Panjabi	8065	Tigrinya	8473
Bulgarian	6671	Indonesian	7378	Pashto, Pushto	8083	Tonga	8479
Burmese	7789	Interlingua	7365	Persian	7065	Turkish	8482
Byelorussian	6669	Irish	7165	Polish	8076	Turkmen	8475
Cambodian	7577	Italian	7384	Portuguese	8084	Twi	8487
Catalan	6765	Japanese	7465	Quechua	8185	Ukrainian	8575
Chinese	9072	Javanese	7487	Rhaeto-Romance	8277	Urdu	8582
Corsican	6779	Kannada	7578	Rumanian	8279	Uzbek	8590
Croatian	7282	Kashmiri	7583	Russian	8285	Vietnamese	8673
Czech	6783	Kazakh	7575	Samoa	8377	Volapük	8679
Danish	6865	Kirghiz	7589	Sanskrit	8365	Welsh	6789
Dutch	7876	Korean	7579	Scots Gaelic	7168	Wolof	8779
English	6978	Kurdish	7585	Serbian	8382	Xhosa	8872
Esperanto	6979	Laotian	7679	Serbo-Croatian	8372	Yiddish	7473
Estonian	6984	Latin	7665	Shona	8378	Yoruba	8979
Faroese	7079	Latvian, Lettish	7686	Sindhi	8368	Zulu	9085

Area Codes

Choose an area code from this list.

Area	Code	Area	Code	Area	Code	Area	Code
Afghanistan	AF	Ethiopia	ET	Malaysia	MY	Saudi Arabia	SA
Argentina	AR	Fiji	FJ	Maldives	MV	Senegal	SN
Australia	AU	Finland	FI	Mexico	MX	Singapore	SG
Austria	AT	France	FR	Monaco	MC	Slovak Republic	SK
Belgium	BE	Germany	DE	Mongolia	MN	Slovenia	SI
Bhutan	BT	Great Britain	GB	Morocco	MA	South Africa	ZA
Bolivia	BO	Greece	GR	Nepal	NP	South Korea	KR
Brazil	BR	Greenland	GL	Netherlands	NL	Spain	ES
Cambodia	KH	Heard and McDonald Islands	HM	Netherlands Antilles	AN	Sri Lanka	LK
Canada	CA	Hong Kong	HK	New Zealand	NZ	Sweden	SE
Chile	CL	Hungary	HU	Nigeria	NG	Switzerland	CH
China	CN	India	IN	Norway	NO	Taiwan	TW
Colombia	CO	Indonesia	ID	Oman	OM	Thailand	TH
Congo	CG	Israel	IL	Pakistan	PK	Turkey	TR
Costa Rica	CR	Italy	IT	Panama	PA	Uganda	UG
Croatia	HR	Jamaica	JM	Paraguay	PY	Ukraine	UA
Czech Republic	CZ	Japan	JP	Philippines	PH	United States	US
Denmark	DK	Kenya	KE	Poland	PL	Uruguay	UY
Ecuador	EC	Kuwait	KW	Portugal	PT	Uzbekistan	UZ
Egypt	EG	Libya	LY	Romania	RO	Vietnam	VN
El Salvador	SV	Luxembourg	LU	Russian Federation	RU	Zimbabwe	ZW



Bluetooth phone compatibility list

- If even a phone as described in this list meets requirements of Bluetooth Hand-free Profile 1.0 and Object Push Profile 1.1, it can operate. However, it is noted that this function can or can not be supported according to bluetooth phone features.
- As difference in functional operation are mainly resulted from the features of a hand-free phone, consult manufacturer of the phone if you have any question.

Manufacturer	Model	Manufacturer	Model
Nokia	3230	Sony Ericsson	W810i
	6021		K700i
	6230		K750i
	6680		V800
	6630	Siemens	SL75
	8800	SP65	
	N70	LG	U8210
Samsung	SGH-Z500	U8290	
	SGH-E7700	M4410	
	SGH-D600	KU730	
	SPH-V6900	KG800	
Motorola	L6 (L7)	P7200	
	V3	S5200	
	E1		

Specifications

GENERAL

Output Power.....	50W x 4CH (Max.)
Power Source	DC 12V
Speaker impedance.....	4 Ω
Ground System	Negative
Dimensions (W x H x D).....	400 x 280 x 55 mm (Main unit)
Dimensions (W x H x D)	256.8 x 163.8 x 40 mm (Hideaway unit)
Net Weight.....	2.28 kg (Main unit)
Net Weight	1.12 kg (Hideaway unit)

DISPLAY

LCD	7 inch TFT LCD
Resolution	480 X 234
Back Light.....	CCFL type (L-type)

CD/DVD/VCD SELECTION

Frequency Response	20 Hz-20 kHz
S/N Ratio.....	95 dB
Distortion	0.1 %
Channel Separation (1kHz)	70 dB

RADIO SELECTION

FM

Frequency Range.....	87.5-107.9 or 87.5-108 MHz
S/N Ratio.....	55 dB
Distortion	1.0 %
Usable Sensitivity	12 dB μ V

AM (MW)

Frequency Range.....	520-1720 or 522-1620 kHz
S/N Ratio.....	45 dB
Distortion	1.0 %
Usable Sensitivity	32 dB μ V



Support-Hotline

- * You can download the Update Software from <http://www.lge.com/support/software.jsp> for free.
- * You can purchase the Upgrade Map from Authorized LG Service Centres. For more information, contact Call Centre or Website.

LG Subsidiary	Country	Service Number
LG Electronics ESPANA S.A.	SPAIN	902 500 234
LG Electronics U.K. Ltd	U.K. / IRELAND	0870 873 5454
LG Electronics France	FRANCE	0825-826-822 0825-825-592
LG Electronics Deutschland GmbH	GERMANY	01805 4737 84
LG Electronics Italia S.p.A	ITALY	39 199600099
LG Electronics Hellas S.A	GREECE	+30-210-4800-564/8 801 11 200 900
LG Electronics Benelux B.V	BELGIUM LUXEMBOURG Netherlands	070-233-557 32-70-233-557 0900-543-5454
LG ELECTRONICS MAGYAR KFT	HUNGARY Bulgaria	36-06-40-545454 +359-070-1-5454
LG Electronics Polska Sp. z.o.o	POLAND	801 54 54 54
LG Electronics Portugal, S,A	PORTUGAL	808-78-5454
LG Electronics Nordic AB	SWEDEN DENMARK FINLAND NORWAY	0771 41 4379 8088 5758 0800 116 587 800 18 740
Austria	AUSTRIA	420 810 555 810
RUMANIA	RUMANIA	40 31 228 3542
CZECH REPUBLIC	CZECH SLOVAKIA	420 810 555 810 421 850 111 154

- * For the latest Call Centre numbers, please visit Website (www.lge.com)



P/NO : MFL36334735