



**LG**

**LAC-UA370R, LAC-UA377R,  
LAC-UA375R, LAC-UA270R**

**ENGLISH**

## **CAR CD/MP3/WMA Receiver**

**Read the manual carefully before using the unit**

Internet address ; <http://ua.lge.com>  
Customer Information Center LG ;  
(380-44) 490-7777, 8-800-303-0000

**RUSSIAN**

## **Автомобильный CD/MP3/WMA-ресивер**

**Перед тем как использовать данное приспособление, внимательно прочитайте Руководство по эксплуатации**

Интернет адрес; <http://ua.lge.com>  
Информационная служба LG;  
(380-44) 490-7777, 8-800-303-0000

**Ukraine**

## **Автомобільний CD/MP3/WMA-ресівер**

**Перш ніж розпочати використання пристрою, будь-ласка, уважно прочитайте цю інструкцію.**

Интернет адреса: <http://ua.lge.com>  
Інформаційна служба LG: (380-44) 490-7777  
Безкоштовна інформаційна лінія: 8-800-303-0000



P/NO : MFL37340938

## Safety note



**CAUTION**  
RISK OF ELECTRIC SHOCK  
DO NOT OPEN



CAUTION : TO REDUCE THE RISK OF ELECTRIC SHOCK DO NOT SPLIT COVER(OR BACK) NO USER SERVICEABLE PARTS INSIDE. REFER SERVICING TO QUALIFIED SERVICE PERSONNEL.



The lightning flash with the arrowhead symbol, within an equilateral triangle is intended to alert the user about the presence of uninsulated dangerous voltage within the product's enclosure that may be of sufficient magnitude to constitute a risk of electric shock.



The exclamation point within an equilateral triangle is intended to alert the user to the presence of important operating and maintenance (servicing) instructions in the literature accompanying the appliance.



Always operate the vehicle in a safe manner. Do not become distracted by the vehicle while driving, and always be fully aware of all driving condition. Do not change settings, or any functions. Pull over in a safe and legal manner before attempting such operations.



Do not use for many hours at extremely low or high temperature. (-10~60°C)



To reduce the risk of electric shock, do not remove the cover or back of this product. There are no user-serviceable parts inside. Refer servicing to qualified service personnel.



To reduce the risk of fire or electric shock, do not expose this product to dripping or splashing water, rain, or moisture.



The temperature of unit's outside can be extremely high, please use the unit after proper installation in your vehicle.

**CAUTION** : This product uses a Laser System.

To ensure proper use of this product, please read this owner's manual carefully and retain it for future reference.

Should the unit require maintenance, contact an authorized service center.

Performing controls, adjustments, or carrying out procedures other than those specified herein may result in hazardous radiation exposure.

To prevent direct exposure to laser beam, do not try to open the enclosure. Visible laser radiation when open. DO NOT STARE INTO BEAM.

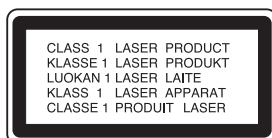



- A defective or soiled disc inserted into unit can cause sound to drop out during playback.
- Handle the disc by holding its inner and outer edges.
- Do not touch the surface of the unlabeled side of the disc.



Do not stick paper or tape etc. on the surface.



Do not expose the disc to direct sunlight or excessive heat.



This unit cannot play 8cm disc (use 12cm disc only).



- Clean the disc before playback. Wipe the disc from the center outward with a cleaning cloth.
- Never use solvents such as benzine or alcohol to clean the disc.

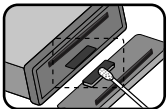

Periodically wipe the contacts on the back of the control panel with a cotton swab moistened with alcohol.

A section whose title has one of the following symbols is applicable only to the disc represented by the symbol.

**CD** Audio CDs   **MP3** MP3 files   **WMA** WMA files

**MP3/WMA Disc compatibility with this unit is limited as follows:**

1. Sampling Frequency / 8 - 48kHz (MP3) 22.05 - 48kHz (WMA)
2. Bit rate / within 8 - 320kbps (include VBR) (MP3) 32 - 320kbps (WMA)
3. CD-R/CD-RW file system should be "ISO 9660"
4. If you record MP3/WMA files using software which cannot create a FILE SYSTEM, for example "Direct-CD" etc., it will not be possible to playback MP3/WMA files. We recommend that you use "Easy-CD Creator" which creates an ISO9660 file system.

**Customers should also note that permission is required in order to download MP3/WMA files and music from the Internet.**

**Our company has no right to grant such permission.**

**Permission should always be sought from the copyright owner.**

**Disposal of your old appliance**



1. When this crossed-out wheeled bin symbol is attached to a product, it means the product is covered by the European Directive 2002/96/EC.
2. All electrical and electronic products should be disposed of separately from the municipal waste stream via designated collection facilities appointed by the government or the local authorities.
3. The correct disposal of your old appliance will help prevent potential negative consequences for the environment and human health.
4. For more detailed information about disposal of your old appliance, please contact your city office, waste disposal service or the shop where you purchased the product.



This product is manufactured to comply with Directive 2005/83/EEC(ANNEX I , 3.2.9), 72/245/EEC, and 2006/95/EC.

## Table of contents

Safety note . . . . .	2-3
Table of contents . . . . .	4
Before use . . . . .	4
Control panel . . . . .	5
Remote control (optional) . . . . .	5-6
Installation . . . . .	6
Connection diagram . . . . .	7-8
Basic operation . . . . .	9-11
Radio operation . . . . .	12
RDS operation . . . . .	13
CD/MP3/WMA operation . . . . .	14-15
Troubleshooting . . . . .	16
Specifications . . . . .	16

## Before use

### Detaching the control panel

The control panel of this unit can be detached to prevent theft.

- 1 Press the “▲” (RELEASE) to open the control panel.
- 2 Hold the right part of the control panel.
- 3 Pull out the control panel.
- 4 Place the control panel in the supplied protective case.

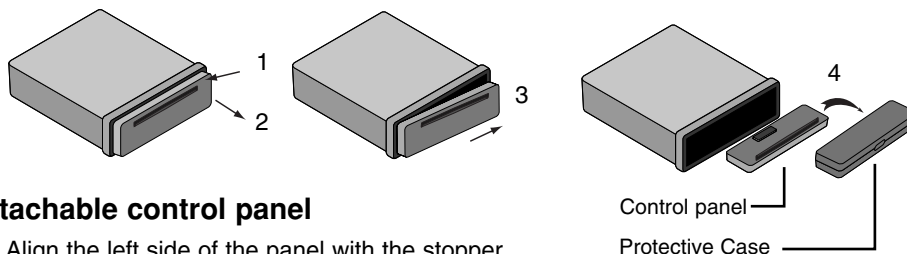

### Attachable control panel

- 1 Align the left side of the panel with the stopper.
- 2 Push the right side of panel into the unit until it clicks.

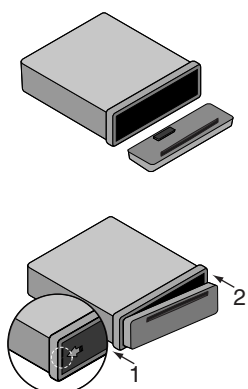

#### **Caution**

- The control buttons may not work properly if the control panel is not attached properly. If this occurs, gently press the display.
- Do not leave the control panel in any area exposed to high temperatures or direct sunlight.
- Do not drop the control panel or otherwise subject it to strong impact.
- Do not allow such volatile agents as benzene, thinner, or insecticides to come into contact with the surface of the control panel.

## Control panel

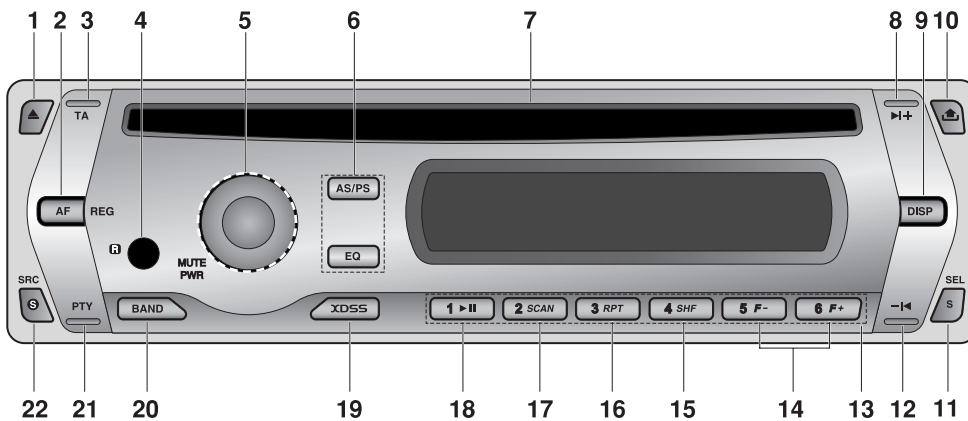

- |                                      |   |   |
|--------------------------------------|---|---|
| 1 EJECT ▲                            | 7 DISC SLOT                               | • Folder Up/Down [F+/F-]<br>MP3 WMA       |
| 2 Alternative frequency<br>[AF(REG)] | 8 • Skip / Search ► +                     | 15 Shuffle [SHF]                          |
| 3 Traffic Announcement [TA]          | • Seek/ Tune ► +                          | 16 Repeat [RPT]                           |
| 4 Remote Sensor - Optional           | 9 Display [DISP]                          | 17 Intro Scan [SCAN]                      |
| 5 • Volume                           | 10 Release ▲                              | 18 Play/Pause ►                           |
| • [MUTE]                             | 11 Select [SEL S]                         | 19 Extreme Dynamic Sound<br>System [XDSS] |
| • Power [PWR]                        | 12 • Skip / Search - ◀                    | 20 [BAND]                                 |
| 6 • Auto Store [AS]                  | • Seek/ Tune - ◀                          | 21 Programme Type [PTY]                   |
| • Preset Scan [PS]                   | 13 Preset Station [1-6]                   | 22 SOURCE [SRC S]                         |
| • Equalizer [EQ]                     | 14 • MP3 Track +10/-10<br>[F+/F-] MP3 WMA |   |

## Remote control (optional)

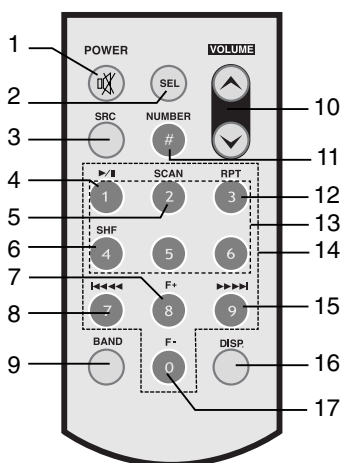

- |                              |                               |
|------------------------------|-------------------------------|
| 1 Power [POWER] / Mute ☒     | 9 [BAND]                      |
| 2 Select [SEL]               | 10 Volume Up ▲ / Down ▼       |
| 3 Source [SRC]               | 11 Number [#]                 |
| 4 Play / Pause ►             | 12 Repeat [RPT]               |
| 5 Intro Scan [SCAN]          | 13 Preset Station [1-6]       |
| 6 Shuffle [SHF]              | 14 Number [0-9]               |
| 7 • MP3 Track +10<br>MP3 WMA | 15 • CD Skip<br>/ Search ►►►► |
| • Folder Up [F+]<br>MP3 WMA  | • Seek / Tune ►►►►            |
| 8 • CD Skip<br>/ Search ◀◀◀◀ | 16 Display [DISP.]            |
| • Seek / Tune ◀◀◀◀           | 17 • MP3 Track -10<br>MP3 WMA |
|                              | • Folder Down [F-]<br>MP3 WMA |

## Battery Installation

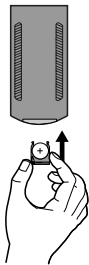
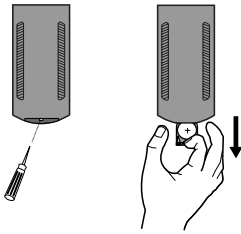

- 1 Pull out the battery holder with a sharp product like a ball point pen.
- 2 Put the battery with  $\oplus$  and  $\ominus$  correctly on the battery holder.
- 3 Push the battery holder back into its original position.

### Note

- Use only one CR2025 (3V) lithium battery.
- Remove the battery if the remote control is not used for a long period of time.
- Do not leave the product in a hot or humid place.
- Do not handle the battery with metallic tools.
- Do not store the battery with metallic materials.

## Installation

### Basic Installation

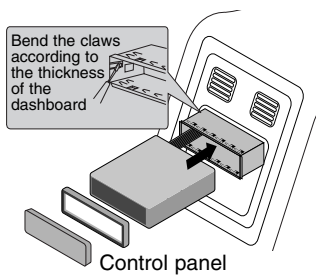

Before installing, make sure that the ignition-switch is set to OFF and remove the terminal of the car battery to avoid short-circuiting.

- 1 Remove the existing receiver unit.
- 2 Make the necessary connections.
- 3 Install the installation sleeve.
- 4 Install the unit into the installation sleeve.

### Removing the existing receiver unit

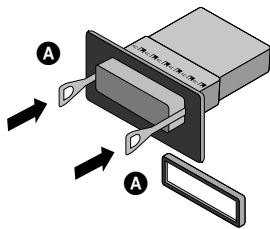

If there is already an installation sleeve for the receiver unit in the dashboard, it must be removed.

- 1 Remove the rear support from the unit.
- 2 Remove the control panel and trim ring from the unit.
- 3 Insert the lever **A** into the hole on one side of the unit. Perform the same operation on the other side and pull the unit out from the mounting sleeve.

### ISO-DIN Installation

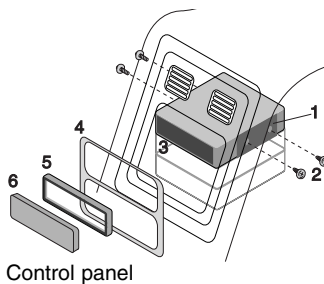

- 1 Slide the unit into the ISO-DIN frame.
- 2 Fit screws removed from the old unit.
- 3 Slide the unit and frame into the dash opening.
- 4 Install the dash panel or adapter plate.
- 5 Install the trim ring to the unit.
- 6 Install the control panel to the unit.

# Connection diagram

Before connecting, make sure that the ignition switch is set to OFF, and remove the battery ⊖ terminal to avoid short circuits.

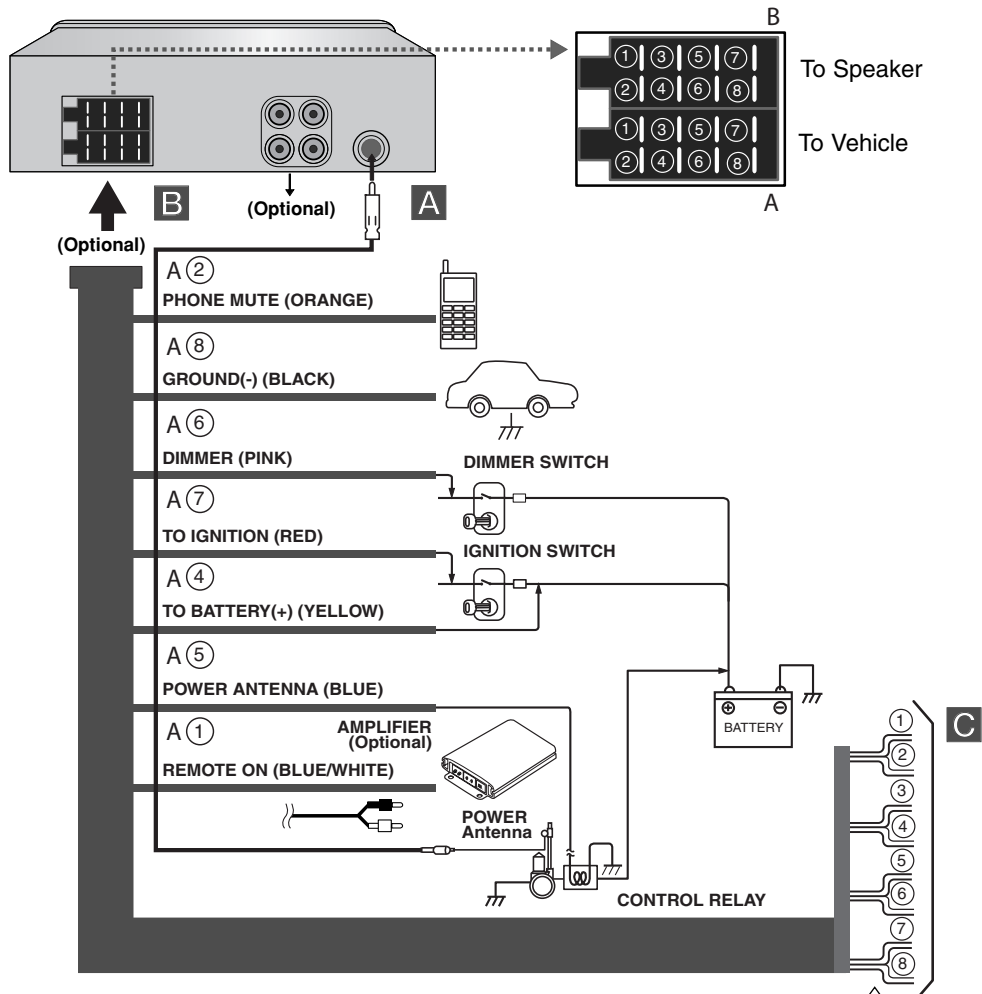

- B ①. Violet : Rear Right +
- B ②. Violet/ Black Stripe : Rear Right -
- B ③. Gray : Front Right +
- B ④. Gray / Black Stripe : Front Right -
- B ⑤. White : Front Left +
- B ⑥. White/Black Stripe : Front Left -
- B ⑦. Green : Rear Left +
- B ⑧. Green/ Black Stripe : Rear Left -

**A From antenna**

**B To the wiring of the vehicle colors of leads.**

- **BLACK:** This lead is for the ground connection.
- **ORANGE:** This lead is for the phone line connection.
- **PINK:** This lead is for the dimmer line connection.
- **RED:** This lead is for connection to the power supply terminal when the ignition switch is set to ACC.
- **YELLOW:** This lead is for connection to the battery (back-up) terminal from which power is always supplied.
- **BLUE:** This lead is for the power antenna connection.
- **BLUE/WHITE:** This lead is for the remote amplifier on connection.

**C Speaker Connections**

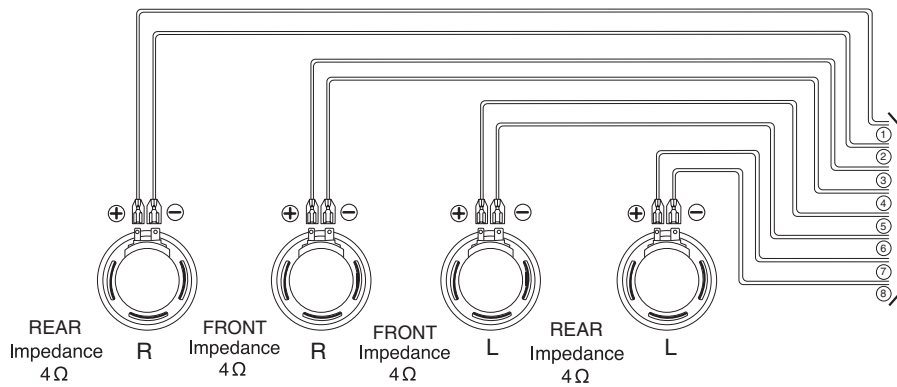

**Connecting to Auxiliary Equipment (Optional)**

Connect the **AUDIO OUTPUT** jack of this unit to the **AUDIO INPUT** jack of the Auxiliary Equipment.

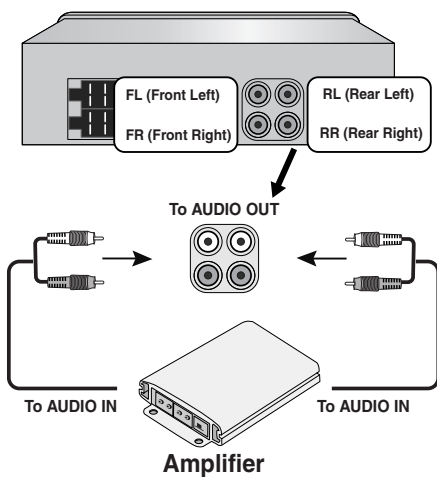



## Basic operation

### Turning the unit on

Press **MUTE/PWR** (**POWER**  on the remote control) or any other button.

#### **Note**

When you insert the CD in the CD slot, the unit turns on.

### Turning the unit off

Press and hold **MUTE/PWR** (**POWER**  on the remote control).

### Selecting a source



Press **SRC**  repeatedly to select a source.

The indicator lights up in the following order. TUNER → CD → TUNER...

#### **Note**

You cannot select a source if a CD is not inserted.

### Adjusting the volume

Rotate **MUTE/PWR** (Press **VOLUME**   on the remote control) to adjust the sound level.

#### **Note**

When you turn the unit off, the current volume level is automatically memorized. Whenever you turn the unit back on, it will operate at the memorized volume level.

### Mute

- 1 Press **MUTE/PWR** (**POWER**  on the remote control) to cut the sound.
- 2 To cancel it, press again.



### Checking the clock

You can see the clock pressing **DISP** (**DISP.** on the remote control).

#### **Note**

- If the unit is receiving RDS broadcasting with CT (Clock Time) information, the clock will be shown automatically in the display window .
- Unless, "NO CLOCK" appears in the display window.

### Changing the general settings

- 1 Press and hold **SEL [S]** (**SEL** on remote control) so that one of menu items appears.
- 2 Press **SEL [S]** (**SEL** on remote control) to scroll between menus.  
TA ALARM → PI SOUND → DEMO OFF → BEEP 2ND
- 3 Rotate **MUTE/PWR** clockwise or unclockwise to select one of the settings specified belows.  
(Press **VOLUME**   on the remote control.)
- 4 Press and hold **SEL [S]** (**SEL** on remote control) to finish the setting.

- **TA(Traffic Announcement) ALARM / SEEK**

- **TA ALARM :**

- When a newly tuned station has no TP information for 5 seconds, a double beep sound is output.

- **TA SEEK :**

- When the newly tuned station does not receive TP information for 5 seconds, the receiver retunes to the next station which has the same PI as the last station, but has the TP information.

- **PI (Programme Identification) SOUND / MUTE**

- **PI SOUND :**

- If the sound of a station with different PI is heard intermittently, the receiver mutes the sound after 1 second.

- **PI MUTE :**

- If the sound of a station with different PI is heard intermittently, the receiver mutes the sound right now.

- **DEMO ON / OFF**

- You can change the initial indication on the display to information name (function name, EQ name, etc...) while listen to a source.

- **DEMO ON**

- Displays information name while listen to source.

- **DEMO OFF**

- Cancels the function.

- **BEEP 2ND / ALL**

- Sets the beep sound every time a button is pressed.

- **BEEP 2ND**

- The beep is generated when a key is long pressed. (1 sec)

- **BEEP ALL**

- The beep is generated when any key is pressed.

## **RDS AF/REG FUNCTION**

To switch on or off the AF function (Network-Tracking), shortly press the **AF(REG)** button. To switch on or off the REG function (Regional Network Tracking), press the **AF(REG)** button longer than 2 seconds.

- **AF(Alternative frequency) ON / OFF**

- When the reception quality worsens, the tuner automatically changes to another station in the network, broadcasting a better reception quality, using the PI and AF codes.

- **AF ON** ("AF" appears on display window) :

- Wherever you drive, you can continue to listen to the same program without interruptions.

- **AF OFF** ("AF" disappears on display window):

- Only station name will be displayed. In case of poor reception no alternative station can be used.

- **REG (Region) ON / OFF**

- **REG ON :**

- The unit switches to another station, within the same network, broadcasting the same program when the receiving signals from the current station become weak.

- **REG OFF :**

- The unit switches to another station, within the same network when the receiving signals from the current station become weak. (This mode, the program may differ from the one currently received.)

## Using the EQ (Equalizer)

Press **EQ** repeatedly. The indicator lights up in the following order.

POP → CLASSIC → ROCK → JAZZ → VOCAL → SALSA → SAMBA → USER1  
→ USER2 → OFF

- POP : Optimized for R&B, Soul and Country music.
- CLASSIC : Optimized for orchestral music.
- ROCK : Optimized for Hard Rock and Heavy Metal music.
- JAZZ : Sweet sound with soft feeling.
- VOCAL : Powerful realism with strong sound quality.
- SALSA : Reproduces salsa music acoustics.
- SAMBA : Reproduces samba music acoustics.
- USER1 : Use the menu to set the sound level you want.
- USER2 : Use the menu to set the sound level you want.

You can adjust each sound level to your preference. Once you select a USER mode and then make an adjustment, it automatically stored for the currently selected USER mode.

## Adjusting the sound level

- 1 Press **SEL [S]** (**SEL** on the remote control) repeatedly to select the mode you want to adjust from volume, bass, middle, treble, balance and fader.  
The indicator lights up in the following order.  
VOL → BAS → MID → TRB → BAL → FAD
- 2 Rotate the **MUTE/PWR** (Press **VOLUME**  $\wedge$   $\vee$  on the remote control) to adjust the sound quality.

Indication	Turn right	Turn left
<b>VOL</b>	Increase the volume level.	Decrease the volume level.
<b>BAS</b>	Increase the bass level.	Decrease the bass level.
<b>MID</b>	Increase the middle level.	Decrease the middle level.
<b>TRB</b>	Increase the treble level.	Decrease the treble level.
<b>BAL</b>	Decrease the level of the left speaker(s).	Decrease the level of the right speaker(s).
<b>FAD</b>	Decrease the level of the front speaker(s).	Decrease the level of the rear speaker(s).

### **Note**









When EQ and XDSS+ is set to "Off", you can adjust the sound level (BAS, MID, TRB) settings.

## XDSS+ (Extreme Dynamic Sound System)

- 1 Press **XDSS**  
XDSS+ : Improves the treble, bass sound.
- 2 To cancel, press **XDSS** again.

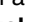
## Radio operation

### Listening to radio stations

- 1 Press **SRC**  to select the tuner.
- 2 Press the **BAND** repeatedly to select a band.  
The indicator lights up in the following order. FM1 → FM2 → FM3 → MW(AM)
- 3 **Auto Seek** : Press - /  + (   ) on the remote control).  
When a station is received, searching stops.  
**Manual Seek** : Press and hold - /  + (   ) on the remote control) until "MANUAL" appears, and then press it repeatedly.  
The frequencies move up or down step by step.

### Storing and recalling broadcast frequencies

You can easily store up to 6 broadcast frequencies for later recall at the touch of a button.

- 1 Press **BAND** to select desired band you want to store.
- 2 Select the desired frequency.
- 3 Press one of preset buttons 1-6 and hold until the beep sound.  
The number you have pressed will flash in the preset number indicator and then remain lit. The selected radio station frequency has been stored in memory.
- 4 Repeat steps 1-3 to preset other stations.  
The next time, you press the same preset button, the radio station frequency is recalled from the memory.

#### **Note**

- Up to 18 FM stations, 6 for each of three FM bands and 6 MW(AM) stations can be stored in the memory.
- When a station is stored on the preset numbers on which another station of the same band has already been preset, the previously preset station is automatically erased.

### Auto search memory

This function lets you automatically store the 6 strongest broadcast frequencies.

- 1 Press **AS/PS** until "A/S" appears.  
The six strongest broadcast frequencies will be stored under preset button 1-6 in the order of their signal strength.
- 2 To cancel, press **AS/PS**.

### To scan the preset stations

Press **AS/PS**. Each preset station appears. To cancel, press **AS/PS**.

### To tune in the preset stations

Press **BAND** to select the desired band and press the desired preset button 1-6 (preset button 1-6 on the remote control).  
The preset station of the preset button 1-6 is displayed and the preset station is received.

## RDS operation

### RDS Display options

In normal RDS operation the display will indicate the station name. Pressing **DISP** enables you to cycle through the various data types in the following sequence:

CT → FREQUENCY → PTY → RT → PS

- **CT** (Time controlled by the channel)
- **PTY** (Programme type recognition)
- **RT** (Radio text recognition)
- **PS** (Programme Service name)
- **PI** (Programme Identification)
- **AF** (Alternative Frequencies for the actual programme)
- **TP** (Traffic programme Identification)
- **TA** (Traffic Announcement Identification)

### PTY (Programme Type) function

To select a certain program type out of the reception band, following procedure can be operated.

- 1 Press **BAND** to select in FM mode.
- 2 After, pressing **PTY** button one by one activated as selecting each mode.  
music group → speech group → search off
- 3 Press one of the **PRESET (1-6)** button shortly. Each time this button is pressed, the display mode changes as follow.

No	Music group	No	Speech group
1.	Pop M, Rock M	1.	News, Affairs, Info
2.	Easy M, Light M.	2.	Sport, Educate, Drama
3.	Classics, Other M	3.	Culture, Science, Varied
4.	Jazz, Country	4.	Weather, Finance, Children
5.	Nation M, Oldies	5.	Social, Religion, Phone In
6.	Folk M	6.	Travel, Leisure, Document

### TA (Traffic Announcement) function

TA reception allows the unit to switch temporarily to a Traffic Announcement from the current source (another FM station, CD, or other connected components).

To switch the TA (Traffic Announcement) function on or off, press **TA**.

- **TA ON**  
Traffic programs and announcements can be automatically received using TP/TA features.
- **TA OFF**  
Traffic programs and announcements can not be received using TP/TA features.

## CD/MP3/WMA operation

### Playing an Audio CD and MP3/WMA Disc

The unit can play MP3/WMA formatted recordings on CD-ROM, CD-R or CD-RW discs. Before playing MP3/WMA recordings, read the notes on MP3/WMA Recordings on page 3. If you change the source, CD play also stops (without ejecting the CD). Next time you select "CD" as the source, CD play starts from where playback has been stopped previously.

- To directly play a file, press **NUMBER (#)** on remote control and then press the track number with **0-9** number.

### Pause

- 1 Press **▶/||** during playback.
- 2 To return to playback, press **▶/||** again.

### Skip to next track/file

Press briefly **▶| + (▶▶▶▶|** on the remote control) to select the next track or file.

### Skip to previous track/file

Press briefly **-◀ (|◀◀◀◀** on the remote control) within 3 seconds of playing time.

### Return to the beginning of the current track/file

Press briefly **-◀ (|◀◀◀◀** on the remote control) after 4 seconds of playing time.

### Search

Press and hold **-◀/▶| + (|◀◀◀◀/▶▶▶▶|** on remote control) for about 1 second during playback and then release at the point you want.

### Intro scan

The first 10 seconds of each tracks/files (**SCAN**) or each files in the current selected folder (**■ SCAN**) on the disc are played.

- 1 Press **SCAN**.
  - **■ SCAN** **MP3 WMA** (or **SCAN** **CD**) appears on the display window. Press and hold **SCAN** for about 2 seconds during playback.
  - **SCAN** appears on the display window. **MP3 WMA**
- 2 Press **SCAN** again.
  - **SCAN** or **■ SCAN** disappear from the display window and the intro scan is cancelled.

### Repeat

The current selected tracks/files (**1 RPT**) or folder (**■ RPT**) on the disc is played repeatedly.

- 1 Press **RPT** during playback.
  - **1 RPT** appears on the display window. **CD MP3 WMA**
- 2 Press and hold **RPT** for about 2 seconds during playback.
  - **■ RPT** appears on the display window. **MP3 WMA**
- 3 Press **RPT** again.
  - **1 RPT** or **■ RPT** disappear from the display window and the repeat mode is cancelled.

## Shuffle

All of the tracks/files (**SHF**) or the current selected folder (■ **SHF**) on the disc is played randomly.

- 1 Press **SHF** during playback.
  - ■ **SHF** (MP3 WMA) (or **SHF** (CD)) appears on the display window.  
Press and hold **SHF** for about 2 seconds during playback.
  - **SHF** appears on the display window. (MP3 WMA)
- 2 Press **SHF** again.
  - **SHF** or ■ **SHF** disappear from the display window and the random playback is cancelled.

### Note

During random playback, if you press - **⏮** (⏮ ⏮ on remote control), you won't go back to the previous track.

## CD TEXT / ID3 TAG

When playing a disc containing information, you can see the CD TEXT/ID3 TAG information. In CD TEXT, information about the disc (disc title, performer and track title) is recorded. In a ID3 TAG, information about the file (Album title/ Song title/ Performer name) is recorded. In a WMA Content, information about the file (Song title/ Performer name) is recorded. If there is no information, "NO TEXT" will be shown in the display window.

Press **DISP** (**DISP.** on the remote control) repeatedly during MP3/WMA/CD TEXT file playback.

## To go to a particular quickly (+10/-10 steps) (MP3 WMA)

(If there is no folder or one folder.)

Press **F+** to skip to the next 10 track, and press **F-** to skip to the previous 10 track.

## To skip to the next or previous folder (MP3 WMA)

(If there are more than two folders.)

Press **F+** to skip to the next folder, and press **F-** to skip to the previous folder.

### Note

Time display appearing on the display part when playing VBR file may vary and there may be some difference from actual time (both progress time and VBR are displayed at the same time when playing file).

## Troubleshooting

**Sy** : Symptom / **Ca** : Cause  
**Co** : Correction

### **Sy** Power doesn't turn on. / The unit doesn't operate.

**Ca** Leads and connectors are not properly connected.

**Co** Confirm once more that all connections are correct.

**Ca** The fuse is blown.

**Co** Rectify the problem that caused the fuse to blow, and then replace it. Be very sure to install the correct fuse with the same rate.

**Ca** Noise and other factors are causing the built-in microprocessor to operate incorrectly.

**Co** Turn the unit off and then on.

### **Sy** Playback is not possible.

**Ca** The disc is dirty.

**Co** Clean disc.

**Ca** The loaded disc is of a type this unit cannot play.

**Co** Check what type the disc.

### **Sy** No sound is heard. / The volume level will not rise.

**Ca** Cables are not connected correctly.

**Co** Connect the cables correctly.

### **Sy** There's no sound.

**Ca** The volume level is low.

**Co** Adjust the volume.

### **Sy** There's audio skipping.

**Ca** This unit is not firmly secured.

**Co** Secure this unit firmly.

### **Sy** The unit does not operate correctly even when the appropriate remote control buttons are pressed.

**Ca** Battery power is low.

**Co** Load new battery.

## Specifications

### GENERAL

Output Power . . . . . 50W x 4CH (Max.)

Power Source . . . . . DC 12V

Speaker impedance . . . . . 4Ω

Ground System . . . . . Negative

Dimensions (W x H x D) . . . . . 181.5 x 50 x 200 mm (Without Control Panel)

Net Weight . . . . . 1.5 kg

### CD SECTION

Frequency Response . . . . . 20 Hz-20 kHz

S/N Ratio . . . . . 80 dB

Distortion . . . . . 0.12%

Channel Separation (1kHz) . . . . . 55 dB

### RADIO SECTION

#### FM

Frequency Range . . . . . 87.5-107.9, 87.5-108, 65-74 or 87.5-108 MHz

S/N Ratio . . . . . 53 dB

Distortion . . . . . 0.7%

Usable Sensitivity . . . . . 12 dBμV

#### AM (MW)

Frequency Range . . . . . 520-1720 or 522-1620 kHz

S/N Ratio . . . . . 45 dB

Distortion . . . . . 1.0%

Usable Sensitivity . . . . . 28 dBμV

Designs and specifications are subject to change without notice.