

LAC2800.DCHLLLR_MFL41655329



MODEL : LAC2800

ENGLISH



Table of Contents

2	Table of Contents	9	Connecting an Auxiliary Equipment
3	Safety Note	10	Listening a CD
4	Front Panel		Pause or restart a CD
5	About Detachable Control Panel		Search for a section within a track / file
	Attaching the control panel		Skip to another track / file
	Detaching the control panel		Intro scan
6	Installation		Repeat
	Basic installation		Shuffle
	Removing the existing receiver unit		MP3/WMA TRACK -10 / +10
	ISO-DIN installation		MP3/WMA Folder UP/DOWN
7	Connection		See information about your music
8	Basic operation	11	Troubleshooting
	Mute	12	Specifications
	Changing the general settings		
	Using the EQ		
	Adjusting the sound level		
	XDSS+		
	Checking the clock		
	Setting the clock		
9	Listening to the radio		
	Auto search memory		
	Storing and recalling broadcast frequencies		
	To scan the preset stations		
	To tune in the preset stations		

Safety Note



CAUTION
RISK OF ELECTRIC SHOCK
DO NOT OPEN

CAUTION : TO REDUCE THE RISK OF ELECTRIC SHOCK DO NOT SPLIT COVER(OR BACK) NO USER SERVICEABLE PARTS INSIDE. REFER SERVICING TO QUALIFIED SERVICE PERSONNEL.



This lightning flash with arrowhead symbol within an equilateral triangle is intended to alert the user to the presence of uninsulated dangerous voltage within the product's enclosure that may be of sufficient magnitude to constitute a risk of electric shock to persons.



The exclamation point within an equilateral triangle is intended to alert the user to the presence of important operating and maintenance (servicing) instructions in the literature accompanying the product.



Always operate the vehicle in a safe manner. Do not become distracted by the vehicle while driving, and always be fully aware of all driving condition. Do not change settings, or any functions. Pull over in a safe and legal manner before attempting such operations.



Do not use for many hours at extremely low or high temperature. (-10~60°C)



To reduce the risk of electric shock, do not remove the cover or back of this product. There are no user-serviceable parts inside. Refer servicing to qualified service personnel.



To reduce the risk of fire or electric shock, do not expose this product to dripping or splashing water, rain, or moisture.



The temperature of unit's outside can be extremely high, please use the unit after proper installation in your vehicle.



This unit cannot play 8cm disc (use 12cm disc only).

CAUTION : This product uses a Laser System.

To ensure proper use of this product, please read this owner's manual carefully and retain it for future reference.

Should the unit require maintenance, contact an authorized service center.

Performing controls, adjustments, or carrying out procedures other than those specified herein may result in hazardous radiation exposure.

To prevent direct exposure to laser beam, do not try to open the enclosure. Visible laser radiation when open. DO NOT STARE INTO BEAM.

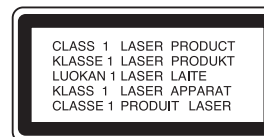

Caution

When being connected in a wrong way, the unit displays as follows.

- Antenna port short : **"ANTENNA ON PORT SHORT CIRCUIT CHECK"**

After connecting it again, restart the unit.

You have to set the disc format option to [Mastered] in order to make the discs compatible with the LG players when formatting rewritable discs. When setting the option to Live File System, you cannot use it on LG players. (Mastered/Live File System : Disc format system for Windows Vista)

Front Panel

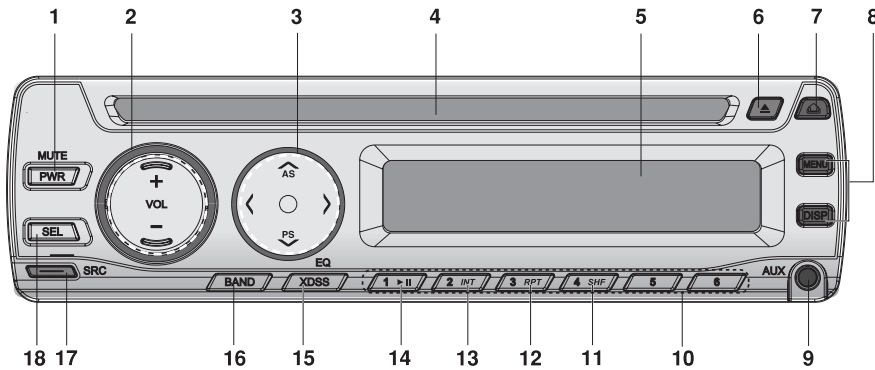

- | | |
|-----------------------------|---------------------------------------|
| 1 [PWR]/[MUTE] | 9 AUX In [AUX] |
| 2 Volume UP/DOWN [+/-] | 10 Preset Station [1-6] |
| 3 • Skip / Search </> | 11 Shuffle [SHF] |
| • Seek/ Tune </> | 12 Repeat [RPT] |
| • Auto Store [A/AS] | 13 Intro Scan [INT] |
| • Preset Scan [V/PS] | 14 Play/Pause ►/ |
| • MP3/WMA Track +10/-10 A/V | 15 • Equalizer [EQ] |
| • Folder Up/Down A/V | • Extreme Dynamic Sound System [XDSS] |
| 4 Disc slot | 16 [BAND] |
| 5 Display Window | 17 Source [SRC] |
| 6 Eject ▲ | 18 Select [SEL] |
| 7 Release 🏠 | |
| 8 • [MENU] | |
| • Display [DISP] | |

About Detachable Control Panel

Attaching the control panel

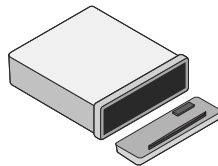

- 1 Align the left side of the panel with the stopper.
- 2 Push the right side of panel into the unit until it clicks.

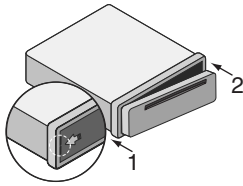

Caution

- The control buttons may not work properly if the control panel is not attached properly. If this occurs, gently press the display.
- Do not leave the control panel in any area exposed to high temperatures or direct sunlight.
- Do not drop the control panel or otherwise subject it to strong impact.
- Do not allow such volatile agents as benzine, thinner, or insecticides to come into contact with the surface of the control panel.

Detaching the control panel

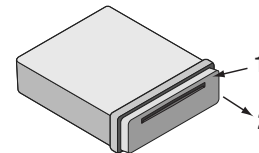

- 1 Press the “” (RELEASE) to open the control panel.
- 2 Hold the right part of the control panel.
- 3 Pull out the control panel.
- 4 Place the control panel in the supplied protective case.

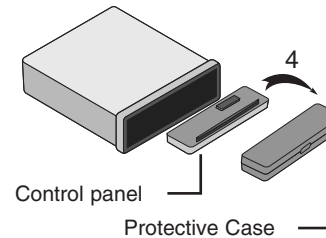
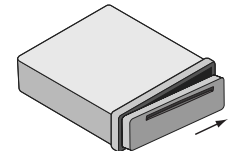

Note

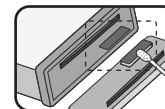

Periodically wipe the contacts on the back of the control panel with a cotton swab moistened with alcohol. For safety, turn off the ignition before cleaning, and remove the key from the ignition switch.

Installation

Basic Installation

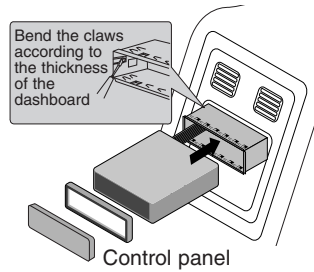

Before installing, make sure that the ignition-switch is set to OFF and remove the terminal of the car battery to avoid short-circuiting.

- 1 Remove the existing receiver unit.
- 2 Make the necessary connections.
- 3 Install the installation sleeve.
- 4 Install the unit into the installation sleeve.

ISO-DIN Installation

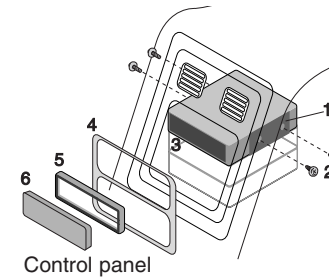

- 1 Slide the unit into the ISO-DIN frame.
- 2 Fit screws removed from the old unit.
- 3 Slide the unit and frame into the dash opening.
- 4 Install the dash panel or adapter plate.
- 5 Install the trim ring to the unit.
- 6 Install the control panel to the unit.

Removing the existing receiver unit

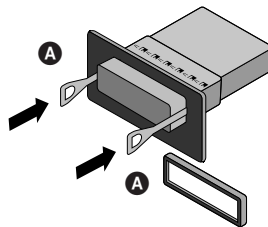

If there is already an installation sleeve for the receiver unit in the dashboard, it must be removed.

- 1 Remove the rear support from the unit.
- 2 Remove the control panel and trim ring from the unit.
- 3 Insert the lever **A** into the hole on one side of the unit.
Perform the same operation on the other side and pull the unit out from the mounting sleeve.

Connection

Before connecting, make sure that the ignition switch is set to OFF, and remove the battery ⊖ terminal to avoid short circuits.

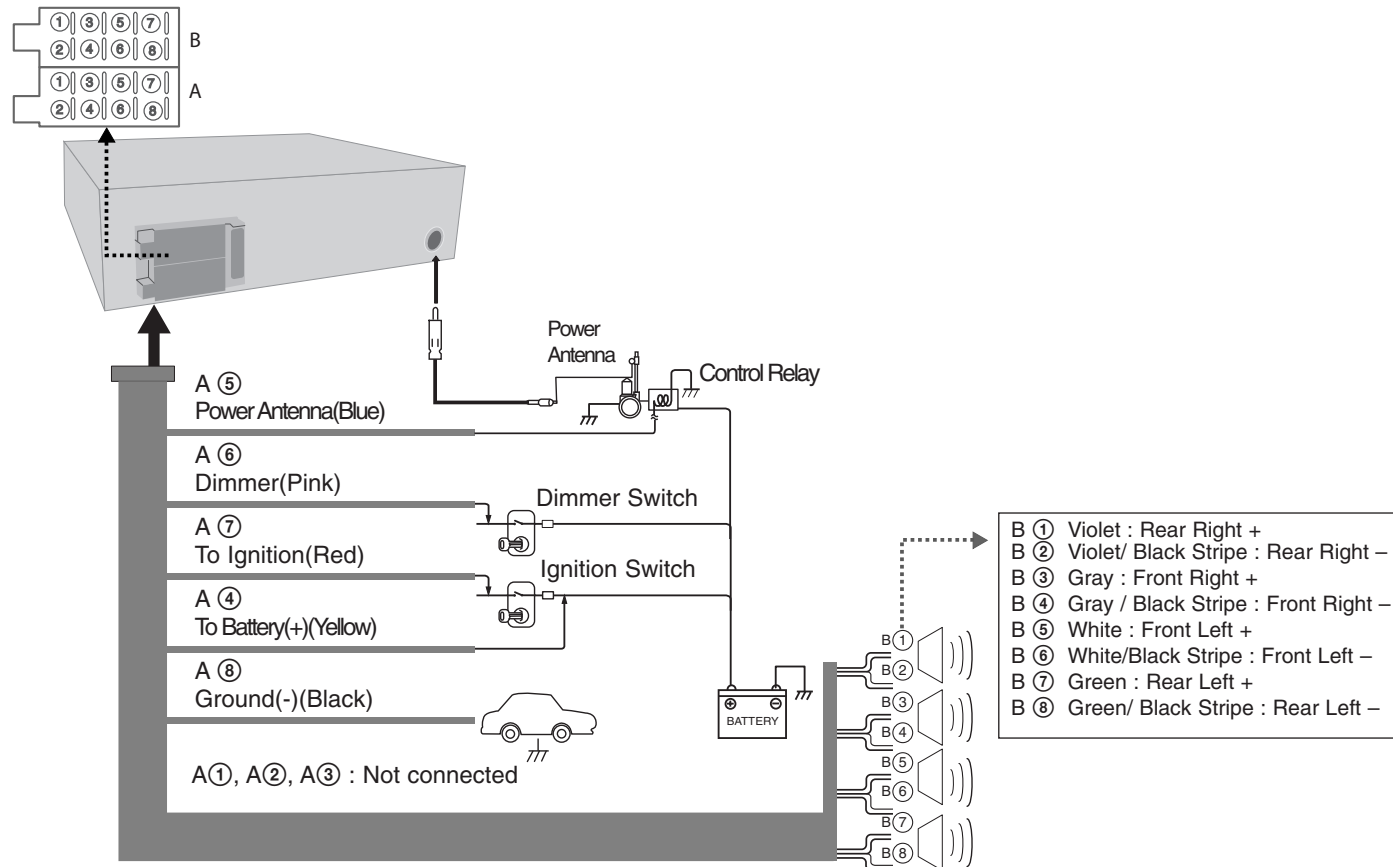

Basic Operation

	ON PLAYER
1. Turn the unit on.	PWR/MUTE
2. Select a source.	SRC
3. Adjust the volume.	VOLUME + or -

Basic operation - more you can do

Mute

Press **PWR/MUTE** to cut the sound. To cancel it, press again.

Changing the general settings

- 1 Press **MENU** so that one of menu items appears.
 - 2 Press **MENU** and press + or - to select one of the settings specified belows.
 - 3 Press and hold **MENU** finish the setting.
- **AUX (Auxiliary) ON / OFF**
It is possible to use auxiliary equipment with this unit. Activate the auxiliary setting when using auxiliary equipment connected to this unit.
 - **AUX (Auxiliary) 00dB / +6dB**
You can adjust the volume level of each source to prevent radical changes in volume when switching between sources.
You can set to 0 dB or +6 dB. You may be surprised at a loud sound when you change the source from the external component to another source.
 - **DEMO OFF/ ON**
You can change the initial indication on the display to information name (function name, EQ name, etc...) while listen to a source.
 - **BEEP 2ND / ALL**
BEEP 2ND : The beep is generated when a key is long pressed. (1 sec)
BEEP ALL : The beep is generated when any key is pressed.

Using the EQ

EQ is to increase or decrease the signal strength of audio frequencies. The function helps you to enjoy sound more plentifully. Press **XDSS/EQ** repeatedly. The indicator lights up in the following order.

POP → CLASSIC → ROCK → OFF(Not displayed.)

Note

When XDSS+ is set to "Off", you can adjust the EQ settings.

Adjusting the sound level

Press **SEL** repeatedly to select the mode you want to adjust from volume, balance and fader.

Note

When EQ and XDSS+ is set to "Off", you can adjust the sound level (BAS, TRB) settings.

XDSS+ (Extreme Dynamic Sound System)

Press and hold **XDSS/EQ** for more 2 seconds. (XDSS+ : Improves the treble, bass sound.)

Checking the clock

You can see the clock pressing **DISP**.

Setting the clock

- 1 Press the **DISP** and then, press and hold **DISP** for more 1 second.
- 2 Press the < to adjust the hour.
- 3 Press the > to adjust the minute.

Listening to the radio

	ON PLAYER
1. Select a source to tuner.	SRC
2. Select a band.	BAND
3. Auto seek. Manual seek.	< / > < / > (Press and hold)

Listening to the radio - more you can do

Auto search memory

Press **▲/AS**. The six strongest broadcast frequencies will be stored under preset button 1-6 in the order of their signal strength. To cancel, press **▲/AS**.

Storing and recalling broadcast frequencies

- 1 Press **BAND** to select desired band you want to store.
- 2 Select the desired frequency and press one of preset buttons 1-6 and hold until the beep sound.
- 3 Repeat steps 1-2 to preset other stations. The next time, you press the same preset button, the radio station frequency is recalled from the memory.

To scan the preset stations

Press **▼/PS**. Each preset station appears. To cancel, press **▼/PS**.

To tune in the preset stations

Press **BAND** to select the desired band and press the desired preset button 1-6.

Note

- Up to 24 stations, 6 for each of three FM bands and 6 MW(AM) stations can be stored in the memory.
- When a station is stored on the preset numbers on which another station of the same band has already been preset, the previously preset station is automatically erased.

Connecting an Auxiliary Equipment

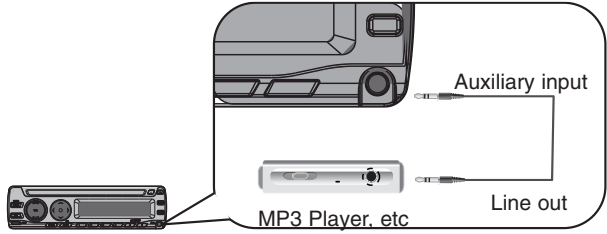

The diagram illustrates the connection of an MP3 Player, etc. to a car stereo. The MP3 player is connected to the car stereo's Auxiliary input and Line out ports.

	ON PLAYER
1. Select a source to AUX.	SRC
2. Play the connected Auxiliary Equipment.	-
3. Adjust the volume.	VOLUME + or -

Listening a CD

	ON PLAYER
1. Insert a CD.	-
2. Adjust the Volume.	VOLUME + or -

Listening a CD - more you can do

Pause or restart a CD

Press **▶||** on the player during playback. Press this button again to resume play.

Search for a section within a track / file

Press and hold **< / >** on the player for about 1 second during playback and then release at the point you want.

Skip to another track / file

Press **< / >** on the player. If you want to skip to previous track or file, press briefly **<** within 3 seconds of playing time.

Intro scan

Press or press and hold **INT** on the player. Each files in the current selected folder (**■ INT**) or the first 10 seconds of each tracks/files (**INT**) on the disc are played. Press the **INT** again to cancel it.

Repeat

Press or press and hold **RPT** on the player. The current selected tracks/files (1 **RPT**) or folder (**■ RPT**) on the disc is played repeatedly. Press **RPT** again to cancel it.

Shuffle

Press or press and hold **SHF** on the player. Each files in the current selected folder (**■ SHF**) of all of the tracks/files (**SHF**) on the disc is played randomly. Press **SHF** again to cancel it.

Note

During random playback, if you press **<**, you won't go back to the previous track.

MP3/WMA Track -10 / +10

(If there is no folder or one folder.) During playback press **V** to go back 10 tracks, and press **Λ** to go forward 10 tracks.

MP3/WMA Folder UP/DOWN

(If there are more than two folders.) During playback, press **V** to go back to the previous folder, and press **Λ** to go forward to the next folder.

See information about your music

MP3/WMA files often come with tags. The tag gives the Title, Artist or Album. Press **DISP** repeatedly during MP3/WMA/CD TEXT file playback. If there is no information, "NO TEXT" will be shown in the display window.

Note

- **■** : The icon is displayed during MP3/WMA playback.
- **MP3/WMA Disc compatibility with this unit is limited as follows:**
 1. Sampling Frequency / 8 - 48kHz (MP3) 22.05 - 48kHz (WMA)
 2. Bit rate / within 8 - 320kbps (include VBR) (MP3) 32 -320kbps (WMA)
 3. CD-R/CD-RW file system should be "ISO 9660"
 4. If you record MP3/WMA files using software which cannot create a FILE SYSTEM, for example "Direct-CD" etc., it will not be possible to playback MP3/WMA files. We recommend that you use "Easy-CD Creator" which creates an ISO9660 file system.
 5. WMA decoder is supported until "Class 2A".

Customers should also note that permission is required in order to download MP3/WMA files and music from the Internet. Our company has no right to grant such permission. Permission should always be sought from the copyright owner.

Troubleshooting

	Symptom	Cause	Correction
General	Power doesn't turn on / The unit doesn't operate.	Leads and connectors are not properly.	Confirm once more that all connections are correct.
		The fuse is blown.	Rectify the problem that caused the fuse to blow, and then replace it. Be very sure to install the correct fuse with the same rate.
		Noise and other factors are causing the built-in microprocessor to operate incorrectly.	Turn the unit off and then on.
	No sound is heard / The volume level will not rise.	Cables are not connected correctly.	Connect the cables correctly.
CD	There's audio skipping.	This unit is not firmly secured.	Secure this unit firmly.
	The playback is not possible.	The disc is dirty.	Clean disc.
		The loaded disc is of a type this unit cannot play.	Check what type the disc.

Specifications

General

Output Power	50W x 4CH (Max.)
Power Source	DC 12V
Speaker impedance	4Ω
Ground System	Negative
Dimensions (W x H x D)	180 x 50 x 176 mm (Without Control Panel)
Net Weight	1.3 kg

Tuner

FM

Frequency Range	87.5-107.9, 87.5-108, 65-74 or 87.5-108 MHz
S/N Ratio	55 dB
Distortion	0.7%
Usable Sensitivity	12 dBμV

AM (MW)

Frequency Range	520-1720 or 522-1620 kHz
S/N Ratio	50 dB
Distortion	1.0%
Usable Sensitivity	28 dBμV

CD

Frequency Response	20 Hz-20 kHz
S/N Ratio	80 dB
Distortion	0.12%
Channel Separation (1kHz)	55 dB

AUX

Frequency Response	20 Hz-20 kHz
S/N Ratio	80 dB
Distortion	0.12 %
Channel Separation (1kHz)	45 dB
Max Input Level (1kHz)	1.2V (35KΩ)

Designs and specifications are subject to change without notice.

P/N : MFL41655329

12 | CAR CD/MP3/WMA Receiver