

# LG

Model: HT33S (HT33S-DP, SH33S-F/A)



Unique Features	Full HD up-scaling (1080p)	Home Theater Speaker ez Set-up	USB Direct Recording
	View Full HD picture quality with simple setup.	Listen sound from TV and Digital Device with 2.1ch mode.	Record music from CD to your USB device.
	Go to page 9	Go to page 14	Go to page 16
Portable In	Made for iPod	P/NO : MFL56962815	
Listen to music from your portable device (MP3, Notebook, etc).	Enjoy music from iPod with simple connection.		
Go to page 16	Go to page 17		

## Safety Precaution



**CAUTION**  
RISK OF ELECTRIC SHOCK  
DO NOT OPEN



**CAUTION:** TO REDUCE THE RISK OF ELECTRIC SHOCK DO NOT REMOVE COVER (OR BACK) NO USER-SERVICEABLE PARTS INSIDE REFER SERVICING TO QUALIFIED SERVICE PERSONNEL.



This lightning flash with arrowhead symbol within an equilateral triangle is intended to alert the user to the presence of uninsulated dangerous voltage within the product's enclosure that may be of sufficient magnitude to constitute a risk of electric shock to persons.



The exclamation point within an equilateral triangle is intended to alert the user to the presence of important operating and maintenance (servicing) instructions in the literature accompanying the product.

**WARNING:** TO PREVENT FIRE OR ELECTRIC SHOCK HAZARD, DO NOT EXPOSE THIS PRODUCT TO RAIN OR MOISTURE.

**WARNING:** Do not install this equipment in a confined space such as a book case or similar unit.

**CAUTION:** Do not block any ventilation openings. Install in accordance with the manufacturer's instructions.

Slots and openings in the cabinet are provided for ventilation and to ensure reliable operation of the product and to protect it from over heating. The openings should be never be blocked by placing the product on a bed, sofa, rug or other similar surface. This product should not be placed in a built-in installation such as a bookcase or rack unless proper ventilation is provided or the manufacturer's instruction has been adhered to.

**CAUTION:** This product employs a Laser System.

To ensure proper use of this product, please read this owner's manual carefully and retain it for future reference. Should the unit require maintenance, contact an authorized service center. Use of controls, adjustments or the performance of procedures other than those specified herein may result in hazardous radiation exposure. To prevent direct exposure to laser beam, do not try to open the enclosure. Visible laser radiation when open. DO NOT STARE INTO BEAM.

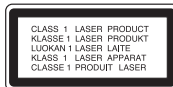

**CAUTION:** The apparatus should not be exposed to water (dripping or splashing) and no objects filled with liquids, such as vases, should be placed on the apparatus.

**CAUTION concerning the Power Cord**

**Most appliances recommend they be placed upon a dedicated circuit;**

That is, a single outlet circuit which powers only that appliance and has no additional outlets or branch circuits. Check the specification page of this owner's manual to be certain.

Do not overload wall outlets. Overloaded wall outlets, loose or damaged wall outlets, extension cords, frayed power cords, or damaged or cracked wire insulation are dangerous. Any of these conditions could result in electric shock or fire. Periodically examine the cord of your appliance, and if its appearance indicates damage or deterioration, unplug it, discontinue use of the appliance, and have the cord replaced with an exact replacement part by an authorized service center.

Protect the power cord from physical or mechanical abuse, such as being twisted, kinked, pinched, closed in a door, or walked upon. Pay particular attention to plugs, wall outlets, and the point where the cord exits the appliance.

To disconnect power from the mains, pull out the mains cord plug. When installing the product, ensure that the plug is easily accessible.

### Disposal of your old appliance



1. When this crossed-out wheeled bin symbol is attached to a product it means the product is covered by the European Directive 2002/96/EC.
2. All electrical and electronic products should be disposed of separately from the municipal waste stream via designated collection facilities appointed by the government or the local authorities.
3. The correct disposal of your old appliance will help prevent potential negative consequences for the environment and human health.
4. For more detailed information about disposal of your old appliance, please contact your city office, waste disposal service or the shop where you purchased the product.



**This product is manufactured to comply with EMC Directive 2004/108/EC and Low Voltage Directive 2006/95/EC.**

### European representative :

LG Electronics Service Europe B.V.  
Veluwezoom 15, 1327 AE Almere, The Netherlands  
(Tel : +31-036-547-8940)

# Welcome to your new stylish home theater system

## Contents

Main unit	.4
Remote control	.5
Making system connections	.6-7
Listening to the sound from your analog component	.7
OSD Initial language settings - optional	.8
Initial Setting the Area Code	.8
Adjust the settings	.8-10
Setting the sound mode	.10
Displaying Disc Information	.11
Playing a disc or file	.11-13
Viewing photo files	.13
Listening to the radio	.14
Home Theater Speaker ez Set-up	.14
Listening to music from your USB device	.15
Recording music from CD to your USB device	.16
Listening to music from your portable player	.16
Listening to music from your iPod	.17
Language Codes	.18
Area Codes	.18
Troubleshooting	.19
Types of Playable Discs	.20
Specifications	.21



## What is SIMPLINK?

Some functions of this unit are controlled by TV's remote control when this unit and LG TV with SIMPLINK are connected through HDMI connection.

- Controllable functions by LG TV's remote control; Play, Pause, Scan, Skip, Stop, Power Off, etc.
- Refer to the TV owner's manual for the details of SIMPLINK function.
- LG TV with SIMPLINK function has the logo as shown above.
- Use a higher version cable than 1.2A HDMI cable.



iPod is a trademark of Apple Inc., registered in the U.S. and other countries.

# Main Unit

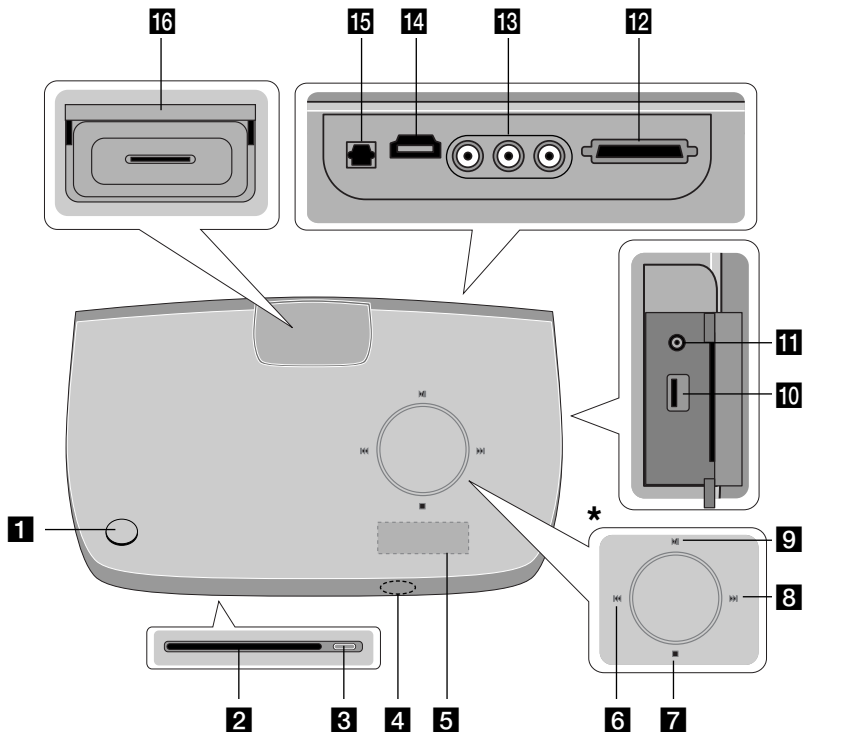

- |                                  |                                |                                     |
|----------------------------------|--------------------------------|-------------------------------------|
| <b>1</b> POWER                   | <b>7</b> STOP                  | <b>13</b> COMPONENT VIDEO OUT JACKS |
| <b>2</b> DISC SLOT               | <b>8</b> TUNING UP & SKIP (▶▶) | <b>14</b> HDMI OUT JACK             |
| <b>3</b> EJECT                   | <b>9</b> PLAY/PAUSE (▶ /   )   | <b>15</b> OPTICAL IN JACK           |
| <b>4</b> REMOTE SENSOR           | <b>10</b> USB PORT             | <b>16</b> iPod DOCK                 |
| <b>5</b> DISPLAY WINDOW          | <b>11</b> PORTABLE IN JACK     |                                     |
| <b>6</b> TUNING DOWN & SKIP (◀◀) | <b>12</b> SYSTEM JACK          |                                     |

## \* Touch sensor

This unit has sensitive controls that respond to the touch of your fingers. You can also change the volume by moving your finger around the touch wheel.

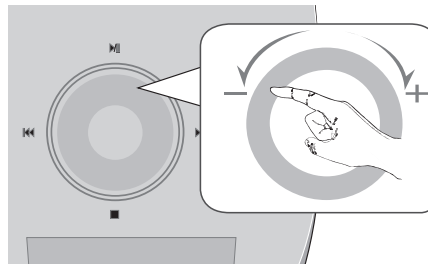

### Precautions in using the touch buttons

- Use the touch buttons with clean and dry hands.
  - In a humid environment, wipe out any moisture on the touch buttons before using.
- Do not press the touch buttons hard to make it work.
  - If you apply too much strength, it can damage the sensor of the touch buttons.
- Touch the button that you want to work in order to operate the function correctly.
- Be careful not to have any conductive material such as metallic object on the touch buttons. It can cause malfunctions.

## Remote control

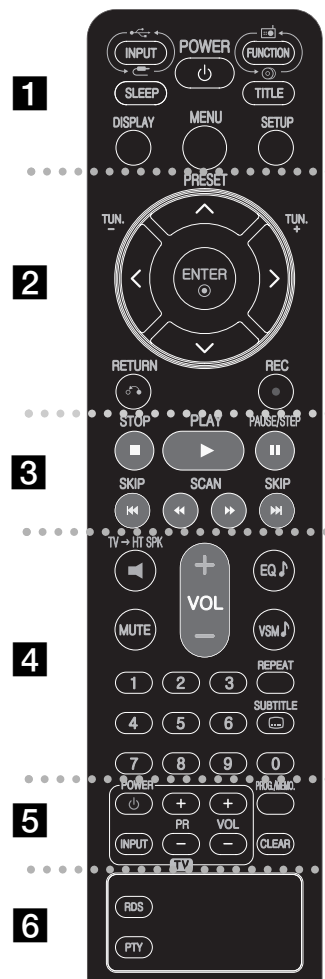

- 1**
- INPUT** : Changes the input source ( AUX, AUX OPT, PORTABLE, USB, OSD IPOD, IPOD)  
**SLEEP** : Sets a certain period of time after which the unit will switch to standby.  
 - Press SLEEP repeatedly to select the desired time period options (in minutes): (Dimmer on → Sleep timer value → Dimmer off)  
 Dimmer on: The display window becomes dark and the touch wheel turns off.  
 - To view the time countdown to the standby mode, press SLEEP again.  
 - To deactivate the sleep timer, press SLEEP until the previous status is displayed or press POWER to switch the unit to standby.
- POWER**: Switches the unit ON or OFF.  
**FUNCTION** : Selects the function (DVD/CD, FM)  
**TITLE** : If the current DVD title has a menu, the title menu appears on the screen. Otherwise, the disc menu may not appear.  
**DISPLAY**: Accesses On-Screen Display.  
**MENU** : Accesses the menu on a DVD disc.  
**SETUP** : Accesses or removes setup menu
- 2**
- PRESET**(▲/▼): Selects programme of Radio.  
**TUN**.(-/+): Tunes in the desired radio station.  
**</> / ▲ / ▼ (left/right/up/down)**:Used to navigate on-screen displays.  
**ENTER** : Acknowledges menu selection.  
**RETURN** (↶): Press to move backwards in the menu.  
**REC** (●) : USB Direct Recording
- 3**
- STOP** (■): Stops playback or recording.  
**PLAY** (▶): Starts playback. Mono/Stereo.  
**PAUSE/STEP** (⏸): Pause playback.  
**SKIP**(⏮ / ⏭): Go to next or previous chapter/ track.  
**SCAN**(⏮/⏭) : Search backward or forward.

- 4**
- TV→HT SPK** (Home theater Speaker ez Set-up): Press HT→ SPK to select the AUX OPT directly.  
**MUTE** : Press MUTE to mute your unit. You can mute your unit in order, for example, to answer the telephone.  
**VOLUME (+/-)** : Adjusts speaker volume.  
**EQ** : You can choose 6 (or 7) fixed sound impressions.  
**VSM** : Press VSM to set the VIRTUAL sound.  
**REPEAT**: Repeats a Chapter/ Track/ Title/ all.  
**SUBTITLE**: During playback, SUBTITLE repeatedly to select a desired subtitle language .  
**0-9 numerical buttons**: Selects numbered options in a menu.
- 5**
- TV Control buttons** : Control the TV. (LG TV only)  
**PROG./MEMO.** : Accesses or removes Program menu.  
**CLEAR**: Removes a track number on the Program List.
- 6**
- RDS**: Radio display mode  
**PTY**: Views the various displays of the RDS

### Put the batteries into the remote control

Make sure that the + (plus) and - (minus) on the batteries match those on the remote control.

### Controlling the TV.

You can control the sound level, input source, and power switching of LG TVs as well. Hold POWER (TV) and press PR (+/-) button repeatedly until the TV turns on or off.

## Making system connections

### Connecting the main unit, speakers, and FM antenna to the active subwoofer.

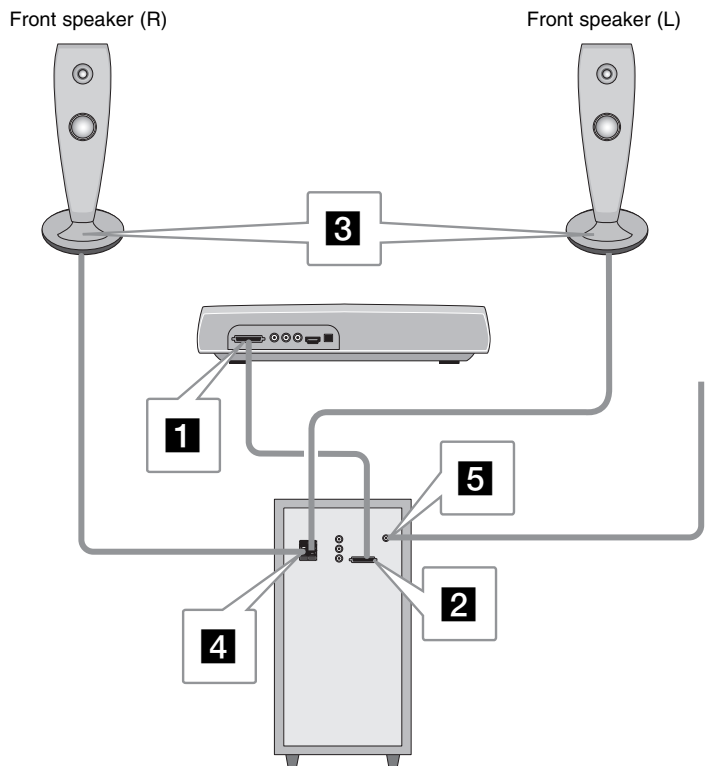

- 1** Connect the system jack marked **MAIN** to the main unit (**SYSTEM**). Secure the jack by tightening the two screws.

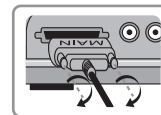

- 2** Connect the system jack marked **SPK** to the active subwoofer (**SYSTEM**). Secure the jack by tightening the two screws.

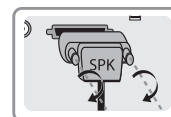

- 3 4** Connect the speakers to the active subwoofer (**SPEAKERS**). Connect the red end of each wire to the terminals marked **+** (plus) and black end to the terminals marked **-** (minus).

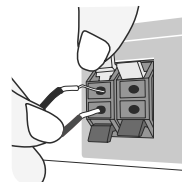

Active subwoofer

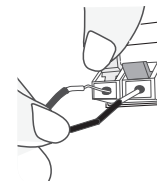

The bottom of the speaker

- 5** Connect the **FM antenna** for listening to the radio.
  - Be sure to fully extend the FM antenna.
  - After connecting the FM antenna, keep it as horizontal as possible.

## Making system connections

### Connecting the video out to your TV.

Check the jacks of your TV, and choose the **A**, **B**, or **C** connection.

Picture quality improves in order from **A** to **C**.

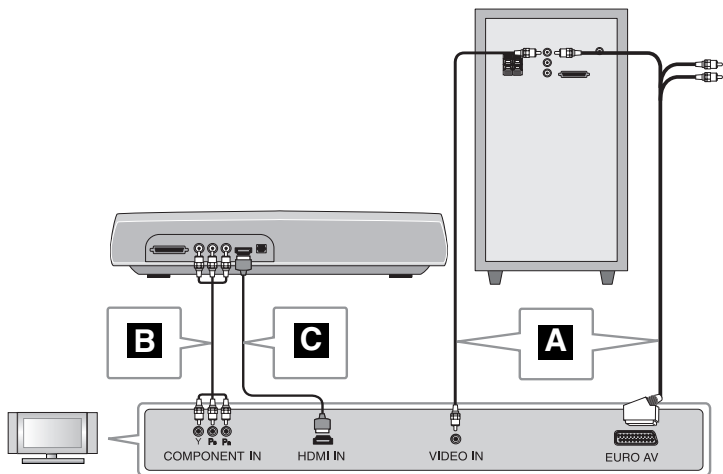

#### **A** To connect to a TV with the video in jack

Connect the video cable from the VIDEO OUT on the rear of the active subwoofer to the video in jack on your TV.

or

#### To connect to a TV with the SCART jack

Connect the RCA to SCART cable from the VIDEO OUT on the rear of the active subwoofer to the SCART jack on your TV.

#### **B** To connect to a TV with the component video in jacks

If your TV has component video in, connect a component video cable from COMPONENT VIDEO OUT (Y, PB and PR) jacks on the rear of the main unit to the component video in jacks on your TV.

#### **C** To connect to a TV with the HDMI jack

Connect the HDMI cable from the HDMI OUT jack on the rear of the main unit to the HDMI IN jack on your TV.

- If your TV does not accept your resolution setting, abnormal picture appears on the screen.
- Use the HDMI Cable within 5 meters.
- If the volume bar is not displayed on TV screen, when you select Simplink to off on TV, restart the unit.

Available resolution according to connection

[HDMI OUT] : Auto, 1080p, 1080i, 720p and 480p (or 576p)

[COMPONENT VIDEO OUT] : 480p (or 576p) and 480i (or 576i)

[VIDEO OUT] : 480i (or 576i)

## Listening to the sound from your analog component

Analog signal components such as VCR and TV.

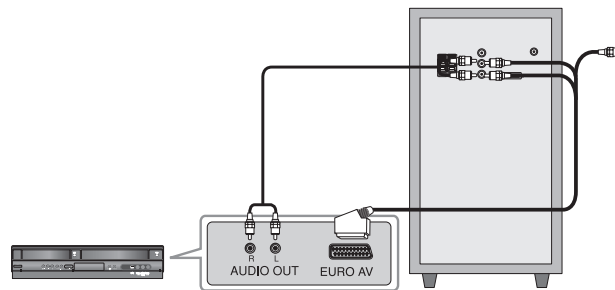

**1** Connect the audio out of your analog component to the AUX IN (AUDIO L/R) on the rear of the active subwoofer:

or

Connect the SCART jack of your analog component to the AUX IN (AUDIO L/R) on the rear of the active subwoofer.

**2** Select the AUX function:

ON REMOTE

-

INPUT

## OSD Initial language settings - optional

Before using the unit for the first time, you have to adjust OSD initial language.

	ON REMOTE
<b>1 Turn the power on:</b> The language list display window appears	POWER
<b>2 Select the language:</b>	▲▼◀▶
<b>3 Press:</b>	ENTER
<b>4 To confirm press:</b>	◀▶ and ENTER

## Initial Setting the Area Code

The first time you use this unit, to set the Area Code you have to as below.

	ON REMOTE
<b>1 Display setup menu:</b>	SETUP
<b>2 Select LOCK menu on the first level:</b>	▲▼
<b>3 Move to second level:</b> The activated Area Code appears on the second level.:	▶
<b>4 Move to third level:</b>	▶
<b>5 Enter the new password:</b>	numerical buttons (0-9) and ENTER
<b>6 Recheck entered new password:</b>	numerical buttons (0-9) and ENTER
<b>7 Select a code for a geographic area:</b> After select, Rating and Password will be activated.(page 18)	▲▼◀▶
<b>8 To confirm press:</b> Make sure to finish setting the Area Code before leaving the setup menu if you cannot set the Rating and Password.	ENTER

## Adjust the settings

	ON REMOTE
<b>1 Display setup menu :</b>	SETUP
<b>2 Select a desired option on the first level:</b>	▲▼
<b>3 Move to second level:</b>	▶
<b>4 Select a desired option on the second level:</b>	▲▼
<b>5 Move to third level:</b>	▶
<b>6 Change the setting:</b>	▲▼, ENTER

## Adjust the settings - more you can do

### Adjust the language settings

**OSD** – Select a language for the Setup menu and on-screen display.

There is displayed as “-” or other error mark on display when you change OSD, do as follows;

- Restart the unit
- Change function
- Disconnect and connect USB device.

**Disc Audio/Subtitle/Menu**– Select a language for the Menu/Audio/Subtitle.

[Original]: Refers to the original language in which the disc was recorded.

[Other]: To select another language, press number buttons then ENTER to enter the corresponding 4-digit number according to the language code list in the reference chapter (see page 18). If you make a mistake before pressing ENTER, press CLEAR

[Off] (for Disc Subtitle): Turn off Subtitle.



## Adjust the display settings

**TV Aspect** – Select which screen aspect to use based on the shape of your TV screen.

[4:3]: Select when a standard 4:3 TV is connected.

[16:9]: Select when a 16:9 wide TV is connected.

**Display Mode** – If you selected 4:3, you'll need to define how you would like widescreen programs and films to be displayed on your TV screen.

[Letterbox]: This displays a widescreen picture with black bands at the top and bottom of the screen.

[Panscan]: This fills the entire 4:3 screen, cropping the picture as necessary.

**Video Resolution** - Use ▲▼ to select the desired resolution then press ENTER to confirm your selection.

**You can set 1080p video resolution to enjoy Full HD picture quality. (Full HD up-scaling)**

The number in 480p (or 576p), 720p, 1080p and 1080i indicates the number of lines of video. The “i” and “p” indicate interlaced and progressive scan, respectively.

[Auto] If your HDMI jack is connected to TVs providing display information (EDID), automatically selects the resolution best suited to the connected TV (1080p, 1080i, 720p or 480p (or 576p)). (only for HDMI connection)

[1080p] Outputs 1080 lines of progressive video. (only for HDMI connection)

[1080i] Outputs 1080 lines of interlaced video.(only for HDMI connection)

[720p] Outputs 720 lines of progressive video.(only for HDMI connection)

[480p (or 576p)] Outputs 480 (or 576) lines of progressive video.

[480i (or 576i)] Outputs 480 (or 576) lines of interlaced video.

### Notes on Video Resolution

- Only resolutions supported by the TV are available.
- Depending on your TV, certain HDMI output resolutions may not work.
- If your TV does not accept your resolution setting, an abnormal picture appears on the screen. Please read TV's owner's manual then set the resolution that your TV can accept.
- If the HDMI jack is connected for TVs providing display information (EDID), you can not select resolutions that the TV does not accept.
- If the picture does not appear on the screen, change the TV's input source.
- If you turn off the TV or disconnect the HDMI cable during playback of the device, the playback may pause. You have to click on the play button to play back again. For some TVs, when you change the TV mode, such condition specified above may happen.

## Adjust the audio settings

**2.1 Speaker Setup** - Adjust 2.1 Speaker Setup menu for amplifier's output.

[Speaker]: Select a speaker that you want to adjust.

[Volume]: Adjust the output level of the selected speaker. (-5dB ~ 5dB)

[Test]: Press ◀ / ▶ to test the signals of each speaker. Adjust the volume to match the volume of test signals memorized in the system.

**DRC (Dynamic Range Control)** – Make the sound clear when the volume is turned down (Dolby Digital only). Set to [On] for this effect.

**Vocal** – Select [On] to mix karaoke channels into normal stereo. This function is effective for multi-channel karaoke DVDs only.

**HD AV Sync** - Sometimes Digital TV encounters a delay between picture and sound. If this happens you can compensate by setting a delay on the sound so that it effectively 'waits' for the picture to arrive: this is called HD AV Sync. Use ▲▼ to scroll up and down through the delay amount, which you can set at anything between 0 and 300m sec.

The delay will vary depending on which digital TV channel you are on. If you change channel you may need to readjust the HD AV Sync.

## Adjust the lock settings

To access the lock options, you must enter the 4-digit password. If you have not yet entered a password you are prompted to do so. Enter a 4-digit password. Enter it again to verify. If you make a mistake while entering number, press CLEAR to delete numbers.

If you forget your password you can reset it. Press SETUP to display the Setup menu. Input '210499' and press ENTER. The password has now been cleared.

**Rating** – Select a rating level. The lower the level, the stricter the rating. Select [Unlock] to deactivate the rating.

**Password** – Sets or changes the password for lock settings.

[New]: Enter a new 4-digit password using the numerical buttons then press ENTER. Enter the password again to confirm.

[Change]: Enter the new password twice after entering the current password.

**Area code** – Select a code for a geographic area as the playback rating level. This determines which area's standards are used to rate DVDs controlled by the parental lock. See the Area Codes on page 18.

## Adjust the others settings

**DivX(R) Registration** – We provide you with the DivX® VOD (Video On Demand) registration code that allows you to rent and purchase videos using the DivX® VOD service.

For more information, visit [www.divx.com/vod](http://www.divx.com/vod).

Press ENTER when [Select] icon is highlighted and you can view the registration code of the unit.

**Bit Rate** – You can set the quality of the recorded file.

Bit rate refers to the amount of data used to store each second of audio.

Generally, higher bit rates provide better sound quality, but require more storage space for the same length of audio.

## Setting the sound mode

### VSM (VIRTUAL SOUND MATRIX)

You can select the Virtual sound. Press VSM to set the virtual sound (This function does not operate when you select AUX or Tuner functions. VSM is not available during DivX file playback.)

[BYPASS] mode : Software with multichannel surround audio signals is played according to the way it was recorded.

### 2Ch source

[ON STAGE] mode: Simulates a large Concert hall

[VIRTUAL] mode: Realtime 3D positioned sound rendering technology with stereo sources, optimized for stereo speakers. Listeners may experience amazing virtual surround effects with their own multimedia players.

### 5.1Ch source

[VIRTUAL] mode: A patent pending downmix technology converts 5.1 channel to 2 channel sound having directional information of audio.

### Set a pre-programmed sound field

This system has a number of pre-set surround sound fields. Select the one which best suits the programme you are watching by pressing EQ repeatedly to cycle through the options : NORMAL, NATURAL, AUTO EQ, POP, CLASSIC, ROCK, JAZZ

[AUTO EQ]: AUTO EQ operates only in the MP3/ WMA files which include the information. (ID3 Tag is operated ver.1 only.) WMA file operates to Normal EQ regardless of Tag information.

## Displaying Disc Information

	ON REMOTE
1 Press DISPLAY:	DISPLAY
2 Select a item:	▲▼
3 Adjust the Display menu settings:	◀▶
4 To return the exit:	DISPLAY

## Displaying Disc Information - more you can do

You can select an item by pressing ▲▼ and change or select the setting by pressing ▶▶.

	Current title (or track) number/total number of titles (or tracks)
	Current chapter number/total number of chapters
	Elapsed playing time
	Selected audio language or channel
	Selected subtitle
	Selected angle/total number of angles
	Selected sound mode

## Symbol Used in this Manual

All discs and file listed below	<b>ALL</b>	MP3 files	<b>MP3</b>
DVD and finalized DVD±R/RW	<b>DVD</b>	WMA files	<b>WMA</b>
DivX files	<b>DivX</b>	Audio CDs	<b>ACD</b>

## Playing a Disc or file

	ON REMOTE
1 Insert a Disc in the slot: (On unit)	-
2 Select the DVD/CD function:	FUNCTION
3 Adjust the menu settings: or Select a file from the menu:	▲▼◀▶ ▲▼
4 Start the Disc playing:	▶ PLAY
5 To stop the Disc playing:	■ STOP

## Playing a Disc or file - more you can do

### Playing a DVD that has a menu **DVD**

Most DVD now have menus which load first before the film begins to play. You can navigate these menus using ▲▼◀▶ to highlight an option. Press ENTER to select.

### Skip to the next/previous chapter/track **ALL**

Press SKIP (▶▶) to move to the next chapter/track.  
Press SKIP (◀◀) to return to the beginning of the current chapter/track.  
Press SKIP (◀◀) twice briefly to step back to the previous chapter/track.

### Pause playback **ALL**

Press PAUSE/STEP (||) to pause playback. Press PLAY (▶) to continue playback.

### Frame-by-Frame playback **DVD** **DivX**

Press PAUSE/STEP (||) repeatedly to play title Frame-by-Frame.

### Playing repeatedly **ALL**

Press REPEAT repeatedly to select a desired repeat mode: track, all and off. The current title, chapter or track will be played back repeatedly. To return to normal playback, press REPEAT repeatedly to select [Off].

**Fast forward or fast reverse** **ALL**

Press SCAN (◀◀ or ▶▶) to play fast forward or fast reverse during playback. You can change the playback speed by pressing SCAN (◀◀ or ▶▶) repeatedly. Press PLAY (▶) to continue play at normal speed.

**Selecting a subtitle language** **DVD** **DivX**

During playback, press SUBTITLE (☐) repeatedly to select a desired subtitle language.

**Slow down the playing speed** **DVD**

While playback is paused, press SCAN (◀◀ or ▶▶) to slow down forward or reverse playback. You can change the various playback speed by pressing SCAN (◀◀ or ▶▶) repeatedly. Press PLAY (▶) to continue play at normal speed.

**Watch and listen 1.5 times faster** **DVD** **ACD** **MP3** **WMA**

Press PLAY when a DVD is already playing to watch and listen to a DVD 1.5 times faster than normal playback speed. ▶x1.5 will appear in the top right corner of the screen. Press PLAY again to return to normal playback speed.

**Viewing the Title menu** **DVD**

Press TITLE to display the disc's title menu, if available.

**Viewing the DVD MENU** **DVD**

Press MENU to display the disc menu, if available.

**Starting play from selected time** **DVD** **DivX**

Searches for the starting point of entered time code. Press DISPLAY during playback and select the time clock icon. Input the required start time in hours, minutes, and seconds and press ENTER. If you enter the wrong number, press CLEAR to enter again.

**Last Scene Memory** **DVD**

This unit memorizes the last scene from the last disc that is viewed. The last scene remains in memory even if you remove the disc from the player or switch off (Stand-by mode) the unit. If you load a disc that has the scene memorized, the scene is automatically recalled.

**Mixed disc or USB Flash Drive – DivX, MP3/WMA and JPEG**

When playing a disc or USB Flash Drive containing with DivX, MP3/WMA and JPEG files together, you can select which menu of files you would like to play by pressing TITLE. Press ENTER after selecting MUSIC, PHOTO, or MOVIE by pressing ◀ ▶.

**Changing the character set to display DivX® subtitle correctly** **DivX**

If the subtitle does not display properly during playback, press and hold SUBTITLE for about 3 seconds then press SUBTITLE to select another language code until the subtitle is displayed properly

**DivX file requirement** **DivX**

DivX disc compatibility with this player is limited as follows:

- Available resolution size: 800x600 (W x H) pixel
- The file name of the DivX subtitle is available by 45 characters.
- If there is impossible code to express in the DivX file, it may be displayed as " \_ " mark on the display.
- If the number of the screen frame is over 30 per 1 second, this unit may not operate normally.
- If the video and audio structure of recorded files are not interleaved, either video or audio is outputted.
- If the name of movie file is different from that of the subtitle file, during playback of a DivX file, subtitle may not be display.
- MPEG4 file extensions: ".avi", ".mpg", ".mpeg"
- Playable DivX subtitle: SubRip(\*.srt/\*.txt), SAMI(\*.smi), SubStation Alpha(\*.ssa/\*.txt) MicroDVD(\*.sub/\*.txt) SubViewer 2.0(\*.sub/\*.txt) TMPlayer(.txt), DVD Subtitle System(.txt) (Files (VobSub(.sub)) included with USB device is not supported)
- Playable Codec format: "DIVX3.xx", "DIVX4.xx", "DIVX5.xx", "MP43", "3IVX"
- Playable Audio format: "AC3", "DTS", "PCM", "MP3", "WMA"
- Sampling frequency: within 32 - 48 kHz (MP3), within 24 - 48kHz (WMA)
- Bit rate: within 32 - 320kbps (MP3), 40 - 192kbps (WMA)
- CD-R/RW, DVD±R/RW Format: ISO 9660
- Maximum Files/Disc: Less than 999 (total number of files and folders)

**Displaying file information (ID3 TAG)** **MP3**

While playing an MP3 file containing file information, you can display the information by pressing DISPLAY repeatedly.

**Screen Saver**

The screen saver appears when you leave the unit in Stop mode for about five minutes.

### Creating your own program **ACD** **MP3** **WMA**

You can play the contents of a disc in the order you want by arranging the order of the music files on the disc. The program is cleared when the disc is removed. Select a desired music file then press PROG./MEMO. or select "⏪" and then press ENTER to add the music file to the program list. To add all music files on the disc, select "⏪" and then press ENTER. Select a music file from the program list then press ENTER to start programmed playback. To clear a music file from the program list, select the music file you want to clear then press CLEAR or select "⏩" icon and then press ENTER. To clear all music files from the program list, select "⏩" then press ENTER.

### MP3/WMA music file requirement

MP3/WMA compatibility with this unit is limited as follows:

- File extensions: ".mp3", ".wma".
- Sampling frequency: within 32 - 48 kHz (MP3), within 24 - 48kHz (WMA)
- Bit rate: within 32 - 320kbps (MP3), 40 - 192kbps (WMA)
- CD-R/RW, DVD±R/RW Format: ISO 9660
- Maximum Files/Disc: Less than 999 (total number of files and folders)

### System Select

You must select the appropriate system mode for your TV system. If "NO DISC" appears in the display window, press and hold PAUSE/STEP (||) on the remote control for more than five seconds to be able to select a system.

## Viewing photo files

	ON REMOTE
<b>1 Insert a Disc in the slot: (On unit)</b>	-
<b>2 Select a photo file:</b>	▲ ▼
<b>3 Display the selected file in full screen:</b>	ENTER
<b>4 To return to the menu:</b>	■ STOP

## Viewing photo files - more you can do

### Viewing photo files as a slide show

Use ▲▼◀▶ to highlight (■) icon then press ENTER to start slide show. You can change slide show speed using ◀▶ when (■) icon is highlighted. If ■ is selected, the slide show dose not operate.

### Skip to the next/previous photo

Press SKIP (◀◀ or ▶▶) to view the previous/next photo.

### Rotate a photo

Use ▲▼◀▶ to rotate the photo in full screen mode.

### Pause a slide show

Press PAUSE/STEP (||) to pause a slide show. Press PLAY (▶) to continue the slide show.

### Photo file requirement

JPEG file compatibility with this unit is limited as follows:

- File extensions: ".jpg"
- Photo size: Normal - within 5120 x 3840 (W x H) pixels.  
Progressive - within 2048 x 1536 (W x H) pixels
- CD-R/RW, DVD±R/RW Format: ISO 9660
- Maximum Files/Disc: Less than 999 (total number of files and folders)

## Listening to the radio

Be sure that FM antenna is connected.

	ON REMOTE
<b>1 Turn the power on:</b>	<b>POWER</b>
<b>2 Select FM:</b>	<b>FUNCTION</b>
<b>3 Select a radio station:</b>	<b>TUN.-/+</b>
<b>4 To save a radio station:</b> A preset number will show in the display. Up to 50 radio stations can be saved.	<b>PROG/MEMO.</b>
<b>5 To confirm press:</b>	<b>PROG/MEMO.</b>
<b>6 To select a saved station:</b>	<b>PRESET ▲/▼</b>

## Listening to the radio - more you can do

### Look for radio stations automatically

Press and hold TUN.-/TUN.+ for more than a second. The tuner will scan automatically and stop when it finds a radio station.

### Choose a preset number for a radio station

When storing a radio station, the preset number can be chosen. When this unit automatically shows a preset number, press PRESET ▲/▼ to change it. Press PROG./MEMO. to save your chosen number.

### Delete all the saved stations

Press and hold PROG./MEMO for two seconds. ERASE ALL will flash up on the display. Press PROG./MEMO to erase all saved radio stations.

### Improve poor FM reception

Press PLAY (▶) on the remote control. This will change the tuner from stereo to mono and usually improve the reception.

## See information about a radio station

The FM tuner is supplied with the RDS (Radio Data System) facility. This shows information about the radio station being listened to. Press RDS repeatedly to cycle through the various data types:

- PS** (Programme Service Name)  
The name of the channel will appear in the display
- PTY** (Programme Type Recognition)  
The programme type (e.g. Jazz or News) will appear in the display.
- RT** (Radio Text)  
A text message contains special information from the broadcast station. This text may scroll across the display.
- CT** (Time controlled by the channel)  
This shows the time and date as broadcast by the station.

## Home Theater Speaker ez Set-up

Listen to sound from TV and Digital Device with 2.1ch mode. Even in power off mode, if you press TV→HT SPK, then power is on and automatically changed to AUX OPT mode.

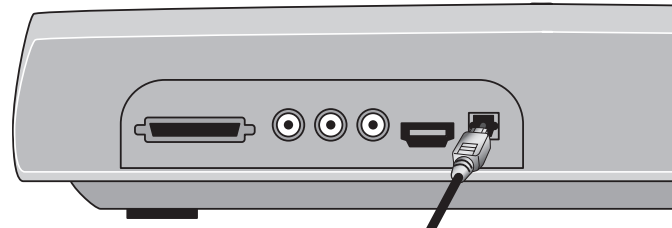

	ON REMOTE
<b>1 Connect</b> the main unit's OPTICAL IN jack to jack on optical out of your TV (or Digital Device etc.):	-
<b>2 Select the AUX OPT function:</b> To select the AUX OPT directly	<b>TV→HT SPK</b>
<b>3 Listen sound with 2.1ch speaker.:</b>	-
<b>4 To escape from AUX OPT</b>	<b>TV→HT SPK, FUNCTION, or INPUT</b>

## Listening to music from your USB device

The advantage of connecting your portable USB player through the system's USB port is that the USB device can be controlled from the system.

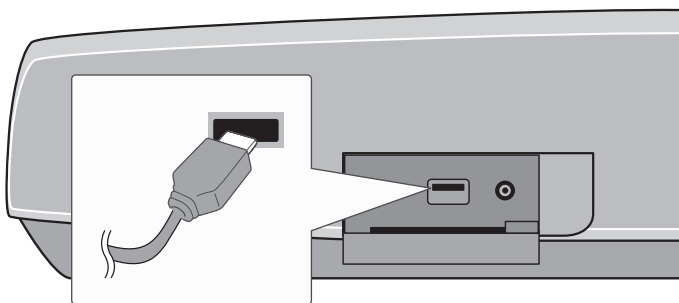

	ON REMOTE
<b>1 Connect the USB device to the unit:</b>	-
<b>2 Select the USB function:</b>	<b>INPUT</b>
<b>3 Select a file from the menu:</b>	<b>▲ ▼</b>
<b>4 Start your music playing:</b>	<b>▶PLAY</b>
<b>5 Before disconnecting</b> the portable USB device, change to any other function by pressing:	<b>FUNCTION or INPUT</b>
<b>6 Remove the USB device:</b>	-

## Listening to music from your USB device - more you can do

### Compatible USB Devices

- Devices which require additional program installation when you have connected it to a computer, are not supported.
- MP3 Player : Flash type MP3 player.  
The MP3 player requiring installation of a driver is not supported.
- USB Flash Drive : Devices that support USB2.0 or USB1.1. (In case USB 2.0, it operates at the same speed as that of USB 1.1)

### USB device requirement

- **Do not extract the USB device while in operation.**
- To prevent data loss, back up all data.
- If you use a USB extension cable or USB hub, the USB device might not be recognized.
- A device using NTFS file system is not supported. (Only FAT (16/32) file system is supported.)
- The USB function of this unit does not support all USB devices.
- Digital camera and mobile phone are not supported.
- This unit is not supported when the total number of files is 1000 or more.
- If the connected USB device has two or more folders, a drive folder is displayed on the screen. If you want to move to the previous menu after you select a folder, press RETURN.
- In case of Multi card reader, video files can not be played.

## Recording music from CD to your USB device

	ON REMOTE
<b>1 Connect</b> the USB device to the unit:	-
<b>2 Select the DVD/CD function:</b>	<b>FUNCTION</b>
<b>3 Start the recording:</b> If you want to record a desired music file in disc to USB, record after playing back the file.	● REC ▲▼, PLAY (▶) and ● REC
<b>4 To stop a recording:</b>	■ STOP

## Recording music from CD to your USB device - more you can do

### Record Audio CD source to USB

**One track recording** - If the USB recording is started during playback of the CD, the only track would be recorded into the USB.

**All track recording** - If the REC button is pressed at the CD stop, all track would be recorded.

**Program list recording** - USB Records after selecting the tracks pressing the PROG./MEMO. button if you want to record the track you want. (Refer to "Creating your own program" on page 13.)

### When you are recording, look out for the following

- Do not remove the USB device during USB recording. If not, an incomplete file may be made and not deleted on PC.
- When you start the USB direct recording, you can check the recording percentage rate on the screen.
- During the recording is no sound and not operate for volume .
- When you stop recording, the file that has been recorded at that time will be stored.
- Playable USB REC. Bit rate : 96/128kbps (Refer to "Bit Rate" on page 10.)
- PAUSE/STEP (■) button does not operate during USB recording.
- USB port of the unit cannot be connected to PC. The unit cannot be used as a storage device.
- If the USB recording is not available, "NO USB", "ERROR", "USB FULL", "NO REC" appear on the display window.
- File will be stored to CD\_REC folder as a format "TRK-001.MP3".
- CD-G disc and the disc encoded with DTS are not recorded to USB.

- If you record more 999 files on CD\_REC folder, "ERROR" appears on the display window.
- New files are numbered in numeric sequence. If the total number of the files are more than 999, delete some or store some in PC.
- External HDD, Multi Card reader, Locked device and MP3 player is not supported.
- If you turn off and then on TV when the connected TV is HDMI mode, nothing may be displayed on screen during USB recording. To solve the problem, stop the USB direct recording.

The making of unauthorized copies of copy-protected material, including computer programs, files, broadcasts and sound recordings, may be an infringement of copyrights and constitute a criminal offense. This equipment should not be used for such purposes.

**Be responsible  
Respect copyrights**

## Listening to music from your portable player

The player can be used to play the music from many types of portable player

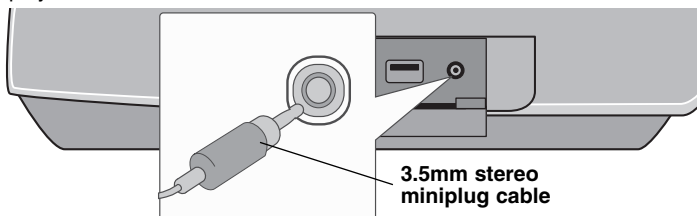

	ON REMOTE
<b>1 Connect</b> the headphone (or line out ) jack of the portable player into the PORT. IN on the right side of the main unit:	-
<b>2 Turn the power on:</b>	<b>POWER</b>
<b>3 Select the PORTABLE function:</b>	<b>INPUT</b>
<b>4 Turn the portable player on and start it playing:</b>	-



## Listening to music from your iPod

**iPod mode:** You can operate your iPod by using the supplied remote control and controls on your iPod. TV screen is turned off. iPod will not be charged when selecting the iPod mode. But you can enjoy better sound quality.

**OSD iPod mode:** You can operate your iPod by controlling OSD menu on the TV screen with supplied remote control. The controls on your iPod are not operational in the OSD iPod mode. If you want to charge the iPod while listening to music, selects the OSD iPod mode.

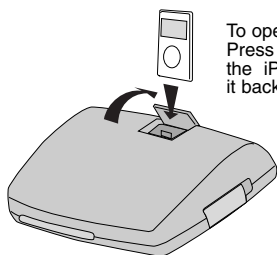

To open the iPod dock door: Press the marked iPod ▲ on the iPod dock door and push it backwards.

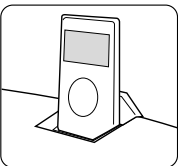

	ON REMOTE
<b>1 Connect</b> your iPod to the Dock on the top of the main unit:	-
<b>2 Turn the power on:</b>	<b>POWER</b>
<b>3 Select the iPod or OSD iPod function:</b>	<b>INPUT</b>
<b>4 Select the menu:</b>	<b>▲ ▼ ENTER</b>
<b>5 Select a file:</b>	<b>▲ ▼</b>
<b>6 Start the file playing:</b>	<b>▶ PLAY or ENTER</b>
<b>7 To stop the file playing:</b> To move the previous mode, press MENU on the remote control.	<b>■ STOP</b>
<b>8 Before disconnecting</b> the iPod, change to any other function by pressing:	<b>FUNCTION or INPUT</b>
<b>9 Remove</b> the iPod:	-

## Listening to music from your iPod - more you can do

### Pause playback **OSD iPod mode** **iPod mode**

Press PAUSE/STEP (II) to pause playback. Press PLAY (▶) to continue playback.

### Skip to the next/previous file **OSD iPod mode** **iPod mode**

Press SKIP (▶▶) to move to the next file.  
Press SKIP (◀◀) to return to the beginning of the current file.  
Press SKIP (◀◀) twice briefly to step back to the previous file.

### Fast forward or fast reverse **OSD iPod mode** **iPod mode**

During playback, press and hold SCAN (◀◀ or ▶▶) and then release at a point you want.

### Playing repeatedly **OSD iPod mode** **iPod mode**

Press REPEAT repeatedly to select a desired repeat mode : track, all and off.

### iPod message **OSD iPod mode**

“Please, check your iPod” - If the power of your iPod is insufficient or the iPod is misconnected or unknown device. Reset the iPod if the iPod is not operating normally (Refer to <http://www.apple.com/support/>)

### Compatible iPod

- Compatibility with your iPod may vary depending on the type of your iPod.
- Depending on your iPod's software version, it may not be possible to control your iPod from the unit. We recommend installing the latest software version.

### When you use iPod, look out for the following

- Interference may happen depending on iPod devices.
- The video or photo file is not displayed.
- When iPod is connected with dock connector, it may result in malfunctions of this unit.

## Language Codes

Use this list to input your desired language for the following initial settings: Disc Audio, Disc Subtitle, Disc Menu.

Language	Code	Language	Code	Language	Code	Language	Code	Language	Code	Language	Code
Afar	6565	Croatian	7282	Hausa	7265	Lingala	7678	Quechua	8185	Tajik	8471
Afrikaans	6570	Czech	6783	Hebrew	7387	Lithuanian	7684	Rhaeto-Romance	8277	Tamil	8465
Albanian	8381	Danish	6865	Hindi	7273	Macedonian	7775	Rumanian	8279	Telugu	8469
Ameharic	6577	Dutch	7876	Hungarian	7285	Malagasy	7771	Russian	8285	Thai	8472
Arabic	6582	English	6978	Icelandic	7383	Malay	7783	Samoan	8377	Tonga	8479
Armenian	7289	Esperanto	6979	Indonesian	7378	Malayalam	7776	Sanskrit	8365	Turkish	8482
Assamese	6583	Estonian	6984	Interlingua	7365	Maori	7773	Scots Gaelic	7168	Turkmen	8475
Aymara	6588	Faroeese	7079	Irish	7165	Marathi	7782	Serbian	8382	Twi	8487
Azerbaijani	6590	Fiji	7074	Italian	7384	Moldavian	7779	Serbo-Croatian	8372	Ukrainian	8575
Bashkir	6665	Finnish	7073	Javanese	7487	Mongolian	7778	Shona	8378	Urdu	8582
Basque	6985	French	7082	Kannada	7578	Nauru	7865	Sindhi	8368	Uzbek	8590
Bengali; Bangla	6678	Frisian	7089	Kashmiri	7583	Nepali	7869	Singhalese	8373	Vietnamese	8673
Bhutani	6890	Galician	7176	Kazakh	7575	Norwegian	7879	Slovak	8375	Volapük	8679
Bihari	6672	Georgian	7565	Kirghiz	7589	Oriya	7982	Slovenian	8376	Welsh	6789
Breton	6682	German	6869	Korean	7579	Panjabi	8065	Spanish	6983	Wolof	8779
Bulgarian	6671	Greek	6976	Kurdish	7585	Pashto, Pushto	8083	Sudanese	8385	Xhosa	8872
Burmese	7789	Greenlandic	7576	Laothian	7679	Persian	7065	Swahili	8387	Yiddish	7473
Byelorussian	6669	Guarani	7178	Latin	7665	Polish	8076	Swedish	8386	Yoruba	8979
Chinese	9072	Gujarati	7185	Latvian, Lettish	7686	Portuguese	8084	Tagalog	8476	Zulu	9085

## Area Codes







Choose a area code from this list.

Area	Code	Area	Code	Area	Code	Area	Code	Area	Code	Area	Code
Afghanistan	AF	Costa Rica	CR	Greenland	GL	Maldives	MV	Paraguay	PY	Sri Lanka	LK
Argentina	AR	Croatia	HR	Hong Kong	HK	Mexico	MX	Philippines	PH	Sweden	SE
Australia	AU	Czech Republic	CZ	Hungary	HU	Monaco	MC	Poland	PL	Switzerland	CH
Austria	AT	Denmark	DK	India	IN	Mongolia	MN	Portugal	PT	Taiwan	TW
Belgium	BE	Ecuador	EC	Indonesia	ID	Morocco	MA	Romania	RO	Thailand	TH
Bhutan	BT	Egypt	EG	Israel	IL	Nepal	NP	Russian Federation	RU	Turkey	TR
Bolivia	BO	El Salvador	SV	Italy	IT	Netherlands	NL	Saudi Arabia	SA	Uganda	UG
Brazil	BR	Ethiopia	ET	Jamaica	JM	Netherlands Antilles	AN	Senegal	SN	Ukraine	UA
Cambodia	KH	Fiji	FJ	Japan	JP	New Zealand	NZ	Singapore	SG	United States	US
Canada	CA	Finland	FI	Kenya	KE	Nigeria	NG	Slovak Republic	SK	Uruguay	UY
Chile	CL	France	FR	Kuwait	KW	Norway	NO	Slovenia	SI	Uzbekistan	UZ
China	CN	Germany	DE	Libya	LY	Oman	OM	South Africa	ZA	Vietnam	VN
Colombia	CO	Great Britain	GB	Luxembourg	LU	Pakistan	PK	South Korea	KR	Zimbabwe	ZW
Congo	CG	Greece	GR	Malaysia	MY	Panama	PA	Spain	ES		

## Troubleshooting

PROBLEM	CAUSE	CORRECTION
No power	The power cord is disconnected.	Plug the power cord into the wall outlet securely.
No picture	The TV is not set to receive the DVD signal.	Select the appropriate video input mode on the TV so the picture from the DVD Receiver appears on the TV screen.
	The video cables are not connected securely.	Connect the video cables securely to both the TV and DVD Receiver.
There is little or no sound	Equipment connected via the audio cable is not set to receive DVD signal output.	Select the correct input mode of the audio receiver so you can hear the sound from the DVD receiver.
	The audio cables are not connected to the speakers or receiver securely.	Connect the audio cables into the connection terminals correctly.
	The audio cables are damaged.	Replace with a new audio cable.
The DVD picture quality is poor	The disc is dirty.	Clean the disc using a soft cloth with outward strokes.
A DVD/CD will not play	No disc is inserted.	Insert a disc
	An unplayable disc is inserted.	Insert a playable disc (check the disc type, colour system and regional code).
	The disc is inserted upside down.	Place the disc with the label or printed side facing upwards.
	The menu is open on screen.	Press SETUP to close the menu screen.
	There is a parental lock which prevents the playback of DVDs with a certain rating.	Enter your password or change the rating level.
Humming noise heard while a DVD or CD is playing	The disc is dirty.	Clean the disc using a soft cloth with outward strokes.
	The DVD receiver is located too close to the TV, causing feedback.	Move DVD receiver and audio components further away from your TV.
Radio stations can't be tuned in properly	The antenna is positioned or connected poorly.	Check the antenna connection and adjust its position. Attach an external aerial if necessary.
	The signal strength of the radio station is too weak.	Tune to the station manually.
	No stations have been preset or preset stations have been cleared (when tuning by scanning preset channels).	Preset some radio stations, see page 14 for details.
The remote control doesn't work well / at all	The remote is not pointed directly at the DVD receiver.	Point the remote directly at the unit.
	The remote is too far from the DVD receiver.	Use the remote within 23 feet (7m) of the DVD receiver.
	There is an obstacle in the path between the remote control and the unit.	Remove the obstacle.
	The batteries in the remote control are flat.	Replace the batteries with new ones.
The display window becomes dark and the touch wheel turns off.	The dimmer function is activated.	Switch off dimmer. (Refer to SLEEP on page 5)

## Types of Playable Discs

Type	Logo
<b>DVD-VIDEO:</b> Discs such as movies that can be purchased or rented.	
<b>DVD-R:</b> Video mode and finalized only	
<b>DVD-RW:</b> Video mode and finalized only DVD VR format that have been finalized can not be played in this unit	
<b>DVD+R:</b> Video mode only Supports the double layer disc also	
<b>DVD+RW:</b> Video mode only	
<b>Audio CD:</b>	

This unit plays DVD±R/RW and CD-R/RW that contains audio titles, DivX, MP3, WMA and/or JPEG files. Some DVD±RW/DVD±R or CD-RW/CD-R cannot be played on this unit due to the recording quality or physical condition of the disc, or the characteristics of the recording device and authoring software.

Manufactured under license from Dolby Laboratories. "Dolby" and the double-D symbol are trademarks of Dolby Laboratories.

Manufactured under license under U.S. Patent #'s: 5,451,942; 5,956,674; 5,974,380; 5,978,762; 6,487,535 & other U.S. and worldwide patents issued & pending. DTS is a registered trademark and the DTS logos, Symbol and DTS 2.0 Channel are trademarks of DTS, Inc. © 1996-2007 DTS, Inc. All Rights Reserved.

HDMI, the HDMI logo and High-Definition Multimedia Interface are trademarks or registered trademarks of HDMI licensing LLC.

### About the Symbol Display

"" may appear on your TV display during operation and indicates that the function explained in this owner's manual is not available on that specific DVD video disc.

### Regional Codes

This unit has a regional code printed on the rear of the unit. This unit can play only DVD discs labeled same as the rear of the unit or "ALL".

- Most DVD discs have a globe with one or more numbers in it clearly visible on the cover. This number must match your unit's regional code or the disc cannot play.
- If you try to play a DVD with a different regional code from your player, the message "Check Regional Code" appears on the TV screen.

### Copyrights

It is forbidden by law to copy, broadcast, show, broadcast via cable, play in public, or rent copyrighted material without permission. This product features the copy protection function developed by Macrovision. Copy protection signals are recorded on some discs. When recording and playing the pictures of these discs picture noise will appear. This product incorporates copyright protection technology that is protected by method claims of certain U.S. patents and other intellectual property rights owned by Macrovision Corporation and other rights owners. Use of this copyright protection technology must be authorized by Macrovision Corporation, and is intended for home and other limited viewing uses only unless otherwise authorized by Macrovision Corporation. Reverse engineering or disassembly is prohibited.

CONSUMERS SHOULD NOTE THAT NOT ALL HIGH DEFINITION TELEVISION SETS ARE FULLY COMPATIBLE WITH THIS PRODUCT AND MAY CAUSE ARTIFACTS TO BE DISPLAYED IN THE PICTURE. IN CASE OF 525 OR 625 PROGRESSIVE SCAN PICTURE PROBLEMS, IT IS RECOMMENDED THAT THE USER SWITCH THE CONNECTION TO THE 'STANDARD DEFINITION' OUTPUT. IF THERE ARE QUESTIONS REGARDING OUR TV SET COMPATIBILITY WITH THIS MODEL 525p AND 625p UNIT, PLEASE CONTACT OUR CUSTOMER SERVICE CENTER.

You have to set the disc format option to [Mastered] in order to make the discs compatible with the LG players when formatting rewritable discs. When setting the option to Live File System, you cannot use it on LG players.  
(Mastered/Live File System : Disc format system for Windows Vista)

## Specifications

### General

Power supply	Refer to main label.
Power consumption	Refer to main label.
Net Weight	2.15 kg
External dimensions (W x H x D)	360 x 78 x 216 mm
Operating conditions Temperature	5°C to 35°C, Operation status: Horizontal
Operating humidity	5% to 85%
Laser	Semiconductor laser, wavelength 650 nm

### Tuner FM

FM Tuning Range	87.50 - 108.00 MHz or 65.00 - 74.00 MHz, 87.50 - 108.00 MHz
FM Intermediate Frequency	10.7 MHz

### Amplifier

Stereo mode	75 W + 75 W (4Ω at 1 kHz, THD 10 %) Subwoofer : 150 W (3Ω at 80 Hz, THD 10 %)
-------------	--

### Speakers

	Front Speaker	Active Subwoofer
Type	2 Way 2 Speaker	1Way 1Speaker
Impedance	4 Ω	3 Ω
Rated Input Power	75 W	150 W
Max. Input Power	150 W	300 W
Net Dimensions (W x H x D)	110 x 330 x 130 mm	200 x 401 x 445 mm
Net Weight	1.2 kg	10.9 kg

**Designs and specifications are subject to change without prior notice.**

