



**MCT354 (MCT354-A0U  
MCS354F, MCS354W)**

P/NO :MFL61543916

## Safety Precaution



**CAUTION:** TO REDUCE THE RISK OF ELECTRIC SHOCK DO NOT REMOVE COVER (OR BACK) NO USER-SERVICEABLE PARTS INSIDE REFER SERVICING TO QUALIFIED SERVICE PERSONNEL.



This lightning flash with arrowhead symbol within an equilateral triangle is intended to alert the user to the presence of uninsulated dangerous voltage within the product's enclosure that may be of sufficient magnitude to constitute a risk of electric shock to persons.



The exclamation point within an equilateral triangle is intended to alert the user to the presence of important operating and maintenance (servicing) instructions in the literature accompanying the product.

**WARNING:** TO PREVENT FIRE OR ELECTRIC SHOCK HAZARD, DO NOT EXPOSE THIS PRODUCT TO RAIN OR MOISTURE.

**WARNING:** Do not install this equipment in a confined space such as a book case or similar unit.

**CAUTION:** Do not block any ventilation openings. Install in accordance with the manufacturer's instructions.

Slots and openings in the cabinet are provided for ventilation and to ensure reliable operation of the product and to protect it from over heating. The openings be never be blocked by placing the product on a bed, sofa, rug or other similar surface. This product not be placed in a built-in installation such as a bookcase or rack unless proper ventilation is provided or the manufacturer's instruction has been adhered to.

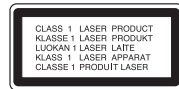

**CAUTION:** This product employs a Laser System. To ensure proper use of this product, please read this owner's manual carefully and retain it for future reference. the unit require maintenance, contact an authorized service center. Use of controls, adjustments or the performance of procedures other than those specified herein may result in hazardous radiation exposure. To prevent direct exposure to laser beam, do not try to open the enclosure. Visible laser radiation when open. DO NOT STARE INTO BEAM.

**CAUTION:** The apparatus not be exposed to water (dripping or splashing) and no objects filled with liquids, such as vases be placed on the apparatus.

### CAUTION concerning the Power Cord

**Most appliances recommend they be placed upon a dedicated circuit**

That is, a single outlet circuit which powers only that appliance and has no additional outlets or branch circuits. Check the specification page of this owner's manual to be certain.

Do not overload wall outlets. Overloaded wall outlets, loose or damaged wall outlets, extension cords, frayed power cords, or damaged or cracked wire insulation are dangerous. Any of these conditions could result in electric shock or fire.

Periodically examine the cord of your appliance, and if its appearance indicates damage or deterioration, unplug it, discontinue use of the appliance, and have the cord replaced with an exact replacement part by an authorized servicer.

Protect the power cord from physical or mechanical abuse, such as being twisted, kinked, pinched, closed in a door, or walked upon. Pay particular attention to plugs, wall outlets, and the point where the cord exits the appliance.

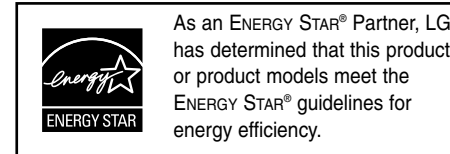

To disconnect power from the mains, pull out the mains cord plug. When installing the product, ensure that the plug is easily accessible.



ENERGY STAR® is a U.S. registered mark.



## **Contents**

	Setting up	4
	Main Unit	5
	Remote control	6
	Listening to CDs	7
	Listening to music from your external device	7
	Listening to the radio	8
	Listening to cassette tapes	8
	Using an USB device	9
	Enjoying a pre-programmed sound field	9
	Synchronized Recording from CD to Tape	10
	Recording to TAPE	10
	Recording to USB	11
	Setting the Clock	12
	Troubleshooting	13
	Specifications	13

The making of unauthorized copies of copy-protected material, including computer programs, files, broadcasts and sound recordings, may be an infringement of copyrights and constitute a criminal offense. This equipment should not be used for such purposes.

**Be responsible**  
**Respect copyrights**

**Before connecting, operating or adjusting this product, please read this instruction booklet carefully and completely.**

## Setting up

### Using the subwoofer

You can use the sound of the subwoofer to enhance the bass.

#### 1 Connection of the front speakers

Connect the speaker cables to the front speaker terminals.

Connect the black end of each wire to the terminals marked - (minus) and the other end to the terminals marked + (plus).

#### 2 Connection of the subwoofer

Connect the subwoofer cables to the subwoofer terminals.

#### 3 Fit the AM loop aerial to its stand

Connect the AM loop aerial to the unit.

#### 4 Connect the FM aerial

The reception will be at its best when the two loose ends of the aerial are in a straight line and horizontal.

#### 5 Plug the power plug into a wall socket

#### Be careful of the following

Be careful to make sure children not to put their hands or any objects into the \*speaker duct.

\*speaker duct : A hole for plentiful bass sound on speaker cabinet(enclosure).

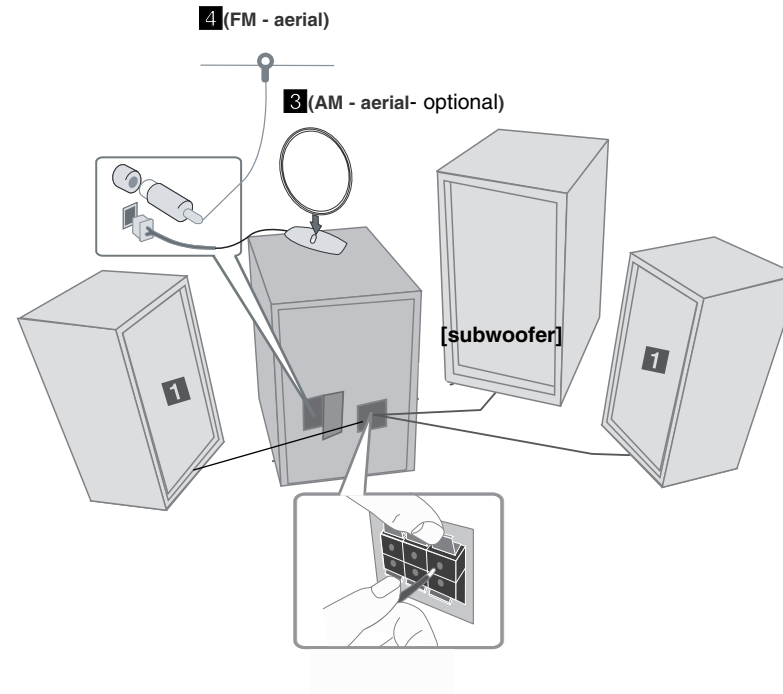

#### NOTES :

- If TV screen becomes discolored do not place speakers within 30cm from TV.
- Be sure to match the speaker cord to the appropriate terminal on the components : + to + and - to -. If the cords are reversed, the sound will be distorted and will lack base.

## Main Unit

- 1** Disc tray
- 2** POWER on/off
- 3** Display window
- 4** **CLOCK**  
For setting the clock and checking the time.
- 5** **TIMER**  
With the **TIMER** function you can turn CD, TAPE, USB play and TUNER reception on or off at a desired time.
- 6** **USER EQ**  
Selects **CD** function.  
Selects **TUNER** function.  
Selects **TAPE** function.  
Selects **AUX** function.
- 8** **SET/CD II**  
- **SET** Confirms the settings.  
(TIMER/CLOCK)  
- **CD II** Pauses  
**PRESET(-)**  
**◀◀◀ TUNING(-)**  
**USB/DEMO**  
- **DEMO** In power off state to demonstrate the function on display window. To cancel it, press or this button again.
- 9** Headphone jack
- 10** USB connector  
Connect a USB compatible device here.
- 11** Cassette Door 1, 2

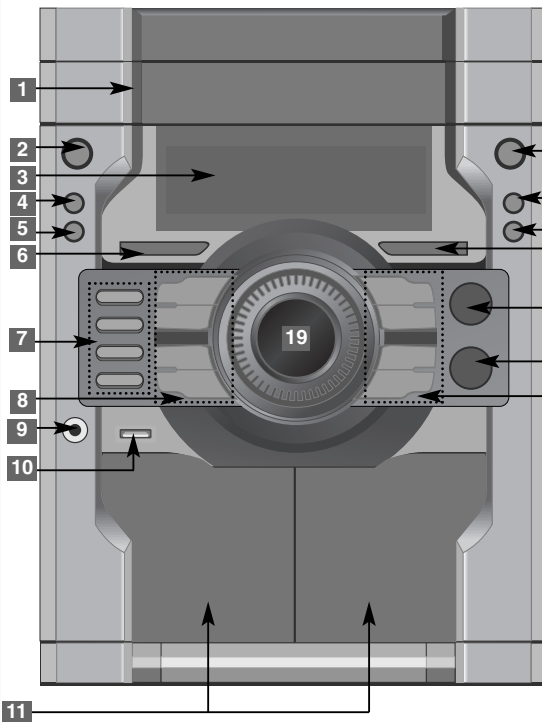

- 12** **OPEN/CLOSE**  
Open or close your CD door.
- 13** **DISC SKIP**  
Choose a desired disc.
- 14** **EQ**  
You can choose fixed sound impression
- 15** **XDSS**  
Extreme Dynamic Sound System  
Reinforce the treble, bass and surround effect.
- MP3 OPT.**  
Optimizes compressible MP3 files so that it improves the bass sound.
- 16** **REC./PAUSE(USB)**
- 17** **LG EQ**  
You can choose fixed sound impression
- 18** **CD SYNC/DUBB.**  
- **CD SYNC** CD to Tape Synchronized.  
- **DUBB.** Recording from tape to tape.  
**▶ PRESET(+)**  
**▶▶▶ TUNING(+)**  
**STOP**
- 19** Volume control

### POWER SAVE MODE

Press on the player or on the remote control for longer than 3 seconds as the device is powered on, you can move into POWER SAVE MODE. Press again to cancel.

## Remote control

	<b>Power on/ off Power SAVE MODE</b>
<b>SLEEP</b>	<b>Fall asleep while listening to your unit .</b> Press <b>SLEEP</b> one or more times to select delay time between 10 and 180 minutes.
<b>INFO</b>	<b>See information about your music.</b> MP3/ WMA files often come with tags. The tag gives the Title, Artist, Album or Time information.

	<b>Searches for a folder of MP3/ WMA files</b> When a CD containing MP3/ WMA files in several folders is being played, press <b>FOLDER•PRESET</b> selects the folder you want to play. <b>Choose a 'preset number' for a radio station.</b>
<b>± VOL</b>	Controls the volume when using any function.
<b>D.SKIP</b>	<b>Choose a desired CD</b>
	<b>Temporarily stop the sound.</b> Press the button again to return to the sound.

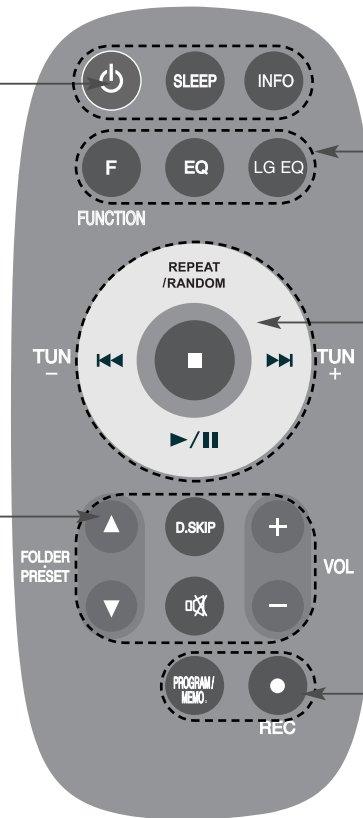

<b>F (FUNCTION)</b>	<b>Changes the functions.</b>
<b>EQ</b>	<b>sound quality adjustment.</b> You can choose sound impressions.
<b>LG EQ</b>	You can select a Natural or Local Specialization equalizer effect by using LG EQ.

<b>REPEAT/ RANDOM</b>	<b>CD: Listen to your tracks repeatedly or randomly.</b>
	<b>Selects the radio station.</b> <b>Searches for a section within a track.</b> <b>Skips Fast backward or Forward.</b>
	Starts or pauses playback
	Stops playback or recording

<b>PROGRAM/ MEMO.</b>	<b>For storing radio stations</b> If you have saved radio stations using <b>PROGRAM/MEMO.</b> , you can scroll through them and select one. <b>Listens to your tracks in any order</b>
	<b>Recording button.</b>



### Put the battery into the remote control

Make sure for the + (plus) and - (minus) on the battery to be matched on the remote control. (size AAA)

## Listening to CDs

Audio CD and MP3/ WMA CD can be played back in this unit.

	ON UNIT	ON REMOTE
1. Open the CD door	▲ OPEN/ CLOSE	-
2. Select the CD tray	DISC SKIP	D.SKIP
3. Insert the CD: Label facing up.	-	-
4. Close the CD door	▲ OPEN/ CLOSE	-
5. Select the CD function The display will show the total number of tracks (files).	CD	FUNCTION
6. Start the CD playing	▶	▶/
7. To stop a CD playing	STOP	■

## Listening to CDs - More you can do

### Pausing or restarting a CD

- 1 Press **SET/CD II** on the unit or **▶/||** on the remote control during playback.
- 2 Press this button again to resume play.

### Searching for a section within a track

Hold **◀◀◀◀ / ▶▶▶▶** on the unit or **◀◀/▶▶** on the remote control during playback and release it at the point you want to listen to.

### Skipping to another track (files)

Press **◀◀◀◀ / ▶▶▶▶** on the unit or **◀◀/▶▶** on the remote control in stop status.

### Listening to your tracks (files) repeatedly or randomly

- 1 Press **REPEAT/RANDOM** repeatedly. The current (tracks) file will be played back repeatedly or randomly.
- 2 To return to normal playback, press **REPEAT/RANDOM** repeatedly to select [Off].

### Program list

You can play up to 20 tracks on a CD in order.

- 1 Insert a CD and wait for it to be read.
- 2 Press **PROGRAM/MEMO.** on the remote control in stop status.
- 3 Press **◀◀◀◀ / ▶▶▶▶** on the unit or **◀◀/▶▶** on the remote control to select a track.

- 4 Press **PROGRAM/MEMO.** again to save and select a next track.
- 5 Press **▶** on the unit or **▶/||** on the remote control to play the programmed music files.
- 6 To clear your selection, press **STOP** (or **■**), **PROGRAM/MEMO.** and then **STOP** (or **■**).

## About MP3/ WMA

**MP3/WMA Disc compatibility with this unit is limited as follows:**

- Sampling Frequency : 32 - 48 (MP3/ WMA)
- Bit rate : 32 - 320 kbps (MP3), 40 - 320 kbps (WMA)
- CD-R physical format should be "ISO 9660/JOLIET"
- If you record MP3/WMA files using the software which cannot create a FILE SYSTEM, for example "Direct-CD" etc., it is impossible to playback MP3 files. We recommend that you use "Easy-CD Creator", which creates an ISO 9660 file system.
- Do not use special letters such as "/ : \* ? " < >" etc.
- Even if the total number of files on the disc has more than 1000, it will only be shown up to 999.

## Listening to music from your external device

The unit can be used to play the music from many types of external device.

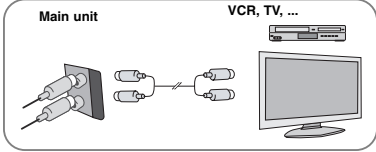
	ON UNIT	ON REMOTE
<b>1. Connect</b> the external device to the <b>AUX IN</b> connector of the unit. > If your TV has only one output for audio(MONO), connect it to the left(white) audio jack on the unit. <div style="text-align: center;">  </div>	-	-
<b>2. Turn the power on.</b>	⏻/	⏻
<b>3. Select the AUX function.</b>	AUX	FUNCTION
<b>4. Turn on the external device and start it playing.</b>	-	-

### Listening to the radio

Make sure both the FM and AM aerials are connected.

	ON UNIT	ON REMOTE
1. Select either FM or AM	TUNER	FUNCTION
2. Select the radio station	TUNING (+) / (-)	TUN- / TUN+
3. To 'save' a radio station: A preset number will show in the display.	-	PROGRAM/MEMO.
4. Select the preset number	PRESET(-) / (+)	FOLDER • PRESET
5. To confirm press: Up to 50 radio stations can be saved.	-	PROGRAM/MEMO.
6. To select a 'saved' station	PRESET(-) / (+)	FOLDER • PRESET

### Listening to the radio - More you can do

#### Looking for radio stations automatically

- 1 Press and hold **TUNING + / TUNING -** on the unit or **TUN- / TUN+** on the remote control for more than 0.5 second.
- 2 The tuner will scan automatically and stop when it finds a radio station.

#### Deleting all the saved stations

- 1 Press and hold **PROGRAM/MEMO.** on the remote control for two seconds. "ERASE ALL" shows.
- 2 Press **PROGRAM/MEMO.** on the remote control to erase all the saved stations.

#### Improving poor FM reception

Press **▶/||** (MONO/ST) on the remote control. This will change the tuner from stereo to mono and usually improve the reception.

### Listening to cassette tapes

Cassette tapes can be played back in this unit.

	ON UNIT	ON REMOTE
1. Open the tape door	▲ PUSH EJECT	-
2. Insert the tape	-	-
3. Close the tape door	▲ PUSH EJECT	-
4. Select the TAPE function	TAPE	FUNCTION
5. Start the tape playing	▶	▶/
6. To stop a tape playing	STOP	■

### Listening to cassette tapes - More you can do

#### Playing Fast backward or Forward

Press **◀◀◀ / ▶▶▶▶** (**◀◀ / ▶▶** on the remote control ) on the unit during playback, or stop, press **▶** at a point you want.

#### Dubbing

This function shows how to record from tape to tape

- 1 Press **TAPE** to select tape function.
- 2 Insert the tape as follows.
  - TAPE1 - Insert a playback tape to dub.
  - TAPE2 - Insert a blank tape.
- 3 Press **DUBB.** "DUBBING" shows. Dubbing starts.
- 4 To stop dubbing, press **STOP**.

**NOTE:** In case you use the tape for the first time push the **▲ PUSH EJECT** to open the tape door and then remove the cushion in it.



### Using an USB device

You can enjoy media files saved on an USB device by connecting the USB device to the USB port of the unit.  
If you want to operate other function, see the CD playback section.

	ON UNIT	ON REMOTE
<b>1. Connect the USB device to the USB port of the unit.</b>	-	-
<b>2. Select the USB function.</b>	USB	FUNCTION
<b>3. Select a file you want to play.</b>	◀◀◀◀ / ▶▶▶▶	◀◀ / ▶▶
<b>4. Start your media playing.</b>	▶	▶/
<b>5. To stop, press</b>	STOP	■
<b>6. Before disconnecting the USB device, change to any other function.</b>	(CD,TUNER, ...)	FUNCTION

#### Compatible USB Devices

- MP3 Player : Flash type MP3 player.
- USB Flash Drive : Devices that support USB 2.0 or USB 1.1.
- The USB function may not be available depending on devices.

#### USB device requirement

- Devices which require additional program installation when you have connected it to a computer, are not supported.

#### Look out for the follows

- **Do not extract the USB device while in operation.**
- For a large capacity USB, it may take longer than a few minute to be searched.
- To prevent data loss, back up all data.
- If you use a USB extension cable or USB hub, the USB device is not recognized.
- Using NTFS file system is not supported. (Only FAT(16/ 32) file system is supported.
- This unit is not supported when the total number of files is 1 000 or more.
- External HDD, Locked devices or hard type USB devices are not supported.
- USB port of the unit can not be connected to PC. This unit can not be used as a storage device.

### Enjoying a pre-programmed sound field

This system has a number of pre-set surround sound fields. You can select a desired sound mode by using **EQ/ LG EQ**.  
The displayed items for the Equalizer may be different depending on sound sources and effects.

ON DISPLAY	Description
<b>NATURAL</b>	You can enjoy comfortable and natural sound.
<b>Local Specialization equalizer</b>	Regionally optimized sound effect.(DANGDUT/ ARABIC/ PERSIAN/ INDIA/ REGUETON/ MERENGUE/ SALSA/ SAMBA)
<b>AUTO EQ</b>	Realizes the sound equalizer that is the most similar to the genre of which is included in the MP3 ID3 tag of song files.
<b>POP CLASSIC JAZZ ROCK</b>	This program lends an enthusiastic atmosphere to the sound, giving you the feeling you are at an actual rock , pop, jazz or classic concert.
<b>MP3 OPT</b>	This function is optimized for compressible MP3 file. It improves the bass sound.
<b>XDSS ON</b>	Reinforce the treble, bass and surround sound effect.
<b>VIRTUAL</b>	You can enjoy mroe virtual surround sound.
<b>NORMAL(OFF)</b>	You can enjoy the sound without equalizer effect.

### Setting the sound mode

#### USER EQ

1. Press **USER EQ**
2. "**USER EQ**" is displayed.
3. Press **SET**.
4. Select the sound effect you want among BASS(100HZ), MIDDLE(1kHz),TREBLE(10kHz) by pressing **PRESET(-)/PRESET(+)**.
5. Adjust sound level by pressing **◀◀◀◀ / ▶▶▶▶** .
6. To finish the setting, press **SET**.

### Synchronized Recording from CD to Tape

	ON UNIT	ON REMOTE
<b>1. Open the tape deck and then insert a blank tape.</b> There are 2 tape decks on the unit, open the second one.	▲ PUSH EJECT	-
<b>2. Close the door and insert a CD.</b>	▲ OPEN/ CLOSE	-
<b>3. To select CD function, press</b>	CD	FUNCTION
<b>4. Press the button on a stop status to move to CD synchronizing mode.</b> - Recording automatically starts 7 seconds later after "REC" blinks.	CD SYNC	-
<b>5. To stop, press</b>	STOP	■

### Recording to TAPE

You can record a various sound source to TAPE.

	ON UNIT	ON REMOTE
<b>1. Open the tape deck.</b> There are 2 tape decks on the unit, open the second one.	▲ PUSH EJECT	-
<b>2. Insert a blank tape and close the door.</b>	-	-
<b>3. Select a mode in which you want to record.</b>	(CD,TUNER, ...)	FUNCTION
<b>4. Play back a sound source first.</b>	▶	▶/II
<b>5. Press</b> The display changed in the following order, "USB REC" <-> "TAPE REC"	REC./ PAUSE (USB)	● REC
<b>6. Press the button once more when "TAPE REC" is displayed.</b> Recording starts.	REC./ PAUSE (USB)	● REC
<b>7. To stop recording, press</b>	STOP	■

## Recording to USB

You can record a various sound source to USB.

	ON UNIT	ON REMOTE
<b>1. Connect the USB device to the unit.</b>	-	-
<b>2. Select a mode in which you want to record.</b> Play back a sound source first.	(CD,TUNER, ...)	FUNCTION
<b>3. Press</b> The display changed in the following order. "USB REC" <-> "TAPE REC"	REC./ PAUSE (USB)	● REC
<b>4. Press the button once more when "USB REC" is displayed.</b> Recording starts.	REC./ PAUSE (USB)	● REC
<b>5. To stop recording, press</b>	STOP	■

## Recording to USB - More you can do

### Recording Music file in disc source to USB

#### One track recording -

If the USB recording is started during playback of the CD, the one track/ file would be recording into the USB.

#### All tracks recording -

If the recording button is pressed at the CD stop, all tracks/ files would be recording.

#### Program list recording -

USB records after creating your own program if you want to record the track you want. Up to 20 songs can be recorded.(Audio CD only)

### To select recording bit rate and speed

- 1 Press **REC./ PAUSE (USB)** on the player or ● **REC** on the remote control for longer than 3 seconds.
- 2 Use **◀◀◀◀ / ▶▶▶▶** on the player or **◀◀ / ▶▶** on the remote control to select the bit rate.
- 3 Press **REC./ PAUSE (USB)** or ● **REC** again to select the recording speed.
- 4 Use **◀◀◀◀ / ▶▶▶▶** or **◀◀ / ▶▶** to select a desired recording speed.  
**X 1 SPEED** (96kbps, 128kbps, 192kbps, 256kbps)  
 - You can listen to music while recording it. (Audio CD Only)  
**X 2 SPEED** (96kbps, 128kbps)  
 - You can just recording the music file. (Audio CD Only)
- 5 Press **REC./ PAUSE (USB)** or ● **REC** to finish the setting.

### Pausing recording

During recording, press **REC./PAUSE(USB)** or ● **REC** to pause recording. Press **REC./PAUSE(USB)** or ● **REC** to continue recording. (Only Radio/ AUX)

### When you are recording, look out for the following

- You can check the recording percentage rate for the USB record on the screen during the recording. (MP3/ WMA CD only)
- During recording MP3/ WMA, there is no sound.
- When you stop recording during playback, the file that has been recorded at that time will be stored.(Audio CD only)
- Do not remove the USB device or turn off the unit during USB recording. If not, an incomplete file may be made and not deleted on PC.
- If USB recording does not work, the message like "NO USB", "ERROR", "USB FULL" or "NO REC" is displayed on the display window.
- A file is recorded by 128Mbyte when you record for a long term.
- When you stop recording during playback, the file will not be stored.
- You may not record more than 999 files.
- **It'll be stored as follows.**

AUDIO CD	MP3/ WMA	The other sources
■ CD_REC   - TRK 001   - TRK 002   :   :	■ FILE_REC   - (File name)   - (File name)   :   :	■ EXT_REC   - AUDIO_001   - AUDIO_002   :   :

## Setting the Clock

	ON UNIT
<b>1. Press for at least 2 seconds</b>	<b>CLOCK</b>
<b>2. Choose from either AM 12:00</b> (for an am and pm display) or 0:00 (for a 24 hour display).	◀◀◀◀ / ▶▶▶▶
<b>3. Confirm your selection</b>	<b>SET</b>
<b>4. Select the hours</b>	◀◀◀◀ / ▶▶▶▶
<b>5. Press</b>	<b>SET</b>
<b>6. Select the minutes</b>	◀◀◀◀ / ▶▶▶▶
<b>7. Press</b> The setting is finished.	<b>SET</b>

### Using your player as an alarm clock

- Press and hold **TIMER**. Each function, EX) TUNER, CD.... flashes.
- Press **SET** when the function you want to be woken by is showing. If you choose TUNER, "PLAY" and Then "REC" flashes in the display window alternately.
- Choose one of them by pressing **SET**.
- "ON TIME" will be displayed. Then you can set the time you want the alarm to go on. Press ◀◀◀◀ / ▶▶▶▶ to change the hours and minutes and **SET** to save.
- "OFF TIME" will be displayed. Then, you can set the time you want the function to stop. Press ◀◀◀◀ / ▶▶▶▶ to change the hours and minutes and press **SET** to save.
- You will be shown the volume (VOL) you want to be woken by. Use ◀◀◀◀ / ▶▶▶▶ to change the volume and **SET** to save. Switch the system off. The clock icon "⌚" shows that the alarm is set.
- When the system is turned off, you can check the time the alarm is set for by pressing **TIMER**. You can also turn the alarm on and off by pressing **TIMER**.

### Setting the asleep time

- Press **SLEEP** repeatedly to select delay time between 10 and 180 minutes, after the unit will be turned off.
- To check the remaining time, press **SLEEP**.

### DEMO

- Press **USB/DEMO** in power off state to demonstrate the function on display window.
- To cancel it, press **⏻** or this button again.

### DIMMER

Press **SLEEP** once. The LED (Light-emitting diode) of front panel is turned off and the display window will be darkened by half. To cancel it, press **SLEEP** repeatedly until dim off.

Troubleshooting		
Symptom	Cause	Correction
<b>General</b>		
No power.	The power cord is not plugged in.	Plug in the power cord.
	Check whether electricity failed.	Check the condition by operating other electronic devices.
No sound.	Check whether you select right function.	Press <b>FUNCTION</b> and check the selected function.
<b>CD</b>		
The unit does not start playback.	An unplayable disc is inserted.	Insert a playable disc.
	The disc is dirty.	Clean the disc.
<b>RADIO</b>		
Radio stations cannot be tuned in.	The antenna is positioned or connected poorly.	Connect the antenna securely.
<b>TAPE</b>		
Unable to record.	Record protect tabs are removed.	Cover holes on back edge of tape with tap.
<b>Remote control</b>		
The remote control does not work properly.	The remote control is too far from the unit.	Operate the remote control within about 23 ft (7 m).
	There is an obstacle in the path of the remote control and the unit.	Remove the obstacle.
	The battery in the remote control is exhausted.	Replace the battery with new one.

Designs and specifications are subject to change without notice.

## Specifications

<b>General</b>	
Power supply	Refer to main label.
Power consumption	Refer to main label.
Net Weight	5.7 kg
External dimensions (WxHxD)	272 x 334 x 344 mm
Operating temperature	5 °C to 35 °C
Operating humidity	5% to 85 %
<b>Tuner</b>	
FM Tuning Range	87,5 - 108,0 MHz or 87,50 - 108,00 MHz
AM Tuning Range (optional)	522 - 1620 kHz or 522 - 1710 kHz or 520 - 1710 kHz
<b>Amplifier</b>	
Output Power	Front : 100 W x 2 W, Sub Woofer : 150 W
T.H.D	10 %
Frequency Response	42 - 20000 Hz
Signal-to-noise ratio	75 dB
<b>CD</b>	
Frequency response	40 - 20000 Hz
Signal-to-noise ratio	75 dB
Dynamic range	80 dB
<b>Cassette</b>	
F.F/REW Time	120 sec (C-60)
Frequency Response	250 - 8000 Hz
Signal to Noise Ratio	43 dB
Channel Separation	45 dB (P/B)/ 45 dB (R/P)
Erase Ratio	50 dB (MTT-5511)
<b>Speakers (MCS354F)</b>	
Type	2 Way 2 Speaker
Impedance	4 Ω
Input Power	100 W
Max. Input Power	200 W
Net Dimensions (WxHxD)	220 x 333 x 283 mm
Net Weight (1EA)	3.3 kg
<b>Speakers (MCS354W)</b>	
Type	1 Way 1 Speaker
Impedance	3 Ω
Input Power	150 W
Max. Input Power	300 W
Net Dimensions (WxHxD)	274 x 333 x 342 mm
Net Weight (1EA)	5.9 kg

