

User's Guide

W1971SC
W2271SC
W2271TC

Make sure to read the **Important Precautions** before using the product.

Keep the User's Guide(CD) in an accessible place for future reference.

See the label attached on the product and give the information to your dealer when you ask for service.

This unit has been engineered and manufactured to ensure your personal safety, however improper use may result in potential electrical shock or fire hazards. In order to allow the proper operation of all safeguards incorporated in this display, observe the following basic rules for its installation, use, and servicing.

On Safety

Use only the power cord supplied with the unit. In case you use another power cord, make sure that it is certified by the applicable national standards if not being provided by the supplier. If the power cable is faulty in any way, please contact the manufacturer or the nearest authorized repair service provider for a replacement.

The power supply cord is used as the main disconnection device. Ensure that the socket-outlet is easily accessible after installation.

Operate the display only from a power source indicated in the specifications of this manual or listed on the display. If you are not sure what type of power supply you have in your home, consult with your dealer.

Overloaded AC outlets and extension cords are dangerous. So are frayed power cords and broken plugs. They may result in a shock or fire hazard. Call your service technician for replacement.

Do not Open the Display:

- There are no user serviceable components inside.
- There are Dangerous High Voltages inside, even when the power is OFF.
- Contact your dealer if the display is not operating properly.

To Avoid Personal Injury :

- Do not place the display on a sloping shelf unless properly secured.
- Use only a stand recommended by the manufacturer.
- Do not drop an object on or apply impact to the product. Do not throw any toys or objects on the product screen.

It can cause injury to human, problem to product and damage the display.

To Prevent Fire or Hazards:

- Always turn the display OFF if you leave the room for more than a short period of time. Never leave the display ON when leaving the house.
- Keep children from dropping or pushing objects into the display's cabinet openings. Some internal parts carry hazardous voltages.
- Do not add accessories that have not been designed for this display.
- When the display is to be left unattended for an extended period of time, unplug it from the wall outlet.
- In the presence of thunder and lightning, never touch the power cord and signal cable because it can be very dangerous. It can cause electric shock.

On Installation

Do not allow anything to rest upon or roll over the power cord, and do not place the display where the power cord is subject to damage.

Important Precautions

Do not use this display near water such as near a bathtub, washbowl, kitchen sink, laundry tub, in a wet basement, or near a swimming pool.

Displays are provided with ventilation openings in the cabinet to allow the release of heat generated during operation. If these openings are blocked, built-up heat can cause failures which may result in a fire hazard. Therefore, NEVER:

- Block the bottom ventilation slots by placing the display on a bed, sofa, rug, etc.
- Place the display in a built-in enclosure unless proper ventilation is provided.
- Cover the openings with cloth or other material.
- Place the display near or over a radiator or heat source.

Do not rub or strike the Active Matrix LCD with anything hard as this may scratch, mar, or damage the Active Matrix LCD permanently.

Do not press the LCD screen with your finger for a long time as this may cause some afterimages.

Some dot defects may appear as Red, Green or Blue spots on the screen. However, this will have no impact or effect on the display performance.

If possible, use the recommended resolution to obtain the best image quality for your LCD display. If used under any mode except the recommended resolution, some scaled or processed images may appear on the screen. However, this is characteristic of the fixed-resolution LCD panel.

Leaving a fixed image on the screen for a long time may cause damage to the screen and cause image burn-in. Make sure to use a screen saver on the product. Burn-in and related problems are not covered by the warranty on this product.

Do not shock or scratch the front and sides of the screen with metallic objects. Otherwise, it may cause damage to the screen.

On Cleaning

- Unplug the display before cleaning the face of the display screen.
- Use a slightly damp (not wet) cloth. Do not use an aerosol directly on the display screen because over-spraying may cause electrical shock.

On Repacking

- Do not throw away the carton and packing materials. They make an ideal container in which to transport the unit. When shipping the unit to another location, repack it in its original material.

On Disposal

- The fluorescent lamp used in this product contains a small amount of mercury.
- Do not dispose of this product with general household waste.
- Disposal of this product must be carried out in accordance to the regulations of your local authority.

Connecting the Display

- Before setting up the monitor, ensure that the power to the monitor, the computer system, and other attached devices is turned off.

Connecting the stand

1. Place the monitor face down on the cushion or soft cloth.
2. Assemble the Stand Body into the product in the correct direction as shown in the picture.

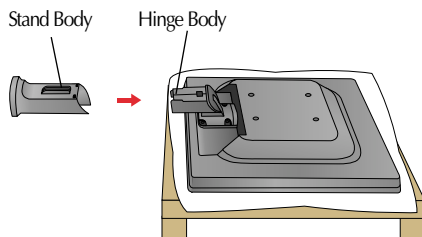

3. Check the direction of the Stand Base and assemble it into the Stand Body.

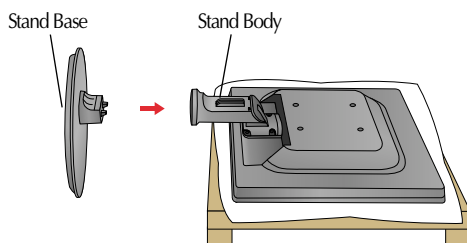

4. Insert the Cable Deco Cover in the Stand Body in the correct direction.

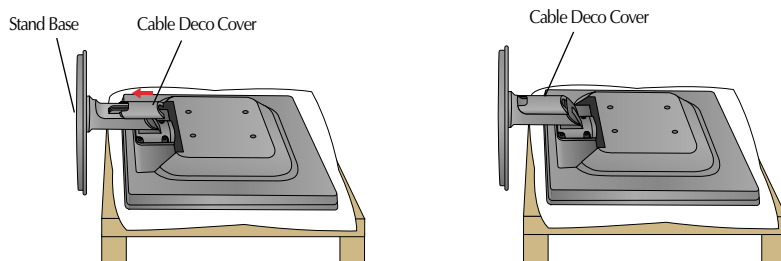

5. Once assembled take the monitor up carefully and face the front side.

IMPORTANT

- This illustration depicts the general model of connection. Your monitor may differ from the items shown in the picture.
- Do not carry the product upside down holding only the stand base. The product may fall and get damaged or injure your foot.

Disassembling the stand

1. Place the monitor face down on the cushion or soft cloth.



2. Slide the Cable Deco Cover out from the stand body.



3. Press the hook, take off the stand base from stand body.



4. Please pull the stand body lightly to separate it from the hinge body.



Connecting the Display

- Before setting up the monitor, ensure that the power to the monitor, the computer system, and other attached devices is turned off.

Positioning your display

1. Adjust the position of the panel in various ways for maximum comfort.
 - Tilt Range : -5° ~ 22°

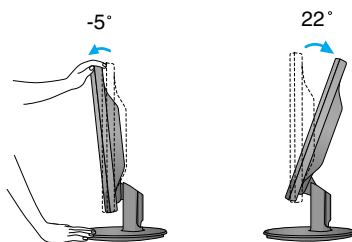

ERGONOMIC

- It is recommended that in order to maintain an ergonomic and comfortable viewing position, the forward tilt angle of the monitor should not exceed 5 degrees.

Using the Computer

1. Make sure to turn off the computer and product.
Connect signal input cable ① and power cord ② in order, then tighten the screw of the signal cable.

- A Connect DVI(Digital signal) Cable
- B Connect D-sub(Analog signal) Cable (PC)
- C Connect D-sub(Analog signal) Cable (Mac)

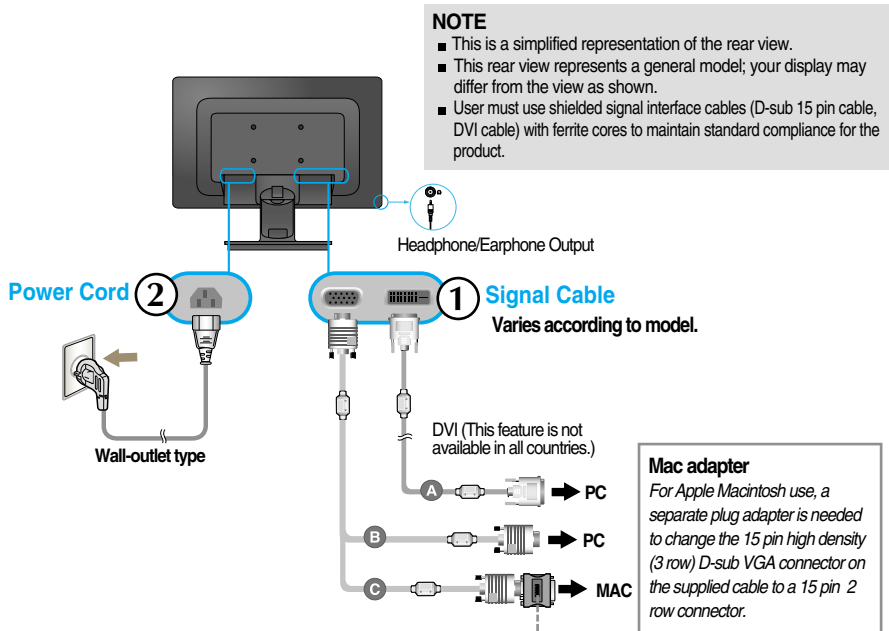

2. Insert the Cable Deco Cover in the Stand Body in the correct direction.



3. Press the power button on the front panel to turn the power on. When monitor power is turned on, the **'Self Image Setting Function'** is executed automatically.
(Only Analog Mode)

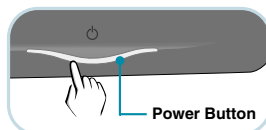

NOTE

'Self Image Setting Function'? This function provides the user with optimal display settings. When the user connects the monitor for the first time, this function automatically adjusts the display to optimal settings for individual input signals.

'AUTO/SET' Function? When you encounter problems such as blurry screen, blurred letters, screen flicker or tilted screen while using the device or after changing screen resolution, press the AUTO/SET function button to improve resolution.

Using the Computer

1. Make sure to turn off the computer and product.
Connect signal input cable ① and power cord ② in order, then tighten the screw of the signal cable.

- A Connect D-sub(Analog signal) Cable (PC)
- B Connect D-sub(Analog signal) Cable (MAC)

NOTE

- This is a simplified representation of the rear view.
- This rear view represents a general model; your display may differ from the view as shown.
- User must use shielded signal interface cables (D-sub 15 pin cable, DVI cable) with ferrite cores to maintain standard compliance for the product.

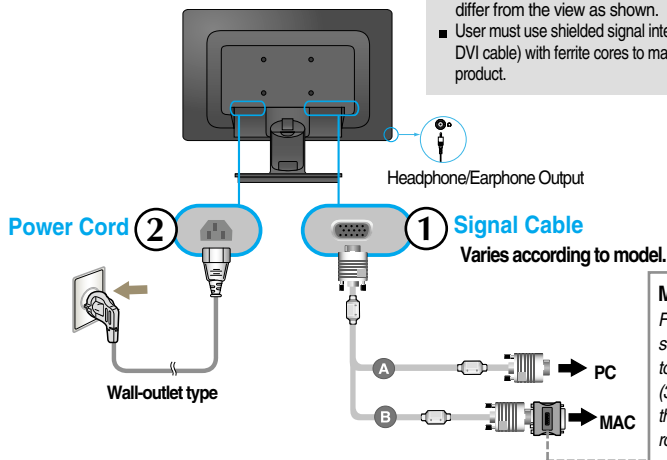

Mac adapter

For Apple Macintosh use, a separate plug adapter is needed to change the 15 pin high density (3 row) D-sub VGA connector on the supplied cable to a 15 pin 2 row connector.

2. Insert the Cable Deco Cover in the Stand Body in the correct direction.



3. Press the power button on the front panel to turn the power on. When monitor power is turned on, the 'Self Image Setting Function' is executed automatically.

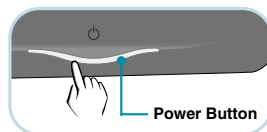

NOTE

'Self Image Setting Function'? This function provides the user with optimal display settings. When the user connects the monitor for the first time, this function automatically adjusts the display to optimal settings for individual input signals.

'AUTO/SET' Function? When you encounter problems such as blurry screen, blurred letters, screen flicker or tilted screen while using the device or after changing screen resolution, press the AUTO/SET function button to improve resolution.

Connecting the USB(Universal Serial Bus) Cable

1. You can use the monitor's webcam function by connecting the monitor and the PC with USB cable.

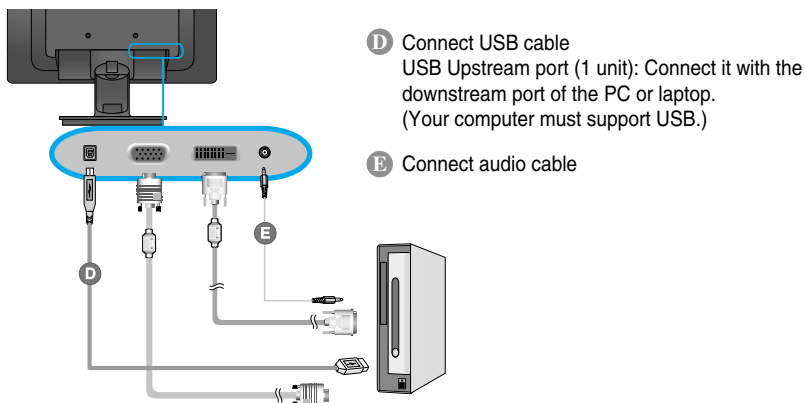

NOTE

- For more information on USB, visit the following web site.(<http://www.usb.org>)
- With the USB cable unconnected, you will not have any trouble using the PC.

Using the Webcam function

To use the webcam function, your PC should meet the following minimum system requirements.

■ Minimum system requirements

- Intel Pentium 4 1.6 GHz or AMD® equivalent processor (Intel® Pentium® D processor running at 3.0 GHz or better recommended)
 - Microsoft®Windows®XP Service Pack 2 (32/64-bit), Vista (32/64-bit)
 - 256MB RAM or higher (512MB RAM recommended)
 - 500MB HDD
 - CD-ROM
 - USB 2.0 interface
 - Window Vista Premium / XP SP2 with UVC patch
- Please update **UVC patch** from <http://www.microsoft.com> before use.

1. To use the webcam function, connect the USB cable and install the programs on the webcam software CD.
2. The webcam software CD contains two programs. Install the LG Webcam Viewer program first, and then the LG Webcam Driver files.
3. For more information about the programs, refer to the user guide in the webcam software CD.



Front Panel Controls

W2271TC

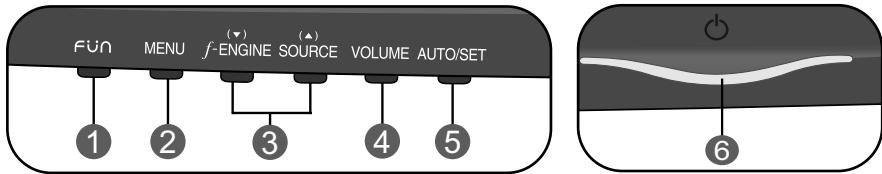

W2271SC

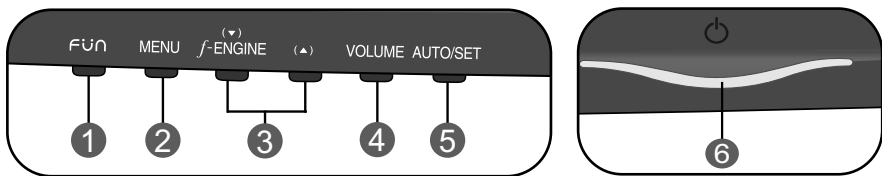

1 FÜN Button

Use this button to enter **EZ ZOOMING**, **4:3 IN WIDE**, **PHOTO EFFECT** items.
For more information, refer to page 17.

2 MENU Button

Use this button to enter or exit from the On Screen Display.

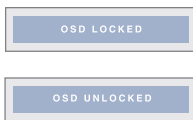

OSD LOCKED/UNLOCKED

This function allows you to lock the current control settings, so that these settings are not inadvertently changed. To lock the OSD settings, press and hold the **MENU button** for several seconds. The message "**OSD LOCKED**" appears.

You can unlock the OSD settings at any time by pushing the **MENU button** for several seconds. The message "**OSD UNLOCKED**" appears.

3

▲ ▼ Buttons

Use these buttons to select or adjust functions in the On Screen Display.

f-ENGINE ▼

For more information, refer to page 21.

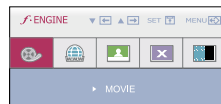

SOURCE ▲
(SOURCE Hot key)

Use this button to make either D-Sub or DVI connector active. This feature is used when two computers are connected to the display. The default setting is D-Sub. **(Only W2271TC)**

4

VOLUME Button

Use this button to mute or adjust the sound volume.

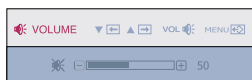

<MUTE ON>

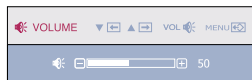

<MUTE OFF>

Use the ▲ ▼ buttons to adjust the speaker volume.

5

AUTO/SET Button

Use this button to enter a selection in the On Screen Display.



AUTO IMAGE ADJUSTMENT

When adjusting your display settings, always press the **AUTO/SET** button before entering the On Screen Display(OSD). This will automatically adjust your display image to the ideal settings for the current screen resolution size (display mode).

The best display mode is

1680 x 1050

6

Power Button/ Power Indicator

Use this button to turn the display on or off.

This Indicator lights up blue when the display operates normally(On Mode). If the display is in Sleep Mode (Energy Saving), this indicator color changes to amber.

Front Panel Controls

W1971SC

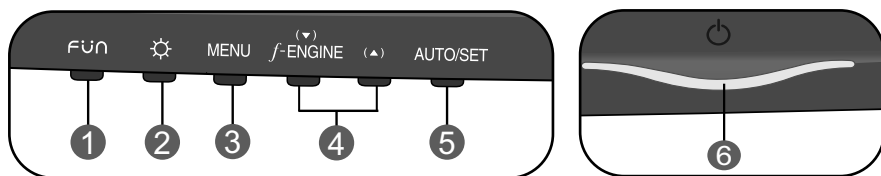

1 FUN Button

Use this button to enter **EZ ZOOMING**, **4:3 IN WIDE**, **PHOTO EFFECT** items.

For more information, refer to page 17.

2 Button

Use this button to enter On Screen Display Sub-menu to adjust **BRIGHTNESS** directly.

3 MENU Button

Use this button to enter or exit from the On Screen Display.



OSD LOCKED/UNLOCKED

This function allows you to lock the current control settings, so that these settings are not inadvertently changed. To lock the OSD settings, press and hold the **MENU button** for several seconds. The message "**OSD LOCKED**" appears.

You can unlock the OSD settings at any time by pushing the **MENU button** for several seconds. The message "**OSD UNLOCKED**" appears.

4 ▼ ▲ Buttons

Use these buttons to select or adjust functions in the On Screen Display.

f•ENGINE ▼

For more information, refer to page 21.

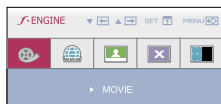

5 AUTO/SET Button

Use this button to enter a selection in the On Screen Display.



AUTO IMAGE ADJUSTMENT

When adjusting your display settings, always press the **AUTO/SET** button before entering the On Screen Display(OSD). This will automatically adjust your display image to the ideal settings for the current screen resolution size (display mode).

The best display mode is

1440 x 900

6 Power Button/ Power Indicator

Use this button to turn the display on or off.

This Indicator lights up blue when the display operates normally(On Mode). If the display is in Sleep Mode (Energy Saving), this indicator color changes to amber.

Screen Adjustment

Making adjustments to the image size, position and operating parameters of the display is quick and easy with the On Screen Display Control system. A short example is given below to familiarize you with the use of the controls. The following section is an outline of the available adjustments and selections you can make using the OSD.

NOTE

- Allow the display to stabilize for at least 30 minutes before making image adjustments.

To make adjustments in the On Screen Display, follow these steps:

MENU → ▼ ▲ → AUTO/SET → ▼ ▲ → MENU

- 1** Press the MENU Button, then the main menu of the OSD appears.
- 2** To access a control, use the ▼ or ▲ Buttons. When the icon you want becomes highlighted, press the AUTO/SET Button.
- 3** Use the ▼ / ▲ Buttons to adjust the image to the desired level. Use the AUTO/SET Button to select other sub-menu items.
- 4** Press the MENU Button once to return to the main menu to select another function. Press the MENU Button twice to exit from the OSD.

The following table indicates all the On Screen Display control, adjustment, and setting menus.

Main menu	Sub-menu		A	D	Reference
EZ ZOOMING			●	●	To adjust the resolution
4:3 IN WIDE			●	●	To adjust the image size
PHOTO EFFECT	NORMAL		●	●	To adjust the screen color mode
	GAUSSIAN BLUR		●	●	
	SEPIA		●	●	
	MONOCHROME		●	●	
PICTURE	BRIGHTNESS		●	●	To adjust the brightness, contrast and gamma of the screen
	CONTRAST		●	●	
	GAMMA		●	●	
COLOR	PRESET	sRGB	●	●	To customize the color of the screen
		6500K	●	●	
		9300K	●	●	
	RED		●	●	
	GREEN		●	●	
	BLUE		●	●	
TRACKING	HORIZONTAL		●		To adjust the position of the screen
	VERTICAL		●		
	CLOCK		●		To improve the clarity and stability of the screen
	PHASE		●		
	SHARPNESS		●	●	
SETUP	LANGUAGE		●	●	To customize the screen status for a user's operating environment
	OSD POSITION	HORIZONTAL	●	●	
		VERTICAL	●	●	
	WHITE BALANCE		●		
	POWER INDICATOR		●	●	
	FACTORY RESET		●	●	
FLATRON F-ENGINE	MOVIE		●	●	To select or customize desired image settings
	INTERNET		●	●	
	USER		●	●	
	NORMAL		●	●	
	DEMO		●	●	
VOLUME			●	●	To turn off or adjust the sound
● : Adjustable A : Analog Input D : Digital Input					

NOTE

- The order of icons may differ depending on the model (14~21).

The following table indicates all the On Screen Display control, adjustment, and setting menus.

Main menu	Sub-menu		A	Reference
EZ ZOOMING			●	To adjust the resolution
4:3 IN WIDE			●	To adjust the image size
PHOTO EFFECT	NORMAL		●	To adjust the screen color mode
	GAUSSIAN BLUR		●	
	SEPIA		●	
	MONOCHROME		●	
PICTURE	BRIGHTNESS		●	To adjust the brightness, contrast and gamma of the screen
	CONTRAST		●	
	GAMMA		●	
COLOR	PRESET	sRGB	●	To customize the color of the screen
		6500K	●	
		9300K	●	
	RED		●	
	GREEN		●	
	BLUE		●	
TRACKING	HORIZONTAL		●	To adjust the position of the screen
	VERTICAL		●	
	CLOCK		●	To improve the clarity and stability of the screen
	PHASE		●	
	SHARPNESS		●	
SETUP	LANGUAGE		●	To customize the screen status for a user's operating environment
	OSD POSITION	HORIZONTAL	●	
		VERTICAL	●	
	WHITE BALANCE		●	
	POWER INDICATOR		●	
	FACTORY RESET		●	
FLATRON F-ENGINE	MOVIE		●	To select or customize desired image settings
	INTERNET		●	
	USER		●	
	NORMAL		●	
	DEMO		●	
VOLUME			●	To turn off or adjust the sound (Only W2271SC)
● : Adjustable A : Analog Input				

NOTE

- The order of icons may differ depending on the model (15~21).

On Screen Display(OSD) Selection and Adjustment

You were introduced to the procedure of selecting and adjusting an item using the OSD system. Listed below are the icons, icon names, and icon descriptions of the all items shown on the Menu.

Press the MENU Button, then the main menu of the OSD appears.

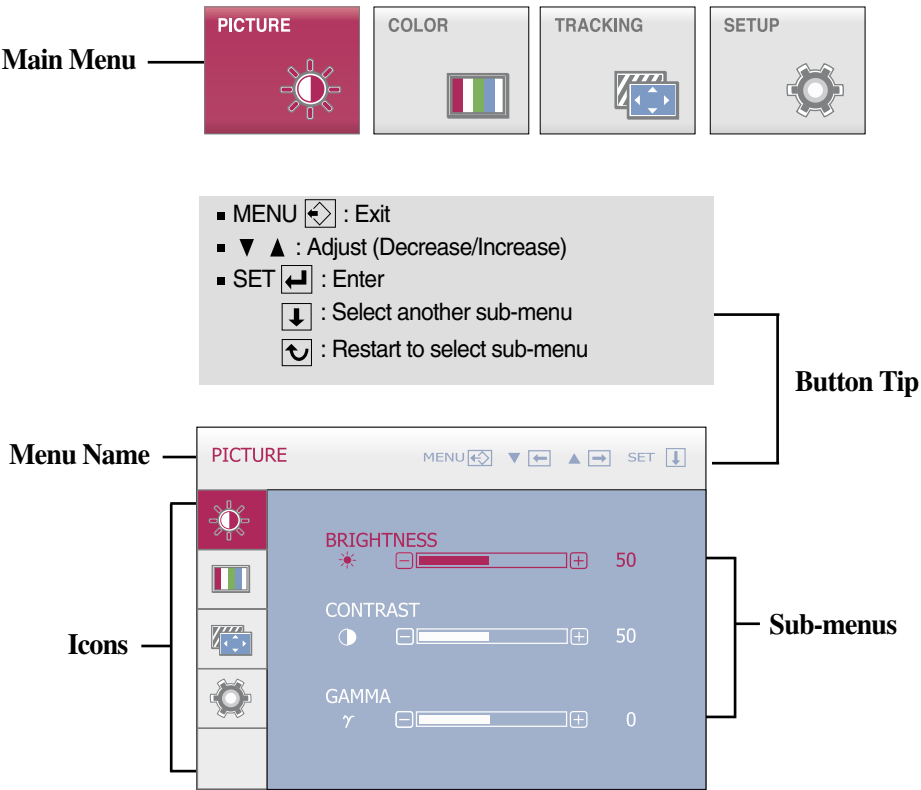

NOTE







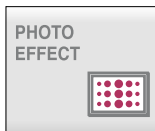
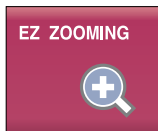

- OSD (On Screen Display) menu languages on the monitor may differ from the manual.

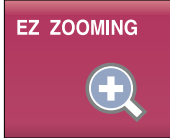
On Screen Display(OSD) Selection and Adjustment

- ■ ■ The OSD screen will appear when you press the **FUN** button on the front of the monitor.

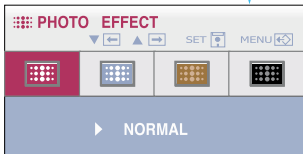

- **MENU** : Exit
- **▼, ▲** : Move
- **SET** : Select

Main menu	Description
 EZ ZOOMING	<p>To select the display resolution.</p> <p>When you select 'EZ ZOOMING' in OSD, display resolution goes one step down so characters and images look bigger. When you select EZ ZOOMING once again, it goes back to the original resolution.</p> <p>* This function is operated only if the 'forteManager' is installed to PC.</p>
 4:3 IN WIDE	<p>To select the image size of the screen.</p> <div style="display: flex; justify-content: space-around; align-items: center;">   </div> <div style="display: flex; justify-content: space-around; align-items: center;"> WIDE 4:3 </div> <ul style="list-style-type: none"> • WIDE : Switch to full screen mode according to input image signal. • 4:3 : Change the input image signal ratio to 4:3.
 PHOTO EFFECT <p>Use the AUTO/SET button to go to sub-menu.</p> 	<p>To select the color of the screen.</p> <ul style="list-style-type: none"> • NORMAL The PhotoEffect function is disabled. • GAUSSIAN BLUR This option is to add the effect to the screen that the dark and sharp image becomes brighter and more blurred. • SEPIA This option changes the screen to be Sepia tone. The Sepia tone is brown color tone. • MONOCHROME This option changed the screen to be Gray tone. The screen image is displayed with just white, black, gray colors. <div style="display: flex; justify-content: space-around; align-items: center;">     </div> <div style="display: flex; justify-content: space-around; align-items: center;"> NORMAL GAUSSIAN BLUR SEPIA MONOCHROME </div>

Main menu	Sub menu	Description
-----------	----------	-------------



PICTURE

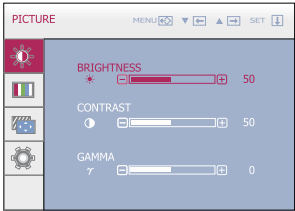

BRIGHTNESS To adjust the brightness of the screen.

CONTRAST To adjust the contrast of the screen.

GAMMA Set your own gamma value. : -50 / 0 / 50
On the monitor, high gamma values display whitish images and low gamma values display high contrast images.

- **MENU** : Exit
- **▼** : Decrease
- **▲** : Increase
- **SET** : Select another sub-menu



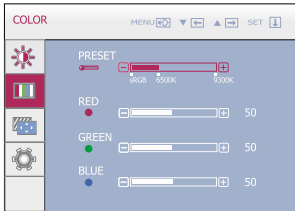

COLOR



PRESET Select the screen color.

- sRGB: Set the screen color to fit the sRGB standard color specification.
- 6500K: Slightly reddish white.
- 9300K: Slightly bluish white.

 **RED** Set your own red color levels.

 **GREEN** Set your own green color levels.

 **BLUE** Set your own blue color levels.

- **MENU** : Exit
- **▼** : Decrease
- **▲** : Increase
- **SET** : Select another sub-menu

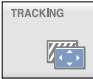
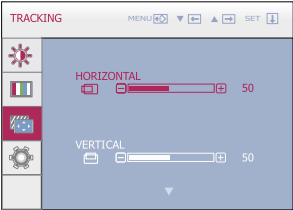
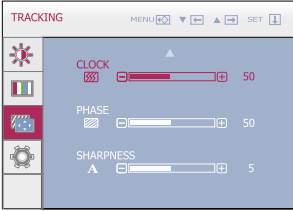
Main menu	Sub menu	Description
	TRACKING	
	HORIZONTAL	To move image left and right.
	VERTICAL	To move image up and down.
	CLOCK	To minimize any vertical bars or stripes visible on the screen background. The horizontal screen size will also change.
	PHASE	To adjust the focus of the display. This item allows you to remove any horizontal noise and clear or sharpen the image of characters.
<ul style="list-style-type: none">■ MENU : Exit■ ▼ : Decrease■ ▲ : Increase■ SET : Select another sub-menu	SHARPNESS	To adjust the clearness of the screen.

On Screen Display(OSD) Selection and Adjustment

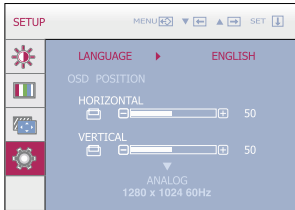
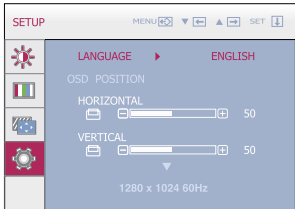
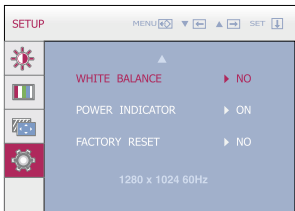
Main menu	Sub menu	Description
	SETUP	
W2271TC		
	LANGUAGE	To choose the language in which the control names are displayed.
	OSD POSITION	To adjust position of the OSD window on the screen.
	WHITE BALANCE	If the output of the video card is different the required specifications, the color level may deteriorate due to video signal distortion. Using this function, the signal level is adjusted to fit into the standard output level of the video card in order to provide the optimal image. Activate this function when white and black colors are present in the screen.
W1971SC/W2271SC		
	POWER INDICATOR	Use this function to set the power indicator on the front side of the monitor to ON or OFF . If you set OFF , it will go off. If you set ON at any time, the power indicator will automatically be turned on.
	FACTORY RESET	Restore all factory default settings except "LANGUAGE." Press the ▲, ▼ buttons to reset immediately.
<ul style="list-style-type: none"> ■ MENU : Exit ■ ▼ : Adjust ■ ▲ : Adjust ■ SET : Select another sub-menu 		

If this does not improve the screen image, restore the factory default settings. If necessary, perform the white balance function again. This function will be enabled only when the input signal is an analog signal.

On Screen Display(OSD) Selection and Adjustment

- ■ ■ The OSD screen will appear when you press the **f-ENGINE** button on the front of the monitor.

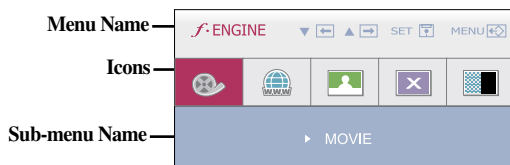

FLATRON F-ENGINE

When you execute F-ENGINE, two tones will appear on the screen as shown. The applied screen will appear on the left side, whereas the non-applied screen will appear on the right side. Press the SET button to use the adjusted screen.

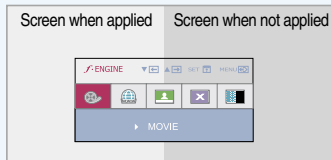

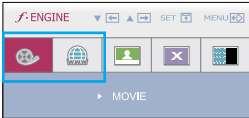
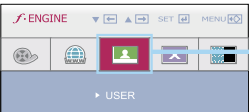
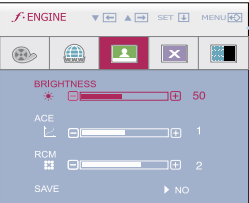
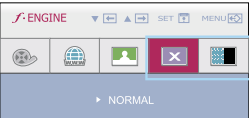
Main menu	Sub menu	Description
 <ul style="list-style-type: none"> ■ MENU : Exit ■ ▼, ▲ : Move ■ SET : Select 	MOVIE INTERNET	<p>This feature lets you easily select the best desired image condition optimized to the environment (ambient illumination, image types etc).</p> <p>MOVIE: For animation images in videos or movies INTERNET: For text images (Word processing etc.)</p>
 <p>To adjust the USER sub-menu function, press the SET Button</p>  <ul style="list-style-type: none"> ■ MENU : Exit ■ ▼ : Decrease ■ ▲ : Increase ■ SET : Select another sub-menu 	USER	<p>You can manually adjust brightness, ACE or RCM. You can save or restore the adjusted value even when using a different environment.</p> <p>...BRIGHTNESS(☀) : Adjusts screen brightness.</p> <p>...ACE(Adaptive Clarity Enhancer): Selects the clarity mode.</p> <p>0 Not applied 1 Weak clarity and luminosity contrast. 2 Strong clarity and luminosity contrast.</p> <p>...RCM(Real Color Management): Selects the color mode.</p> <p>0 Not applied 2 Flesh tone 1 Green enhance 3 Color Enhance</p> <p>Select 'YES' in SAVE sub-menu to save adjustments.</p>
	NORMAL DEMO	<p>This is under normal operating conditions. * Normal mode is when f-ENGINE is turned off.</p> <p>This is used for advertising in the store. The screen will be divided to show the standard mode on the left and video mode on the right so that the consumers can check the difference after applying the video mode.</p>

Check the following before calling for service.

No image appears	
● Is the power cord of the display connected?	<ul style="list-style-type: none"> • Check and see if the power cord is connected properly to the power outlet.
● Is the power indicator light on?	<ul style="list-style-type: none"> • Press the Power button.
● Is the power on and the power indicator blue or green?	<ul style="list-style-type: none"> • Adjust the brightness and the contrast.
● Is the power indicator amber?	<ul style="list-style-type: none"> • If the display is in power saving mode, try moving the mouse or pressing any key on the keyboard to bring up the screen. • Try to turn on the PC.
● Do you see an "OUT OF RANGE" message on the screen?	<ul style="list-style-type: none"> • This message appears when the signal from the PC (video card) is out of horizontal or vertical frequency range of the display. See the 'Specifications' section of this manual and configure your display again.
● Do you see a "CHECK SIGNAL CABLE" message on the screen?	<ul style="list-style-type: none"> • This message appears when the signal cable between your PC and your display is not connected. Check the signal cable and try again.

Do you see a "OSD LOCKED" message on the screen?	
● Do you see "OSD LOCKED" when you push MENU button?	<ul style="list-style-type: none"> • You can secure the current control settings, so that they cannot be inadvertently changed. You can unlock the OSD controls at any time by pushing the MENU button for several seconds: the message "OSD UNLOCKED" will appear.

Display image is incorrect

- | | |
|---|--|
| <ul style="list-style-type: none">● Display Position is incorrect. | <ul style="list-style-type: none">• Press the AUTO/SET button to automatically adjust your display image to the ideal setting. If the results are unsatisfactory, adjust the image position using the H position and V position icon in the on screen display. |
| <ul style="list-style-type: none">● On the screen background, vertical bars or stripes are visible. | <ul style="list-style-type: none">• Press the AUTO/SET button to automatically adjust your display image to the ideal setting. If the results are unsatisfactory, decrease the vertical bars or stripes using the CLOCK icon in the on screen display. |
| <ul style="list-style-type: none">● Any horizontal noise appearing in any image or characters are not clearly portrayed. | <ul style="list-style-type: none">• Press the AUTO/SET button to automatically adjust your display image to the ideal setting. If the results are unsatisfactory, decrease the horizontal bars using the PHASE icon in the on screen display.• Check Control Panel --> Display --> Settings and adjust the display to the recommended resolution or adjust the display image to the ideal setting. Set the color setting higher than 24 bits (true color). |

IMPORTANT

- Check **Control Panel --> Display --> Settings** and see if the frequency or the resolution were changed. If yes, readjust the video card to the recommend resolution.
- If the recommended resolution (optimal resolution) is not selected, letters may be blurred and the screen may be dimmed, truncated or biased. Make sure to select the recommend resolution.
- The setting method can differ by computer and O/S (Operation System), and resolution mentioned above may not be supported by the video card performance. In this case, please ask to the computer or the video card manufacturer.

Display image is incorrect

- | | |
|--|---|
| <ul style="list-style-type: none">● The screen color is mono or abnormal. | <ul style="list-style-type: none">• Check if the signal cable is properly connected and use a screwdriver to fasten if necessary.• Make sure the video card is properly inserted in the slot.• Set the color setting higher than 24 bits (true color) at Control Panel - Settings. |
| <ul style="list-style-type: none">● The screen blinks. | <ul style="list-style-type: none">• Check if the screen is set to interlace mode and if yes, change it to the recommend resolution. |

Have you installed the display driver?

- | | |
|--|---|
| <ul style="list-style-type: none">● Have you installed the display driver? | <ul style="list-style-type: none">• Be sure to install the display driver from the display driver CD (or diskette) that comes with your display. Or, you can also download the driver from our web site: http://www.lge.com. |
| <ul style="list-style-type: none">● Do you see an "Unrecognized monitor, Plug&Play (VESA DDC) monitor found" message? | <ul style="list-style-type: none">• Make sure to check if the video card supports Plug&Play function. |

Display	19 inches (48.14 cm) Flat Panel Active matrix-TFT LCD	
	Anti-Glare coating	
	Visible diagonal size : 48.14 cm	
	0.285 mm pixel pitch	
Sync Input	Horizontal Freq.	28 - 83 kHz (Automatic)
	Vertical Freq.	56 - 75 Hz (Automatic)
	Input Form	Separate Sync. SOG (Sync On Green)
Video Input	Signal Input	15 pin D-Sub Connector
	Input Form	RGB Analog (0.7 Vp-p/ 75 ohm)
Resolution	Max	VESA 1440 x 900 @75 Hz
	Recommend	VESA 1440 x 900 @60 Hz
Plug&Play	DDC 2B	
Power Consumption	On Mode	: 34W(Typ.)
	Sleep Mode	≤ 1 W
	Off Mode	≤ 1 W
Dimensions & Weight	With Stand	
	Width	44.85 cm / 17.66 inches
	Height	38.64 cm / 15.21 inches
	Depth	22.09 cm / 8.7 inches
	Weight(excl. packing)	
	Without Stand	
	44.85 cm / 17.66 inches	
	32.15 cm / 12.66 inches	
	5.58 cm / 2.2 inches	
	3.99 kg (8.79 lbs)	
Range	Tilt	-5° ~22°
Power Input	AC 100-240V~ 50/60Hz 0.8A	
Environmental Conditions	Operating Conditions	
	Temperature	10°C to 35 °C
	Humidity	10 % to 80 % non-Condensing
	Storage Conditions	
	Temperature	-20°C to 60 °C
	Humidity	5 % to 90 % non-Condensing

Stand Base	Attached (), Detached (O)	
Power cord	Wall-outlet type	
USB	Standard Data Rate	USB 2.0, Bus-Power Max 480 Mbps
Audio	Input Sensitivity	0.7Vrms
Webcam	Video Resolution View Angle(Diagonal)	Max 640 x 480 (VGA) 60°
MIC	Analog One Channel	

NOTE

- Information in this document is subject to change without notice.

Display	22 inches (55.867 cm) Flat Panel Active matrix-TFT LCD Anti-Glare coating Visible diagonal size : 55.867 cm 0.282 mm pixel pitch	
Sync Input	Horizontal Freq.	28 - 83 kHz (Automatic)
	Vertical Freq.	56 - 75 Hz (Automatic)
	Input Form	Separate Sync. SOG (Sync On Green)
Video Input	Signal Input	15 pin D-Sub Connector
	Input Form	RGB Analog (0.7 Vp-p/ 75 ohm)
Resolution	Max	VESA 1680 x 1050 @60 Hz
	Recommend	VESA 1680 x 1050 @60 Hz
Plug&Play	DDC 2B	
Power Consumption	On Mode	: 42W(Typ.)
	Sleep Mode	≤ 1 W
	Off Mode	≤ 1 W
Dimensions &Weight	With Stand	
	Without Stand	
	Width	51.96 cm / 20.46 inches
	Height	42.81 cm / 16.86 inches
	Depth	22.07 cm / 8.69 inches
	Weight(excl. packing)	4.5 kg (9.92 lbs)
Range	Tilt	-5° ~22°
Power Input	AC 100-240V~ 50/60Hz 1.0A	
Environmental Conditions	Operating Conditions	
	Temperature	10°C to 35 °C
	Humidity	10 % to 80 % non-Condensing
	Storage Conditions	
	Temperature	-20°C to 60 °C
	Humidity	5 % to 90 % non-Condensing

Stand Base	Attached (), Detached (O)	
Power cord	Wall-outlet type	
USB	Standard Data Rate	USB 2.0, Bus-Power Max 480 Mbps
Audio	RMS Audio Output Input Sensitivity	1W+1W(R+L) 0.7Vrms
Webcam	Video Resolution View Angle(Diagonal)	Max 1600 x 1200 (2M) 65°
MIC	Digital Two Channel	

NOTE

- Information in this document is subject to change without notice.

Display	22 inches (55.867 cm) Flat Panel Active matrix-TFT LCD Anti-Glare coating Visible diagonal size : 55.867 cm 0.282 mm pixel pitch	
Sync Input	Horizontal Freq.	28 - 83 kHz (Automatic)
	Vertical Freq.	56 - 75 Hz (Automatic)
	Input Form	Separate Sync. SOG (Sync On Green) Digital
Video Input	Signal Input	15 pin D-Sub Connector DVI-D Connector (Digital)
	Input Form	RGB Analog (0.7 Vp-p/ 75 ohm), Digital
Resolution	Max	VESA 1680 x 1050 @60 Hz
	Recommend	VESA 1680 x 1050 @60 Hz
Plug&Play	DDC 2B	
Power Consumption	On Mode	: 42W(Typ.)
	Sleep Mode	≤ 1 W
	Off Mode	≤ 1 W
Dimensions &Weight	With Stand	
	Without Stand	
	Width	51.96 cm / 20.46 inches
	Height	42.81 cm / 16.86 inches
	Depth	22.07 cm / 8.69 inches
	Weight(excl. packing)	4.5 kg (9.92 lbs)
Range	Tilt	-5°~22°
Power Input	AC 100-240V~ 50/60Hz 1.0A	
Environmental Conditions	Operating Conditions	
	Temperature	10°C to 35 °C
	Humidity	10 % to 80 % non-Condensing
	Storage Conditions	
	Temperature	-20°C to 60 °C
	Humidity	5 % to 90 % non-Condensing

Stand Base	Attached (), Detached (O)	
Power cord	Wall-outlet type	
USB	Standard Data Rate	USB 2.0, Bus-Power Max 480 Mbps
Audio	RMS Audio Output Input Sensitivity	1W+1W(R+L) 0.7Vrms
Webcam	Video Resolution View Angle(Diagonal)	Max 1600 x 1200 (2M) 65°
MIC	Digital Two Channel	

NOTE

- Information in this document is subject to change without notice.

Preset Modes (Resolution)

W1971SC

Display Modes (Resolution)			Horizontal Freq. (kHz)	Vertical Freq. (Hz)
1	VGA	640 x 350	31.469	70
2	VGA	720 x 400	31.468	70
3	VGA	640 x 480	31.469	60
4	VESA	640 x 480	37.500	75
5	VESA	800 x 600	37.879	60
6	VESA	800 x 600	46.875	75
7	MAC	832 x 624	49.725	75
8	VESA	1024 x 768	48.363	60
9	VESA	1024 x 768	60.123	75
10	MAC	1152 x 870	68.681	75
11	VESA	1152 x 900	61.805	65
12	VESA	1280 x 1024	63.981	60
13	VESA	1280 x 1024	79.976	75
14	VESA	1440 x 900	55.500	60
*15	VESA	1440 x 900	55.935	60
16	VESA	1440 x 900	70.635	75

W2271SC/W2271TC

Display Modes (Resolution)			Horizontal Freq. (kHz)	Vertical Freq. (Hz)
1	VGA	720 x 400	31.468	70
2	VGA	640 x 480	31.469	60
3	VGA	640 x 480	37.500	75
4	VESA	800 x 600	37.879	60
5	VESA	800 x 600	46.875	75
6	VESA	1024 x 768	48.363	60
7	VESA	1024 x 768	60.123	75
8	VESA	1152 x 864	67.500	75
9	VESA	1280 x 1024	63.981	60
10	VESA	1280 x 1024	79.976	75
11	VESA	1680 x 1050	64.674	60
*12	VESA	1680 x 1050	65.290	60

*Recommend Mode

Indicator

MODE	LED Color
On Mode	Blue
Sleep Mode	Amber
Off Mode	Off

Installing the Wall mount plate

This monitor satisfies the specifications of the Wall mount plate or the interchange device.

1. Place the monitor face down on the cushion or soft cloth.
2. Separate the stand using a screwdriver as shown in the picture.

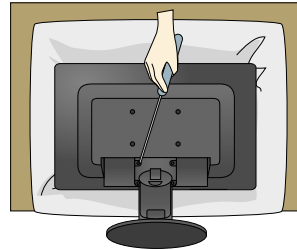
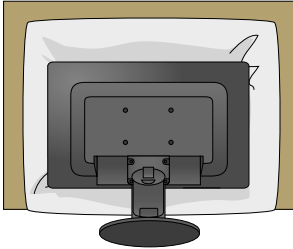

3. Install the Wall mount plate.

Wall mount plate(Separate purchase)

This is stand-type or wall mount type and is connectable with Wall mount plate.

Please refer to the installation guide for more details, which is provided when Wall mount plate is purchased.

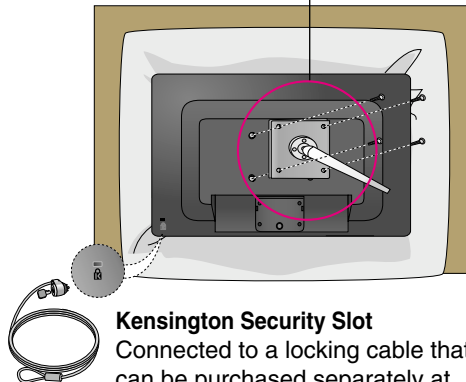

Kensington Security Slot

Connected to a locking cable that can be purchased separately at most computer stores.

Digitally yours ■■■■■■■■■■

