

Digital Photo Frame

User's Guide

F7010N
F7010S
F8010N
F8010S



Make sure to read the **Important Precautions** before using the product.
Keep the User's Guide(CD) in an accessible place for future reference.

See the label attached on the product and give the information to your dealer when you ask for service.

Table of Contents

Preparation and Installation / Connection

| | |
|---|----------|
| Important Safety Precaution | 1 |
| Composition of product | 3 |
| Accessories | 3 |
| Names of parts | 4 |
| Remote Control Button Names and Functions | 6 |
| Remote Controller Sensor / Replacing the Remote Control Battery | 7 |
| Installation and connection of product | 8 |
| Installing Stand / Connecting Power Cord | 8 |
| Connecting USB / Connecting Memory card | 9 |

Menu and Functions

| | |
|---|-----------|
| Before beginning | 11 |
| Setting / Key-Help | 11 |
| HomeMenu | 12 |
| Screen composition and buttons | 12 |
| Slide Show | 13 |
| Playing photo and slide show menu | 13 |
| Music (Only F7010N/F8010N Model) | 15 |
| Playing music | 15 |
| Playing screen composition and buttons | 16 |
| Video (Only F7010N/F8010N Model) | 17 |
| Playing video | 17 |
| Playing screen composition and buttons | 18 |
| File management | 19 |
| Screen composition and buttons | 19 |
| File management menu | 20 |
| File copy/delete | 21 |
| Selecting all file/Unselecting all file | 22 |
| Setup | 23 |
| Power On Message function | 25 |

Appendix

| | |
|----------------------------------|-----------|
| Troubleshooting | 26 |
| Specifications | 28 |
| Service information | 30 |

Digital Photo Frame

Important Safety Precaution

This unit has been engineered and manufactured to ensure your personal safety, however improper use may result in potential electrical shock or fire hazards. In order to allow the proper operation of all safeguards incorporated in this display, observe the following basic rules for its installation, use, and service.

On Safety

Use only the power cord supplied with the unit. In case you use another power cord, make sure that it is certified by the applicable national standards if not being provided by the supplier. If the power cable is faulty in any way, please contact the manufacturer or the nearest authorized repair service provider for a replacement.

The power supply cord is used as the main disconnection device. Ensure that the socket-outlet is easily accessible after installation.

Operate the display only from a power source indicated in the specifications of this manual or listed on the display. If you are not sure what type of power supply you have in your home, consult with your dealer.

Overloaded AC outlets and extension cords are dangerous. So are frayed power cords and broken plugs. They may result in a shock or fire hazard. Call your service technician for replacement.

As long as this unit is connected to the AC wall outlet, it is not disconnected from the AC power source even if the unit is turned off.

Do not Open the Display:

- There are no user serviceable components inside.
- There are Dangerous High Voltages inside, even when the power is OFF.
- Contact your dealer if the display is not operating properly.

To Avoid Personal Injury :

- Do not place the display on a sloping shelf unless properly secured.
- Use only a stand recommended by the manufacturer.
- Do not drop an object on or apply impact to the product. Do not throw any toys or objects on the product screen. This can cause personal injury, and/or damage the product.

To Prevent Fire or Hazards:

- Always turn the display OFF if you leave the room for more than a short period of time. Never leave the display ON when leaving the house.
- Keep children from dropping or pushing objects into the display's cabinet openings. Some internal parts carry hazardous voltages.
- Do not add accessories that have not been designed for this display.
- When the display is to be left unattended for an extended period of time, unplug it from the wall outlet.
- Never touch the power cord during periods of thunder and lightning. This can be very dangerous and can cause electric shock.

On Installation

Do not allow anything to rest upon or roll over the power cord, and do not place the display where the power cord is subject to damage.

Do not use this display near water such as near a bathtub, washbowl, kitchen sink, laundry tub, in a wet basement, or near a swimming pool.

Displays are provided with ventilation openings in the cabinet to allow the release of heat generated during operation. If these openings are blocked, built-up heat can cause failures which may result in a fire hazard. Therefore, NEVER:

- Place the display in a built-in enclosure unless proper ventilation is provided.
- Place the display near or over a radiator or heat source.

Do not rub or strike the Active Matrix LCD with anything hard as this may scratch, mar, or damage the Active Matrix LCD permanently.

Do not press the LCD screen with your finger for a long time as this may cause some afterimages.

Some dot defects may appear as Red, Green or Blue spots on the screen. However, this will have no impact or effect on the display performance.

Leaving a fixed image on the screen for a long time may cause damage to the screen and cause image burn-in. Make sure to use a screen saver on the product. Burn-in and related problems are not covered by the warranty on this product.

Make sure the panel faces forward and hold it with both hands to move. If you drop the product, the damaged product can cause electric shock or fire. Contact an authorized the service center for repair.

Avoid high temperatures and humidity.

On Cleaning

- Unplug the display before cleaning the face of the display screen.
- Use a slightly damp (not wet) cloth. Do not use an aerosol directly on the display screen because over-spraying may cause electrical shock.
- When cleaning the product, unplug the power cord and scrub gently with a soft cloth to prevent scratching. Do not clean with a wet cloth or spray water or other liquids directly onto the product. An electric shock may occur. (Do not use chemicals such as benzene, paint thinners or alcohol)
- Spray water onto a soft cloth 2 to 4 times, and use it to clean the front frame; wipe in one direction only. Too much moisture may cause staining.

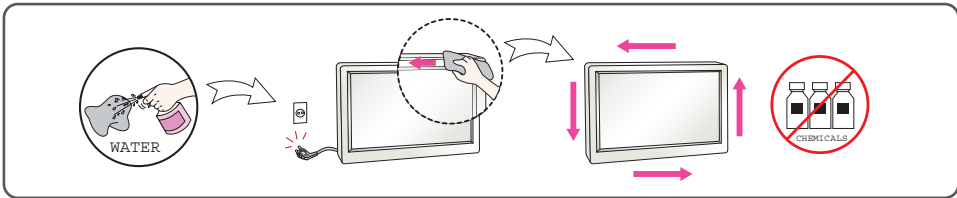

On Repacking

- Do not throw away the carton and packing materials. They make an ideal container in which to transport the unit. When shipping the unit to another location, repack it in its original material.

On Disposal

- The fluorescent lamp used in this product contains a small amount of mercury.
- Do not dispose of this product with general household waste.
- Disposal of this product must be carried out in accordance to the regulations of your local authority.

Digital Photo Frame

Composition of product

Accessories

- Check the accessories.



Digital Photo Frame



F7010S/F8010S



F7010N/F8010N

Remote



CD User's guide / Cards

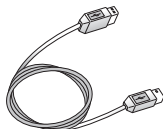

USB Cable to PC

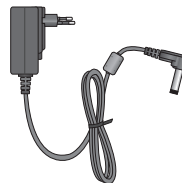

Power Adapter

Note

- The Digital Photo Frame and its accessories may look different from those shown here.

Digital Photo Frame

Composition of product

Names of parts

✦ Front

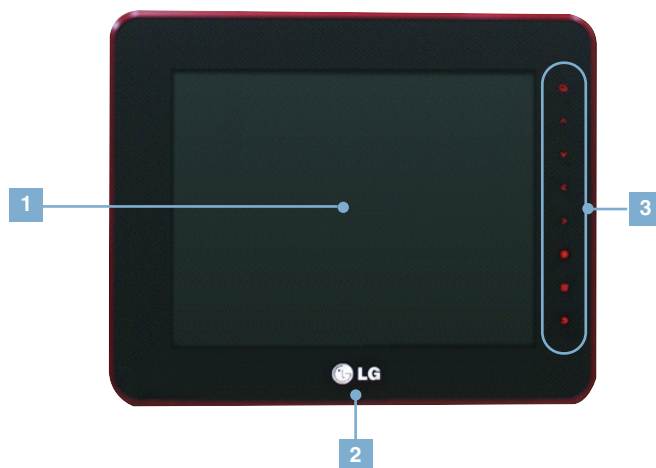

1 Remote controller sensor

There is a remote controller sensor of the product at the center of the product. Please press toward remote controller sensor when using remote controller.

2 LG Logo

If connecting to the power, LG logo's light is on.

3 Touch Key Button

- | | | |
|--|----------------------|---|
| | MENU Button | It pops up menu |
| | UP Button | Go to Up |
| | DOWN Button | Go to Down |
| | LEFT Button | Go to Left |
| | RIGHT Button | Go to Right |
| | OK Button | OK(The Play/Pause button is used to play Slide Show, Music, and Video files.) |
| | SELECT Button | Select the file |
| | BACK Button | Shortly: Going out / Long: Home menu |

Digital Photo Frame

Composition of product

✕ Back

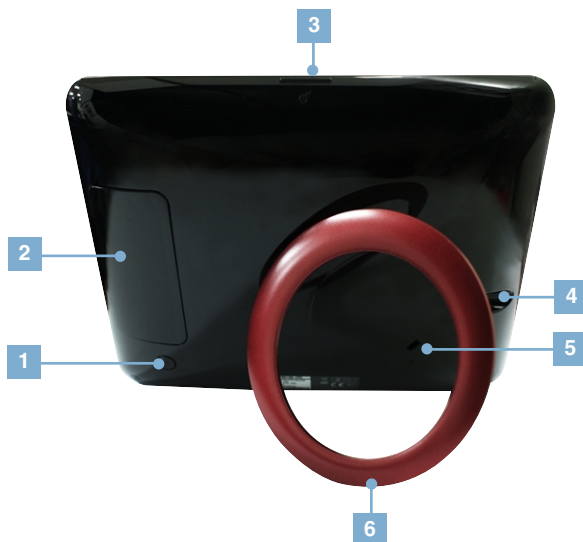

1 POWER Button You can turn the power on and off.

2 Connecting part to external device (→ 9P)

3 Power saving button If pressing once, the screen goes to power saving mode, and if pressing once again, it goes back to default setting.

4 DC 9V IN terminal After connecting power adapter to DC 9V IN terminal, you can use it by connecting power cord.

5 Kensington Security Slot (Separate purchase required) Connected to a locking cable that can be purchased separately at most computer stores.

6 Stand

Digital Photo Frame

Composition of product

Remote Control Button Names and Functions

F7010S/F8010S

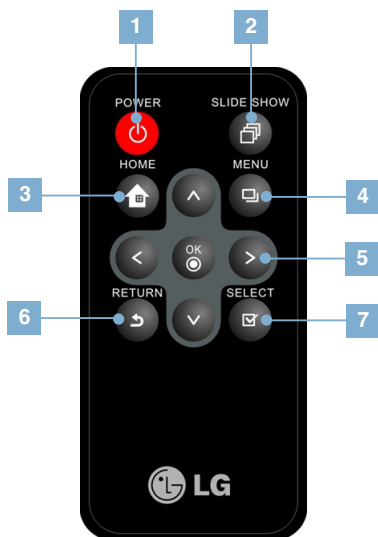

- | | | |
|---|--|---|
| 1 | | Turn ON/OFF |
| 2 | | Go to Show Slide |
| 3 | | Go to HomeMenu |
| 4 | | It pops up menu |
| 5 | | Go to Up |
| | | Go to Down |
| | | Go to Left |
| | | Go to Right |
| | | OK(The Play/Pause button is used to play Slide Show, Music, and Video files.) |

F7010N/F8010N

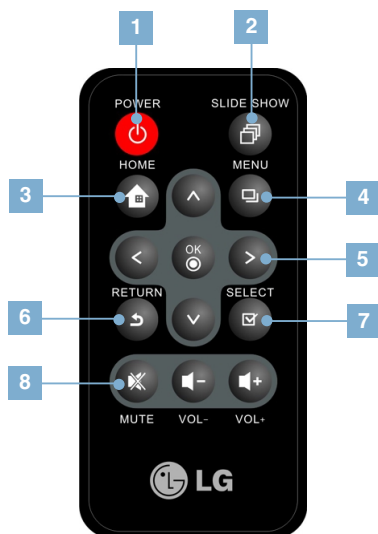

- | | | |
|---|--|-----------------------|
| 6 | | Go to previous screen |
| 7 | | Select the file |
| 8 | | It goes to mute |
| | | It adjusts volume |
| | | |

Note

- Before using the remote control, please remove the safety film on the bottom of the remote control as shown in the picture.

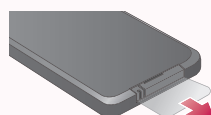

Digital Photo Frame

Composition of product

Remote Controller Sensor

- There is a remote controller sensor of the product at the center of the product. Please press toward remote controller sensor when using remote controller.

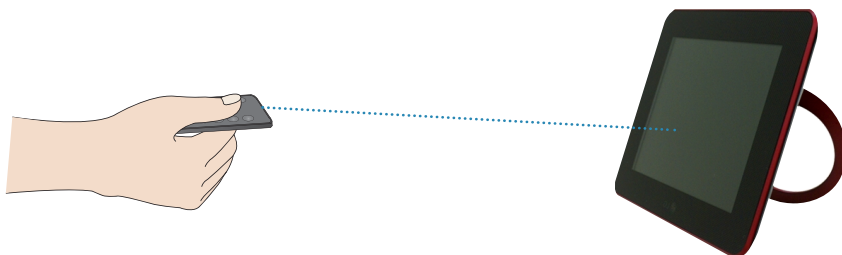

Replacing the Remote Control Battery

- 1 Push the tab of the battery holder on the rear bottom side of the remote controller.

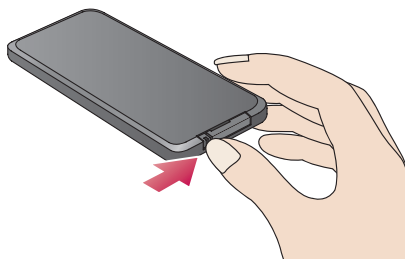

- 2 Pull the battery holder out.

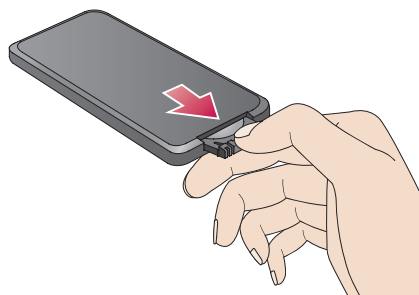

- 3 Replace the battery (Lithium Cell CR2025 3V) and push the holder in.

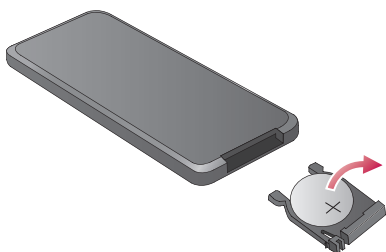

Note

- Please use only assigned battery. Unless you do, the battery could explode.
- Please be careful that the foreign substance goes into inside of remote controller when changing battery.
- Unless you use the battery correctly, it could be the cause of leakage or corrosion.

Digital Photo Frame

Installation and connection of product

Installing Stand

- 1 Please set up by gently pulling the product stand.



- 2 You can use by setting up horizontally or vertically.



Connecting Power Cord

- 1 After connecting power adapter to DC 9V IN terminal at the product side, please connect power code.

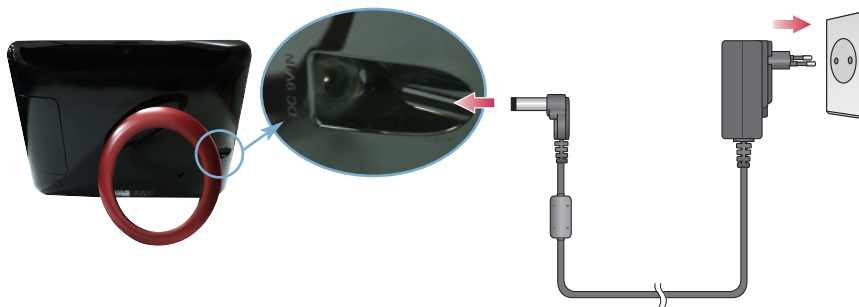

- 2 Press the POWER button  on the back of the product or remote to turn the power on. When turning off the power, press the POWER button for 2~3 seconds until the screen goes off.

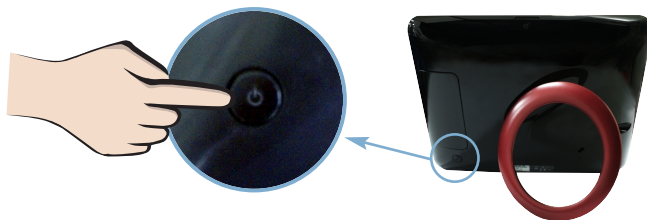

Note

- After setting up the stand, please check if the product is stable. Unless the product is setup correctly, there could be possible danger of damage from the product's knocking or falling down.
- When **Auto** setting up **Orientation** menu of the **Setup**, the image automatically rotates as well. But Menu and Key-Help don't rotate.
- The product and it accessories may look different from those shown here.

Digital Photo Frame

Installation and connection of product

Connecting USB / Connecting Memory card

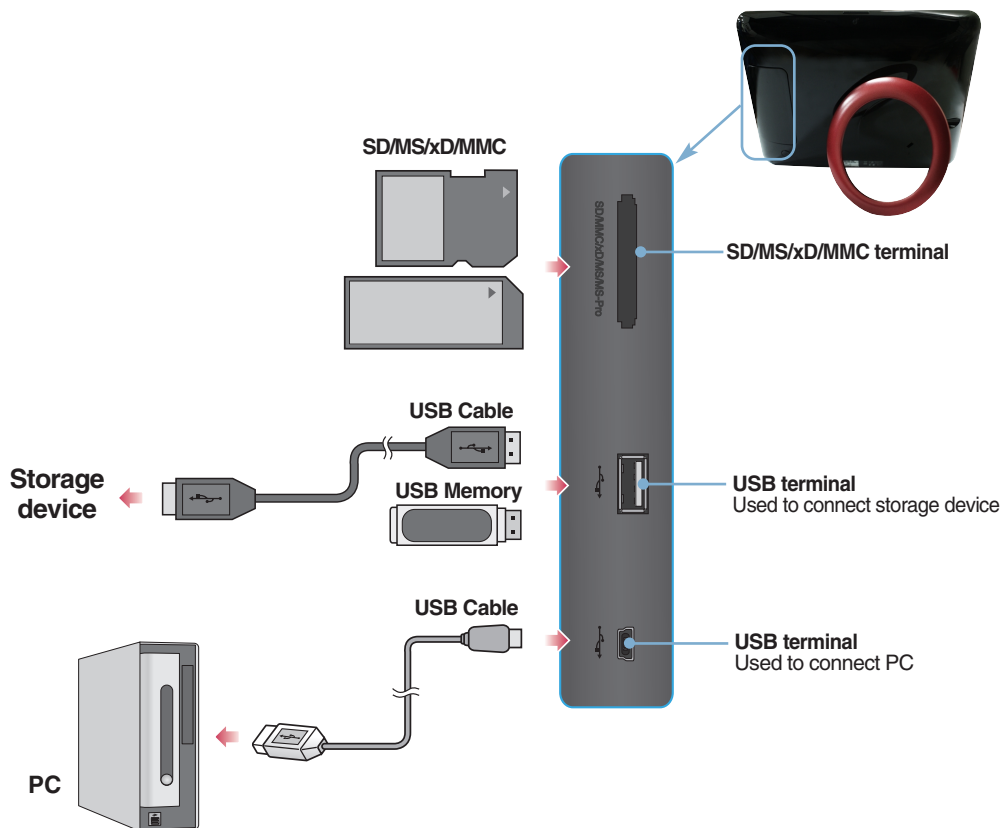

1 Storage device connection

1. Please connect to product's USB terminal.
2. Please connect to USB terminal of external storage device.
3. If external storage device is read, a window pops up as below.
Please select an operation you want.

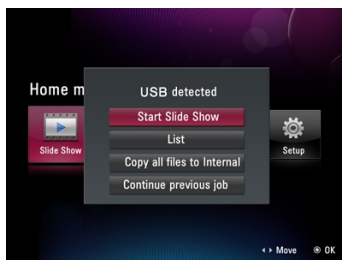

Digital Photo Frame

Installation and connection of product

2 PC connection

1. Please connect to product's USB terminal using a provided USB cable.
2. Please connect to PC's USB terminal.
3. If PC is read, a window pops up as below. Please select use mode you want between a **Mass storage** and **Mini monitor**.

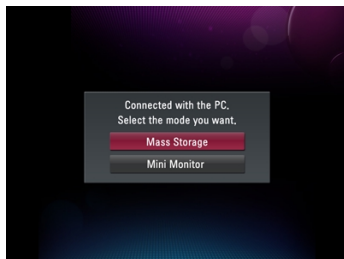

3 Memory card slot (SD/MS/xD/MMC)

1. Please pay attention to the direction of the memory card.
2. Please push into the slot.
3. If external memory card is read, a window pops up as below. Please select an operation you want.

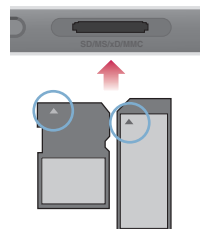
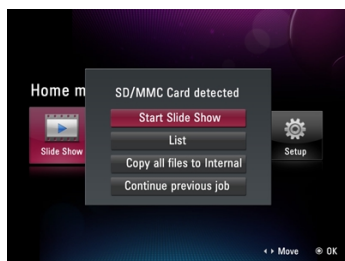



Note

- The internal memory of the product is 2GB. If the memory is full, no more files are saved.
- Two or more external devices can be connected together.
- Do not turn the product off or remove external devices while moving, saving, playing or deleting files.
- If removing external storage devices while playing file, the product may abnormally operate. Please turn the power off and on again for this case.
- When connecting external storage devices to the product, use the cables included with the devices.
(For more information on storage devices, and cable purchase, contact the relevant service centers for the devices.)
- This product doesn't support external hard and card reader.
- When connecting to PC by USB cable, the volume name(Ex: E:, F:, G:, and so on) of moving disk depends on computer circumstance.

Digital Photo Frame

Before beginning

Setting

- When turning on the power at first, the setup window that you can set up Language, Date and Time, and Power on Message pops up. After finishing setup, it doesn't appear again, and if initializing, it reappears.
- Please refer to  **Setup** (→ 23P) for details about each menu.
- You can change setup again at  **Setup** (→ 23P).

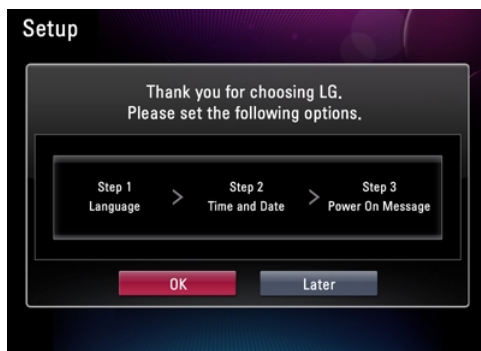

1Step Language

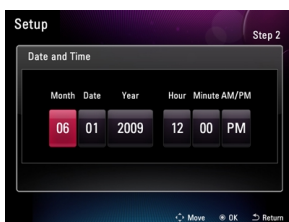

2Step Date and Time

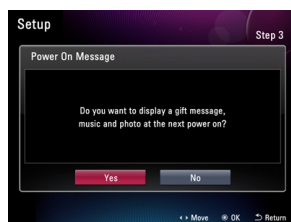

3Step Power on Message

Key-Help

- Key-Help is indicated at the right lower part of each menu to help user for adjusting button. Please refer to it for adjusting product's button.

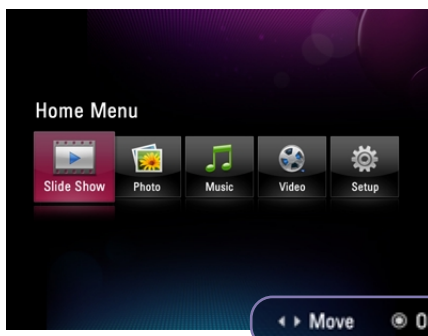

Screen Display and Buttons

- Please select desired menu.



F7010S/F8010S



F7010N/F8010N

6 Key-Help

1



Slide Show

You can display the photo. (→ P13)

2



Photo

You can select and manage the photo. (→ P19)

3



Music

(Only F7010N / F8010N Model)

You can play the music. (→ P15)

You can select and manage the music. (→ P19)

4



Video

(Only F7010N / F8010N Model)

You can play the video. (→ P17)

You can select and manage the video. (→ P19)

5











Setup

You can set up other setting. (→ P23)

Digital Photo Frame







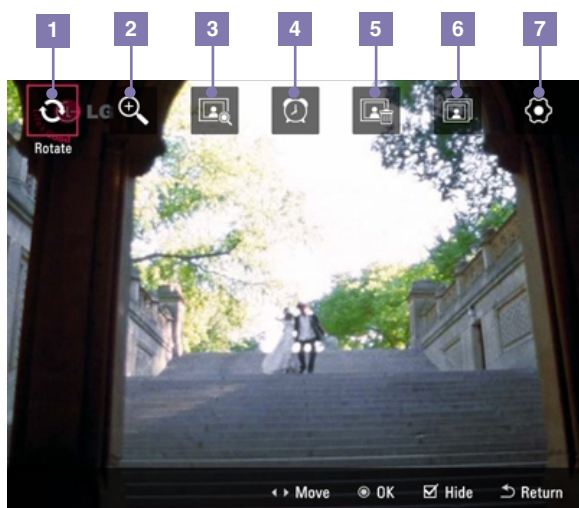

Slide Show

- You can play photo files in  **Slide Show**.
- To use a Slide Show, press the  button on the remote control or select the  **Slide Show** on the **HomeMenu**.
- If selecting a  **Slide Show** at home menu, it basically plays photo. If you want to play music or video, please begin at  **Music** and  **Video**. ( **Music**,  **Video** - Only F7010N/F8010N Model)

Slide Show Menu Function



Operating key

| | |
|--------------------------|--|
| Open/close menu |  |
| Menu movement |   |
| Menu detailed adjustment |     |
| Selecting menu/setup |  |

1 Rotate

You can rotate the photo at regular angle.

0° - 90° - 180° - 270°

2 Zoom

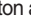
You can extend the photo by  button. It extends the photo in order from 100% to 400%, and if pressing  button at 400%, it goes back to 100%.

100% - 150% - 200% - 300% - 400%

Extension rate indication

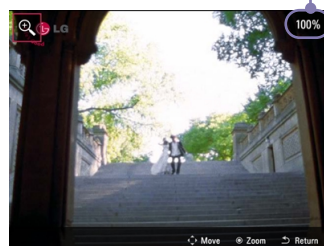

3 List

It moves to  **Photo** that you can manage the file. (→ 19P)

Digital Photo Frame

Slide Show

4 Clock/Calendar

You can set up clock and calendar.

- **Photo**

+ : Insert photo - : Delete photo

- **Clock/Calendar**

1~4 : Select Theme - : Delete clock/calendar

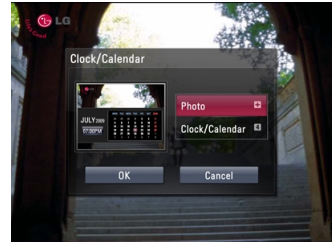

5 Copy

It copies the photo being currently played. It is only possible to copy external device's photo into internal memory. When playing internal memory's photo, copy menu is deactivated.

6 Delete

It deletes the photo being currently played.

7 Slide show setting

Set up slide show's setting.

- **Duration** : Set up photo's switch time.

3s, 10s, 30s, 1m, 5m, 30m, 1h, 12h, 24h

- **Effect** : Set up effect when photo is switched. At random selection, all effect except multiple images is indicated randomly.

* Multi image effect is only supported for the horizontal display.

Random, Multi image, Cross Comb, Door Open, Door Close, Mosaic Random, Mosaic Bar, Snail, Transition, Shutter, Sliding, Corner Sliding, Dissolve, Stairs

- **Sequence** : Set up photo play order.

By Time, By Name, Random

- **Brightness** : Set up brightness of the screen.

1~5

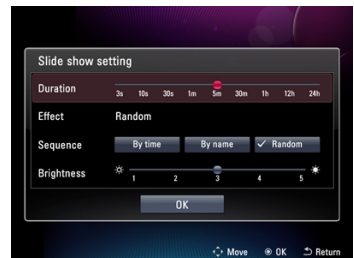

! Tip

- Press the ◀ button to go to the previous photo in Slide Show. Press the ▶ button to go to the next photo.
- If pressing ⏸ button at slide show, slide show pauses. If pressing once more, slide show starts again. ▶
- If the size/capacity of the photo is large, photo switching time could be longer than the time that you originally set.
- If you want to appreciate photo and music together, please set up **Music auto play** at ⚙ **Setup**.
(Only F7010N/F8010N Model)

Digital Photo Frame

Music (Only F7010N/F8010N Model)

Playing music

- 1 If you want to play the music, please selects 🎵 **Music** at **Home Menu**.

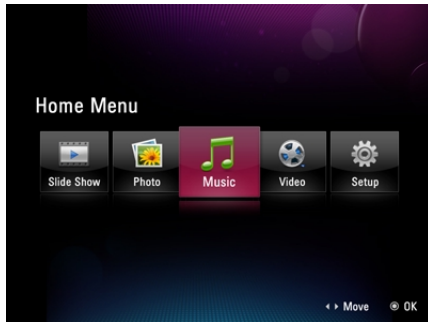

- 2 Please select the file you want by  button.

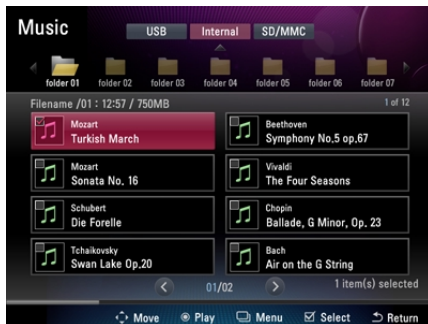

- 3 If pressing  button, it plays the music you selected.

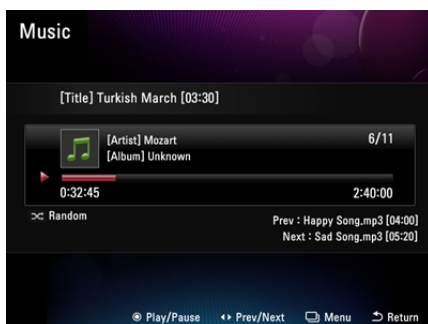

Playing screen composition and buttons

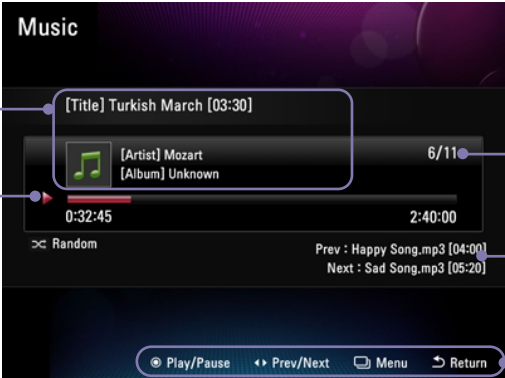

1 [Title] Turkish March [03:30]

2 6/11

3 0:32:45 2:40:00

4 Prev : Happy Song.mp3 [04:00] Next : Sad Song.mp3 [05:20]

5 Play/Pause Prev/Next Menu Return

| Operating key | |
|-----------------------|----------------------|
| Play mode setup | [Icon] |
| Playing previous song | [Icon] |
| Playing next song | [Icon] |
| Pause/play | [Icon] |
| Volume adjustment | [Icon] [Icon] [Icon] |

1 File information indication It indicates file name, musician, and album title.

2 Playing order It indicates the total number of the file to be played and order of the file being currently played.

3 Play bar It indicates playing state of the file being currently played.

4 Previous/next file indication It indicates the previous and next file.

Play mode

- If pressing [Icon] button at the screen of music playing, it moves to play mode.
- You can set up repetition configuration of selected music
- You can select among **Once**, **Repeat all**, **Repeat one**, and **Random**.

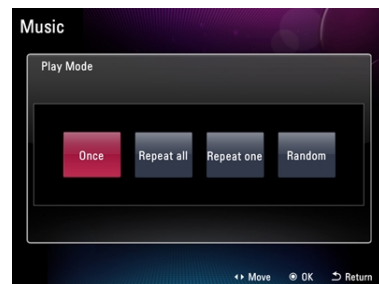

Digital Photo Frame

Video (Only F7010N/F8010N Model)

Playing video

- 1 If you want to play the video, please select  **Video** at Home Menu.

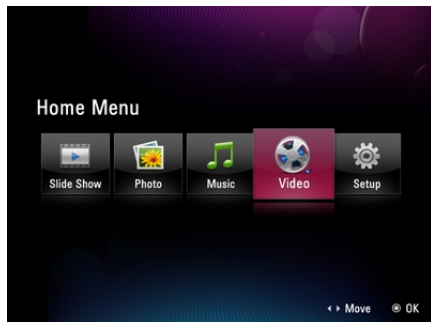

- 2 Please select the file you want by  button.

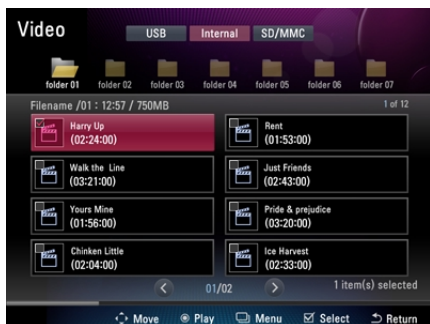

- 3 If pressing  button, it plays the video you selected.

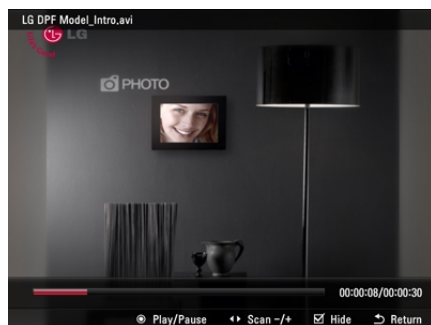

Playing screen composition and buttons

1

LG DPF Model_Intro.avi

PHOTO



00:00:08/00:00:30

Play/Pause

Scan +/-

Hide

Return

Operating key

Open/close play bar

Rewind

Fast rewind

Pause / play



Volume adjustment











3

Key-Help

- 1

File information indication

It indicates name of the file being currently played.
- 2

Play bar

It indicates playing state of the file being currently played.

Digital Photo Frame



File management

Screen Composition and Buttons

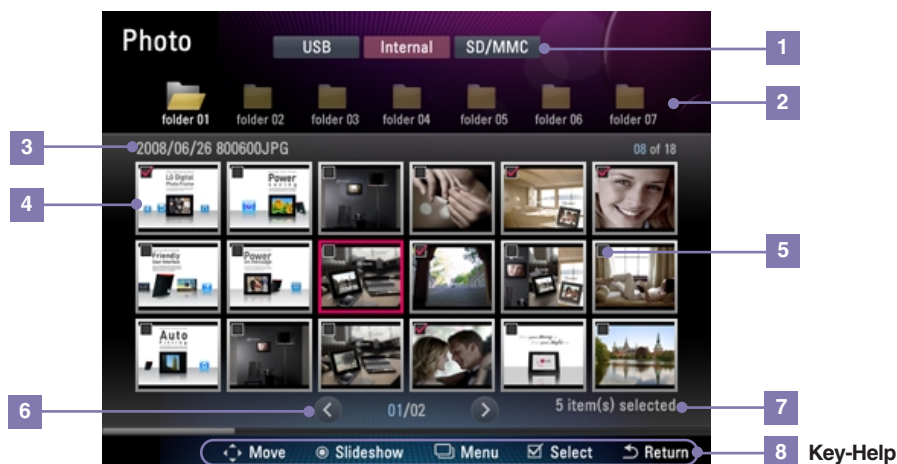
- You can separately manage each file at **Photo**, **Music**, and **Video**.
- Below is an explanation by giving you an example of the **Photo**, and operation method of **Music** and **Video** is also identical. (**Music**, **Video** - Only F7010N/F8010N Model)



- Device type selection** Indicates inside memory and connected external memory apparatus. Please select desired type.
- Folder** Indicates folder at the device you selected. Please select desired folder.
- File information** Indicate file's name and capacity and so on.
- File's table of contents** All files within selected folder are indicated, and preview is possible for photo file. Information of corresponding file is indicated for file of music and video.
- Selection indication** To select any media file content. Press it to select content and press it again to unselect the content.

<Enabled>
<Disabled>
- Page indication** The number of current page and the whole page is indicated, and page movement is possible by using , key. If pressing , key long, each moves to the first and last page.
- The number of selected file** It indicates the total number of currently selected file.







! Tip

- Recommend that you designate the file name as same language as the product current setup language. If different language, some letters could be broken.

Digital Photo Frame

File management

File management menu

- If pressing  button at  **Photo**,  **Music**, and  **Video**, it moves to each menu.
( **Music**,  **Video** - Only F7010N/F8010N Model)
- The usable menu could be different according to the format of the file.



1 Selected file indication

Indicates the number and capacity of selected file.

2 Function

Please select the function you want.





- **Slide Show** Start Slide Show.
- **Select all** Select all files within currently located device. (➡ P22)
- **Unselect all** Unselect all selected files within currently located device. (➡ P22)
- **Copy** Copies file. (➡ P21)
- **Delete** Deletes file. (➡ P21)
- **Rotate** You can rotate the photo.
- **Sequence** Set up photo play order.
- **Device Selection** Select the connected other device.

Digital Photo Frame

File management



File copy / delete

1 Selecting Copy/Delete menu

Pressing the  button in  **Photo**,  **Music**, or  **Video** displays the menu. Select the **Copy** or **Delete** menu.



2 File selection

The file selected in  **Photo**,  **Music**, or  **Video** appears automatically. Select the **Select from of the list** menu if you want to select another file. You can select all files on the device.

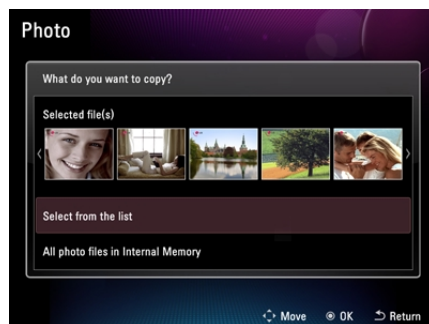

3 Designating copy location (Delete menu doesn't count.)

Please assign the device copying the file.

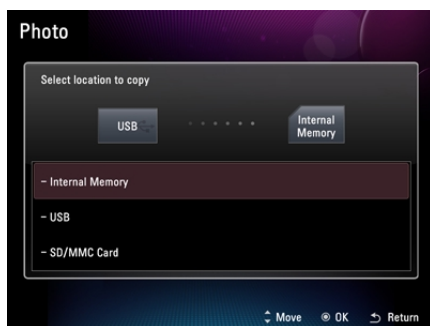





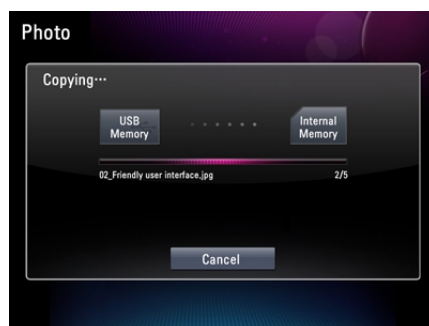



4 Copy/delete

It copies/deletes the file. If copy/deletion completes, please press  button.



Note





- You can also use the Copy/Delete menu to copy/delete files after selecting either  **Photo**,  **Music**, or  **Video**.
- You can't copy the file from internal memory to internal memory (between internal memories).
- You cannot copy/delete all  **Photo**,  **Music**, or  **Video** files at once. Use the Copy/Delete menu of  **Photo**,  **Music**, or  **Video** to copy or delete them individually.

Digital Photo Frame

File management

Selecting all file / Unselecting all file

Select all files/Unselect all files within the device

If pressing  button at  **Photo**,  **Music**, and  **Video** menu appears. Please select **Select all** or **Unselect all**.

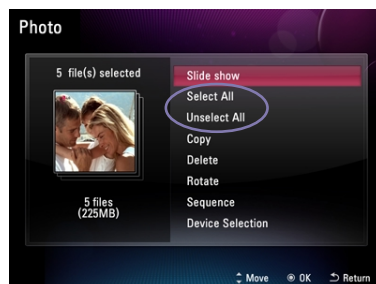

Select all files/Unselect all files within folder

If pressing  button at the location of corresponding folder, it performs select all. If pressing once more, it performs unselect all.



Digital Photo Frame

Setup

- Setup allows you to configure the basic Properties of the device. Select  **Setup** on the **Home Menu**.

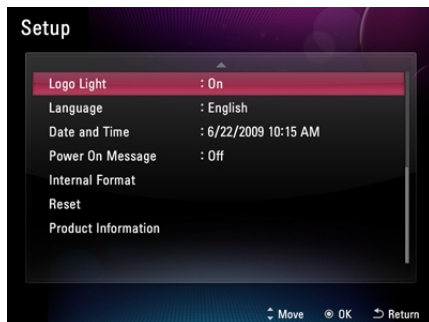

-
- **Brightness** Set up the screen's brightness. It is possible to adjust from 1 to 5.
-
- **Orientation** Set the display direction of the product.
(* This product reads the photo information and the orientation value and rotates the photo accordingly.)
 - **Auto** Sensor automatically shows in rotation by perceiving the product direction.
 - **Landscape** Shows at breadth.
 - **Portrait** Shows at length.
-
- **Photo Aspect Ratio** Adjust the aspect ratio of the screen.
 - **Width Custom** It expands the photo size horizontally to fill the screen.
 - **Height Custom** It expands the photo size vertically to fill the screen.
 - **Full1** It shows the picture fit to the size of the screen regardless of the ratio of the picture.
 - **Full2** It shows the picture fit to the size of the screen maintaining the ratio of the picture. The outer edges may be cut off depending on the size of the picture.
-
- **Video Aspect Ratio** Adjust video aspect ratio.
(Only F7010N/F8010N Model)
 - **Original** It shows by automatically adjusting the screen ratio.
 - **4:3** It shows as the ratio of 4:3.
 - **16:9** It shows as the ratio of 16:9.
-
- **Alarm** You can set up the alarm. Set up the time, repetition setup, sound, and so on.
(Only F7010N/F8010N Model)
-

-
- **Music Auto play**
(Only F7010N/F8010N Model) If music file is detected at photo slide show, it sets up that both are automatically played together.
 - **Power Saving** You can set up the time that power is turned on or off.
 - **Starting mode** Set up the screen that initially shows up when turning on the power.
 - **Home Menu** Start at Home Menu.
 - **Slide Show** Start Slide Show.
 - **Last Mode** Start from the last state that the power is off.
 - **Logo light** Set up logo indication light at the product lower part
 - **Language** Select a language used in the menu screen.
 - **Date and Time** Set up date and time.
 - **Power on Message** Set up present message. (➡ P25)
 - **On** When giving present, you set up by selecting the photo and phrase proper to the objective.
 - **Off** No setup for present message
 - **Internal Format** Delete all data stored in internal memory.
 - **Reset** Initialize all setups.
 - **Product information** Verify product information.
-

Note

- Language and Time are not initialized even when you execute **Reset**.

Digital Photo Frame

Setup

Power On Message Function

- Power On Message is the function to show setup function when other turns on the power by setting up message, photo, music, and video.

1 Selecting 'On'

Select **On** on the **Power On Message** menu.

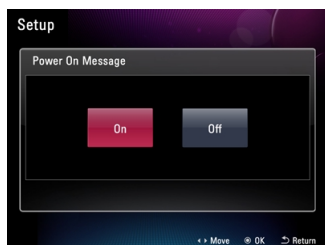

2 Selecting message

Please select the message you will send.

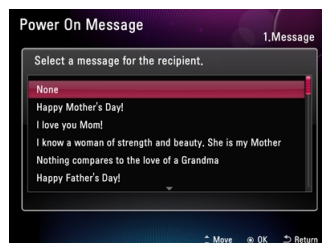

3 Selecting Photo(Video)

Please select the **Photo(Video)**. Please select **Skip** button unless you want to insert.

* If selecting video, you cannot insert the music.

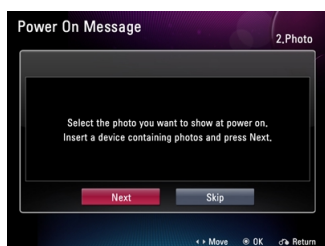

F7010S/F8010S

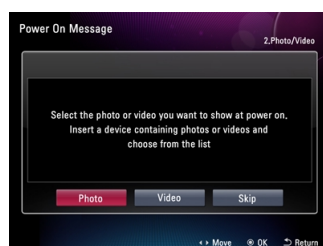

F7010N/F8010N

4 Selecting music (Only F7010N/F8010N Model / It counts only for selecting the photo.)

Please select the music. If selecting **Next** button, you can select the music from the music list, and if selecting **Skip** button, it doesn't insert the music and goes into the next step.

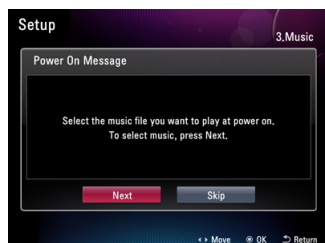

5 Setup completion

You can preview the **Power On Message** by pressing the **Preview** button after setup.

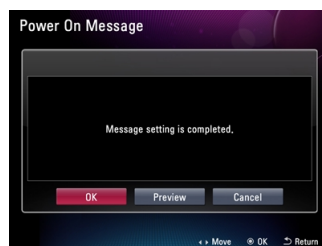



Note

- Even though you set up display direction vertically, the phrase of **Power On Message** isn't supported vertically.

Digital Photo Frame

Troubleshooting

| Problems | Solutions |
|--|---|
| ● The screen does not work. | <ul style="list-style-type: none"> • Check if the product is connected to the power adapter properly. • Check if the power adapter is connected to the power outlet properly. • Press the Power button to turn the product on. |
| ● The photo is not displayed on the screen. | <ul style="list-style-type: none"> • There are some image file formats which are not supported. Please check the product specifications. |
| ● Video screen and sound doesn't operate. | <ul style="list-style-type: none"> • The configuration of video file could not match. Please check product standard and then change the video configuration. |
| ● The music does not play back. | <ul style="list-style-type: none"> • There are some music file formats that are not supported. Please check the product specifications. • Press the , ,  buttons to check if the volume is turned off. |
| ● The USB / memory card is not detected. | <ul style="list-style-type: none"> • Check if the USB cable is connected to the product and the external device properly. • There are some memory card formats which are not supported. Please check the product specifications. • Check if the files stored in the external device are supported file formats. |
| ● The screen is black or none of the buttons work. | <ul style="list-style-type: none"> • The product may not respond because of invalid file format, virus infection or unexpected situation. Turn DC Jack plug off and on to make it function normally. |
| ● I want to format the internal memory. | <ul style="list-style-type: none"> • If you want to format internal memory, it is safe to use Setup -> Internal Format. Format will delete all media file. • Do not format internal memory using PC after connecting the product to PC because it may cause malfunctions. |
| ● It takes long for photo to come up. | <ul style="list-style-type: none"> • When opening the file from external memory card, it could take time. • The time that photo comes up could be different depending on file format type and size. |

Digital Photo Frame

Troubleshooting

| Problems | Solutions |
|--|--|
| <ul style="list-style-type: none">● The screen ration is not normal. | <ul style="list-style-type: none">• Please adjust the aspect ratio of the screen. You can adjust it in the Setup -> Photo Aspect Ratio or Setup -> Video Aspect Ratio. |
| <ul style="list-style-type: none">● The screen color is dim or dark. | <ul style="list-style-type: none">• Please adjust screen brightness. You can adjust at Setup -> Brightness or Slide show setting -> Brightness. |

Digital Photo Frame

Specifications

F7010S/F8010S

* Information in this document is subject to change without notice.

| Model | F7010S | F8010S |
|---------------------------------------|--|--|
| Size | 7" | 8" |
| Dimension (Width x Height x Depth) | Fold Stand | Fold Stand |
| | 195.6 x 161.2 x 29.5 mm | 221.8 x 178.3 x 29.5 mm |
| | Unfold Stand | Unfold Stand |
| | 195.6 x 150.8 x 117.5 mm | 221.8 x 166.7 x 126 mm |
| Weight (excl.packing) | 372 g | 533 g |
| Resolution | 800 x 600 | 800 x 600 |
| Power Input | DC 9V 2.0A | DC 9V 2.0A |
| Power Consumption | General : 5W Power off : less than 1W | General : 5W Power off : less than 1W |
| USB | Version 2.0 X 2(up stream (host) X1, down stream (slave) X1) | Version 2.0 X 2(up stream (host) X1, down stream (slave) X1) |
| Internal Memory | 2 GB | 2 GB |
| Supported file format | JPEG, BMP, GIF, PNG | JPEG, BMP, GIF, PNG |
| Supported Memory Cards | SD ≤ 2GB / SDHC ≤ 32GB / MMC ≤ 2GB / MS ≤ 128MB / MS-PRO ≤ 32GB | SD ≤ 2GB / SDHC ≤ 32GB / MMC ≤ 2GB / MS ≤ 128MB / MS-PRO ≤ 32GB |
| AC-DC Adapter | ADS-18C-12N 09018GPG(EU) ADS-18C-12N 09018GPB(UK) ADS-18C-12N 09018GPCU(USA) | ADS-18C-12N 09018GPG(EU) ADS-18C-12N 09018GPB(UK) ADS-18C-12N 09018GPCU(USA) |

Digital Photo Frame

Specifications

F7010N/F8010N

* Information in this document is subject to change without notice.

| Model | F7010N | F8010N |
|---------------------------------------|--|--|
| Size | 7" | 8" |
| Dimension (Width x Height x Depth) | Fold Stand 195.6 x 161.2 x 29.5 mm | Fold Stand 221.8 x 178.3 x 29.5 mm |
| | Unfold Stand 195.6 x 150.8 x 117.5 mm | Unfold Stand 221.8 x 166.7 x 126 mm |
| Weight (excl.packing) | 382 g | 539 g |
| Resolution | 800 x 600 | 800 x 600 |
| Power Input | DC 9V 2.0A | DC 9V 2.0A |
| Power Consumption | General : 5W Power off : less than 1W | General : 5W Power off : less than 1W |
| USB | Version 2.0 X 2(up stream (host) X1, down stream (slave) X1) | Version 2.0 X 2(up stream (host) X1, down stream (slave) X1) |
| Internal Memory | 2 GB | 2 GB |
| Supported file format | JPEG, BMP, GIF, PNG, MP3, Motion JPEG, MPEG1, MPEG4(SD) | JPEG, BMP, GIF, PNG, MP3, Motion JPEG, MPEG1, MPEG4(SD) |
| Supported Memory Cards | SD ≤ 2GB / SDHC ≤ 32GB / MMC ≤ 2GB / MS ≤ 128MB / MS-PRO ≤ 32GB | SD ≤ 2GB / SDHC ≤ 32GB / MMC ≤ 2GB / MS ≤ 128MB / MS-PRO ≤ 32GB |
| AC-DC Adapter | ADS-18C-12N 09018GPG(EU) ADS-18C-12N 09018GPB(UK) ADS-18C-12N 09018GPCU(USA) | ADS-18C-12N 09018GPG(EU) ADS-18C-12N 09018GPB(UK) ADS-18C-12N 09018GPCU(USA) |

Service center

- LG Electronics Service center web site : <http://www.lgservice.com>

Software Update

- For software update, please refer to www.lge.com

Product Registration

- Visit www.lge.com and register the Serial No. on the product package or the back of the product.
- The Serial No. is a combination of 12 digits with English letters and numbers.
- If you register the Serial No., you can enjoy free A/S service and various events.

