



LG

Life's Good

PLASMA TV OWNER'S MANUAL

PLASMA TV MODELS

42PJ2* 50PJ6*****
50PJ2* 50PK5*****
42PJ3* 60PK5*****
50PJ3***
42PJ5***
50PJ5***
42PJ6***

Please read this manual carefully before operating your TV.

Retain it for future reference.

Record the model number and serial number of the TV.

Refer to the label on the back cover and quote this information.

To your dealer when requiring any service.



HDMI, the HDMI logo and High-Definition Multimedia Interface are trademarks or registered trademarks of HDMI Licensing LLC.

CONTENTS

PREPARATION

PLASMA TV Models : 42PJ5***, 42/50PJ3***,
42/50PJ6***, 42/50PJ2***, 50/60PK5***, A-1

EXTERNAL EQUIPMENT SETUP

Antenna Connection.....	1
Connectiing With a Component cable	2
Connecting with an HDMI cable	3
Connecting with an HDMI to DVI cable	4
USB setup.....	4
Connecting with a RCA cable	5
Connecting with a RF Cable	6
External Stereo Setup.....	6
Connecting with a D-sub 15 pin cable.....	7
Supported Display Resolution.....	8
Screen Setup for PC mode.....	9

WATCHING TV / PROGRAMME CON- TROL

Turning on the TV	13
Initializing Setup	13
Programme Selection.....	13
Volume Adjustment	13
Quick Menu	14
On Screen Menus Selection and Adjustment... ..	15
Auto Programme Tuning	16
Manual Programme Tuning.....	17
Programme Edit	19
Selecting the Programme List.....	21
Favourite Programme Setup.....	22
Input List.....	23
Input Label	24
SIMPLINK.....	25
AV Mode.....	28
Initializing (Reset to Original Factory Settings) ...	29
Key Lock.....	30

TO USE A USB DEVICE

When Connecting a USB Device.....	31
Photo List	33
Music List	39
Movie List.....	42
DivX Registration Code.....	48
Deactivation.....	49

PICTURE CONTROL

Picture Size (Aspect Ratio) Control	50
Energy Saving.....	52
Preset Picture Settings	53
Manual Picture Adjustment	54
Picture Improvement Technology.....	55
Advanced - Black(Darkness) Level.....	56
Advanced - Film Mode	57
Picture Reset.....	58
Image Sticking Minimization (ISM) Method	59
Demo Mode.....	60
Mode Setting	61

SOUND & LANGUAGE CONTROL

Auto Volume Leveler	62
Clear Voice II.....	63
Preset Sound Settings-Sound Mode	64
Sound Setting Adjustment -User Mode	65
Infinite Sound	65
Balance	66
TV Speakers On/ Off Setup	67
Audio Reset.....	68
I/II	
Stereo/Dual Reception (In Analogue Mode Only)...	69
NICAM Reception	70
Speaker Sound Output Selection	70
On-Screen Menu Language Selection.....	71

CONTENTS

TIME SETTING

Clock Setup	72
Auto On/Off Time Setting	73
Sleep Timer Setting.....	74

TELETEXT

Switch On/Off	75
SIMPLE Text.....	75
TOP Text.....	75
FASTEXT	76
Special Teletext Functions	76

APPENDIX

Troubleshooting.....	77
Maintenance.....	79
Product Specifications	80
IR Codes	82
External Control Device Setup.....	83

PREPARATION

PLASMA TV Models : 42PJ5*, 42/50PJ3***, 42/50PJ6***, 42/50PJ2***, 50/60PK5***.**

ACCESSORIES

Ensure that the following accessories are included with your TV. If an accessory is missing, please contact the dealer where you purchased the TV.

Here shown may differ from your TV.

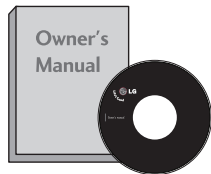

Owner's Manual

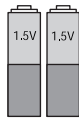

Batteries (AAA)

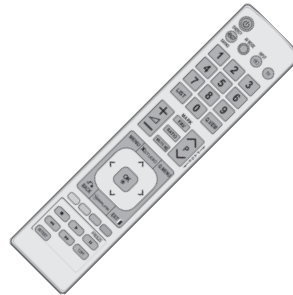

Remote Control

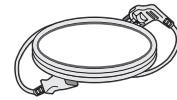

Power Cord

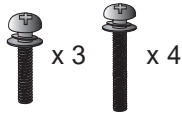

M5X14 x 3 M4X28 x 4
Bolts for stand assembly
(Except for 60PK5***)

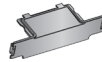

Protection Cover

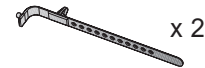

Cable Holder

Wall Mounting Bracket (Separate purchase)

AW-50PG60MS

AW-60PG60MS
(Only 60PK5***)

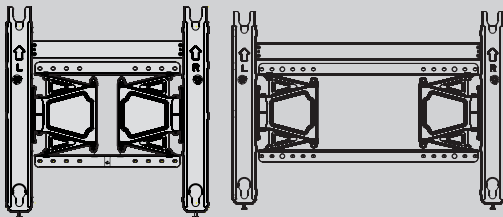

This item is not included for all models.



Polishing Cloth

Polishing cloth for use on the screen.

* Lightly wipe any stains or fingerprints on the surface of the TV with the polishing cloth.

Do not use excessive force. This may cause scratching or discolouration.

PREPARATION

FRONT PANEL CONTROLS

NOTE

The energy consumed during use can be significantly reduced if the level of brightness of the picture is reduced, and this will reduce the overall running cost.

CAUTION

Do not step on the glass stand or subject it to any impact. It may break, causing possible injury from fragments of glass, or the TV may fall. Do not drag the TV. The floor or the product may be damaged.

Image shown may differ from your TV.

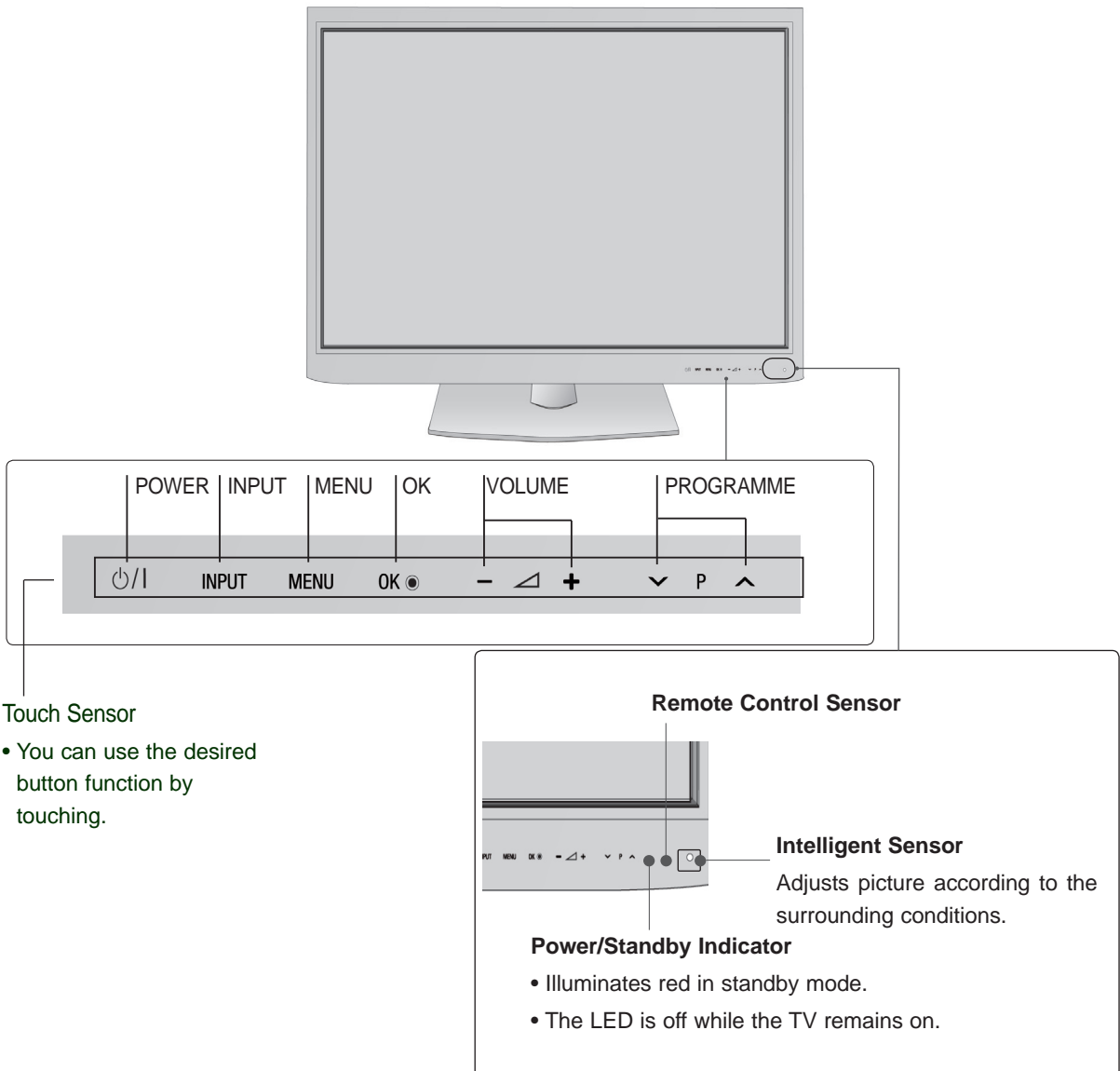

BACK PANEL INFORMATION

Image shown may differ from your TV.

42/50PJ3***, 50/60PK5***

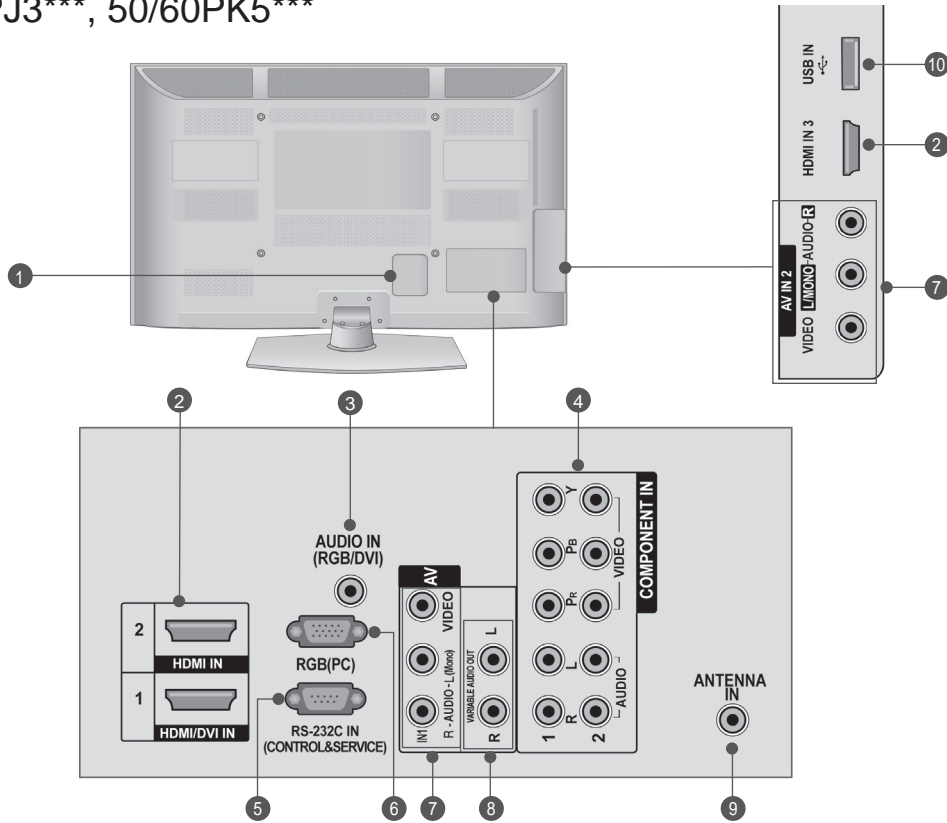

- 1 Power Cord Socket**
This TV operates on an AC power. The voltage is indicated on the Specifications page. Never attempt to operate the TV on DC power.
- 2 HDMI Input**
Connect an HDMI signal to HDMI IN.
Or DVI(VIDEO)signal to HDMI/DVI port with DVI to HDMI cable.
- 3 RGB/DVI Audio Input**
Connect the audio from a PC.
- 4 Component Input**
Connect a component video/audio device to these jacks.
- 5 RS-232C Input (CONTROL&SERVICE) Port**
Connect to the RS-232C port on a PC.
This port is used for Service or Hotel mode.
- 6 RGB Input**
Connect the output from a PC.
- 7 Audio/Video Input (AV IN1/2)**
Connect audio/video output from an external device to these jacks.
- 8 Variable Audio Output**
Connect an external amplifier or add a subwoofer to your surround sound system.
- 9 Antenna Input**
Connect RF antenna to this jack.
- 10 USB Input**
Connect USB storage device to this jack.

PREPARATION

BACK PANEL INFORMATION

Image shown may differ from your TV.

42/50PJ2***

PREPARATION

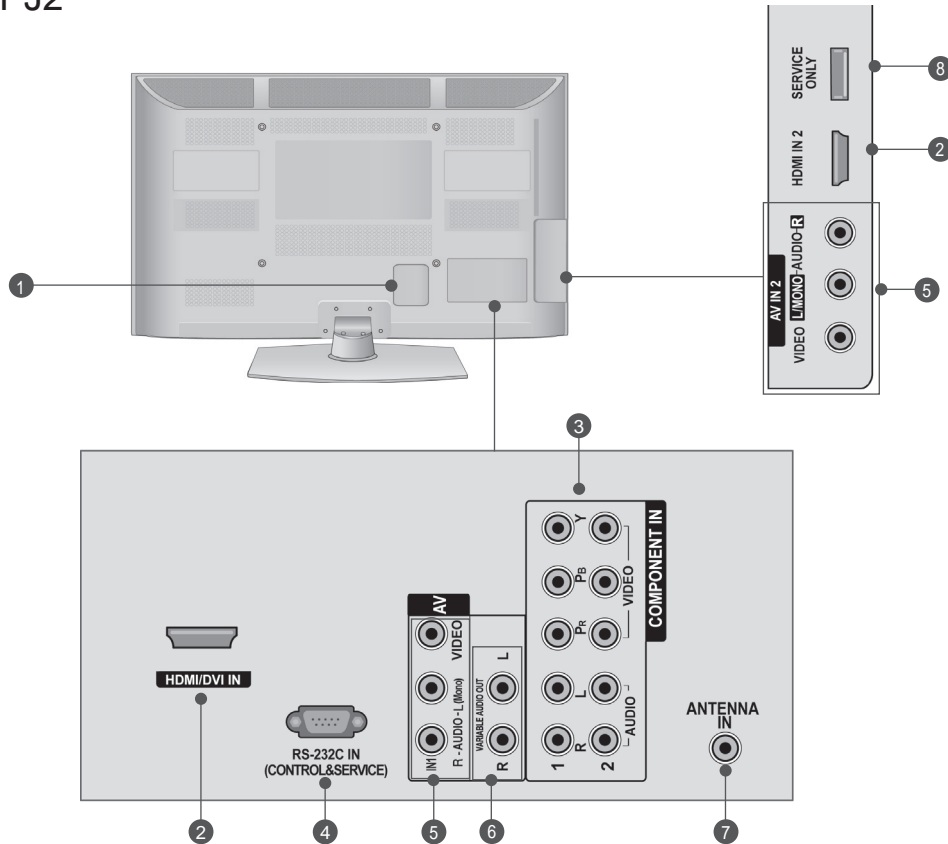

1 Power Cord Socket

This TV operates on an AC power. The voltage is indicated on the Specifications page. Never attempt to operate the TV on DC power.

2 HDMI Input

Connect an HDMI signal to HDMI IN.
Or DVI(VIDEO)signal to HDMI/DVI port with DVI to HDMI cable.

3 Component Input

Connect a component video/audio device to these jacks.

4 RS-232C Input (CONTROL&SERVICE) Port

Connect to the RS-232C port on a PC.
This port is used for Service or Hotel mode.

5 Audio/Video Input (AV IN1/2)

Connect audio/video output from an external device to these jacks.

6 Variable Audio Output

Connect an external amplifier or add a subwoofer to your surround sound system.

7 Antenna Input

Connect RF antenna to this jack.

8 SERVICE ONLY PORT

STAND INSTALLATION

Image shown may differ from your TV.

When assembling the desk type stand, check whether the bolt is fully tightened. (If not tightened fully, the product can tilt forward after the product installation.) If you tighten the bolt with excessive force, the bolt can deviate from abrasion of the tightening part of the bolt.

- 1 Carefully place the TV screen side down on a cushioned surface to protect the screen from damage.

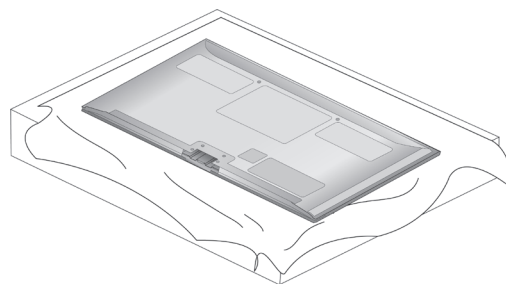

- 2 Assemble the parts of the **Stand Body** with the **Stand Base** of the TV.

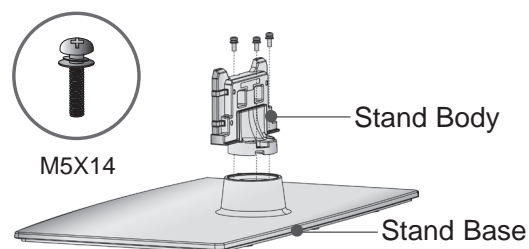

- 3 Assemble the TV as shown.

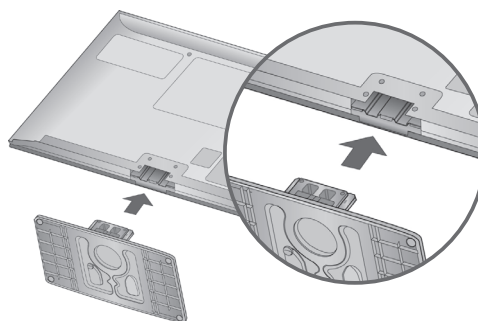

- 4 Fix the 4 bolts securely using the holes in the back of the TV.

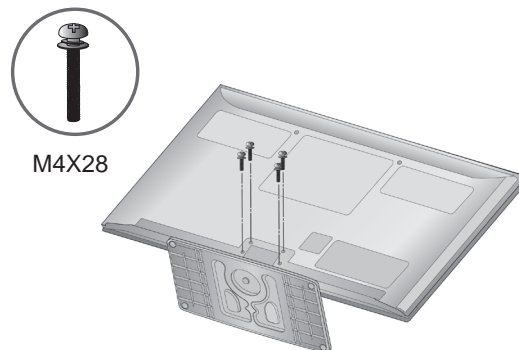

PREPARATION

CAREFUL INSTALLATION ADVICE

You should purchase necessary components to fix the TV safely and secure to the wall from the market.

Position the TV close to the wall to avoid the possibility of it falling when pushed.

The instructions shown below are a safer way to set up the TV, by fixing it to the wall, avoiding the possibility of it falling forwards if pulled. This will prevent the TV from falling forward and causing injury. This will also prevent the TV from damage. Ensure that children do not climb or hang from the TV.

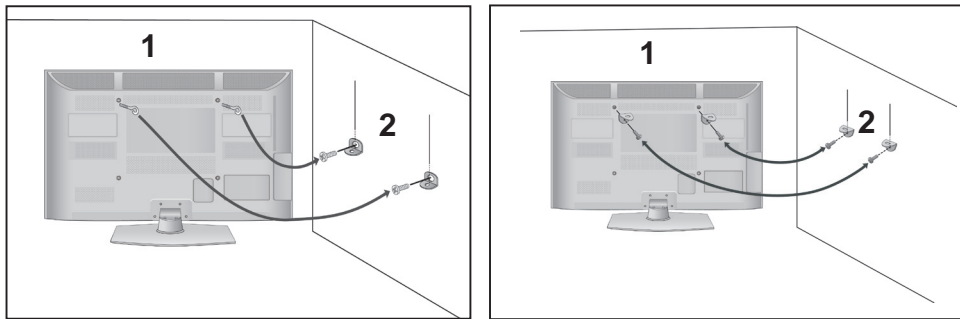

- 1 Use the eye-bolts or TV brackets/bolts to fix the product to the wall as shown in the picture. (If your TV has bolts in the eye-bolts, loosen them first.)
* Insert the eye-bolts or TV brackets/bolts and tighten them securely in the upper holes.
- 2 Secure the wall brackets with the bolts on the wall. Match the height of the bracket that is mounted on the wall.

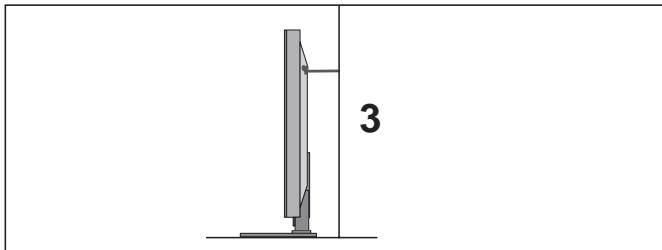

- 3 Use a sturdy rope to tie the product for alignment. It is safer to tie the rope so it becomes horizontal between the wall and the product.

! NOTE

When moving the TV undo the cords first.

Use a platform or cabinet strong and large enough to support the size and weight of the TV.

To use the TV safely make sure that the height of the bracket on the wall and on the TV is the same.

BACK COVER FOR WIRE ARRANGEMENT

Image shown may differ from your TV.

After Connecting the cables as necessary, install **Cable Holder** as shown and bundle the cables.

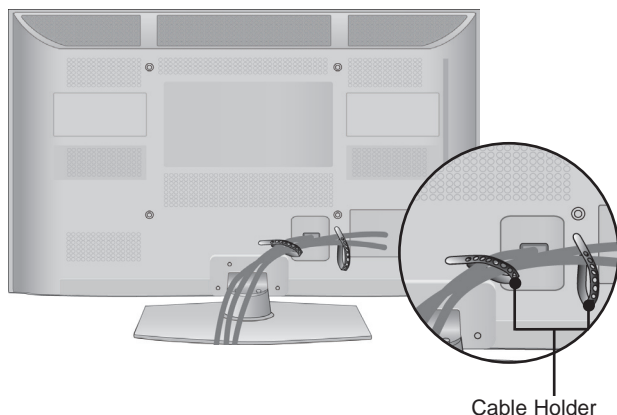

NOT USING THE DESK-TYPE STAND

Image shown may differ from your TV. When installing the wall-mounted unit, use the protection cover. Insert the **Protection cover** into the TV until clicking sound.

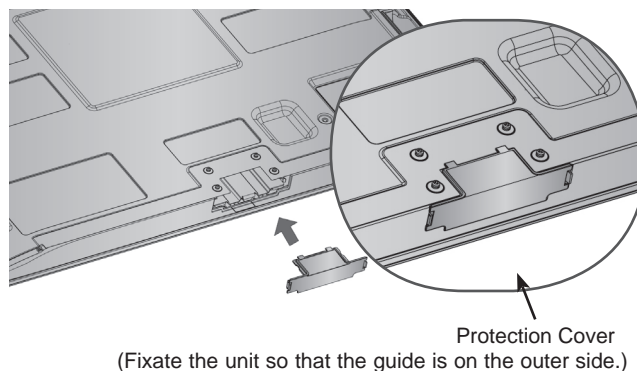

SWIVEL STAND

This feature is not available for all models.

After installing the TV, you can adjust the TV set manually to the left or right direction by 20 degrees to suit your viewing position.

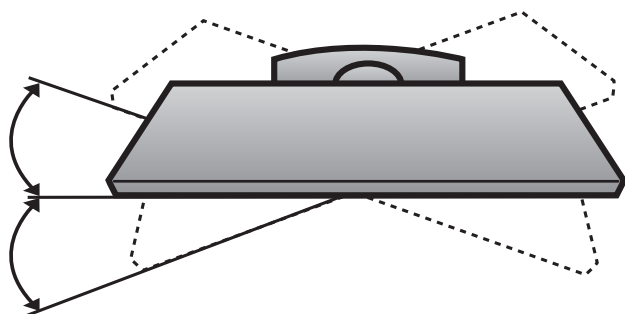

EARTHING

Ensure that you connect the earth wire to prevent possible electric shock. If grounding methods are not possible, have a qualified electrician install a separate circuit breaker.

Do not try to earth the TV by connecting it to telephone wires, lightening rods or gas pipes.

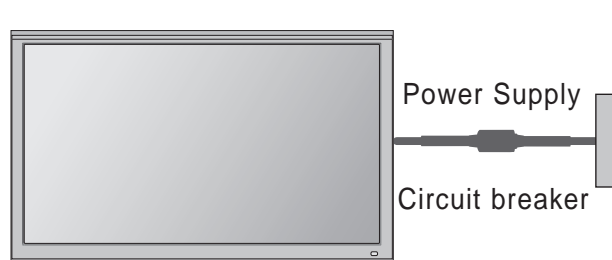

PREPARATION

The TV can be installed in various ways such as on a wall, or on a desktop etc.

The TV is designed to be mounted horizontally.

DESKTOP PEDESTAL INSTALLATION

For adequate ventilation allow a clearance of 4" (10Cm) all around the TV.

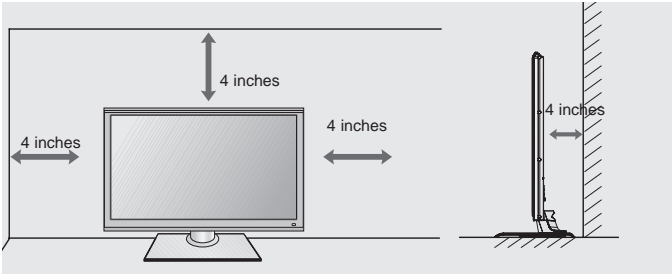

PREPARATION

WALL MOUNT : HORIZONTAL INSTALLATION

We recommend the use of a LG Brand wall mounting bracket when mounting the TV to a wall.

We recommend that you purchase a wall mounting bracket which supports VESA standard.

LG recommends that wall mounting be performed by a qualified professional installer.

NOTE

Should Install wall mount on a solid wall perpendicular to the floor.

Should use a special wall mount, if you want to install it to ceiling or slanted wall.

The surface that wall mount is to be mounted on should be of sufficient strength to support the weight of TV set; e.g. concrete, natural rock, brick and hollow block.

Installing screw type and length depends on the wall mount used. Further information, refer to the instructions included with the mount.

LG is not liable for any accidents or damage to property or TV due to incorrect installation:

- Where a non-compliant VESA wall mount is used.
- Incorrect fastening of screws to surface which may cause TV to fall and cause personal injury
- Not following the recommended Installation method.

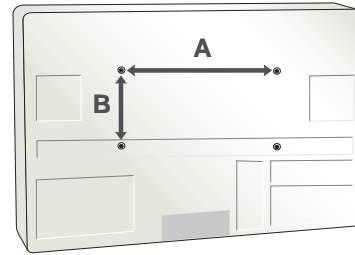

Model	VESA (A * B)	Standard Screw	Quantity
42PJ2***	400 * 400	M6	4
50PJ2***	400 * 400	M6	4
42PJ3***	400 * 400	M6	4
50PJ3***	400 * 400	M6	4
42PJ5***	400 * 400	M6	4
50PJ5***	400 * 400	M6	4
42PJ6***	400 * 400	M6	4
50PJ6***	400 * 400	M6	4
50PK5***	400 * 400	M6	4
60PK5***	200 * 100	M4	4

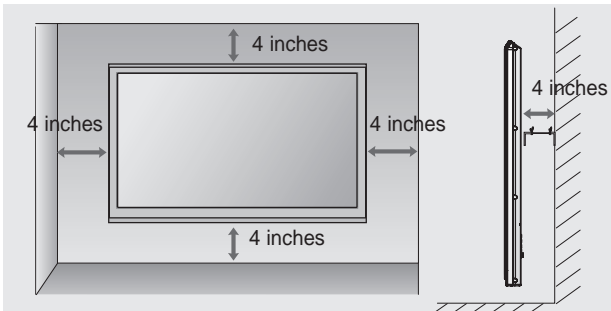

REMOTE CONTROL KEY FUNCTION

When using the remote control, aim it at the remote control sensor on the TV.



POWER Switches the TV on from standby or off to standby.

ENERGY SAVING Adjust the power saving mode of the TV.

AV MODE It helps you select and set images and sounds when connecting AV devices.(p.28)

INPUT External input mode rotate in regular sequence. Switches the TV on from standby.

TV Selects TV channel.

0~9 number button Selects a programme. Selects numbered items in a menu.

LIST Displays the programme table.

Q.VIEW Returns to the previously viewed programme.

VOLUME UP /DOWN Adjusts the volume.

MARK Check and un-check programmes in the USB menu.(Excpt for 42/50PJ2***)

FAV Displays the selected favourite programme.

RATIO Selects your desired picture format.

MUTE Switches the sound on or off.

PAGE UP/ DOWN Move from one full set of screen information to the next one.

Programme UP/DOWN Selects a programme.

Coloured buttons These buttons are used for teletext (on **TELETEXT** models only), **Programme edit**.

TELETEXT BUTTONS These buttons are used for teletext. For further details, see the 'Teletext' section.(p.75)

PREPARATION



MENU Selects a menu.
Clears all on-screen displays and returns to TV viewing from any menu.

XSTUDIO Controls the USB menu.

Q. MENU Select the desired quick menu source.(p.14)

BACK Allows the user to move return one step in an interactive application, EPG or other user interaction function.

EXIT Clears all on-screen displays and returns to TV viewing from any menu.

SIMPLINK See a list of AV devices connected to TV.
When you toggle this button, the Simplink menu appears at the screen.(p.25)

THUMBSTICK (Up/Down/Left/Right) Allows you to navigate the on-screen menus and adjust the system settings to your preference.

OK Accepts your selection or displays the current mode.

SIMPLINK / USB Menu control buttons Controls SIMPLINK or USB menu. (Excpt for 42/50PJ2***)

FREEZE Pause the present picture at the screen. (It doesn't work at USB, Simplink Mode.)
The TV returns to normal viewing automatically if no signal is received or no operation is performed for 5 minutes.

Installing Batteries

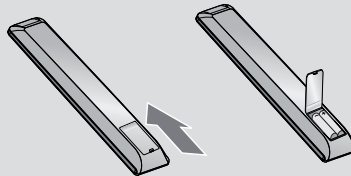

Open the battery compartment cover on the back and install the batteries matching correct polarity (+with +,-with -).
Install two 1.5V AAA batteries. Do not mix old or used batteries with new ones.

Close cover.

To remove the batteries, perform the installation a actions in reverse

EXTERNAL EQUIPMENT SETUP

To prevent damage do not connect to the mains outlet until all connections are made between the devices.

ANTENNA CONNECTION

For optimum picture quality, adjust antenna direction.
An antenna cable and converter are not supplied.

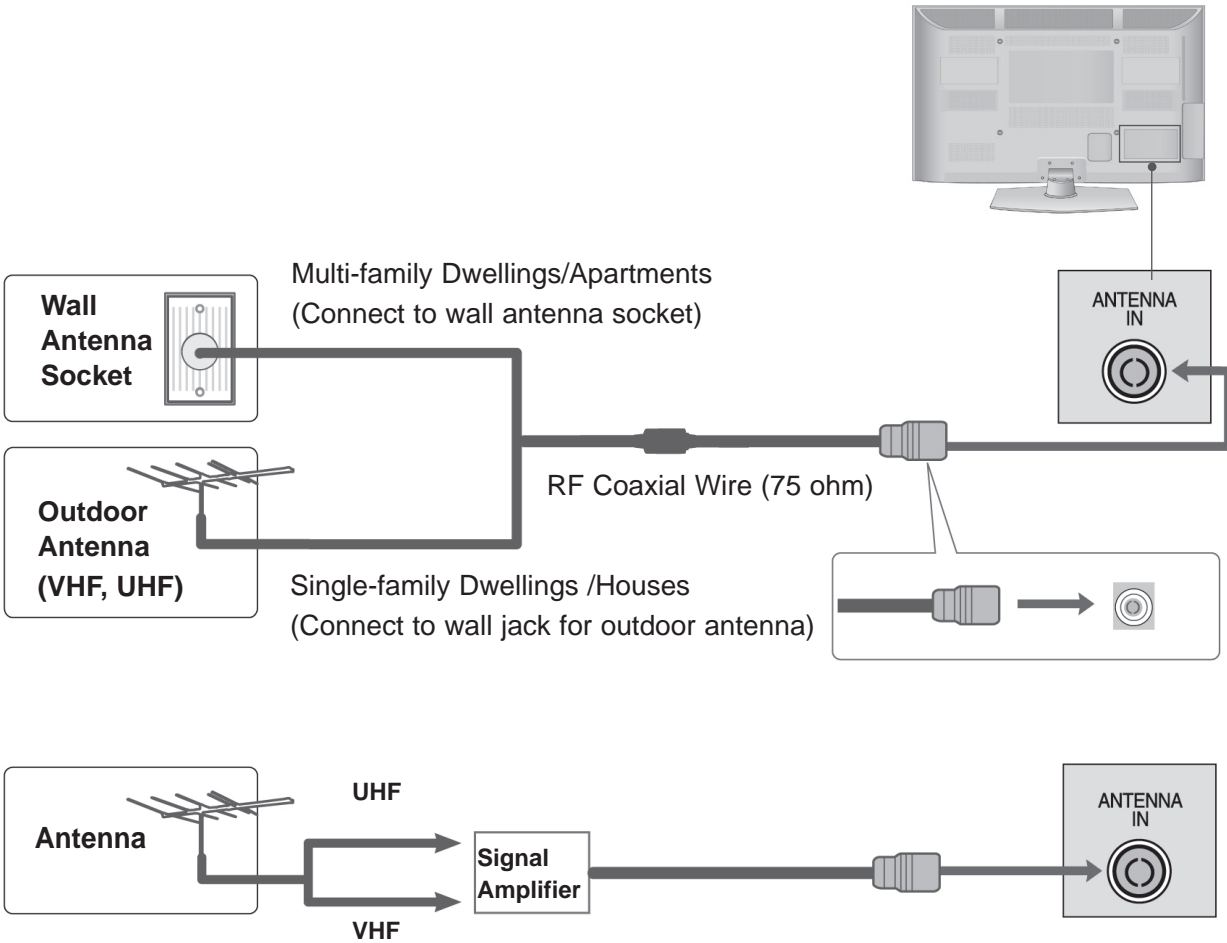

In poor signal areas, to achieve better picture quality it may be necessary to install a signal amplifier to the antenna as shown above.

If signal needs to be split for two TVs, use an antenna signal splitter for connection.

EXTERNAL EQUIPMENT SETUP

To avoid damaging any equipment, never plug in any power cord until you have finished connecting all equipment.

This section on EXTERNAL EQUIPMENT SETUP mainly uses diagrams for the 42/50PJ3*** models. Image shown may differ from your TV.

CONNECTING WITH A COMPONENT CABLE

- 1 Connect the video outputs (Y, PB, PR) of the external equipment (digital set-top box, DVD, etc.) to the **COMPONENT IN VIDEO** jacks on the TV.
- 2 Connect the audio outputs (Y, PB, PR) of the external equipment (digital set-top box, DVD, etc.) to the **COMPONENT IN AUDIO** jacks on the TV.
- 3 Turn on the external equipment. (Refer to the external equipment's manual for operating instructions.)
- 4 Select **COMPONENT 1** input source using the INPUT button on the remote control. If connected to **COMPONENT IN 2**, select **COMPONENT 2** input source.

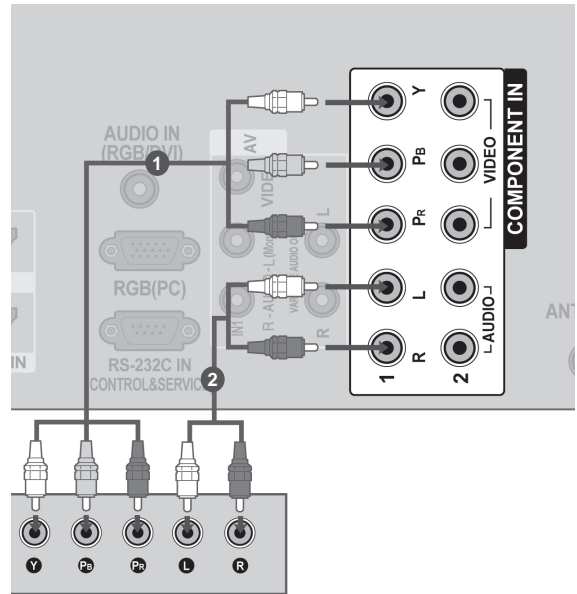

EXTERNAL EQUIPMENT SETUP

Signal	Component	HDMI
480i/576i	O	X
480p/576p	O	O
720p/1080i	O	O
1080p	O (50/60Hz only)	O (24Hz/30Hz/50Hz/60Hz)

Component Input ports

To achieve better picture quality, connect a DVD player to the component input ports as shown below.

Component ports on the TV	Y	P _B	P _R
Video output ports on DVD player	Y	P _B	P _R
	Y	B-Y	R-Y
	Y	Cb	Cr
	Y	Pb	Pr

CONNECTING WITH AN HDMI CABLE

- 1 Connect the HDMI output of the external equipment (digital set-top box, DVD, etc.) to **HDMI/DVI IN 1(DVI)**, **HDMI IN 2** or **HDMI IN 3** (Except for 42/50PJ2***) jack on the TV.
- 2 Turn on the external equipment.
- 3 Select **HDMI1**, **HDMI2** or **HDMI3** (Except for 42/50PJ2***) input source using the **INPUT** button on the remote control.

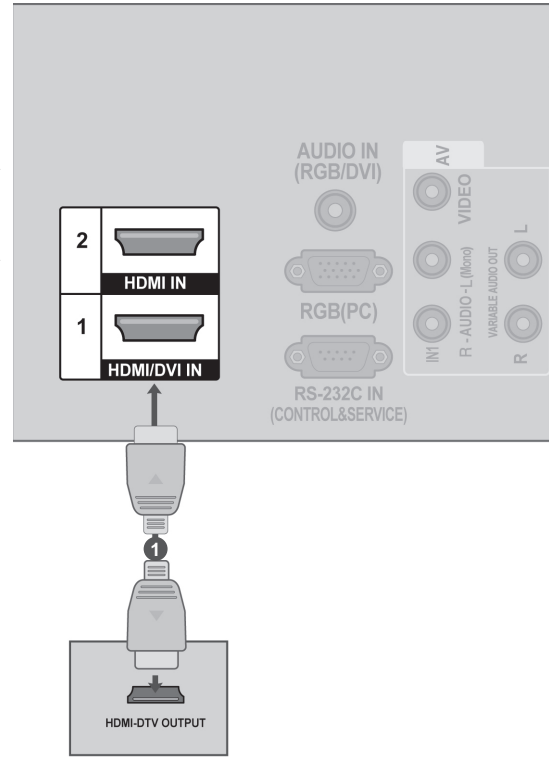

! NOTE

Check that your HDMI cable is version 1.3 or higher. If the HDMI cables don't support HDMI version 1.3, flickering or no screen display can result. Please use the latest cables that support at least HDMI version 1.3.

HDMI mode supports PCM audio format only.

Audio format was reset to Dolby/DTS/Bitstream in DVD Player or STB, it should be changed to PCM.

We recommend using under 10m of the HDMI cable. When using over the length, connect a amplifier or repeater.

If the DVD does not support Auto HDMI, you must set the output resolution appropriately.

EXTERNAL EQUIPMENT SETUP

CONNECTING WITH AN HDMI TO DVI CABLE

- 1 Connect the digital set-top box or the DVI output of the PC to **HDMI/DVI IN 1(DVI)** jack on the TV.
- 2 Connect the audio output of the digital set-top box or the PC audio output to the **AUDIO IN (RGB/DVI)** jack on the TV.
- 3 Turn on the digital set-top box or the PC and the TV.
(Refer to the digital set-top box or the PC manual for operating instructions.)
- 4 Select **HDMI1** input source using the **INPUT** button on the remote control.

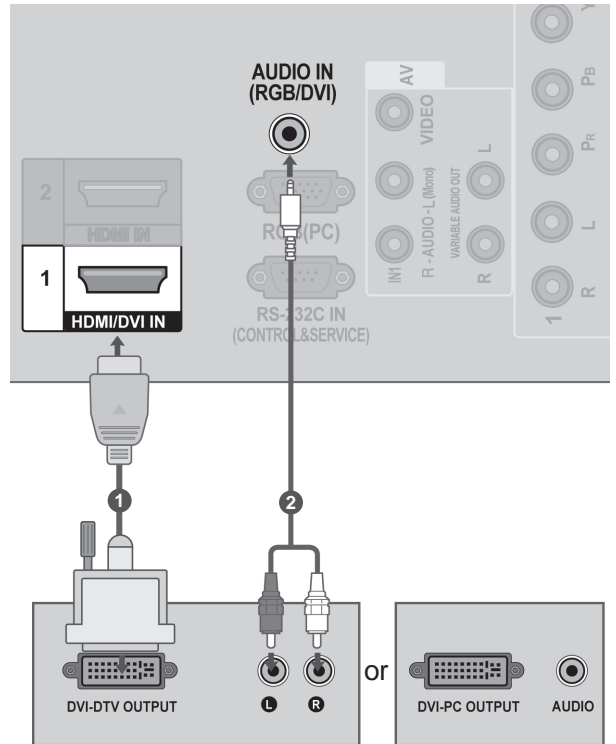

USB SETUP (Except 42/50PJ2***)

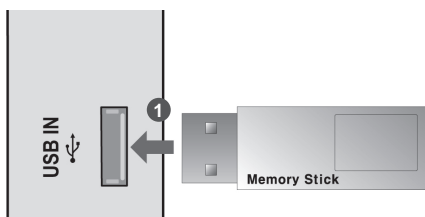

- 1 Connect the USB device to the **USB IN** jack on the TV.
- 2 After connecting the **USB IN** jack, you use the **USB** function. (p.31)

CONNECTING WITH A RCA CABLE

- 1 Connect the **AUDIO/VIDEO** jacks between TV and VCR or external equipment. Match the jack colours (Video = yellow, Audio Left = white, and Audio Right = red)
- 2 Insert a video tape into the VCR and press **PLAY** on the VCR. (Refer to the VCR owner's manual.)
Or, Operate the corresponding external equipment.
(Refer to external equipment operating guide.)
- 3 Select **AV1** input source using the **INPUT** button on the remote control.
If connected to **AV IN2**, select **AV2** input source.

! NOTE

If you have a mono VCR, connect the audio cable from the VCR to the **AUDIO L/MONO** jack of the TV.

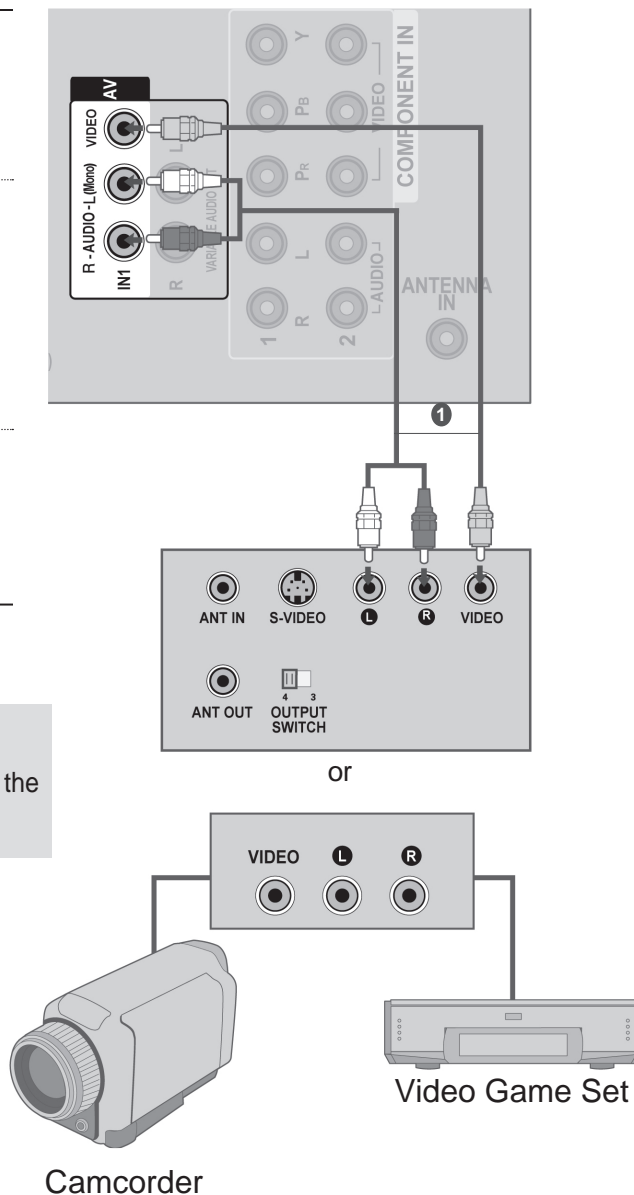

EXTERNAL EQUIPMENT SETUP

CONNECTING WITH A RF CABLE

To avoid picture noise (interference), allow adequate distance between the VCR and TV.

- 1 Connect the **ANT OUT** socket of the VCR to the **ANTENNA IN** socket on the TV.
- 2 Connect the antenna cable to the **ANT IN** socket of the VCR.
- 3 Press the **PLAY** button on the VCR and match the appropriate programme between the TV and VCR for viewing.

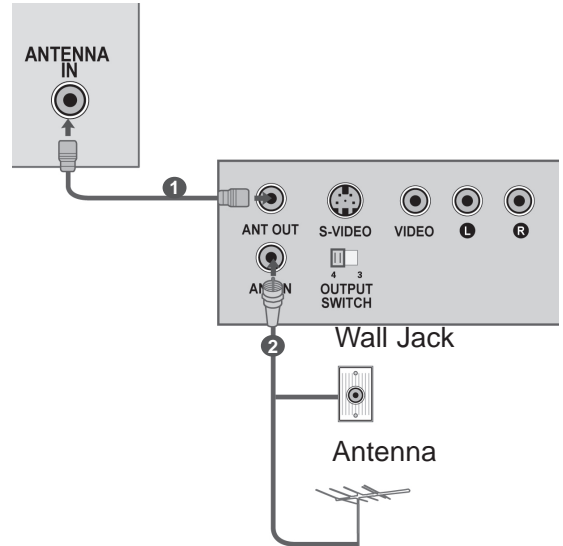

EXTERNAL STEREO SETUP

Use to connected either an external amplifier, or add a subwoofer to your surround sound system.

- 1 Connect the input jack of the stereo amplifier to the **VARIABLE AUDIO OUT** jacks on the TV.
- 2 Set up your speakers through your analog stereo amplifier, according to the instructions provided with the amplifier.

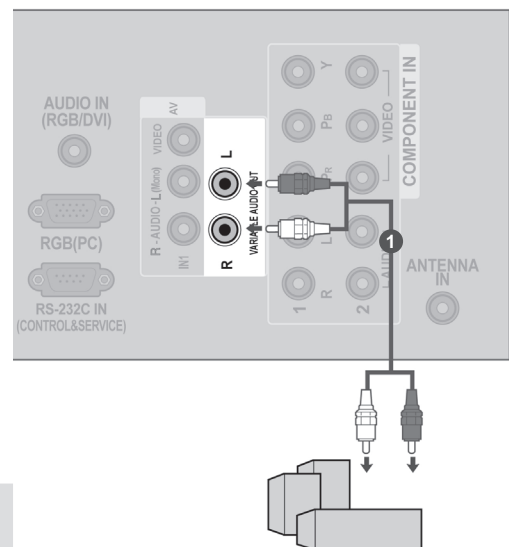

NOTE

When connecting with external audio equipments, such as amplifiers or speakers, please turn the TV speakers off. (p.67)

CONNECTING WITH A D-SUB 15 PIN CABLE

(Except 42/50PJ***)

This TV provides Plug and Play capability, meaning that the PC adjusts automatically to the TV's settings.

- 1 Connect the RGB output of the PC to the **RGB IN (PC)** jack on the TV.
- 2 Connect the PC audio output to the **AUDIO IN (RGB/DVI)** jack on the TV.
- 3 Turn on the PC and the TV.
- 4 Select **RGB** input source using the INPUT button on the remote control.

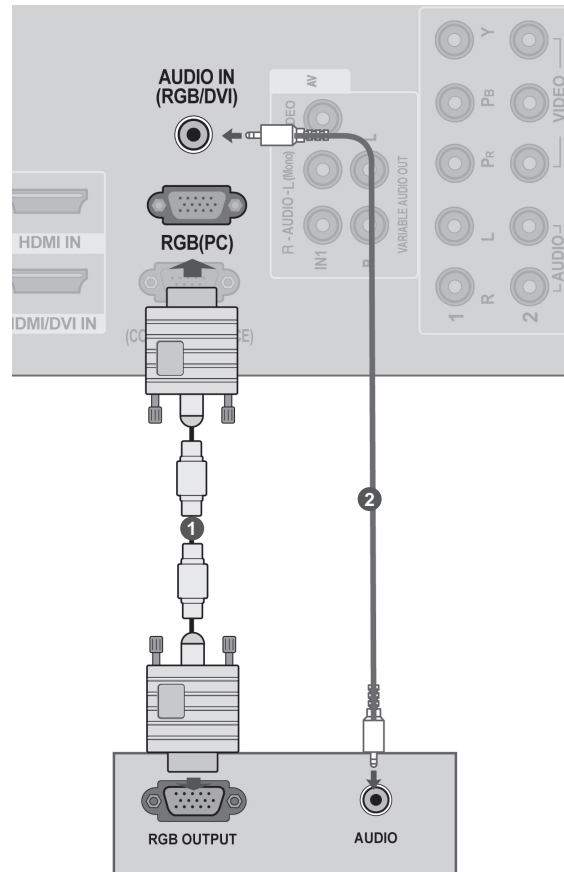

EXTERNAL EQUIPMENT SETUP

SUPPORTED DISPLAY RESOLUTION

RGB-PC mode (Except 42/50PJ***)			HDMI/DTV mode		
Resolution	Horizontal Frequency(kHz)	Vertical Frequency(Hz)	Resolution	Horizontal Frequency(kHz)	Vertical Frequency(Hz)
640x350	31.468	70.09	720x480	31.47	59.94
720x400	31.469	70.09	720x480	31.50	60.00
640x480	31.469	59.94	720x576	31.25	50.00
800x600	37.879	60.317	1280x720	44.96	59.94
1024x768	48.363	60.004	1280x720	45.00	60.00
1280x768	47.776	59.87	1280x720	37.50	50.00
1360x768	47.720	59.799	1920x1080	33.72	59.94
1280x1024	63.668	59.895	1920x1080	33.75	60.00
1920x1080	66.587	59.934	1920x1080	28.125	50.00
			1920x1080	67.432	59.94
			1920x1080	67.50	60.00
			1920x1080	56.25	50.00
			1920x1080	27.00	24.00
			1920x1080	33.75	30.00

Only 50/60PK5***, 50PK7***, 50/60PK9***

Only 50PJ2***, 50PJ3***, 50PJ6***, 50/60PK5***, 50PK7***, 50/60PK9***

NOTE

Avoid keeping a fixed image on the TV's screen for prolonged periods of time. The fixed image may become permanently imprinted on the screen; use a screen saver when possible.

There may be interference relating to resolution, vertical pattern, contrast or brightness in PC mode. Change the PC mode to another resolution or change the refresh rate to another rate or adjust the brightness and contrast on the menu until the picture is clear. If the refresh rate of the PC graphic card can not be changed, change the PC graphic card or consult the manufacturer of the PC graphic card.

The synchronization input waveform for Horizontal and Vertical frequencies are separate.

We recommend using 1920x1080, 60Hz (Only 50/60PK5***, 50PK7***, 50/60PK9***) 1360x768 (Only 50PJ2***, 50PJ3***, 50PJ6***, 50/60PK5***, 50PK7***, 50/60PK9***) for the PC mode, this should provide the best picture quality.

If the resolution of PC is over SXGA, there will be no picture on the TV. (Only HD Models)

Connect the audio cable from the PC to the Audio input on the TV. (Audio cables are not included with the TV).

you use too long an RGB-PC cable, there may be interference on the screen. We recommend using under 5m of the cable. This provides the best picture quality.







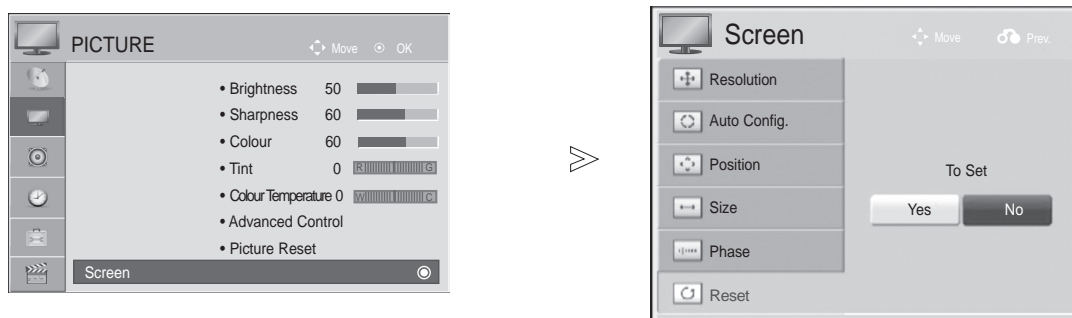

SCREEN SETUP FOR PC MODE (Except 42/50PJ***)

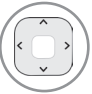
SCREEN RESET

Returns Position, Size and Phase to the factory default settings.

This function works in the following mode: Component(Except 480i, 576i), RGB.



- 1   Select **PICTURE**.
- 2   Select **Screen**.
- 3   Select **Reset**.
- 4   Select **Yes**.
- 5  Run **Reset**.

- Press the **MENU/EXIT** button to return to normal TV viewing.
- Press the **BACK** button to move to the previous menu screen.

EXTERNAL EQUIPMENT SETUP

AUTO CONFIGURE (RGB [PC] MODE ONLY)

Automatically adjust the picture position and minimizes image instability. After adjustment, if the image is still not correct, your TV is functioning properly but needs further adjustment.

Auto configure

This function is for automatic adjustment of the screen position, size and phase. The displayed image will be unstable for a few seconds while the auto configuration is in progress.

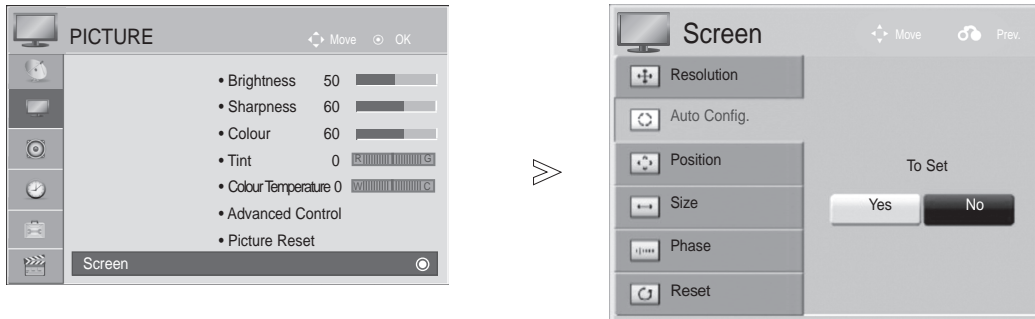

1. Select **PICTURE**.
2. Select **Screen**.
3. Select **Auto Config..**
4. Select **Yes**.
5. Run **Auto Config..**

- If the position of the image is still not correct, try Auto adjustment again.
- If picture needs to be adjusted again after Auto adjustment in RGB (PC), you can adjust the **Position, Size or Phase**.







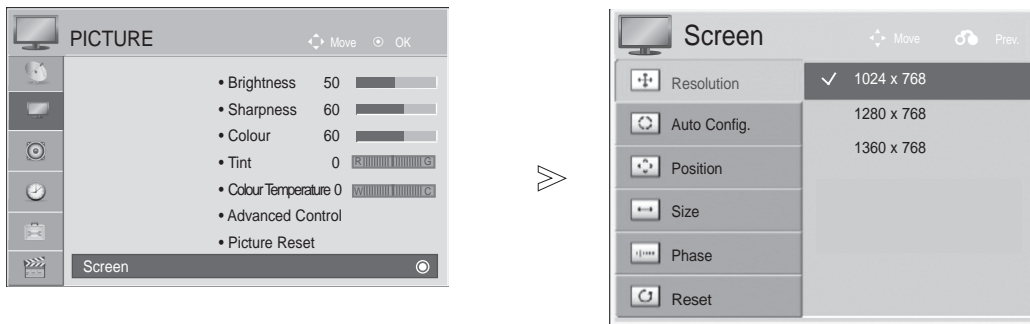

- Press the **MENU/EXIT** button to return to normal TV viewing.
- Press the **BACK** button to move to the previous menu screen.

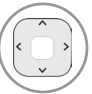
SELECTING RESOLUTION

To view a normal picture, match the resolution of RGB mode at TV and selection at PC.

This function works in the following mode: RGB[PC] (1024x768, 1280x768, 1360x768)

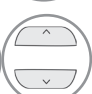

- 1   Select **PICTURE**.
- 2   Select **Screen**.
- 3   Select **Resolution**.
- 4   Select the desired resolution.
- 5 

- Press the **MENU/EXIT** button to return to normal TV viewing.
- Press the **BACK** button to move to the previous menu screen.

EXTERNAL EQUIPMENT SETUP







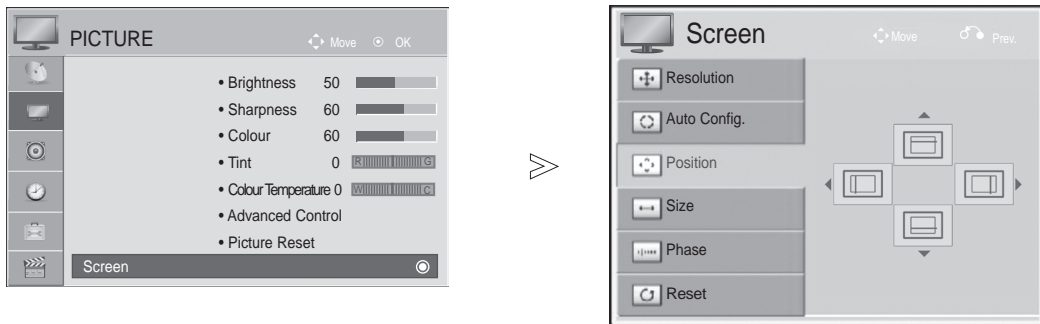

ADJUSTMENT FOR SCREEN POSITION, SIZE, PHASE

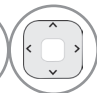
If the picture is not clear after auto adjustment and especially if characters are still trembling, adjust the picture phase manually.

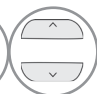
Position operates in Component(except 480i, 576i), RGB mode.

Size, Phase operate only in RGB mode.



- 1   Select **PICTURE**.
- 2   Select **Screen**.
- 3   Select **Position, Size or Phase**.
- 4    Make appropriate adjustments.
- 5 

- Press the **MENU/EXIT** button to return to normal TV viewing.
- Press the **BACK** button to move to the previous menu screen.

WATCHING TV / PROGRAMME CONTROL

TURNING ON THE TV

- When your TV is turned on, you will be able to use its features.

-
- 1 Firstly, connect the power cord correctly.
At this stage, the TV switches to standby mode.
 - 2 In standby mode to turn TV on, press the \odot / I, **INPUT** or **P** button on the TV or press the **POWER**, **INPUT**, **P** or **NUMBER** button on the remote control and the TV will switch on.
-

INITIALIZING SETUP

-
- 1 If the OSD (On Screen Display) is displayed on the screen after turning on the TV, you can adjust the **Language**, **Mode Setting**, **Auto Tuning**.

Note:

- a. If you close without completing the initial setting, the Initial Setting menu can be displayed again.
 - b. "Store Demo" mode is only for shop display and not for general customer use.
 - c. "Home Use" mode is the optimal setting for home environments, and is the TV's default mode.
 - d. "Store Demo" mode is the optimal setting for store environments. If a user modifies image quality data, "Store Demo" mode initializes the product to the image quality set by us after a certain period of time.
 - e. The mode (Home Use, Store Demo) can be changed by executing Mode Setting in the OPTION menu.
-

PROGRAMME SELECTION

-
- 1 Press the **P** or **NUMBER** buttons to select a programme number.
-

VOLUME ADJUSTMENT

-
- 1 Press the \triangle + or - button to adjust the volume.

.....
If you wish to switch the sound off, press the MUTE button.

.....
You can cancel this function by pressing the MUTE, \triangle + , - or AV Mode button.
