



ENGLISH

OWNER'S MANUAL

DIGITAL SIGNAGE MEDIA PLAYER

Please read this manual carefully before operating your set and retain it for future reference.

DIGITAL SIGNAGE MEDIA PLAYER
NC1000
NC2000

www.lg.com

CONTENTS

NC1000

Specifications	4
General Specifications	4
Multi I/O port.....	4
Operational Specifications	4
Included in the Box.....	5
Basic Components	5
Optional items	5
Connections	6
Back Panel.....	6
Installing	7
In/Out Cable Connection.....	9
Connecting a Monitor with D-SUB Cable	9
Connecting a Monitor with an HDMI Cable	12
Connecting/Disconnecting HDMI in Windows	14
Connection to Multiple Monitors	15

NC2000

Specifications	16
General Specifications	16
Multi I/O port.....	16
Operational Specifications	16
Included in the Box.....	17
Basic Components	17
Connections	18
Back Panel.....	18
Installing	19

Specifications

Attention

- Product specifications may change without prior notice to improve performance.

General Specifications

Dimensions	250 mm (W) x 220 mm (H) x 45 mm (D) (only Set)																							
Weight	1.321 kg (only Set)																							
CPU	Intel ATOM Processor 330 1.6 GHz(Dual Core), FSB 533 MHz																							
Chip Set	Nvidia MCP7A-I ON																							
Main Memory	DDR3 1066 SODIMM type 1 GB, 2 GB																							
Secondary Storage Device	SATA SSD 8 GB, 16 GB, 32 GB		<table border="1"> <thead> <tr> <th colspan="2"></th> <th colspan="3">SSD</th> </tr> <tr> <th colspan="2"></th> <th>8G</th> <th>16G</th> <th>32G</th> </tr> </thead> <tbody> <tr> <th rowspan="2">DDR</th> <th>1GB</th> <td>NC1000-BAAA</td> <td>NC1000-CAAA</td> <td>NC1000-DAAA</td> </tr> <tr> <th>2GB</th> <td>NC1000-BABA</td> <td>NC1000-CABA</td> <td>NC1000-DABA</td> </tr> </tbody> </table>					SSD					8G	16G	32G	DDR	1GB	NC1000-BAAA	NC1000-CAAA	NC1000-DAAA	2GB	NC1000-BABA	NC1000-CABA	NC1000-DABA
		SSD																						
		8G	16G	32G																				
DDR	1GB	NC1000-BAAA	NC1000-CAAA	NC1000-DAAA																				
	2GB	NC1000-BABA	NC1000-CABA	NC1000-DABA																				
O/S	Windows Embedded Standard																							

Multi I/O port

Serial Port	One external RS-232 Serial port
USB Port	Hi-Speed USB 2.0 port 480 Mbps rate (x5)
LAN Port	Realtek RTL8103E 10/100 Mbps Ethernet controller
VGA / HDMI	Nvidia MCP7A-ION integrated Graphic chipset
4-in-1 Card	Secure Digital (SD) / MultiMedia Card (MMC/MMC4.0) / Memory Stick (MS/MS-Pro) / xD Memory Card
PCI Express Card Slot	Supported
LINE OUT	Supported
SPDIF (Digital Audio Out)	5.1 Channel Supported (depend on source signal)

Operational Specifications

Resolution	Maximum Resolution	1920 x 1080 @ 60 Hz		
	Recommended Resolution	1920 x 1080 @ 60 Hz		
Power	Rated Voltage	AC 100-240 V~, 50 / 60 Hz, 1.2 A		
Sound Output Wattage	RMS Audio Output 10 W + 10 W (R + L) : When connected to the monitor (model name : M4224C)			
Operating Condition		Sync (H/V)	Video	LED
	Normal Mode	On/On	Active	On
	Deep Sleep Mode (Set = Off)	Off/Off	Off	Off
Operating Conditions	Operating Conditions	Temperature	5 °C to 35 °C	Humidity 10 % to 80 %
	Storage Conditions	Temperature	-20 °C to 60 °C	Humidity 5 % to 95 %

Included in the Box

Basic Components

The NC1000 consists of the following components. Please check that these components have been included prior to installation.

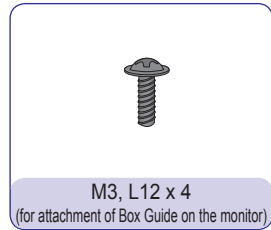
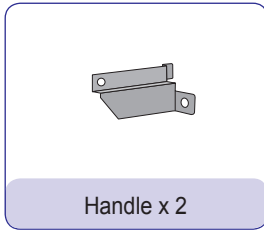
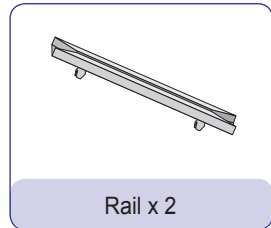
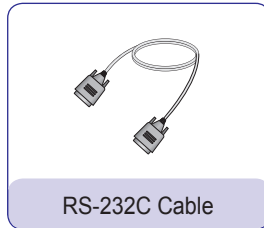
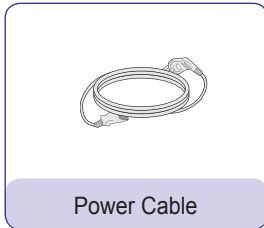
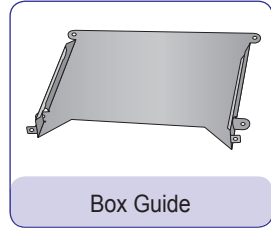
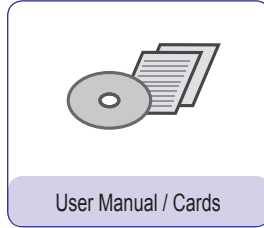
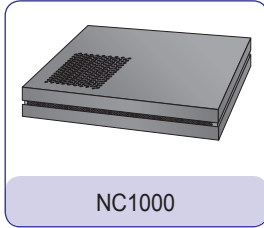

NC1000

Attention

- These illustrations may differ from your product. Some of these are subject to change.

Optional items

The following items are supported by the NC1000, but are not provided with the product.

Please purchase optional items as needed.

- HDMI cable, D-SUB cable, LINE-OUT cable, fiber optic cable, LAN cable, mouse, keyboard.

Connections

Back Panel

NC1000

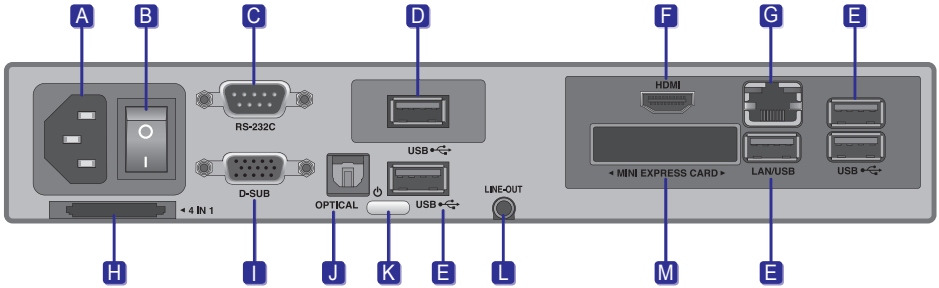

Number	Connection	Description
A	Power Cable In	For the power cable.
B	Power Switch	Provides power to the NC1000
C	RS-232C Out	For the RS-232C cable.
D	USB Wireless Modem In	For a USB-type wireless modem.
E	USB In	For USB-type devices, including memory, hard disk, CD-ROM, keyboard, and mouse.
F	HDMI Out	For an HDMI-compatible monitor.
G	LAN Connector	For a LAN cable.
H	4 IN 1 Multi-Card Slot	Accommodates memory cards for storing video or reading images. Supported cards include Secure Digital (SD), MultiMedia (MMC/MMC4.0), Memory Stick (MS/MS-Pro), and xD Memory Cards.
I	D-SUB Out	For the monitor's RGB video in.
J	OPTICAL Out	For an optical cable for digital audio transfer.
K	NC1000 Power Button	Turns NC1000 on.
L	LINE-OUT Connector	For a LINE-OUT cable for analog audio transfer.
M	PCI MINI EXPRESS Card Slot	Provided for PCI Mini Express Cards.

Installing

We recommend you to use the items provided with your NC1000 and follow our instructions for integrating the product with your monitor in order to ensure the correct results.

⚠ Attention

- The monitor illustrations shown are to guide your integration they may differ from your product.

- 1 Place the handle into the slots on the side of the product.

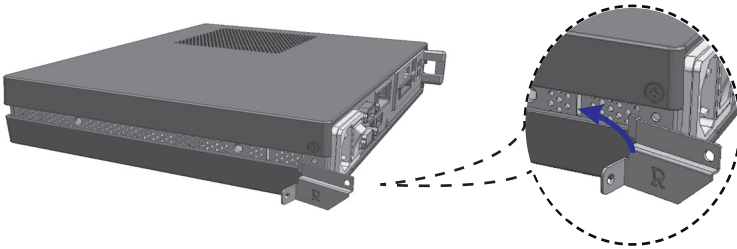

- 2 Use screws to secure the handle.

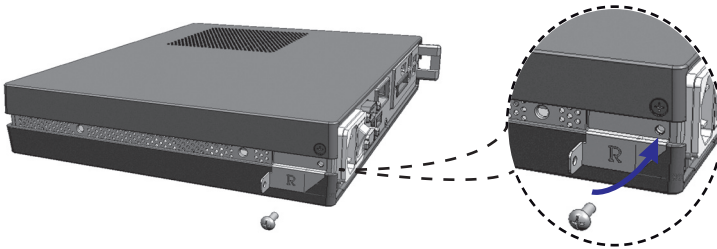

- 3 Place the rail in the slots on the side of the product.

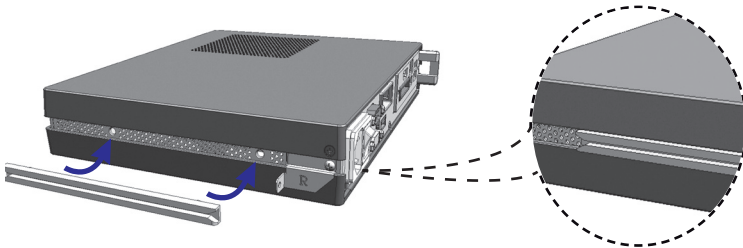

⚠ Warning

- Be careful of sharp edges on the rail and the handle.

4 As shown below, use screws to secure the Box Guide in the four slots at the back of the monitor.

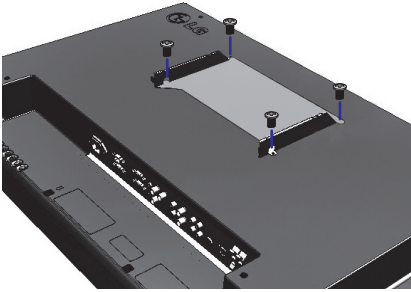

5 Attach the Box Guide to the rail slots, and press it upward.

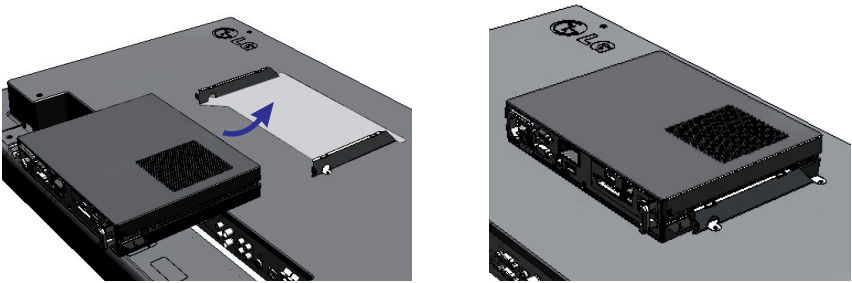

6 Use screws to secure the player and the Box Guide as shown below.

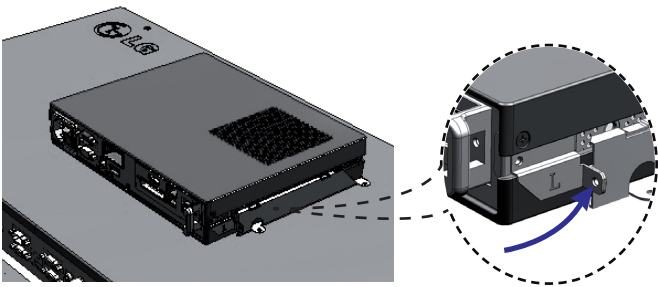

In/Out Cable Connection

In order to watch video through a monitor, you need to use a D-SUB cable or HDMI cable to connect NC1000 to a monitor.

Attention

- D-SUB, HDMI, LINE-OUT, OPTICAL, and LAN cables are not included with the NC1000. If the cables were not provided with your monitor, you may need to purchase them separately.
- After all required cables are connected, configure SET ID to 1 for the first monitor connected to the NC1000. The SET ID for one of the connected monitors should be configured to 1.
- To configure the SET ID, please refer to the owner’s manual for your monitor.
- Monitors used with NC1000 should support LG RS-232C protocols. The brightness, resolution, sound, and other features of an LG RS-232C protocol-enabled monitor can be controlled by SuperSign Manager software.

NC1000

Note

- A SET ID is a reference number for the monitor that can be set to the user’s preference. The monitor SET ID is used by the SuperSign Manager software to identify monitors.

Connecting a Monitor with D-SUB Cable

Attention

- A D-SUB cable connection does not include an audio signal. For audio, you need to connect a LINE-OUT or OPTICAL cable.

Note

- D-SUB cables are also known as RGB cables.

1 Connect the appropriate power cables to a monitor and NC1000 respectively.

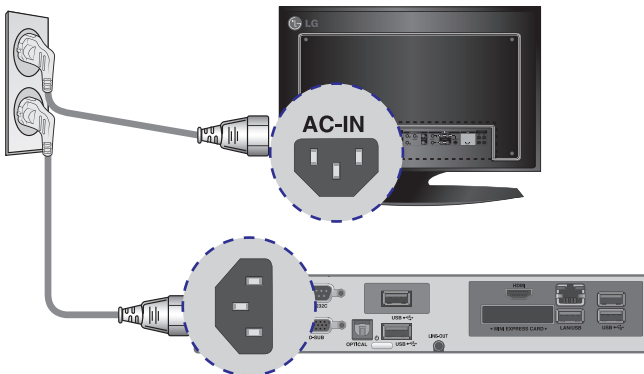

In/Out Cable Connection

- 2 Connect the D-SUB port of NC1000 and RGB-IN port of the monitor with a D-SUB cable.

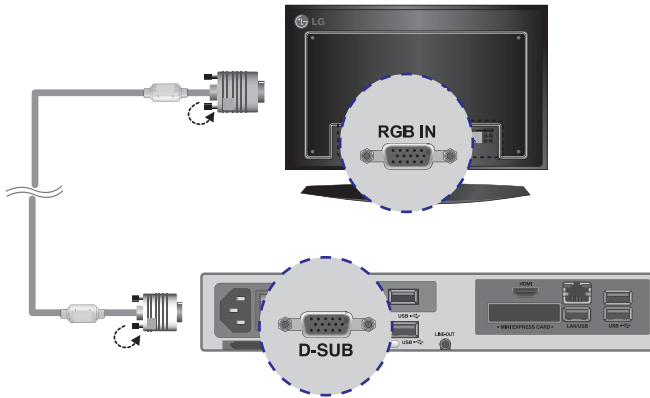

- 3 Connect NC1000 (OUT) to the monitor (IN) with an RS-232C cable.

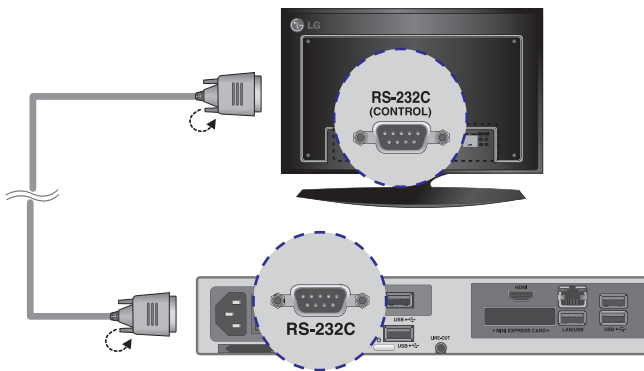

In/Out Cable Connection

4 Connect the NC1000 to the monitor with a LINE-OUT cable.

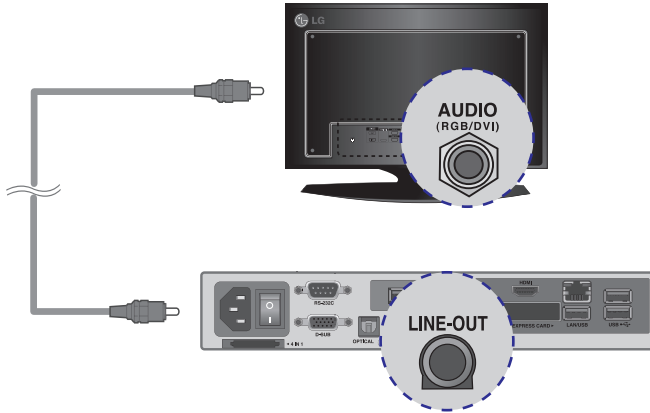

5 Connect a LAN cable to the NC1000

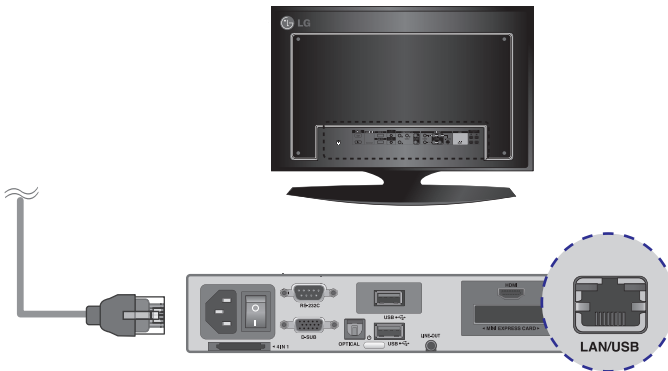

In/Out Cable Connection

Connecting a Monitor with an HDMI Cable

HDMI connections allow digital video and audio signals to be transferred with one cable. HDMI cable connections do not require an additional audio in cable.

Note

- In and Out signals are not differentiated when using HDMI cables.

Attention

- The monitor to connect with NC1000 should have the HDMI in for the HDMI connection.
- To use the HDMI device, you need to activate the HDMI device in Microsoft Windows Embedded Standard, the operating system of the NC1000. The procedures for activating and deactivating HDMI devices are described below.

NC1000

1 Connect the appropriate power cables to a monitor and NC1000 respectively.

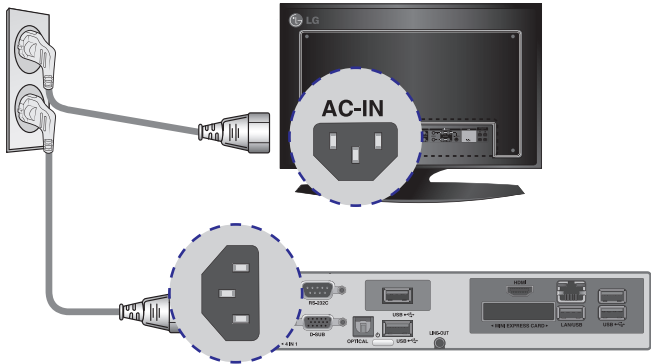

2 Connect NC1000 to a monitor with an HDMI cable.

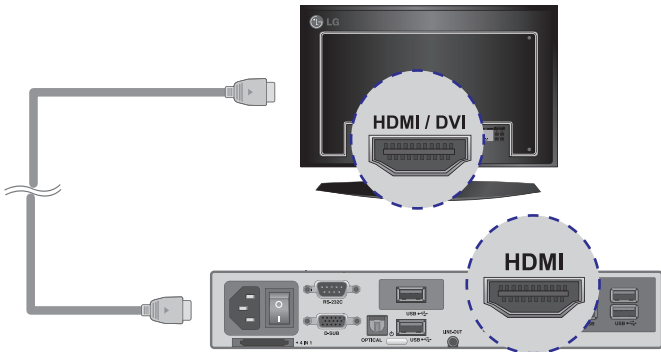

In/Out Cable Connection

3 Connect NC1000 (OUT) to the monitor (IN) with an RS-232C cable.

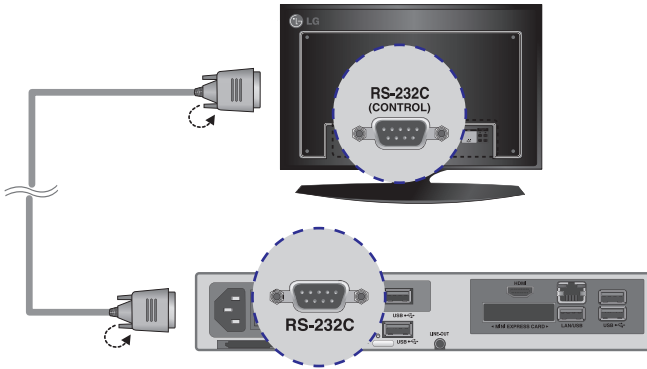

4 Connect a LAN cable to NC1000.

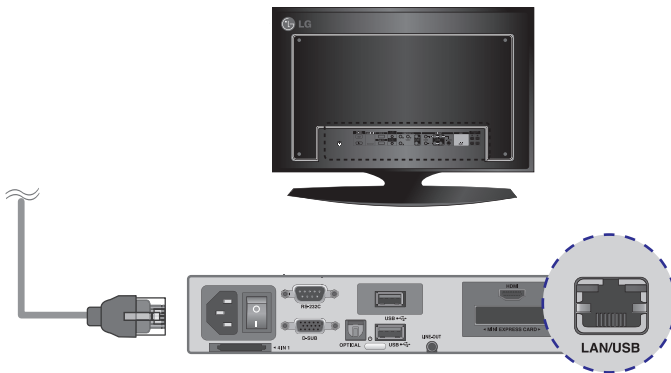

Connecting/Disconnecting HDMI in Windows

Connecting HDMI

Move to the desktop of the monitor connected to the NC1000.

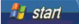
- 1 Click the  button in the lower left of the screen.
- 2 Select **Start > Control Panel > Sounds and Audio Devices > Audio**.
- 3 Select **Play Sounds > NVIDIA High Definition Audio from the list** and click **OK**.

Disconnecting HDMI

Move to the desktop of the monitor connected to the NC1000.

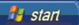
- 1 Click the  button in the lower left of the screen.
- 2 Select **Start > Control Panel > Sounds and Audio Devices > Audio**.
- 3 Select **Play Sounds > Realtek HD Audio output from the list** and click **OK**.

Attention

- If you do not reset after disconnecting the HDMI cable from the NC1000, the sound will not work.
- In order for the sound to work properly, stop playing the content and restart the NC1000.

Connection to Multiple Monitors

Each NC1000 can accommodate up to 25 monitors for video playback.
 You can connect it to several monitors in Tile Mode.

- 1 Connect the NC1000's **D-SUB OUT** to the **D-SUB IN** of the first monitor, which has **SET ID = 1**
- 2 Connect other monitors with **D-SUB** cables as shown below (**IN/OUT** separated).



- 3 Connect the NC1000's **RS-232C OUT** to the **RS-232C IN** of the first monitor, which has **SET ID = 1**.
- 4 Connect other monitors with RS-232C cables as shown below (**IN/OUT** separated).



Attention

- You may want to purchase additional RS-232C cables to use several monitors together.
- You cannot use multiple monitors with the HDMI cable.

Specifications

Attention

- Product specifications may change without prior notice to improve performance.

General Specifications

NC2000

Dimensions	99.8 mm (W) x 183.3 mm (H) x 28.4 mm (D) (only Set)			
Weight	0.215 kg (only Set)			
CPU	Intel ATOM Processor 330 1.6 GHz(Dual Core), FSB 533 MHz			
Chip Set	Nvidia MCP7A-I ON			
Main Memory	DDR3 1066 SODIMM type 1 GB, 2 GB			
Secondary Storage Device	SATA SSD 8 GB, 16 GB, 32 GB			
O/S	Windows Embedded Standard			

		SSD		
		8G	16G	32G
DDR	1GB	NC2000-BAAA	NC2000-CAAA	NC2000-DAAA
	2GB	NC2000-BABA	NC2000-CABA	NC2000-DABA

Multi I/O port

Serial Port	N/A
USB Port	Hi-Speed USB 2.0 port 480 Mbps rate (x3)
LAN Port	Realtek RTL8103E 10/100 Mbps Ethernet controller
VGA / HDMI	Nvidia MCP7A-I ON integrated Graphic chipset
4-in-1 Card	N/A
PCI Express Card Slot	Supported
LINE OUT	N/A
SPDIF (Digital Audio Out)	N/A

Operational Specifications

Resolution	Maximum Resolution	1920 x 1080 @ 60 Hz			
	Recommended Resolution	1920 x 1080 @ 60 Hz			
Power	Rated Voltage	DC 12 V / 3.5 A			
Sound Output Wattage	N/A				
Operating Condition		Sync (H/V)	Video	LED	
	Normal Mode	On/On	Active	On	
	Deep Sleep Mode (Set = Off)	Off/Off	Off	Off	
Operating Conditions	Operating Conditions	Temperature	5 °C to 35 °C	Humidity	10 % to 80 %
	Storage Conditions	Temperature	-20 °C to 60 °C	Humidity	5 % to 95 %

Included in the Box

Basic Components

The NC2000 consists of the following components. Please check that these components have been included prior to installation.

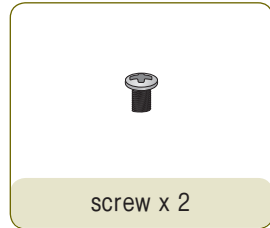
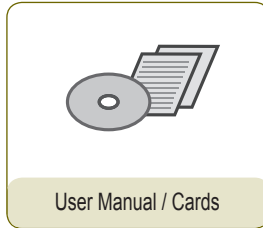
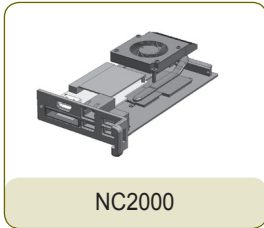

Attention

- These illustrations may differ from your product. Some of these are subject to change.

Connections

Back Panel

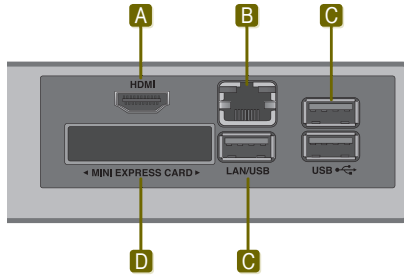

Number	Connection	Description
A	HDMI Out	For an HDMI-compatible monitor.
B	LAN Connector	For a LAN cable.
C	USB In	For USB-type devices, including memory, hard disk, CD-ROM, keyboard, and mouse.
D	PCI MINI EXPRESS Card Slot	Provided for PCI Mini Express Cards.

Installing

We recommend you to use the items provided with your NC2000 and follow our instructions for integrating the product with your monitor in order to ensure the correct results.

⚠ Attention

- The monitor illustrations shown are to guide your integration they may differ from your product.

- 1 Remove the screw and Metal cover.

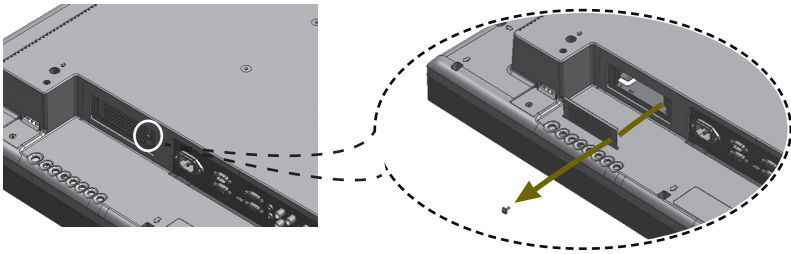

- 2 Attach the Box Guide to the rail slots, and press it upward.

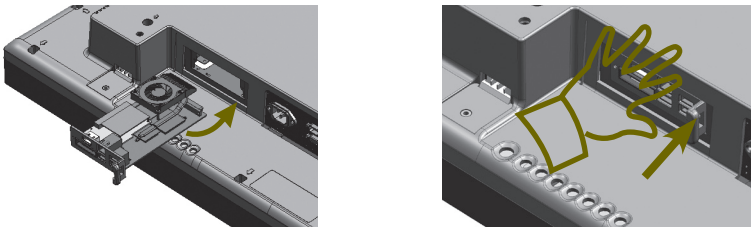

📌 Note

- If card does not become fully inserted into the insertion direction.
Hit by hand carefully to make fully connected.

- 3 Use screws to secure the player and the Box Guide as shown below.

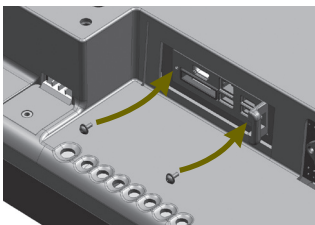



Make sure to read the Safety Precautions before using the product.

Keep the Owner's Manual(CD) in an accessible place for future reference.

The model and serial number of the SET is located on the back and one side of the SET. Record it below should you ever need service.

MODEL _____

SERIAL _____

WARNING - This is a class A product. In a domestic environment this product may cause radio interference in which case the user may be required to take adequate measures.

Temporary noise is normal when powering ON or OFF this device.