



## OWNER'S MANUAL

# Mini Hi-Fi System

Please read this manual carefully before operating your set and retain it for future reference.

### MODEL

MDS715 (MDS715, MDS715V/S/C/W)

P/NO : MFL63284656

Reg. No. I.3.LG1.00905.0411

# 1 Safety Information



**CAUTION:** TO REDUCE THE RISK OF ELECTRIC SHOCK DO NOT REMOVE COVER (OR BACK) NO USER-SERVICEABLE PARTS INSIDE REFER SERVICING TO QUALIFIED SERVICE PERSONNEL.



This lightning flash with arrowhead symbol within an equilateral triangle is intended to alert the user to the presence of uninsulated dangerous voltage within the product's enclosure that may be of sufficient magnitude to constitute a risk of electric shock to persons.



The exclamation point within an equilateral triangle is intended to alert the user to the presence of important operating and maintenance (servicing) instructions in the literature accompanying the product.

**WARNING:** TO PREVENT FIRE OR ELECTRIC SHOCK HAZARD, DO NOT EXPOSE THIS PRODUCT TO RAIN OR MOISTURE.

**WARNING:** Do not install this equipment in a confined space such as a book case or similar unit.

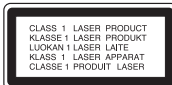

**CAUTION:** This product employs a Laser System. To ensure proper use of this product, please read this owner's manual carefully and retain it for future reference. Shall the unit require maintenance, contact an authorized service center.

Use of controls, adjustments or the performance of procedures other than those specified herein may result in hazardous radiation exposure.

To prevent direct exposure to laser beam, do not try to open the enclosure. Visible laser radiation when open. DO NOT STARE INTO BEAM.

**CAUTION:** The apparatus shall not be exposed to water (dripping or splashing) and no objects filled with liquids, such as vases, shall be placed on the apparatus.

### **CAUTION concerning the Power Cord**

Most appliances recommend they be placed upon a dedicated circuit;

That is, a single outlet circuit which powers only that appliance and has no additional outlets or branch circuits. Check the specification page of this owner's manual to be certain. Do not overload wall outlets. Overloaded wall outlets, loose or damaged wall outlets, extension cords, frayed power cords, or damaged or cracked wire insulation are dangerous. Any of these conditions could result in electric shock or fire. Periodically examine the cord of your appliance, and if its appearance indicates damage or deterioration, unplug it, discontinue use of the appliance, and have the cord replaced with an exact replacement part by an authorized service center. Protect the power cord from physical or mechanical abuse, such as being twisted, kinked, pinched, closed in a door, or walked upon. Pay particular attention to plugs, wall outlets, and the point where the cord exits the appliance. To disconnect power from the mains, pull out the mains cord plug. When installing the cord, ensure that the plug is easily accessible.

**WARNING:** Do not install this equipment in a confined space such as a book case or similar unit.

**CAUTION:** Do not block any ventilation openings. Install in accordance with the manufacturer's instructions.

Slots and openings in the cabinet are provided for ventilation and to ensure reliable operation of the product and to protect it from overheating. The openings should be never be blocked by placing the product on a bed, sofa, rug or other similar surface. This product should not be placed in a built-

in installation such as a bookcase or rack unless proper ventilation is provided or the manufacturer's instruction have been adhered to.

This device is equipped with a portable battery or accumulator.

**Safe way to remove the battery or the battery from the equipment:**

Remove the old battery pack, follow the steps in reverse order than the assembly. To prevent contamination of the environment and bring on possible threat to human and animal health, the old battery or the battery put in the appropriate container at designated collection points. Do not dispose of batteries or battery together with other waste. It is recommended that you use local, free reimbursement system batteries and accumulators.

The battery shall not be exposed to excessive heat such as sunshine, fire or the like.

## Copyrights

It is forbidden by law to copy, broadcast, show, broadcast via cable, play in public, or rent copyrighted material without permission. This product features the copy protection function developed by Macrovision. Copy protection signals are recorded on some discs. When recording and playing the pictures of these discs picture noise will appear. This product incorporates copyright protection technology that is protected by U.S. patents and other intellectual property rights. Use of this copyright protection technology must be authorized by Macrovision, and is intended for home and other limited viewing uses only unless otherwise authorized by Macrovision. Reverse engineering or disassembly is prohibited.

CONSUMERS SHOULD NOTE THAT NOT ALL HIGH DEFINITION TELEVISION SETS ARE FULLY COMPATIBLE WITH THIS PRODUCT AND MAY CAUSE ARTIFACTS TO BE DISPLAYED IN THE PICTURE. IN CASE OF 525 OR 625 PROGRESSIVE SCAN PICTURE PROBLEMS, IT IS RECOMMENDED THAT THE USER SWITCH THE CONNECTION TO THE 'STANDARD DEFINITION' OUTPUT. IF THERE ARE QUESTIONS REGARDING OUR TV SET COMPATIBILITY WITH THIS MODEL 525p AND 625p UNIT, PLEASE CONTACT OUR CUSTOMER SERVICE CENTER.

You have to set the disc format option to [Mastered] in order to make the discs compatible with the LG players when formatting rewritable discs. When setting the option to Live File System, you cannot use it on LG players.

(Mastered/ Live File System : Disc format system for Windows Vista)

# Contents

1

## Safety Information

2

- 2 CAUTION
- 3 Copyrights

3

## Preparation

4

- 6 Unique Features
- 6 Accessories
- 7 Introduction
  - 7 Playable Discs
  - 7 About the  Symbol Display
  - 7 Symbol Used in this Manual
  - 7 Regional Codes

5

- 8 Playable file Requirement

6

- 9 Remote control
- 11 Rear panel
- 12 Front panel

7

## Installation

- 14 Attaching the speakers to the unit
- 15 Positioning the system
- 16 Connections to Your TV
  - 16 Component Video Connection
  - 17 Video Connection
- 17 Optional Equipment Connection
  - 17 AUX In Connection
  - 18 USB Connection

- 18 Enjoying audio from an external source and selecting the function
- 19 AUDIO (PORT. IN) In Connection
- 19 Antenna Connection
- 20 Adjust the setup settings
  - 20 OSD Initial language settings - Optional
  - 20 To display and exit the Setup menu
  - 21 Language
  - 21 Display
  - 22 Audio
  - 23 Lock (Parental Control)
  - 24 Others

## Operation

- 25 Using the Home Menu
- 25 Basic Operations
  - 25 CD/ USB Operations
- 26 iPod Operation
  - 27 Playing the iPod
  - 29 Enjoying iPod on the screen
- 29 TAPE Operation
- 30 Other Operations
  - 30 Displaying Disc Information on-screen
  - 30 To display the DVD Menu
  - 30 To display the DVD title
  - 30 Starting play from selected time
  - 31 Marked Playback

31	Changing subtitle code page
32	AUTO DJ playback
32	Viewing a PHOTO file
33	Options while viewing a photo
33	Sleep Timer Setting
33	Dimmer
33	Turn off the sound temporarily
33	1.5 times speed playback
34	Screen Saver
34	System Select - Optional
34	Last Scene Memory
34	DEMO
34	VOCAL FADER
<b>35</b>	<b>Radio Operations</b>
35	Listening to the radio
35	Presetting the Radio Stations
35	Deleting all the saved stations
35	Improving poor FM reception
36	Setting the USER EQ
36	Setting the Clock
36	Using your player as an alarm clock
<b>37</b>	<b>Sound adjustment</b>
37	Setting the surround mode
37	Adjust the speaker level settings
<b>38</b>	<b>Advanced Operations</b>
38	Listening to music from your portable player or external device
38	Recording to TAPE
38	Synchronized Recording from CD to Tape
39	Recording to USB

## Maintenance

---

40	Notes on Discs
40	Handling the Unit

## Troubleshooting

---

41	Troubleshooting
----	-----------------

## Appendix

---

42	Language Codes
43	Area Codes
44	Trademarks and Licenses
44	Specifications

1

2

3

4

5

6

7

# 2 Preparation

## Unique Features

### Portable In

Listens to music from your portable device.  
(MP3, Notebook, etc)

### USB Direct Recording

Records music to your USB device.

## Accessories

Please check and identify the supplied accessories.

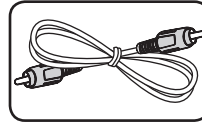

Video cable (1)



AM antenna (1)

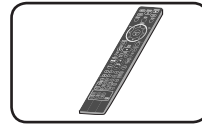

Remote control (1)

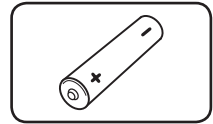

Battery (1)

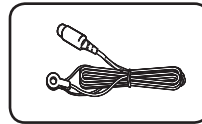

FM antenna (1)

# Introduction

## Playable Discs

This unit plays DVD±R/RW and CD-R/RW that contains audio titles, DivX, MP3, WMA and/or JPEG files. Some DVD±RW/DVD±R or CD-RW/CD-R cannot be played on this unit due to the recording quality or physical condition of the disc, or the characteristics of the recording device and authoring software.



DVD-VIDEO (8 cm / 12 cm disc)  
Discs such as movies that can be purchased or rented.



DVD±R (8 cm / 12 cm disc)  
Video mode and finalized only



DVD-RW (8 cm / 12 cm disc)  
Video mode and finalized only



DVD+R: Video mode only  
Supports the double layer disc also



DVD+RW (8 cm / 12 cm disc)  
Video mode and finalized only



Audio CD: Music CDs or CD-R/CD-RW in music CD format that can be purchased.

## About the Symbol Display

" " may appear on your TV display during operation and indicates that the function explained in this owner's manual is not available on that disc.

## Symbol Used in this Manual

All discs and file listed below

**ALL**

MP3 files

**MP3**

DVD and finalized DVD±R/RW

**DVD**

WMA files

**WMA**

DivX files

**DivX**

Audio CDs

**ACD**

JPG files

**JPG**



### NOTE

Indicates special notes and operating features.



### CAUTION

Indicates cautions for preventing possible damages from abuse.

## Regional Codes

This unit has a regional code printed on the rear of the unit. This unit can play only DVD discs labeled same as the rear of the unit or "ALL".

- Most DVD discs have a globe with one or more numbers in it clearly visible on the cover. This number must match your unit's regional code or the disc cannot play.
- If you try to play a DVD with a different regional code from your unit, the message "Check Regional Code" appears on the TV screen.

# Playable file Requirement

## MP3/ WMA music file requirement

MP3/WMA file compatibility with this unit is limited as follows :

- Sampling frequency : within 32 to 48 kHz (MP3), within 32 to 48 kHz (WMA)
- Bit rate : within 32 to 320 kbps (MP3), 40 to 192 kbps (WMA)
- Support Version : v2, v7, v8, v9
- Maximum files : Under 999
- File extensions : ".mp3"/".wma"
- CD-ROM file format : ISO9660/ JOLIET
- We recommend that you use Easy-CD Creator, which creates an ISO 9660 file system.

## Photo file requirement

Photo file compatibility with this unit is limited as follows :

- Max pixel in width : 2 760 x 2 048 pixel
- Maximum files : Under 999
- Some discs may not operate due to a different recording format or the condition of disc.
- File extensions: ".jpg"
- CD-ROM file format : ISO9660/ JOLIET

## DivX file requirement

DivX file compatibility with this unit is limited as follows :

- Available resolution: within 800 x 600 (W x H) pixels.
- The file name of the DivX subtitle should be entered within 45 characters.
- If there is impossible code to express in the DivX file, it may be displayed as " \_ " mark on the display.
- Frame rate : less than 40 fps.
- If the video and audio structure of recorded files is not interleaved, either video or audio is outputted.
- Playable DivX file : ".avi", ".mpg", ".mpeg", ".divx"
- Playable Subtitle format : SubRip (\*.srt/ \*.txt), SAMI (\*.smi), SubStation Alpha (\*.ssa/ \*.txt), MicroDVD (\*.sub/ \*.txt), SubViewer 2.0 (\*.sub/ \*.txt), Vobsub (\*.sub)
- Playable Codec format : "DIVX3.xx", "DIVX4.xx", "DIVX5.xx", "MP4V3", "3IVX".
- Playable Audio format : "AC3", "PCM", "MP3", "WMA".
- Sampling frequency : within 32 to 48 kHz (MP3), within 32 to 48 kHz (WMA)
- Bit rate : within 32 to 320 kbps (MP3), 40 to 192 kbps (WMA)
- For Discs formatted in Live file system, you can not it on this unit.
- If the name of movie file is different from that of the subtitle file, during playback of a DivX file, subtitle may not be display.
- If you play a DivX file differ from DivXspec, it may not operate normally.



# Remote control

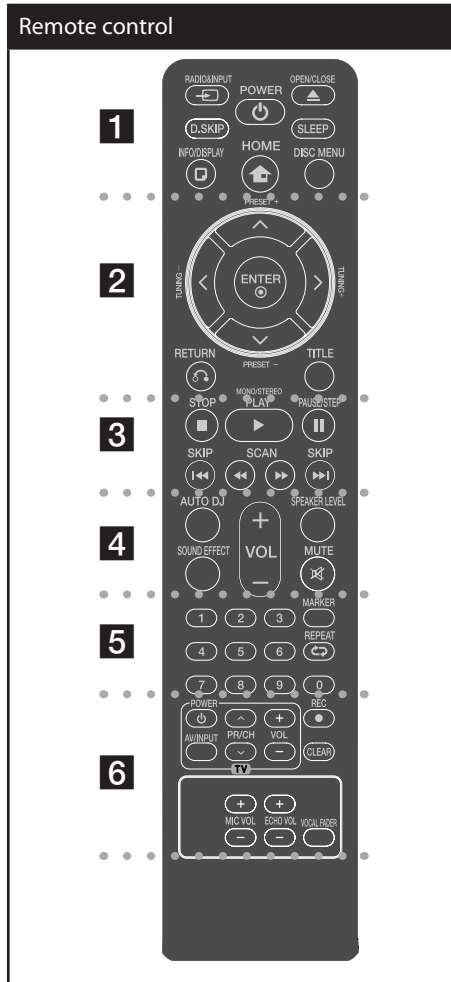

..... **1** .....

**RADIO&INPUT:** Changes input sources.

**D.SKIP:** Choose a desired disc.

**POWER:** Switches the unit ON or OFF.

**OPEN/CLOSE:** Opens and closes the disc Drawer.

**SLEEP:** Sets the system to turn off automatically at a specified time. (Dimmer : The display window will be darken by half.)

**INFO/DISPLAY:** Accesses On-Screen Display.

**HOME:** Displays the [Home] menu.

**DISC MENU:** Accesses the menu on a DVD disc.

..... **2** .....

**^/v/</>** (up/ down/ left/ right): Used to navigate on-screen displays.

**PRESET (+/-):** Selects programmed of Radio.

**TUNING (-/+):** Tunes in the desired radio station.

**ENTER:** Acknowledges menu selection. Presetting the radio station.

**RETURN (↶):** Moving back wards in the menu.

**TITLE:** If the current DVD title has a menu, the title menu appears on the screen. Otherwise, the disc menu may appear.

..... **3** .....

**STOP (■):** Stops playback or recording.

**PLAY (▶), MONO/STEREO:** Starts playback. Selects Mono/ Stereo.

**PAUSE/STEP (⏸):** Pauses playback.

**SKIP (⏮/⏭):** Goes to next or previous chapter/ track/ file.

**SCAN (⏪/⏩):** Searches backward or forward.

2

Preparation

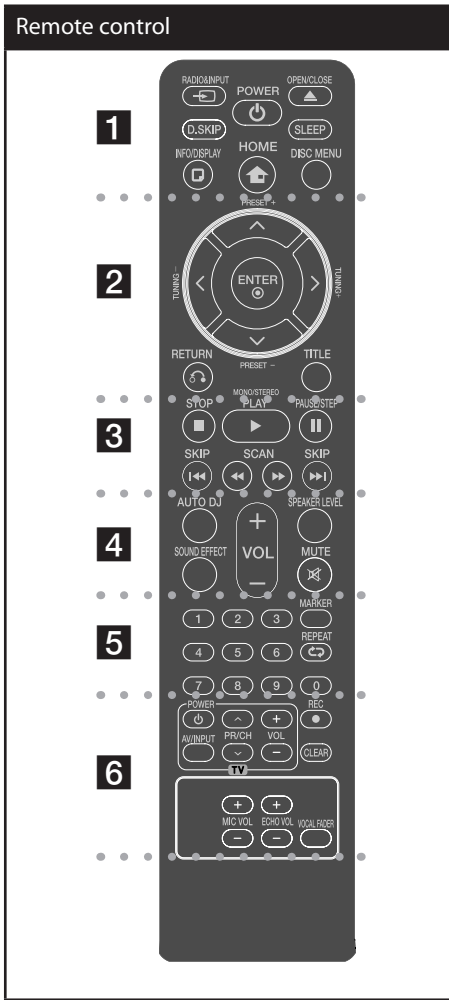

**Put the battery into the remote control.**

Make sure for the + (plus) and - (minus) on the batteries to be matched on the remote control.

..... **5** .....

**0 to 9 numerical buttons :** Selects numbered options in a menu.

**MARKER :** Marks play list.

**REPEAT :** Selects a play mode. (Repeat/Random)

..... **6** .....

**TV Control buttons :** Controls the TV. (LG TV only)

**Controlling the TV.**

You can control the sound level, input source, and power switching of LG TVs as well.

Hold POWER (TV) and press PR/CH (Λ/V) button repeatedly until the TV turns on or off.

**REC (●) :** USB Direct Recording.

**CLEAR :** Removes a radio saved station or a number when setting the password.

**MIC VOL (+/-) :** Adjusts microphone volume.

**ECHO VOL (+/-) :** Adjusts echo volume.

**VOCAL FADER:** You can enjoy the function as karaoke, by reducing singer vocal of music in the various source.

..... **4** .....

**AUTO DJ :** Selects the AUTO DJ mode. (For more information refer to the page 32)

**SOUND EFFECT:** Selects a sound effect mode.

**VOL (Volume) (+/-) :** Adjusts speaker volume.

**SPEAKER LEVEL:** Sets the sound level of desired speaker.

**MUTE :** Mutes the sound.

# Rear panel

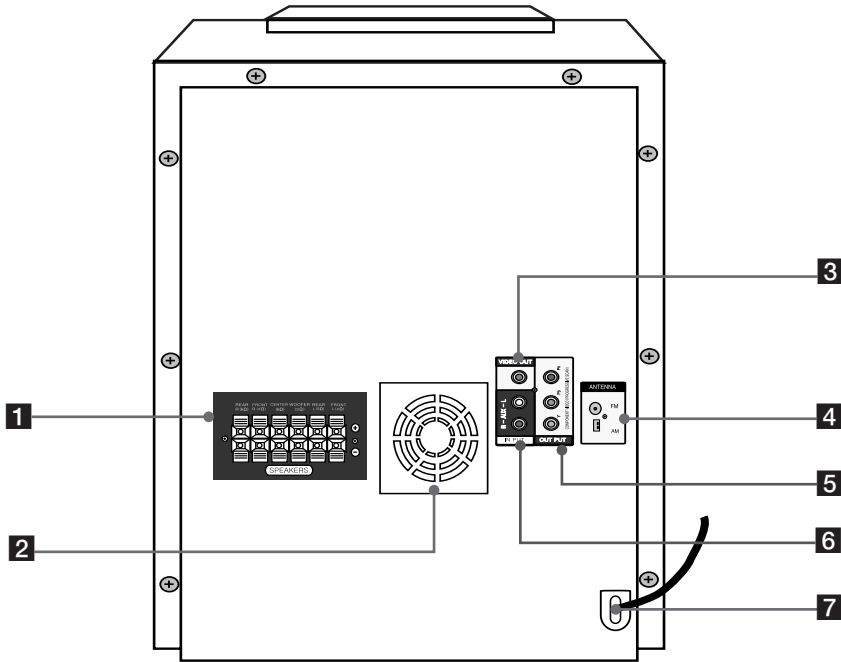



- 1** Speaker terminal
- 2** Cooling fan
- 3** VIDEO OUT connector
- 4** ANTENNA (FM, AM)
- 5** OUT PUT (COMPONENT VIDEO) connector
- 6** IN PUT (AUX) connector
- 7** Power cord.

# Front panel

2

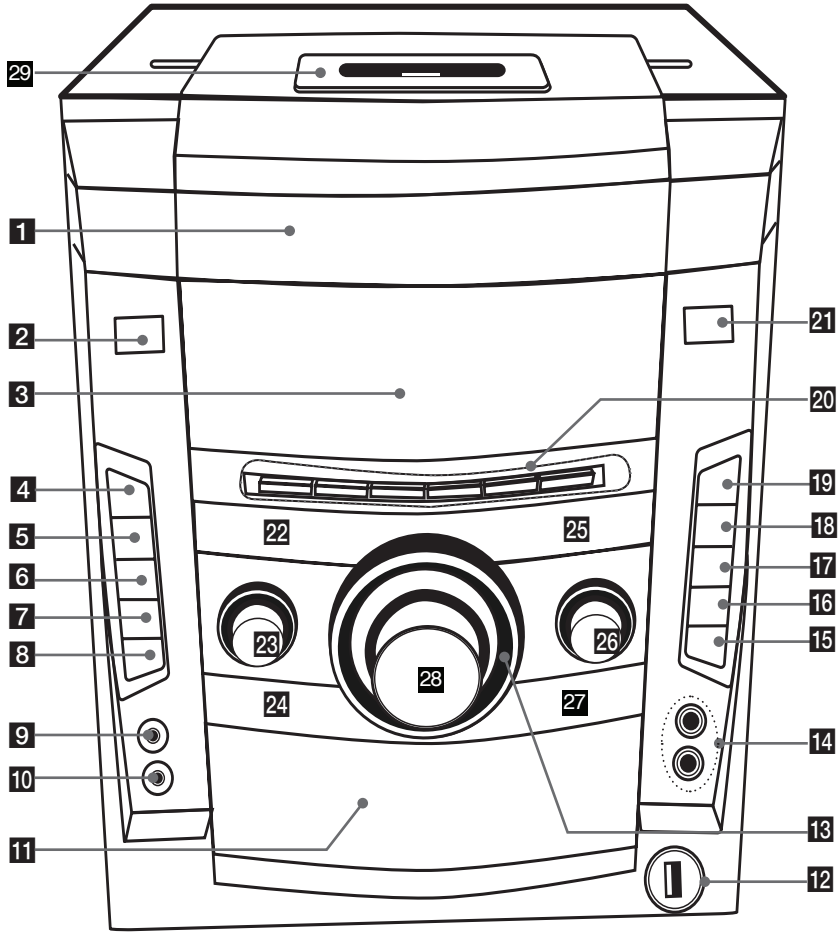
Preparation



- 1 Disc tray**
- 2  (Power)**
- 3 Display window**
- 4 TIMER**  
With the TIMER function you can turn CD, USB play and TUNER reception on or off at a desired time.
- 5 CLOCK**  
For setting the clock and checking the time.
- 6 USER EQ**  
Controls sound register.
- 7 LG SOUND EFFECT**  
You can select a Natural or Local Specialization equalizer effect.
- 8 BASS BLAST**  
Reinforces the treble, bass and surround effect.  
**MP3 Opt.**  
Optimizes compressive MP3 files so that it improves the treble sound.
- 9 PORT. IN jack**
- 10 PHONES**
- 11 Cassette door**
- 12 USB port**
- 13 MULTI JOG DIAL**  
Moves to the another file/ track or you can select the tuning range.
- 14 MIC jack. (6.3 mm jack)**
- 15 **  
Recording to USB
- 16 REVERSE MODE/DEMO**  
Scrolls through a selection of cassette playing options.
- 17 SOUND EFFECT**  
Chooses sound impressions.
- 18 DISC SKIP**  
Chooses a desired CD
- 19 OPEN/CLOSE**
- 20 SET**  
Confirms the setting.  
**CD SYNC.**  
From CD to TAPE Synchronized Recording Starts playback.  
**◀◀/ TUNING -** (CD FB/Prev.,TAPE REW)  
**PRESET -/ ◀** (TAPE reverse play)  
**PRESET +/ ▶** (CD play, TAPE FW play)  
**▶▶/ TUNING +** (CD FF/NEXT, TAPE FF)  
**■ STOP**
- 21 AUTO DJ**  
Selects the AUTO DJ mode. (For more information refer to the page 32)
- 22 HOME**  
Displays the [Home] menu.
- 23 ECHO VOL**
- 24 RADIO**  
Selects the **RADIO** function.
- 25 TAPE**  
Selects the **TAPE** function
- 26 MIC VOL**
- 27 AUX/PORTABLE/iPod**  
Selects the AUX, PORTABLE or iPod function.
- 28 MASTER VOLUME**  
Controls the volume when using any function.
- 29 iPod dock**

# 3

## Installation

### Attaching the speakers to the unit

3  
Installation

To connect the cable to the unit, press each plastic finger pad to open the connection terminals on the unit. Insert the wire and release the finger pad.

Connect the black end of each wire to the terminals marked - (minus) and the other end to the terminals marked + (plus).

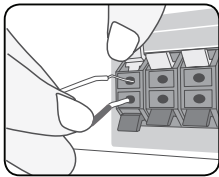

Connect the other end of each wire to the correct speaker according to the color coding:

Color	Speaker	Position
Grey	Rear	Rear right
Blue	Rear	Rear left
Green	Center	Center
Orange	Sub woofer	Any front position
Red	Front	Front right
White	Front	Front left

#### ! CAUTION

- Be careful to make sure children not to put their hands or any objects into the \*speaker duct. \*Speaker duct: A hole for plentiful bass sound on speaker cabinet (enclosure).
- The speakers contain magnet parts, so color irregularity may occur on the TV screen or PC monitor screen. Please use the speakers far away from either TV screen or PC monitor.

# Positioning the system

The following illustration shows an example of positioning the system. Note that the illustrations in these instructions differ from the actual unit for explanation purposes. For the best possible surround sound, all the speakers other than the subwoofer should be placed at the same distance from the listening position (A).

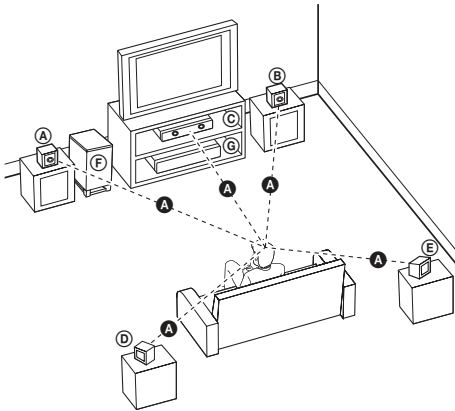

**(A) Front left speaker (L)/**

**(B) Front right speaker (R):**

Place the front speakers to the sides of the monitor or screen and as flush with the screen surface as possible.

**(C) Center speaker:**

Place the center speaker above or below the monitor or screen.

**(D) Surround left speaker (L)/**

**(E) Surround right speaker (R):**

Place these speakers behind your listening position, facing slightly inwards.

**(F) Subwoofer:**

The position of the subwoofer is not so critical, because low bass sounds are not highly directional. But it is better to place the subwoofer near the front speakers. Turn it slightly toward the center of the room to reduce the wall reflections.

**(G) Unit**

# Connections to Your TV

Make one of the following connections, depending on the capabilities of your existing equipment.

## NOTE

- Depending on your TV and other equipment you wish to connect, there are various ways you could connect the unit. Use only one of the connections described in this manual.
- Please refer to the manuals of your TV, Stereo System or other devices as necessary to make the best connections.
- Make sure the unit is connected directly to the TV. Tune the TV to the correct video input channel.
- Do not connect your unit via your VCR. The image could be distorted by the copy protection system.

## Component Video Connection

Connect the COMPONENT VIDEO OUTPUT (PROGRESSIVE SCAN) jacks on the unit to the corresponding input jacks on the TV using component cables.

You can hear the sound through the system's speakers.

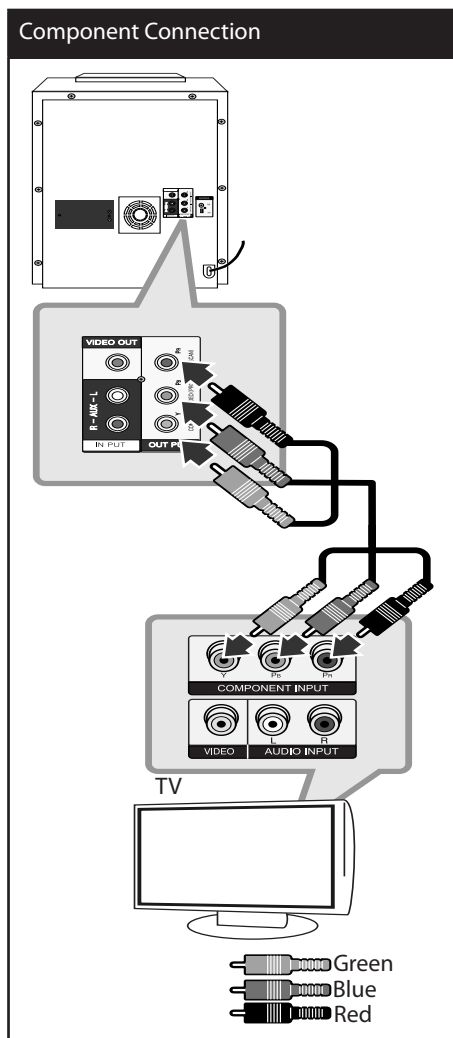



## Video Connection

Connect the VIDEO OUT jack on the unit to the video in jack on the TV using a video cable.

You can hear the sound through the system's speakers.

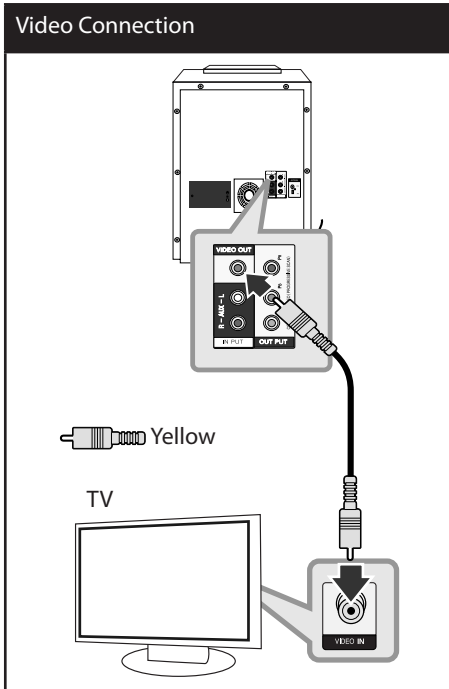

## Optional Equipment Connection

### AUX In Connection

Connect an Output of auxiliary device to the AUX (L/R) INPUT Connector.

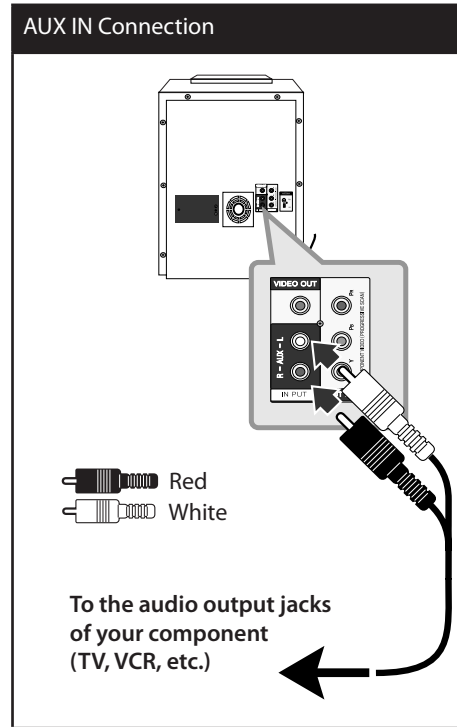

### NOTE

If your TV has only one output for audio (mono), connect it to the left (white) audio jack on the unit.

## USB Connection

Connect the USB port of USB Memory (or MP3 player, etc.) to the USB port on the front of the unit.

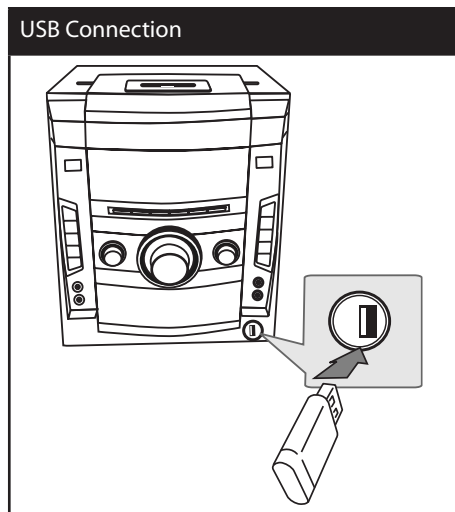

Removing the USB Device from the unit

1. Choose a different function mode or press **STOP** (■) twice in a row.
2. Remove the USB device from the unit.

### Compatible USB Devices

- MP3 Player : Flash type MP3 player.
- USB Flash Drive : Devices that support USB 2.0 or USB 1.1.
- The USB function of this unit does not support some USB devices.

### USB device requirement

- Devices which require additional program installation connected to a computer, are not supported.
- Do not extract the USB device while in operation.
- For a large capacity USB, it may take longer than a few minute to be searched.
- To prevent data loss, back up all data.
- If you use a USB extension cable or USB hub, the USB device is not recognized.
- Using NTFS file system is not supported. (Only FAT(16/ 32) file system is supported.)
- This unit is not supported when the total number of files is 1,000 or more.
- External HDD, Card readers, Locked devices, or hard type USB devices are not supported.
- USB port of the unit cannot be connected to PC. The unit can not be used as a storage device.

## Enjoying audio from an external source and selecting the function

You can enjoy audio from an external source through your unit. And you can select the function.

Press **RADIO&INPUT** repeatedly to select the desired input source or the function. - DVD/CD, AUX, iPod, PORTABLE, TAPE, FM, AM

## AUDIO (PORT. IN) In Connection

Connect an output of portable device (MP3 or PMP etc) to the AUDIO (PORT. IN) input connector.

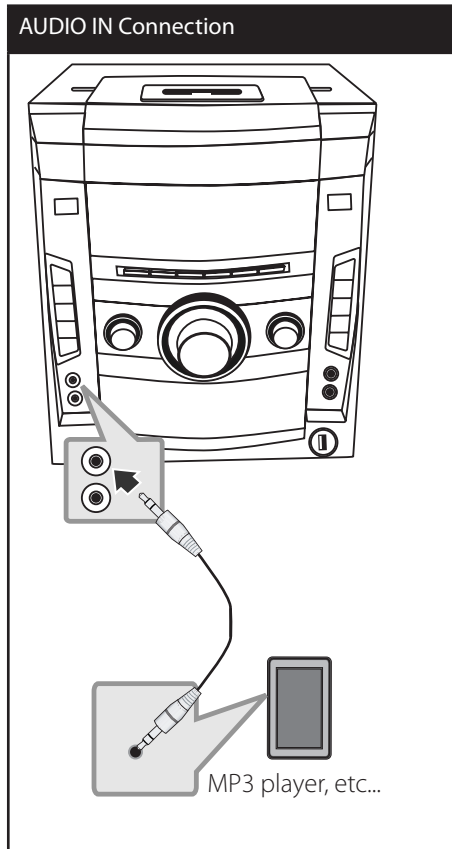

## Antenna Connection

Connect the supplied FM/AM antenna for listening to the radio.

Connect the AM Loop antenna to the AM antenna connector. (A)

Connect the FM wire antenna to the FM antenna connector. (F)

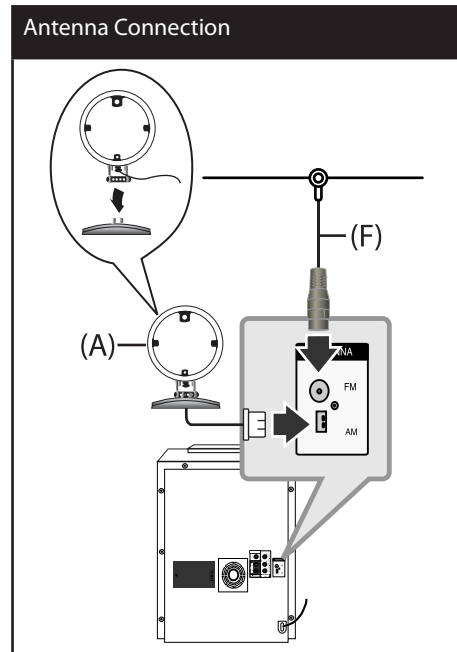

### ! NOTE

- To prevent noise pickup, keep the AM Loop antenna away from the unit and other components.
- Be sure to fully extend the FM wire antenna. After connecting the FM wire antenna, keep it as horizontal as possible.

## Adjust the setup settings

By using the Setup menu, you can make various adjustments to items such as picture and sound.

You can also set a language for the subtitles and the Setup menu, among other things. For details on each Setup menu item, see pages 20 to 24.

## To display and exit the Setup menu

1. Press **HOME**.  
Displays the [Home] Menu.



2. Select an [Setup] by using < >.
3. Press **ENTER**.  
Displays the [Setup].
4. Press **HOME** or **RETURN** to exit in the [Setup] Menu.

### About help menu for Setup

Help Menu	Buttons	Operation
▲▼ Move	^ v	Moving to another menu.
◀ Move	<	Moving to previous level.
▶ Move	>	Moving to next level or selecting menu.
↶ Close	<b>RETURN</b>	To exit the [Setup] menu or [5.1/2.1 Speaker Setup].
⊙ Select	<b>ENTER</b>	To confirm menu.

## OSD Initial language settings - Optional

During the first use of this unit, the initial language setup menu appears on your TV screen. You must complete initial language selection before using the unit. English will be selected as the initial language.

1. Press **POWER** to turn the unit on. The language setup menu will appear on the screen.

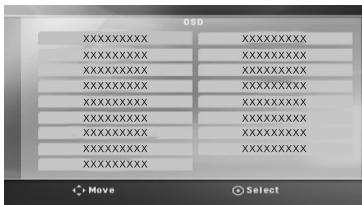

2. Use ^ v < > to select a language then press **ENTER**.  
The confirm menu will appear.

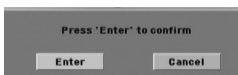

3. Use < > to select the [Enter] then press **ENTER** to finish the language setup.

## Language

### Menu Language

Select a language for the Setup menu and then on screen display.

### Disc Audio / Disc Subtitle / Disc Menu

Select the language you prefer for the audio track (disc audio), subtitles, and the disc menu.

#### [Original]

Refers to the original language in which the disc was recorded.

#### [Other]

To select another language, press numeric buttons and then **ENTER** to enter the corresponding 4-digit number according to the language code list on the page 42. If you enter the wrong language code, press **CLEAR**.

#### [Off (for Disc Subtitle)]

Turn off Subtitle.

## Display

### TV Aspect

Select which screen aspect to use based on the shape of your TV screen.

#### [4:3]

Select when a standard 4:3 TV is connected.

#### [16:9]

Select when a 16:9 wide TV is connected.

### Display Mode

The Display Mode setting works only when the TV Aspect mode is set to 4:3.

#### [Letterbox]

Displays a wide picture with bands on the upper and lower portions of the screen.

#### [Panscan]

Automatically displays the wide picture on the entire screen and cuts off the portions that do not fit. (If the disc/file is not compatible with Pan Scan, the picture is displayed at Letterbox ratio.)

### Progressive Scan (For Component Video connections)

Selects whether the COMPONENT/ PROGRESSIVE SCAN OUTPUT jacks output progressive signal. If your TV accepts progressive format signals, you will enjoy accurate color reproduction and high quality image by selecting [On]. If your TV does not accept progressive format signals, select [Off]. If you set Progressive Scan to [On] in error, you must reset the unit. First, remove the disc in the unit. Next, press and hold **STOP** ■ for five seconds. The video output will be restored to the standard setting, and a picture will be visible on your TV.

## Audio

### 5.1 Speaker Setup (MDS 715)

Make the following settings for the built-in 5.1 channel surround decoder.

1. Select [5.1 Speaker Setup] on the [Audio] menu.
2. Press **ENTER**.  
The [5.1 SPEAKER] appears.



3. Use < > to select the desired speaker.
4. Adjust options using ^ v < > buttons.
5. Returns to the previous menu by pressing **RETURN**.

#### [Speaker]

Select a speaker that you want to adjust.



#### NOTE

Certain speaker settings are prohibited by the Dolby Digital licensing agreement.

#### [Size]

Since the speaker settings are fixed, you cannot change the settings.

#### [Volume]

Adjust the output level of each speaker.

#### [Distance]

Adjust the distance between each speaker and the listening position.

#### [Speaker Test Start]

Select [Speaker Test Start] by using the ^ v and press **ENTER**. Press **ENTER** again to stop. Adjust the volume to match the volume of test signals memorized in the system.

## DRC (Dynamic Range Control)

Make the sound clear when the volume is turned down (Dolby Digital only). Set to [On] for this effect.

## Vocal

Select [On] to mix karaoke channels into normal stereo.

This function is effective for multi-channel karaoke DVDs only.

## Semi Karaoke

When a chapter/ title/ track is fully finished, this function shows the score in the screen with a fanfare sound.

### [On]

When you finished singing a score will appear on the screen.

### [Off]

Fanfare and score do not appears on the screen.



## NOTE

- DVD, DVD Karaoke discs with more than 2 tracks are available discs for this function.
- When you watch movies, "off" the Semi Karaoke at the SETUP menu or enjoy it without connecting the MIC if the fanfare or score appears during changing a chapter.
- This function operate on the DVD/CD mode.
- The Semi Karaoke function is available only when a microphone is connected.

## Lock (Parental Control)

### Initial Setting of the Area Code:

When you use this unit for the first time, you have to set the Area Code.

1. Select the [Lock] menu and then press >.
2. Press >.
 

To access the [Lock] options, you must input the password you have created. Input a password and press **ENTER**. Enter it again and press **ENTER** to verify. If you make a mistake before pressing **ENTER**, press **CLEAR**.
3. Select the first character using  $\Delta$   $\nabla$  buttons.
4. Press **ENTER** and select the second character using  $\Delta$   $\nabla$  buttons.
5. Press **ENTER** to confirm your Area code selection.

## Rating

Blocks playback of rated DVDs based on their contents. Not all discs are rated.

1. Select [Rating] on the [Lock] menu then press >.
2. Input a password and press **ENTER**.
3. Select a rating from 1 to 8 using the  $\Delta$   $\nabla$  buttons.

### [Rating 1-8]

Rating one (1) has the most restrictions and rating eight (8) is the least restrictive.

### [Unlock]

If you select unlock, parental control is not active and the disc plays in full.

4. Press **ENTER** to confirm your rating selection.

## Password

You can enter or change password.

1. Select [Password] on the [Lock] menu and then press **>**.
2. Press **ENTER**.
3. Input a password and press **ENTER**.

To change the password, press **ENTER** when the [Change] option is highlighted. Input a password and press **ENTER**. Enter it again and press **ENTER** to verify.

4. Press **HOME** to exit the menu.



### NOTE

If you forget your password, you can clear it using the following steps:

1. Select the [Setup] menu on the [Home] menu.
2. Input the 6-digit number "210499" and press **ENTER**. The password is cleared.

## Area Code

Enter the code of the area whose standards were used to rate the DVD video disc, based on the list on page 43.

1. Select [Area Code] on the [Lock] menu then press **>**.
2. Input a password and press **ENTER**.
3. Select the first character using **Λ** **V** buttons.
4. Press **ENTER** and select the second character using **Λ** **V** buttons.
5. Press **ENTER** to confirm your Area code selection.

## Others

### DivX VOD

**ABOUT DIVX VIDEO:** DivX® is a digital video format created by DivX, Inc. This is an official DivX Certified device that plays DivX video. Visit [www.divx.com](http://www.divx.com) for more information and software tools to convert your files into DivX video.

**ABOUT DIVX VIDEO-ON-DEMAND:** This DivX Certified® device must be registered in order to play DivX Video-on-Demand (VOD) content. To generate the registration code, locate the DivX VOD section in the device setup menu. Go to [vod.divx.com](http://vod.divx.com) with this code to complete the registration process and learn more about DivX VOD.

---

#### [Register]

Displays the registration code of your unit.

---

#### [Deregister]

Deactivate your unit and display the deactivation code.



### NOTE

All the downloaded videos from DivX VOD can only be played back on this unit.



# 4 Operation

## Using the Home Menu Basic Operations

1. Press **HOME**.  
Displays the [Home] menu.



2. Select an option by using < >.
3. Press **ENTER** then select option menu.  
[Music] – Displays [MUSIC] menu.  
[Movie] – Start video media's playback or displays the [MOVIE] menu.  
[Photo] – Displays [PHOTO] menu.  
[Setup] – Displays the [Setup] menu.

### CD/ USB Operations

1. Insert the disc by Pressing **OPEN/CLOSE** or connect the USB device to the USB port.
2. Press **HOME**.  
Displays the [Home] Menu.
3. Select an option by using < >.  
If you select the [Movie], [Photo] or [Music] option when you connect up to two devices, it appears as above.



4. Press **ENTER** then selected option menu.

#### ! NOTE

- For the most Audio CD and DVD-ROM discs, playback starts automatically.
- The unit plays only music file contained in the USB storage device or disc automatically.

To	Do this
Stop	Press <b>■</b> .
Playback	Press <b>▶</b> .
Pause	Press <b>PAUSE</b> .
Frame-by-Frame playback	Press <b>PAUSE/STEP</b> repeatedly to play title Frame-by-Frame. (DVD, DivX only)
Skipping to the next/previous chapter/ track/ file	During playback, press or rotate; (1) to go to the next track/ file or to return to the beginning of current track/file: - On the remote control: <b>⏮</b> or <b>⏭</b> - On the unit: MULITI JOG DIAL or <b>⏮/⏭</b> (2) to go back to the previous track/file: - On the remote control: <b>⏪</b> - On the unit: MULITI JOG DIAL or <b>⏪</b>
Locating a point quickly by playing a file in fast forward or fast reverse	During playback, press and hold <b>⏩</b> or <b>⏮</b> on remote control or <b>⏩</b> or <b>⏮</b> on the unit repeatedly to select the required scan speed. To return to normal speed, press <b>PLAY</b> .
Playing repeatedly or randomly	Press <b>REPEAT</b> repeatedly, and the current title, chapter or track will be played back repeatedly or randomly. - Random play mode : only music files.
Slowing down the playing speed	In the pause mode, press <b>SCAN</b> ( <b>⏮</b> or <b>⏭</b> ) to select the required speed. (DVD, DivX only) - The DivX file can not be slow down reverse play back.

## iPod Operation

You can enjoy the media file with your iPod. For details about iPod, refer to the iPod's User Guide.

### Preparation

To view iPod's Videos and Photos on the TV screen.

- Be sure to use the video connection through the VIDEO OUT jack on the rear panel of this unit. Select the appropriate video input mode on the TV.
- Depending on the iPod, make sure that select Videos > Video settings, and then set TV Out to Ask or On from your iPod. For details about Video Settings, refer to the iPod User Guide.
- The viewing photos is available only if this unit is in iPod IN mode and you can view photos only as a slide show. You have to start a slide show on your iPod to view a photo on a TV. For details about a slide show, refer to the iPod User Guide.

Before connecting the iPod, turn this unit off and reduce the volume of this unit to its minimum.

## Playing the iPod

1. Connect the iPod firmly.

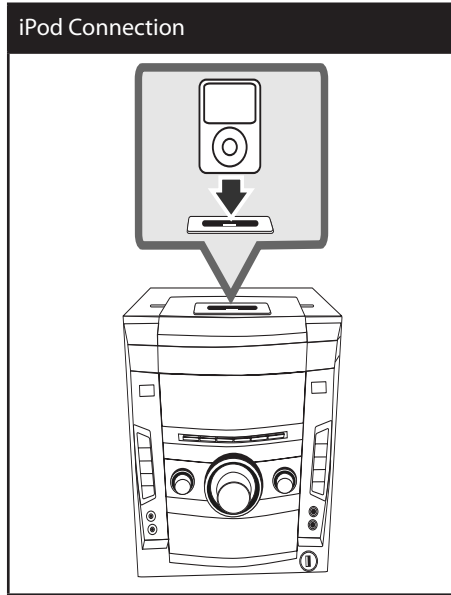

If you turn this unit on, your iPod is automatically turned on and recharging starts.

If your iPod is completely discharged, charge the battery first.

2. Press **AUX/ PORTABLE/ iPod** on the unit or **FUNCTION** on the remote control to select iPod function. You can operate your iPod through an iPod's display by using the supplied remote control and also control on your iPod.

Button		Do this
ON UNIT	ON REMOTE	
SET/CD II	▶ /	Pause or restart
◀◀ / ▶▶	◀◀ / ▶▶	Skip
◀◀ / ▶▶ (press and hold)	◀◀ / ▶▶ (press and hold)	Search
-	REPEAT	To select a desired repeat mode: Track (⏮), All (⏮), Off (No display).
-	∧/∨/</>	Selects an option in the menu.
▶	▶, ENTER	Starts playback.

## Compatible iPod

- We recommend installing the latest software version.
- The unit supports the models as follows, iPod nano, 1G, 2G, 3G, 4G/ iPod classic/ iPod 4G, 5G/ iPod touch 2G. For some models, the unit may not operate depending on the firmware version.
- Depending on your iPod's software version, it may not be possible to control your iPod from the player.
- Unsupported iPod models are recognized as an USB device when connected.



### NOTE

- An error message "CHECK IPOD" or "Connected iPod model is not supported." appears when:
  - your iPod is not available for the function to be operated.
- An error message "CHECK IPOD" or "Please update iPod's software." appears when:
  - your iPod has an old software version.
    - Update your iPod software to latest version.
- If this unit displays an error message, follow the message. An error message "CHECK IPOD" or "Please check your iPod." appears when:
  - the communication between this unit and your iPod is failed.
    - Undock & re-dock your iPod in this unit.
  - your iPod is not connected firmly.
  - this unit recognizes your iPod as unknown device.
  - your iPod is exceptionally low on power.
    - The battery needs to be charged.
    - If you charge the battery while iPod is extremely low in power, it may take longer to charge.
- You may use the dock adapter which should be supplied with your iPod to the dock for the stable use of the iPod. If you need an adapter, consult your iPod dealer.



### NOTE

- Compatibility with your iPod may vary depending on the type of your iPod.
- iPod touch and iPhone have any difference in operation other than iPod. You may need any additional control to use them with this unit. (e.g. "slide to unlock")
- If you use an application, make a call, or send and receive SMS text message, etc. on iPod touch or iPhone, disconnect it from iPod dock of this unit and then use it.
- Depending on your iPod's software version, it may not be possible to control your iPod from this unit. We recommend installing the latest software version.
- The video quality depends on the video sources on your iPod.
- If you have a problem with your iPod, please visit [www.apple.com/support/ipod](http://www.apple.com/support/ipod).

## Enjoying iPod on the screen

1. Connect the iPod firmly.
2. Press [Music] or [Movie].  
If you connected the other device (CD or USB), select the iPod on the menu and **ENTER**.



3. Select a content using  $\wedge/\vee/\lt;/\gt;$ , and press **ENTER**.

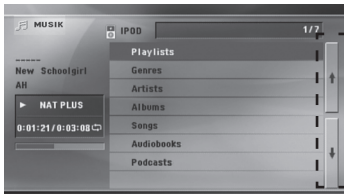

Moving to the previous or next file list.

4. Operate iPod.  
Refer to basic operation section.

### NOTE

The controls on your iPod are not operational in this mode.

## TAPE Operation

### Listening to cassette tapes

Cassette tapes can be played back in this unit.

1. Open the tape door by pressing **PUSH EJECT**.
2. Insert the tape.
3. Close the tape door by pressing **PUSH EJECT**.
4. Select the TAPE function by pressing **TAPE** on the unit or **RADIO&INPUT** on the remote control.

To	Do this
Stop	Press <b>■</b>
Playback	Press <b>▶</b> on the remote control or <b>◀ PRESET - / PRESET + ▶</b> on the unit.
Change direction	Press <b>▶</b> repeatedly on the remote control or <b>◀ PRESET - / PRESET + ▶</b> on the unit.
Searching for a section	Press <b>◀◀</b> or <b>▶▶</b> on remote control or <b>◀◀◀</b> or <b>▶▶▶</b> on the unit during playback and release it at the point you want to listen to.
Reverse mode	You can set the tape to play one side <b>↔</b> , both sides one time <b>↔</b> , or both sides repeatedly <b>↔</b> , by pressing <b>REVERSE MODE/ DEMO</b> on the unit one or more times.

## Other Operations

### Displaying Disc Information on-screen

You can display various information about the disc loaded on-screen.

1. Press **INFO/DISPLAY** to show various playback information.  
The displayed items differ depending on the disc type or playing status.
2. You can select an item by pressing **^ V** and change or select the setting by pressing **< >**.

Title – Current title number/ total number of titles.

Chapter – Current chapter number/ total number of chapters.

Time – Elapsed playing time.

Audio – Selected audio language or channel.

Subtitle – Selected subtitle.

Angle – Selected angle/ total number of angles.



#### NOTE

If any button is not pressed for a few seconds, the onscreen display disappears.

### To display the DVD Menu **DVD**

When you play a DVD which contains several menu, you can select the menu you want using the Menu.

1. Press **DISC MENU**.  
The disc's menu appears.
2. Select the menu by using **^ V < >**.
3. Press **PLAY** to confirm.

### To display the DVD title **DVD**

When you play a DVD which contains several title, you can select the title you want using the Menu.

1. Press **TITLE**.  
The disc's title appears.
2. Select the menu by pressing **^ V < >**.
3. Press **PLAY** to confirm.

### Starting play from selected time **DVD** **DivX**

To start playing at any chosen time on the file or title.

1. Press **INFO/DISPLAY** during playback.
2. Press **^ V** to select the time clock icon and “--:--” appears.
3. Input the required start time in hours, minutes, and seconds from left to right. If you enter the wrong numbers, press **CLEAR** to remove the numbers you entered. Then input the correct numbers.  
For example, to find a scene at 1 hour, 10 minutes, and 20 seconds, enter “11020” by using numerical buttons.
4. Press **ENTER** to confirm. Playback starts from the selected time.

## Marked Playback **ACD** **MP3**

### **WMA**

The mark function enables you to store your favourite files from any disc or USB device in the unit memory.

1. Select [Music] on the [Home] menu.

**Music menu**

Moving to the previous or next file list.

Returning to the previous folder. (MP3/WMA only)

File information will be displayed according to the ID3TAG information on the appropriate music file.



Selecting all tracks/ files.  
Deselecting all tracks/files.

2. Select a desired music on the [List] by using the  $\wedge$   $\vee$  then press **MARKER** to appears the mark on the list.
3. Press **ENTER** or **PLAY**.  
Displays the play mode.
4. Select the play mode by using the  $\wedge$   $\vee$  and press **ENTER**.

#### **[Mark Play]**

Marked playback.

#### **[Current Play]**

Normal playback

### **NOTE**

If you want to select all files on the list, select [Select All] and press **ENTER**.

#### **To delete a Marker**

1. Use  $\wedge$   $\vee$  to select the track that you wish to erase from the marked file.
2. Press **MARKER**.

#### **To delete all Markers**

Use  $\wedge$   $\vee$   $<$   $>$  to select [Deselect All] then press **ENTER** in program edit mode.

### **NOTE**

The markers are also cleared when the disc or USB device is removed, the unit is switched to power off or the function is switched to others.

## Changing subtitle code page

### **DivX**

If the subtitle is not displayed properly, you can change the subtitle code page to view the subtitle file properly.

1. During playback, press **INFO/DISPLAY** to display the On-Screen display.
2. Use  $\wedge$   $\vee$  to select the [Code Page] option.
3. Use  $<$   $>$  to select desired code option.
4. Press **RETURN** ( $\curvearrowright$ ) to exit the On-Screen display.

## AUTO DJ playback **ACD** **MP3** **WMA**

Auto DJ blends the end of one song into the beginning of another for seamless playback. It equalizes volume across tracks for uninterrupted playback.

Press **AUTO DJ** on the remote control or unit repeatedly, the display changes as follows. order, RANDOM (AUTO DJ RANDOM) -> (AUTO DJ SEQUENTIAL) -> (AUTO DJ OFF).

Mode	Display Window	Description
OFF	(AUTO DJ OFF)	-
RANDOM	RANDOM (AUTO DJ RANDOM)	The music is played randomly on this mode.
REPEAT	(AUTO DJ SEQUENTIAL)	The music is played repeatedly on this mode.

### NOTE

- Searching for a section or playing repeatedly or randomly is not supported on the AUTO DJ mode.
- If you switch to other functions or stop the music using **STOP** on the unit (or **ENTER** on the remote control) on AUTO DJ mode, AUTO DJ function will be disabled.
- AUTO DJ function is not supported in the music file whose length is less than 60 seconds.
- All musics are repeated continually until the user deactivates the AUTO DJ function.
- During recording AUTO DJ function is not available.
- If you change a disc while the AUTO DJ function is activated the function is deactivated.

## Viewing a PHOTO file **JPG**

You can view photo files using this player.

1. Select [Photo] on the [Home] menu and press **ENTER**.

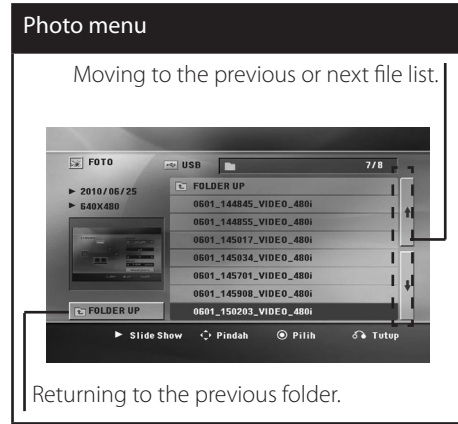

2. Press **^ V** to select a folder, and then press **ENTER**.
3. If you want to view a slide show, press **^ V** to highlight a file and press **PLAY**.

### About help menu in the [Photo] menu.

Menu	Buttons	Operation
<b>▶ Slide Show</b>	PLAY	Viewing a slide show.
<b>▲ ▼ ◀ ▶ Move</b>	<b>^ V &lt; &gt;</b>	Moving to another file or content.
<b>⊙ Select</b>	ENTER	Viewing a particular file.
<b>↶ Close</b>	RETURN	Returning to the [Home] menu.



About help menu in the full screen.

Menu	Buttons	Operation
Menu	<b>INFO/DISPLAY</b>	Displaying the Option menu.
<b>Prev./ Next</b>	<b>&lt;/&gt;</b>	Moving to another file
<b>Close</b>	<b>RETURN</b>	Returning to the [Photo] menu.

Options while viewing a photo

You can use various options during viewing a photo in full screen.

1. While viewing a photo in full screen, press **INFO/DISPLAY** to display the option menu.
2. Select an option using **^ v < >**.

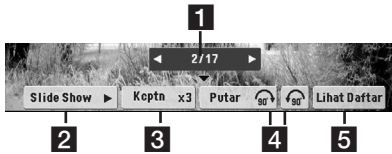

- 1 Current photo/Total number of photos**  
– Use **< >** to view previous/next photo.
- 2 Slide Show /||**– Press **ENTER** to start or pause slide show.
- 3 Speed x3/ x2/ x1** – Use **ENTER** to select a delaying speed between photos in a slide show.
- 4 Rotate** – Press **ENTER** to rotate the photo.
- 5 Go to list** – Press **ENTER** to return [Photo] menu.

Sleep Timer Setting

Press **SLEEP** one or more times to select delay time between 10 and 180 minutes, after the unit will turn off.

To check the remaining time, press **SLEEP**.

To cancel the sleep function, press **SLEEP** repeatedly until “SLEEP 10” appears, and then press **SLEEP** once again while “SLEEP 10” is displayed.

**NOTE**

You can check the remaining time before the Unit turns off.  
Press **SLEEP** The remaining time appears in the display window.

Dimmer

Press **SLEEP** once. The display window will be darkened by half. To cancel it, press **SLEEP** repeatedly until dim off.

Turn off the sound temporarily

Press **MUTE** to mute your unit.

You can mute your unit, for example, to answer the telephone, appears the in the display window.

1.5 times speed playback **DVD**

The 1.5 speed allows you to watch the pictures and listen to the sound quicker than playing at a normal speed.

1. During playback, press **PLAY** to play at 1.5 times speed. “▶X1.5” appears on the screen.
2. Press **PLAY** again to exit.

## Screen Saver

The screen saver appears when you leave the unit in Stop mode for about five minutes.

## System Select - Optional

You must select the appropriate system mode for your TV system. Press and hold **II (PAUSE/STEP)** for more than five seconds to be able to select a system in the [Home] menu. (AUTO/PAL/NTSC)

## Last Scene Memory **DVD**

This unit memorizes last scene from the last disc that is viewed. The last scene remains in memory even if you remove the disc from the unit or switch off the unit. If you load a disc that has the scene memorized, the scene is automatically recalled.

## DEMO

In power off state to demonstrate the function on display window.

## VOCAL FADER

You can enjoy the function as karaoke, by reducing singer vocal of music in the various source. (MP3/WMA/CD/etc.) Press the **VOCAL FADER**, and "FADE ON" will appear in display window.

To cancel it, press **VOCAL FADER** again. The quality of the VOCAL FADER may be different depending on the recording conditions of music files. This function is available only when MIC is connected.



### NOTE

- This function is available to use only when a microphone is connected.
- It is not available on the MONO source.

# Radio Operations

Be sure that both FM and AM aerials are connected. (Refer to the page 19)

## Listening to the radio

1. Press **RADIO&INPUT** until FM or AM appears in the display window. The last received station is tuned in.
2. Press and hold **TUNING (-/+)** for about two seconds until the frequency indication starts to change, then release. Scanning stops when the Unit tunes in a station.

or

Press **TUNING (-/+)** repeatedly.

3. Adjust the volume by rotating **MASTER VOLUME** on the unit or by pressing **VOL (+/-)** on the remote control repeatedly.

## Presetting the Radio Stations

You can preset 50 stations for FM and AM.

Before tuning, make sure that you have turned down the volume.

1. Press **RADIO&INPUT** on the remote control or **RADIO** on the unit until FM or AM appears in the display window.
2. Press or rotate to select a desired frequency;
  - On the remote control: **TUNING (-/+)**
  - On the unit: **MULITI JOG DIAL** or **◀◀ / ▶▶**
3. Press **ENTER** a preset number will flash in the display window.
4. Press **PRESET (-/+)** to select the preset number you want.

5. Press **ENTER**. The station is stored.
6. Repeat steps 2 to 5 to store other stations.
7. Press to select a preset station;
  - On the remote control: **PRESET -/+** or **0 to 9 numerical buttons**
  - On the unit: **◀ PRESET - / PRESET + ▶**

## Deleting a saved station

1. Press **PRESET - / +** to Select a preset number you want to delete.
2. Press **CLEAR**, the preset number will blink in the display window.
3. Press **CLEAR** again, to delete the selected preset number.

## Deleting all the saved stations

1. Press and hold **CLEAR** for two seconds. "ERASE ALL" will flash up on the unit display.
2. Press **ENTER** or **CLEAR** to erase all saved of the radio stations.

## Improving poor FM reception

Press **PLAY (MONO/STEREO)** on the remote control. This will change the tuner from stereo to mono and usually improve the reception.

## Setting the USER EQ

You can listen to music with the desired sound effect by adjusting the BASS, MIDDLE and TREBLE.

1. Press **USER EQ**.  
"USER EQ" is displayed.
2. Press **SET/CD SYNC**. to enter the **USER EQ**.
3. Select the BASS, MIDDLE or TREBLE sound effect you want by using **◀ PRESET - / ▶ PRESET +**.
4. Press **◀◀ TUNING - / ▶▶ TUNING +** or rotating **MULTI JOG DIAL** on the unit to select the sound level you want.
5. To finish the setting, press **SET/CD SYNC**.

## 4

### Operation

## Setting the Clock

1. Turn the power on.
2. Press **CLOCK** for at least 2 seconds
3. Choose from either, by rotating the **MULTI JOG DIAL** knob or pressing **◀◀/▶▶**.  
- AM 12:00 (for an AM and PM display) or 0:00 (for a 24 hour display)
4. Press **SET/CD SYNC**. for confirm your selection
5. Select the hours, by rotating the **MULTI JOG DIAL** knob or pressing **◀◀/▶▶**.
6. Press **SET/CD SYNC**.
7. Select the minutes, by rotating the **MULTI JOG DIAL** knob or pressing **◀◀/▶▶**.
8. Press **SET/CD SYNC**.

## Using your player as an alarm clock

1. Turn the power on.
2. Press **TIMER**. Each functions flashes.
3. Press **SET/CD SYNC**. when the function you want to be woken by is showing.
4. "ON TIME" will be displayed. This is where you set the time you want the alarm to start. Rotate the **MULTI JOG DIAL** knob or press **◀◀/▶▶** to change the hours and minutes and **SET/CD SYNC**. to save.
5. The "OFF TIME" will be displays. This is where you set the time you want the function to stop.
6. Rotate the **MULTI JOG DIAL** knob or press **◀◀/▶▶** to change the hours and minutes and press **SET/CD SYNC**. to save.
7. Rotate the **MULTI JOG DIAL** knob or press **◀◀/▶▶** to change the hours and minutes and press **SET/CD SYNC**. to save. The clock icon "⌚" shows that the alarm is set.
8. Press **TIMER** button 2 times. You can check the setting status.



### NOTE

- If you set the clock time, you can check the time by pressing **CLOCK** even when the player is turned off.
- If you set the clock time and alarm, you can check the alarm icon "⌚" by pressing **CLOCK** even when the player is turned off.
- If you set the clock time and alarm, you can check the alarm icon "⌚" and setting information by pressing **TIMER** even when the unit is turned off.

# Sound adjustment

## Setting the surround mode

This system has a number of pre-set surround sound fields. You can select a desired sound mode by using **SOUND EFFECT**.

You can change the **SOUND EFFECT** using **< >** arrow key while the sound effect information is displayed on.

The displayed items for the equalizer maybe different depending on sound sources and effects.

On Display	Description
NAT PLUS	You can enjoy the natural sound effect same as a 5.1-channel.
NATURAL	You can enjoy comfortable and natural sound
Local Specialization equalizer	Regionally optimized sound effect. (DANGDUT/ ARABIC/ PERSIAN/ INDIA/ REGUETON/ MERENGUE/ SALSA/ SAMBA/ CUMBIA/ AFRO)
AUTO EQ	Sets the sound equalizer to the mode that is the most similar to the genre which is included in the MP3 ID3 tag of song files.
POP CLASSIC JAZZ ROCK	This program lends an enthusiastic atmosphere to the sound, giving you the feeling you are at an actual rock pop, jazz or classic concert.
MP3 - OPT	This function is optimized for compressible MP3 file. It improves the treble sound.

On Display	Description
BASS BLAST	During playback, reinforce the treble, bass and surround sound effect.
LOUDNESS	Improves the bass and treble sound .
VIRTUAL	You can enjoy more virtual surround sound.
BYPASS	You can enjoy the sound without equalizer effect.

### NOTE

- In some of surround modes, some speakers, there's no sound or low sound. It depends on the mode of surround and the source of audio, it is not defective.
- You may need to reset the surround mode, after switching the input, sometimes even after the sound track changed.

## Adjust the speaker level settings

You can adjust the sound level of each speaker.

1. Press **SPEAKER LEVEL** repeatedly to select a desired speaker to set.
2. Press **VOL +/-** to adjust the sound level of the selected speaker while the level setting menu is displayed on the display window.
3. Repeat and adjust the sound level of the other speakers.

## Advanced Operations

### Listening to music from your portable player or external device

The unit can be used to play the music from many types of portable player or external devices. (Refer to the page 19)

1. Connect the portable player to the PORT.IN(PORTABLE IN) connector of the unit.  
Or  
Connect the external device to the AUX connector of the unit.
2. Turn the power on by pressing **POWER**.
3. Select the PORTABLE or AUX (L/R) INPUT function by pressing **RADIO&INPUT**.
4. Turn on the portable player or external device and start it playing.

### Recording to TAPE

You can record a various sound source to TAPE.

1. Open the tape deck and then insert a blank tape.
2. Select a function in which you want to record.
3. Playback a sound source first.
4. Press **Ⓜ** on the unit or **REC** on the remote control.  
> The display changed in the following order, "USB REC" <-> "TAPE REC"
5. Press the **Ⓜ** on the unit or **REC** on the remote control button once more when "TAPE REC" is displayed.  
> Recording starts.
6. To stop recording, press **■ STOP**.

### Pausing recording

During TAPE recording, press **Ⓜ** on the unit or **● REC** on the remote control to pause recording. Press it again to restart recording. (Only Radio/ AUX)

### Synchronized Recording from CD to Tape

1. Open the tape deck and then insert a blank tape.
2. Close the door and insert a CD.  
> Audio CD only
3. Select CD function.
4. Press **SET/CD SYNC**. on a stop status to move to CD synchronizing mode.  
> Recording automatically starts 7 seconds later after "CD SYNC" blinks.
5. To stop, press **■ STOP**.

## Recording to USB

You can record a various sound source to USB.

1. Connect the USB device to the unit.
2. Select a function in which you want to record.
3. Playback a sound source first.
4. Press **Ⓜ** on the unit or **REC** on the remote control.  
 > The display is changed in the following order, "USB REC" <-> "TAPE REC"
5. Press the **Ⓜ** on the unit or **REC** on the remote control button once more when "USB REC" is displayed.  
 > Recording starts.

### [All tracks/ files recording]

Record to USB in stop or play mode.

### [Program list recording]

After marking desired file(s) and you can record it to USB (Refer to the page 31).

6. To stop recording, press **■**.

It'll be stored as follows

Audio CD	
MP3/ WMA	
The other sources (Tuner, AUX, Tape Portable, etc)	

## NOTE

- You can check the recording percentage rate for the USB record on the screen during the recording. (Audio CD or MP3/ WMA CD only)
- During recording MP3/WMA, there is no sound.
- When you stop recording during playback, the file that has been recorded at that time will be stored.
- Do not remove the USB device during USB recording. It will result in an incomplete file being made and may not be deleted on a PC.
- If USB recording does not work, messages like "NO USB", "ERROR", "USB FULL" or "NO REC" will be displayed on the display window
- Multi card reader device or external HDD can not be used for USB recording.
- A file is recorded by 128 Mbyte (about 2 hours) when you record for a long term. There are recorded less than 4 files.
- When you stop recording during playback, the file will not be stored. (In case of audio disc)
- USB record is not possible from CD-G discs.
- During recording, you can select a function by pressing, **HOME, TAPE, AUX/ PORTABLE/ iPod, RADIO** on the unit or **HOME, RADIO&INPUT** on the remote control.

The making of unauthorized copies of copy-protected material, including computer programs, files, broadcasts and sound recordings, may be an infringement of copyrights and constitute a criminal offense. This equipment should not be used for such purposes.

**Be responsible  
Respect copyrights.**

# 5 Maintenance

## Notes on Discs

### Handling Discs



Never stick paper or tape on the disc.

### Storing Discs

After playing, store the disc in its case. Do not expose the disc to direct sunlight or sources of heat and never leave it in a parked car exposed to direct sunlight.

### Cleaning Discs

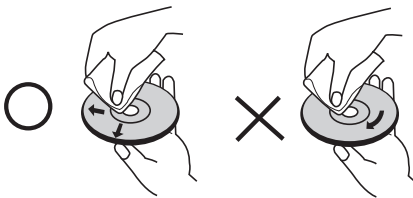

Do not use strong solvents such as alcohol, benzene, thinner, commercially available cleaners, or anti-static spray intended for older vinyl records.

## Handling the Unit

### When shipping the unit

Please save the original shipping carton and packing materials. If you need to ship the unit, for maximum protection, re-pack the unit as it was originally packed at the factory.

### Keeping the exterior surfaces clean

Do not use volatile liquids such as insecticide spray near the unit.

Wiping with strong pressure may damage the surface.

Do not leave rubber or plastic products in contact with the unit for a long period of time.

### Cleaning the unit

To clean the player, use a soft, dry cloth. If the surfaces are extremely dirty, use a soft cloth lightly moistened with a mild detergent solution. Do not use strong solvents such as alcohol, benzene, or thinner, as these might damage the surface of the unit.

### Maintaining the Unit

The unit is a high-tech, precision device. If the optical pick-up lens and disc drive parts are dirty or worn, the picture quality could be diminished. For details, please contact your nearest authorized service center.



# 6 Troubleshooting

PROBLEM	CAUSE	CORRECTION
No power	The power cord is disconnected.	Plug the power cord into the wall outlet securely.
No picture	The TV is not set to receive the DVD signal.	Select the appropriate video input mode on the TV so the picture from the unit appears on the TV screen.
	The video cables are not connected securely.	Connect the video cables securely to both the TV and unit.
There is little or no sound	Equipment connected via the audio cable is not set to receive DVD signal output.	Select the correct input mode of the unit so you can hear the sound from the unit.
	The audio cables are not connected to the speakers or unit securely.	Connect the audio cables into the connection terminals correctly.
	If not, connect speaker cables correctly.	Speaker cables connected correctly.
The DVD picture quality is poor	The disc is dirty.	Clean the disc using a soft cloth with outward strokes.
A DVD/CD will not play	No disc is inserted.	Insert a disc.
	An unplayable disc is inserted.	Insert a playable disc (check the disc type, colour system and regional code).
	The disc is inserted upside down.	Place the disc with the label or printed side facing upwards.
	There is a parental lock which prevents the playback of DVDs with a certain rating.	Enter your password or change the rating level.
Humming noise heard while a DVD or CD is playing	The disc is dirty.	Clean the disc using a soft cloth with outward strokes.
	The unit is located too close to the TV, causing feedback.	Move unit and audio components further away from your TV.
Radio stations can't be tuned in properly	The antenna is positioned or connected poorly.	Check the antenna connection and adjust its position. Attach an external aerial if necessary.
	The signal strength of the radio station is too weak.	Tune to the station manually.
	No stations have been preset or preset stations have been cleared (when tuning by scanning preset channels).	Preset some radio stations, see page 35 for details.
The remote control doesn't work well / at all	The remote is not pointed directly at the unit.	Point the remote directly at the unit.
	The remote is too far from the unit.	Use the remote within 23 feet (7 m) of the unit.
	There is an obstacle in the path between the remote control and the unit.	Remove the obstacle.
	The battery in the remote control are flat.	Replace the battery with new ones.

# 7

## Appendix

### Language Codes

Use this list to input your desired language for the following initial settings: Disc Audio, Disc Subtitle, Disc Menu.

Language	Code	Language	Code	Language	Code	Language	Code
Afar	6565	French	7082	Lithuanian	7684	Singhalese	8373
Afrikaans	6570	Frisian	7089	Macedonian	7775	Slovak	8375
Albanian	8381	Galician	7176	Malagasy	7771	Slovenian	8376
Ameharic	6577	Georgian	7565	Malay	7783	Spanish	6983
Arabic	6582	German	6869	Malayalam	7776	Sudanese	8385
Armenian	7289	Greek	6976	Maori	7773	Swahili	8387
Assamese	6583	Greenlandic	7576	Marathi	7782	Swedish	8386
Aymara	6588	Guarani	7178	Moldavian	7779	Tagalog	8476
Azerbaijani	6590	Gujarati	7185	Mongolian	7778	Tajik	8471
Bashkir	6665	Hausa	7265	Nauru	7865	Tamil	8465
Basque	6985	Hebrew	7387	Nepali	7869	Telugu	8469
Bengali; Bangla	6678	Hindi	7273	Norwegian	7879	Thai	8472
Bhutani	6890	Hungarian	7285	Oriya	7982	Tonga	8479
Bihari	6672	Icelandic	7383	Panjabi	8065	Turkish	8482
Breton	6682	Indonesian	7378	Pashto, Pushto	8083	Turkmen	8475
Bulgarian	6671	Interlingua	7365	Persian	7065	Twi	8487
Burmese	7789	Irish	7165	Polish	8076	Ukrainian	8575
Byelorussian	6669	Italian	7384	Portuguese	8084	Urdu	8582
Chinese	9072	Javanese	7487	Quechua	8185	Uzbek	8590
Croatian	7282	Kannada	7578	Rhaeto-Romance	8277	Vietnamese	8673
Czech	6783	Kashmiri	7583	Rumanian	8279	Volapük	8679
Danish	6865	Kazakh	7575	Russian	8285	Welsh	6789
Dutch	7876	Kirghiz	7589	Samoan	8377	Wolof	8779
English	6978	Korean	7579	Sanskrit	8365	Xhosa	8872
Esperanto	6979	Kurdish	7585	Scots Gaelic	7168	Yiddish	7473
Estonian	6984	Laothian	7679	Serbian	8382	Yoruba	8979
Faroese	7079	Latin	7665	Serbo-Croatian	8372	Zulu	9085
Fiji	7074	Latvian, Lettish	7686	Shona	8378		
Finnish	7073	Lingala	7678	Sindhi	8368		

## Area Codes

Choose a area code from this list.

Area	Code	Area	Code	Area	Code
Afghanistan	AF	Greenland	GL	Paraguay	PY
Argentina	AR	Hong Kong	HK	Philippines	PH
Australia	AU	Hungary	HU	Poland	PL
Austria	AT	India	IN	Portugal	PT
Belgium	BE	Indonesia	ID	Romania	RO
Bhutan	BT	Israel	IL	Russian Federation	RU
Bolivia	BO	Italy	IT	Saudi Arabia	SA
Brazil	BR	Jamaica	JM	Senegal	SN
Cambodia	KH	Japan	JP	Singapore	SG
Canada	CA	Kenya	KE	Slovak Republic	SK
Chile	CL	Kuwait	KW	Slovenia	SI
China	CN	Libya	LY	South Africa	ZA
Colombia	CO	Luxembourg	LU	South Korea	KR
Congo	CG	Malaysia	MY	Spain	ES
Costa Rica	CR	Maldives	MV	Sri Lanka	LK
Croatia	HR	Mexico	MX	Sweden	SE
Czech Republic	CZ	Monaco	MC	Switzerland	CH
Denmark	DK	Mongolia	MN	Taiwan	TW
Ecuador	EC	Morocco	MA	Thailand	TH
Egypt	EG	Nepal	NP	Turkey	TR
El Salvador	SV	Netherlands	NL	Uganda	UG
Ethiopia	ET	Netherlands Antilles	AN	Ukraine	UA
Fiji	FJ	New Zealand	NZ	United States	US
Finland	FI	Nigeria	NG	Uruguay	UY
France	FR	Norway	NO	Uzbekistan	UZ
Germany	DE	Oman	OM	Vietnam	VN
Great Britain	GB	Pakistan	PK	Zimbabwe	ZW
Greece	GR	Panama	PA		

## Trademarks and Licenses



Dolby and the double-D symbol are registered trademarks of Dolby Laboratories.



"DVD Logo" is a trademark of DVD Format/Logo Licensing Corporation.



iPod is a trademark of Apple Inc., registered in the U.S. and other countries.

"Made for iPod" means that an electronic accessory has been designed to connect specifically to iPod and has been certified by the developer to meet Apple performance standards.

Apple is not responsible for the operation of this device or its compliance with safety and regulatory standards.



DivX is a registered trademark of DivX, Inc., and is used under license.

## Specifications

### General

- Power requirements:  
MDS715 : Refer to main label
- Power consumption:  
MDS715 : Refer to main label
- Dimensions (W x H x D):  
MDS715 :  
273 x 333 x 339 mm without foot
- Net Weight (Approx.):  
MDS715 :  
5.7 kg
- Operating temperature:  
41 °F to 95 °F (5 °C to 35 °C)
- Operating humidity:  
5 % to 90 %
- Bus Power supply (USB/ iPod):  
DC 5 V  $\pm$  500 mA

### Inputs/ Outputs

- VIDEO OUT:  
1.0 V (p-p), 75  $\Omega$ , sync negative, RCA jack x 1
- COMPONENT VIDEO OUT:  
(Y) 1.0 V (p-p), 75  $\Omega$ , sync negative, RCA jack x 1,  
(Pb)/(Pr) 0.7 V (p-p), 75  $\Omega$ , RCA jack x 2
- ANALOG AUDIO IN:  
2.0 Vrms (1 kHz, 0 dB), 600  $\Omega$ , RCA jack (L, R) x 1
- PORT. IN:  
0.5 Vrms (3.5 mm stereo jack)

## Tuner

- FM Tuning Range:  
87.5 to 108.0 MHz or 87.50 to 108.00 MHz
- AM Tuning Range:  
522 to 1 620 kHz, 520 to 1 710 kHz or  
522 to 1 710 kHz

## Amplifier

- Stereo mode:  
MDS715 : 150 W + 150 W (4 Ω at 1 KHz)
- Surround mode:  
MDS715  
Front 150 W + 150 W (4 Ω at 1 KHz)  
Center 70 W (6 Ω at 1 KHz)  
Surround 70 W + 70 W (6 Ω at 1 KHz)  
Subwoofer 200 W (3 Ω at 60 Hz)

## CD

- Frequency Response 40 to 20 000 Hz
- Signal-to-noise ratio 75 dB
- Dynamic range 80 dB

## Speakers

- Front speaker  
Type: 2 Way 2 speaker  
Impedance : 4 Ω  
Rated Input Power: 150 W  
Max. Input power: 300 W  
Net Dimensions  
(W x H x D): 240 x 387 x 336 mm  
Net Weight: 5 kg
- Rear speaker  
Type: 2 Way 2 speaker  
Impedance: 6 Ω  
Rated Input Power: 70 W  
Max. Input power: 140 W  
Net Dimensions  
(W x H x D): 204 x 331 x 255 mm  
Net Weight: 2.8 kg
- Center speaker  
Type: 2 Way 3 speaker  
Impedance: 6 Ω  
Rated Input Power: 70 W  
Max. Input power: 140 W  
Net Dimensions  
(W x H x D): 277 x 120 x 160 mm  
Net Weight: 2 kg
- Passive Subwoofer  
Type: 1 Way 1 speaker  
Impedance: 3 Ω  
Rated Input Power: 200 W  
Max. Input power: 400 W  
Net Dimensions  
(W x H x D): 261 x 331 x 409 mm  
Net Weight: 6.5 kg

Designs and specifications are subject to change without prior notice.



**PT. LG ELECTRONICS INDONESIA**  
Kawasan Industri MM2100 Blok G  
Cikarang Barat, Bekasi, Jawa Barat 17520  
INDONESIA