



ENGLISH

OWNER'S MANUAL CAR CD/MP3/WMA Receiver

Please read this manual carefully before operating your set and retain it for future reference.

LCS710BRS / LCS710DAB /
LCF810BRS / LCF810DAB



MF167244352

www.lg.com.mx



Safety Information



CAUTION: TO REDUCE THE RISK OF ELECTRIC SHOCK DO NOT REMOVE COVER (OR BACK) NO USER-SERVICEABLE PARTS INSIDE REFER SERVICING TO QUALIFIED SERVICE PERSONNEL.



This lightning flash with arrowhead symbol within an equilateral triangle is intended to alert the user to the presence of uninsulated dangerous voltage within the product's enclosure that may be of sufficient magnitude to constitute a risk of electric shock to persons.



The exclamation point within an equilateral triangle is intended to alert the user to the presence of important operating and maintenance (servicing) instructions in the literature accompanying the product.

WARNING: TO PREVENT FIRE OR ELECTRIC SHOCK HAZARD, DO NOT EXPOSE THIS PRODUCT TO RAIN OR MOISTURE.

WARNING: Do not install this equipment in a confined space such as a book case or similar unit.



Always operate the vehicle in a safe manner. Do not become distracted by the vehicle while driving, and always be fully aware of all driving condition. Do not change settings, or any functions. Pull over in a safe and legal manner before attempting such operations.



Do not use for many hours at extremely low or high temperature. (-10 °C to 60 °C)



To reduce the risk of electric shock, do not remove the cover or back of this product. There are no user-serviceable parts inside. Refer servicing to qualified service personnel.



To reduce the risk of fire or electric shock, do not expose this product to dripping or splashing water, rain, or moisture.



The temperature of unit's outside can be extremely high, please use the unit after proper installation in your vehicle.

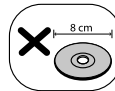

This unit cannot play 8 cm disc (use 12 cm disc only).



While driving, keep the sound volume at a proper level.



Do not drop it and avoid heavy impacts at anytime.



This unit is for vehicles with a 12-volt battery and negative grounding. Before installing it in a recreational vehicle, lorry or bus, check the battery voltage. To avoid shorts in the electrical system, be sure to disconnect the E battery cable before beginning the installation.

CAUTION: This product employs a Laser System. To ensure proper use of this product, please read this owner's manual carefully and retain it for future reference. Shall the unit require maintenance, contact an authorized service centre.

Use of controls, adjustments or the performance of procedures other than those specified herein may result in hazardous radiation exposure.

To prevent direct exposure to laser beam, do not try to open the enclosure. Visible laser radiation when open. **DO NOT STARE INTO BEAM.**

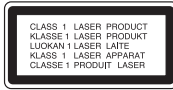

"This device is equipped with a portable battery or accumulator.

Safe way to remove the battery or the battery from the equipment:

Remove the old battery or battery pack, follow the steps in reverse order than the assembly. To prevent contamination of the environment and bring on possible threat to human and animal health, the old battery or the battery put it in the appropriate container at designated collection points. Do not dispose of batteries or battery together with other waste. It is recommended that you use local, free reimbursement systems batteries and accumulators."

The battery shall not be exposed to excessive heat such as sunshine, fire or the like.

You have to set the disc format option to [Mastered] in order to make the discs compatible with the LG players when formatting rewritable discs. When setting the option to Live File System, you cannot use it on LG players.

(Mastered/Live File System : Disc format system for Windows Vista)



Caution

When being connected in a wrong way, the unit displays as follows.

- Antenna / Remote port short : "ON PORT SHORT CIRCUIT CHECK"

After connecting it again, restart the unit.

Table of Contents

1

1 Getting Started

- 2 Safety Information
- 5 Front panel [LCS710BRS / LCS710DAB]
- 6 Front panel [LCF810BRS / LCF810DAB]
- 7 Remote control
- 7 – Battery Installation

3

2 Connecting

- 8 About detachable control panel [LCS710BRS / LCS710DAB]
 - 8 – Attaching the control panel
 - 8 – Detaching the control panel
- 9 About detachable control panel [LCF810BRS / LCF810DAB]
 - 9 – Attaching the control panel
 - 9 – Detaching the control panel
- 10 Installation
 - 10 – Basic Installation
 - 10 – Removing the existing receiver unit
 - 10 – ISO-DIN Installation
- 11 Connection
 - 11 – Connecting to a car

4

5

3 Operating

- 12 Operation
 - 12 – Basic operations
 - 12 – Turning off the sound temporarily
 - 12 – Using EQ (Equalizer)
 - 12 – Checking the clock
 - 12 – Turning off the display light
 - 12 – Resetting the unit
 - 13 – Adjusting the general settings
- 14 Listening to a CD
 - 14 – Pausing or restarting CD playback
 - 14 – Searching for a section within a track / file
- 15 – Skipping to another track/ file
- 15 – Checking information about your music
 - 15 – Playing back tracks / files in a way you want
- 16 Listening to music from an external device

- 16 – Preventing radical changes in volume as switching sources
- 17 Listening to the TUNER
 - 17 – Storing desired frequencies manually
 - 17 – Listening to a preset station
- 18 – Adjusting TUNER settings
- 19 Listening to the DAB (Only LCS710DAB / LCF810DAB)
 - 19 – Storing desired frequencies manually
 - 19 – Listening to a preset station
 - 19 – Adjusting DAB settings
- 20 Using an USB device / SD card
 - 20 – Moving to another drive
 - 21 – Quick Search of a desired file
 - 21 – Deleting the desired file
 - 21 – Playable USB device / SD card Requirement
 - 21 – Recording to USB device / SD card
- 22 Listening to music by connecting iPod / iPhone
 - 22 – Pausing or restarting playback
 - 22 – Searching for a section within a track / file
 - 22 – Checking information about your music
- 23 – Playing back tracks / files in a way you want
 - 23 – Playing back files by music menus
- 23 – 2WAY Control
- 23 – Compatible iPod models
- 24 Connecting a Bluetooth wireless technology
 - 25 – Using the buttons for Bluetooth wireless technology
 - 25 – Using a Bluetooth wireless technology
- 26 – Adjusting the setting
- 27 – WICS (Wireless Controller & Synchronization)
- 28 – Phone compatibility list

4 Troubleshooting

- 31 Troubleshooting

5 Appendix

- 32 Steering Remote Control
- 36 Specifications

Front panel [LCS710BRS / LCS710DAB]

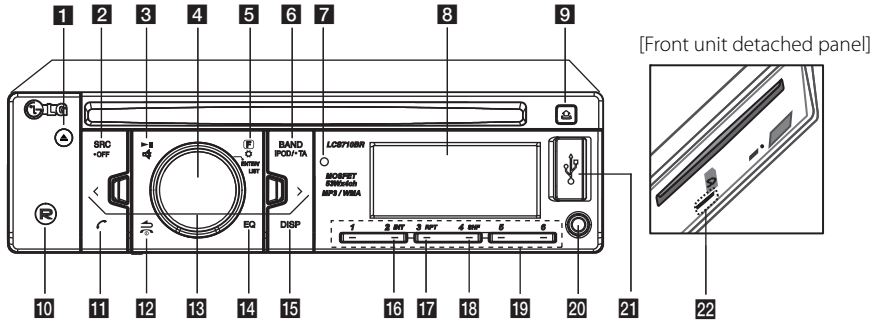

- 1** Ejects a disc.
- 2** **SRC / • OFF**
 - When pressed, selects function sources.
 - When pressed and held, powers unit on or off.
- 3** Plays and pauses playback.
 - Temporarily stops the sound.
- 4** **Volume knob**
 - Adjusts volume level.
 - Confirms the settings.
 - Checks tracks, files or preset stations.
- 5** **F**
 - In each mode, sets playback items.
 - Activates setting menu.
- 6** **BAND**
 - Selects a band in Tuner mode.
 - Moves to a next USB drive.**iPOD / • TA**
 - Searches stations that have TA / TP information, when it is pressed and held.
 - Activates 2WAY Control.
- 7** Remote Sensor
- 8** Display window
- 9** Opens the front panel.
- 10** Recording to USB / SD card.
- 11**
 - Activates BT function.
 - Answers a call.
- 12** Returns to the previous step.
 - Ends a call.
- 13** **< / >** Skip / Search / Seek / Tune
- 14** **EQ** Improves sound quality.
 - When pressed, selects the EQ function.
- 15** **DISP**
 - Press it, you can check the clock time.
 - Press and hold it, you can turn on /off the display window and the light of LED buttons.
- 16** **INT** Intro scan.
- 17** **RPT** Repeats playback.
- 18** **SHF** Shuffles playback.
- 19** **Numeric buttons (1 to 6)** Selects a numbered preset station in TUNER.
- 20** **AUX**
 - If connected to other portable player, you can enjoy music from it on the unit.
- 21** **USB port**
- 22** **SD card slot**

Front panel [LCF810BRS / LCF810DAB]

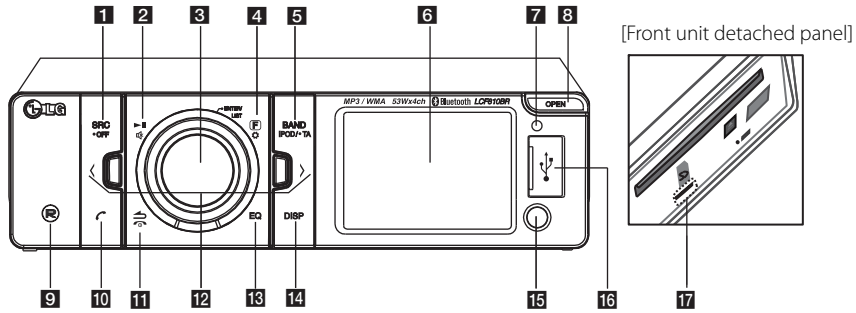

1 SRC / • OFF

- When pressed, selects function sources.
- When pressed and held, powers unit on or off.

2 ▶||

- Plays and pauses playback.
- Temporarily stops the sound.

3 Volume knob

- Adjusts volume level.
- Confirms the settings.
- Checks tracks, files or preset stations.

4 F

- In each mode, sets playback items.
- Activates setting menu.

5 BAND

- Selects a band in Tuner mode.
- Moves to a next USB drive.

iPOD / • TA

- Searches stations that have TA / TP information, when it is pressed and held.
- Activates 2WAY Control.

6 Display window

7 Remote Sensor

8 OPEN

- Opens the front panel.

9 (R)

- Recording to USB / SD card.

10 ☎

- Activates BT function.
- Answers a call.

11 ↶

- Returns to the previous step.



- Ends a call.

12 < / >

- Skip / Search / Seek / Tune

13 EQ

- Improves sound quality.
- When pressed, selects the EQ function.

14 DISP

- Press it, you can check the clock time.
- Press and hold it, you can turn on /off the display window and the light of LED buttons.

15 AUX

- If connected to other portable player, you can enjoy music from it on the unit.

16 USB port

17 SD card slot

Remote control

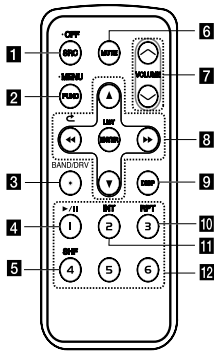

1 SRC / • OFF

- When pressed, selects function sources.
- When pressed and held, powers unit off.

2 FUNC

When pressed, sets playback items in each mode.

• MENU

When pressed and held, activates setting menu.

3 BAND

Selects a band in Tuner mode.

DRV

Moves to next USB drive.

4 ►/|| Plays or pauses playback.

5 SHF Shuffles playback.

6 MUTE Temporarily stops the sound.

7 VOLUME ▲ / ▼

Adjusts volume level.

8 ◀◀ / ▶▶

Skip / Search / Seek / Tune



Returns to the previous step.

▲ / ▼

- List up / down
- Adjusts settings.
- Moves 10 MP3 / WMA tracks backward or forward if there is no folder or one folder on a CD.
- Moves to the previous or next folder if there are more than 2 folders on a CD.

ENTER / LIST

- Confirms the settings.
- Checks tracks, files or preset stations.

9 DISP

- Press it, you can check the clock time.
- Press and hold it, you can turn on / off the display window and the light of LED buttons.

10 RPT

Repeats playback.

11 INT

Intro scan.

12 Numeric buttons (1 to 6)

Selects a numbered preset station in TUNER.

Battery Installation

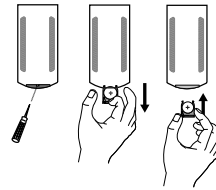

1. Pull out the battery holder with a sharp product like a ball point pen.
2. Put the battery with + and - correctly on the battery holder.
3. Push the battery holder back into its original position.

! Note

- Use only one CR2025 (3 V) lithium battery.
- Remove the battery if the remote control is not used for a long period of time.
- Do not leave the product in a hot or humid place.
- Do not handle the battery with metallic tools.
- Do not store the battery with metallic materials.

About detachable control panel [LCS710BRS / LCS710DAB]

2

Connecting

Attaching the control panel

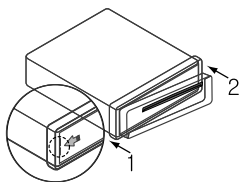

1. Align the left side of the panel with the stopper.
2. Push the right side of panel into the unit until it clicks.

⚠ Caution

- The control buttons may not work properly if the control panel is not attached properly. If this occurs, gently press the display.
- Do not leave the control panel in any area exposed to high temperatures or direct sunlight.
- Do not drop the control panel or otherwise subject it to strong impact.
- Do not allow such volatile agents as benzene, thinner, or insecticides to come into contact with the surface of the control panel.

Detaching the control panel

1. Press the  to open the control panel.

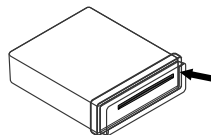

2. Push the control panel to right.

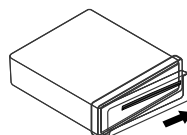

3. Pull the control panel out of the unit.
4. Put the detached control panel into the protective case.

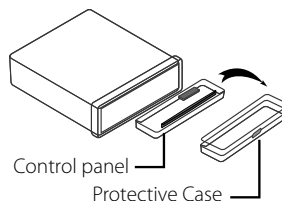

⚠ Note

Periodically wipe the contacts on the back of the control panel with a cotton swab moistened with alcohol. For safety, turn off the ignition before cleaning, and remove the key from the ignition switch.

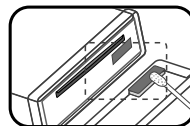

About detachable control panel [LCF810BRS / LCF810DAB]

Attaching the control panel

1. Attach part **A** of the control panel to part **B** of the unit.

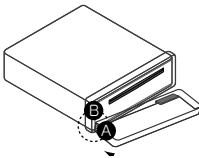

2. Attach part **C** of the control panel to part **D** of the unit while pushing the control panel to left.
3. Close the control panel.

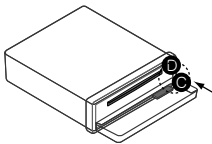

! Caution

- The control buttons may not work properly if the control panel is not attached properly. If this occurs, gently press the display.
- Do not leave the control panel in any area exposed to high temperatures or direct sunlight.
- Do not drop the control panel or otherwise subject it to strong impact.
- Do not allow such volatile agents as benzene, thinner, or insecticides to come into contact with the surface of the control panel.

Detaching the control panel

1. Press the OPEN to open the control panel.

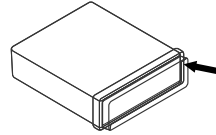

2. Push the control panel to left.

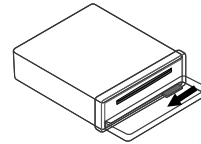

3. Pull the control panel out of the unit.
4. Put the detached control panel into the protective case.

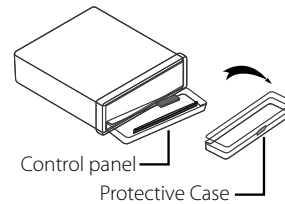

! Note

Periodically wipe the contacts on the back of the control panel with a cotton swab moistened with alcohol. For safety, turn off the ignition before cleaning, and remove the key from the ignition switch.

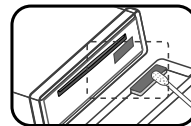

Installation

Basic Installation

Before installing, make sure that the ignition-switch is set to OFF and remove the terminal of the car battery to avoid short-circuiting.

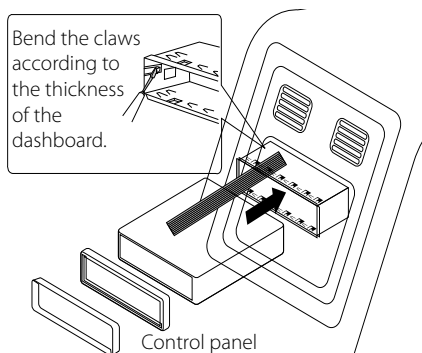

1. Remove the existing receiver unit.
2. Make the necessary connections.
3. Install the installation sleeve.
4. Install the unit into the installation sleeve.

Removing the existing receiver unit

If there is already an installation sleeve for the receiver unit in the dashboard, it must be removed.

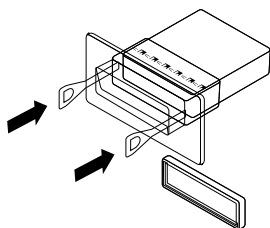

1. Remove the rear support from the unit.
2. Remove the control panel and trim ring from the unit.
3. Insert the lever into the hole on one side of the unit. Perform the same operation on the other side and pull the unit out from the mounting sleeve.

ISO-DIN Installation

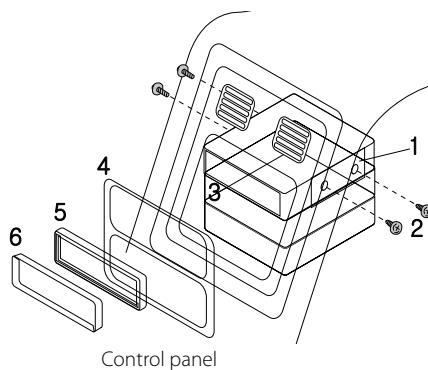

1. Slide the unit into the ISO-DIN frame.
2. Fit screws removed from the old unit.
3. Slide the unit and frame into the dash opening.
4. Install the dash panel or adapter plate.
(According to models, this step may not be needed.)
5. Install the trim ring to the unit.
6. Install the control panel to the unit.

Connection

Connecting to a car

Before installing, make sure that the ignition-switch is set to OFF and remove the terminal of the car battery to avoid short-circuiting.

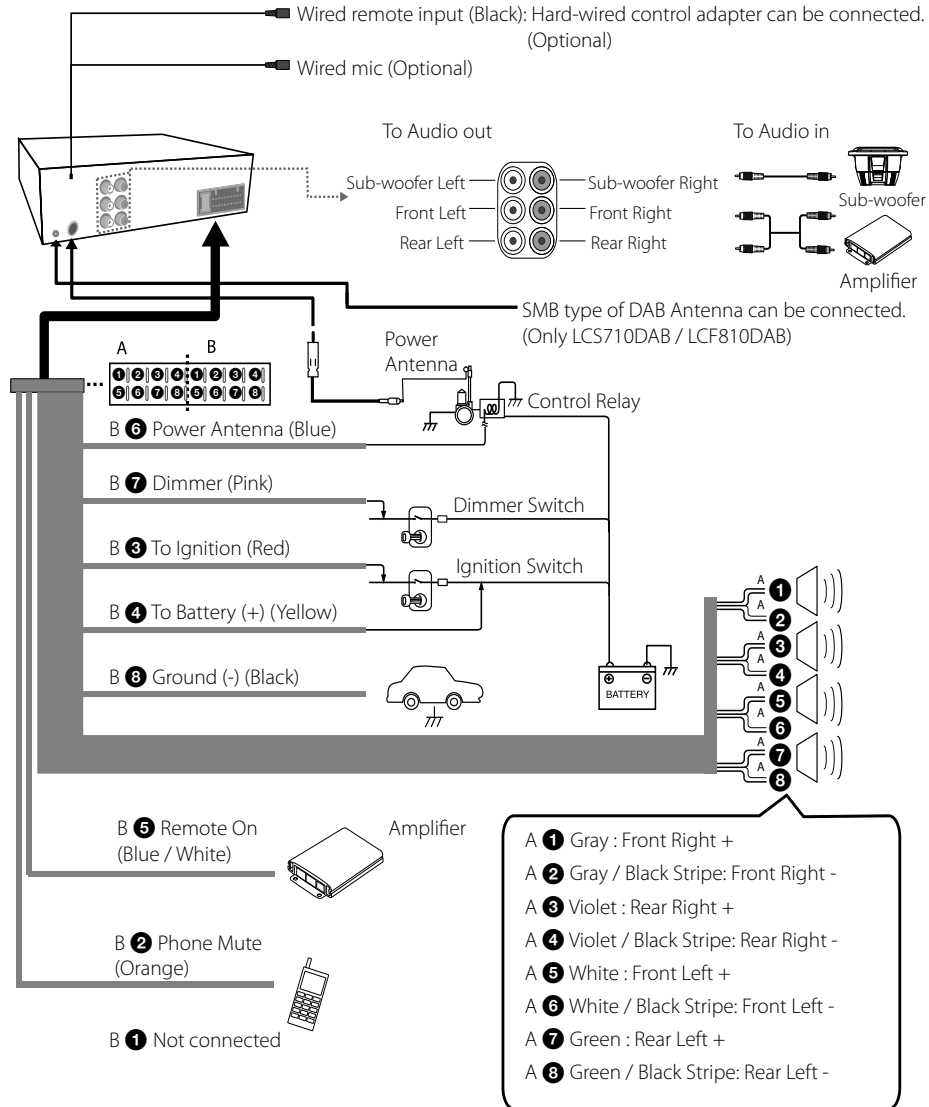

Operation

Basic operations

1. Turn the unit on by pressing any key on the unit.
2. Select a source by pressing SRC.
3. Rotate the volume knob to adjust the volume on the unit.
Or press VOLUME \wedge / \vee on the remote control.

! Note

If a source is not connected to the unit, the source is not recognized.

Turning off the sound temporarily

1. Press MUTE to mute your unit. (Except CD, USB device and SD card)
Or press MUTE on the remote control.
2. To cancel it, press MUTE again.
Or press MUTE again.

Using EQ (Equalizer)

EQ is to increase or decrease the signal strength of audio frequencies. The function helps you to enjoy sound more plentifully.

Press EQ on the unit. And rotate the volume knob to select the item and press it. The indicator lights up in the following order.

FLAT \rightarrow XDSS+ \rightarrow POP \rightarrow CLASSIC \rightarrow ROCK \rightarrow
JAZZ \rightarrow VOCAL \rightarrow SALSA \rightarrow SAMBA \rightarrow REGGAE
 \rightarrow RUSSY \rightarrow USER EQ1 \rightarrow USER EQ2

! Note

You can adjust sound level to your preference. Once you select a USER EQ1 / 2 mode and press and hold EQ on the unit, then adjust the sound level ((BAS (bass), MID (middle), TRB (treble), BALANCE (left / right speaker), FADER (front / rear speaker), SW (Subwoofer), SW-F (Subwoofer Frequency), A-EQ (Auto EQ)), it will be automatically stored for the currently selected USER EQ1 / 2 mode. Refer to the "For [SOUND] setting" for USER EQ1 / 2 mode on the page 13.

Checking the clock

1. Press DISP to check the clock.
2. Press it again to remove it.

Turning off the display light

1. Press and hold DISP.
2. Press and hold it again to turn it on.

! Note

Under the light-off condition, press any key, the light is turned on and then off automatically if you don't press it within a few seconds.

Resetting the unit

You can reset the unit when it does not operate properly.

1. Detach the control panel.
Refer to page 8 to 9 for detaching the control panel.
2. Press the RESET hole with a sharp object.

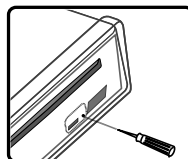

[LCS710BRS / LCS710DAB]

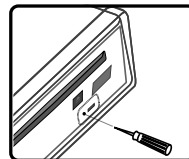



[LCF810BRS / LCF810DAB]

Adjusting the general settings

You can adjust [SOUND], [LIGHT] and [OTHER] settings.

On the unit

1. Press and hold .
 2. Rotate the volume knob to select [SOUND], [LIGHT], or [OTHER] and press it.
 3. Rotate the volume knob to select the item and press it.
 4. Rotate the volume knob clockwise or counterclockwise to adjust the level.
 5. Press the volume knob to confirm the setting.
- If you want to return to the previous step, press .

On the Remote Control

1. Press and hold FUNC / • MENU.
 2. Press ▲ / ▼ to select [SOUND], [LIGHT], or [OTHER] and press ENTER.
 3. Press ▲ / ▼ to select the mode and press ENTER.
 4. Press ▲ / ▼ to adjust the level.
 5. Press ENTER to confirm the setting.
- If you want to return to the previous step, press .

For [SOUND] setting

You can adjust sound quality by adjusting the level of BALANCE (left / right speaker), FADER (front / rear speaker), SW (Subwoofer), SW-F (Subwoofer Frequency) and A-EQ (Auto EQ).

- When you set the EQ to USER EQ1 / 2 mode :
You can adjust the sound level of BAS (bass), MID (middle), TRB (treble), BALANCE (left / right speaker), FADER (front / rear speaker), SW (Subwoofer), SW-F (Subwoofer Frequency) and A-EQ (Auto EQ)

- SW (Subwoofer)
You can adjust the volume of subwoofer.
- SW-F (Subwoofer Frequency)
You can enable the subwoofer.
SW OFF <-> SW 55 Hz <-> SW 85 Hz <-> SW 120 Hz.
- A-EQ (Auto EQ) ON / OFF
AUTO EQ operates only in the music file supported with genre in the device. When you set AUTO EQ to ON, POP, CLASSIC, ROCK, or JAZZ is automatically selected according to the music genre.

For [LIGHT] setting

You can adjust the light effects by adjusting LED, DIM, or DIM L.

- LED COL1 / COL2 / AUTO : You can change the LED window color.
- DIM (Dimmer) OFF / ON / AUTO : You can change the brightness of the display window during the power-on status.

Settings	Description
DIM ON	The display window becomes dark.
DIM OFF	The display window becomes bright.
DIM AUTO	The dimmer operates according to the car dimmer setting.

- DIM L (Dimmer Level) : When you set DIM to ON / AUTO, you can adjust the dimmer level. (-2, -1, 0, +1, +2)



For [OTHER] setting

- AUX (Auxiliary) ON / OFF
It is possible to use auxiliary equipment with this unit. Activate the auxiliary setting when using auxiliary equipment connected to this unit.
- DEMO OFF / ON
You can change the initial indication on the display to information name (function name, EQ name, etc...) while listening to a source.
- BEEP 2ND / ALL
BEEP 2ND : The beep is generated when a key is pressed for longer than 2 seconds.
BEEP ALL : The beep is generated when any key is pressed.
- CLK (Clock)
For the model RDS is not supported unit or even for a RDS supported unit.
 - When RDS CT information is not received and then you set CT to OFF, you can adjust the time by yourself. Set the clock as follows ;
 1. Select a source to TUNER.
 2. Press the **F** to select the CT and then set CT to OFF.
(Refer to the " Adjusting TUNER settings " on the page 18 for setting the CT (Clock Time) ON / OFF.)
 3. Press and hold **⚙** on the unit to select [OTHER] and then select CLK by rotating the volume knob.
 4. Set the hour by rotating the volume knob.
 5. Press the volume knob to confirm the hour.
 6. Set the minute by rotating the volume knob.
 7. Press the volume knob to confirm the minute.
 - When RDS CT information is received ;
The clock is displayed according to the RDS CT information.
 - When RDS is not supported, set the clock according to 3 to 7 steps.

Listening to a CD

[LCS710BRS / LCS710DAB]

1. Insert a CD.
2. Rotate the volume knob on the unit to adjust the volume.
Or press VOLUME **▲** / **▼** on the remote control.

[LCF810BRS / LCF810DAB]

1. Press the OPEN to open the control panel.
2. Insert a CD.
3. Close the control panel.
4. Rotate the volume knob on the unit to adjust the volume.
Or press VOLUME **▲** / **▼** on the remote control.

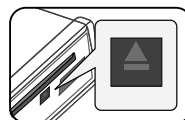
**! Note**

Make sure to press **▲** after pressing OPEN to eject a disc. Refer to the picture above.

Pausing or restarting CD playback

1. Press **⏸** on the unit to pause playback.
Or press **▶/⏸** on the remote control.
2. Press it to resume playback.

Searching for a section within a track / file

1. Press and hold **< / >** on the unit for about 1 second during playback.
Or press and hold **◀◀ / ▶▶** on remote control.
2. Press **⏸** on the unit at the point you want.
Or press **▶/⏸** on the remote control.

Skipping to another track/ file

Press < / > on the unit.

Or press ◀◀ / ▶▶ on the remote control.

Or

1. Press the volume knob on the unit.
Or press ENTER on the remote control.
2. Rotate the volume knob on the unit to select a desired ROOT or folder and press it.
Or press ▲ / ▼ and press ENTER on the remote control.
3. Rotate the volume knob on the unit to select a desired track / file and press it.
Or press ▲ / ▼ and press ENTER on the remote control.



Note

To skip to previous track, press briefly < with- in 3 seconds of playing time.

Checking information about your music

MP3 / WMA files often come with tags. The tag gives the Title, Artist or Album.

Press DISP repeatedly during MP3 / WMA / CD TEXT file playback. If there is no information, "NO TEXT" will be shown in the display window.

Playing back tracks / files in a way you want

For using applicable buttons

1. Press INT / RPT / SHF.
2. Press it again to cancel.

Or

Using the FUNC button

On the unit

1. Press **[F]**.
2. Rotate the volume knob to select an item and press it.
3. Rotate the volume knob to select the option.
4. Press the volume knob to set the option.
If you want to return to the previous step, press .

On the Remote Control

1. Press FUNC / • MENU.
2. Press ▲ / ▼ to select an item and press it.
3. Press ▲ / ▼ to select the option.
4. Press ENTER to set the option.

If you want to return to the previous step, press



- RPT (Repeat)
The current selected tracks / files (1 RPT) or folder (■ RPT) on the disc is played repeatedly.
- SHF (Shuffle)
Each files in the current selected folder (■ SHF) or all of the tracks / files (SHF) on the disc is played randomly. During random playback, even if you press <, you won't go back to the previous track.
- INT (Intro Scan)
The first 10 seconds of all tracks / files (INT) or each files in the current selected folder (■ INT) on the disc are played.
- DEV (Device) USB / SD
You can change the recording device.
USB <-> SD
- MODE
SPD REC / SPD COPY
SPD REC : The recording speed is normal. And during the recording, you can listen to the music being recorded.
SPD COPY : The recording speed is twice as fast. And during the recording, you can listen to the TUNER / DAB. But you cannot listen to the music being recorded.



Note

DEV and MODE are only available when the disc is activating.

 **Note**

-  : The icon is displayed during MP3 / WMA playback.
- **MP3 / WMA Disc compatibility with this unit is limited as follows:**
 1. Sampling Frequency / 8 kHz to 48 kHz (MP3) 22.05 kHz to 48 kHz (WMA).
 2. Bit rate / within 8 kbps to 320 kbps (include VBR) (MP3) 32 kbps to 320 kbps (WMA).
 3. CD-R / CD-RW file system should be "ISO 9660".
 4. If you record MP3 / WMA files using software which cannot create a FILE SYSTEM, for example "Direct-CD" etc., it will not be possible to playback MP3 / WMA files. We recommend that you use "Easy-CD Creator" which creates an ISO 9660 file system.

You have to set the disc format option to [Mastered] in order to make the discs compatible with the LG players when formatting rewritable discs. When setting the option to Live File System, you cannot use it on LG players.

(Mastered / Live File System : Disc format system for Windows Vista)



Customers should also note that permission is required in order to download MP3 / WMA files and music from the Internet. Our company has no right to grant such permission. Permission should always be sought from the copyright owner.

Listening to music from an external device

1. Connect an external device to the AUX jack with line input cable.
2. Select a source to AUX.
3. Play the connected Auxiliary Equipment.
4. Rotate the volume knob on the unit to adjust the volume.
Or press VOLUME ▲ / ▼ on the remote control.

Preventing radical changes in volume as switching sources

Only when you set AUX to ON as switching sources, you can adjust the volume level of each source to prevent radical changes in volume by selecting GAIN 0 / +3 / +6.

1. Press **F** on the unit.
Or press FUNC / • MENU on the remote control.
2. Rotate the volume knob on the unit.
Or press ▲ / ▼ on the remote control to set the option. (GAIN 0 / +3 / +6)
3. Press the volume knob on the unit.
Or press ENTER on the remote control to confirm the setting.
4. If you want to return to the previous step, press .
Or press  on the remote control.

Listening to the TUNER

1. Press SRC repeatedly to select a source to TUNER.
2. Press BAND repeatedly to select a desired band.
3. For manual search, press and hold </> on the unit until "MANUAL" is displayed. Then press it repeatedly to select a desired frequency.
Or press and hold ◀◀/▶▶ on the remote control.

For auto search, press </> on the unit until "SEARCH" is displayed. (Except MW)
Or press ◀◀/▶▶ on the remote control.
4. Rotate the volume knob on the unit to adjust the volume.
Or press VOLUME ▲ / ▼ on the remote control.

Storing desired frequencies manually

1. Press BAND to select a desired band you want to store.
2. Select the desired frequency by using </> on the unit.
Or use ◀◀/▶▶ on the remote control.
3. Press the volume knob and rotate the volume knob to select a preset station among 1 to 6 and then press and hold the volume knob until the beep sound is heard.
Or press ENTER and press ▲/▼ to select a preset station among 1 to 6 and then press and hold ENTER until the beep sound is heard on the remote control.

Or press and hold one of preset buttons among 1 to 6 on the remote control until the beep sound is heard.

Or press and hold one of preset buttons among 1 to 6 on the unit until the beep sound is heard. (Only LCS710BRS / LCS710DAB)
4. Repeat steps 1 to 3 to preset other stations.

! Note

When a station is stored on the preset numbers on which another station of the same band has already been preset, the previously preset station is automatically erased.

Listening to a preset station

1. Press BAND repeatedly to select a desired band.
2. Press the volume knob on the unit.
Or press ENTER on the remote control.
3. Rotate the volume knob to select a preset station.
Or press ▲/▼ on the remote control.
4. Press the volume knob.
Or press ENTER on the remote control.

Or

Press BAND and then press the desired preset button among 1 to 6 on the remote control.

Or press BAND and then press the desired preset button among 1 to 6 on the unit. (Only LCS710BRS / LCS710DAB)

Adjusting TUNER settings

On the unit

1. Press **F**.
2. Rotate the volume knob to select an item and press it.
3. Rotate the volume knob to set the option and press it.
4. If you want to return to the previous step, press **↶**.

On the Remote Control

1. Press **FUNC / • MENU**.
2. Press **▲ / ▼** to select an item and press **ENTER**.
3. Press **▲ / ▼** to set the option and press **ENTER**.
4. If you want to return to the previous step, press **↶**.

- **PTY (Program type, RDS (OPTIONAL))**
It searches the radio stations by program type of FM tuner.
The program types are displayed as follows.

NEWS	FINANCE	EASY M
AFFAIRS	CHILDREN	LIGHT M
INFO	SOCIAL	CLASSICS
SPORT	RELIGION	OTHER M
EDUCATE	PHONE IN	JAZZ
DRAMA	TRAVEL	COUNTRY
CULTURE	LEISURE	NATION M
SCIENCE	DOCUMENT	OLDIES
VARIED	POP M	FOLK M
WEATHER	ROCK M	

- **A / S (Auto Store)**
The six strongest broadcasting frequencies will be stored under preset button 1 to 6 in the order of their signal strength. To cancel, press the volume knob (or **ENTER** on the remote control).
- **P / S (Preset scan)**
Each preset station appears. To cancel, press the volume knob (or **ENTER** on the remote control).
- **SENS (Tuner sensitivity) MID / HI / LOW**
In an area in which signal reception is weak, it helps the tuner to search more stations. The weaker the reception is, the lower option you should set to.

RDS (OPTIONAL)

- **AF (Alternative Frequency) ON / OFF**
When the reception quality drops, the tuner automatically changes to another station in the network, broadcasting a better reception quality, using the PI and AF codes.
- **REG (Region) ON / OFF**
REG ON : The unit switches to another station, within the same network, broadcasting the same program when the receiving signals from the current station become weak.
REG OFF : The unit switches to another station, within the same network when the receiving signals from the current station become weak. (In this mode, the program may differ from the one currently received.)
- **TA (Traffic Announcement) ALARM / SEEK**
TA ALARM : When the tuned station has no TP information for 5 seconds, a double beep sound is output.
TA SEEK : When the tuned station does not receive TP information for 5 seconds, the receiver retunes to the next station that has the TP information.
- **PI (Programme Identification) SOUND / MUTE**
PI SOUND : When the frequency of a tuned station switches to an AF (Alternative frequency) with an unidentified PI, it keeps the sound.
PI MUTE : When the frequency of a tuned station switches to an AF with an unidentified PI, it mutes the sound until the PI is identified.
- **CT (Clock Time) ON / OFF**
You can use the RDS CT information to update the time. When RDS CT information is not received and then you set CT to OFF, you can adjust the time by yourself. Refer to the page 14 for setting the clock.

Listening to the DAB (Only LCS710DAB / LCF810DAB)

1. Press SRC repeatedly to select a source to DAB.
2. Press BAND repeatedly to select a desired band.
3. Press the volume knob on the unit.
Or press ENTER on the remote control.
4. Rotate the volume knob to select a station.
Or press ▲ / ▼ on the remote control.
5. Press the volume knob.
Or press ENTER on the remote control.
6. Press < / > on the unit to skip to another station.
Or press ◀◀ / ▶▶ on the remote control.
For auto search, press and hold < / > on the unit until "ENS SRCH" (Ensemble Search) is displayed.
Or press and hold ◀◀ / ▶▶ on the remote control.
7. Rotate the volume knob on the unit to adjust the volume.
Or press VOLUME ▲ / ▼ on the remote control.

Storing desired frequencies manually

1. Press BAND to select a desired band you want to store.
2. Select the desired frequency by using < / > on the unit.
Or use ◀◀ / ▶▶ on the remote control.
3. Press and hold the volume knob and rotate the volume knob to select a preset station among 1 to 6 and then press and hold the volume knob until the beep sound is heard.
Or press and hold ENTER and press ▲ / ▼ to select a preset station among 1 to 6 and then press and hold the ENTER until the beep sound is heard on the remote control.
Or press and hold one of preset buttons among 1 to 6 on the remote control until the beep sound is heard.
Or press and hold one of preset buttons among 1 to 6 on the unit until the beep sound is heard.
(Only LCS710DAB)

4. Repeat steps 1 to 3 to preset other stations.

! Note

When a station is stored on the preset numbers on which another station of the same band has already been preset, the previously preset station is automatically erased.

Listening to a preset station

1. Press BAND repeatedly to select a desired band.
2. Press and hold the volume knob on the unit.
Or press ENTER on the remote control.
3. Rotate the volume knob to select a preset station.
Or press ▲ / ▼ on the remote control.
4. Press the volume knob.
Or press ENTER on the remote control.

Or

Press BAND and then press the desired preset button among 1 to 6 on the remote control.

Or press BAND and then press the desired preset button among 1 to 6 on the unit. (Only LCS710DAB)

Adjusting DAB settings

On the unit

1. Press **F**.
2. Rotate the volume knob to select an item and press it.
3. Rotate the volume knob to set the option and press it.
4. If you want to return to the previous step, press **↶**.

On the Remote Control

1. Press FUNC / • MENU.
2. Press ▲ / ▼ to select an item and press ENTER.
3. Press ▲ / ▼ to set the option and press ENTER.
4. If you want to return to the previous step, press **↶**.

- PTY (Program type, RDS (OPTIONAL))
The program types are displayed as follows.
When you select an item, it will start operating immediately.

NEWS	FINANCE	EASY M
AFFAIRS	CHILDREN	LIGHT M
INFO	SOCIAL	CLASSICS
SPORT	RELIGION	OTHER M
EDUCATE	PHONE IN	JAZZ
DRAMA	TRAVEL	COUNTRY
CULTURE	LEISURE	NATION M
SCIENCE	DOCUMENT	OLDIES
VARIED	POP M	FOLK M
WEATHER	ROCK M	

- A-SCAN (Auto Scan)
Scans all available services. To confirm the lists, press the volume knob and rotate the volume knob.
- P-SCAN (Preset Scan)
The broadcasting frequencies stored in the preset number are received Sequentially. Each broadcasting frequencies are received for 6 seconds.
- DRC (Dynamic Range Control) ON / OFF
Automatically adjusts the audio level.
- ANNOUNCE (Announcement) X / O
Provides information on selected contents. TRFC (Traffic), TRNSP (Transport), WARN (Service Warning), NEWS, WTHR (Weather), EVNT (Event), SEVNT (Special Event), PINFO (Program Info), SPORT (Sport Report), FNNC (Financial Report)
- LINK
DAB+FM / OFF / DAB / FM
When the reception quality drops, the tuner automatically changes to another station in the network.
If the broadcasting is disconnected during operation, it does not sound until the next broadcasting is linked. It takes about 10 seconds. Depending on the amount of broadcasting information, it can be shorter or longer.

! Note

If each preset number has no stored frequency, "EMPTY" is displayed.

Using an USB device / SD card

[USB]

1. Open the USB cover.
2. Connect the USB device.
3. Press SRC repeatedly to select a source to USB.
4. Rotate the volume knob on the unit to adjust the volume.
Or press VOLUME \blacktriangle / \blacktriangledown on the remote control.

[SD]

1. Detach the control panel. (Refer to "About detachable control panel" on page 8 to 9.)
2. Connect the SD card.
3. Attach the control panel.
4. Press SRC repeatedly to select a source to SD.
5. Rotate the volume knob on the unit to adjust the volume.
Or press VOLUME \blacktriangle / \blacktriangledown on the remote control.

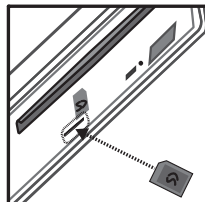

[LCS710BRS / LCS710DAB]

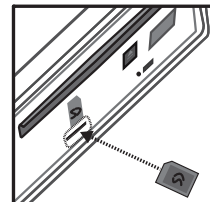

[LCF810BRS / LCF810DAB]

Moving to another drive

When connecting this unit to multi-reader, press BAND on the unit (or DRV on remote control) to go the next drive. Each time you press the button, the driver modes change.

Quick Search of a desired file

You can select and play a desired file regardless of the order in USB device / SD card.

1. Press the volume knob on the unit.
Or press ENTER on the remote control.
2. Rotate the volume knob on the unit to select a desired ROOT or folder and press it.
Or press ▲ / ▼ and press ENTER on the remote control.
3. Rotate the volume knob on the unit to select a desired track / file and press it.
Or press ▲ / ▼ and press ENTER on the remote control.

Deleting the desired file

You can select and delete a playable file you want.

1. Select the desired file in the same way as "Quick Search of a desired file"
2. Press **(R)**, and then "DELETE?" displayed. Press it again to delete.

When the delete operation is started, playing is stopped. When the delete operation is ended, the list of files is displayed. If you do not select a file within few seconds, or press the **(B)**, the first file is played.

(!) Note

Other functions are same with "Listening to a CD". Refer to page 14 to 15.

Playable USB device / SD card Requirement

- Do not extract the USB device / SD card during operation (play, etc.).
- An USB device / SD card which requires additional programme installation when you have connected it to a computer, is not supported.
- Regular back up is recommended to prevent data loss.
- If you use a USB extension cable, USB HUB, USB Multi-reader, or external HDD, the USB device may not be recognized.
- When you connect a partitioned USB device into the unit, only the first partition is recognized on it.
- Some USB device may not work with this unit.

- Digital camera and mobile phone are not supported.
- USB Port of the unit cannot be connected to PC. The unit cannot be used as a storage device.
- Using FAT (16 / 32) file system is supported. Using NTFS file system is supported to read only.

Recording to USB device / SD card

[USB]

1. Open the USB cover and connect it to the unit.
2. Select one of the following lists. (CD, FM tuner, DAB(Only LCS710DAB / LCF810DAB), Bluetooth Handsfree)
3. Press **(R)** to start recording.
For one track CD recording, press it once.
For all tracks recording, press and hold it until the beep is heard. (In case of MP3 / WMA CD, recorded all files in the folder.)
4. Press it again to stop.

[SD]

1. Detach the control panel and connect it to the unit. Then attach the control panel. (Refer to "About detachable control panel" on page 8 to 9.)
2. Select CD only.
3. Press **(R)** to start recording.
For one track CD recording, press it once.
For all tracks recording, press and hold it until the beep is heard. (In case of MP3 / WMA CD, recorded all files in the folder.)
4. Press it again to stop.

! Note

- [USB] Only in CD, FM tuner, DAB and Bluetooth Handsfree, recording is available. [SD] Only in CD, recording is available.
- Do not remove the USB device / SD card during recording, or an incomplete file may be made and not deleted on PC.
- When USB device / SD card is not connected, "REC ERR NO USB" / "REC ERR NO SD" displays and cannot record.
- When USB device / SD card memory is full, "MEMORY FULL" [LCS710BRS / LCS710DAB] "REC ERR MEMORY FULL" [LCF810BRS / LCF810DAB] displays and stops recording.
- While FM tuner / DAB / Bluetooth Handsfree recording, the broadcastings are recorded as a file every 20 minutes.
- While one track CD recording, "REC 1" appears. While other recording, "REC" appears.
- You can adjust the recording speed. (Refer to the page 15.)

The making of unauthorized copies of copy-protected material, including computer programs, files, broadcasts and sound recordings, may be an infringement of copyrights and constitute a criminal offense. This equipment should not be used for such purposes.

Be responsible
Respect copyrights

Listening to music by connecting iPod / iPhone

You can enjoy iPod / iPhone-stored music on the unit by connecting it to the USB connector using the appropriate cable.

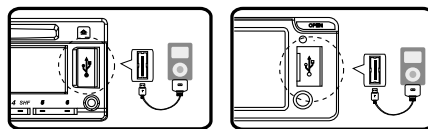

[LCS710BRS / LCS710DAB] [LCF810BRS / LCF810DAB]

1. Open the USB cover.
2. Connect the iPod / iPhone.
3. Press SRC to select a source to USB.
4. Rotate the volume knob to adjust the volume on the unit.
Or press VOLUME ▲ / ▼ on the remote control.

! Note

Refer to the page 23 to check the compatible iPod model for this unit.

Pausing or restarting playback

1. Press ►|| on the unit to pause playback.
Or press ►/|| on the remote control.
2. Press it to resume playback.

Searching for a section within a track / file

During playback, press and hold < / > and then release at a point you want.

Checking information about your music

MP3 / WMA files often come with tags. The tag gives the Title, Artist or Album.

Press DISP repeatedly during MP3 / WMA file playback. If there is no information, "NO TEXT" will be shown in the display window.

Playing back tracks / files in a way you want

On the Unit

1. Press **F**.
2. Rotate the volume knob to select an item and press it.
3. Rotate the volume knob to select the option.
4. Press the volume knob to set the option.
If you want to return to the previous step, press **↶**.

On the Remote Control

1. Press RPT / SHF.
2. Press it again to cancel.
Or
1. Press FUNC / • MENU.
2. Press **▲** / **▼** to select an item and press ENTER.
3. Press **▲** / **▼** to select the option.
4. Press ENTER to set the option.
If you want to return to the previous step, press **↶**.

- RPT (Repeat)
The current selected tracks / files (1 RPT) or folder (**■** RPT) on the iPod / iPhone is played repeatedly.
- SHF (Shuffle)
Each file in the currently selected album (**■** SHF) or all of the tracks / files (SHF) on the iPod / iPhone are played randomly.
During random playback, even if you press **<**, you won't go back to the previous track.
- SPD (BOOK SPEED)
You can adjust the audiobook speed of iPod / iPhone to NOR (Normal), FAST or SLOW.

Playing back files by music menus

You can check files by music menus and play it back.

The music menus are as follows.

PLAYLISTS → ARTISTS → ALBUMS → GENRES
→ SONGS → COMPOSER → AUDIO BOOK →
PODCAST → ...

1. Press the volume knob on the unit.
Or press ENTER on the remote control.
2. Rotate the volume knob on the unit to select a music menu and press it.
Or press **▲** / **▼** on the remote control.
3. Rotate the volume knob on the unit to select a file.
Or press **▲** / **▼** on the remote control.
4. Press the volume knob on the unit to confirm the setting.
Or press ENTER on the remote control.
5. If you want to return to the previous step, press **↶**.
Or press **↶** on the remote control.

2WAY Control

You can control on the unit and iPod / iPhone.

- Press **iPOD / • TA** on the unit. Then playback is paused. And you can control on the unit and iPod / iPhone.
- While using the 2WAY Control, any functions are not available on the unit.
- Press **iPOD / • TA** again to cancel the 2WAY Control.

Compatible iPod models

iPod classic (5th / 6th generation)
iPod nano (1st / 2nd / 3rd / 4th / 5th generation)
iPod touch (1st / 2nd / 3rd generation)
iPhone
iPhone 3G
iPhone 3GS
iPhone 4

**We recommend that you use the OS
Version 4.2.1 or more.**



"Made for iPod" means that an electronic accessory has been designed to connect specifically to iPod and has been certified by the developer to meet Apple performance standards.

"Works with iPhone" means that an electronic accessory has been designed to connect specifically to iPhone and has been certified by the developer to meet Apple performance standards. Apple is not responsible for the operation of this device or its compliance with safety and regulatory standards.

iPod is a trademark of Apple Inc., registered in the U.S. and other countries.

iPhone is a trademark of Apple Inc.



Connecting a Bluetooth wireless technology

Before you start the pairing procedure, make sure the Bluetooth wireless technology is turned on in to your phone. Refer to your phone's user guide. Pairing links your unit and phone with Bluetooth wireless technology, and is required only once for the initial setup. If the connection is successful, the phone is registered (Device 1 to 10). The process of pairing may be different depend on the phones. The PIN CODE is 1234.

	ON PLAYER
1. Enter the menu.	
2. Find the "CONNECT" menu.	Rotate the volume knob
3. Enter the "CONNECT" menu.	Press the volume knob
4. Select the "SEARCH" menu.	Rotate the volume knob
5. Search the phones supported Bluetooth wireless technology.	Press the volume knob
6. Select a phone you want to connect.	Rotate the volume knob
7. Connect the phone.	Press the volume knob

Microphone (OPTIONAL)

- Unit has a built-in microphone.

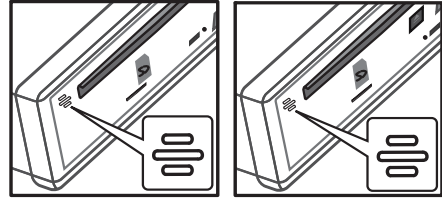

[LCS710BRS / LCS710DAB] [LCF810BRS / LCF810DAB]

- The microphone needs to be close to and pointed toward the person speaking. Install the microphone as shown below.

Microphone unit

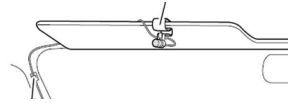

! Note

If you power off the unit while talking on the phone through the unit by using the BT function, the function is deactivated and you can talk on the phone directly.

Using the buttons for Bluetooth wireless technology

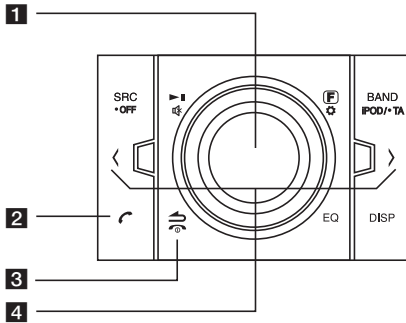

1 Volume knob

- Press the volume knob : Go to the next contents of the setting.
- Rotate the volume knob : Move the contents vertically on the setting or choose a spell when you write the words on the unit.

2

- Press it to enter BT function.
- Answers a call.

3

Returns to the previous step.



Ends a call.

4 < / >

Adjusts the mic volume while talking on the phone by BT function.

- < : Press it to delete a spell or go back previous contents.
- > : When you write some words on the unit, press it to move next space on display.

Using a Bluetooth wireless technology

Disconnecting a phone

Go to the menu ( -> CONNECT -> LIST -> Connected device name -> DISCONN).

Answering and Ending a call

When your unit rings, press  to answer a call.

To end a call, press .

Rejecting a call

When your unit rings, press .

Making a call saved as a preset number

Press  and a preset number (1 to 6).

Checking missed calls



When an incoming call is not answered, the missed call message is displayed on the display window (without headset profile). When the “*?” appears, go to the menu (-> CALL -> LASTCALL). You can check the list of missed call.

Note

- The lists of LASTCALL are sorted from newest to oldest entries.
- When you want to make an international call, press > to add “+” and to delete it press again.
- “+” can only be added when the detail list of LASTCALL is selected.
- Rejecting a call / Making a call saved preset number / Missed call notification (These features are only available on phones with Handsfree profile.)
- You can record the Bluetooth Handsfree to USB. (Refer to the page 21 to 22.)

Audio transfer

It is possible to switch the audio connection between your phone equipped with Bluetooth wireless technology and this unit.

1. Press  to answer the call.
2. Press  again. The "PRIVATE" is displayed.

If the private mode is selected on the unit, press  to return to the call to hands-free mode.

Paring your unit and device with Bluetooth wireless technology (MP3 Player, MP3 Phone...)

When you activate your Bluetooth device's linked unit, you can listen to MP3 with wireless connections. The method of use for a Bluetooth device is the same as when using a Bluetooth phone. Refer to the phone's user guide for using this function.

Playing MP3 files

When you turn Bluetooth on, your device supported Bluetooth wireless technology displays "Bluetooth" on the home screen. The Bluetooth remains on until you turn the device off. Press SRC repeatedly to select "BT". To play an MP3 file stored on your device. Refer to the phone's user guide for using this function. This feature is only available on phones with A2DP(Advanced Audio Distribution Profile).

Bluetooth wireless technology profiles information

In order to use Bluetooth wireless technology, devices must be able to interpret certain profiles. This unit is compatible with following profiles.

GAP (Generic Access Profile)

HFP (Hands Free Profile)



GAVDP (Generic Audio / Video Distribution Profile)

A2DP (Advanced Audio Distribution Profile)

AVRCP (Audio / Video Distribution Remote Control Profile)

PBA / PBAP (Phone Book Access Profile)

Adjusting the setting

1. Press .
2. Rotate the volume knob to select an item and press it.
3. Rotate the volume knob to set the option and press it.
4. If you want to return to the previous step, press .

CALL

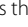
- LASTCALL
Phone number list (Received, Dialed, Missed).
CALL -> LASTCALL -> Select the phone number -> Press the volume knob -> Display the information -> Press the volume knob -> DIAL, SAVE, DELETE menu will be displayed.
- To call the phone number, DIAL -> Press the volume knob.
- To save the phone number, SAVE -> Press the volume knob -> select the preset number (1 to 6) -> Press the volume knob.
- To delete the selected phone number, DELETE -> Press the volume knob -> NAME -> Press the volume knob.
- To delete all phone number, DELETE -> Press the volume knob -> ALL -> Press the volume knob.
- DIAL
Enters the number directly on the unit. To select the 0 to 9 rotate the volume. Press  to make the phone number. To call it, Press the volume knob.
- PRESET
Checks and deletes/dials the phone number saved preset number.
CALL -> PRESET -> Select the preset number and press the volume knob -> Display the information -> Press the volume knob -> DIAL, DELETE menu will be displayed.
- To call the phone number, select DIAL and Press the volume knob.
- To delete the selected phone number, DELETE -> NAME -> Press the volume knob.
- To delete all phone number, DELETE -> ALL -> Press the volume knob.

P-BOOK

- LIST
Checks the list of the phone numbers saved by phonebook.
- SEARCH
Searches the phone number in the list.
- GET
Getting the phonebook from the phone automatically. This menu is only available on phones with PBA / PBAP (Phone Book Access Profile).

CONNECT

- LIST
Checks the list of the Connected Device Name.
- SEARCH
Searches the phones available to connect. The Connected Device Name is displayed on the top.

SETUP

- VISIBLE
Makes it impossible to search this unit.
(SHOWN <-> HIDDEN)
- AUTO CON
Adjusts connection with automatically or not.
(ON <-> OFF)
- AUTO ANS
Adjusts answering automatically or not.
(MANUAL <-> AUTO)
- MIC VOL
Adjusts microphone volume on the phone from 1 to 5. While you are on the phone with Bluetooth wireless technology, press </> (or <</> / >>) on the remote control) to adjust the MIC volume.
- REDIAL
Adjusts the counts of redial. (1 TIME <-> 2 TIMES)

INFO

- NAME
Changes the name of this unit.
- ADDRESS
Checks the address.
- PIN-CODE
Changes the PIN code. Default is 1234.

WICS (Wireless Controller & Synchronization)

You can control the unit by using the "WICS" application.

1. Search the "WICS" application and install it.



[Displays installed "WICS" application]

2. Pairing links your unit and iPhone with Bluetooth wireless technology. (Refer to the page 24.)
3. When you run the "WICS" application, activating source is displayed after initial screen. Then you can control the unit on iPhone.



[Initial screen]

[Tuner screen]

- You can select a source by pressing "SOURCE".

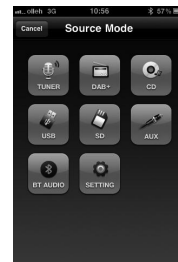

[Source Mode screen]

Phone compatibility list

Bluetooth list and manufacturing company applicable.					H : Hnadsfree A : Audio Streiming (A2DP)					P : Phonebook Sync (GET)				
Company	List	H	A	P	Company	List	H	A	P					
Nokia	E61	○			SAMSUNG	D900	○	○						
	5200	○	○			SGH-U600	○	○	○					
	N80	○				SGH-Z240	○							
	N70	○				SGH-F300	○	○						
	N72	○				SGH-E890	○							
	N91	○	○			SGH-E950	○	○	○					
	3250	○				SGH-F210	○							
	6110	○	○			SGH-G600	○	○						
	6288	○	○			i-900	○	○						
	E90	○	○			F330	○	○						
	N73	○	○			F480	○	○						
	N95	○	○			L878	○	○	○					
	N77	○	○			M8800 PIXON	○	○						
	E71	○	○			S5603	○	○	○					
	E75	○	○	○		S8003 JET(8GB)	○	○	○					
	N97	○	○	○		i8510 INNOV8 (16G)	○	○	○					
	5800 (Xpress music)	○	○	○		i8910 Omnia HD	○	○	○					
	C6	○	○	○		U808	○	○						
	E5	○	○	○		B5722	○	○						
	E52	○	○	○		B7330 (Omnia Pro)	○	○	○					
X6	○	○	○	B7620 (Giorgio Armani)	○	○	○							
N97-1	○	○	○	C3303K (Champ)	○		○							
N900	○	○		M5650U (Lindy)	○	○								
6710 (Navigator)	○	○	○	M8910 (Pixon12)	○	○	○							
Motorola	ROKR E6	○			S7350	○	○	○						
	V3x	○	○		S8500 (Wave)	○	○	○						
	RIZR K1	○			i5503 (Galaxy S)	○	○	○						
	V9	○	○		i5700 (Galaxy Spica)	○	○	○						
	Z8	○	○		i9000 (Galaxy S(16G))	○	○	○						
	V9r	○			T959	○	○	○						
	XT701	○	○	○	Galaxy Tab	○	○	○						
	XT720 (MOTOROI)	○	○	○										
	Milestone Droid	○	○		SONY	W880	○	○	○					
					ERICSSON	Z610	○	○	○					
						W300	○							
						K800i	○	○	○					

Bluetooth list and manufacturing company applicable.		H : Hnadsfree A : Audio Streaming (A2DP)			P : Phonebook Sync (GET)					
Company	List	H	A	P	Company	List	H	A	P	
SONY ERICSSON	P990i	○	○	○	LG	BL40 (New Chocolate)	○	○	○	
	W910i	○	○	○		KM335	○	○	○	
	C702i	○	○	○		GD510 (POP)	○	○	○	
	G705	○	○	○		GD880	○	○	○	
	W595	○	○	○		GM730	○	○	○	
	W705	○	○	○		G5500 (Cookie Plus)	○	○	○	
	W980i	○	○	○		GT505	○	○	○	
	Xperia-X1	○	○	○		GT540	○	○	○	
	Vizaz	○	○	○		GW305	○	○	○	
	Xperia-X2	○	○	○		GX500	○	○	○	
Xperia-X10	○	○		Rim	Bold 9700	○	○	○		
LG	KE850	○			APPLE	iphone	○		○	
	KU250	○				iphone 3GS	○	○	○	
	KU970	○	○			(16GB)				
	KS10	○				iphone 3GS	○	○	○	
	KC550	○	○			(32GB)				
	KC780	○	○			iPhone 4G	○	○	○	
	KC910(Renoir)	○	○	○		(16GB)				
	KF350(IceCream)	○	○			I-Pad		○		
	KF600	○	○	○		ASUS	P750	○	○	
	KF700	○	○			HTC	Goole G1	○	○	
	KF750(Secret)	○	○		Magic G2		○	○		
	KF900(PRADA2)	○	○	○	Hero G3		○	○		
	KM380	○	○	○	Touch2		○	○	○	
	KM900(Arena)	○	○	○	Legend		○	○	○	
	KP500(Cookie)	○	○	○	Nexus One		○	○	○	
	KT520	○	○		Desire		○	○	○	
	KT610	○								
	KU990	○	○							
	GD900	○	○	○						



! Note

- When the phone features <Bluetooth Power Save> function, you should make the function turned on to maintain connection.
- When you switch the call mode from handsfree to phone, the connection may be disconnected.
- Some phones don't support Reject function.
- Low battery in phone may cause the problems.



“The Bluetooth word mark and logos are owned by the Bluetooth SIG, Inc. and any use of such marks by LG Electronics is under license. Other trademarks and trade names are those of their respective owners.”

Bluetooth® wireless technology is a system which allows radio contact between electronic devices within a max range of 10 meters.

Connecting individual devices under Bluetooth® wireless technology does not incur any charges. A mobile phone with Bluetooth® wireless technology can be operated via the Cascade if the connection was made via Bluetooth® wireless technology.

operating condition for using a Bluetooth wireless technology function

- Close windscreen.
- Turn off the air conditioner / heater.
- Stop the vehicle or drive at low speed.
- Make the call in a quiet location.
 - There may be differences in call quality depending on phone type, road conditions weather, etc.
 - Using the phone while driving may cause unexpected accidents.
 - The Bluetooth wireless technology function may not operate properly with certain types of phones equipped with Bluetooth wireless technology.



Troubleshooting

Symptoms	Cause	Solution
Power doesn't turned on. The unit doesn't operate.	Leads and connectors are not properly.	Confirm once more that all connections are correct.
	The fuse is blown.	Rectify the problem that caused the fuse to blow, and then replace it. Be very sure to install the correct fuse with the same rate.
	Noise and other factors are causing the built in microprocessor to operate incorrectly.	Turn the unit off and then on again.
No sound is heard.	Cables are not connected correctly.	Connect the cables correctly.
There's audio skipping.	This unit is not firmly secured.	Secure this unit firmly.
The playback is not possible.	The disc is dirty.	Clean the disc.
	The disc of unplayable type is loaded.	Check what type the disc.
Radio stations cannot be tuned in.	The signal strength of the stations is too weak. (When tuning in with automatic tuning.)	Tuned in the stations manually.
	No station has been preset or preset stations have been cleared. (When tuning by scanning preset stations.)	Preset the stations. (Refer to the page 17.)
iPod/ iPhone does not work.	Check whether iPod / iPhone is connected to the unit correctly.	Connect it to the unit correctly.
The unit does not operate correctly even when the appropriate remote control buttons are pressed.	Battery power is low.	Load a new battery.

Steering Remote Control

Appellation

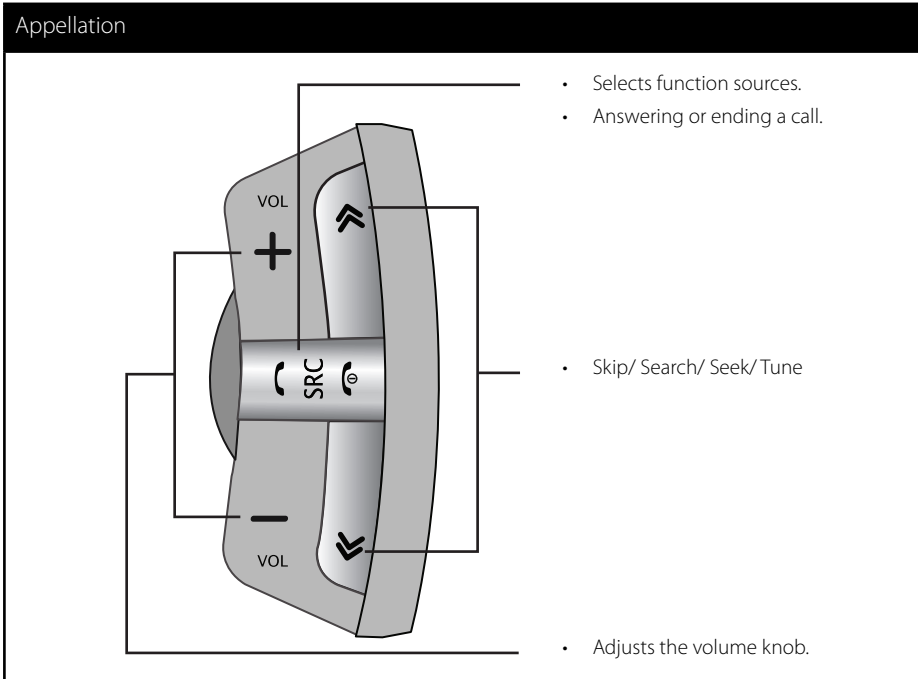

5

Appendix

! Note

- Press and hold SRC, you can turn the unit off during operation.
- Button on the car receiver head unit and remote control unit with same name have the same function.
- Depending on the car receiver, there may not be some buttons with the same names as those on this unit.
- This unit can not be used for a car receiver that does not accept a remote control unit.

Battery installation

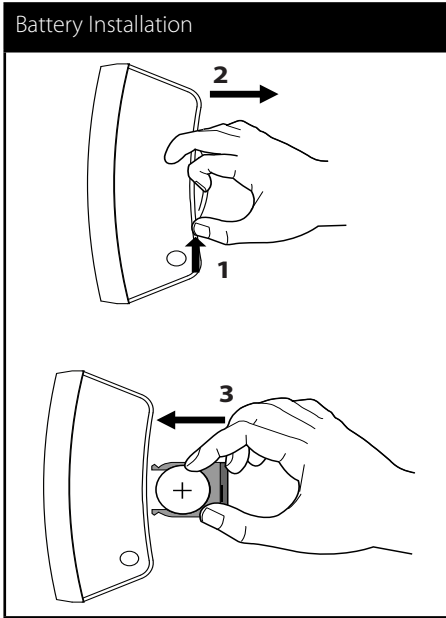

1. Pull out the battery holder while pressing the bottom of it.
2. Put the battery with **+** and **-** correctly on the battery holder.
3. Push the battery holder back into its original position.

! Note

- Use only one CR2025 (3V) lithium battery.
- Remove the battery if the remote control is not used for long.
- Do not handle the battery with metallic tools.
- Do not store the battery with metallic materials.
- In the event of battery leakage, wipe the remote control completely clean and install a new battery.
- Always check carefully that you are loading battery with its (+) and (-) poles facing in the proper directions.
- Do not eat lithium battery.

Installation

If you install in place other than installation scope, this unit is not operated.

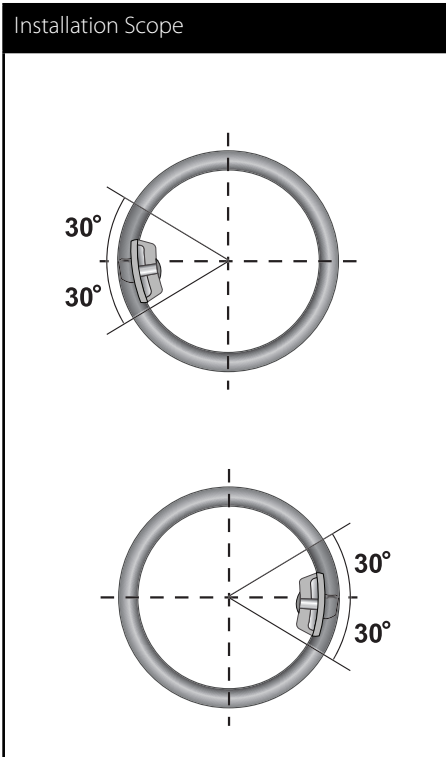

! Caution

- Avoid installing this unit in such a location where the operation of safety devices such as airbags is prevented by this unit. Otherwise, there is danger of a fatal accident.
- Fix this unit securely to the steering wheel with the belt attached to the unit. If this unit is loose, it disturbs driving stability, which may result in a traffic accident.
- Do not attach this unit to the outer circumference of the steering wheel. Otherwise, it disturbs driving stability, causing a traffic accident. Always attach this unit to the inner circumference of steering wheel as shown.

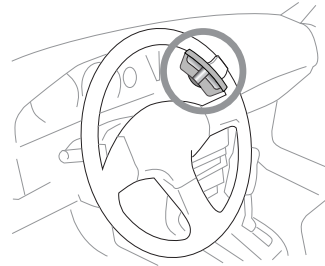

5

Appendix

! Note

- Do not install this unit in such a place as may obstruct the driver's view.
- Since inferior layout differs depending on the type of vehicle, the ideal installation location for the unit also differ. When installing the unit, select a location that assures optimum transmission of signals from the unit to car receiver.

Installing the unit on a Left-Hand-Drive Car

When the unit is installed on a Right-Hand-Drive car, the horizontal position are inverted.

1. Secure Cover holder to the inner circumference of the steering wheel with belt.

Fit the Cover holder to the steering wheel so that the arrow-marked side faces the driver as shown by picture.

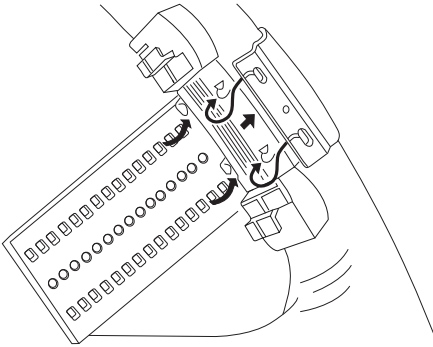

2. Cut the extra portion of the belt at the center of the cover holder.

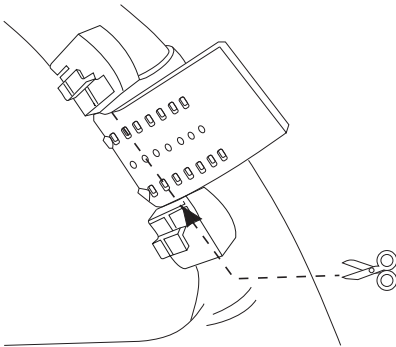

3. Install the remote control unit in the holder.

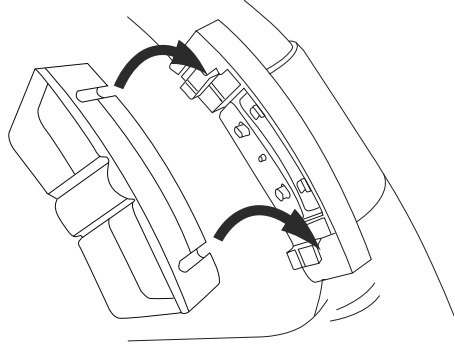

4. When removing the remote control unit from the holder, move the corrugated release section toward the steering wheel as far as possible before sliding the remote control unit toward you.

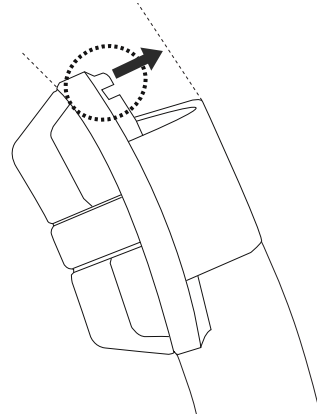

Specifications

General

Output Power : 53 W x 4 CH (Max.)
Power Source : DC 12 V
Speaker impedance : 4 Ω
Ground System : Negative
Dimensions (W x H x D) : (178 x 50 x 169) mm
(without Control Panel)
Net Weight : 1.37 kg

TUNER

FM Tuning Range :
87.5 MHz to 108.0 MHz
S / N Ratio : 55 dB
Distortion : 0.7 %
Usable Sensitivity : 12 dBμV
AM (MW) Tuning Range :
(520 to 1720) kHz or (522 to 1620) kHz
S / N Ratio : 50 dB
Distortion : 1.0 %
Usable Sensitivity : 28 dBμV

DAB

Distortion : 0.1 %
Channel Separation (1 kHz) : 68 dB

CD

Frequency Response : 20 Hz to 20 kHz
S / N Ratio : 80 dB
Distortion : 0.12 %
Channel Separation (1 kHz) : 55 dB

AUX

Frequency Response : 20 Hz to 20 kHz
S / N Ratio : 80 dB
Distortion : 0.1 %
Channel Separation (1 kHz) : 45 dB
Max Input Level (1 kHz) : 1.1 V

USB

Version : USB 1.1 or USB 2.0 Full Speed
Bus Power Supply (USB) : DC 5 V $\overline{\text{---}}$ 1 A

SD

Distortion : 0.1 %

Line OUT

Frequency Response : 20 Hz to 20 kHz
Output Voltage : 2 V (Max.)

Subwoofer

Frequency Response : 20 Hz to 120 Hz
Output Voltage : 2 V (Max.)

- Design and specifications are subject to change without notice.



Av. Sor Juana Inés de la Cruz No 555
Col. San Lorenzo
Tlalnepantla, Estado de México CP 54033
Tel. (55) 5321-1919
Lada sin costo 01 (800) 347 1919
LG Electronics México S.A. de C.V.

