



# LED DOWNLIGHT

## User Manual



- Please read the 「Safety Precautions」 prior to use for your safety.
- This manual is intended to prevent product damage and protect the user's safety.
- Place the manual at a place where it can be easily located by all potential users.

## LED DOWNLIGHT

Application of high-efficiency LED technology allows for tremendous energy reduction and its excellent heat management solution allows a life expectancy of 50,000 hours or more, making it an environmentally friendly product.

## Advantages



### Excellent Alternative

Significant energy savings over 42% through replacement compared to conventional 26/52W downlight.

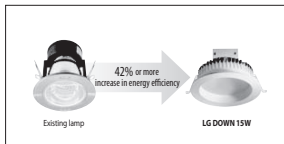

### Energy Saving by High Efficiency

Up to 76% energy saving yearly compared to conventional downlight lamp.

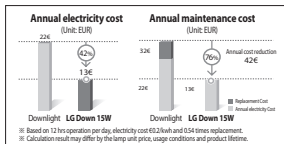

### Eco-friendly

Eco-friendly light source, which contains no mercury and low CO<sub>2</sub> emission.

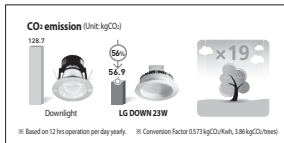



### Low Heat Generation

Feeling comfortable and lowering cooling costs compared with conventional downlight.

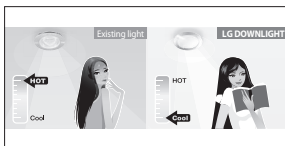

### Dimming Control

Up to 70% cost saving with its automatic dimming control by light sensor detection.

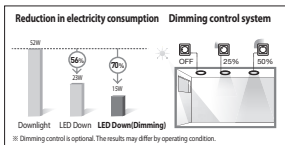

### Wide Application Coverage

Natural light with comfort for wide application.



## Table of Contents

|  |      |                                |    |
|--|------|--------------------------------|----|
| Safety Precautions .....                                 | 4~7  | Product Specifications .....   | 12 |
| Product Configuration and Information, Size .....        | 8    | Dimming Cable Connection ..... | 13 |
| Installation .....                                       | 9~10 | Limited Warranty.....          | 14 |
| Things to check before Requesting<br>Repair Service..... | 11   |                                |    |

## Safety Precautions

The meanings of the signs displayed on the product and user manual are as follows

- This sign indicates operations that might be dangerous and needs care with caution. For parts with this sign, user must read the manual carefully and follow instructions in order to avoid risks.
- This sign displays risks involving electric shock under certain conditions.

 **WARNING**

• Violation of warnings may lead to serious injury or death.

 **CAUTION**

• Violation of precautions may lead to light injury or product damage.

 **WARNING**



**Product is heavy.  
Use a trolley when  
transporting the  
product.**

• Dropping the product may cause product damage and malfunction.

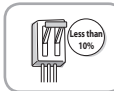

**Use with proper  
rated voltage.**

• Risk of fire and product damage.



**Do not install product  
in places exposed to  
dampness.**

• Risk of fire.

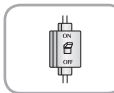

**Install a circuit  
breaker.**

• Risk of fire and electric shock.



**⚠ WARNING**



**Do not store in a humid area.**

- Risk of product malfunctioning.



**Perform grounding work.**

- Risk of electric shock.



**Be careful not to apply excessive force to the power cable.**

- Otherwise, it may cause the device to drop or result in electric shock.

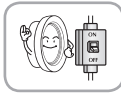

**Block power when installing lighting device.**

- Risk of accidents such as electric shock.



**Do not randomly connect the power polarities.**

- Risk of product damage and accidents.



**Use the device within a temperature range of 20°C to 50°C only.**

- Using the device in high temperatures may cause fire or shorten the LED's life span.

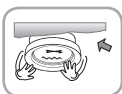

**Do not install on un-leveled ceilings.**

- Risk of product falling, which may lead to product damage and injury to the user.



**Do not expose the product to water when cleaning it.**

- Risk of fire and electric shock.



**⚠ WARNING**



**Must fix the product properly on the ceiling.**

- Risk of product dropping and causing injury to the user.



**Do not use the product if impurities are present in the product or if the product is submerged.**

- Risk of accidents such as electric shock and product damage.



**Do not use if the product has been dropped or exposed to shock.**

- Risk of product malfunctioning.



**Never disassemble the product.**

- Risk of accidents such as electric shock and product damage.

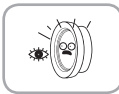

**Do not stare directly at the lamp when turned on.**

- Strong light may cause visual impairment.



**If the lamp turns off by itself, do not disassemble the product. Contact the service center for repair.**

- It has risks of electric shock and product malfunctioning.



**Electric work must be performed by a certified technician according to electrical device technology standards or extension regulations' or indoor electrical wire specifications' and the installation manual. Specific circuits must be used.**

- Inadequate power capacity and faulty electric work may lead to fire or electric shock.



**⚠ WARNING**



**Do not cover the device with clothes or paper, or place it near inflammables.**

- Otherwise, it may cause malfunction of the device or fire.



**Keep some distance between the lamp and the object to be illuminated.**

- If the illumination distance is too close or if the illumination is on a material's surface, this may cause discoloration or deformation of the object or cause fire.



**Do not use the device for purposes other than illumination.** (which include warming food, drying clothes, using under water, using as a search light, fishing or other events.)

- Otherwise, it may cause fire or electric shock.

**⚠ CAUTION**

- Do not wipe the surface with inflammables, such as alcohol, benzene, and acetone.
- Do not use the device in places with corrosive gases.
- The color and the brightness of the lamp may differ even among the same model because the LED light source has "light dispersion".

## Product Configuration and Information, Size

### Product Configuration

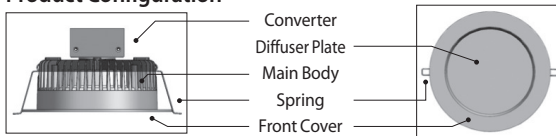

※ Product Configuration may vary depending on the product.

### Product Information

| Category             | 4 Inch |                     | 6 Inch              |                     | 8 Inch              |  |
|----------------------|--------|---------------------|---------------------|---------------------|---------------------|--|
|                      | 8W     |                     | 15W                 | 23W                 | 37W                 |  |
| Product Verification | 3000K  | LD08X730M2B.D00***0 | LD15X730P2B.D00***0 | LD25X730P2B.D00***0 | LD40X730R2B.D00***0 |  |
|                      | 4000K  | LD08X740M2B.D00***0 | LD15X740P2B.D00***0 | LD25X740P2B.D00***0 | LD40X740R2B.D00***0 |  |
|                      | 5000K  | LD08X750M2B.D00***0 | LD15X750P2B.D00***0 | LD25X750P2B.D00***0 | LD40X750R2B.D00***0 |  |
|                      | 5700K  | LD08X757M2B.D00***0 | LD15X757P2B.D00***0 | LD25X757P2B.D00***0 | LD40X757R2B.D00***0 |  |

※ 23W and 37W products are not suitable for covering with thermally insulating material.

※ Asterisk(\*) will vary by model.



### Product Size

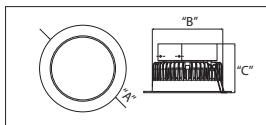

(Unit: mm)

| Category        | 4 inch  | 6 inch  | 8 inch  |
|-----------------|---------|---------|---------|
| Ceiling Cut-out | ∅ 100±5 | ∅ 155±5 | ∅ 200±5 |
| "A"             | ∅ 120   | ∅ 180   | ∅ 223   |
| "B"             | 90      | 145     | 187     |
| "C"             | 88      | 100     | 111     |

- 8 -





## Installation

### **⚠ WARNING**

Make sure to turn off the main power switch of the installation space before connection.

Connect so that the colors of the 3 power cables match.  
(LIVE: BROWN, NEUTRAL: BLUE, P.E.: GREEN/YELLOW)

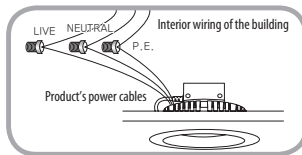
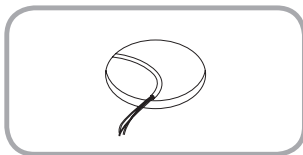

- 1** Drill and prepare the ceiling so that it can accommodate the product (refer to page 8 for product size).

- 2** Connect the 3 product cables to the interior wiring of the building. For finishing cap, use standardized products.

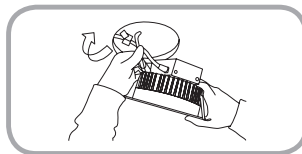
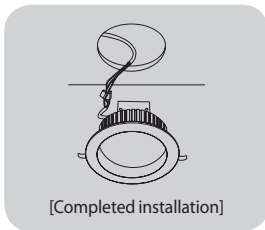

- 3** Connect the 3 product cables to the interior wiring of the building. For finishing cap, use standardized products.



## ● Installation

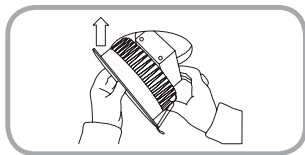

- 4** Insert the power cable in such a way that the power cable does not get tangled between the ceiling surface and the product.

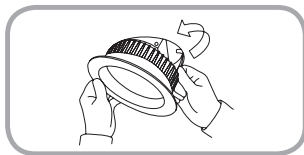

- 5** Sufficiently lift the product so that the spring can be inserted on the other side.

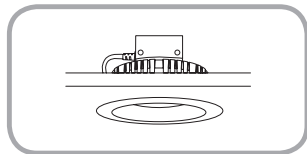

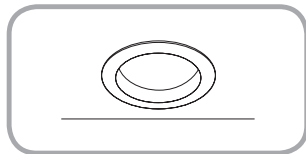

- 6** Check to see if the product's exterior surface is installed on the ceiling so that there is no gap between them.



- 7** Turn the power switch on to verify that the product is working properly.

## ● Things to check before Requesting Repair Service

| Symptom   | Check  |
|---|--|
| <p><b>It won't turn on.</b></p>        | <p>Check to see if the power is connected or if the switch is off.</p>   |
| <p><b>It flickers.</b></p>             | <p>Turn the power off. Turn it back on after a moment. (If the flickering problem still exists, make a service request.)</p> |
| <p><b>A certain area is dark.</b></p>  | <p>Make a service request.</p>   |

## Product Specifications

| Category              | 4 Inch   |      |      |      | 6 Inch         |      |      |      | 8 Inch         |      |      |      | Unit |      |      |      |            |
|-----------------------|--|------|------|------|----------------|------|------|------|----------------|------|------|------|------|------|------|------|------------|
| Watts                 | 8  |      |      |      | 15             |      |      |      | 23             |      |      |      | 37   | W    |      |      |            |
| Light Output          | 430  | 490  | 520  | 510  | 880            | 930  | 990  | 960  | 1430           | 1500 | 1580 | 1560 | 2270 | 2450 | 2580 | 2540 | lm         |
| Lumens per Watt       | 54   | 61   | 65   | 64   | 59             | 62   | 66   | 64   | 62             | 65   | 69   | 68   | 61   | 66   | 70   | 69   | lm/W       |
| Light Color           | 3000   | 4000 | 5000 | 5700 | 3000           | 4000 | 5000 | 5700 | 3000           | 4000 | 5000 | 5700 | 3000 | 4000 | 5000 | 5700 | K          |
| Color Accuracy (CRI)  | 80   |      |      |      |                |      |      |      |                |      |      |      |      |      |      |      |            |
| Beam Angle            | 100  |      |      |      |                |      |      |      |                |      |      |      |      |      |      |      | °(degrees) |
| Size                  | Ø 120 X 88(H)  |      |      |      | Ø 180 X 100(H) |      |      |      | Ø 223 X 111(H) |      |      |      | mm   |      |      |      |            |
| Product Weight        | 358  |      |      |      | 680            |      |      |      | 720            |      |      |      | 1360 | g    |      |      |            |
| Input Voltage         | AC 100 - 240 ~   |      |      |      |                |      |      |      |                |      |      |      |      |      |      |      | V          |
| Input Frequency       | 50 / 60  |      |      |      |                |      |      |      |                |      |      |      |      |      |      |      | Hz         |
| Method of Power Input | Single-phase three-wire system   |      |      |      |                |      |      |      |                |      |      |      |      |      |      |      |            |
| Dimming               | Dimmable with 0-10V DC control <sup>(1)</sup> (Source Current : 1mA, Max.) |      |      |      |                |      |      |      |                |      |      |      |      |      |      |      |            |
| Power Factor (PF)     | Min. 0.90  |      |      |      |                |      |      |      |                |      |      |      |      |      |      |      |            |

- Performance may vary depending on the model.
- Light Color of 3000K is limited to 6" products.

(1) Some Dimmers may not be compatible.

## Dimming Cable Connection

**To dim the lamps, a compatible dimmer should be used.**

The use of incompatible dimmers will result in damage to the products. Please verify with vendors.

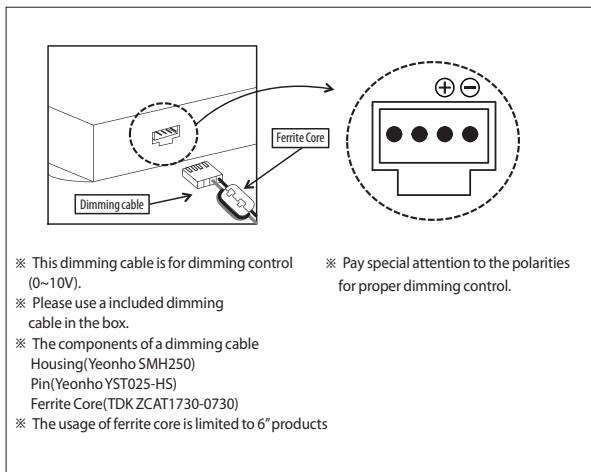



## Limited Warranty

The limited warranty set forth below is given by LG Electronics, Inc. ("LGE") with respect to the lighting product packaged with this limited warranty. (the "Product"). Your Product ,when delivered to you in new condition in its original packaging, is warranted against defects in materials or workmanship as follows: for a period of three (3) years from the date of original purchase, defective parts or a defective Product returned to LGE, or its authorized service providers, as applicable, and proven to be defective upon inspection, will be repaired, or exchanged for a new Product, as determine by LGE, or the authorized service provider. This limited warranty is conditioned upon proper storage, installation, use and maintenance complying with their respective published specifications, and does not apply in the following cases: (a) Loss of or damage to the Product due to abuse, mishandling, alteration, accident, electrical current fluctuations failure to follow operating, maintenance or environmental instructions prescribed by LGE in writing or services performed by someone other than LGE or an authorized service provider. To make a warranty claim, contact your local LGE sales representative. After contacting your local LGE sales representative, you will receive instructions regarding if, when and where to ship non-conforming Product. Failed Product must be returned for inspection and verification of non-conformance by LGE. Failure to follow this procedure shall void this warranty. **WARRANTY IS VOID IF PRODUCT IS NOT USED FOR THE PURPOSE FOR WHICH THIS PRODUCT IS MANUFACTURED. NO IMPLIED WARRANTY, INCLUDING ANY IMPLIED WARRANTY OF MERCHANTABILITY OR FITNESS FOR A PARTICULAR PURPOSE, APPLIES TO THE PRODUCT AFTER THE APPLICABLE PERIOD OF THE EXPRESS LIMITED WARRANTY STATED ABOVE, AND NO OTHER EXPRESS WARRANTY OR GUARANTY, EXCEPT AS MENTIONED ABOVE, GIVEN BY ANY PERSON OR ENTITY WITH RESPECT TO THE PRODUCT SHALL BIND LGE. (SOME STATES AND PROVINCES DO NOT ALLOW LIMITATIONS ON HOW LONG AN IMPLIED WARRANTY LASTS, SO THE ABOVE LIMITATION MAY NOT APPLY TO YOU.)**

- 14 -







P/No : MFL67082801 (REV06)

